



Specification No.

AEC\_CPK\_110516\_01

Messrs : Celluon

## Approval Sheet for Product Specification

Issued Date : May. 12. 2005

Product Description : SMD Type Chip Antenna

Customer Part No. :

AUTO Part No. : AEC\_CPK\_001

Date :
Company :
Dept. :
Approved by (Signature) (Type)

The duplicate of this specification shall be returned to us with your authorized signature. Unless it reaches us by June. 15, 2005 it shall be mutually understood that this specifications have been duly approved by you.

Technical Dept.  
Prepared by

\_\_\_\_\_  
(Signature)  
(Type)

Approved by

\_\_\_\_\_  
(Signature)  
(Type)

Manager  
Product Engineering Section  
Antenna Products Department  
Auto Electronic Corp.

\_\_\_\_\_  
(Company name/Dept.)

# Specification Sheet

Object	Chip Antenna	REV.	1.0	Page	1 of 6
Model Name	AEC_CPK_001	Date	May. 12, 2005		
System	Bluetooth Module	Written by	S.O.Hong		

## Electrical Specification

Frequency	2.4 ~ 2.485[GHz]
Bandwidth	200[MHz]
V.S.W.R	1.9:1[max]
Gain (max)	0[dBi]
Input Impedance	50[Ω]
Polarization	Linear

## Mechanical Specifications

Size	11×5×1.6[mm]
Weight	0.2[g]
Radiator Material	Copper
Operation Temperature	-30 ~ 90[℃]
Operation Humidity	10 ~ 90[%]

Option	
Others	- Land Pattern이 반대이기 때문에 Antenna를 뒤집어서 실장

## 1. Dimension

. 11mm(L)×5(W)×1.6(H)

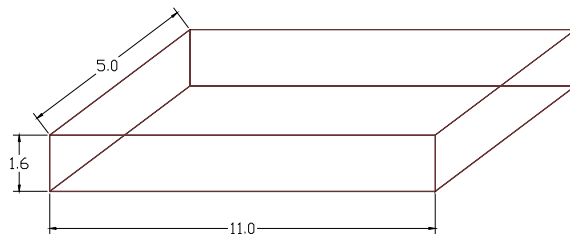

Dimension

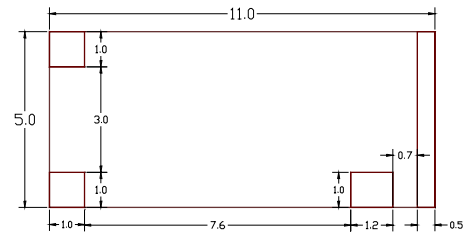

Bottom land pattern

\* The chip antenna is required to be used on our suggested PCB.

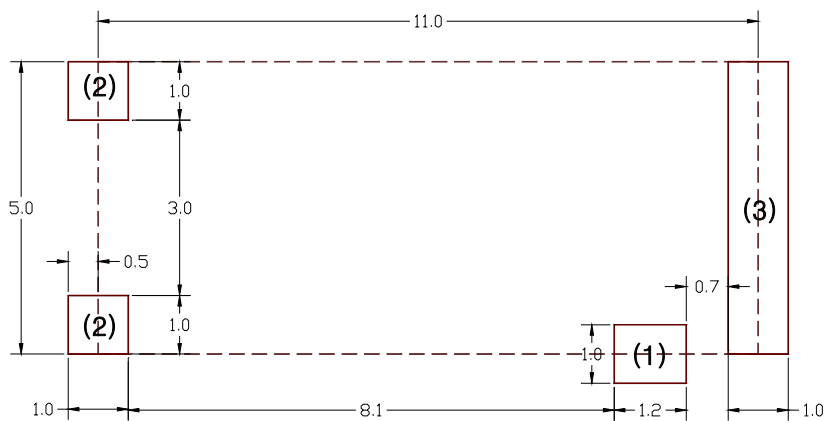

- (1) Feed point
- (2) NC(Mount points)
- (3) GND

Recommended land pattern

## 2. Characteristics

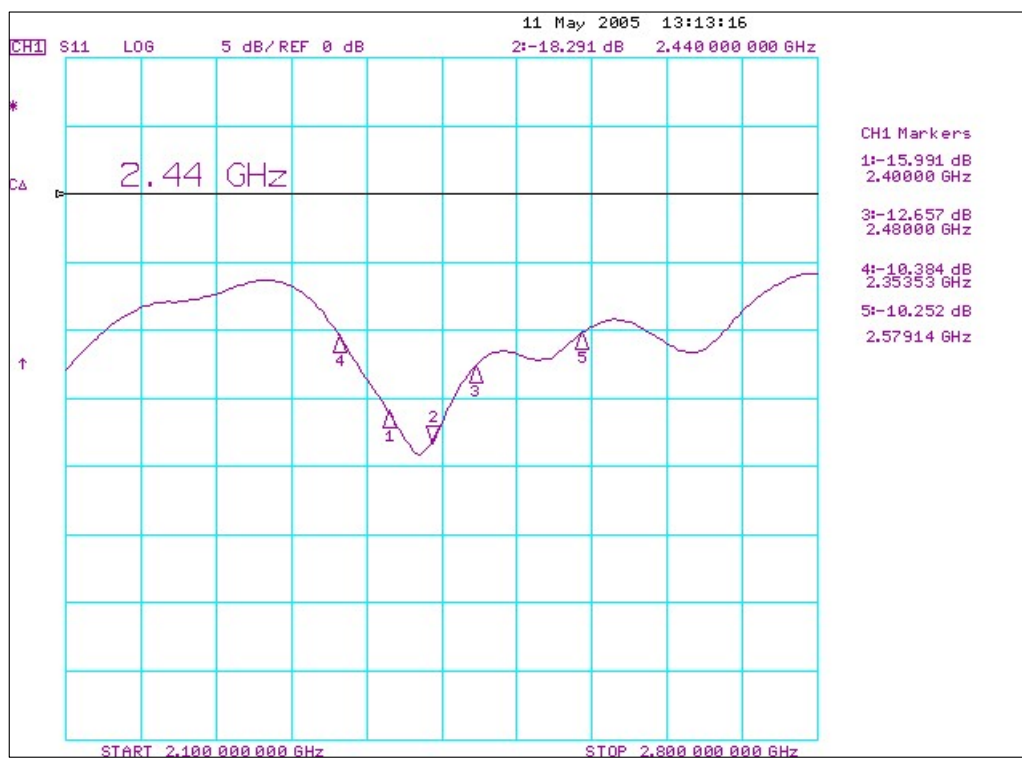

Return Loss ( $S_{11}$ )

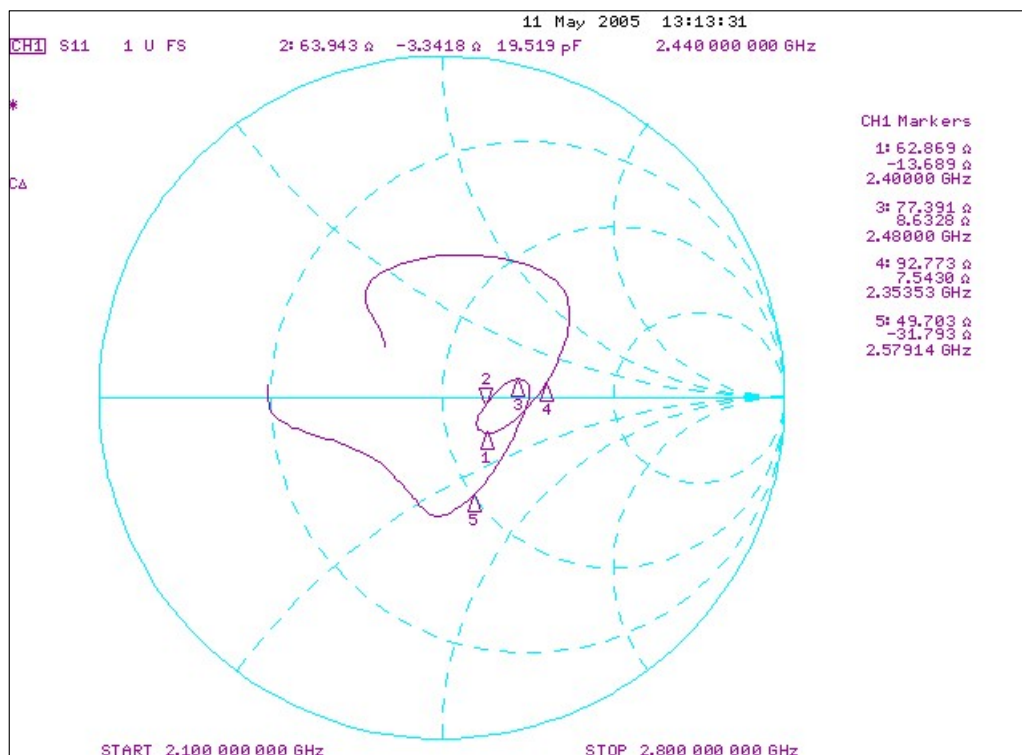

Smith Chart

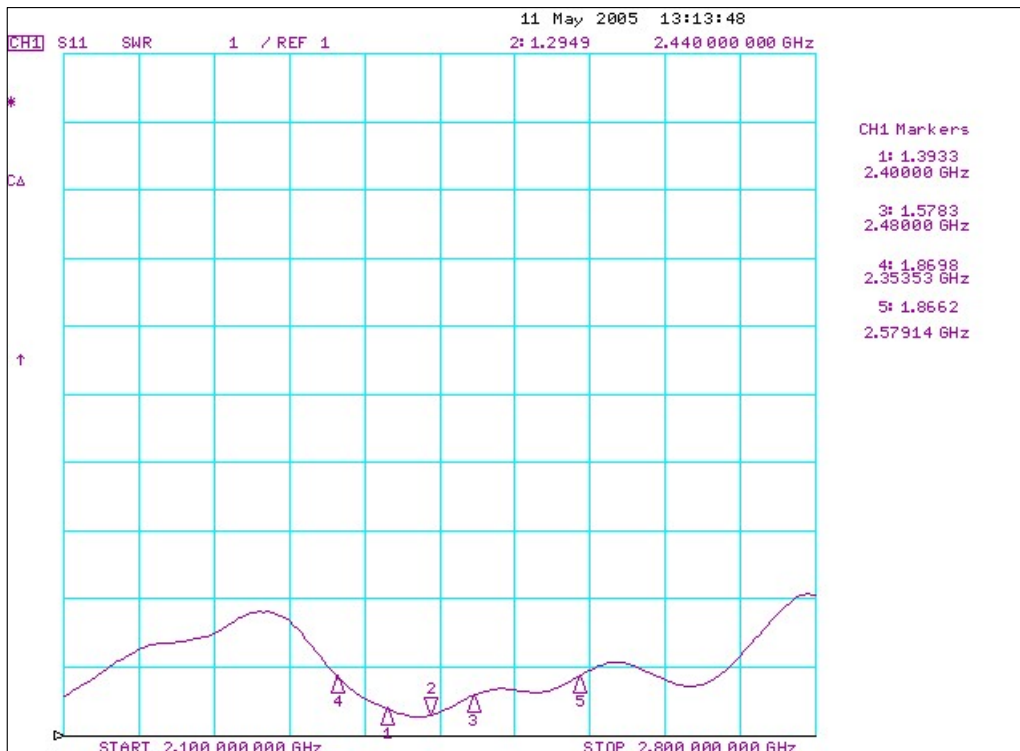

VSWR

### 3. Radiation Pattern

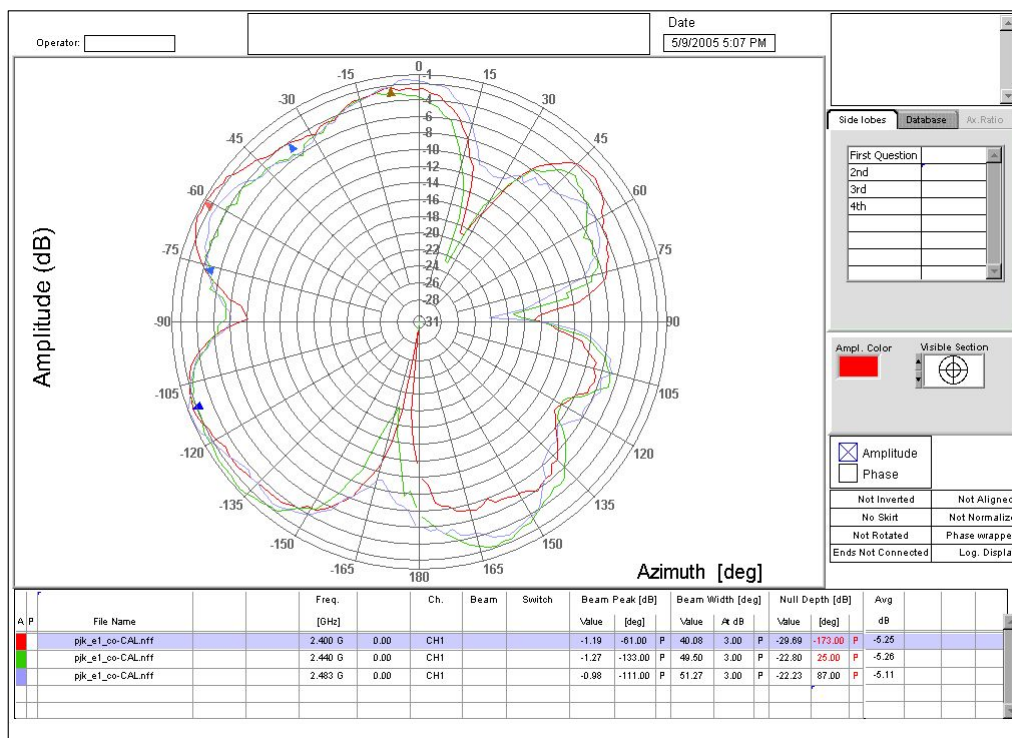

E-Plane (90°)

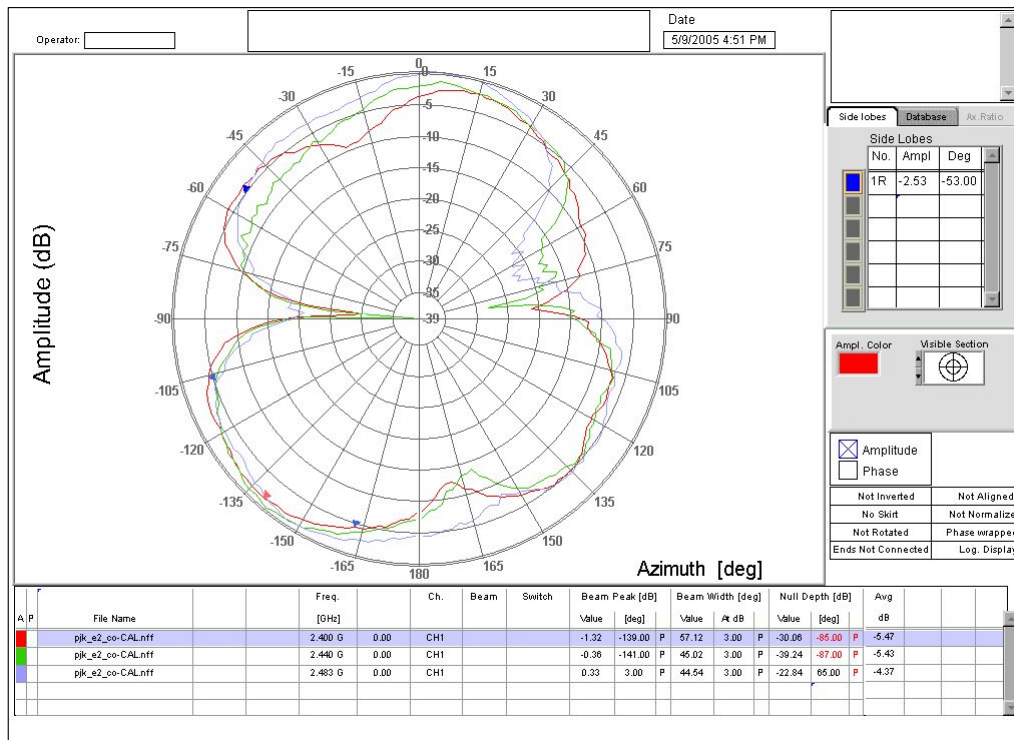

E-Plane (0°)

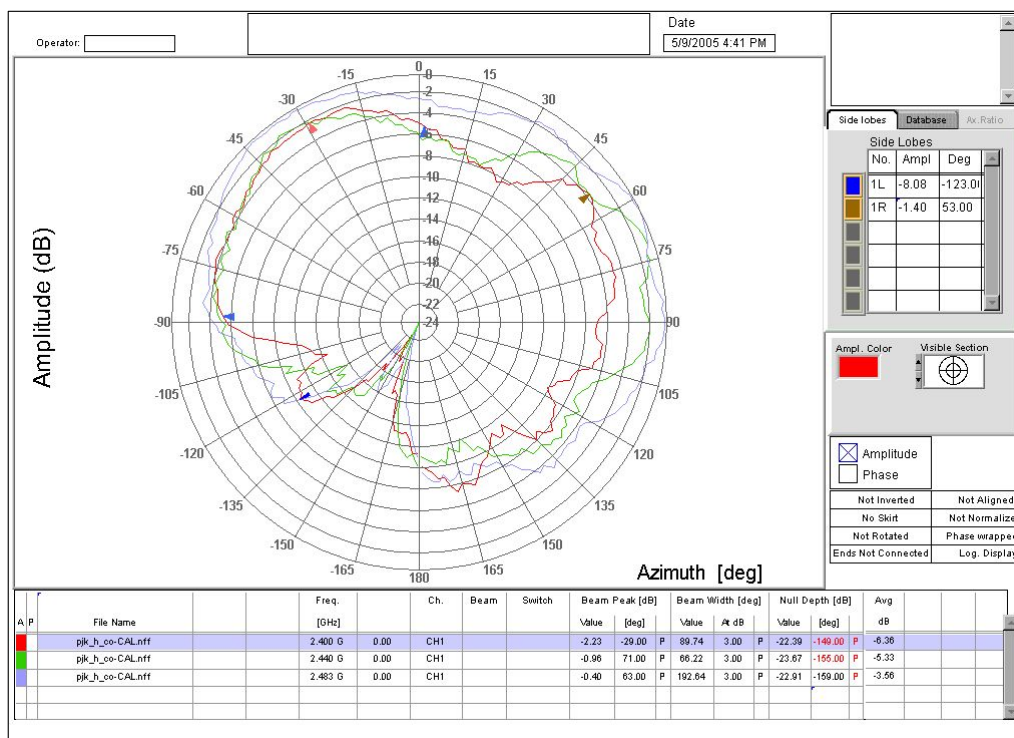

H-Plane

#### 4. Taping

##### . Dimension of Tape (Plastic Case)

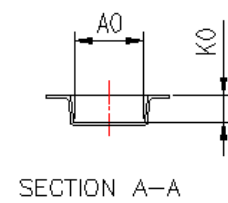
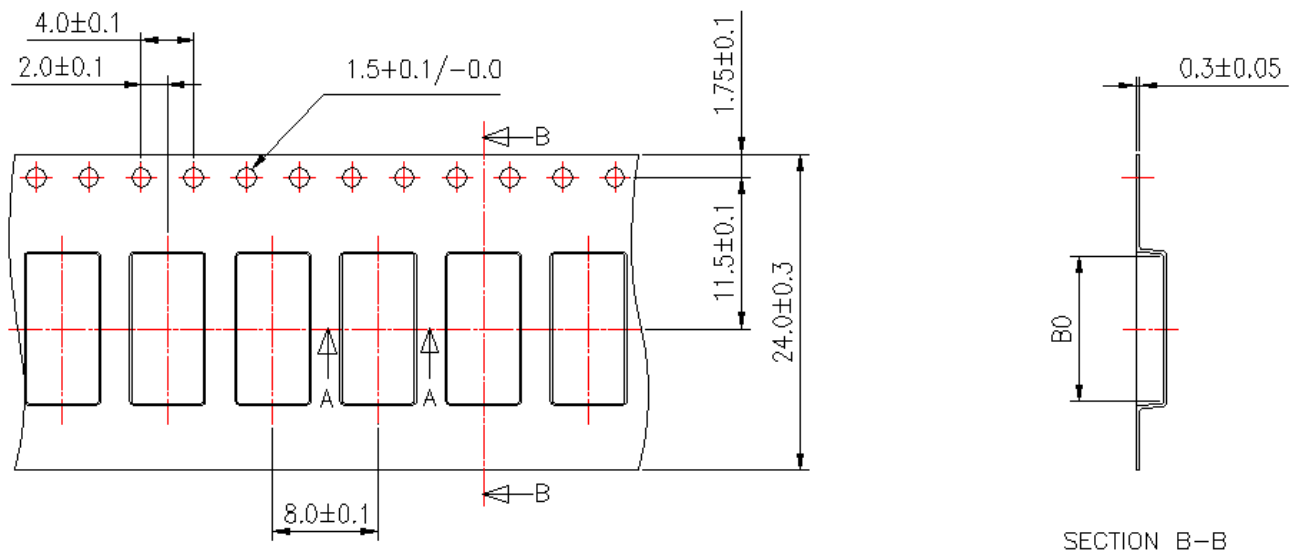

주]

1. 지시없는 라운딩 Max R0.5
2. 빠짐기울기 Max 5°

A0 :  $5.40 \pm 0.10$   
 B0 :  $11.40 \pm 0.10$   
 K0 :  $2.10 \pm 0.10$