



USER'S GUIDE

C O N T E N T S

Precautions	4	■■■■■
Using and Handling the System Cartridge	8	■■■■■
Using and Handling the XaviX Interface (Fishing Tackle)	10	■■■■■
XaviX Bass FISHING Accessories	13	■■■■■
Welcome to the World of XaviX	14	■■■■■
Product Description	16	■■■■■
Description of XaviX Fishing Tackle	16	■■■■■
Assembling the XaviX Fishing Tackle	18	■■■■■
Install the batteries in your XaviX Fishing Rod	19	■■■■■
Description of System Cartridge and XaviX Fishing Tackle	21	■■■■■
Description of XaviXPORT with Bass Fishing System Cartridge	22	■■■■■
How to cast over arm	22	■■■■■
Positioning the XaviXPORT system and XaviX Fishing Tackle for Bass Fishing	23	■■■■■
Playing Distance	23	■■■■■
Inserting a System Cartridge in the PORT	24	■■■■■
Releasing a System Cartridge from the PORT	25	■■■■■
How to Use Your XaviX Fishing Tackle	26	■■■■■
How to Cast	28	■■■■■
Basic Knowledge for Enjoying XaviX Bass FISHING	32	■■■■■
Starting Fishing Action	38	■■■■■
Menu Control	39	■■■■■
Game Control	40	■■■■■
Introduction	41	■■■■■
About the POWER CHECK	42	■■■■■
POWER CHECK Remedy	43	■■■■■
Basic Game Settings	44	■■■■■
Familiarizing Yourself with XaviX Bass FISHING Screens	45	■■■■■
Starting Tournament Fishing Action	46	■■■■■
Starting Free Fishing Action	52	■■■■■
Options	53	■■■■■
Troubleshooting	55	■■■■■
Notes and General Information	58	■■■■■
XaviX Bass FISHING Specifications	59	■■■■■
Warranty	60	■■■■■

XaviX Products



**PRECAUTION
GUIDE**

Please read this guide before you start using your XaviX system.

Precautions

FCC Rules for customers in the U.S.A.

This device complies with Part 15 of the FCC Rules. Operation is subject to the following two conditions:

- (1) This device may not cause harmful interference.
- (2) This device must accept any interference received, including interference that may cause undesired operation.

15.21 Regulatory information/ Disclaimers

Installation and use of this XaviX Bass FISHING System must be in strict accordance with the instructions included in the user documentation provided with the product. Any changes or modifications (including the antennas) made to this device that are not expressly approved by the manufacturer may void the user's authority to operate the equipment. The manufacturer is not responsible for any radio or television interference caused by unauthorized modification of this device, or the substitution of the connecting cables and equipment other than manufacturer specified. It is the responsibility of the user to correct any interference caused by such unauthorized distributors will assume no liability for any damage or violation of government regulations arising from failing to comply with these guidelines.

FCC RF Radiation Exposure Statement: This equipment complies with FCC RF radiation exposure limits set forth for an uncontrolled environment. This device and its antenna must not be co-located or operating in conjunction with any other antenna or transmitter

MPE Statement (Safety Information)

Your device contains a low power transmitter. When device is transmitted it sends out Radio Frequency (RF) signal.

Safety Information

In order to maintain compliance with the FCC RF exposure guidelines, this equipment should be installed and operated with minimum distance 20cm between the radiator and your body. Use only with supplied antenna. Unauthorized antenna, modification, or attachments could damage the transmitter and may violate FCC regulations.



Precautions



CAUTION

RISK OF ELECTRIC SHOCK. DO NOT OPEN

TO REDUCE THE RISK OF ELECTRIC SHOCK, DO NOT REMOVE COVER (OR BACK). NO USER-SERVICEABLE PARTS INSIDE. REFER SERVICING TO QUALIFIED SERVICE PERSONNEL.

Symbols Used in This User's Guide



This symbol alerts the user to the risk of high voltage inside this equipment. Contact with high voltage may cause an electric shock.



This symbol alerts the user to important operating and maintenance (servicing) instructions in this User's Guide.



This symbol alerts the user to actions that he or she should not do when handling XaviX products. Mishandling XaviX products in the way shown in illustrations marked with this symbol may cause malfunction, damage, accident or injury.



This symbol indicates actions that the user should take when handling XaviX products.

For use in North America only.

Avoid Damage to Your Television

- Some televisions, especially front and rear projection televisions, can be damaged through the use of video games, including the XaviX system. For example, images projected on some televisions may cause "burn-in" or permanent shadows of static images to appear on the TV screen.
- Consult your television user's manual to determine if the system can be played safely on your TV set. If you are unable to find this information in the user's manual, please contact your television dealer or manufacturer to determine if the XaviX system can be played safely on your TV set.

Use with NTSC TVs

- Use the XaviXPORT only with NTSC TVs. Do not use the XaviXPORT with PAL system TVs.



Health Precautions

The following cautions are for the protection of your health. **Read them carefully** before you and your family start to enjoy the XaviX system.

Caution for Seizures

- A very small percentage of individuals may experience epileptic seizures when exposed to certain light patterns or flashing lights. Exposure to certain patterns or backgrounds on a television screen or while playing video games, including XaviX software, may induce an epileptic seizure in these individuals. Certain conditions may induce previously undetected epileptic symptoms even in persons who have no history of prior seizures or epilepsy.
- We recommend that people who have had seizures or blackouts consult a doctor before they use this product.
- You can reduce the possibility of seizures or blackouts by:
 - Standing as far away as possible from your TV screen.
 - Adjusting or reducing the contrast, brightness and color level on your TV to a comfortable level.
 - Operating the product in well-lit room conditions.
 - Taking a **10- to 15-minute** break or not using this product if you feel tired or sleepy.
 - If you feel dizzy or nauseous during use of this product, immediately stop using it, and take a rest until you feel better.
- Keep a careful watch over your child(ren) while they use this product.

Section 1 : Using and Handling the System Cartridge

The System Cartridge comes packed with the XaviX Interface as an integral part of the XaviX system. The System Cartridge is designed to be inserted into the XaviXPORT.

The System Cartridge Blade is designed to connect the System Cartridge to the System Slot on the PORT.

Do **NOT** touch this System Cartridge Blade with your fingertips, or insert wire, metal pins or other objects into this System Cartridge Blade.



System Cartridge Blade

Do **NOT** dismantle the System Cartridge for servicing or repair yourself, or insert anything into openings.

Make sure that the alignment mark on the System Cartridge for the **correct position** of the Cartridge is aligned with the inside wall of the PORT.

Place the System Cartridge on the PORT at the **correct location and orientation**.



Follow the instructions in the User's Guide to release the System Cartridge from the PORT correctly.

Do **NOT** insert any objects into the PORT to release the System Cartridge.

Keep away from water, liquid and moisture.

To **clean** off dirt or stubborn stains, wipe gently with a soft dry cloth. Do **NOT** use a cloth moistened with any liquid.

Do **NOT** attempt to install, insert or connect other tapes or a **non-System Cartridge** in or to the PORT.



Section 2 : Using and Handling the XaviX Interface (Fishing Tackle)

XaviX Interfaces, such as the Fishing Tackle, are created for interactive action with the XaviX system. These interfaces allow you to enjoy the XaviX System on your TV via the PORT.

Attach the **wrist strap** on the Interface to your wrist, and keep it attached at all times during use.



Adjust the wrist strap to a comfortable position. You may be injured or hurt if the wrist strap is fastened too loosely or too tightly.



Do **NOT** loop the strap over the leg or neck of children or animals.



Make sure that batteries are inserted correctly in the Interface.

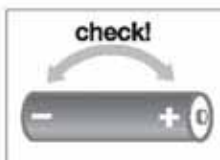

Do **NOT** release or allow the interface to leave your hand even if you have tied the wrist strap to your wrist.



Ensure a safe distance between the Interface and TV. Do **NOT** stand close to other people or your TV when using the Interface. This may cause injury and damages.



Make sure that your child(ren) use the Interfaces correctly. Also be careful not to point or swing the Fishing Tackle around by its grip or wrist strap. Otherwise, you might hit and injure someone, or break something.



Keep away from water, liquid and moisture.



To **clean** off dirt or stubborn stains, wipe gently with a soft dry cloth. Do **NOT** use a cloth moistened with alcohol, benzene or other organic solvent.



We recommend that you remove the batteries from the Interface if you are not planning to use it for a long period.

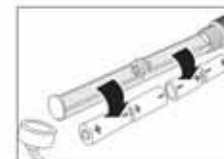









The greatest attraction of Xavix Bass FISHING is that both experts who own several rods and complete beginners alike can enjoy the thrill and excitement of landing tough battling fish.



Xavix Bass FISHING Accessories

Xavix Bass FISHING Accessories

Xavix Fishing Reel (1 pc) 	Xavix Fishing Rod (1 pc) 
System Cartridge (1 pc) 	
User's Guide (1 pc) 	Quick Setup Guide (1 pc) 
Registration Card (1 pc) 	Serial No. Labels (4 pcs) 

Four AA batteries are required.

Please check carefully to confirm that the box includes all components. If parts are missing, contact the Xavix Customer Support Hotline.

Apply one of the provided Serial No. Labels on each of the following components:

- Underside of the Xavix System Cartridge
- Registration Card (provided)
- Owner's Record (page X00)

You will be asked for your Serial No. when confirming details of the warranty or other customer service.





Welcome to the World of XaviX

Welcome to the World of XaviX

Thank you for purchasing this XaviX system.
Before using this product, carefully read this User's Guide and the XaviXPORT User's Guide for safe and proper use, setup and care of your XaviXPORT system. After reading these materials, store them in a safe place for future reference.

Please refer to the table below for trademarks and terms used to describe XaviX products.

Trademark	Terms
XaviX®	XaviX or XaviX Processor
 ™	
XaviXTechnology™	XaviX Technology
XaviXPORT™	XaviXPORT or PORT
XaviXGames™	XaviX Games or Games
XaviXHome™	XaviX Home or Home
XaviXEntertainment™	XaviX Entertainment or Entertainment
XaviXEducation™	XaviX Education or Education
XaviXBassFISHING™	XaviX Bass FISHING, Bass Fishing System or Fishing
XaviXSystemCartridge™	XaviX System Cartridge or System Cartridge
XaviXInterface™	XaviX Interface, XaviX Fishing Tackle e.g. Fishing Rod, Fishing Reel
XaviX® AC Power Adapter	Power Adapter
XaviX® A/V Cable	A/V Cable

"XaviX," and certain other trademarks and logos listed above or appearing in this User's Manual, are trademarks or registered trademarks of SSD COMPANY LIMITED in the United States and other countries.



The XaviXPORT Concept

XaviXPORT transforms your TV into "Digital Entertainment Technology Gear."
Everyday will be different from now on!

XaviX Games

Red is the color of passion. It spiritually uplifts us and fills us with energy. This category offers a variety of hands-on sports games for everyone from small children (with appropriate supervision) to adults.

XaviX Entertainment

Yellow symbolizes joy and happiness. This category encompasses a variety of entertainment, such as karaoke and dance instruction, designed to be shared with your family and friends.

XaviX Home

As well as expressing health and vividness, blue imparts the feeling of stability. This category includes a lineup of software titles for fitness, exercise and healthcare, plus training and other personal development tools.

XaviX Education

Green conveys youthfulness. Software in this category provides children and adults with educational content that is enjoyable and interactive.

Description of XaviX Fishing Tackle

XaviX Bass FISHING comes with two parts, the XaviX Fishing Rod and the XaviX Fishing Reel. When these two parts are assembled together, they become the XaviX Fishing Tackle.

XaviX Fishing Reel

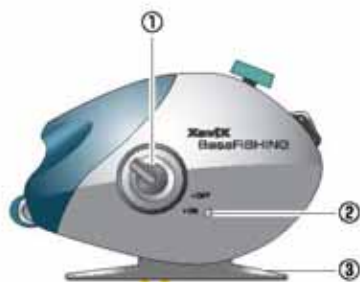

- ① **POWER Switch**
- ② **Power Indicator**
- ③ **Reel foot**
- ④ **Handle**
Turn the handle towards you with your right hand when a fish has taken the bait to reel it in. Turning the handle away from you produces no effect.

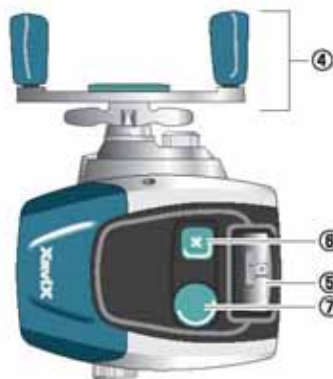

- ⑤ **ENTER Key**
Press this key to make a selection and display the fish radar or lure action.
- ⑥ **CANCEL Key**
Press this key to cancel a selection. It is also used for displaying the menu screen during the game.
- ⑦ **SELECT Key**
Press this key to select various items. You can use this key to move up or down, or to the left or right between items in screens. It is also used for moving the XaviX Fishing Rod during the game.

XaviX Fishing Rod



- ⑧ **Front Grip**
- ⑨ **Nut**
This part of the Rod prevents the stopper from coming loose and the Reel and Rod from separating.
- ⑩ **Hood**
This part of the Rod holds the Reel flush against the Rod.
- ⑪ **Trigger**
Use this part of the Rod to get extra stability.
- ⑫ **Grip**
Hold this part of the Rod with your left hand for Fishing action.
- ⑬ **Battery cap**



This XaviX Fishing Tackle is exclusively for XaviXBass Fishing. Do not use it for other purposes.

Note

Other Parts on the XaviX Fishing Tackle

Other fittings and parts on the XaviX Fishing Tackle are for decorative purposes only. Do not exert unnecessary force or try to manipulate these parts as you may scratch or damage them.

Assembling the XaviX Fishing Tackle

When you buy your XaviX Bass package, the XaviX Fishing Rod and the XaviX Fishing Reel are not assembled.
To enjoy XaviX Bass FISHING, you must first assemble the XaviX Fishing Rod and the XaviX Fishing Reel to assemble your XaviX Fishing Tackle.

1. Hold the Fishing Rod firmly as shown in the figure.
Loosen the Nut ① and Hood ② on the Fishing Rod in the direction of the arrow all the way back.

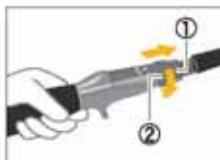

2. Insert the back Reel foot ③ of the Fishing Reel into the insert slot ④ on the Fishing Rod towards you.



3. Bring the front Reel foot of the Fishing Reel towards the Fishing Rod so that it is flush against the Fishing Rod.



4. Tighten the Nut ① and Hood ② firmly.



Do not soil or touch the contacts on the XaviX Rod and Reel. Doing so might cause the XaviX Fishing Tackle to malfunction.

Note

Do not use unnecessary force to tighten the Nut ① and Hood ②. Doing so might cause the Nut ① and Hood ② to split or break.

Install the batteries in your XaviX Fishing Rod

1. Unscrew the Battery cap.



2. Slide in the batteries, making sure that the + and - ends are facing the correct direction.

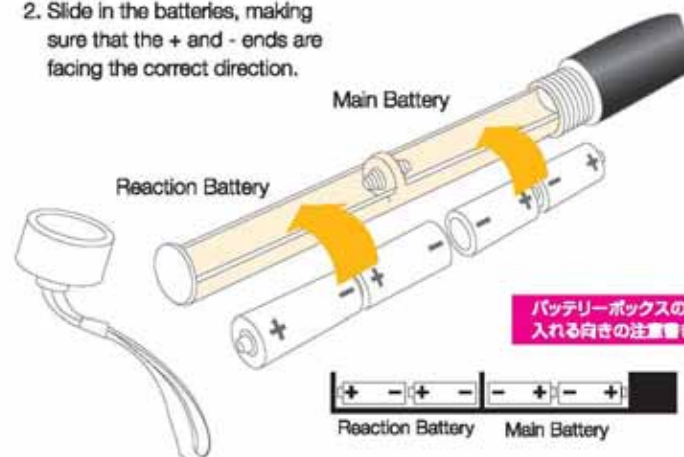

If the Power Indicator does not light even with the power turned on, first replace the two batteries in the Main Battery compartment of the Battery Box with fresh batteries.
If the pull of the fish you have caught is not reaching the XaviX Fishing Reel even though the Power Indicator is lit, replace the two batteries in the Reaction Battery compartment of the Battery Box with fresh batteries.

3. Screw in the Battery cap.





Product Description

Note

Power and Battery Precautions

Power Indicator

Before you start Fishing action, turn on the POWER Switch on the XaviX Fishing Rod. The Power Indicator next to the POWER Switch will light up to indicate that the power is on. The Indicator light should be green.

Power-save Mode

If the system is turned on but is unused (no keys are pressed or the XaviX Fishing Reel Handle is not turned) for an extended period of time (10 minutes), the system will automatically go into the power-save mode. In this mode, the Indicator is out.

The Power Indicator blinks in the power-save mode.

To return to Fishing action from the power-save mode, press the ENTER Key. Pressing other keys, moving or shaking the XaviX Fishing Rod, or turning the XaviX Fishing Reel Handle will not return to game play.

Battery Drainage

If you do not turn the POWER Switch off, the batteries will drain and may completely discharge. So be sure to turn the POWER Switch off after game play to preserve battery power.

You can use both the buttons on the XaviX Fishing Rod and the buttons on the XaviXPORT for Fishing action.

Though the buttons on the XaviX Fishing Rod are named like the buttons on XaviXPORT, they function differently. The following table shows how the functions of the buttons differ.

	XaviX Fishing Reel	XaviXPORT
ENTER	Enters a selection. Displays the fish radar. Displays lure action.	Only enters a selection.
CANCEL	Cancels a selection (menu screen). Switches a selection	Only cancels a selection.

Description of System Cartridge



Description of XaviX Fishing Tackle





Product Description

Positioning the XaviXPORT system and XaviX Fishing Tackle for Bass Fishing / Playing Range

Description of XaviXPORT with Bass Fishing System Cartridge

Top



① **POWER Switch**
Press this to turn the power on and off.

② **RESET Switch**
Press this to reset your XaviX System.

③ **CANCEL Key**
Press this keys to cancel a selection. Follow the on-screen instructions.

④ **Arrow Keys**
Press these keys to move around on screen. Follow the on-screen instructions.

⑤ **ENTER Key**
Press this keys to enter a selection on screen. Follow the on-screen instructions.

⑥ **System Stage**
This is the stage that you place the XaviX System Cartridge on.

⑦ **Power Indicator**
This LED lights (green) when the power is turned on.

⑧ **Infra-Red Receiver**
This Receiver detects the signals transmitted by the Interface.

⑨ **Expansion Jack**
This jack is provided for XaviX products sold in the future.

Front



How to cast overhead



Hold the Fishing Tackle with your left hand firmly by its grip. Bring the Tackle upwards and behind you in a pendulum-like motion keeping your upper arm straight and moving only your forearm using your elbow as a fulcrum.



Swing the Tackle downwards and straight while adding extra force by "snapping" your wrist. During this action, take care to prevent the Tackle from flying out of your hand.



Abruptly stop the Tackle when it reaches the 2 o'clock angle. If you want to stop the lure midway at a specific position, press the ENTER Key on the Fishing Reel.



Check where the lure landed, and start reeling in.

Positioning the XaviXPORT system and XaviX Fishing Tackle for Bass Fishing Playing Distance

Make sure that there are no objects blocking the System Cartridge in the XaviXPORT, or any shiny or reflective metal objects near the XaviXPORT. Bright overhead light or a light source in the area near the XaviXPORT may also interfere with the sensor.

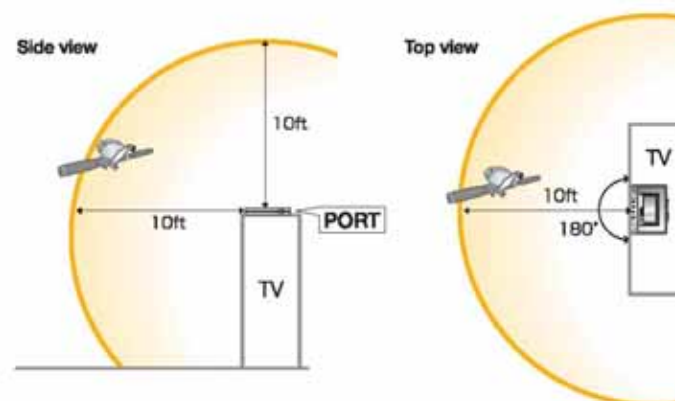

Inserting a System Cartridge in the PORT

To start XaviX Bass FISHING action, you must insert the System Cartridge into the PORT. (The PORT is sold separately.)

Note

Before you insert the System Cartridge in the PORT, make sure that your PORT is turned off.
Place the System Cartridge on the PORT at the correct location and orientation. (The System Cartridge Blade must face the front panel of the PORT.)

Procedure :

- Place the System Cartridge on the System Stage at the top surface of the PORT.
- Press down gently to lower the System Cartridge.
- Slide towards you until the alignment mark on the System Cartridge is in position with the PORT.

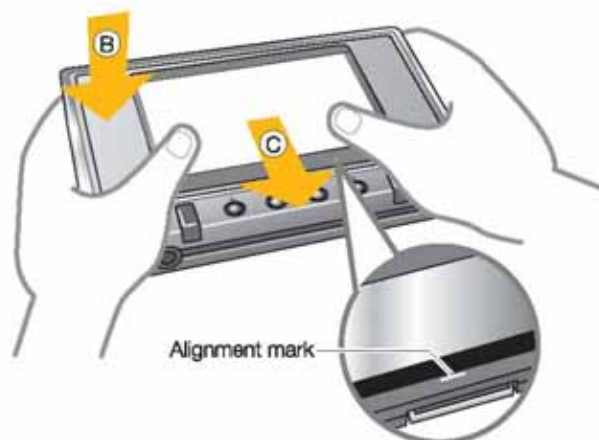

Releasing a System Cartridge from the PORT

Note

Before you release a System Cartridge from the PORT, make sure that the PORT is turned off.

Procedure :

- Press down gently with your fingers on both sides of the System Cartridge and slide the System Cartridge in the direction **D** below.
- Release your fingers. The System Cartridge will raise up automatically from the System Stage on the PORT in direction **E**.

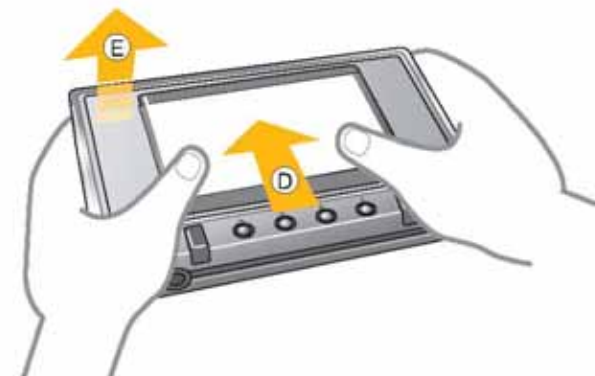

Note

Do not remove the XaviX System Cartridge, disconnect the Power Adapter or turn the XaviXPORT off during Fishing action.
If you do, or if there is a power outage during Fishing action, your score will not be saved to the XaviX System Cartridge.
This can be especially frustrating when you improve your skills and want to preserve record scores.

How to Use Your XaviX Fishing Tackle

■ Holding method

1. Tie the wrist strap attached to the Fishing Rod to your wrist.



2. Adjust the position of the adjuster on the wrist strap to the correct position.



■ How to use your XaviX Fishing Tackle

- When using your fingers to press the buttons on the XaviX Fishing Reel, do not exert too much force or pressure on the buttons.
- Press and release buttons quickly. Holding down the buttons for prolonged periods of time does not produce any different effect.
- Holding down two or more buttons simultaneously, e.g. the ENTER and the SELECT buttons, will not produce any special effect.

■ How to hold the grip of XaviX Fishing Tackle



Hold the XaviX Fishing Tackle with your left hand, and turn the handle with your right hand.

Use Reel and Rod action carefully to land a record-size bass!



How to Cast

XenX Bass FISHING has been designed to eat and feel like the real thing. You can cast any way you like — overhand, from the side or underhand. However, we recommend casting overhand because you can get more wrist action or “snap” in the cast. This is particularly useful if you want to make a long cast. The more wrist action you have, the longer you can cast.

When you are at a fishing point in XenX Bass FISHING, you will see a screen like the one on the right.



First decide where you are going to cast. You can move the casting point by moving the SELECT Key to the left or right. As you do this, the float on the water will move to the left or right.

Try casting. You will see the lure fly away from you into the water. The screen may then look like the one on the right.



Let's take a look at the fan-shaped area at the top of the screen. This is the fish radar. It shows you how many fish there are and where they are located in the water in front of you.

Direction of lure landing point You are here. These indicate fish. Depth gauge

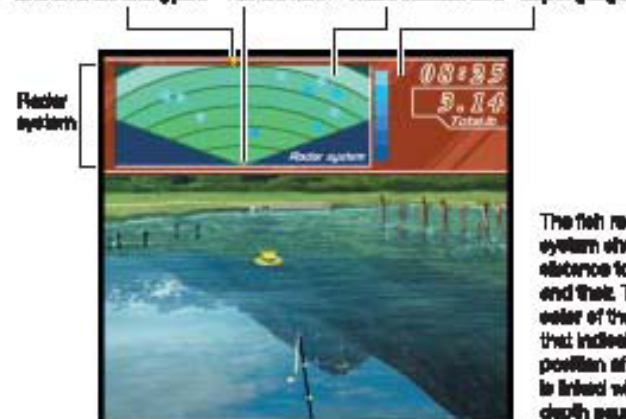

The fish radar system shows the distance to fish and their. The color of the mark that indicates the position of the fish is linked with the depth gauge.

In the fish radar, you are at the narrowest point of the fan shape at the bottom of the radar, and each concentric ring moving away from you is indicated at 10-yard intervals.

At the top of the radar you should be able to see an orange triangle. This is your lure. Try reeling in. You should see this triangle moving in towards you. You can move the lure to the left and right towards the fish by moving the SELECT Key the left or right.

Hint

How to Cast More Accurately

Once you have decided on the cast direction and have swung the XenX Fishing Reels, you can make the lure land more accurately by pressing the ENTER Key just above where you want the lure to fall into the water.

This is just like pressing your thumb against the line as it leaves the reel in real bass fishing.

This way you can cast the lure more accurately to get closer to the fish!





You don't have to go out on a special trip to a famous fishing spot. You can enjoy the thrill of bass fishing in the comfort of your home. With XaviX Bass FISHING, all you have to do is cast and fish in the lakes that spread before you on your TV screen.

