

NQD[®]

WATER SENSE R/C BOAT INSTRUCTION MANUAL

Thank you for choosing our NQD R/C boat. This manual provides instructions on how to operate this model and radio system correctly for enjoyable navigation. Please read through this manual before operation.

WARNING

To be safe and to avoid the propeller from hitting the people around, you can not use it on land, only use it in water, you can control it remotely. In operation, gently adjust the remote control until the rudder and hull form a straight line, To ensure that the ship can be at a glance, can be safe to use.

1. This product is suitable for people over the age of 14, must be under the supervision and guidance of adult use.
2. Ensure that there is no person swimming near the surface, to avoid wounding.
3. The user should observe the water whether there are debris stored in the water, to ensure that ship model water running barrier-free, if too much debris in the water, propeller may be entangled with debris, so the model can not be in the material Of the surface of the operation.
4. Effective remote control distance of about 15 meters, please do not exceed the effective control, or ship model may be out of control.
5. When not in use, please turn off the remote control power, disconnect the ship model power connection.
6. If you find that the rc boat is slowing down, please get it back because the battery is low

CAUTION

There is no protect shield set for the propeller, please carefully do not touch the propeller when you are testing the function.

THE MAIN STRUCTURE OF THE HULL

The battery cover is located on the bottom of the radio controllers. Slide the battery cover as shown in the photos, install two "AA" size batteries into the battery compartment, and replace the battery cover.

Battery Precautions:

1. Do not mix new and old batteries.
2. Use batteries of same brand.
3. Always remove batteries when not in use.
4. Before using your boat, make sure the radio controller is of enough battery power. Low battery power will lead to the loss of control of your boat.

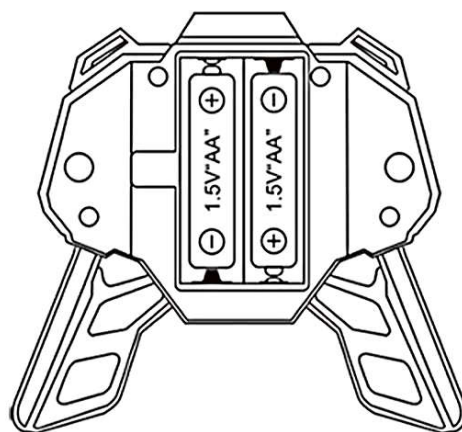
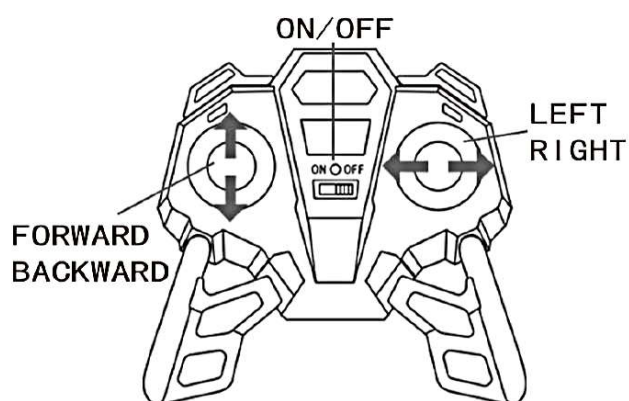

REMOTE CONTROL INSTRUCTIONS

1. Connect the USB Charger to the connector of the Li-ion battery pack. Clip into place.
2. Recharge for up to 4 hours.
3. When the recharging is over, unplug the charger from the electrical outlet, then detach the connectors. Store for safe-keeping

RECHARGING: WARNING!
USE UNDER THE DIRECT SUPERVISION
OF AN ADULT.
* The newly purchased Li-ion pack is
not charged. Charge before operating.

BATTERY CHARACTERISTICS AND RECHARGING TIPS

The battery power may be weak when operating car for the first time or after a long interval without use.

Continue to use and charge the vehicle.

The battery will gradually strengthen after 2 or 3 repetitions of usage and recharging.

Do not charge the battery pack immediately after use!

Wait until battery pack has completely cooled before charging.

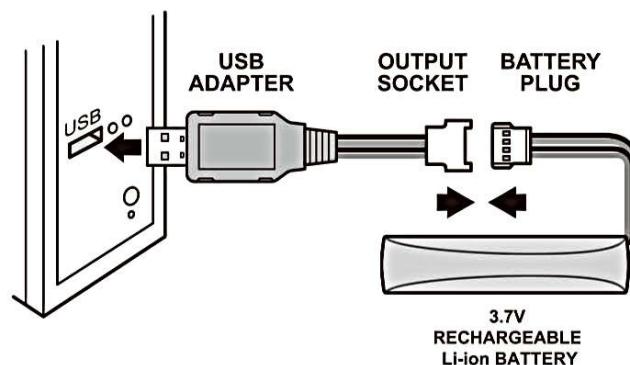

OPERATING INSTRUCTIONS

1. Connect the battery plug and electronic plate.
2. While turn on the switch of the boat, the signal light of the electronic plate flashing , and the steering engine rocker move from side to side, it means the electronic plate is on working.
3. After you turn on the remote controler, please wait until the flashing red signal light stop flash, it means the remote have matched the frequency with the boat.
4. Before you put the boat into water, please check the function of go forward, go backward, turn left and turn right under a safety condition to make sure that the boat is in good situation.
5. After playing, please open the cover of the boat and pour out the water inside.

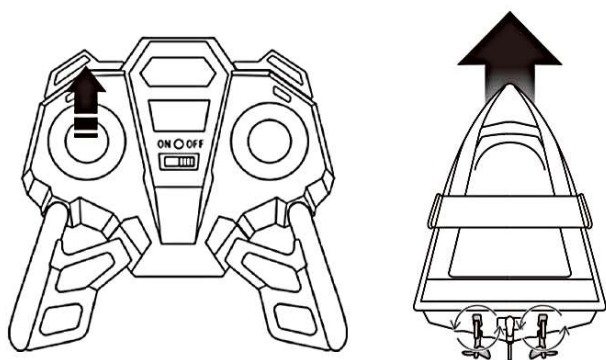

1. Pull throttle trigger inward and the boat will drive forward.

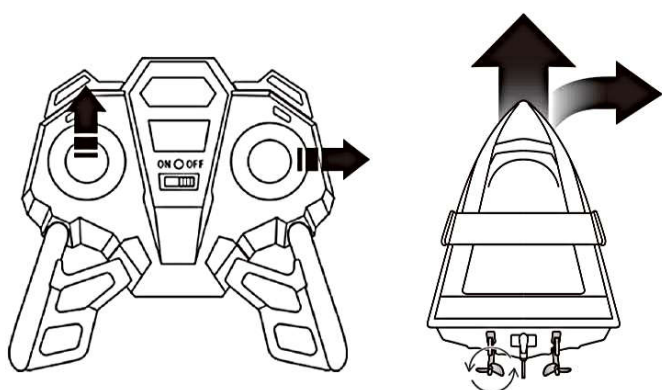

2. Pull throttle trigger inward while turning steering wheel right and boat will go forward, turning to the right.

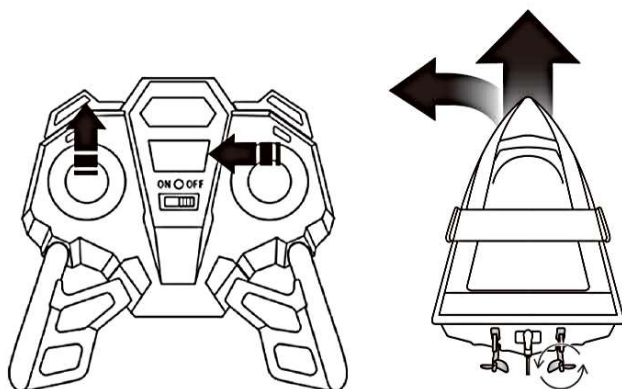

3. Pull throttle trigger inward while turning steering wheel left and boat will go forward, turning to the left.

BATTERY PRECAUTIONS

- Correctly charging battery pack will avoid short circuits. Short circuits will cause overheating, burning of the cords and other damage to the battery pack and charger.
- The Li-ion battery charger should be used for charging one battery pack.
Do not use the charger for charging other types of batteries and battery packs.
- Do not use charger as a direct current outlet for other electrical appliances or machines.
- Make sure that the battery pack and charger are kept out of the hands of infants and small children at all times. Do not charge near fires, locations where the temperature is extremely high. Keep water away from battery pack, especially while charging.
- The battery and charger will slightly heat up while charging. Keep area free of obstacles while charging.
- If the power of the battery pack is weak in spite of proper charging, the batteries may be worn out from repeated use. Replace it with a new Li-ion battery pack.
- Disconnect the A/C Charger before making or breaking connections to the battery.
- Only use recommended battery pack.
- **WARNING! DO NOT ATTEMPT TO RECHARGE NON-RECHARGABLE BATTERIES IN CONTROLLER.**
- Use enclosed battery charger for the rechargeable battery pack only.



A small amount of water into the product does not affect the function, emptying can continue to use.

NOTE: This equipment has been tested and found to comply with the limits for a Class B digital device, pursuant to part 15 of the FCC Rules. These limits are designed to provide reasonable protection against harmful interference in a residential installation. This equipment generates uses and can radiate radio frequency energy and, if not installed and used in accordance with the instructions, may cause harmful interference to radio communications. However, there is no guarantee that interference will not occur in a particular installation. If this equipment does cause harmful interference to radio or television reception, which can be determined by turning the equipment off and on, the user is encouraged to try to correct the interference by one or more of the following measures:

- Reorient or relocate the receiving antenna.
- Increase the separation between the equipment and receiver.
- Connect the equipment into an outlet on a circuit different from that to which the receiver is connected.
- Consult the dealer or an experienced radio/TV technician for help

Changes or modifications not expressly approved by the party responsible for compliance could void the user's authority to operate the equipment.

This device complies with Part 15 of the FCC Rules. Operation is subject to the following two conditions:

- (1) this device may not cause harmful interference, and
- (2) this device must accept any interference received, including interference that may cause undesired operation.