

PLEASE READ ALL INSTRUCTIONS CAREFULLY BEFORE PLAYING AND RETAIN THESE INSTRUCTIONS FOR FUTURE REFERENCE.

RADIO CONTROL FREQUENCY

For interference-free results, do not operate this vehicle with other radio-controlled toys not included in this set within transmission range.

TRANSMITTER AND RECEIVER

Since radio waves control this vehicle and in order to avoid interruption, do not operate this vehicle near electrical or telephone lines, cb interference, cd players, mobile phones, elevators, steel girders, other electronic devices and near highways.

INSTALLING THE BATTERIES

- Remember to set the "ON-OFF" switch at bottom of the vehicle to "OFF" position before inserting the batteries.
- Unscrew and open battery compartment cover to insert batteries in the vehicle as shown in diagram. Make sure all batteries are at the correct polarities.
- Close the cover and tighten the screw.
- To insert battery in the controller, open battery compartment cover to insert battery as shown in diagram.
- Close the cover.
- Do not leave batteries in the vehicle and transmitter when the toy is not in use.
- Do not mix old and new batteries together.
- Do not mix alkaline, standard (carbon-zinc) or rechargeable (nickel-cadmium) batteries.
- Non-rechargeable batteries are not to be recharged.
- Remove exhausted batteries from the toy.
- Supply terminals are not to be short circuited.
- For best performance, alkaline batteries are recommended.
- Do not dispose of batteries in fire, batteries may explode or leak.

OPERATING THE VEHICLE

- For your safety, never play with this toy on the street.
- Turn the "on-off" switch at the bottom of the vehicle to "on" position, then the vehicle will be idle.
- The 27 MHz controller controls the 27MHz vehicle.
- Pull the trigger downward on the transmitter, the vehicle will respond in going forward.
- Release the trigger, the vehicle will stop.
- Push the trigger upward on the transmitter, the vehicle will turn in reverse.

OPERATION TIPS

1. Operate only on smooth (but not slippery), dry and clean surface.
2. Do not play with this toy on grass, sand or carpet.
3. Do not drive the toy through water.
4. Always point the controller antenna upward for better transmission.
5. Do not make any physical contact with the controller antenna while operating.
6. Keep the toy in a dry and cool place after playing.
7. Do not leave in direct sunlight.

CONFORMS TO TOY SAFETY STANDARDS ASTM F963-03

Warning: Changes or modifications to this unit not expressly approved by the party responsible for compliance could void the user's authority to operate the equipment.

NOTE: This equipment has been tested and found to comply with the limits for a Class B digital device, pursuant to Part 15 of the FCC Rules.

These limits are designed to provide reasonable protection against harmful interference in a residential installation. This equipment generates, uses and can radiate radio frequency energy and, if not installed and used in accordance with the instructions, may cause harmful interference to radio communications.

However, there is no guarantee that interference will not occur in a particular installation. If this equipment does cause harmful interference to radio or television reception, which can be determined by turning the equipment off and on, the user is encouraged to try to correct the interference by one or more of the following measures:

- Reorient or relocate the receiving antenna.
- Increase the separation between the equipment and receiver
- Connect the equipment into an outlet on a circuit different from that to which the receiver is connected.
- Consult the dealer or an experienced radio/TV technician for help.

If shielded cables or special accessories are required for compliance, a statement must be included which instructs the user to employ them, for example, Shielded cables must be used with this unit to ensure compliance with the Class FCC limits.

BATTERY INSTRUCTION DIAGRAM

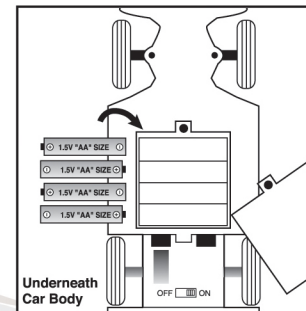

USES 4X 1.5V "AA" SIZE BATTERIES. (NOT INCLUDED)

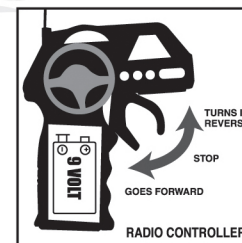

USES 1X 9V SIZE BATTERY.
(NOT INCLUDED)

