

WISETECH® Digital RF Motor 1000 Instruction Manual



WARNING: For Personal safety, READ and UNDERSTAND before using. Save these instructions for future reference.

TABLE OF CONTENTS

Product Specifications 2

Recommended Track Lengths 2

Component List: 3

Motor Assembly: Configurations..... 4

System Installation 5

Setting Remote Control Unit (RCU): 6

Additional Remote Control Features..... 7

Setting Travel Limits on the Drapery Track..... 7

Erasing the Memory Settings From the Motor 7

Remote Control Settings for Dual Motor Configuration.... 8

Speed Settings..... 8

Remote Control Channel Lock..... 8

Legal Statements..... 9

Legal Statements

1) Statements as required by FCC15.19 and RSS-Gen:

- This device complies with Part 15 of the FCC Rules. Operation is subject to the following two conditions:
- This device may not cause harmful interference, and this device must accept any interference received, including interference that may cause undesired operation.

2) User information as specified in 15.21:

- Changes or modifications not expressly approved by the party responsible for compliance could void the user's authority to operate the equipment.

3) User information as specified in 15.105:

- NOTE: This equipment has been tested and found to comply with the limits for a Class B digital device, pursuant to Part 15 of the FCC Rules. These limits are designed to provide reasonable protection against harmful interference in a residential installation. This equipment generates, uses and can radiate radio frequency energy and, if not installed and used in accordance with the instructions, may cause harmful interference to radio communications. However, there is no guarantee that interference will not occur in a particular installation. If this equipment does cause harmful interference to radio or television reception, which can be determined by turning the equipment off and on, the user is encouraged to try to correct the interference by one or more of the following measures:
 - Reorient or relocate the receiving antenna.
 - Increase the separation between the equipment and receiver.
 - Connect the equipment into an outlet on a circuit different from that to which the receiver is connected.
 - Consult the dealer or an experienced radio/TV technician for help.

Congratulations on your purchase of the Wisetech Digital RF Motor 1000 System. Please read all the instructions before you start installing and operating the system.

Product Specifications

Input Voltage to Motor	DC12-16V
Input Voltage to Transformer	AC110V
Traversing Speed	4 in to 14 in/sec (10.2 cm to 35.6 cm/sec)
Maximum Drapery Weight	110 lbs (50 kg)
Amperage	0.8A-1.8A
Thermal Protection	176°F ± 33.8°F (80°C ± 1.0 °C)

Recommended Track Lengths

	Minimum	Maximum
Single Track Model	5 in (12.7 cm)	12 ft (365.8 cm)
Double Track Model	8 in (20.3 cm)	24 ft (731.5 cm)
Triple Track Model	12 in (30.5 cm)	34 ft (1036.3 cm)

Component List:

1. RF Motor
2. Start head
3. Carrier
4. Track
5. Master Carriage Set
6. End Head

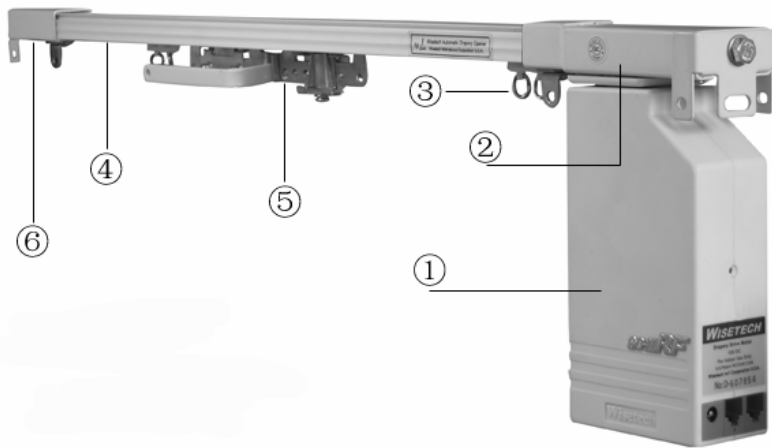

Remote Control Settings for Dual Motor Configuration

You can set your system to use two motors. The recommended configuration is to set the main motor to the odd channels (1, 3, 5) and the second motor to use even channels (2, 4, 6).

Speed Settings

The motor has six speeds 1-6, with 6 being the fastest. You can change motor speeds while the motor is running. To increase speed, push the "channel" and "open" buttons at the same time. To decrease speed, press the "channel" and "close" button at the same time.

Remote Control Channel Lock

- Select the channel to be locked on the remote control.
- Push and hold the channel button for about 7 seconds.
 - The corresponding channel green light will flash to indicate the channel is locked.
 - If you are using the dual motor mode, the second motor will be locked on the next channel.
- To select a channel to be locked on the remote control for either main motor or second motor,
 - Repeat the channel locking steps.
 - The previous channel lights will stop flashing.
 - Repeat these steps to on a locked channel if you want to unlock that channel.

Additional Remote Control Features

- The motor can accept up to 20 different channels. You can set multiple remote control channels for the same motor.
- They motor has a memory protection system that prevents the loss of settings in the event of a power failure.
- The motor will also retain the channel settings until the user manually erases them

Setting Travel Limits on the Drapery Track

- You can set travel limits of the motor to allows quieter operation.
- These settings will automatically stop the motor before it reaches the end of the rod.
- The motor will retain these settings until the user resets or erases them.
- To set the limit:
 - Press the "open" button on the remote control
 - Listen for a series of short beeps
 - The motor will start
 - The master carriage will move to the end of the rod, stop and make a beeping sound to indicate the one side is set.
 - The motor will then move to the other end of the rod, stop, and make a beeping sound to indicate it has set the limit on the other end.
 - During the limit setting process (series of beeping sounds), you can push the stop button to set additional limit positions.
 - Note: You may need to ensure that the drapery cord or wire is properly tightened before setting the motor limits.

Erasing the Memory Settings From the Motor

- Press and hold the motor's programming button with a small narrow object (such as a paper clip or a pin), for about 8 seconds.
- The motor will make a prolonged beeping sound.
- This process will erase the motor memory including all channel and limit settings.

Motor Assembly: Configurations

***Picture of Single Track with one Motor**

Configuration	Application
Single Track, Single Motor	Drapery length up to 12 ft (365.8 cm) and drapery weight up to 110 lbs (50 kg).
Double Track, Double Motor	Sheer and Drapery Set up; either sheer or drapery length up to 12 ft (365.8 cm) weight up to 110 lbs (50 kg)
Single Track, Double Motor	Drapery length up to 24 ft (731.5 cm) or drapery weight up to 220 lbs (100 kg)
Double Track, Triple Motor	Sheer and Drapery Set up, Drape weight up to 200 lbs (90.7 kg) or length up to 24 ft. (731.5 cm).

System Installation

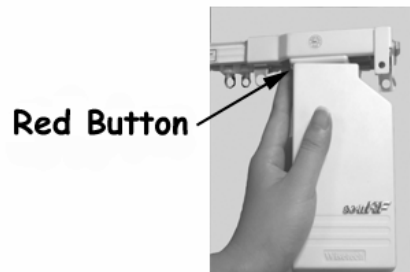

To Install motor onto an assembled track

1. Tilt the motor at a 45 degree angle,
2. Press down on the red button on the start head.
3. Turn the motor until it locks into place.

To Remove the Motor From the Track.

1. Press down on the red button on the start head
2. Turn the motor 45 degrees
3. Detach the motor from the start head.

Connecting the Power to the Motor

1. Plug the transformer connector into the motor
2. Plug the transformer AC plug into an AC outlet.
(**Important:** You must plug the transformer connector into the motor BEFORE plugging the transformer AC plug to an AC outlet)
3. The motor will make a few beeping sounds when properly connected to the AC power.

Setting Remote Control Unit (RCU):

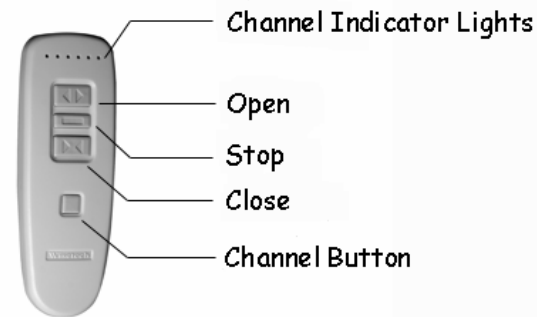

■ Six Channel Remote Control Unit

The top of the RCU has six channel indicator lights positions at the top. Pressing the channel button on the RCU will step the lights through each position.

1. Select the channel on the RCU by pressing the channel button until the indicator light goes to the position you want.
2. Match the channel of the motor to the channel of RCU by
 - a. Pressing the programming button on the motor with a small narrow object (such as a paper clip or a pin).
 - b. The motor will make several short beeps
3. During the short beeps, press any of the "Open", "Stop", or "Close" button on the remote control unit.
4. The motor will make a continuous tone. This tone indicates that the remote control channel is properly set to the motor.