

Ages 4+
Item no.01001



Super Cycling Sarah and Sam Instructions

Out of the Box:

Remove Super Cycling Sarah and Sam from the box, carefully collecting all small pieces to be disposed of properly.

Package Contents:

- Super Cycling Sarah
- Sam the dog
- Bicycle
- Cart
- Remote control
- Helmet
- Hair brush

Read instructions before use, and keep for future reference.

HOW TO INSTALL BATTERIES:

Caution! Always have an adult perform the battery installation.

1) The battery compartment is located in Sam's cart. Flip the cart over to access the battery compartment. Using a Philips-head screwdriver, unscrew the battery compartment cover and insert 4 (C) batteries. Replace the cover and tighten the screw.

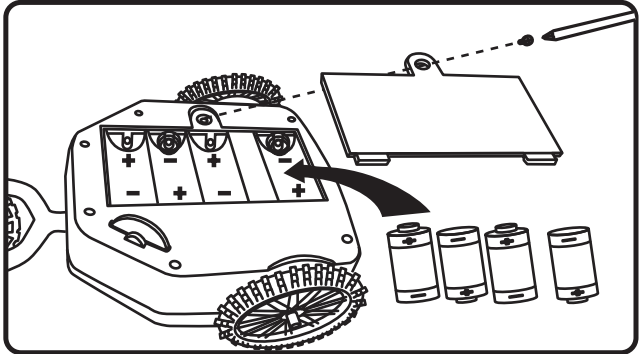

2) Next, slide off the battery panel on the remote control. Insert one 9-Volt and replace the cover on the remote unit.

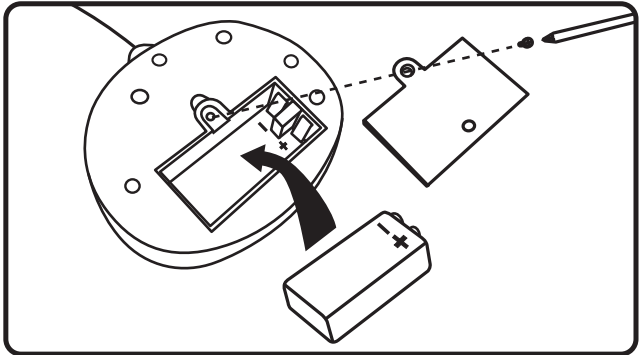

DIFFERENT WAYS TO PLAY:

Sarah and Sam can play in many different ways. Sarah and Sam are always ready for fun, and using Sarah's bike and Sam's cart, they can go anywhere!

Bike Play:

Sarah loves to ride her bike but before leaving on a bike ride please make sure she is securely attached to the bike:

1) Put on her protective helmet by sliding on the chin strap!

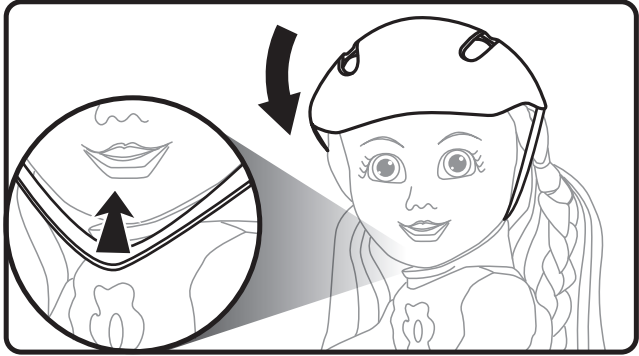

2) Secure her feet using the pegs located on each pedal.

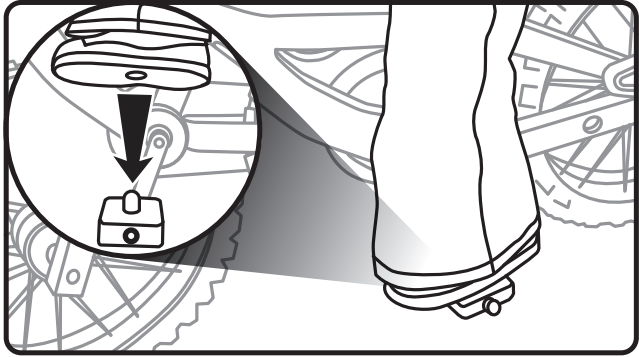

3) Secure her hands on the handlebars.

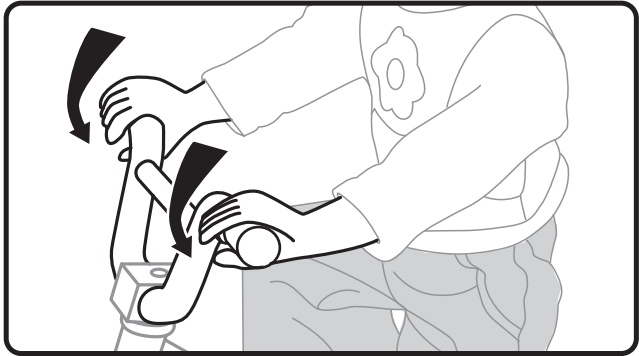

Now Sarah is attached to the bike you can push her around on your own or attached to the cart and use in R/C mode.

R/C Mode:

Sarah and Sam can go on their own adventures with your help navigating using the easy to drive remote control.

1. Get Sarah to ride her bike (see "Bike Play").

2. Prepare Sam's cart by attaching the cart hitch to the bike. Make sure to click the hitch into place on the nubs on the back axle of the bike.

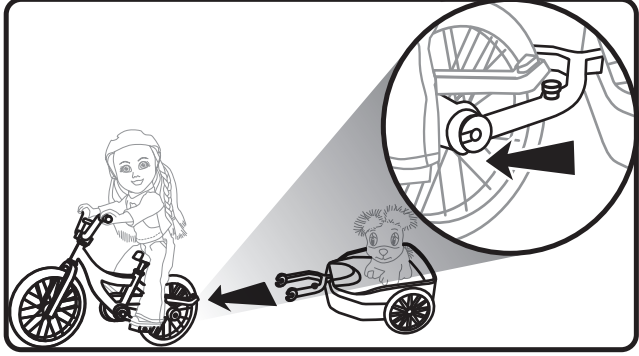

3. Attach Sam to the cart by pressing firmly so he will attach to the Velcro on the cart, and flip the power switch located on the back of the cart to 'On' and you're ready to ride.

Radio Controlled Handset:

To move forward, push the lever on the remote control forward. To move backward and turn left, move the lever on the remote control backward.

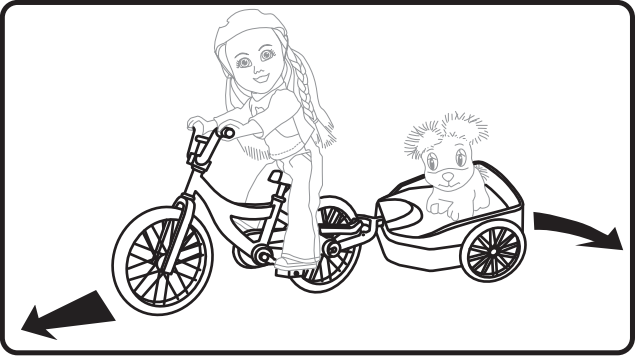
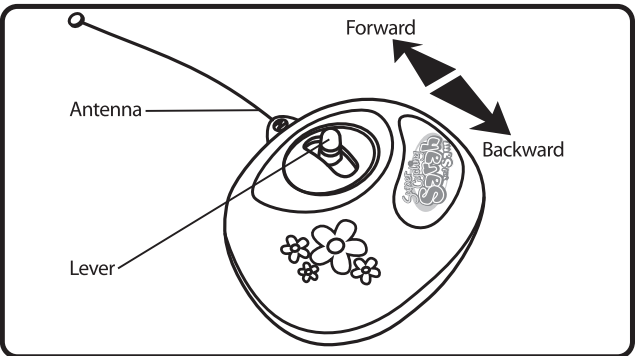

Wheelie Mode:

Sarah loves doing wheelies on her bike! To change into wheelie mode, pop up the front wheel and place the small lever into the hole on the back of the bike (see inset).

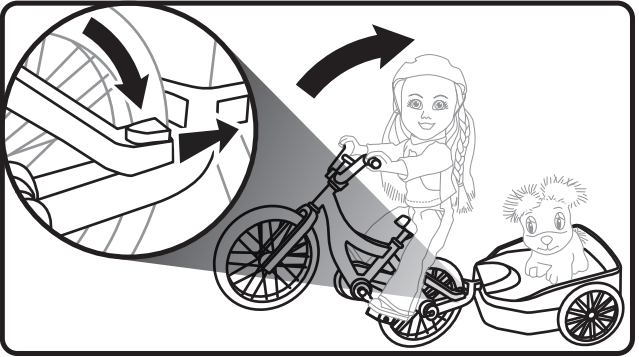

Now you can watch Sarah in wheelie mode with Sam enjoying in the fun!

Doll Play:

Take Sarah and Sam with you wherever you go! Use Sarah's brush to style her hair, and show everyone your new friend.

FCC STATEMENTS

This device complies with Part 15 of the FCC Rules. Operation is subject to the following two conditions: (1) this device may not cause harmful interference, and (2) this device must accept any interference received, including interference that may cause undesired operation.

This device generates and uses radio frequency energy and if not used properly may cause interference to radio and television reception. It has been tested and found to comply with the limits set by the FCC which are designed to provide reasonable protection against such interference.

Meets requirements of European Council Directives - 99/5/EC, 89/336/EEC, 88/378/EEC. Suitable for use in all EU member states.

IMPORTANT BATTERY INFORMATION:

CAUTION: As with all small batteries, the batteries used with this toy should be kept away from small children who still put things in their mouths. If they are swallowed, promptly see a doctor and have the doctor phone the poison control center. Make sure that batteries are inserted correctly and follow the toy and battery manufacturer's instructions.

- Super Cycling Sarah and Sam use 4 (C) batteries (Sam's cart) and 1 9-Volt battery (handset).
- Do not mix old and new batteries. When replacing, replace all batteries.
- Do not dispose of used batteries in a fire. This could cause the batteries to explode.
- Battery installation should be done by an adult.
- Non-rechargeable batteries are not to be recharged.
- Rechargeable batteries are to be removed from the toy before being charged (if removable).
- Rechargeable batteries are only to be charged under adult supervision (if removable).
- Only batteries of the same or equivalent type as recommended are to be used.
- Batteries are to be inserted with the correct polarity.
- Exhausted batteries are to be removed from the toy.
- The supply terminals are not to be short-circuited.
- Replace with new batteries at the first sign of erratic operation.

INFORMATION TO USER

CAUTION: changes or modifications not expressly approved by the party responsible for compliance could void the user's authority to operate the equipment.

NOTE: This equipment has been tested and found to comply with the limits for a Class B digital device, pursuant to Part 15 of the FCC Rules. These limits are designed to provide reasonable protection against harmful interference in a residential installation. This equipment generates, uses and can radiate radio frequency energy and, if not installed and used in accordance with the instructions, may cause harmful interference to radio communications. However, there is no guarantee that interference will not occur in a particular installation. If this equipment does cause harmful interference to radio or television reception, which can be determined by turning the equipment off and on, the user is encouraged to try to correct the interference by one or more of the following measures:

- Reorient or relocate the receiving antenna.
- Increase the separation between the equipment and receiver.
- Connect the equipment into an outlet on a circuit different from that to which the receiver is connected.
- Consult the dealer or experienced radio/TV technician for help.



©2006 ZIZZLE
Zizzle, L.L.C.
1500 South Lakeside Drive
Bannockburn, IL 60015
U.S.A.

MADE IN CHINA All Rights Reserved

Meets or exceeds all safety requirements of ASTM F963.



Printed in China