

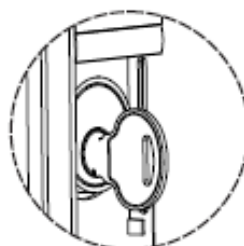

F21-PMR3-0Sx-1 Quick Start Guide

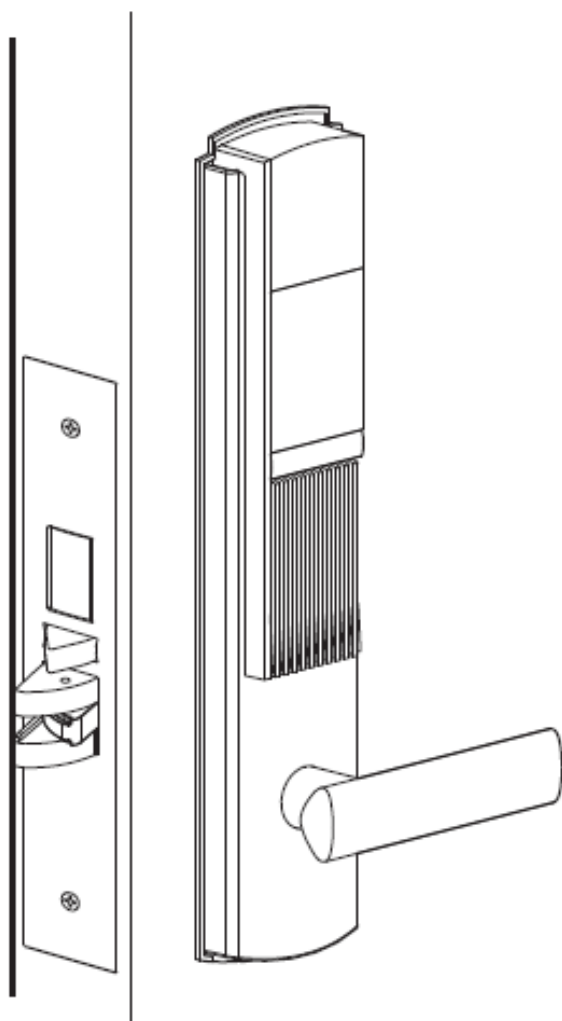

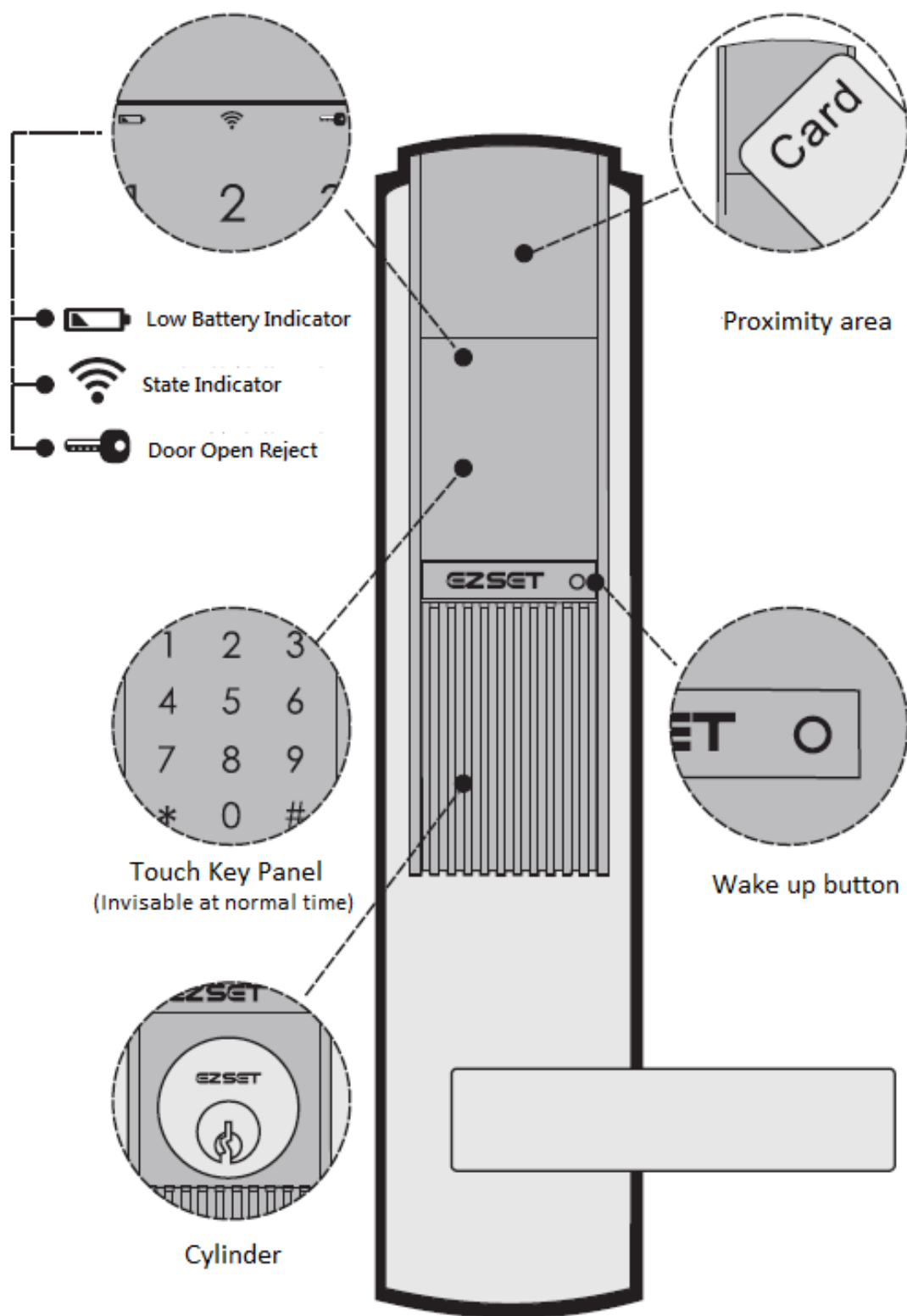

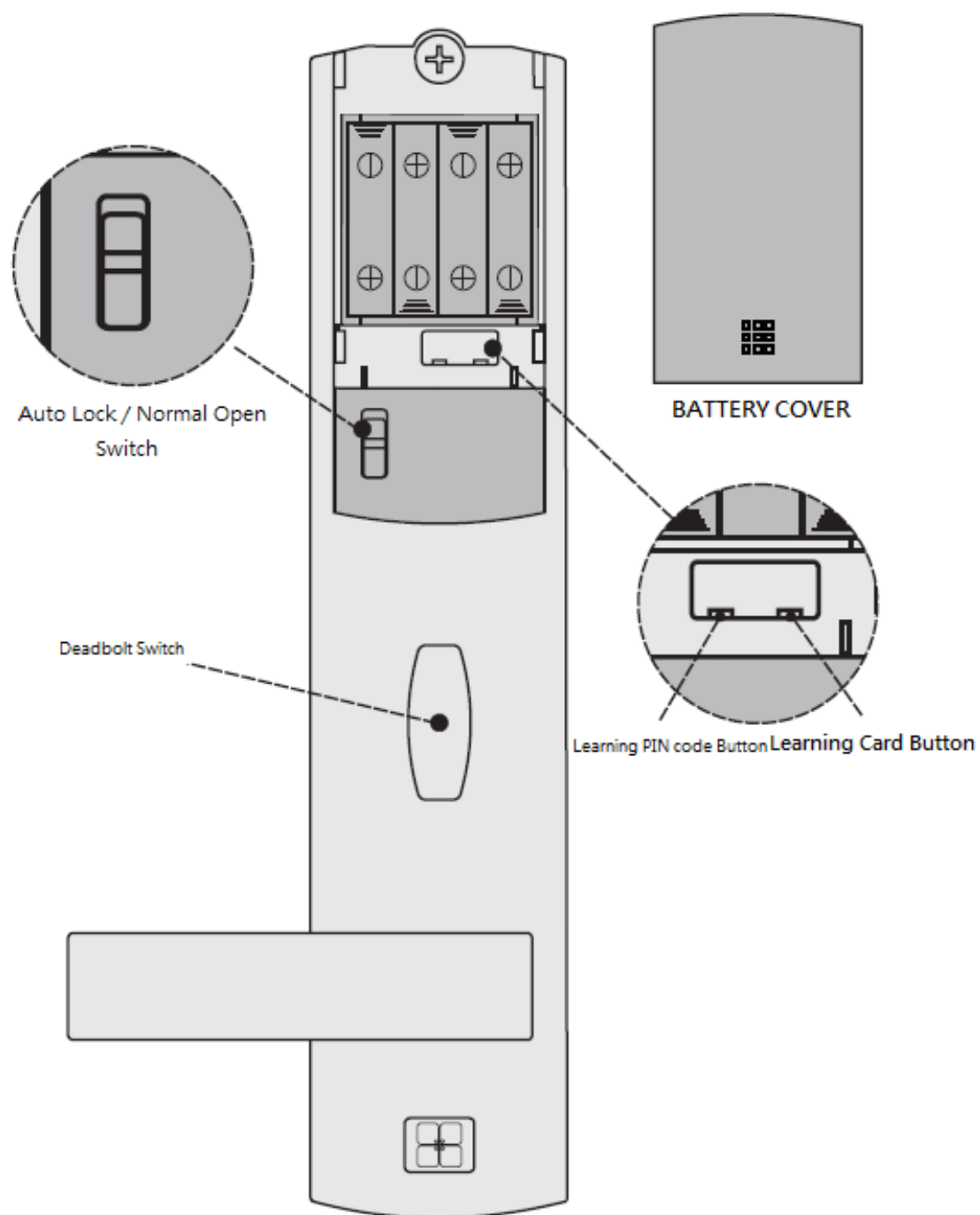

Configure Settings.

Initial Settings: Please perform "CLEAR ALL SETTINGS" step to make sure all cards add by you. (Please ref CLEAR ALL SETTINGS step)

A. Register User Card:

1. Press "Learning Card Button" (Right side BLACK button)
2. Into "Register User Card Mode" (you will get Beep sound)
3. Press four (4) digits display on Touch PIN panel. (The sequence of 4 digits is not problem)
4. Take User Card near the proximity area. (you will get a Beep sound)
5. Repeat step 2 & 3.
6. Register User Card Complete.

[Note]

- a. Each Register User Card step can only register one User Card at the time.
- b. Max User Card is thirty two (32) Cards.
- c. Register User Card Mode quit: Press "Learning Card Button" again.
- d. Register User Card fail: you will get Beep.. Beep.. (two short beep sounds)
- e. When registering User Card code, the code must be entered within 10 seconds. If time expires, no code is registered and the process must be re-start for Registering User Card code.
- f.

B. Register PIN code:

1. To register PIN code you need to have Registered User Card first.
2. Press "Learning PIN code Button" (Left side BROWN button)
3. Into "Learning PIN code mode". The touch key panel will automatically activate.
4. Enter your PIN code (four to eight digits), followed by the # key to complete PIN code input. (Sounds a beep for each PIN code digit)
5. Take your User Card which was you registered and near ear the proximity area (you will get a Beep sound).
6. Repeat Step 4 and 5.
7. PIN code Register complete.

[Note]

- a. Press Star (*) key for clear entered digits.
- b. Press Pound (#) key for Enter or accept PIN code.
- c. if you entered PIN code for two times does not match, notify

sounds is long beep for two time

- d. When registering User PIN code, the code must be entered within 10 seconds. If time expires, no code is registered and the process must be re-start for Registering User PIN code.
- e. Quit "Learning PIN code mode": Press "Learning PIN code Button" again.
- f. Max User PIN codes are thirty two (32) set of PIN codes.
- g. One User Card can only assign one set of PIN code available.

C. CLEAR ALL SETTINGS:

- 1. Hold on "Learning Card Button"(BLACK button) for ten(10) seconds. (There are five beep sounds for every two seconds) and last beep sound is ten short beep sounds.
- 2. [Note]
 - i. After initial set-up, individual User Card & PIN codes will be deleting.
 - ii. Unregister User Card: Unregister single User Card is no support.
 - iii. Unregister User PIN code: Unregister single User PIN code is no support.
 - iv. Clear all settings might need at least ten (10) seconds.
 - v. After clean all User Cards, the door lock state is always at normal open mode until register new User Card.

D. Change PIN code: please ref Register PIN code steps.

E. Wrong Code Entry Limit: After a default of three (3) unsuccessful attempts at entering a valid PIN code will lock Touch key panel and not allow operation within three (3) minutes.

F. Touch key panel unlock: Use a valid User Card to proximity area; the Touch key panel will automatically unlock.

G. Unlock:

- 1. By User Card: take valid User Card near the proximity area.
- 2. By User PIN code: press four digits on Touch key panel then enter your User PIN code to operating Door Lock.

H. Lock:

- 1. Press "Wake up button" for lock.(outside of door)

I. Lock mode switching: there is a switch you can switch between "Normal Open Mode" and "Auto Lock mode".

J. Activate Security Mode: take your valid User Card and near the proximity area for five seconds.

- 1. Cuckoo sounds are for in progress of security mode.
- 2. One long beep sound (1.5sec) is for complete into security mode.

K. De-Active Security Mode: ref Unlock function.

L. Emergency Power Supply

1. 9V battery connections are lock under the front of the outside lock.
(bottom of outside lock) In the case that the four (4) AAA alkaline batteries are completely discharge; a 9V battery can be used to supply power for temporary operating lock. While connecting the 9V battery, the lock can be operated as normal, thus granting access so the four (4) AAA alkaline batteries can be replace.
2. Discharged batteries should be replaced right away.

M. Battery Replacement

1. Alkaline battery type is LR03 only can use on this product.
2. Low battery indicator flushing: Replace all four batteries with new AAA Alkaline (LR03) is necessary.
Do not mix new & old alkaline battery; it might damage product.

N. F21-PMR3-0Sx-1Model List

1. F21-PMR3-0Sx-1: Standalone (RFID, PIN, Metal Key)
2. Security Integrate Feature(RS-485 interface)
3. Security Integrate Feature(I/O Interface)
4. Security Integrate Feature(Wireless slave interface and Host with RS-485 interface)
5. Security Integrate Feature(Wireless slave interface and Host with I/O interface)
6. Real Time User Card management for Hotel (485 network)

Federal Communication Commission interference

Statement :

This equipment has been tested and found to comply with the limits for a Class B digital device, pursuant to part 15 of the FCC rules. These limits are designed to provide reasonable protection against harmful interference in a residential installation. This equipment generates, uses and can radiate radio frequency energy and, if not installed and used in accordance with the instructions, may cause harmful interference to radio communications. However, there is no guarantee that interference will not occur in a particular installation. If this equipment does cause harmful interference to radio or television reception, which can be determined by turning the equipment off and on, the user is encouraged to try to correct the interference by one or more of the following measures:

- Reorient or relocate the receiving antenna.
- Increase the separation between the equipment and receiver.
- Connect the equipment into an outlet on a circuit different from that to which the receiver is connected.
- Consult the dealer or an experienced radio/TV technician for help.

FCC Caution

This device complies with Part 15 of the FCC Rules. Operation is subject to the following two conditions:

- (1) this device may not cause harmful interference and
- (2) this device must accept any interference received, including interference that may cause undesired operation

RF exposure warning: The equipment complies with RF exposure limits set forth for an uncontrolled environment. The antenna(s) used for this transmitter must not be co-located or operating in conjunction with any other antenna or transmitter.

You are cautioned that changes or modifications not expressly approved by the party responsible for compliance could void your authority to operate the equipment.