



MeetingBar A50



Quick Start Guide V1.0

1 Package Contents



MeetingBar A50

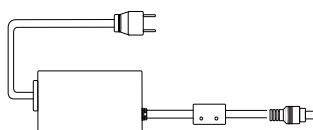

(3.5 m, 11.48 ft)
Power Adapter
(48V)

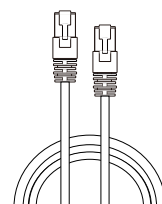

(3 m, 9.84 ft)
CAT5e UTP
(RJ45 - RJ45) Cable

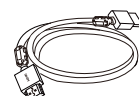

× 2
(1.8 m, 5.91 ft)
HDMI 2.0 Cable

Optional Packages

A



VCR11 and
AAA Battery × 2

B



CTP25 Package

NOTE

We recommend that you use the accessories provided or approved by Yealink. The use of unapproved third-party accessories may result in reduced performance.

2 Basic Connection

- Display requirement: A resolution of 1080p or higher, and a port that supports HDMI 1.4 or higher.
- If you only need to use one display, please connect to HDMI 1 port.



MeetingBar A50

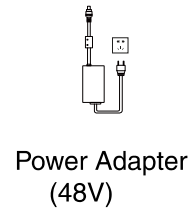
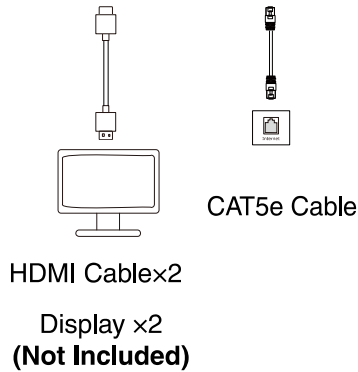

3 Connect CTP25 with A50 (Optional)

Option 1: Direct Connection with an Ethernet Cable

- Use a network cable to connect the CTP25 to the A50.
- This deployment method supports content sharing and BYOD. Refer to the **Content Sharing** and **BYOD** section.

MeetingBar A50

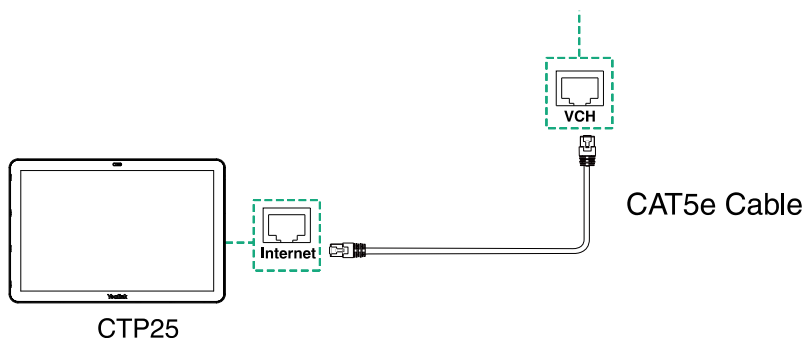
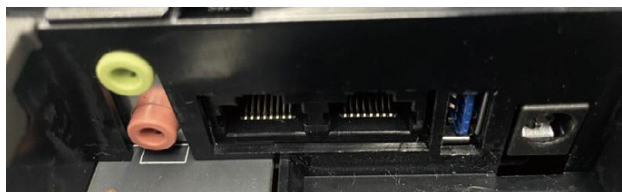

Option 2: Connection on the Same LAN

- A50 and CTP25 need to be on the same LAN.
- This deployment method supports content sharing and BYOD. Refer to the **Content Sharing** and **BYOD** section.

On the same
LAN



MeetingBar A50

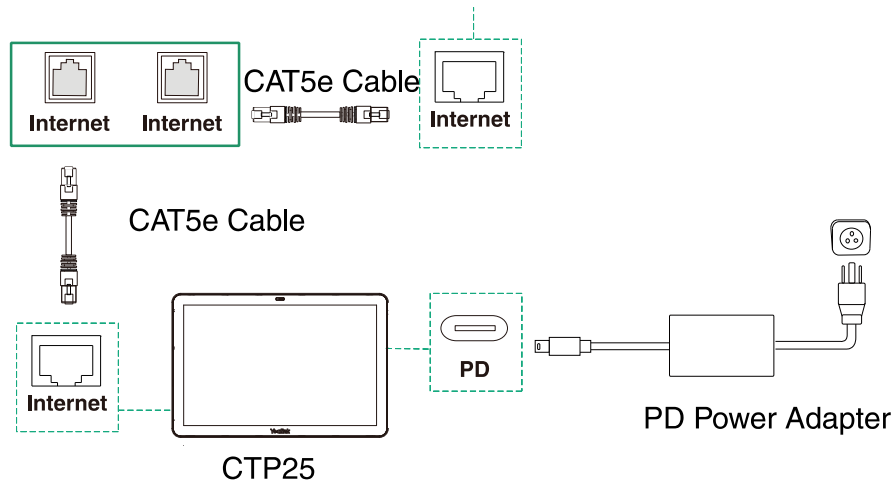

4 Installation

Option 1: Mount on a wall

Step 1: Determine A50 position

The mounting height affects your camera view. The recommended installation height is 110 cm above the ground, and the reserved distance between A50 and TV should be greater than 1 cm.

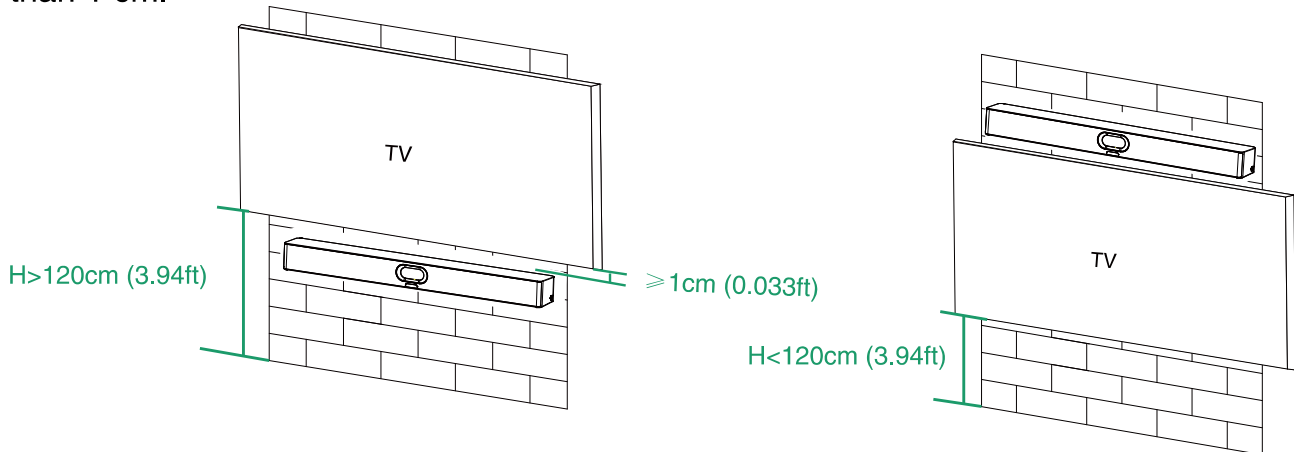

Step 2: Mount the A50 to the wall

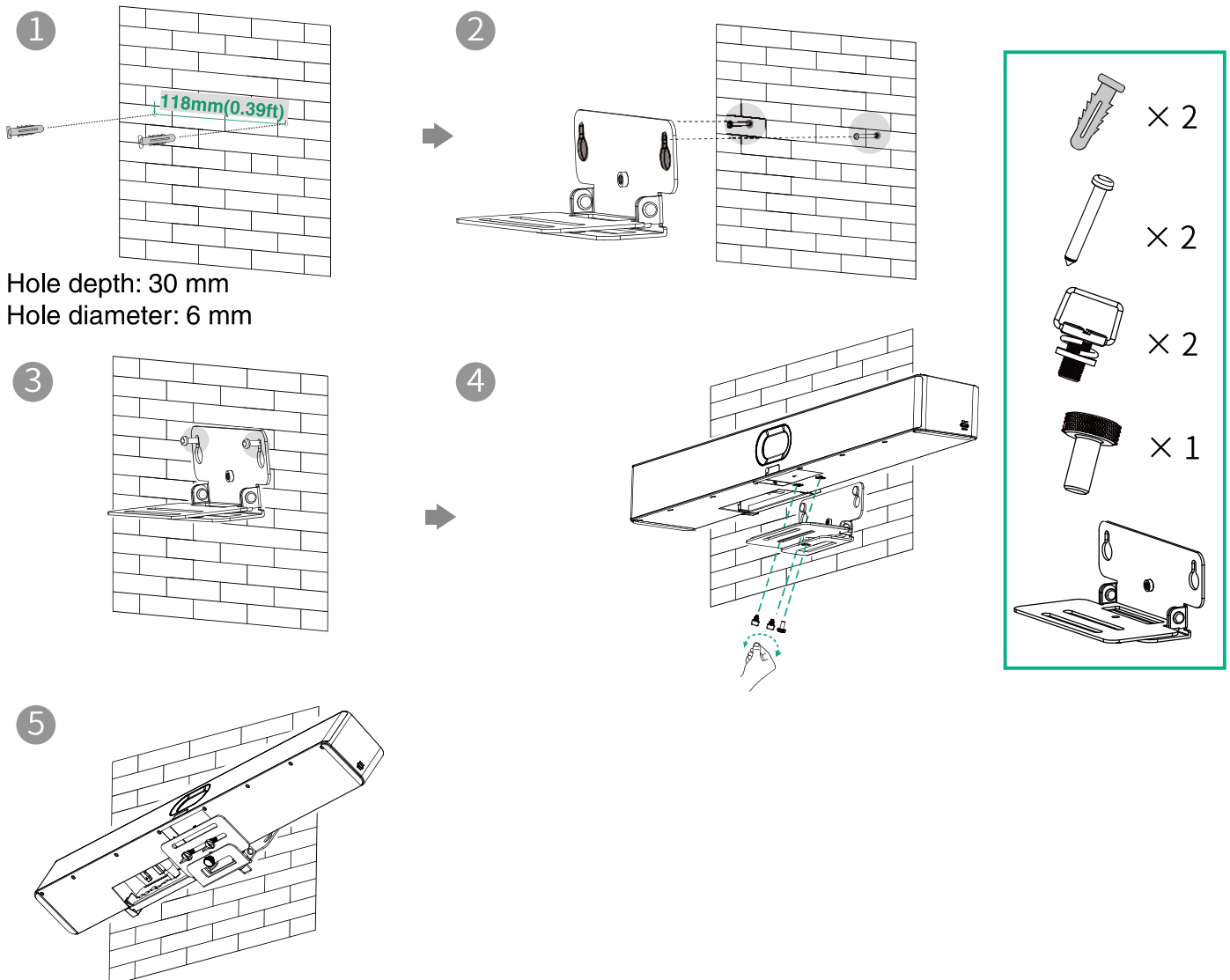

Option 2: Put on a flat surface

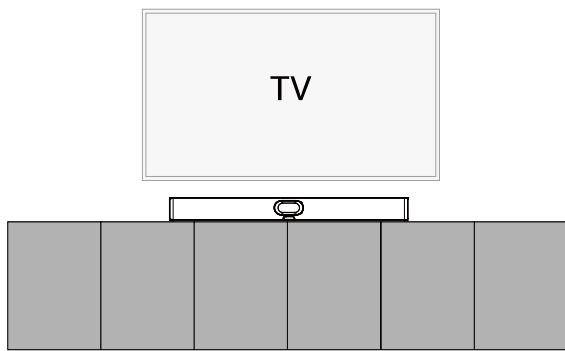

On the desk

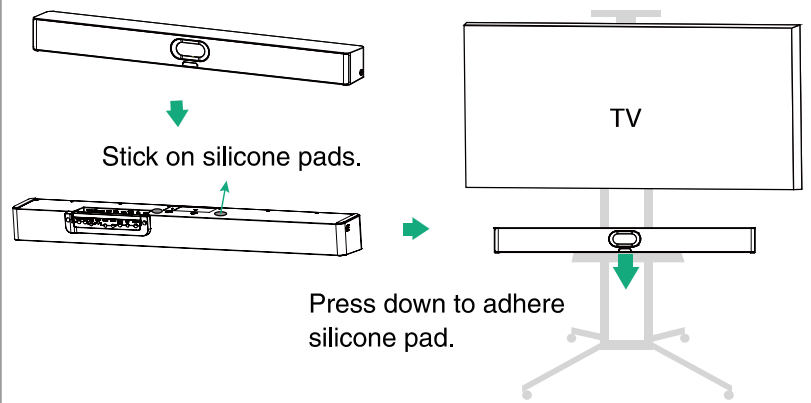

On the TV stand cart platform
(purchase separately)

5 Adjust the Camera Tilt

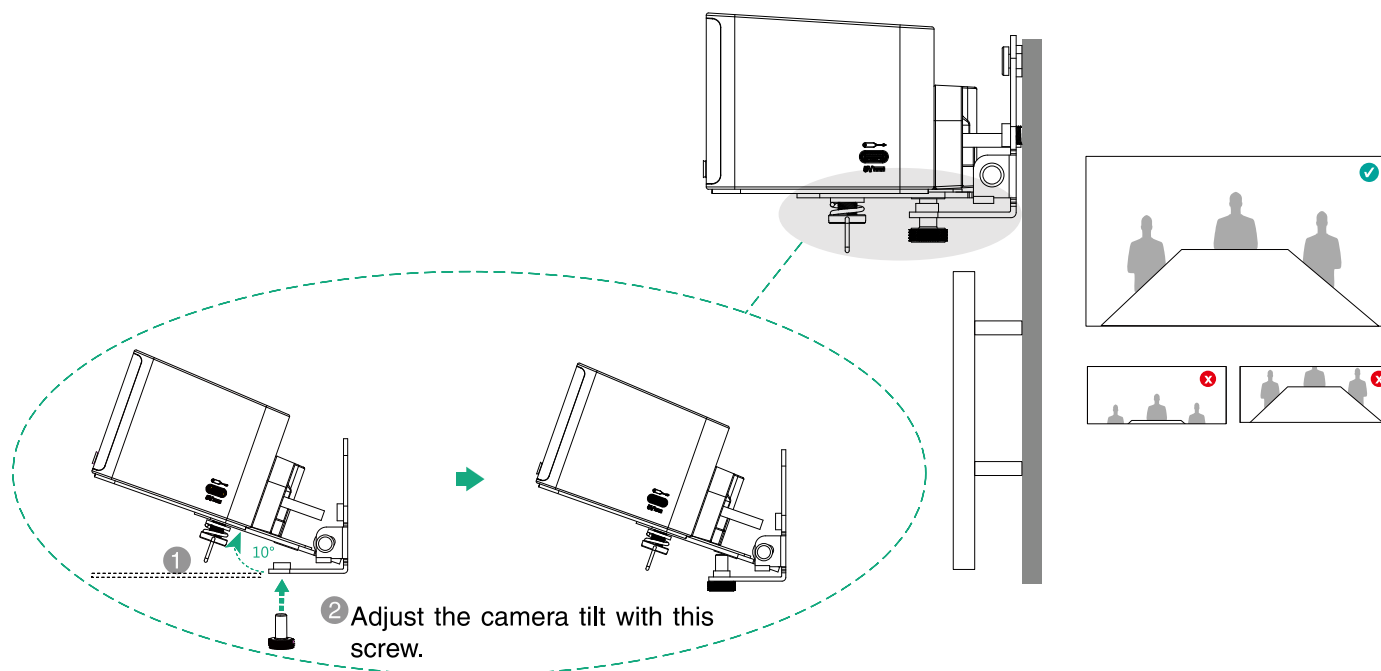

6 VCR11 (Optional)

i You can use the remote control (not applicable to Zoom version) or CTP25 to operate the A50. If a touch display device is connected, you can also operate the A50 directly on the touch screen .

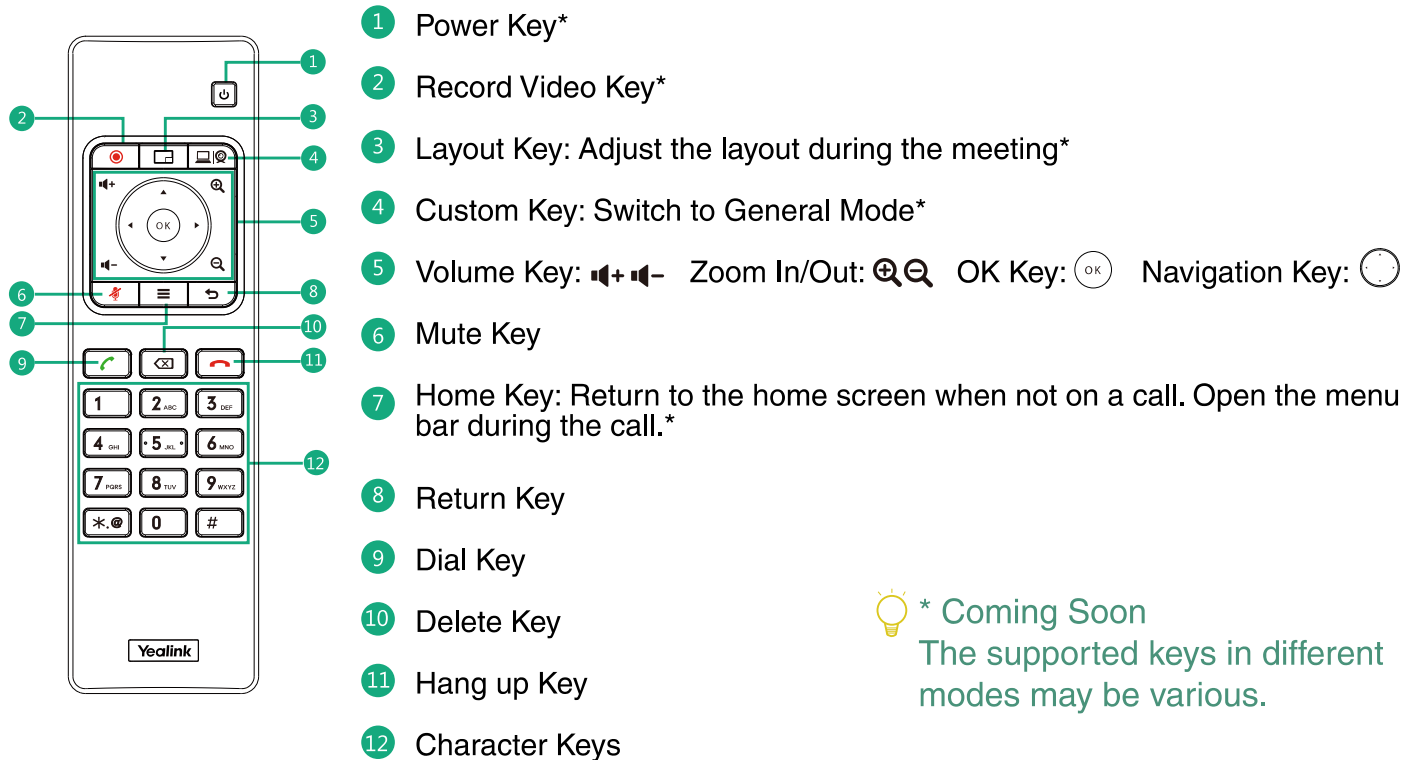

7 Pair with the CTP25 (Optional)

i For a better pairing experience, we recommend starting the A50 first and then the CTP25.

Pair manually

i If you purchased a bundle kit or connected CTP25 to A50 via a network cable, A50 and CTP25 would be paired automatically. You can go to **Initialization** directly.

On the CTP25, enter the IP address and pairing code of the A50 on display.

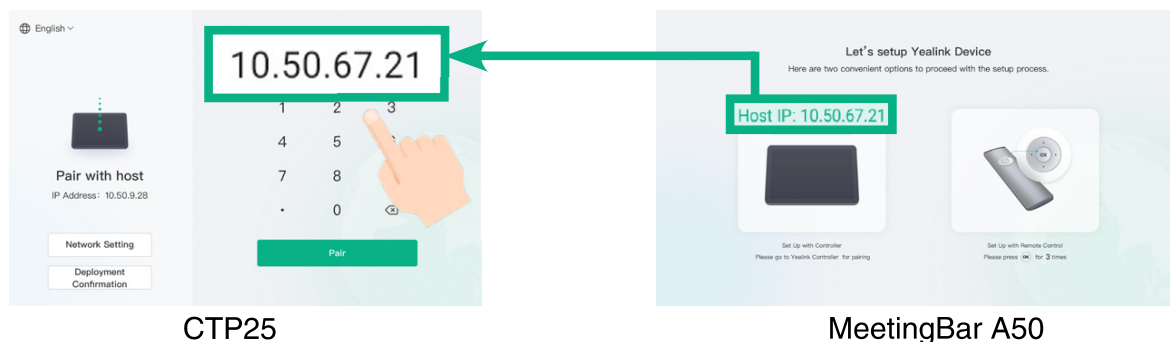

Initialization

1. If the CTP25 is restored to factory settings, you need to change the default password (0000) of the CTP25.
2. Initialize **Language**, **Network**, **Time Zone** and **Auto Update**, and select the desired platform. If you select **General Mode**, refer to the **9 General Mode** section.
3. Change the default password (0000) of the A50.

Account login

i Contact the corresponding service provider to obtain an account.

Teams: The Teams login process is different in different deployment modes of CTP25. Refer to the **3 Connect CTP25 with A50** section for CTP25 deployment.

- **Direct Connection with an Ethernet Cable:** Sign in to the Teams account on the CTP25.
- **Connection on the Same LAN:**
 1. Sign in to the same Teams account on CTP25 and A50.
 2. Select the desired endpoint on the CTP25.
 3. Enter the pairing code displayed on the endpoint on CTP25 and complete the pairing.

Method 1: Sign in on the website

Find a networked computer and operate it according to the prompts of CTP25 and A50.

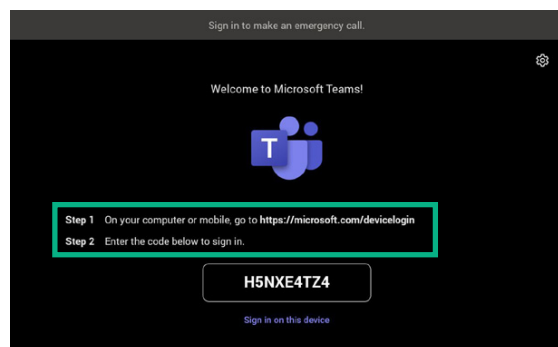

Method 2: Sign in on the device

💡 Use the remote control to operate it if your display does not support touch.

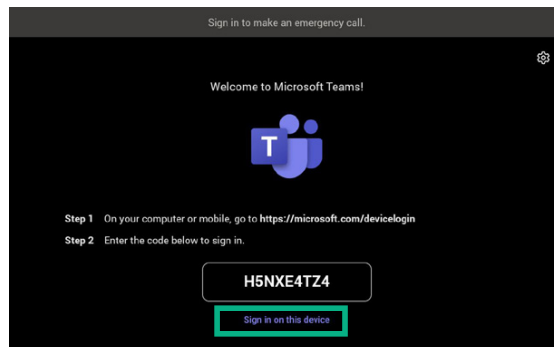

Zoom: Follow the prompts on CTP25 to sign in to the account.

8 General Mode

1. Do one of the following to select **General Mode**:

- When selecting a platform during power-on initialization, select **General Mode**.
- After logging in, you need to reset to factory before switching platforms:

Teams: Go to **More > Settings > Device Settings > System**, enter the admin password (default: 0000), and select **Reset to factory**.

Zoom: Go to **Settings > General > System Settings > System**, enter the admin password (default: 0000), and select **Reset to factory**.

2. Refer to the **10 Content Sharing and BYOD** section to share content or use the BYOD function.

9 Content Sharing and BYOD (Optional)

Content Sharing

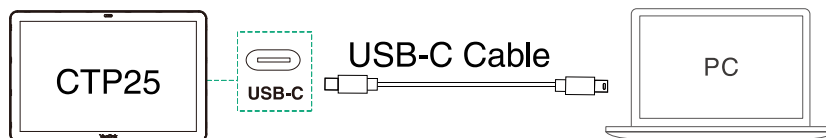

BYOD



If on Teams mode, please refer to steps 1, 2, and 3 in **Manual Update** section to enter the web interface, and enter **System > UC Provider** to enable **BYOD Enable**.

Use the USB-C cable to connect the CTP25 to the PC, and follow the prompts to enter BYOD mode.

10 Update the Firmware

Auto Update

Do one of the following:

- During power-on initialization, turn on **Auto Update**.
- In settings, turn on **Auto Update**:

Teams: Go to **More > Settings > Device Settings > Upgrade**, enter the admin password (default : 0000), and turn on **Auto Update**.

Zoom: Go to **Settings > General > System Settings > System**, enter the admin password (default: 0000), and turn on **Auto Update**.

Manual Update

 Update the firmware of MeetingBar A50 and CTP25 separately.

1. (Teams) Go to **More > Settings > Device Settings > About** to obtain the IP address.
(Zoom) Go to **Settings > General > System Settings > About** to obtain the IP address.
2. Open a web browser and enter the device's IP address in the address bar. For example, <https://10.82.24.11/>, and press **Enter**.
3. Enter the administrator username and the password, and click **Login**. (The default user name is "admin", the password is "0000").
4. Go to **System > Update**.
5. On the right side of **Device Firmware**, click **Select File** to upload the desired firmware.
6. Click **Update**.

Please get the latest firmware at <https://support.yealink.com/>.

Regulatory Notices

Operating Ambient Temperatures

- Operating temperature: -10 to +45°C (+14 to 113°F)
- Relative humidity: 5% to 90%, noncondensing
- Storage temperature: -30 to +70°C (-22 to +158°F)

Warranty

Our product warranty is limited only to the unit itself, when used normally in accordance with the operating instructions and the system environment. We are not liable for damage or loss resulting from the use of this product, or for any claim from a third party. We are not liable for problems with Yealink device arising from the use of this product; we are not liable for financial damages, lost profits, claims from third parties, etc., arising from the use of this product.

Explanation of the symbols

- DC symbol
— is the DC voltage symbol.
- WEEE Warning symbol

 To avoid the potential effects on the environment and human health as a result of the presence of hazardous substances in electrical and electronic equipment, end users of electrical and electronic equipment should understand the meaning of the crossed-out wheeled bin symbol. Do not dispose of WEEE as unsorted municipal waste and have to collect such WEEE separately.

Restriction of Hazardous Substances Directive (RoHS)

This device complies with the requirements of the EU RoHS Directive. Statements of compliance can be obtained by contacting support@yealink.com.

Safety Instructions

Save these instructions. Read these safety instructions before use!

General Requirements

- Before you install and use the device, read the safety instructions carefully and observe the situation during operation.
- During the process of storage, transportation, and operation, please always keep the device dry and clean, avoid collision and crash.
- Please attempt not to dismantle the device by yourself. In case of any discrepancy, please contact the appointed maintenance center for repair.
- Please refer to the relevant laws and statutes while using the device. Legal rights of others should be respected as well.

Environmental Requirements

- Do not cover ventilation openings, this equipment is not intended to be used on soft support.
- The marking information is located at the exterior of the bottom.
- Place the device at a well-ventilated place. Do not expose the device under direct sunlight.
- Keep the device dry and free of dusts.
- Do not place the device on or near any inflammable or fire-vulnerable object, such as rubber-made materials.
- Keep the device away from any heat source or bare fire, such as a candle or an electric heater.

Operating Requirements

- Do not let a child operate the device without guidance.
- Do not let a child play with the device or any accessory in case of accidental swallowing.
- Please use the accessories provided or authorized by the manufacturer only.
- The power supply of the device shall meet the requirements of the input voltage of the device. Please use the provided surge protection power socket only.
- Before plugging or unplugging any cable, make sure that your hands are completely dry.
- Do not spill liquid of any kind on the product or use the equipment near water, for example, near a bathtub, washbowl, kitchen sink, wet basement or near a swimming pool.
- During a thunderstorm, stop using the device and disconnect it from the power supply. Unplug the power plug and the Asymmetric Digital Subscriber Line (ADSL) twisted pair (the radio frequency cable) to avoid lightning strike.
- If the device is left unused for a rather long time, disconnect it from the power supply and unplug the power plug.
- When there is smoke emitted from the device, or some abnormal noise or smell, disconnect the device from the power supply, and unplug the power plug immediately.
- Contact the specified maintenance center for repair.
- Do not insert any object into equipment slots that is not part of the product or auxiliary product.
- Before connecting a cable, connect the grounding cable of the device first. Do not disconnect the grounding cable until you disconnect all other cables.

Cleaning Requirements

- Before cleaning the device, disconnect it from the power supply.
- Use a piece of soft, dry and anti-static cloth to clean the device.
- Keep the power plug clean and dry.

Troubleshooting

The usage environment is out of operating temperature range.

1. Use in the operating temperature range.

The cable between the unit and the Yealink device is connected incorrectly.

1. Connect the cable correctly.
Some dust, etc., may be in the port.

1. Clean the port.

Contact your dealer or authorized service facility for any further questions.

FCC CAUTION

This device complies with part 15 of the FCC Rules. Operation is subject to the following two conditions: (1) This device may not cause harmful interference, and (2) this device must accept any interference received, including interference that may cause undesired operation. Any changes or modifications not expressly approved by the party responsible for compliance could void the user's authority to operate the equipment.

Note: This equipment has been tested and found to comply with the limits for a Class B digital device, pursuant to part 15 of the FCC Rules. These limits are designed to provide reasonable protection against harmful interference in a residential installation. This equipment generates, uses and can radiate radio frequency energy and, if not installed and used in accordance with the instructions, may cause harmful interference to radio communications. However, there is no guarantee that interference will not occur in a particular installation. If this equipment does cause harmful interference to radio or television reception, which can be determined by turning the equipment off and on, the user is encouraged to try to correct the interference by one or more of the following measures:

- Reorient or relocate the receiving antenna.
- Increase the separation between the equipment and receiver.
- Connect the equipment into an outlet on a circuit different from that to which the receiver is connected.
- Consult the dealer or an experienced radio/TV technician for help.

The equipment complies with FCC radiation exposure limits set forth for an uncontrolled environment. The equipment should be installed and operated with minimum distance 20cm between the radiator and your body.

The emissions of U-NII bands are maintained within the band of operation under all conditions of normal operation.

ISED WARNING

This device complies with Innovation, Science and Economic Development Canada licence-exempt RSS standard(s). Operation is subject to the following two conditions: (1) this device may not cause interference, and (2) this device must accept any interference, including interference that may cause undesired operation of the device.

Le présent appareil est conforme aux CNR d'Industrie Canada applicables aux appareils radio exempts de licence. L'exploitation est autorisée aux deux conditions suivantes : (1) l'appareil ne doit pas produire de brouillage, et (2) l'utilisateur de l'appareil doit accepter tout brouillage radioélectrique subi, même si le brouillage est susceptible d'en compromettre le fonctionnement.

This Class B digital apparatus complies with Canadian ICES-003. Cet appareil numérique de la classe B est conforme à la norme NMB-003 du Canada.

Les communications effectuées au moyen de cet appareil ne sont pas nécessairement protégées des indiscrétions.

The device is compliance with RF exposure guidelines, users can obtain Canadian information on RF exposure and compliance. The minimum distance from body to use the device is 20cm.

Le présent appareil est conforme Après examen de ce matériel aux conformité ou aux limites d'intensité de champ RF, les utilisateurs peuvent sur l'exposition aux radiofréquences et la conformité and compliance d'acquies les informations correspondantes. La distance minimale du corps à utiliser le dispositif est de 20cm.

The device for operation in the band 5150-5250MHz is only for indoor use to reduce the potential for harmful interference to co-channel mobile satellite systems.

Operation of 5250-5350 MHz is restricted to indoor use only.

L'appareil destiné à fonctionner dans la bande 5150-5250MHz est uniquement destiné à une utilisation en intérieur afin de réduire le risque d'interférence nuisible aux systèmes mobiles par satellite utilisant le même canal.

Le fonctionnement de la bande 5250-5350MHz est limité à une utilisation en intérieur uniquement.

Contact Information

YEALINK NETWORK TECHNOLOGY CO.,LTD.
No.666 Hu'an Rd, Huli District Xiamen City, Fujian, P.R.C

Made in China

About Yealink

Yealink (Stock Code: 300628) is a global-leading provider of Unified Communication & Collaboration Solutions specialized in video conferencing, voice communications, and collaboration, dedicated to helping every person and organization embrace the power of "Easy Collaboration, High Productivity".

With best-in-class quality, innovative technology, and user-friendly experiences, Yealink is one of the best providers in more than 140 countries and regions, ranks No.1 in the global market share of IP Phone, and is the Top 5 leader in the video conferencing market (Frost & Sullivan, 2021).

Technical Support

Visit Yealink WIKI (<http://support.yealink.com/>) for firmware downloads, product documents, FAQ, and more. For better service, we sincerely recommend you to use Yealink Ticketing system (<https://ticket.yealink.com>) to submit all your technical issues.



YEALINK(XIAMEN) NETWORK TECHNOLOGY CO.,LTD.

Web: www.yealink.com

Addr: No.666 Hu'an Rd,Huli District Xiamen City, Fujian, P.R.
China

Copyright©2024 Yealink Inc. All right reserved.