

PLEASE NOTE:

This equipment has been tested and found to comply with the limits for a Class B digital device, pursuant to Part 15 of the FCC Rules. These limits are designed to provide reasonable protection against harmful interference in a residential installation. This equipment generates, uses and can radiate radio frequency energy and, if not installed and used in accordance with the instruction, may cause harmful interference to radio communications. However, there is not guarantee that interference will not occur in a particular installation. If this equipment does cause harmful interference to radio or television reception, which can be determined by tuning the equipment off and on, the user is encouraged to try to correct the interference by one or more of the following measures:

- Reorient or relocate the receiving antenna
- Increase the separation between the equipment and receiver
- Connect the equipment into an outlet on a circuit different from that to which the receiver is needed
- Consult the dealer or an experienced radio/TV technician for help

TROUBLE SHOOTING:

Problems	Reasons	Solution
Running Problems	The alkaline battery inside the radio control or charger unit is too weak.	Replace with new alkaline batteries.
	There is a weak or low reception for the radio control.	
Operation Problems	A small object obstructs movement of the tire or axle.	Use tweezers or a paper clip to remove obstruction.
	The vehicle was driven on the carpet or has fabric threads caught in the axle.	Playing on the carpet is not recommended.
Other	The vehicle does not respond to the radio control.	Try playing at another location.
	The radio control's frequency is disrupted by something around the environment.	Some other equipment using the same radio wave could disrupt the radio control. Either play in another location, or turn off other equipment.

- Operating multiple vehicles with the same frequency in close proximity will cause interference and poor performance.
- Works best away from high voltage power lines, large buildings, and walls.
- Hold the transmitter antenna up for best performance.
- When the product does not respond, slows down, or loses range, replace the batteries.
- If transmitter is accidentally dropped in water, remove the batteries and allow transmitter to air dry. Replace with fresh batteries before operation
- Please safely! - Do not drive vehicle in the street!
- When operating the vehicle in water, keep the vehicle as close to the transmitter as possible. The water will reduce the range of vehicle.

START UP:

Unscrew and remove the battery covers on both the controller and the car. Insert 4AA batteries into the car and 3AAA batteries into the controller unit. Then replace the battery covers and tighten the screws. (see diagram #1 and #2)

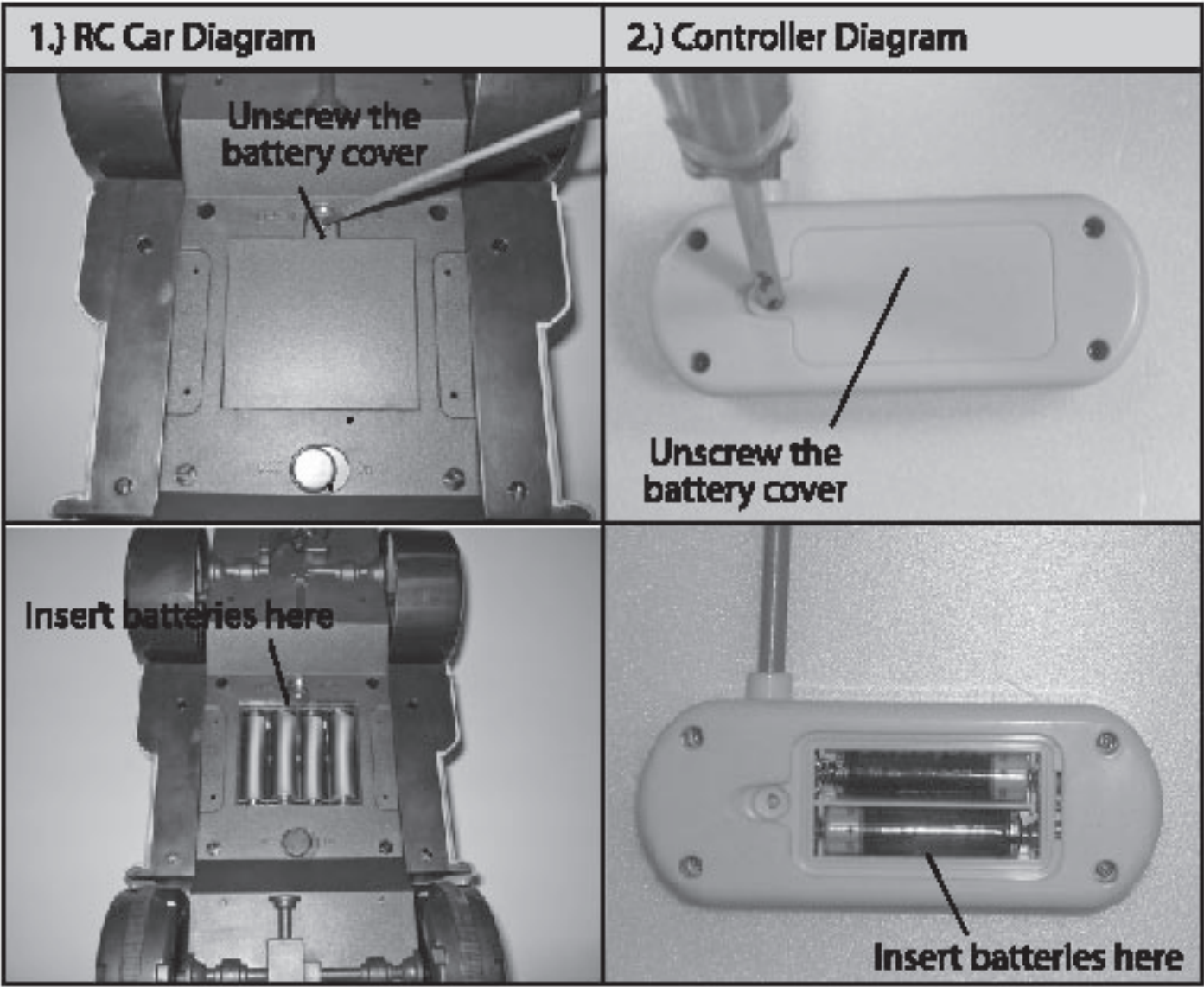

BATTERY SAFETY INFORMATION

In exceptional circumstances batteries may leak fluids that can cause a chemical burn injury or ruin your product. To avoid battery leakage:

- Non-rechargeable batteries are not to be recharged.
- Rechargeable batteries are to be removed from the product before being charged (if designed to be removable).
- Rechargeable batteries are only to be charged under adult supervision (if designed to be removable).
- Do not mix alkaline, standard (carbon-zinc), or rechargeable (nickel-cadmium) batteries.
- Do not mix old and new batteries.
- Only batteries of the same or equivalent type as recommended are to be used.
- Batteries are to be inserted with the correct polarity.
- Exhausted batteries are to be removed from the product.
- The supply terminals are not to be short-circuited.
- Dispose of battery(ies) safely.
- Do not dispose of this product in a fire. The batteries inside may explode or leak.

Protect the environment by not disposing of this product with household waste (2002/96/EC). Check your local authority for recycling advice and facilities.

INSTRUCTION MANUAL

ITEM NO. 3316

Fisher-Price



Jeep and the Jeep grille design are registered trademarks of DaimlerChrysler Corporation. Jeep, Wrangler and its trade dress are used under license from DaimlerChrysler. ©DaimlerChrysler Corporation 2008

FISHER-PRIE, TUFF RUMBUN and associated trademarks are owned by and used under license from Mattel, Inc. ©Mattel, Inc. All Rights Reserved.



*** IMPORTANT - IF CAR DOES NOT RESPOND PROPERLY, PLEASE REPLACE BATTERIES (4 X AA - not included) AND BATTERY IN CONTROLLER (3 X AAA - not included).**

**** NOTE: THE MANUFACTURER IS NOT RESPONSIBLE FOR ANY RADIO OR TV INTERFERENCE CAUSED BY UNAUTHORIZED MODIFICATIONS TO THIS EQUIPMENT. SUCH MODIFICATIONS COULD VOID THE USER'S AUTHORITY TO OPERATE THE EQUIPMENT.**

WARNING:
Changes or modifications to this unit not expressly approved by the party responsible for compliance could void the user's authority to operate the equipment. Play safely! - Do not drive in the street!

This device complies with part 15 of the FCC rules. Operation is subject to the following two conditions:
1. This device may not cause harmful interference, and
2. This device must accept any interference received, including interference that may cause undesired operation

CONSUMER SERVICE
Please do not return to store!
For parts information or questions, please call:
1-877-FUN-TOYS
(1-877-386-8697)
Keep these instructions for future reference as they contain important information.

PLEASE NOTE:

- a) Make sure the batteries have been inserted correctly (+ or -) into car and controller
- b) If the car does not respond properly, please replace the alkaline batteries in the car and/or controller batteries.
- c) For longer life, use only alkaline batteries.

NOTE:

- Adult assembly is required (for battery replacement)
- Tool required for battery replacement: Phillips screwdriver (not included)

OPERATING THE CAR:

1. Switch on the Fisher Price - Radio Control Car
2. Press the action buttons to control the Fisher - Price R/C vehicle to go forward or reverse and turn. (see Diagram #3)
3. After use, switch off the Fisher - Price Radio Control Car
4. If the Fisher - Price Radio Control Car is to be "parked" for a relatively long time, remove all batteries from the car and the controller unit.

PLEASE NOTE:

- a) When operating the controller, please do not touch the antenna, as the control, distance and speed will be affected.
- b) If you notice a reduction in speed and control, please begin to prepare to replace the batteries per the instructions detailed on page 2.

