

USE AND CARE GUIDE

3-HEAD CONVERTIBLE UTILITY LIGHT

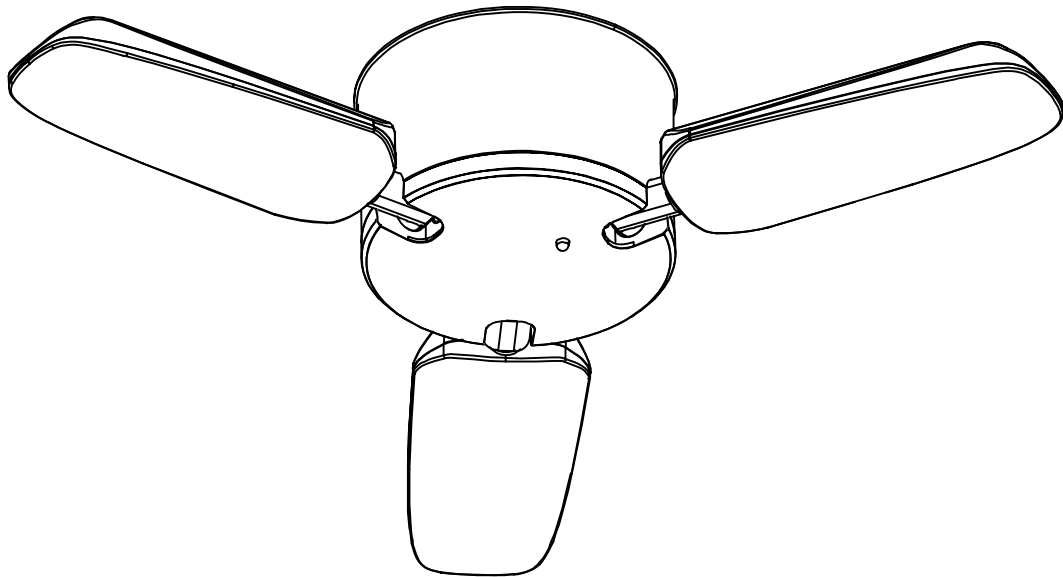

**Questions, problems, missing parts? Before returning to the store,
call Commercial Electric Customer Service
8 a.m. - 7 p.m., EST, Monday - Friday, 9 a.m. - 6 p.m., EST, Saturday
1-877-527-0313
HOMEDEPOT.COM**

THANK YOU

We appreciate the trust and confidence you have placed in Commercial Electric through the purchase of this LED garage light. We strive to continually create quality products designed to enhance your home. Visit us online to see our full line of products available for your home improvement needs. Thank you for choosing Commercial Electric!

Table of Contents

Table of Contents	2	Using the Wireless Remote	6
Safety Information	2	Care and Maintenance	6
Warranty	2	Motion Sensor	7
Pre-Installation	3	Adjusting the light heads	8
Tools Required	3	Troubleshooting	8
Hardware Included	3		
Installation	4-5		

Safety Information

IMPORTANT, RETAIN FOR FUTURE REFERENCE: READ CAREFULLY

For your safety, always remember to:

- ❑ Turn off the power supply at the fuse or circuit breaker box before you install the fixture.
- ❑ Double-check all connections to be sure they are tight and correct.
- ❑ Wear rubber soled shoes and work on a sturdy wooden ladder.
- ❑ Account for small parts and destroy packing material, as these may be hazardous to children.

THIS DEVICE IS NOT INTENDED FOR USE WITH EMERGENCY EXITS.

This fixture is designed for use in a circuit protected by a fuse or circuit breaker. It is also designed to be installed in accordance with local electrical codes. If you are unsure about your wiring, consult a qualified electrician or local electrical inspector, and check your local electrical code.

PRODUCT SPECIFICATIONS:

- 120VAC, 60Hz, 80W
- Not Dimmable
- Suitable for damp locations



WARNING: RISK OF SHOCK. House electric current can cause painful shock or serious injury unless handled properly.

NOTICE: All electrical connections must be in accordance with local and National Electrical Code (N.E.C.) standards. If you are unfamiliar with proper electrical wiring connections obtain the services of a qualified electrician.

Remove the fixture and the mounting package from the box and make sure that no parts are missing by referencing the illustrations on the installation instructions.



WARNING: Risk of fire. Before installing your lighting fixture, thoroughly review enclosed installation manual. If you do not have sufficient electrical wiring experience, please refer to a do-it-yourself wiring handbook or have your fixture installed by a qualified licensed electrician. All electrical connections must be in accordance with Local and National Electrical Code (NEC) Standards. Reliable operating temperature is -13° F to 113° F (-25° C to 45° C).



NOTE: Suitable for damp locations. Do not use with dimmer switch. Not for use in totally enclosed luminaries. Remove the fixture and the mounting package from the box and make sure that no parts are missing by referencing the illustrations on the installation instructions. This device is not intended for use with emergency exits.

Supplier's Declaration of Conformity:

47 CFR § 2.1077 Compliance Information

Responsible Party: Feit Electric Company

4901 Gregg Road, Pico Rivera, CA 90660, USA 562-463-2852

Unique Identifier: ADJC8KMMR5KHD

FCC STATEMENT

This device complies with part 15 of the FCC Rules. Operation is subject to the following two conditions:

(1) This device may not cause harmful interference, and (2) this device must accept any interference received, including interference that may cause undesired operation. Note: This equipment has been tested and found to comply with the limits for a Class B digital device, pursuant to part 15 of the FCC Rules. These limits are designed to provide reasonable protection against harmful interference in a residential installation. This equipment generates, uses and can radiate radio frequency energy and, if not installed and used in accordance with the instructions, may cause harmful interference to radio communications. However, there is no guarantee that interference will not occur in a particular installation. If this equipment does cause harmful interference to radio or television reception, which can be determined by turning the equipment off and on, the user is encouraged to try to correct the interference by one or more of the following measures: Reorient or relocate the receiving antenna. Increase the separation between the equipment and receiver. Connect the equipment into an outlet on a circuit different from that to which the receiver is connected. Consult the dealer or an experienced radio/TV technician for help. **Warning:** Any changes or modifications not expressly approved by the manufacturer could void the user's authority to operate the equipment.

RADIATION EXPOSURE STATEMENT

This device complies with FCC radiation exposure limits set forth for an uncontrolled environment. This device should be installed and operated with a minimum distance of 20cm between the radiator and your body.

Warranty

This product is warranted to be free from defects in workmanship and materials for up to 5 years from date of purchase. If it fails to do so, please contact the Customer Service Team at 1-877-527-0313 or visit www.HomeDepot.com.

Pre-Installation

TOOLS REQUIRED



Phillips
screwdriver



Small flat head
screwdriver

HARDWARE INCLUDED



NOTE: Hardware not shown to actual size.

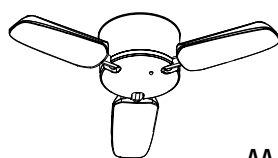

AA



BB



CC



DD



EE



FF



GG



HH

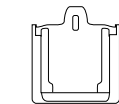

II



JJ

Part	Description	Quantity
AA	LED Garage Light	1
BB	Mounting Plate	1
CC	Supply Conductors (live, neutral, ground)	1 each
DD	Wire Nuts	3
EE	Mounting Screws	2
FF	Remote	1
GG	Double Sided Tape (for remote mount)	1
HH	Screws with Wall Anchors (for remote mount)	2 each
II	Remote Mount	1
JJ	AAA Batteries	2

Installation with Medium Screw Base

1 Removing the Mounting Plate

- Remove the mounting plate (BB) from the fixture by turning it counterclockwise then carefully pulling it off the fixture (AA).

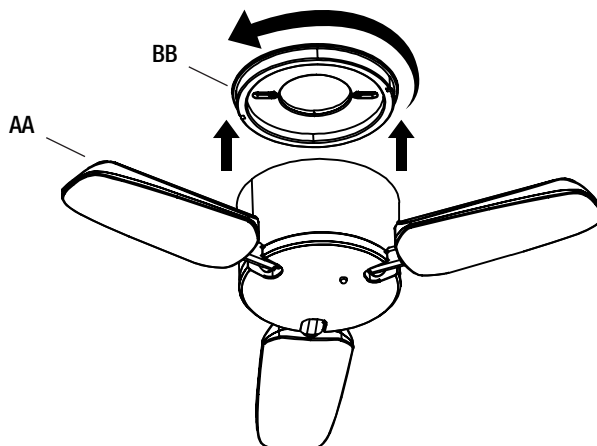

2 Removing the Cap

- Carefully pull off the cap to expose the screw base.



NOTE: Do not remove plastic cover over terminal block.

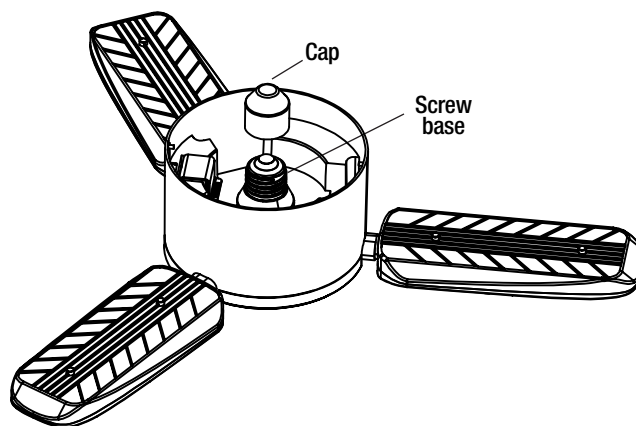

3 Installing the Fixture

- Insert LED fixture (AA) into the socket and turn clockwise (same as a light bulb) until fixture (AA) is securely installed. Do not overtighten.

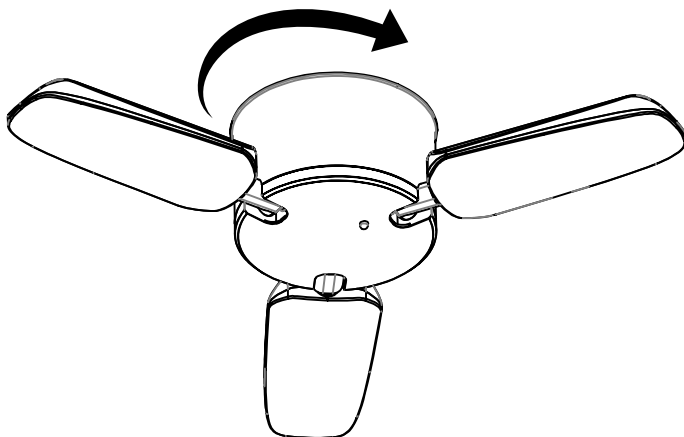

Junction Box Installation



WARNING: RISK OF SHOCK. Turn off all power at the switch and fuse or the circuit breaker box.

1 Removing the Mounting Plate

- Remove the mounting plate (BB) from the fixture by turning it counterclockwise then carefully pulling it off the fixture (AA).



NOTE: Do not remove the screw base cap if you are wiring the fixture to the junction box.

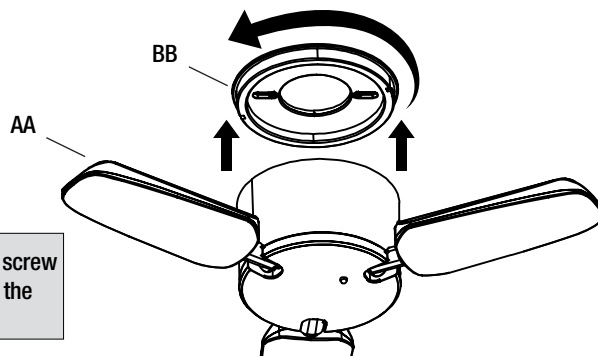

2 Installing the Mounting Plate

- Side labeled "Faces Ceiling" should be facing upward. Insert mounting screws (EE) through the two slots on the mounting plate (BB) to install the plate onto the junction box.

Be sure this label faces upward, towards the Jbox

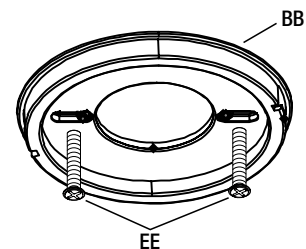
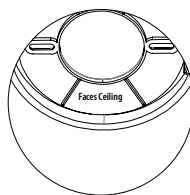

3 Installing Wires

- Manually remove the terminal block cover.
- Connect the provided power supply wires directly to the terminal block.
- Connect: White wire to "N" input, ground wire to "G" input, black wire to "L" input.
- Secure the wires by using a small screwdriver.

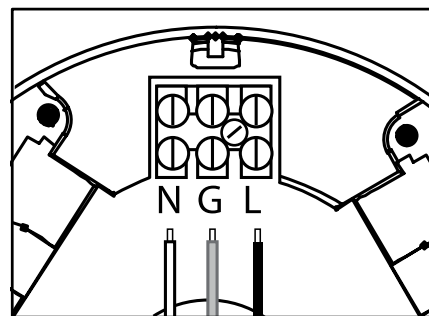

4 Connecting Wires

- Connect the fixture wires to the junction box wires using the provided wire nuts (DD).
- Black - Live wire, White - Neutral wire, Green - Bare/Ground wire.
- Tuck wires into junction box.

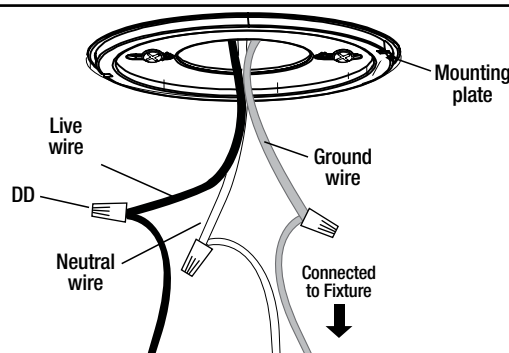

5 Installing the Fixture

- Line up the pin guides on the fixture (AA) with the corresponding notches on the mounting plate (BB). Insert and turn clockwise until the fixture (AA) securely locks into place.

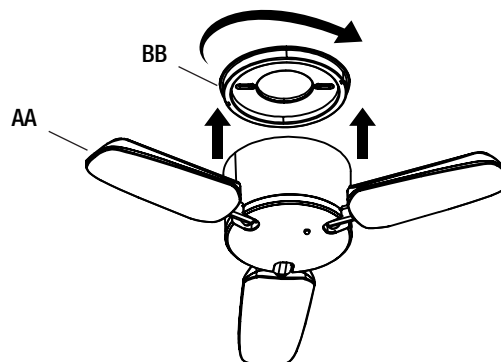

Using the Wireless Remote

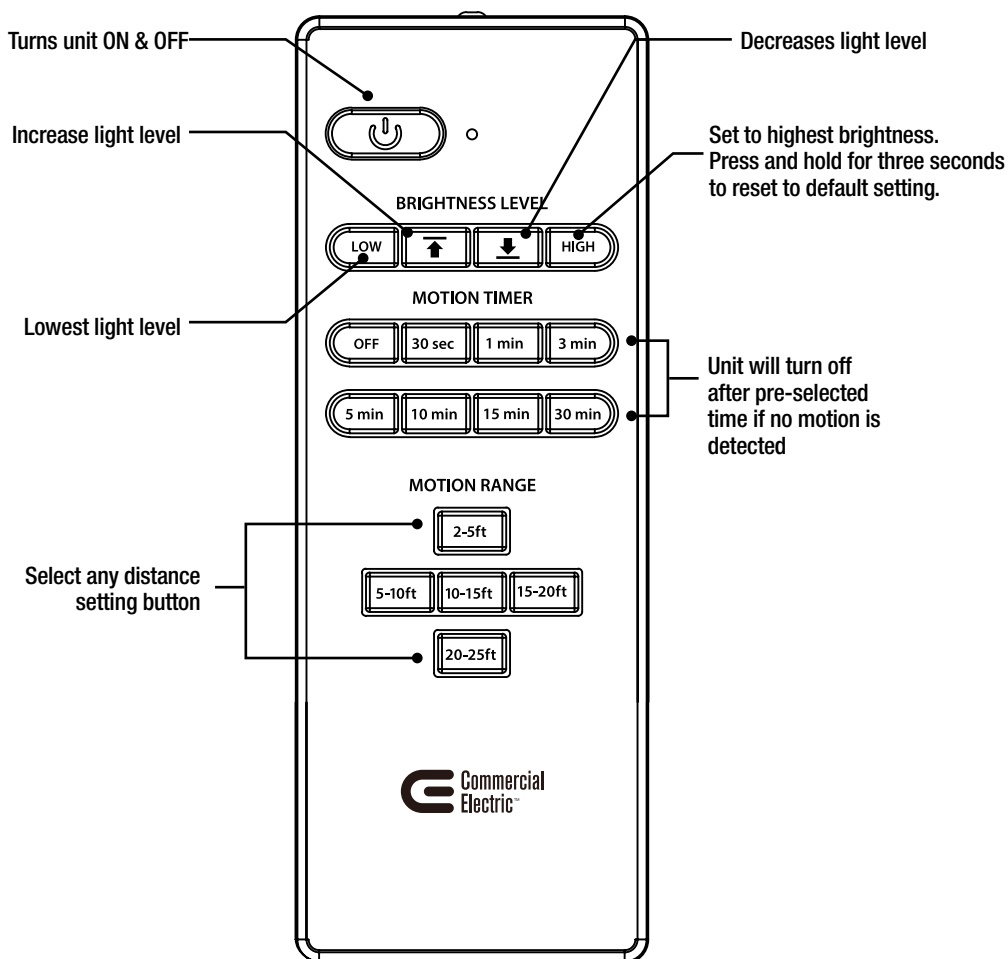

Care and Maintenance

- ❑ Do not mix old and new batteries
- ❑ Do not mix alkaline, standard (carbon-zinc), or rechargeable (ni-cad, ni-mh, etc) batteries.
- ❑ If the remote control is not going to be used for an extended period, it is recommended to remove the batteries. This helps prevent potential battery leakage or corrosion. Store the batteries in a cool, dry location or according to the battery manufacturer's instructions.



IMPORTANT: Dispose of used (or excess) batteries in compliance with federal, state/provincial and local regulations. Do not accumulate large quantities of used batteries for disposal as accumulations could cause batteries to short circuit. Do not incinerate. Do not dispose of batteries in household trash.

Replacing the Batteries

- ❑ Remove battery compartment cover by pressing on the ribbed portion of the cover and pushing outward.
- ❑ Remove both batteries and replace with only two (2) AAA batteries. Ensure to follow the correct polarity.
- ❑ Replace battery compartment cover.

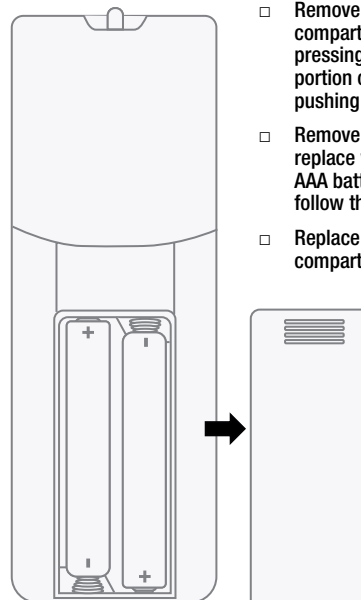

Motion Sensor Operation



NOTE: All distances are measured from the motion sensor located in the center of the fixture.



NOTE: Recommended installation height is 8-9 ft.



NOTE: The fixture uses microwave motion sensor. Do not install within 5ft of router or other wifi source.

SENSOR DETECTION

Can be adjusted from 2 to 25 feet using the remote control.

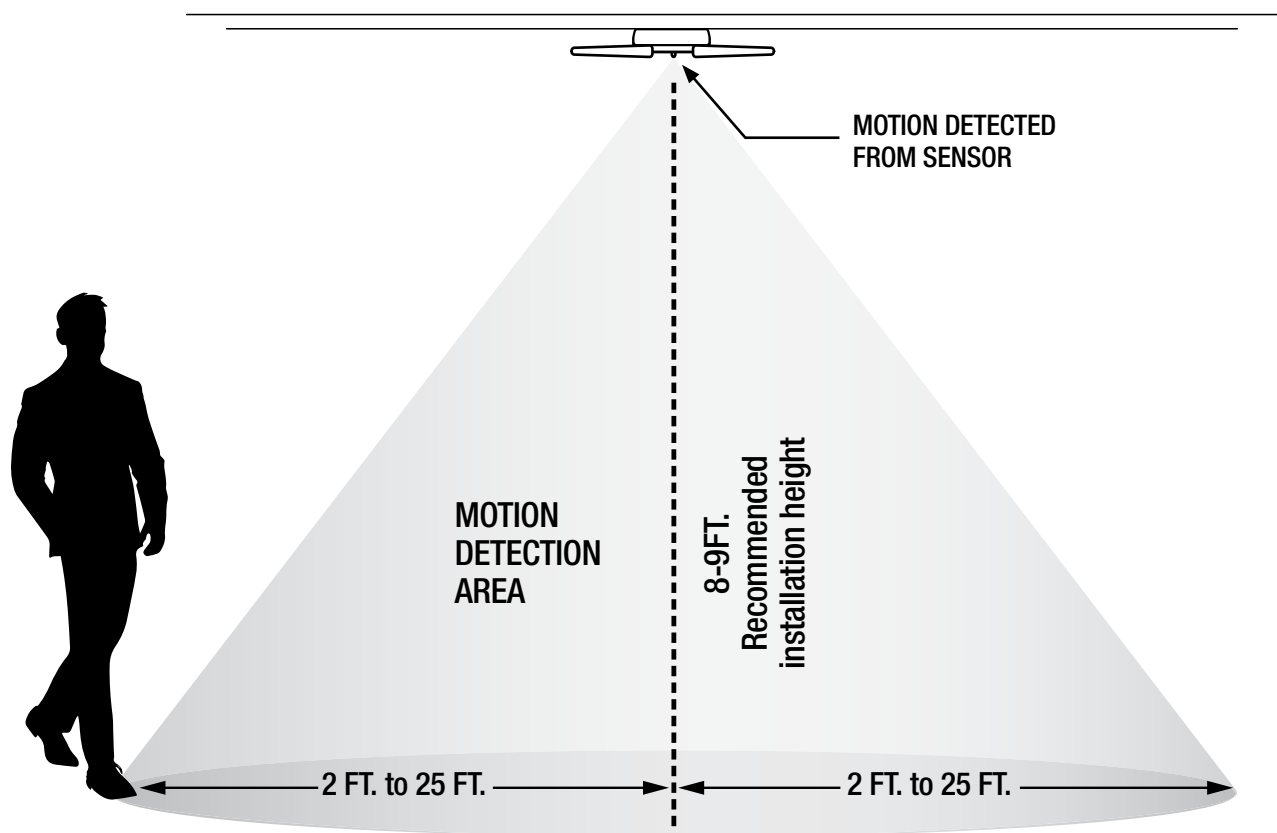

**Approximate motion range
is selected on the remote**

Adjusting the Light Heads

This LED fixture has three light heads that can be adjusted to customize light coverage. You have the ability to manually adjust the vertical angle of each light head from 0° to 90°. Additionally, each light head can be rotated up to 180° degrees.

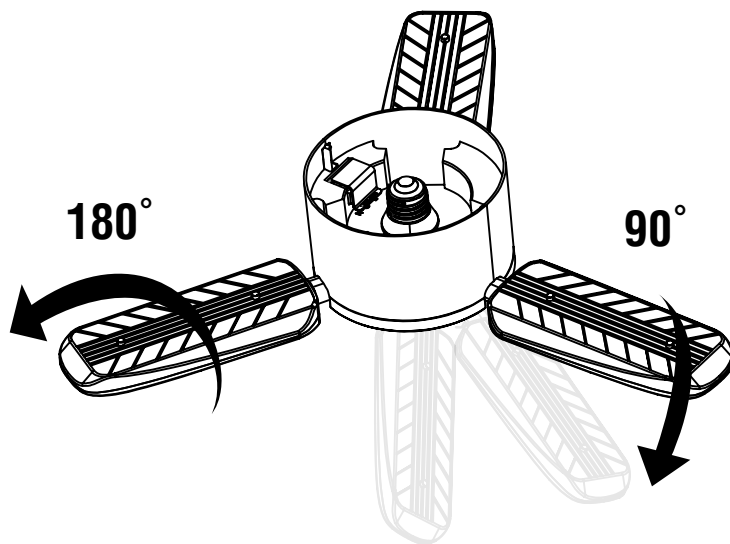

Troubleshooting

Problem	Possible Causes	Solution
Light is not coming out of the fixture	Motion range is selected on remote but no motion has been detected	Select a larger motion range from the remote
Light turns on without obvious movement	Motion detector triggered	Select a shorter motion range from the remote (microwave motion detectors can trigger through walls and doors)
Light stays off despite movement	Detection range is too small	Select a larger detection range from the remote
Light does not go off	Motion detector is being constantly triggered	Select a shorter motion range from the remote (Set time of the light to stay on will reset each time motion is detected)
Fixture does not react to remote	Batteries are dead	Replace dead batteries with new AAA batteries
	Batteries are inserted incorrectly	Ensure batteries are in the correct orientation
	Remote is out of range	Move closer to fixture



Questions, problems, missing parts? Before returning to the store,
call Commercial Electric Customer Service
8 a.m. - 7 p.m., EST, Monday - Friday, 9 a.m. - 6 p.m., EST, Saturday

1-877-527-0313

HOMEDEPOT.COM

Retain this manual for future use.