

Thank you for purchasing our hand held FM transceiver, This model is novel design, stable performance, easy to operate and with a variety of sophisticated functions, so we are using the most advanced technology. we deeply confident that its quality and functionality would make you feel satisfied!

## Table of contents

---

<b>User Safety Information.....</b>	<b>1</b>	<b>Basic operation .....</b>	<b>12</b>
Before use.....	1	Power on/off.....	12
<b>Unboxing and Configuration</b>		Adjust Volume .....	12
<b>Checks.....</b>	<b>2</b>	Select frequency/channel...	12
Accessories.....	2	Transmit/Receive .....	12
Supplied Accessories .....	2	<b>Menu Settings .....</b>	<b>13</b>
<b>Preparation.....</b>	<b>3</b>	Menu Usage.....	13
Charging Instruction.....	3	Menu List.....	13
Charge Steps .....	4		
Install/Remove			
Battery Pack.....	4		
Install Belt Clip .....	5		
Installing The Optional			
Speaker/Microphone.....	5		
<b>Getting Started.....</b>	<b>6</b>		
Main Function .....	6		
Each part name.....	7		
Keyboard .....	8		
LCD Display.....	8		
Long key / Short key			
setting .....	9		
The basic mode of the			
walkie-talkie .....	10		

## User Safety Information

---

### ■ Before use

- Do not use damaged antennas. Damaged antennas may cause minor burns if they come into contact with the skin.
- Do not use the radio or charge the battery in an explosive environment (such as gas, dust, steam, etc.)
- Turn off the radio when refueling or parking at a gas station
- Do not modify or adjust this unit for any reason.
- Do not expose the radio to direct sunlight for a long time, and do not place it near heating appliances
- Do not place the radio in extremely dusty, humid and splashy places, and do not place it on an unstable surface.
- Repairs may only be carried out by professional technicians.
- If you notice a strange smell or smoke from the radio, immediately turn off the power of the radio, remove the rechargeable battery pack from the radio, and contact the supplier.

---

### Safety:

- It is important that the user has knowledge and awareness of the general dangers of using a walkie-talkie.
-

## Unboxing and Configuration Checks

### ■ Accessories

Carefully take out the transceiver from the box. We recommend that confirm the below goods before get rid of the packing.

### ■ Supplied Accessories

Item	Qty.
Radio	1
Li-ion Battery pack	1
Charger /Adapter	1
Belt Clip	1
User Manual	1
Hang Strap	1

## Preparation

### ■ Charging Instruction

The note of Li-ion battery charging below:

- The battery pack had not charging when come out the factory, please charging first when you want to use. After the purchase or long-term storage (more than two months), the first to charging the battery pack can not make the battery pack up to its saturation use of capacity. In repeated charging and discharging two, three times, The effect can be achieved the normal charging and battery power.
- Before charging, should turn off the transceiver power. if use the transceiver while its battery charging, it would badly influence on the battery normally charging.
- The Battery under the normal charging many times, The time of using time is not adding anymore, it mean that life of battery is close to over, should replace new one.
- As calculated, The average time of battery pack is about 13 hours. The average use time is 5% receive time, 5% transmit time, and 90% standby time.

#### CAUTION

- Do not charging the battery pack again, when its already fully charging before. otherwise it would cause the life of battery pack to shorten, even it may be damaged.
- When it's charging fully, please remove it away charger cup.
- Do not short the battery terminal or dispose of the battery by fire.

## ■ Charge Steps

The charger plug into the mains of 110V or 220V power outlet, the charger indicator green light flashing.

The battery pack or the transceiver with battery pack insert into the charger card slot. (as picture show).

The charger red light flashing to start charging. Charging fully then the charger green light flashing, charging end.



## ■ Install/Remove Battery Pack

When install the battery pack, should match the corresponding location of aluminum frame of transceiver backside, then push into the battery towards direction. The Buckles on the tail of battery would fasten the battery pack, until can hear "clicking" sound;

To remove the battery pack, please turn off the transceiver first. Then press the buckles of the battery, at the same time, the battery will be pushed back, take the battery away;

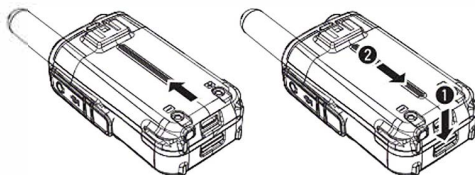

## ■ Install Belt Clip

Push the back clip along the battery back clip slot.

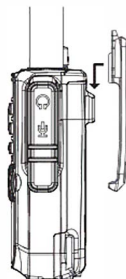

## ■ Installing The Optional Speaker/Microphone

Outward apart the moistureproof rubber of the headphone mouth, Insert the speaker/microphone plugs into the speaker/microphone jacks.

### ⚙ NOTE

- The transceiver is not fully water resistant while using the speaker/microphone.

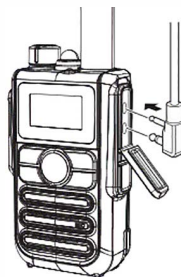

# Getting Started

## • Main Function

- Scrambler function
- Compandor function
- A variety of scanning methods
- VOX function
- Chinese and English voice prompt

## ■ Each part name

LED Torch

Volume/Power knob

Displays

Function keypad

Speaker

Antenna

Status indicator

Microphone

PTT Button

Side key

External Speaker/  
Microphone jack

Battery pack

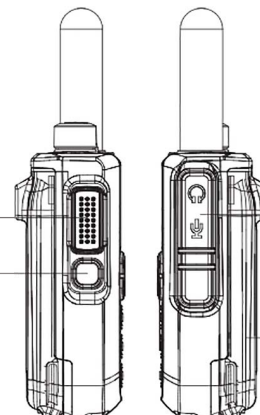
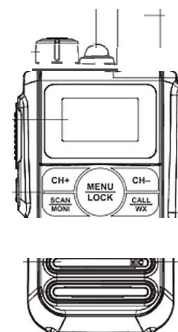

## ■ Keyboard

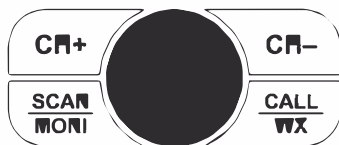

## ■ LCD Display

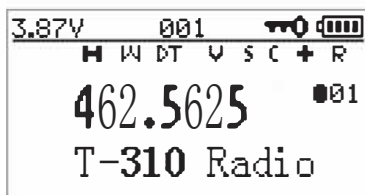

3.87V	Battery voltage	001	Radio ID
Key icon	Keyboard lock	Battery level bar	battery level display
H/L	Power (High H, Low L)	W/N	Bandwidth (W wide, N narrow)
CT/DT	CT: CTCSS, DT: DCS	V	VOX
S	Scrambler	C	compandor
+/-	Difference frequency direction (- / +)	R	Reverse Frequency

## ■ Long key / Short key setting

Users can set the side keys to different functions of long press or short press respectively according to their needs (Default: side key (torch/monitor)).

**Tips:** You can set the long key time through the frequency writing software, the default is 2.0 seconds. If you press these programmed keys for longer than the set long key time, it is a long key; otherwise, it is a short key.

No.	Setting items	Function description
0	Off	The key function is not defined, the key is invalid
1	Squelch Off	Press the key programmed as the squelch cancel function to open the noise squelch; press the key again to exit this function.
2	Squelch Off Momentary	Press and hold the key programmed for the Momentary Squelch Cancel function, the Noise Squelch opens, and when released closes the Squelch. Short keys do not have this function.
3	VOX	Voice enable key. The launch operation can be started by speaking, and the sound can be transmitted without pressing the PTT button. Stop talking and the firing stops.
4	Adjust Power Level	Switch the transceiver transmit power to switch between high and low power.
5	Scan	Scan enable key. Through this key, scan one by one according to the channel numbers in the scan queue. Scanning is a listening method used to hear the calls of all channels.
6	Roger	Turn on/off the beep sound at the end of the launch
7	Screen Display	Turn on/off screen display
8	Battery Electronic Power Display	Broadcast current battery high/medium/low

No.	Setting items	Function description
9	Emergency Alarm	When dealing with emergencies or calling for help when you are trapped, you can press the button programmed as an alarm function to emit a harsh alarm sound. To stop the alarm sound, press the PTT button.
10	Annunciation CH No	Report number current channel number
11	Key Lock	Lock/unlock key functions.
12	Scramble Frequency	Turn on/off the scrambling function. Scrambling is a voice encryption function. Generally, both sides of the call set up scrambling at the same time to prevent the outside world from stealing the information of the call from walkie-talkies with the same frequency.
13	MENU	Enter the menu function, you can set menu related functions.
14	Channel Group Switch	Can switch the direction of channel group A/B
15	Switch Work Mode	Can switch working mode, switch frequency mode/channel frequency mode/channel mode
16	Lamp	Flashlight can be turned on or off

## ■ The basic mode of the walkie-talkie

### VFO Mode (Frequency Mode)

- Long press **[CALL/WX]** key to switch selection.
- In this mode, you can press the **[UP / DOWN]** key to change the frequency of use.

### MR mode (frequency channel mode)

- Long press **[CALL/WX]** key to switch selection.
- In this mode, you can press the **[UP / DOWN]** key to change the

channel number (the frequency and related data have been stored).

- You must program at least one memory channel or you cannot enter this mode.

### CH mode (channel mode)

- Long press **[CALL/WX]** key to switch selection.
- In this mode, you can press the **[UP / DOWN]** key to change the channel number (the frequency and related data have been stored).
- You must program at least one memory channel, otherwise you cannot enter this mode.

## Basic operation

### ■ Power on/off

Transmitting and receiving switching key: when transmitting, press this key and speak into the microphone; when receiving, release this key.

Side key (torch/monitor)

Long press to turn on the flashlight function, long press again to turn off.

Press and hold for a short time to turn on the monitoring function, short and hold again to turn off;

### ■ Adjust Volume

Turn it clockwise to turn on the power of the walkie-talkie; turn it counterclockwise to the end, and turn off the power of the walkie-talkie when you hear a "click"; turn it clockwise to increase the volume, and vice versa.

### ■ Select frequency/channel

Use [UP / DOWN] key to select frequency/channel;

### ■ Transmit/Receive

Transmitting and receiving switching key: when transmitting, press this key and speak into the microphone; when receiving, release this key.

**Status Indicator:** launch - red light; Receive - green light

## Menu Settings

### ■ Menu Usage

The menu contains the settings of various software functions of the walkie-talkie. You can change the settings in the menu to meet your needs.

1. Press the [**Menu**] key to enter the menu system.
2. Use the [**UP / DOWN**] keys to select the menu item to be used.
3. Press [**Menu**] key to enter menu setting.
4. You can press the [**UP / DOWN**] key to select the setting content, then press the [**Menu**] key to complete the setting and return to the menu system.
5. Press [**CALL/WX**] key to exit the menu system and return to the original working mode.

If there is no operation for more than 10 seconds, the walkie-talkie will automatically return to the original working mode.

### ■ Menu List

No.	Display characters	Secondary menu display characters	Secondary menu setting description
0	Power	Low Power/High Power	low power transmission / high power transmission
1	Beep	Close/Open	Turn off/on beeps
2	Scan	/	Scanning starts, if not in frequency mode, at least 2 channels are required to start scanning
3	VOX	Close/Open	Turn off/on voice control
4	TOT	Close	Unlimited launch time
		15s/.../270s	If the transmission exceeds the time, the walkie-talkie will automatically turn off the transmission

No.	Display characters	Secondary menu display characters	Secondary menu setting description
5	SQL	0-10	Adjust between levels 0-10, the higher the level, the deeper the squelch
6	Band Set	Narrow/Wide	N will be displayed when narrow-band is selected, and "W" will be displayed when wideband is selected
7	Backlight	Close	The backlight is off (the backlight will be on for a while when there is an operation)
		Open	The backlight is always on
		Auto 5s/.../60s	Backlight turns off after set time (digits indicate time)
8	VOX Level	Open/1/.../10	Set the voice-activated gain threshold
9	Scramble	Close/Open	Turn off/on scrambling
10	Compandor	Close/Open	Turn off/on compandor
11	Key Lock Mode	Manual	Manually lock the keyboard
		Auto 5s/.../30s	Lock the keyboard after setting the time, without saving the lock state
		Auto 5s/.../30s Save	Lock the keyboard after setting the time, save the lock state
12	Dec-CTDCS	Close/.../CTC-254.1	Press <b>[SCAN/MONI]</b> key to select: OFF, CTCSS, DCSN, DCSL;
		DCS-D023N/.../DCS-D754I	
13	ENc-CTDCS	Close/.../CTC-254.1 DCS-D023N/.../DCS-D754I	

No.	Display characters	Secondary menu display characters	Secondary menu setting description
14	Step	0.05KHz/.../500K	Can be selected from 0.05KHz, ... 500KHz
15	Sft	None	The transmit frequency is equal to the receive frequency
		-	The transmit frequency is equal to the current frequency minus the beat frequency
		+	The transmit frequency is equal to the current frequency plus the difference frequency
16	Offset Freq	0.000-450.000MHz	difference between transmitted and received frequencies
17	Rev Freq	Close/Open	Reverse frequency off/on
18	Power On Turn	Closed/Tone 1/.../Chord Tone 4	Select the startup sound
19	Scan Add/Del	Delete/Add	delete/add scan channel
20	Roger	Close/Open	Turn off/on end sound
21	Boot Screen	Picture	Show boot image
		Voltage	Display voltage volts
		Information	Display setting information
22	Wait Light	Close/Open	Turn off/on the waiting light
23	Language	English/Chinese	Select the display interface language
24	Voice Sort	Close/English/Chinese	Choice of Announcement
25	Call Tone	Close/1/.../10	Select the calling tone type
26	Vibration	Close/Open	Turn off/on the vibration function

## FCC Warning

This device complies with part 15 of the FCC rules. Operation is subject to the following two conditions: (1) this device may not cause harmful interference, and (2) this device must accept any interference received, including interference that may cause undesired operation.

Changes or modifications not expressly approved by the party responsible for compliance could void the user's authority to operate the equipment. To comply with the corresponding requirements, transmitter adjustments should be made only by or under the supervision of a person certified as technically qualified to perform transmitter maintenance and repairs in the private land mobile and fixed services as certified by an organization representative of the user of those services.

Replacement of any transmitter component (crystal, semiconductor, etc.) not authorized by the local government radio management departments equipment authorization for this radio could violate the rules.

NOTE: This equipment has been tested and found to comply with the limits for a Class B digital device, pursuant to part 15 of the FCC Rules. These limits are designed to provide reasonable protection against harmful interference in a residential installation. This equipment generates uses and can radiate radio frequency energy and, if not installed and used in accordance with the instructions, may cause harmful interference to radio communications. However, there is no guarantee that interference will not occur in a particular installation. If this equipment does cause harmful interference to radio or television reception, which can be determined by turning the equipment off and on, the user is encouraged to try to correct the interference by one or more of the following measures:

- Reorient or relocate the receiving antenna.
- Increase the separation between the equipment and receiver.
- Connect the equipment into an outlet on a circuit different from that to which the receiver is connected.
- Consult the dealer or an experienced radio/TV technician for help.

## RF Exposure Information

- DO NOT operate the radio without a proper antenna attached, as this may damage the radio and may also cause you to exceed RF exposure limits. A proper antenna is the antenna supplied with this radio by the manufacturer or an antenna specifically authorized by the manufacturer for use with this radio, and the antenna gain shall not exceed the specified gain by the manufacturer declared.

- DO NOT transmit for more than 50% of total radio use time, more than 50% of the time can cause RF exposure compliance requirements to be exceeded.

- During transmissions, your radio generates RF energy that can possibly cause interference with other devices or systems. To avoid such interference, turn off the radio in areas where signs are posted to do so.

- DO NOT operate the transmitter in areas that are sensitive to electromagnetic radiation such as hospitals, aircraft, and blasting sites.

- Portable Device, this transmitter may operate with the antenna(s) documented in this filing in Push-to-Talk and body-worn configurations. RF exposure compliance is limited to the specific belt-clip and accessory configurations as documented in this filing and the separation distance between user and the device or its antenna shall be at least 2.5 cm. Highest Reported SAR 0.070W/Kg for Front of face, Highest Reported SAR 0.181W/Kg for Body worn.

- General population/uncontrolled Radio, this radio is designed for and classified as "General population/un-controlled Use" .

**ISED Statement**

- English: This device complies with Industry Canada license - exempt RSS standard(s). Operation is subject to the following two conditions: (1) This device may not cause interference, and (2) This device must accept any interference, including interference that may cause undesired operation of the device. The digital apparatus complies with Canadian CAN ICES - 3

(B)/NMB - 3(B).

- French: Le présent appareil est conforme aux CNR d'Industrie Canada applicables aux appareils radio exempts de licence. L'exploitation est autorisée aux deux conditions suivantes: (1) l'appareil ne doit pas produire de brouillage, et (2) l'utilisateur de l'appareil doit accepter tout brouillage radioélectrique subi, même si le brouillage est susceptible d'en compromettre le fonctionnement.

This radio transmitter has been approved by Industry Canada to operate with the antenna types listed with the maximum permissible gain indicated. Antenna types not included in this list, having a gain greater than the maximum gain indicated for that type, are strictly prohibited for use with this device.

Le présent émetteur radio a été approuvé par Industrie Canada pour fonctionner avec les types d'antenne énumérés ci-dessous et ayant un gain admissible maximal. Les types d'antenne non inclus dans cette liste, et dont le gain est supérieur au gain maximal indiqué, sont strictement interdits pour l'exploitation de l'émetteur.

**IC SAR Warning:**

- English: The device has been tested and compliance with SAR limits, users can obtain Canadian information on RF exposure and compliance.

- French: L'appareil a été testé et respecte les limites du SAR. L'UESR a accès à l'information canadienne sur l'exposition aux RF et la conformité.