

Entry Alert Magnetic Sensor User Manual

This equipment has been tested and found to comply with the limits for a Class B digital device, pursuant to part 15 of the FCC Rules. These limits are designed to provide reasonable protection against harmful interference in a residential installation. This equipment generates, uses and can radiate radio frequency energy and, if not installed and used in accordance with the instructions, may cause harmful interference to radio communications. However, there is no guarantee that interference will not occur in a particular installation. If this equipment does cause harmful interference to radio or television reception, which can be determined by turning the equipment off and on, the user is encouraged to try to correct the interference by one or more of the following measures:

- Reorient or relocate the receiving antenna.
- Increase the separation between the equipment and receiver.
- Connect the equipment into an outlet on a circuit different from that to which the receiver is connected.
- Consult the dealer or an experienced radio/TV technician for help.

Modifications not authorized by the manufacturer may void users authority to operate this device.

Introduction

Congratulation on buying this ENTRY ALERT! With this ALERT center, you can know the status of the doors of your premise without going outside or leaving your room. The Alert is working on wireless and microcomputer technology.

Content

3.Door sensor (Magnetic) transmitter	1
4.Magnet strip	1
6.Large double side tape (for transmitter)	2
7.Lithium battery (CR2032)	2

Description of keys and connectors of the Magnetic sensor transmitter.

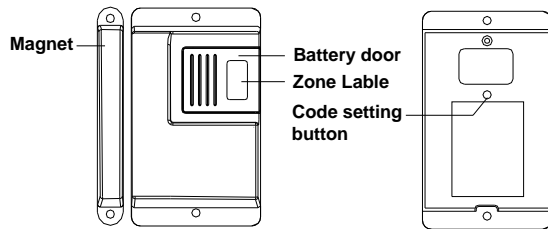

Figure 2. Transmitter u magnet strip nit and

Installation

- 1.Installing the battery to the transmitter units
 - Open the battery on the transmitter unit front cabinet and insert the battery as indicated on the inside of the battery door.
 - Close the battery door
- 2.Connecting the AC adapter to the main receiving unit. The adapter connector can be found on the rear of the unit. Four AA batteries can be used. This is recommended for backup purpose.
- 3.Testing the sensor transmitter and the receiving unit.

3.2 Magnetic sensor transmitter

Place the transmitter close to the main unit. The default zone is zone 2 for magnetic sensor transmitter. Place the magnet strip near the vertical side of the transmitter unit means the door is closed. The main unit will show a door close light for zone 2. Move the magnet strip away from the sensor; this means the door is open.

The main unit will give door open light and beeping sound.

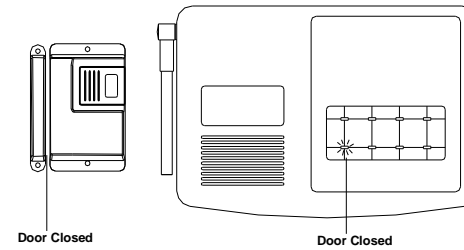

Figure 4. Testing of the magnet sensor transmitter unit and the main receiving unit

- 2.Mount the magnetic sensor unit to the door

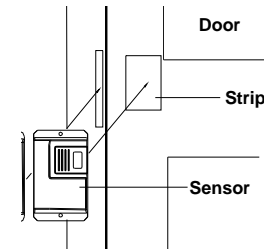

Figure 6. Mounting the magnetic sensor unit

- 3.There is paper label on the front of the ENTRY ALERT covered by the transparent lens. Write down description to match with the transmitter units for easy recognition.
Also fill in the zone label for the corresponding transmitter.

Setting of new transmitter code with the Transmitter and the Receiver

Unless the user finds that the transmitter does not work with the main receiving unit or there is interference from other wireless appliance, it is not recommended to change the transmitter code by the user.

- 1.At the rear panel of the main unit, there is a small learn key. Upon pressing the key, the unit will be in the learn code mode. Both open and close lights for the zone flash in this mode. Press this key to select the zone.
- 2.Underneath the transmitter cabinet, you will find a hole where may be covered with the adhesive tape. You can use some pointed object to press the tiny button inside. Upon push the little switch, the code for the transmitter is emitted. When the main unit receives a valid code, a long beep will be heard. Each zone can accept up to 4 different transmitters.
- 3.Repeat for all the zones and matched transmitter. Make sure only one transmitter is transmitting the code during the process.

4. For the doorbell transmitter, press the doorbell transmitter so that a valid code can be sent.

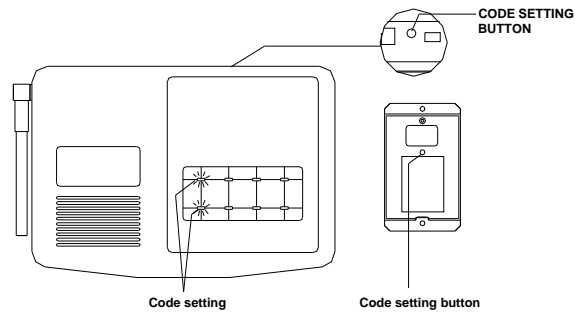

Figure 7. Position of the learn code switch of the main unit and the transmitter

Operation of the ENTRY ALERT

1. Operation of the magnetic sensor transmitter

When the door is closed and the magnet strip is in proximity to the door transmitter unit, there is not signal to the main receiving unit. When the door is opened, the main unit will give red door open light and light beeping sound.

2. Inhibit of all sound

There is a sound disable switch at the rear panel of the main unit. All beeping is off when the switch is at an OFF position. The factory default setting is ON.

Trouble Shooting

	SYMPTOM	POSSIBLE REASON	CORRECTION
1	No function	Battery is running out.	Replace battery.
		Battery is inserted in the reverse direction.	Re-insert the battery in the right direction.
		The AC adapter is not connecting properly to the main receiving unit	Check the connection to the AC adapter.
		The transmitter is too far away from the receiving unit.	Move the two units closer.
2	Intermittent operation	The battery in the transmitter is getting low after prolonged use.	Replace with new battery.

Specifications

1. Magnetic sensor transmitter

Battery	Lithium CR2032
Current consumption	5mA in transmission
Transmitter code	28 bit random address code.
Range	Up to 150 ft.



iMAX
TECHNOLOGY LIMITED
Copyright 2004
<http://www.imax.com.hk>
E-mail: sales@imax.com.hk
Made in China Rev: 1.0