

## Appearance

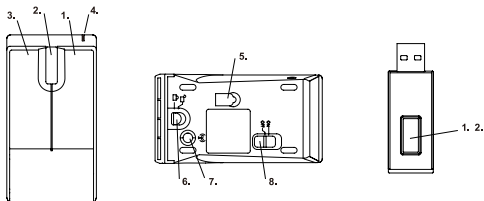

### - Mouse Body

1. Right Button
2. Scrolling Wheel
3. Left Button
4. Low-Power-Alert LED (Orange)
5. Sensor LED (Red)
6. Upper Cover Lock
7. Receiver Link Button
8. Power Switch

### - Receiver

1. Receiver link button
2. build-in LEDs  
(including 1 green & 1 red)

## Before Using

1. Install Batteries.
2. Turn the power on.
3. Connecting the receiver to the laptop
4. Linking the mouse and receiver for connection

## **Install Batteries**

1. Un-lock the Upper Cover Lock.

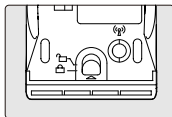

2. Remove the upper cover.

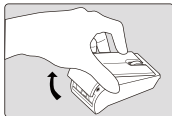

3. Install two AAA batteries into the CM-900/ 2.4GHz Piano Mouse's battery slot (if you had installed the batteries, please remove the old one before install the new batteries).



## **Connecting the receiver to the laptop**

Plug the USB receiver into an available USB port on your laptop. The receiver's LED turns green, and blink, and then your laptop identifies the receiver while a default driver is installed.

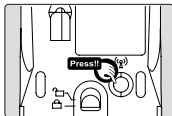

*Important: If a message or dialog box appears on the screen, follow the on-screen prompts to complete the driver installation.*

## **Linking the mouse and receiver**

The mouse has 256 identification codes that allow the mouse and its receiver to operate without interference from other RF devices. After your computer detects the USB receiver and then default driver is installed, you must make a communications link between the mouse and its receiver before you can use the mouse.

### **- Communications link is as the below steps :**

1. Press and release the link button on the receiver. The receiver lights first blinks in green when the receiver is activated, and then turn off.
2. Press and release the link button on the bottom of the mouse. The two devices establish their communication link. The receiver lights first blinks in green, and per mouse motions could be detectable and reflected as well as green blinks.

## **Button Switch**

1. Press and hold both buttons for 3 seconds, then release buttons.

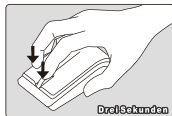
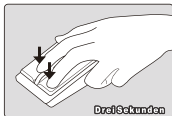

2. The left button and right button had been functional reversed.



3. If you want to switch buttons back to its original functional definition, please repeat the above step 1 and step 2 for change.



### **Conserving power of the Piano Mouse body**

When the mouse batteries are running low on power, the LED light on the Mouse turns orange and blink; and the LED inner the Receiver lights as well as the index in red.

*To use your mouse's Sleep mode based on the below steps :*

1. Do not use your mouse for five minutes. After five minutes of inactivity, the mouse automatically enters Sleep mode to conserve batteries' power.
2. To wake up the mouse, just move the mouse or click either mouse buttons.

## Table OF Contents

---

English .....	1
Español .....	5
Italiano .....	9
Deutsch .....	13
Françai .....	17
Russkey.....	21

### DGT Warning Statement

第十二條 經型式認證合格之低功率射頻電機，非經許可，公司、商號或使用者均不得擅自變更頻率、加大功率或變更原設計之特性及功能。

第十四條 低功率射頻電機之使用不得影響飛航安全及干擾合法通信；經發現有干擾現象時，應改善至無干擾時方得繼續使用。前項合法通信，指依電信法規定作業之無線電通信。低功率射頻電機須忍受合法通信或工業、科學及醫療用電波輻射性電機設備之干擾。

### FCC warning statement:

You are cautioned that changes or modifications not expressly approved by the party responsible for compliance could void your authority to operate the equipment.

This device complies with part 15 of the FCC rules. Operation is subject to the following two conditions

- (1) This device may not cause harmful interference and
  - (2) This device must accept any interference received, including interference that may cause undesired operation
1. This transmitter must not be co-located or operating in conjunction with any other antenna or transmitter.
-