

INSTRUCTIONS:

Deadbolt latch must operate easily. (if not see reverse*).
Open door and lock deadbolt to begin.

PARTS LIST

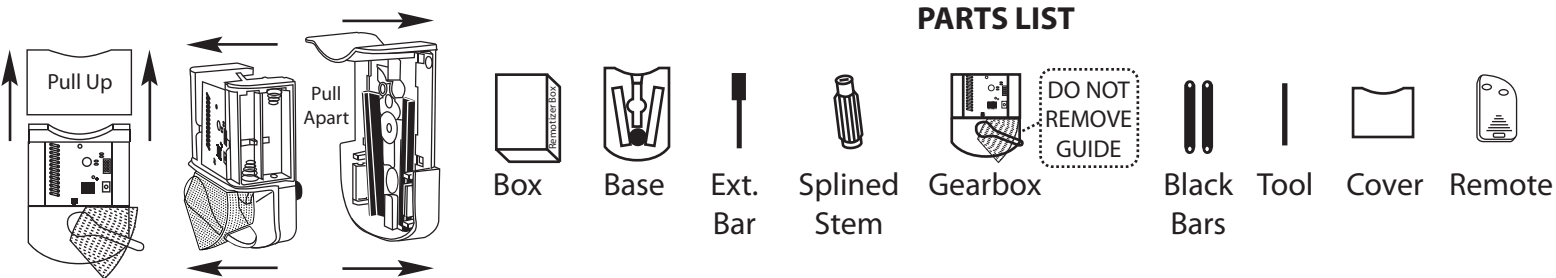

1. Place base on box to make ready for one screw.

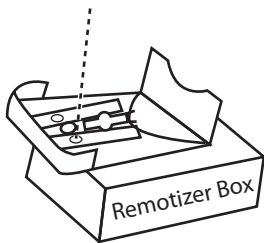

2. Hold outside lock in place,

WHILE

removing inside thumbturn.

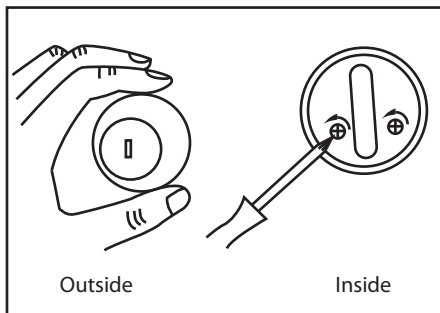

3. Install base with one screw. Add next screw. -- Don't over tighten!

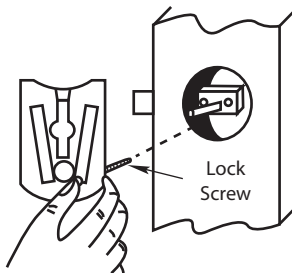

4. Slide splined stem proper end over tail piece of lock -- some locks differ.

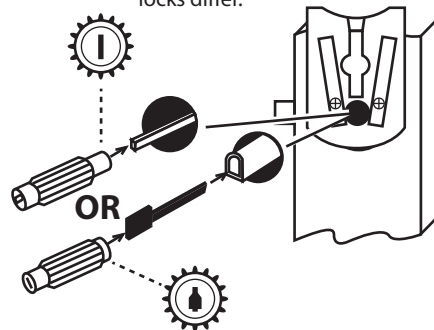

5. From inside, is door left or right?
Set gearbox: Turn and keep turning gear until knob stops in position.

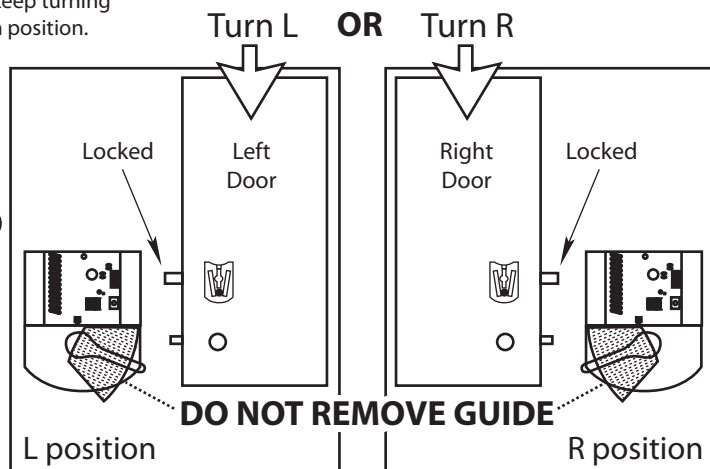
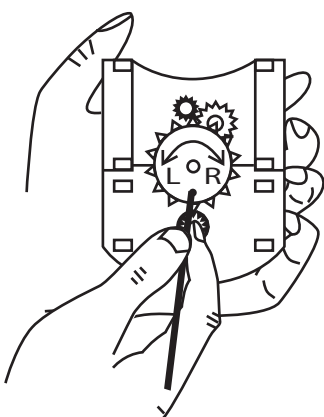

6. With door LOCKED, slide black tip on to splined stem.

WHILE guiding under top cap.

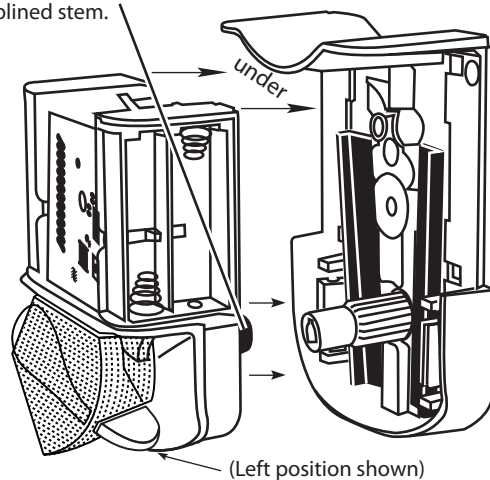

7. Insert black bars (in tiny grooves) in both left and right sides of gearbox.

8. Then slide bars down through holes as far as possible, and install 4 AA batteries..

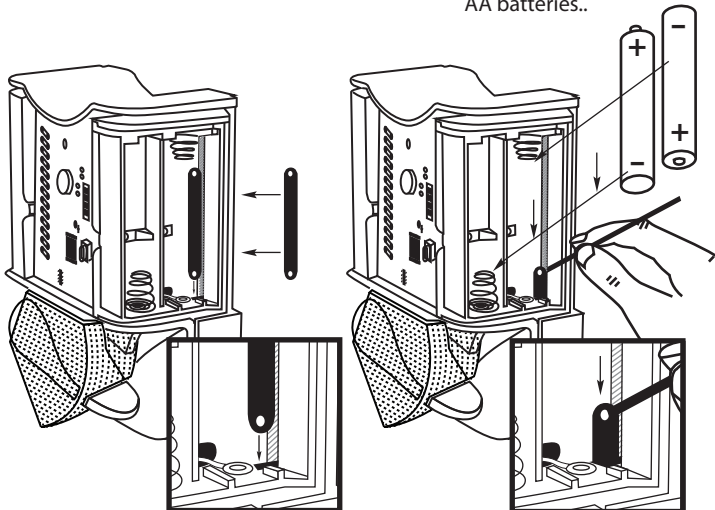

9. Program Remotizer by pressing white button.

THEN

Quickly press either button on remote. Hear 3 beeps.

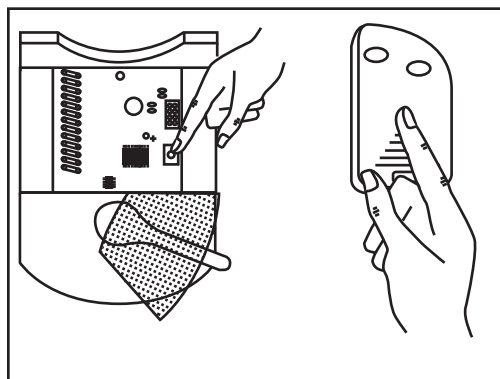

10. Slide cover down and remove handle guide.

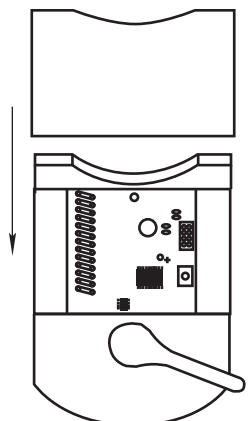

Enjoy!

WARRANTY

MR. BUTLER LLC WARRANTS TO THE ORIGINAL RESIDENTIAL USER OF THIS PRODUCT THAT IT WILL BE FREE FROM DEFECTS IN MATERIALS AND WORKMANSHIP, UNDER NORMAL USE, FOR ONE YEAR FROM THE DATE OF PURCHASE. USER MUST PROVIDE A COPY OF ORIGINAL PURCHASE RECEIPT. THIS WARRANTY DOES NOT COVER ABUSED OR MISUSED PRODUCTS. THIS WARRANTY DOES NOT APPLY TO UNITS THAT HAVE BEEN IMPROPERLY INSTALLED, MODIFIED, USED OTHER THAN DESIGNED, OR SUBJECTED TO ACTS OF GOD. **THIS WARRANTY IS LIMITED TO REPAIRING, REPLACING OR REFUNDING THE ORIGINAL PURCHASE PRICE AT THE DISCRETION OF MR. BUTLER LLC. MR. BUTLER LLC WILL NOT BE LIABLE FOR THE COST OF INSTALLING OR REMOVING THIS PRODUCT, NOR DIRECT, INDIRECT, OR CONSEQUENTIAL DAMAGE TO PERSONS OR PROPERTY RESULTING FROM THE USE OF THIS PRODUCT. TO USE THIS WARRANTY, ENCLOSE A COPY OF THE RECEIPT, TELEPHONE NUMBER, AND A CHECK OR MONEY ORDER OF \$10.00 FOR SHIPPING AND HANDLING.

RETURN FREIGHT PREPAID TO:
MR. BUTLER LLC
310 MORTON ST., SUITE #205
RICHMOND, TX 77469 USA

** OR PRODUCTS USED IN COMMERCIAL APPLICATIONS

* If door is mis-aligned, make necessary adjustment to deadbolt strike and/or hole in the door jam. A hardware store man who knows locks, may show an easy way to make the adjustment. The manufacturer is not responsible for any radio or TV interference caused by unauthorized modifications to this equipment. Such modifications would void the user's authority to operate the equipment.

TROUBLESHOOTING:

- If Remotizer doesn't beep or lock properly:
Re-install and make sure you put it in LOCKED POSITION.
- Also, make sure you positioned the knob by rotating the gear properly.

This device complies with Part 15 of the FCC Rules. Operation is subject to the following two conditions: 1) This device may not cause harmful interference, and 2) This device must accept any interference received, including interference that may cause undesired operation.

To prevent someone who has a transmitter from activating your Remotizer:

1. Pull off cover to Remotizer.
2. Press white button AND HOLD IN until you hear one loud beep (cleared).
Now all remotes won't work.
3. Program remote you want to use (up to 6 different remotes) per programming instructions on front page.

VIEW INSTALLATION VIDEO AND ORDER ADDITIONAL REMOTES

WWW.REMOTIZER.COM