

Device Layout

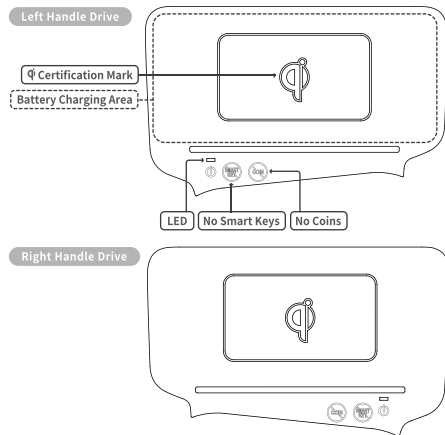

Caution

Q Certification Mark

Mark shows the product is certified by the WPC, using Q technology.

No Smart Keys

Do not place smart keys on the charger while charging.

No Coins

Do not place coins on the charger while charging.

Only products that have obtained standard certification by WPC (Q) are permitted use.

Using the Wireless Phone Charger

1. This product operates when you press the "ACC" start button, that is, when the product is activated.
2. The user must check on whether the product's LED (BLUE) has flickered two times, and then has turned off.
3. Place the cell-phone at the center of the charger. The farther the phone gets from the center, the lower the efficiency of the charging.
4. When charging starts, you will be able to see the LED (BLUE) light turning on.
5. When the charging is done, you will be able to see the LED light change from blue to green.

If the charging does not seem to go well, or if the LED (BLUE) light keeps on flickering, refer to the Problem Solving/Help section. Also, lift your cell-phone up and then shift its place again to the center of the charger. Check again whether the charger is working.

Problem Solving /Help

When the product is not charging

- Please check whether your device meets the Q standards.
(This product only works for products that have been approved by the WPC standards.)
- Adjust the device so it can be placed at the center of the charger.
- Please check whether there are other substances (such as coins, keys, magnetic cards, tops of cans, etc.) on the wireless charger. If there are other objects on it, please remove them and then try using the charger again.

When the charging LED is flickering

- Please check whether your device is placed properly

When the charging LED does not turn on

- Please check whether the ignition key of the car, "ACC" is on.
- Please check whether there are other substances on the charger.

When the message "No smart key inside" appears,

- Please remove the smart keys to another place, places outside the boundaries of wireless charging.

Caution, Services Information

- Do not put smart keys, coins, or magnetic cards on the wireless charger.
- Do not put wet tissues, water, or other liquids on the wireless charger.
- Do not dismantle or remodel the charger.
- When the cellphone moves and detaches while driving, stop the car and then put the cellphone back in its place.
- Do not put heavy or unfixed objects on the charger.
- Put any machinery or device that can be affected by magnetic fields far from the wireless chargers.
- Cell phones larger than the battery charging areas may not be charged.
- If problems or malfunctions occur while using, please contact the Direct Management Center of Hyundai Motors, or Hyundai Mobis Customer Service Center.
- Refer to pictures(9parts) before using the product.
- If your charge your cellphone with a cellphone case attached to it, it might not be charged.
- In cases of small cellphones placed at the end of the charger, they might not be charged.
- If the charging covers are not the ones produced by the official cellphone manufacturers, cellphones using the unauthorized covers may not be charged.
- Do not remove anything from the vehicle unless it needs to be replaced or removed for wireless charger repair.
- If removed, the double-sided tape may remain on the vehicle and remove the double-sided tape carefully.

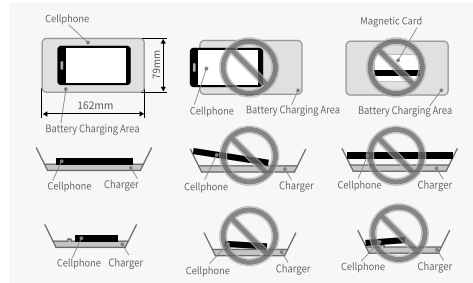

FCC Statements

For a Class B digital device or peripheral, the instructions furnished the user shall include the following or similar statement, placed in a prominent location in the text of the manual :

NOTE

This equipment has been tested and found to comply with the limits for a Class B digital device, pursuant to part 15 of the FCC Rules. These limits are designed to provide reasonable protection against harmful interference in a residential installation. This equipment generates, uses and can radiate radio frequency energy and, if not installed and used in accordance with the instructions, may cause harmful interference to radio communications. However, there is no guarantee that interference will not occur in a particular installation. If this equipment does cause harmful interference to radio or television reception, which can be determined by turning the equipment off and on, the user is encouraged to try to correct the interference by one or more of the following.

measures

- Reorient or relocate the receiving antenna.
- Increase the separation between the equipment and receiver.
- Connect the equipment into an outlet on a circuit different from that to which the receiver is connected.
- Consult the dealer or an experienced radio/TV technician for help.

This device complies with Part 15 of the FCC Rules.

Operation is subject to the following two conditions : (1) this device may not cause harmful interference, and (2) this device must accept any interference received, including interference that may cause undesired operation.

FCC ID : SKU-G6F76AC500

Model : G6F76-AC500

Power : DC 12.0V

FCC CAUTION

Any changes or modifications in construction of this device which are not expressly approved by the party responsible for compliance could void the user's authority to operate the equipment.

FCC NOTE

The manufacturer is not responsible for any radio or TV interference caused by unauthorized modifications to this equipment. Such modifications could void the user's authority to operate the equipment.

This device should be installed and operated with minimum 20cm between the radiator and your body.