

See-Through Mobile Viewer
MOVERIO
BT-200

EPSON
EXCEED YOUR VISION

User's Guide



Copyright©2014 Seiko Epson Corporation. All rights reserved.
Printed in Philippines XX.XX.-XX(XXX) 2014.3



Welcome to the BT-200

This product is standalone, see-through mobile viewer for both eyes.

It allows you to enjoy movies on home networks, or images on smartphones, tablet devices, and so on in comfort.

Saving and Viewing

You can transfer movies and images saved on a computer to this product, and then watch them.

Simply connect by USB

➔ **“Viewing Movies Copied from a Computer (Gallery)” on page 27 (this guide)**

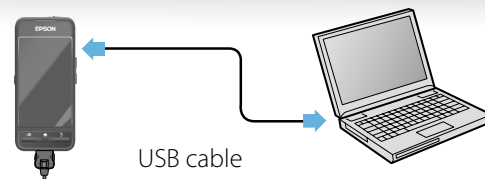

Viewing on a Website

By connecting to the Internet over Wi-Fi, you can view movies on a Website.

Search for movies on a Website

Use on-demand movie services

➔ **“Viewing Movies on a Website (Browser)” on page 28 (this guide)**



Viewing on a Home Network

This product allows you to watch movies stored on a computer with DLNA server devices or a DLNA server function wherever you like in your home.

Supports DLNA

DLNA is technology that connects supported devices through a wireless router and streams movies and music.

➔ **“Viewing Movies on a Home Network Using a DLNA Function (MOVERIO Air)” on page 29 (this guide)**

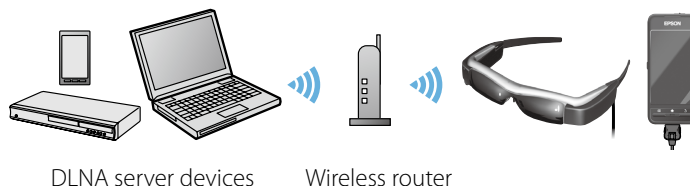

Viewing Images on a Smartphone

This product allows you to view images currently being played back on a smartphone.

Supports Miracast

Miracast is technology that wirelessly connects supported devices directly and streams movies and music. This product supports image reception from other devices, and streaming images to other devices.

➔ **“Synchronizing Other Devices and Screens (MOVE-RIO Mirror)” on page 31 (this guide)**

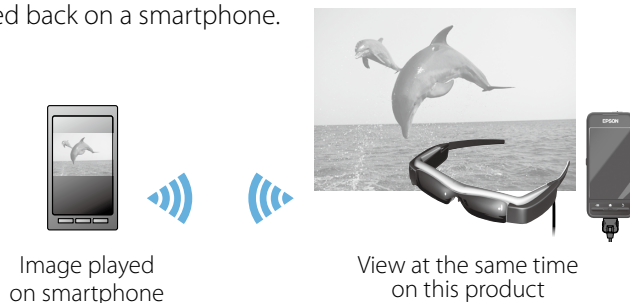

Contents



Safety Instructions6

Getting Ready9

Part Names and Functions..... 9

Charging 11

Wearing the Headset 12

Turning On and Off..... 14

Operations16

Using the Trackpad..... 16

Using the Home Screen 19

Initial Settings..... 23

Viewing Tips..... 25

Viewing Images.....27

Viewing Movies Copied from a Computer (Gallery) ... 27

Viewing Movies on a Website (Browser)..... 28

Viewing Movies on a Home Network Using a DLNA Function (MOVERIO Air) 29

Synchronizing Other Devices and Screens (MOVERIO Mirror)..... 31

Troubleshooting33

Specifications.....35

Intellectual Property Rights.....37

General Notes38

User's Guide Organization

■ Booklet Manual (paper)

User's Guide (this guide)	This guide provides information on how to use this product safely, basic operating methods, troubleshooting, and so on. Make sure you read this guide before using the product.
Startup Guide	This guide provides information on using this product for the first time.

■ Electronic Manual (Web)





Reference Guide	This guide provides information on applications supported by this product, setting items, and troubleshooting. This can be viewed as a PDF file or Help application. See http://www.epson.com for more details.
------------------------	--

Symbols Used in this Guide

■ Safety symbols

 Warning	This symbol indicates information that, if ignored, could possibly result in serious personal injury or even death due to incorrect handling.	 Caution	This symbol indicates information that, if ignored, could possibly result in personal injury or physical damage due to incorrect handling.
---	---	---	--

■ General information symbols

 Caution	Indicates procedures which may result in damage or injury if sufficient care is not taken.	 Note	Indicates additional information and points which may be useful to know regarding a topic.
 []	Indicates icons and menu items displayed on the screen, and the names of controller keys.	 →	Indicates a reference to related topics.

Safety Instructions

Warning Risk of fire, electric shock, or accident

Only use this product at the stated power-supply voltage.

Only use the USB cable and AC adapter supplied.

Do not use the supplied AC adapter with any other device.

Note the following points when handling the AC adapter.

- Do not plug the AC adapter into an outlet being used by many other devices.
- Do not plug in the AC adapter if there are any foreign objects such as dust stuck to it.
- Plug in the AC adapter securely.
- Do not hold the AC adapter with wet hands.
- Do not unplug the AC adapter by pulling on its cable.

Note the following points when handling the power cable (the microUSB cable supplied).

- Do not use the cable if it is damaged.
- Do not modify the cable.
- Do not place heavy objects on the cable.
- Do not bend, twist, or pull the power cable excessively.
- Do not place the wire near an electrical heater.

Do not use the product in locations where it may get wet or be subject to humidity such as in the rain or in a bath or shower. Do not place containers containing water, chemicals, or other liquids near this product.

Do not place this product in locations subject to smoke, steam, high humidity, or dust such as kitchen counters or near humidifiers.

Do not touch the AC adapter during a thunderstorm.

Do not disassemble or remodel this product (including consumable items).

In the following situations, turn off this product immediately, unplug the AC adapter, and contact an authorized Epson dealer.

- If you see smoke, or notice any strange odors or noises.
- If any water or foreign objects get into the product.
- If the product was dropped or the case was damaged.

Warning Risk of deformation due to fire or heat

Do not leave this product in locations subject to extremely high temperatures such as cars with the windows closed, in direct sunlight, or in front of air-conditioning or heater outlets.

Do not place combustible items, such as candles, near this product.

Warning Risk of fire or burns

Do not cover this product or the AC adapter with a cloth or similar material during use.

Warning Risk of malfunction or electric shock

Do not clean this product with a wet cloth or solvents such as alcohol, benzene, or thinner.

Warning Risk of hearing impairment

Do not start using this product at a high volume.

 Permanent hearing loss may occur if earphones or headphones are used at high volume for prolonged periods of

time. Set to an appropriate volume.

Warning Risk of injury or poisoning

Do not disassemble or remodel this product.

Do not wear this product when driving, cooking, or performing any other dangerous tasks.

Warning Risk of interference with other electronic devices

Check that there is no medical equipment in the area before use as this product may cause electromagnetic interference on medical equipment or cause the equipment to malfunction.

When taking this product into areas in which the use of electromagnetic waves is prohibited, such as on aircraft or in hospitals, turn off this product or disable the wireless LAN or Bluetooth function.

Note the following points when using wireless LAN or Bluetooth in medical institutions.

- Do not bring this product into operating rooms, Intensive Care Units (ICUs), or Cardiac Care Units (CCUs).
- When on wards, turn off this product or stop the electromagnetic waves.
- Even when not on wards, turn off this product or stop the electromagnetic waves if there is any electronic medical equipment in the area.
- Follow any rules stipulated by medical institutions that prohibit the use of devices emitting electromagnetic waves, or that prohibit entry to certain areas with such devices.

If you have an implanted pacemaker or implanted defibrillator, make sure you keep a distance of at least 22 cm between this product and the implanted device when using the wireless LAN or Bluetooth. Before use, make sure that there is no one with a pacemaker near you, and if you are in a crowded location such as a train, turn off this product or stop the electromagnetic waves.

Do not use wireless LAN or Bluetooth near automatically controlled devices such as automatic doors or fire alarms because it may cause electromagnetic interference which could cause an accident to occur or the devices to malfunction.

In locations where usage is restricted, such as on aircraft or in hospitals, follow the on-site rules (such as airplane announcements).

Caution Risk of fire, electric shock, or accident

For safety reasons, when you have finished using this product, make sure you turn it off.

When performing maintenance, make sure you unplug the AC adapter and disconnect all wires.

Caution Risk of burns

Do not touch the hot sections of the AC adapter for a while after use.

Do not use this product for extended periods of time if the controller is touching any part of your skin.

Caution Risk of impaired vision

When wearing this product, do not look directly at the sun or at any bright lights.

Caution **Risk of damage or malfunctions**

Do not place this product in locations subject to vibrations or impacts.

Do not use or store this product in locations subject to high or low temperatures. Also, avoid locations subject to sudden changes in temperature.

Do not use this product in environments outside the operating temperature range, such as tropical climates.

Do not place this product near high-voltage lines or magnetized items.

Caution **Risk of deterioration in image quality**

Do not use or store this product in locations subject to smoke.

Caution **Risk of injury or feeling sick**

Do not drop this product or treat it with unnecessary force.

When wearing this product, please be aware of the edges of the frame.

Do not place your finger between the moving parts of this product, such as the hinges.

Make sure you are wearing this product correctly.

Do not carry this product by its cable.

This product should only be used for viewing images.

If a problem or malfunction occurs, stop using this product immediately.

Stop using this product if your skin feels unusual when wearing this product.

Always take periodic breaks when viewing images using this product.

If you feel fatigued or uncomfortable when viewing with this product, stop viewing immediately.

Do not place any breakable or fragile objects in your immediate surroundings when using this product.

Only wear this product when viewing images. Do not move around while wearing this product.

Do not use this product if you are sensitive to light, or feel sick.

Children (especially under elementary school age) should not use this product as their eyesight is still developing.

Caution **Risk of injury or poisoning**

Contact an authorized Epson dealer when replacing batteries.

Dispose of this product in accordance with your local laws and regulations.



You can recycle used lithium-ion batteries. When the product's internal battery reaches the end of its service life, contact a service center for information on recycling.

Getting Ready

Part Names and Functions

Controller

Trackpad

Touch with your finger to operate the product.

➔ **"Using the Trackpad" on page 16 (this guide)**

microSD card slot

Insert a commercially available microSD card.

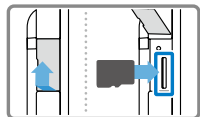

Switch key

Switches the operation performed when you press the Up/Down keys between adjusting the volume, adjusting the brightness, and switching between 2D/3D mode.

MENU key

Displays available menus for the current screen.

HOME key

Press to return to the Home screen.

Power switch

Slide to the [⏻] side to turn on and off the product.

Slide to the other side to turn on and off Key lock.

➔ **"Turning On and Off" on page 14 (this guide)**

LED indicator

Indicates the status of the product.

➔ **"Understanding the LED indicator" on page 12 (this guide)**

micro-USB connector

Connects the supplied USB cable.

Up/Down keys

Adjusts the volume. Press the Switch key to change the mode between adjusting the volume, adjusting the brightness, and switching between 2D/3D mode.

BACK key

Displays the previous screen.



Headset

Mute knock

Tap twice to temporarily hide the image and mute the audio. Tap twice again to restore the image and audio. Since the images and audio continue while muted, you cannot restart from the point the scene was muted.

Camera/Indicator

Captures images and movies.

➔ **“Preinstalled applications”** on page 21 (this guide)

Shade

Shades the product from too much exterior light. The darkness of the shade changes how the surrounding environment and images are viewed.

Headset connection port

Connects the controller.

➔ **“Charging”** on page 11 (this guide)

Arms

Open the arms to wear.

➔ **“Wearing the Headset”** on page 12 (this guide)

Nose pads

By changing the width and position of the pads, you can adjust the height of the lenses to a suitable position.

Earphone socket

Connects the jack for earphones. You can also connect commercially available earphone microphones.

➔ **“Wearing the Headset”** on page 12 (this guide)

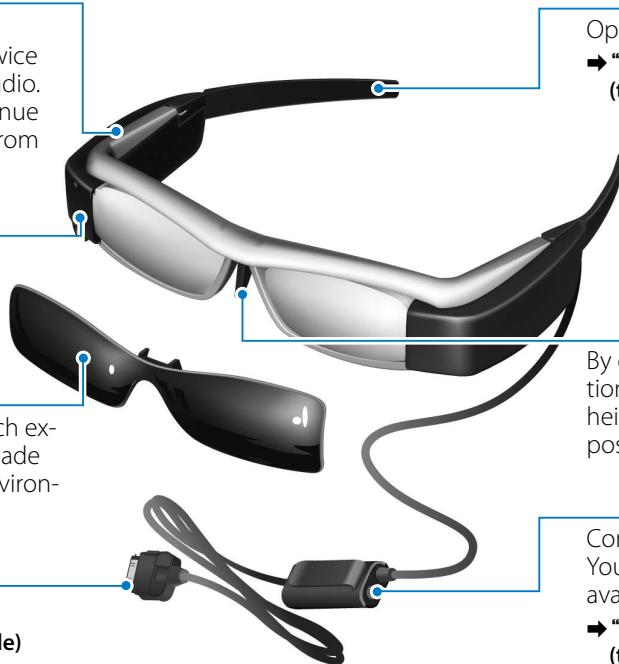

Charging

The product is not fully charged at the time of purchase. Charge before use.

This section explains how to charge using the AC adapter. Initial charging takes approximately 5 hours.

1 Connect the headset and the controller.

Insert the headset's connection cable into the controller's headset connection port until it clicks.

2 Connect the controller and AC adapter.

Connect the controller and the AC adapter with the USB cable.

3 Plug in the AC adapter.

The LED indicator flashes green.

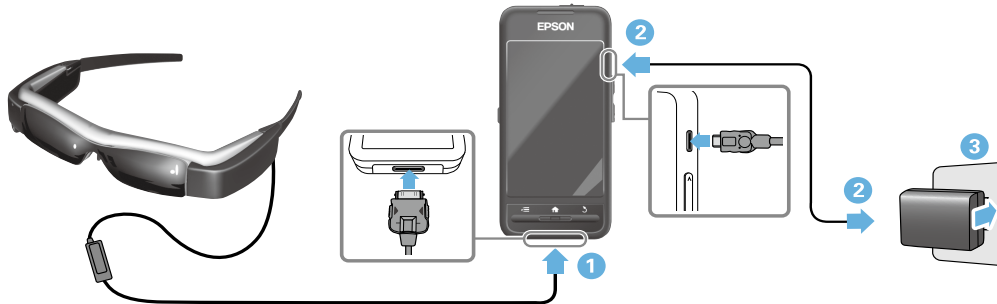

Charging is complete when the LED indicator stops flashing and changes to lit green. Disconnect the AC adapter and the USB cable.

Battery life is approximately six hours. Battery life may vary depending on application and environmental usage conditions.

Understanding the LED indicator

This indicates the status of the product using colors and the lit status of the LED.

Green	Operating
Flashing green (one second intervals)	Starting up / Shutting down
Flashing green (two second intervals)	Charging
Flashing red	Battery running low/Startup error
Flashing red three times	Insufficient battery to start up
Blue	Sleep mode

Wearing the Headset

- 1 Use both hands to open the arms, and then put on the headset.



Caution

Do not use too much force when opening the arms of the headset.

Note

If the headset does not feel secure when wearing it, attach the ear hooks supplied.

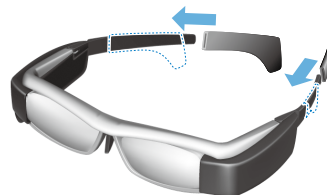

2 Adjust the width and position of the nose pads so that the lenses are at eye level.

Adjust the height so that images can be viewed easily.
Adjust the nose pads to fit the shape of your nose.

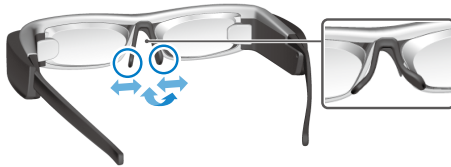

3 Connect the earphones to the earphone socket.

Attach the earphones before playing back any content.
Noise may be heard if the earphones are disconnected or connected while content is being played.

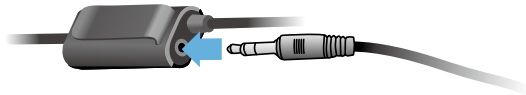

4 Wear the earphones.

For people who wear glasses

The headset can be worn over glasses that are up to 145 cm wide.

Note

When wearing the headset over glasses, adjust the width of the nose pads for the headset so that they are narrower than the nose pads for the glasses. Wear the headset so that the nose pad for the headset rests on your nose in the gap between the frames of the glasses.

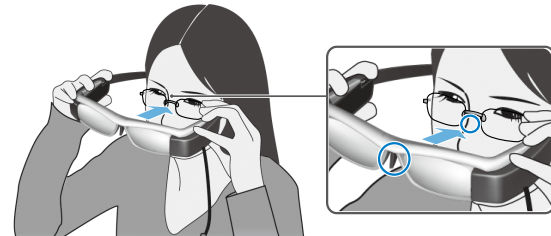

By using the lens holders supplied, you can wear the headset without the problems normally associated with wearing a headset over glasses.

If you visit your local opticians, they can install your lenses into the lens holders and attach them to the headset. (The customer is responsible for the cost of the lenses. Depend-

ing on the opticians, they may not be able to perform this procedure.)

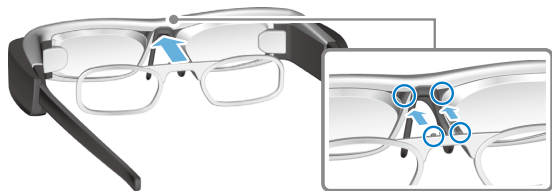

Lens holder supported lenses

Lens (W x H)	45 x 25 mm
Nose pads	26 mm
Frame PD	71 mm
Curve	4

Note

You may not be able to view images when using special lenses such as colored lenses, mirrored lenses, and polarized lenses.

Turning On and Off

Turning on

Note

Before turning on the product, check the charge level.

➔ **“Charging” on page 11 (this guide)**

- 1 Slide the power switch to the [⏻] side and hold it there until the LED indicator turns green.



The LED indicator flashes green when starting up. Startup is complete when the indicator changes from flashing to lit green. Wear the headset and check that the Home screen is displayed.

Note

- See the following for information on using the trackpad.
➔ **“Using the Trackpad” on page 16 (this guide)**
- **Turning off the screen while the product is on (Sleep mode)**
When you slide the power switch briefly to the [⏻] side, the product enters Sleep mode and the LED indicator

turns blue. You can release Sleep mode by briefly sliding the power switch to the [] side again.

• Disabling controller operations (Key lock)

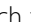
Slide the power switch to the side opposite the [] to turn on Key lock. To release Key lock, slide the power switch to the center.

Turning off

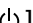
- 1 Slide the power switch to the [] side and hold it there for at least one second.



The [Power off] screen is displayed.

- 2 Touch the trackpad, move [] to [OK], and then tap the trackpad to confirm.

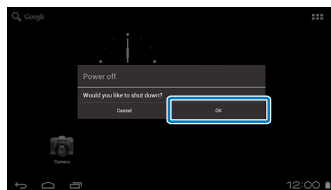

The power turns off.

Note

If operations freeze, you can force the product to shutdown by using one of the following methods.

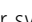
- Slide the power switch to the [] side and hold it there for at least eight seconds.
- Use something thin to press the reset button for at least two seconds.

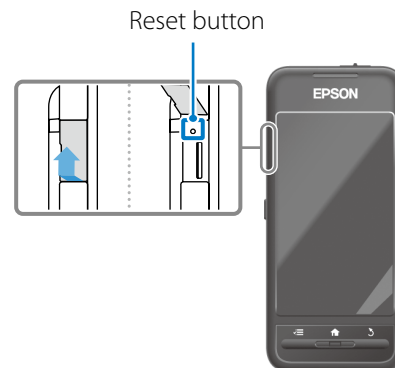

Caution

Do not force the product to shutdown unless operations freeze.

Stored data and settings may be lost.

Operations

Using the Trackpad

This section explains how to operate the product using the trackpad.

When you touch the trackpad with your finger, a pointer is displayed on the screen. Move the pointer to operate the product.

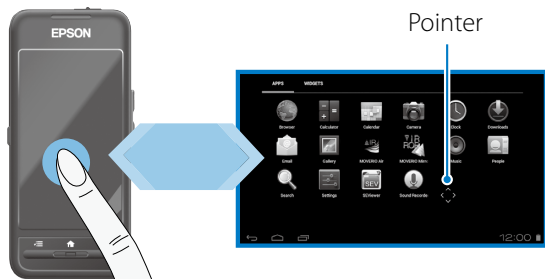

Operation methods

■ Tap

Move the pointer to an icon or display item, and then tap the trackpad. This launches applications, selects items, and so on.

Pointer format: 



■ Drag

Touch the track pad for about one second to select the icon or display item, and then drag your finger on the trackpad to move it. This moves icons, scrolls or changes the screen, and so on.

Pointer format: 



■ Flick

Swipe your finger with a dragging motion, or swipe the trackpad with two fingers.



Pinch out

Enlarges the size of the screen by moving two fingers apart.



Pinch in

Reduces the size of the screen by moving two fingers closer together.



Cross-key function

Allows you to move and confirm selected items.

Up/Down keys

Move your finger up or down along the edge of the screen to move the selected item up or down. Hold your finger in place to keep moving up or down beyond the current screen view.

The following buttons are displayed on the right of the screen during Up/Down key operations.

Up/Down buttons: [] []

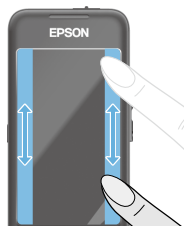

Left/Right keys

Move your finger right or left along the edge of the screen to move the selected item right or left. Hold your finger in place to keep moving right or left beyond the current screen view.

The following buttons are displayed on the right of the screen during Left/Right key operations.

Left/Right buttons: [] []

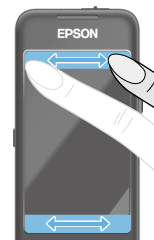

Select key

Tap any corner to confirm the selected item.

The following button is displayed on the right of the screen during Select key operations.

Select button: []



Entering text

Tap a location where text entry is possible to display the software keyboard. Tap the keyboard to enter text.

Changing the text entry mode

Tap the [AB12] key on the keyboard to change the type of characters entered by the keyboard.



Note

You can make detailed settings in [Settings] - [PERSONAL] - [Language & input]. See the Reference Guide for more details.

Using the Home Screen

You can launch applications and perform various settings from the Home screen.

The following screen is the initial screen you see when using this product.

Press the [] key to display the Home screen.



1 App/Widget area

This area allows you to layout shortcuts and widgets for apps displayed on the Home screen.

2 App/Widget list

Displays the APPS/WIDGET list screen.

3 Status bar

Indicates the status of this product.

4 Virtual buttons

 : Returns you to the previous screen.

 : Displays the Home screen.

 : Displays recently used apps.

Launching an application

Launch an application from the APPS list screen.

Home screen



APPS list screen



App screen



Arranging apps and widgets on the Home screen

Select apps and widgets you want to display on the Home screen from the APPS/WIDGET list screen, and then arrange them.

- 1 On the APPS/WIDGET list screen, move the pointer to the app/widget, and then hold down your finger on the app/widget.



The screen that allows you to select the location to place the icon on the Home screen is displayed.

- 2 Drag to the location you want to place the icon, and then remove your finger.

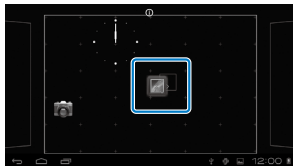

Deleting apps and widgets from the Home screen

Delete apps and widgets that have been placed on the Home screen.

- 1 On the Home screen, hold down your finger on the app/widget you want to delete.

[X] is displayed at the top of the screen.

- 2 Drag the app/widget you want to delete over the [X], and then remove your finger.

