

RF MODULE – INSTALLATION AND USER MANUAL



Congratulations on the purchase of your Techniku automation system with RF (radio frequency) control. After reviewing this instruction guide, simply update or install your automation system to operate with RF (radio frequency) control.

Installation and usage is simple when following the steps in this manual. Before beginning, read this manual in its entirety prior to installing and operating the blind.

With proper installation and care, your automated system with RF communication will provide years of beauty and convenience.

RF MODULE – INSTALLATION AND USER MANUAL

TABLE OF CONTENTS

Install RF Module	3
Install RF Module to Group	3-4
User Instructions	4
Mounting Options	4
Frequently Asked Questions	5
Troubleshooting	5



WARNING: Modifications or changes made by the user without written approval by Techniku will void the warranty and the user's authority to operate the equipment.

RF MODULE – INSTALLATION AND USER MANUAL

FREQUENTLY ASKED QUESTIONS:

- 1.
- 2.

TROUBLESHOOTING:

- 1.
- 2.
- 3.

RF MODULE – INSTALLATION AND USER MANUAL

INSTALL RF MODULE TO GROUP (CONT'D):

Step 7: Verify with Z-Wave controller (i.e.: RF remote control) that unit was successfully added to the group.



CONGRATULATIONS! You have successfully installed RF control to your automated product!

USER INSTRUCTIONS:

In addition to using a variety of Z-Wave controllers, operate the automated product by pressing the button on the RF module. The automated product will toggle between open, stop and close.

MOUNTING OPTIONS:

There are a variety of mounting options to locate the RF module in automated window covering applications including...

In the headrail or roller tube;

Behind the automated window covering;

Anywhere within 3" from the Techniku motor or Intelligence Interface.

RF MODULE – INSTALLATION AND USER MANUAL

INSTALL RF MODULE:



IMPORTANT: On products that require limits to be programmed, set the desired top and bottom limits with IR (infrared) prior to installation. Refer to specific product User Manual for details.



Step 1: Disconnect power (battery holder or power supply) from the Techniku motor, Intelligence Interface (I²) or standard receiver.



IMPORTANT: If automated product is using an IR receiver eye (on motor, I² or receiver), carefully remove the IR receiver from the Communication (COMM) port.

Step 2: Verify automated product (window covering or motor) is installed in final location (i.e.: mounted in window, etc...).

Step 3: Plug RF Module into Communication (COMM) port on Techniku motor or I².



Step 4: Re-connect power (battery holder or power supply) to the Techniku motor or Intelligence Interface (I²). Power must be 6v, 12v or 24v.

INSTALL RF MODULE TO GROUP:

Step 5: Add RF unit to desired group with Z-Wave controller (preferably RF remote control).

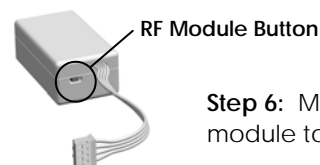

Step 6: Momentarily press the button on the RF module to add unit (automated product) to the group.