

A black and white photograph of three technicians in a warehouse setting. They are working on a large, vertical, rectangular device labeled 'vilant'. One technician is kneeling on the floor, another is standing and leaning against the device, and a third is kneeling in front of it, using a power tool. Various cables and equipment are scattered on the floor. The background shows high industrial shelving units filled with boxes.

Vilant Tracker Charger

User Guide

Vilant Tracker Charger

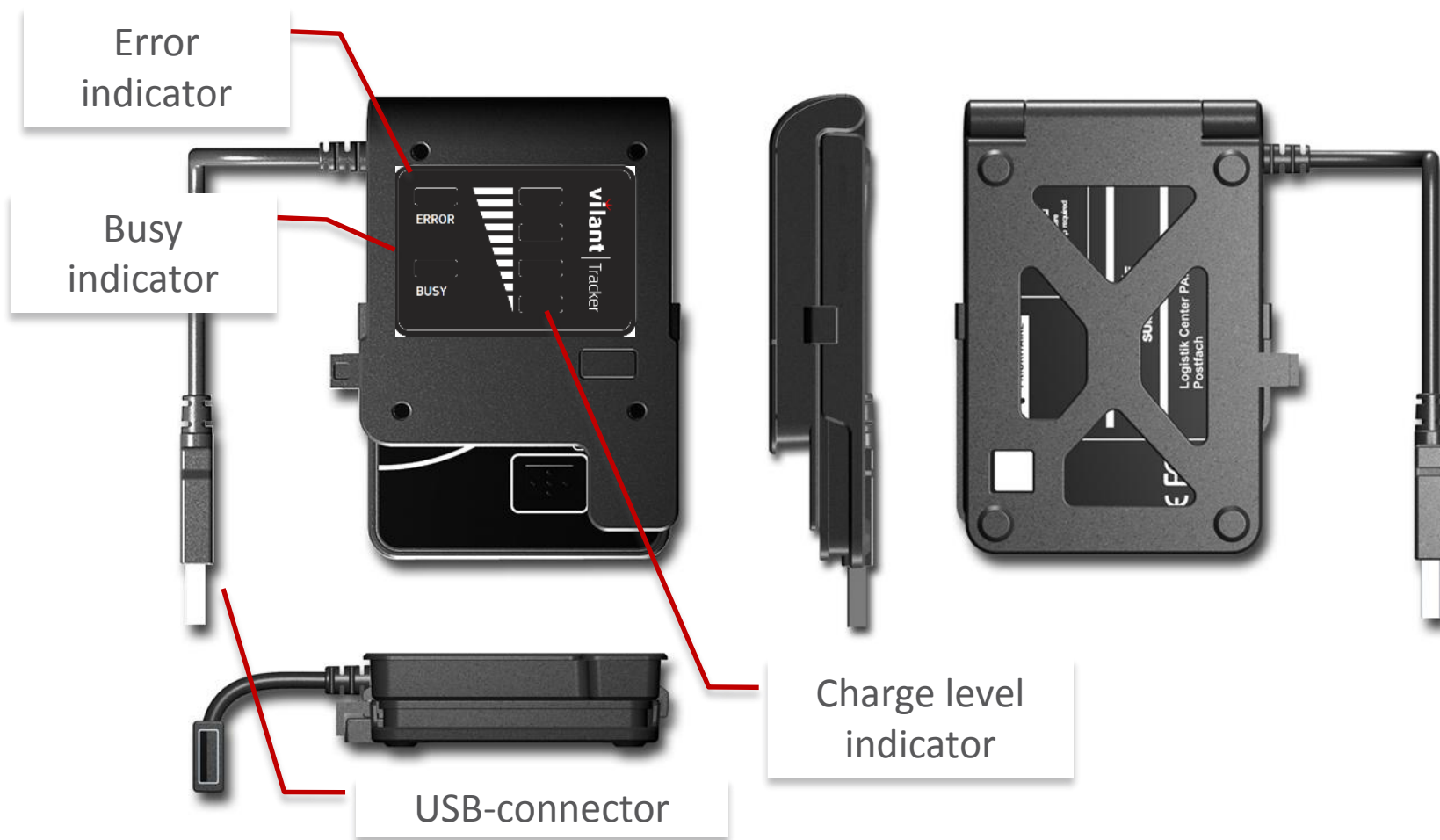

1) Connect to USB port

- On PC or dedicated USB power-supply

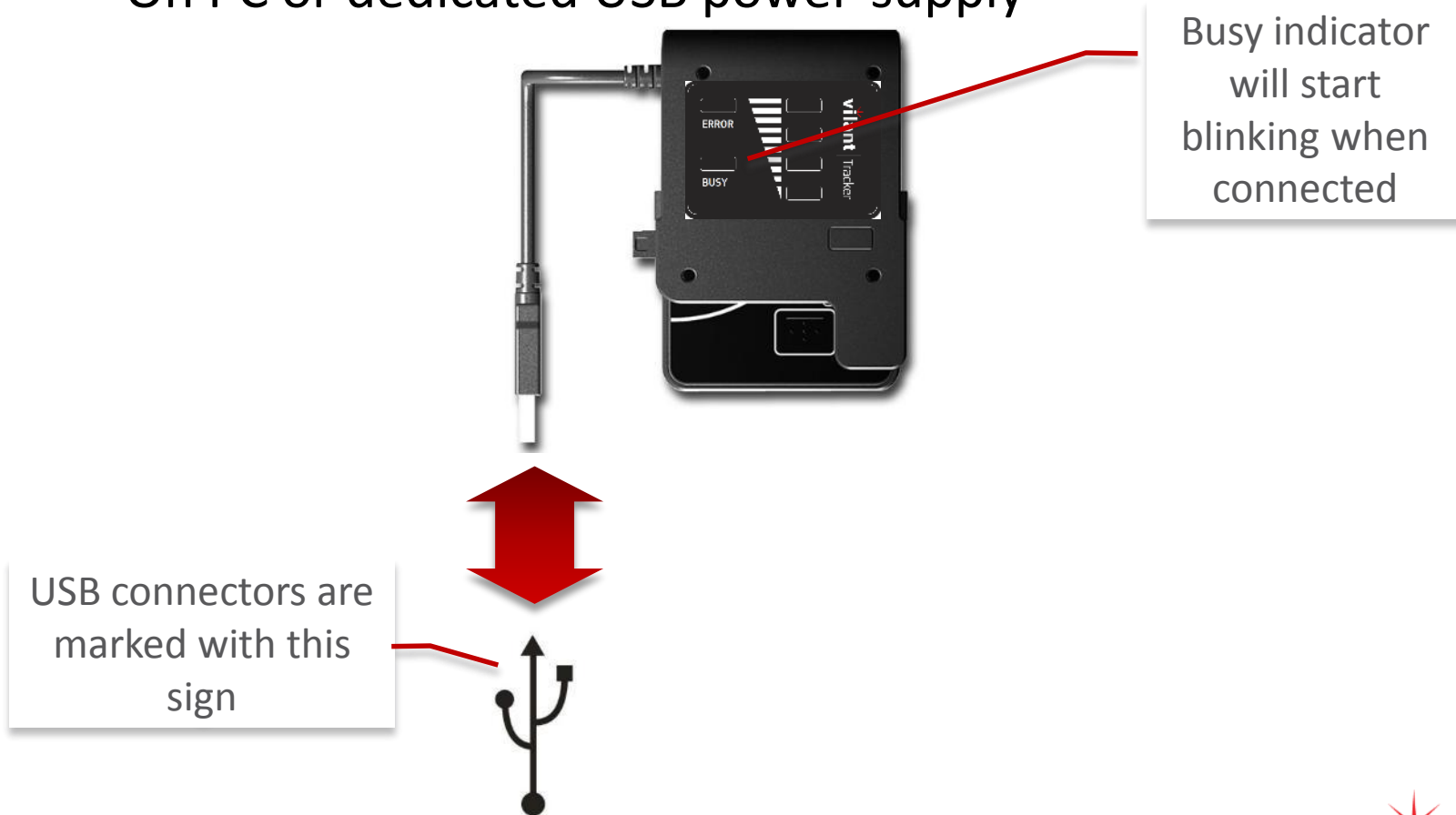

2) Insert tracker and close

- Open charging lid on tracker before inserting

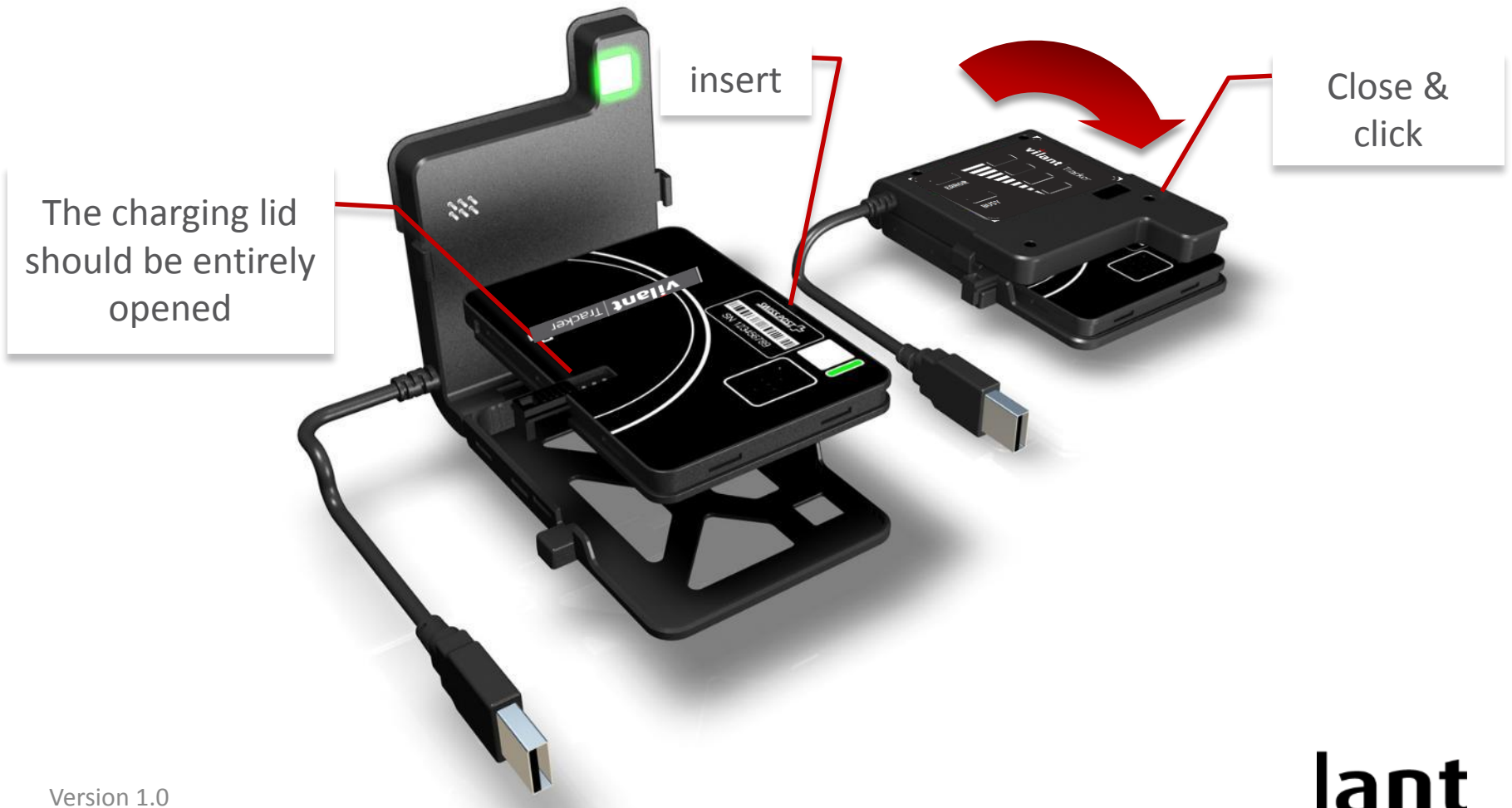

3) Wait during charging

- On PC or dedicated USB power-supply



The green indicators show charging progress. Charging is finished when the busy indicator is off and all green indicators are on

4) Take out the tracker

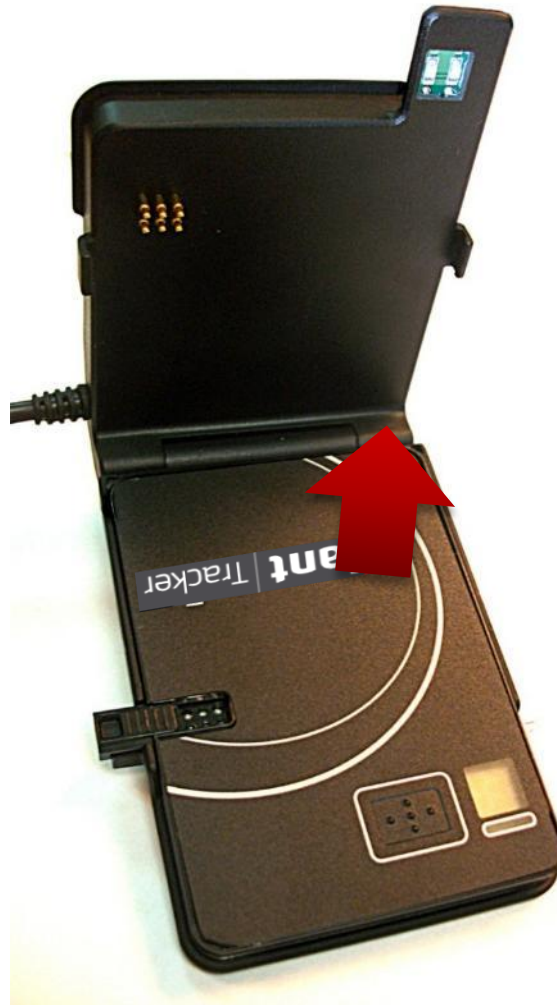

Questions

- I have a USB-charger, can I use this to connect the Jiiva charger to?
 - Yes, you can use any powered USB port to charge.
- How long does a charging cycle take?
 - This depends on the USB-port and the remaining battery charge in the tracker.
- When I insert a tracker, all 4 green indicators are switched on, what's happening?
 - The battery in the tracker is already full, the charger does not start a new charging cycle
- When I insert a tracker, none of the green indicators are switched on, what's happening?
 - A bad contact between the tracker and the charger is likely to be the reason. Reopen the charger and close it again firmly and wait a few seconds. Normally one or more green indicators should be switched on.
 - If the previous doesn't solve the problem, the spring-loaded contacts on the charger may need to be cleaned. For this purpose, use a soft cotton sick and pure alcohol.
- The red error indicator is blinking, what should I do?
 - The read indicator indicates a fatal system error. Please return the charger to your local Vilant Tracker distributor for repair or replacement if covered by warranty.

Warning

FCC Statement

This device complies with Part 15 of the FCC Rules. Operation is subject to the following two conditions: (1) This device may not cause harmful interference, and (2) this device must accept any interference received, including interference that may cause undesired operation. Any Changes or modifications not expressly approved by party responsible for compliance could void the user's authority to operate the equipment.

Radiation Exposure Statement

This equipment complies with FCC radiation exposure limits set forth for an uncontrolled environment. This equipment should be installed and operated with minimum distance 20 cm between the radiator & your body. This transmitter must not be co-located or operating in conjunction with any other antenna or transmitter.