



SCHUBERTH



SC2 STANDARD

**MOTORCYCLE BLUETOOTH®
COMMUNICATION SYSTEM**

USER'S GUIDE

TABLE OF CONTENTS

1.	ABOUT THE SC2 STANDARD	5
1.1	Product Details	5
1.1.1	SC2 Standard	5
1.1.2	SC2 Standard Remote Control	5
1.2	Package Contents	6
1.3	Optional Accessories	6
1.4	Approved Helmet Models	7
1.5	ECE 22.06 SA Label	7
2.	INSTALLING THE HEADSET ON YOUR HELMET	8
2.1	Installing the SC2 Standard Remote Control	8
2.2	Installing the SC2 Standard	8
2.3	Removing the SC2 Standard	10
2.4	Installing the Microphone	11
3.	GETTING STARTED	12
3.1	Legend	12
3.2	Downloadable Software	12
3.2.1	SCHUBERTH SC2 App	12
3.2.2	SCHUBERTH Device Manager	12
3.3	Powering On and Off	13
3.3.1	SC2 Standard Powering On and Off	13
3.3.2	SC2 Standard Remote Control Powering On and Off	13
3.4	Charging the SC2 Standard	14
3.5	Replacing the Battery	14
3.6	Checking the Battery Level	15
3.7	Volume Adjustment	15
4.	PAIRING THE HEADSET WITH OTHER BLUETOOTH DEVICES	16
4.1	Phone Pairing	16
4.2	Second Mobile Phone Pairing	17
4.3	GPS Pairing	18

5.	MOBILE PHONE USAGE	19
5.1	Making and Answering Calls	19
5.2	Call a Voice Assistant (Siri or Google Assistant)	19
5.3	Speed Dialing	19
5.3.1	Assigning Speed Dial Presets	19
5.3.2	Using Speed Dial Presets	19
6.	STEREO MUSIC	21
6.1	Bluetooth Stereo Music	21
6.2	Music Sharing	21
7.	BLUETOOTH INTERCOM	22
7.1	Intercom Pairing	22
7.1.1	Using the Smart Intercom Pairing (SIP)	22
7.1.2	Using the Button	23
7.2	Last-Come, First-Served	23
7.3	Two-Way Intercom	24
7.4	Multi-Way Intercom	25
7.4.1	Starting a Three-Way Intercom Conference	25
7.4.2	Starting a Four-Way Intercom Conference	26
7.4.3	Ending Multi-Way Intercom	26
7.5	Three-Way Conference Phone Call with Intercom Users	27
7.6	Group Intercom	28
7.7	Universal Intercom	28
8.	USING THE FM RADIO	30
8.1	FM Radio On/Off	30
8.2	Seek and Save Radio Stations	30
8.3	Scan and Save Radio Stations	31
8.4	Navigating Preset Stations	32
8.5	Temporary Station Preset	32
8.6	Region Selection	32

9.

FUNCTION PRIORITY

33

9.1

Function Priority

33

10.

CONFIGURATION SETTING

34

10.1

Headset Configuration Setting

34

10.1.1

Delete All Pairings

34

10.2

Software Configuration Setting

35

10.2.1

Speed Dial

35

10.2.2

Headset Language

35

10.2.3

VOX Phone (Default: Enable)

35

10.2.4

VOX Intercom (Default: Disable)

35

10.2.5

VOX Sensitivity (Default: 3)

35

10.2.6

HD Intercom (Default: Enable)

35

10.2.7

HD Voice (Default: Enable)

36

10.2.8

Sidetone (Default: Disable)

36

10.2.9

Voice Prompt (Default: Enable)

36

10.2.10

RDS AF Setting (Default: Disable)

36

10.2.11

FM Station Guide (Default: Enable)

36

11.

TROUBLESHOOTING

37

11.1

SC2 Standard Factory Reset

37

11.2

SC2 Standard Remote Control Factory Reset

37

11.3

Remote Control Pairing

37

11.4

SC2 Standard Fault Reset

38

1. ABOUT THE SC2 STANDARD

1.1 Product Details

1.1.1 SC2 Standard

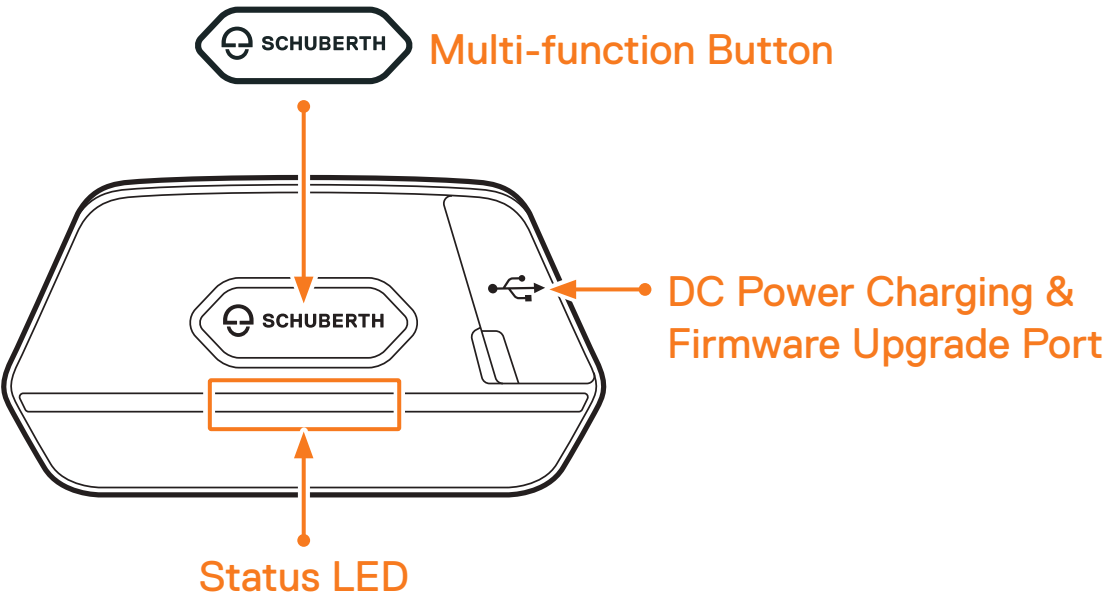

1.1.2 SC2 Standard Remote Control

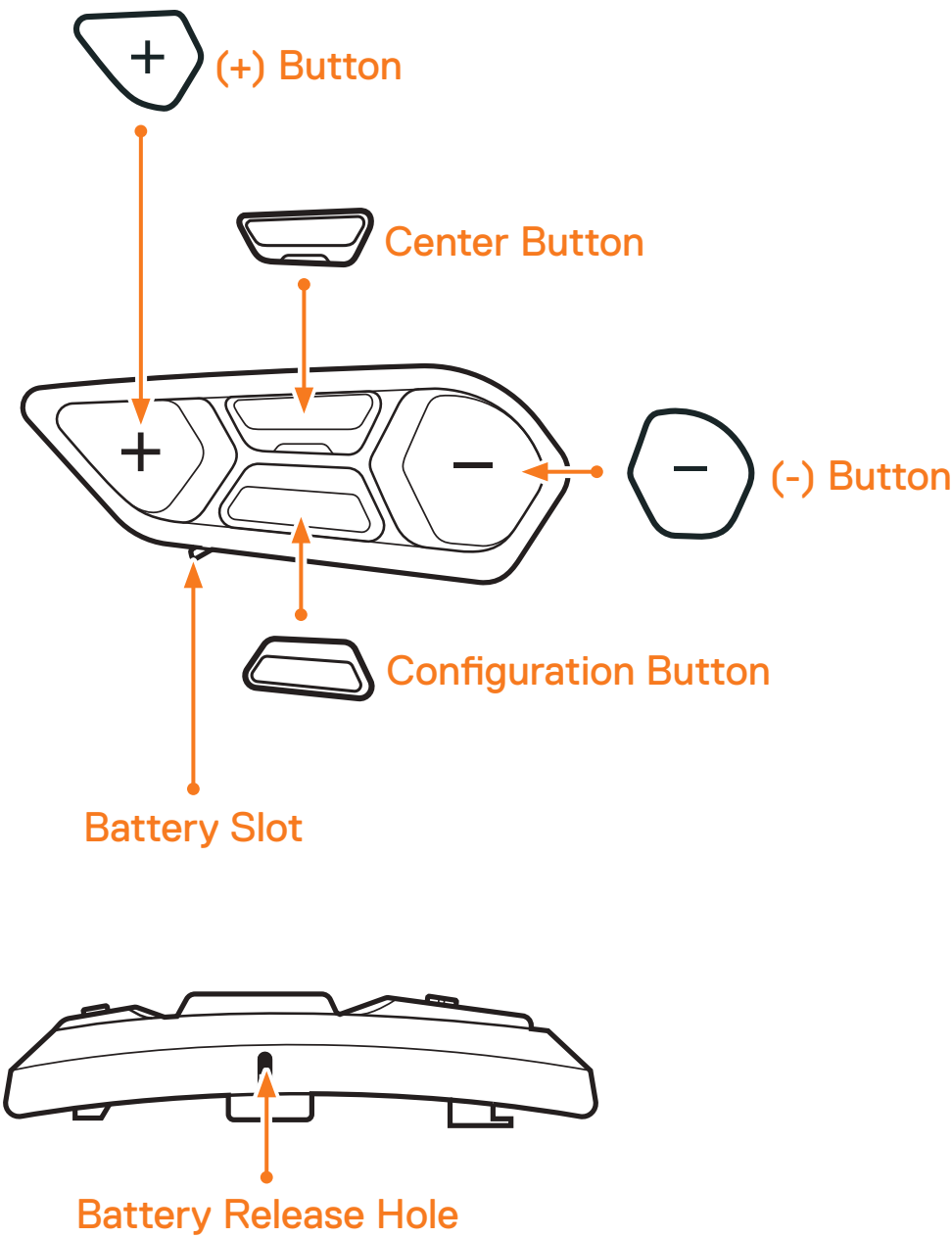

1.2 Package Contents



SC2 Standard

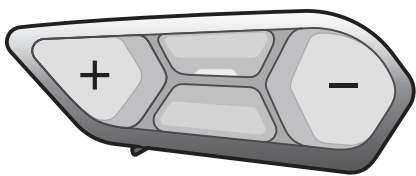

SC2 Standard Remote Control



SC2/SC2 Standard HD Boom Microphone

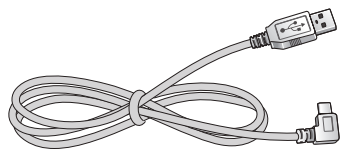

USB-C Power & Data Cable

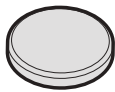



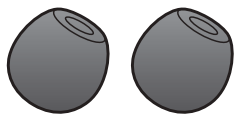

Coin Battery

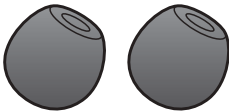

Foam cover for SC2/SC2 Standard HD Boom Microphone (2)

1.3 Optional Accessories

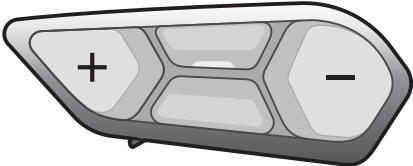
Contact SCHUBERTH or your authorized dealer for accessories.

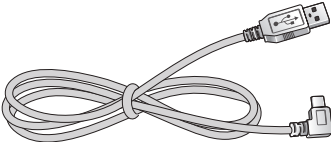
Part Number	Spare Part
9049100370	SC2/SC2 Standard HD Boom Microphone with foam cover  
9049100372	Foam cover for SC2/SC2 Standard HD Boom Microphone 
9049100374	Remote Control for SC2 Standard  
9049100375	USB-C Power & Data Cable 

1.4 Approved Helmet Models

SC2 Standard is approved according to ECE 22.06 for the following SCHUBERTH helmets:

Helmet model	Approval number
C5	0610510
E2	0610510
C5 CARBON	0610596
E2 CARBON	0610596
S3	0610579
J2	0610632

1.5 ECE 22.06 SA Label

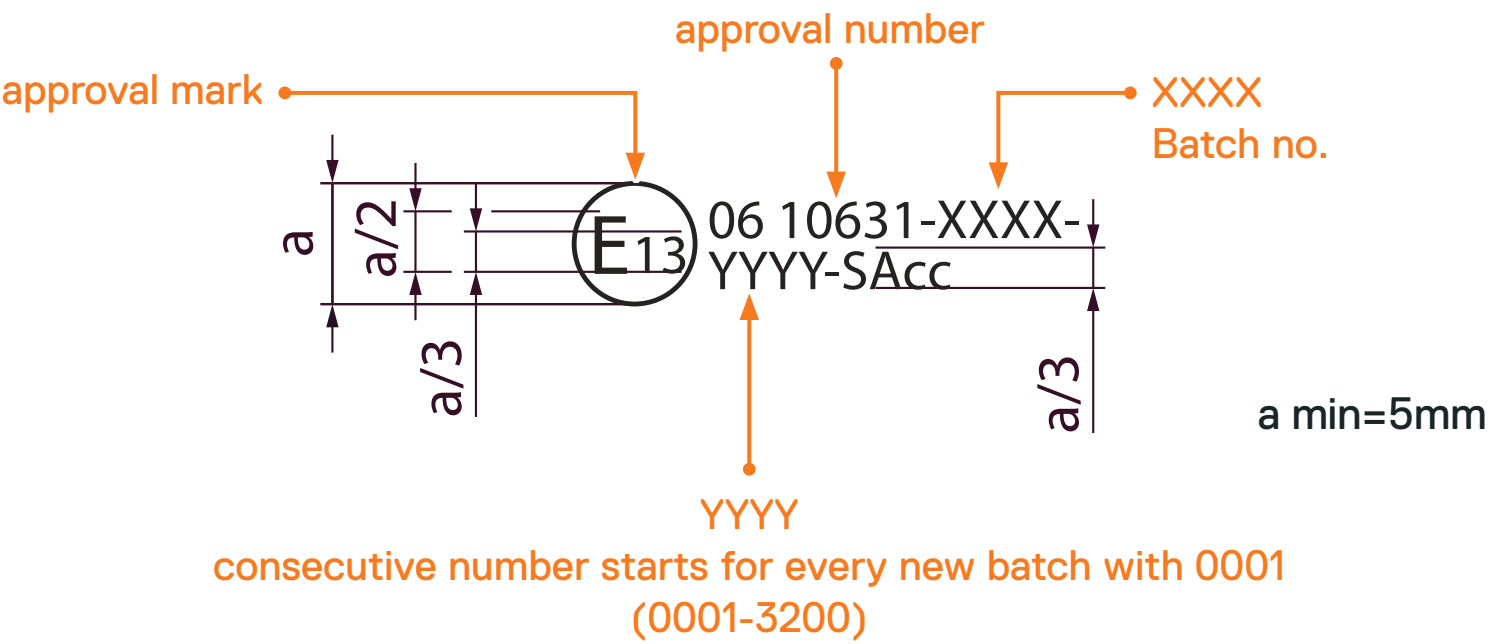

2. INSTALLING THE HEADSET ON YOUR HELMET

2.1 Installing the SC2 Standard Remote Control

- 1. Remove the cover for the **SC2 Standard Remote Control** from your helmet.

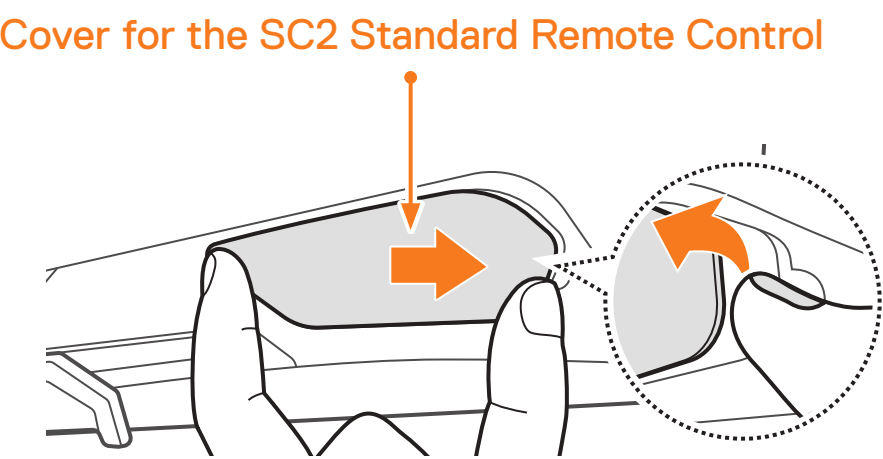

- 2. Slide and insert the **SC2 Standard Remote Control** onto your helmet.

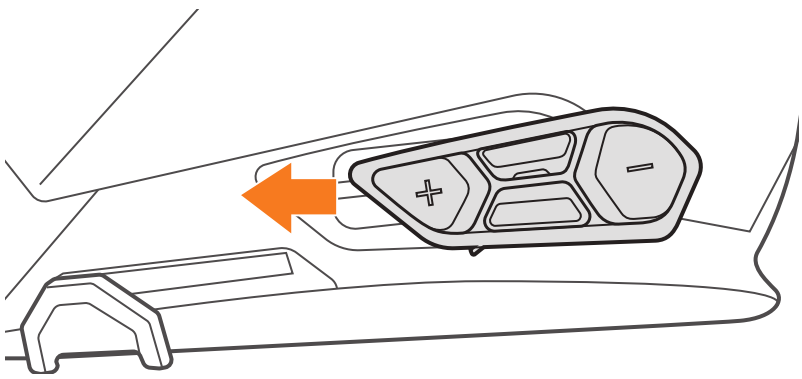

2.2 Installing the SC2 Standard

- 1. Remove the SC2 Standard cover from the helmet by lifting it up with the SC2 Standard Remote Control cover.

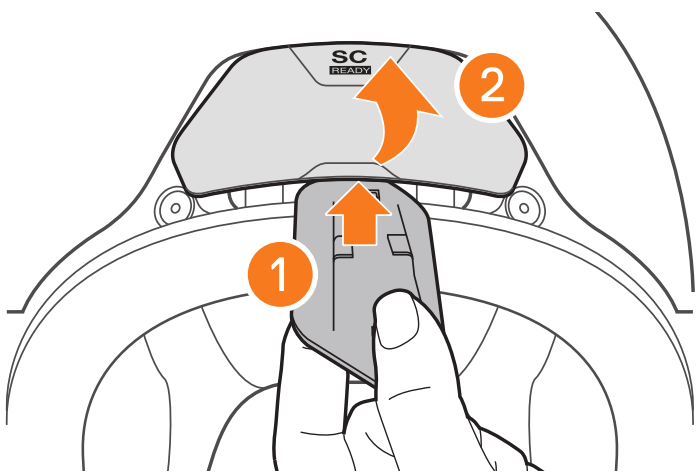

2. Pull out the antenna cable retainer from its original position, and pull out the antenna cables from the upper gap in the space. Then, connect the SC2 Standard's antenna cables and the helmet's antenna cables correctly.

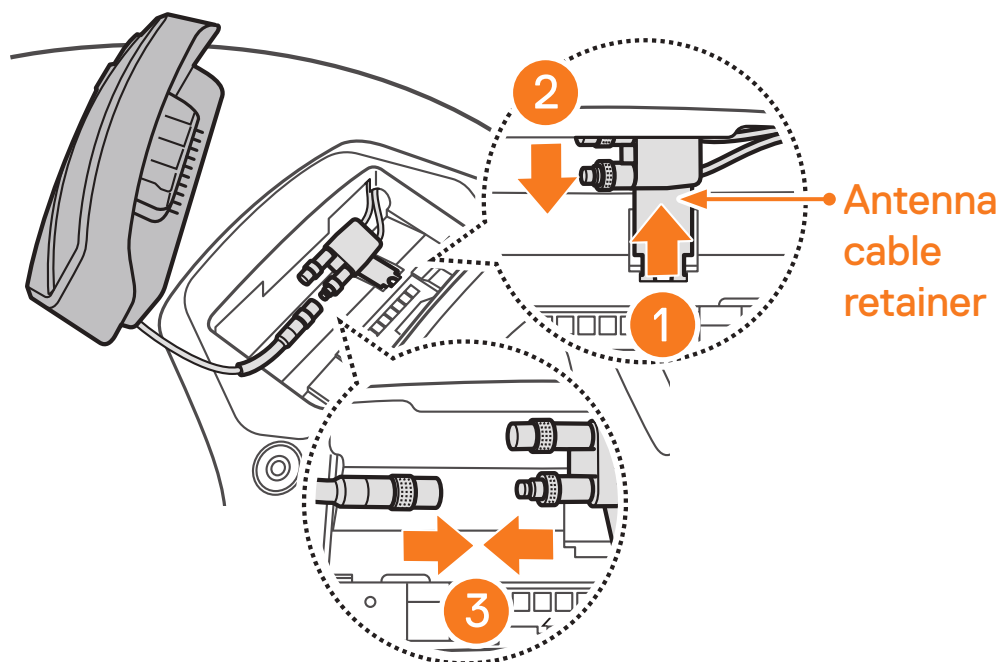

Note: The SC2 Standard is equipped with one antenna cable for connection to the helmet antenna for intercom.

3. Put the antenna cable retainer back into its original position, and put the connected cables into the upper gap in the space.

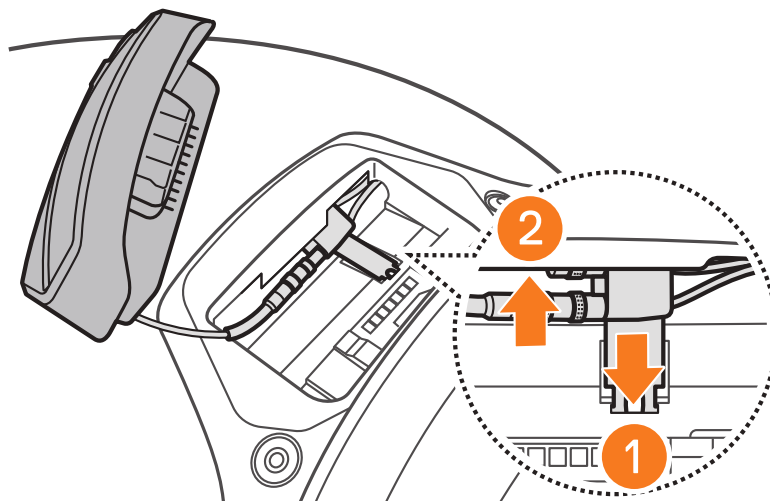

Note: Make sure that the antenna cable retainer and the connected cables are positioned correctly before installing the **SC2 Standard**. If not, the cables may be damaged or interference may occur.

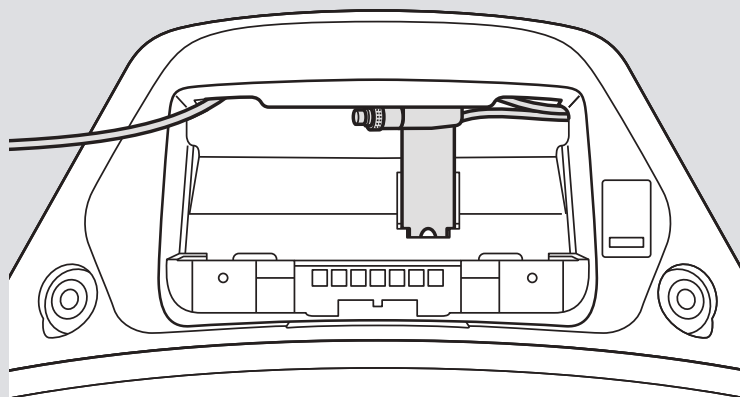

4. Install the **SC2 Standard** into the helmet.

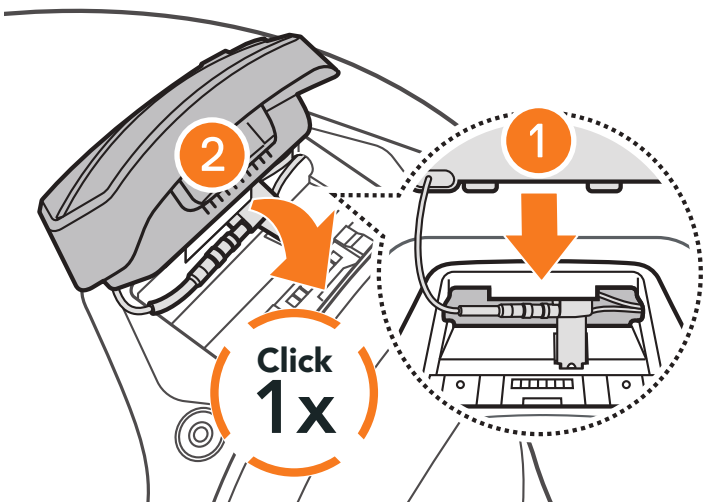

2.3 Removing the SC2 Standard

1. Remove the installed **SC2 Standard** from the helmet by lifting it up with the SC2 Standard Remote Control cover.

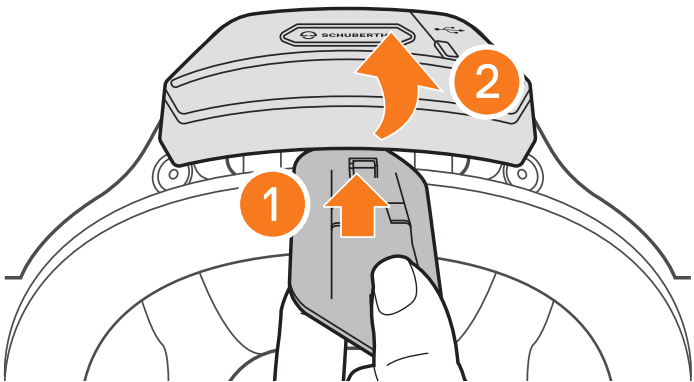

2. Pull the antenna cable retainer out from its original position, and pull out the connected cables from the upper gap in the space. Then, disconnect the cables correctly.

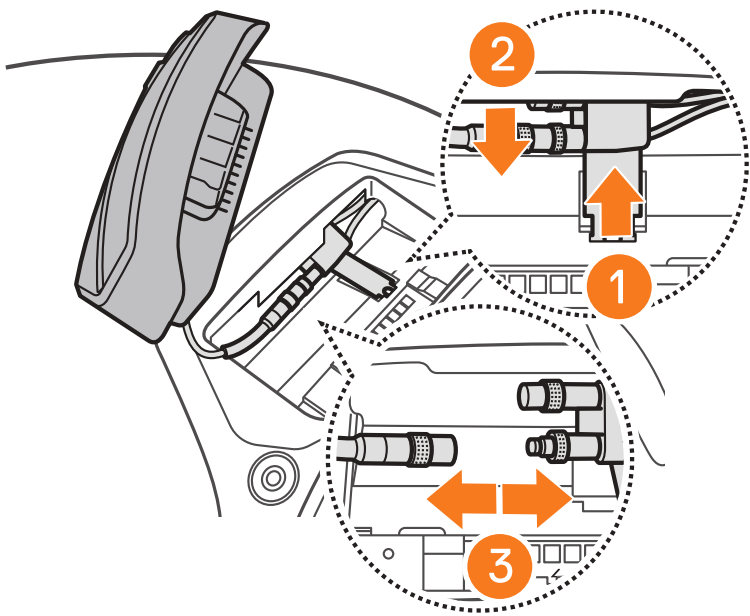

Note: When you need to un-plug the connector, please wiggle and pull it. It will help the connector connection be released more easily.

3. Put the antenna cable retainer back into its original position, and put the helmet’s cables into the upper gap in the space.

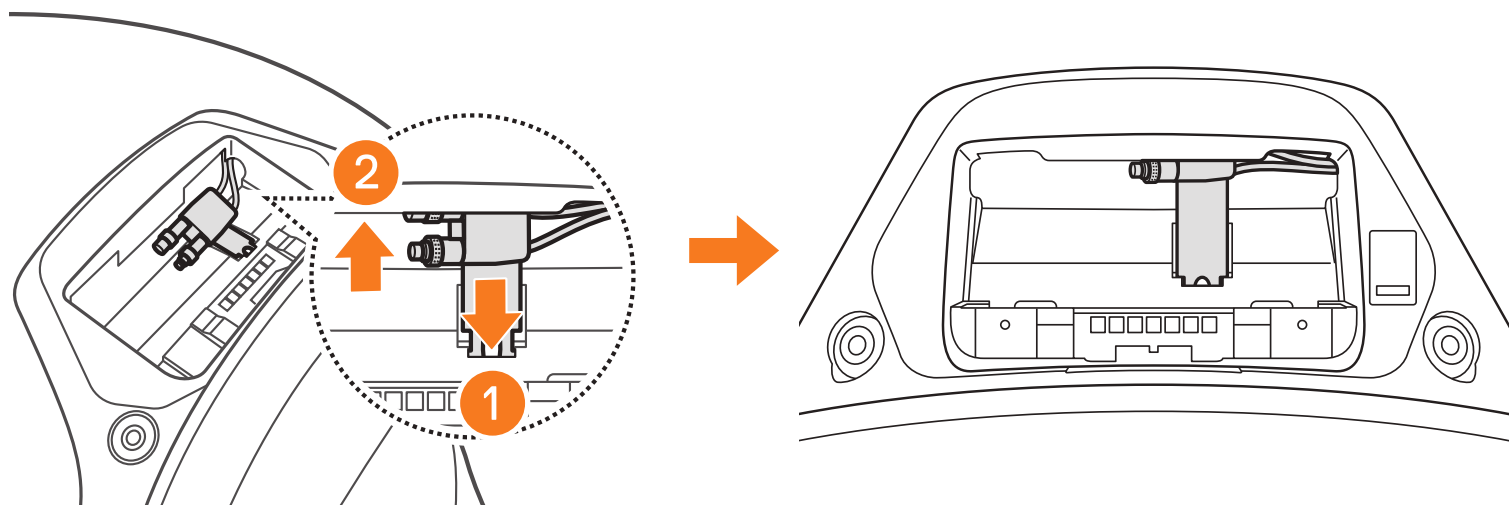

2.4 Installing the Microphone

1. Remove the microphone rubber cap as shown in the illustration to install the microphone.

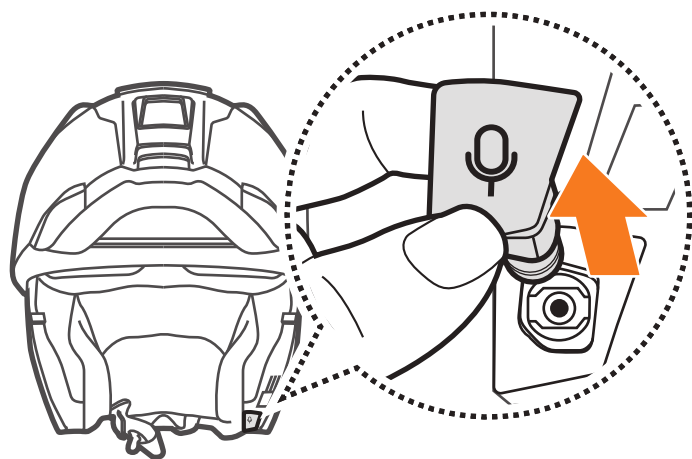

Note: The microphone is pre-installed on the S3.

2. Install the microphone by pressing firmly on the area marked with the orange circle.

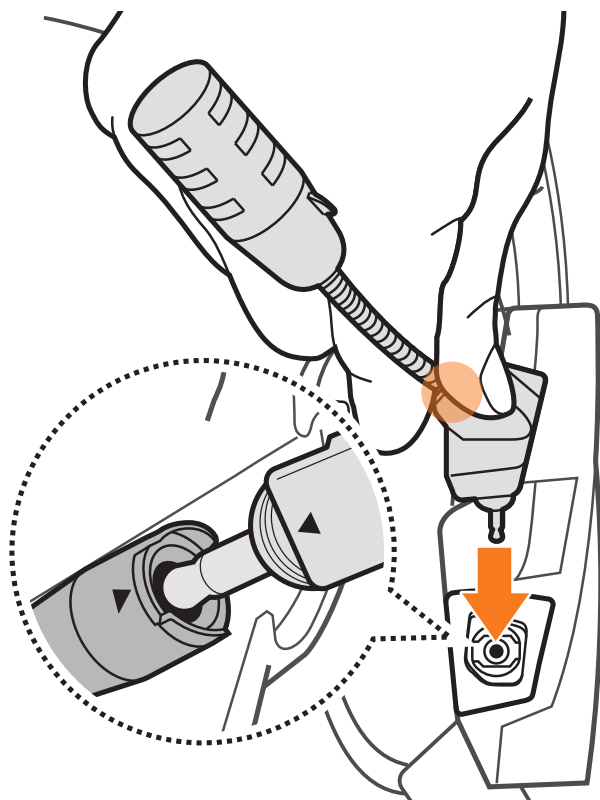

3. GETTING STARTED

3.1 Legend

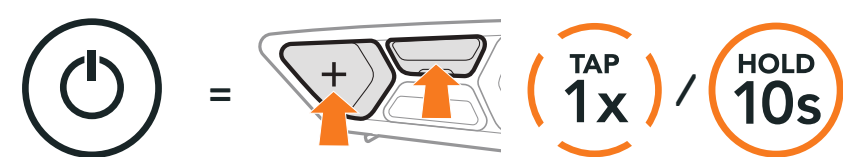

Function = Button(s) to **tap** the specified number of times or **press and hold** for the specified amount of time.



3.2 Downloadable Software

3.2.1 SCHUBERTH SC2 App



SCHUBERTH SC2 APP

By simply pairing your phone with your headset, you can use the **SCHUBERTH SC2 App** for quicker and easier set up and management.

- ♦ App functions: Bluetooth Intercom, Music, Device settings, Language settings
- ♦ Download
 - Android: Google Play Store > **SCHUBERTH SC2**
 - iOS: App Store > **SCHUBERTH SC2**

3.2.2 SCHUBERTH Device Manager

The **SCHUBERTH Device Manager** allows you to **upgrade the firmware** and **configure its settings** directly from your PC or Apple computer.

Download the **SCHUBERTH Device Manager** from oem.sena.com/schuberth/.

Click Here to Visit oem.sena.com/schuberth/

3.3 Powering On and Off

3.3.1 SC2 Standard Powering On and Off

To switch on the **SC2 Standard**, hold the **Multi-function Button** for **2 seconds**.
To switch off the **SC2 Standard**, hold the **Multi-function Button** for **2 seconds** until you hear the double beep.

Powering On/Off



The remote control switches to sleep mode when you switch off the **SC2 Standard**.

To wake up the remote control after starting the **SC2 Standard**, tap **(+) Button** on the remote control.

3.3.2 SC2 Standard Remote Control Powering On and Off

- ◆ To begin using the **SC2 Standard Remote Control**, remove the plastic strip from the battery slot.

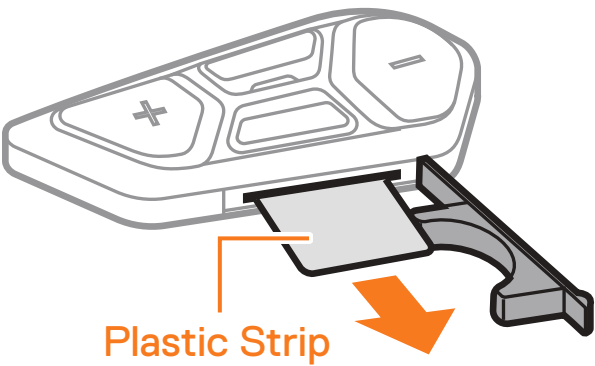

- ◆ Tap the **Center Button**.

Powering On

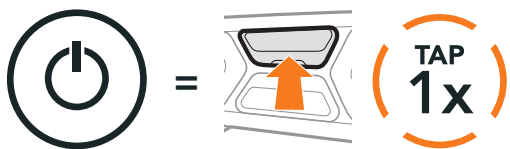

- ◆ Press and hold the **(+) Button** and the **Center Button** for **3 seconds**.

Powering Off

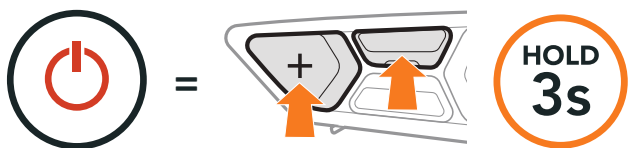

Note: The **SC2 Standard** and the **SC2 Standard Remote Control** come paired together. They will automatically connect to each other when the **SC2 Standard** and the **SC2 Standard Remote Control** are powered on.

3.4 Charging the SC2 Standard

Charging the Headset

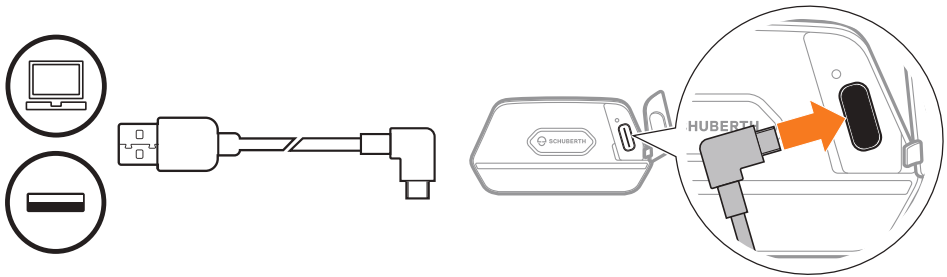

The headset will be fully charged in about 2.5 hours. (The charging time may vary depending on the charging method.)

Note:

- ◆ Please make sure to take off your SC2 Standard-installed helmet while charging. The headset automatically turns off during charging.
- ◆ Any USB charger can be used with the headset if the charger is approved by either the FCC, CE, or IC.
- ◆ The **SC2 Standard** is compatible with 5 V/1 A input USB-charged devices only.

3.5 Replacing the Battery

To replace the discharged battery of the **SC2 Standard Remote Control**, follow the steps below:

1. Prepare a CR2016 Lithium 3 V coin battery for the **SC2 Standard Remote Control**.
2. Open the battery slot's cover.

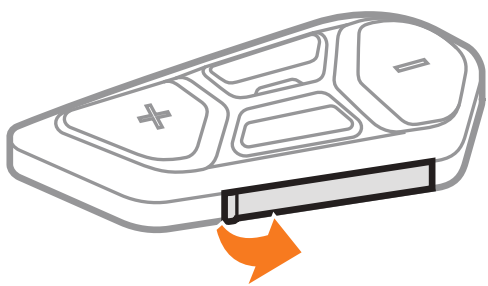

3. Insert a paper clip into the Battery Release Hole. Then, change the discharged battery with the new battery.

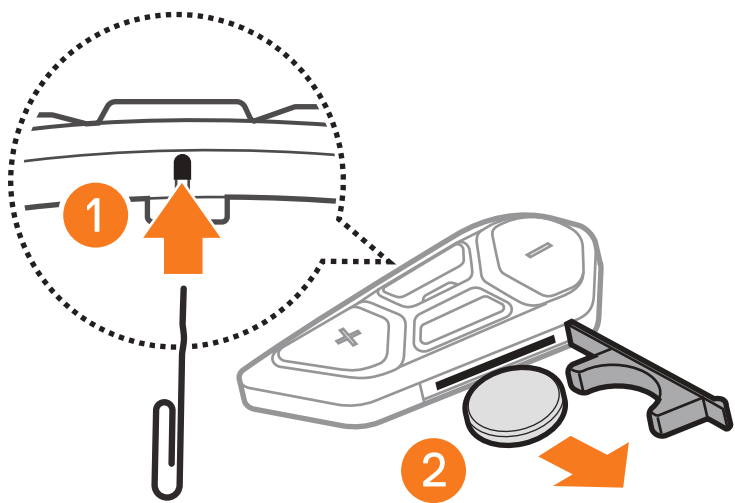

4. Insert the new battery into the battery slot.

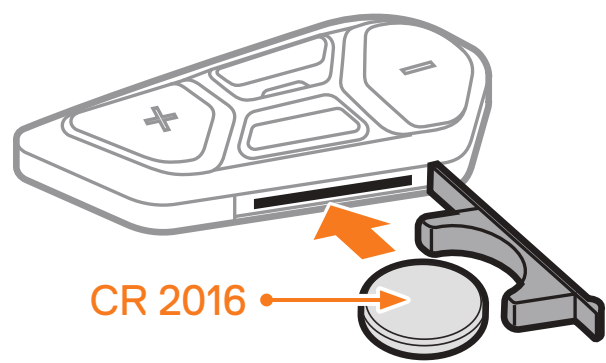

5. Close the battery slot’s cover. When closing the cover, insert the cover’s two battery guides first.

3.6 Checking the Battery Level

When switching on, the LED flashes red to indicate the charge level.

SC2 Standard

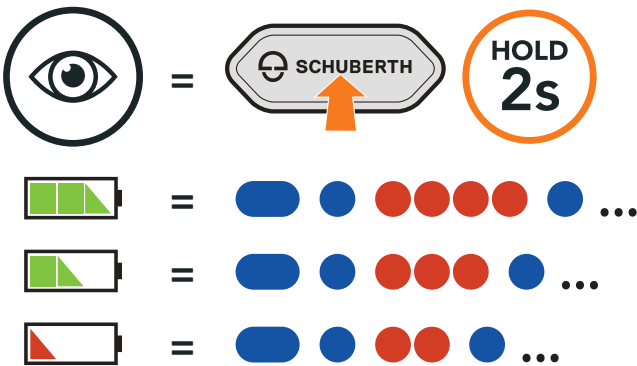

SC2 Standard Remote Control

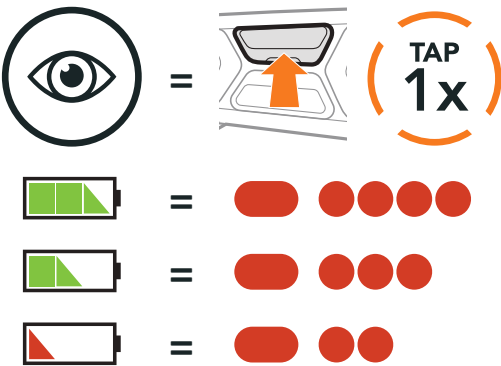

Note: When the SC2 Standard’s battery is low while in use, you will hear a voice prompt saying “Low battery.”

3.7 Volume Adjustment

You can raise or lower the volume by tapping the **(+) Button** or the **(-) Button**. Volume is set and maintained independently at different levels for each audio source (i.e., phone, intercom), even when the headset is rebooted.

Volume Up

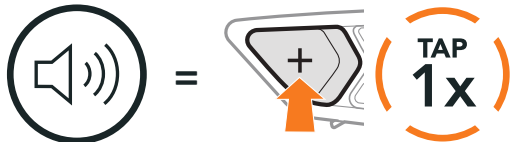

Volume Down



4. PAIRING THE HEADSET WITH OTHER BLUETOOTH DEVICES

When using the headset with other Bluetooth devices for the first time, they will need to be “paired.” This enables them to recognize and communicate with one another whenever they are within range.

The headset can pair with multiple Bluetooth devices such as a mobile phone, GPS, MP3 player, or via **Mobile Phone Pairing, Second Mobile Phone Pairing, and GPS Pairing**. The headset can also be paired with up to three other SCHUBERTH headsets.

Pairs with up to Three SCHUBERTH Headsets



Also Pairs with:

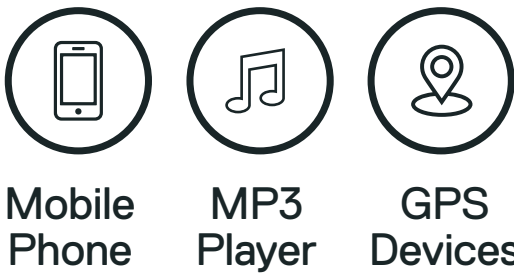

4.1 Phone Pairing

Phone Pairing

- 1. Press and hold the **Configuration Button** for **5 seconds**.



- 2. Tap the **(+) Button**.



3. With your mobile phone in Bluetooth-pairing mode, select **SC2 Standard** in the list of devices detected.
- If your mobile phone asks for a PIN, enter 0000.

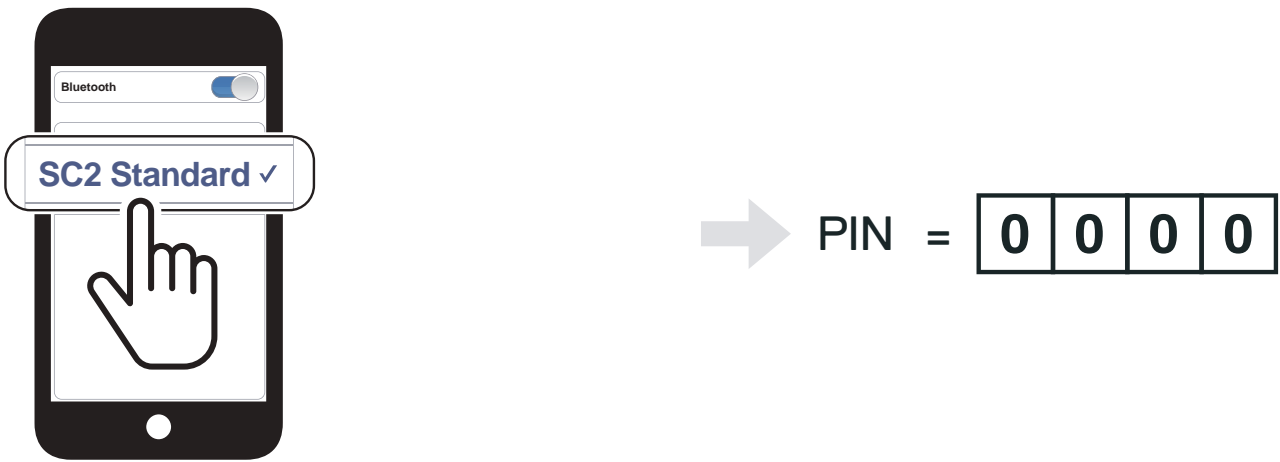

4.2 Second Mobile Phone Pairing

1. Press and hold the **Configuration Button** for 5 seconds.



2. Double tap the **(+) Button**.

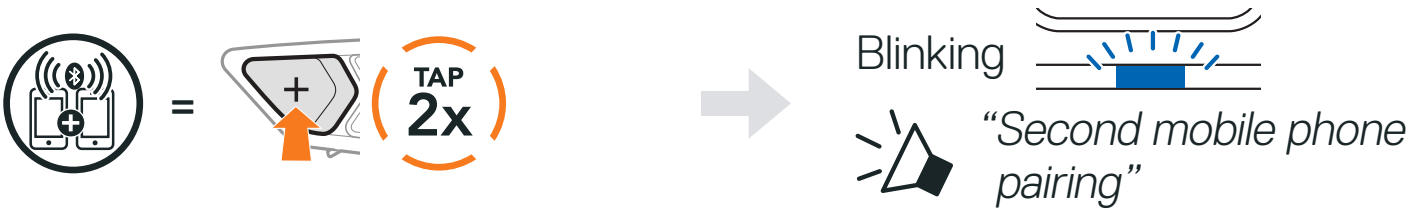

3. With your mobile phone in Bluetooth-pairing mode, select **SC2 Standard** in the list of devices detected.
- If your device asks for a PIN, enter 0000.

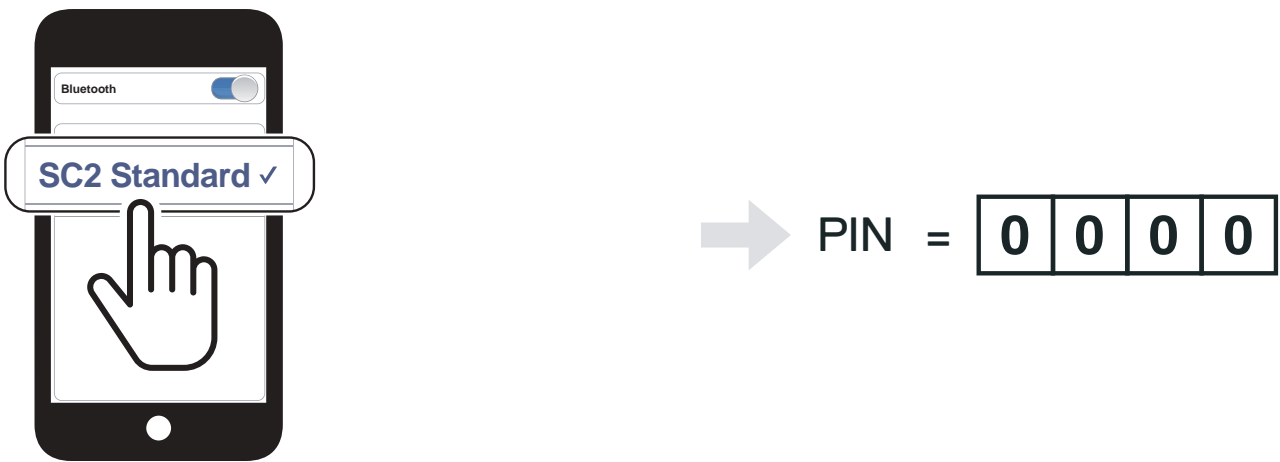

4.3 GPS Pairing

1. Press and hold the **Configuration Button** for **5 seconds**.



2. Tap the **(+) Button** five times.



3. Select **SC2 Standard** in the list of Bluetooth devices detected.
If your device asks for a PIN, enter 0000.

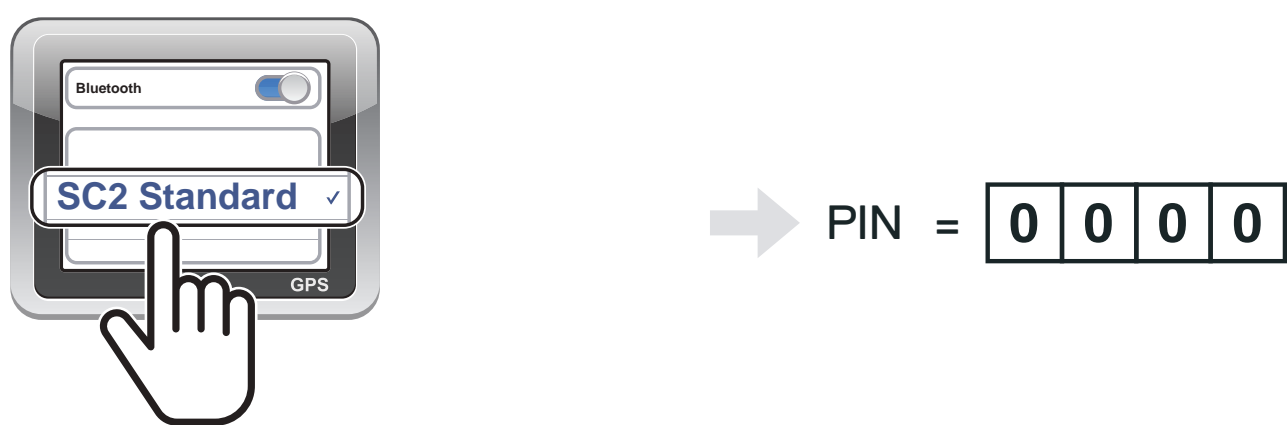

5. MOBILE PHONE USAGE

5.1 Making and Answering Calls

Answer a Call

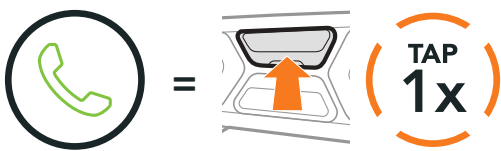

End a Call

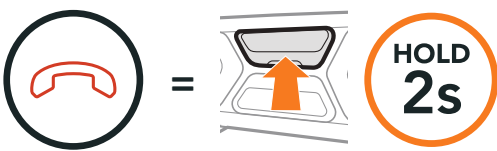

Reject a Call

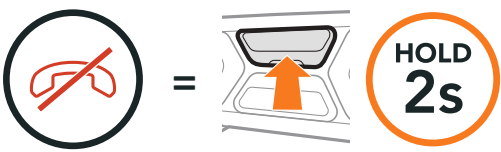

5.2 Call a Voice Assistant (Siri or Google Assistant)



1. Press the **Center Button** for **3 seconds** until you hear “Beep” to enable “Voice Assistant.”
2. Say: For example, “Make a phone call” or “Play music.”

5.3 Speed Dialing

5.3.1 Assigning Speed Dial Presets

Speed Dial Presets could be assigned through the **SCHUBERTH SC2 App** or the **SCHUBERTH Device Manager**.

5.3.2 Using Speed Dial Presets

1. Press and hold the **(+) Button** for **3 seconds**.

Enter Speed Dial Mode



2. Tap the **(+) Button** or the **(-) Button** to navigate between the menus.

Navigate Forward or Backward through Speed Dial Preset Numbers



- (1) Last number redial
- (2) Speed dial 1
- (3) Speed dial 2

- (4) Speed dial 3
- (5) Cancel

3. To call one of your Speed Dial Presets, tap the **Center Button**.

Call a Speed Dial Preset Number



4. To redial the last phone call number, tap the **Center Button**.

Redial Last Number



6. STEREO MUSIC

6.1 Bluetooth Stereo Music

Play/Pause Music



Next Track

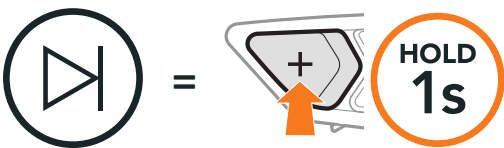

Previous Track



6.2 Music Sharing

You can start sharing music with one intercom friend using Bluetooth stereo music during a two-way intercom conversation.

Press and hold the **(-) Button** for **3 seconds**.

Start/Terminate Sharing Music



Note:

- ◆ Both you and your intercom friend can remotely control music playback such as track forward and track back.
- ◆ **Music sharing** will be paused when you are using your mobile phone or listening to GPS instructions.
- ◆ **Music sharing** will be terminated if the headset starts a multi-way intercom conference.

7. BLUETOOTH INTERCOM

Up to three people can communicate via intercom with the headset simply by pairing their headsets.

Pairing with Intercom Friends

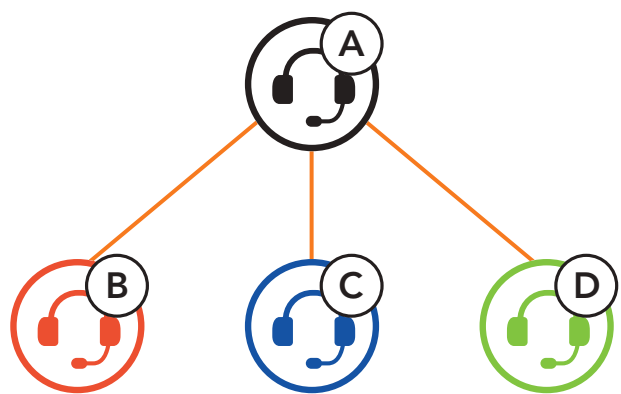



Note: If the **SC2 Standard** communication system is installed on full Carbon helmets, the maximum range of communication is limited to 400 meters in open terrain without obstacles, due to the electromagnetic interference shielding properties of the carbon fiber.

7.1 Intercom Pairing

There are two ways to pair the headset.

7.1.1 Using the Smart Intercom Pairing (SIP)

SIP allows you to quickly pair with your friends for intercom communication by scanning the QR code on the **SCHUBERTH SC2 App** without remembering the button operation.

1. Pair the mobile phone with the headset.
2. Open the **SCHUBERTH SC2 App** and tap  (**Smart Intercom Pairing Menu**).
3. Scan the **QR code** displayed on your friend (**B**)’s mobile phone.
 - ♦ Your friend (**B**) can display the QR code on the mobile phone by tapping  > **QR code** () on the **SCHUBERTH SC2 App**.



- 4. Tap **Save** and check that your friend **(B)** is paired with **you (A)** correctly.
- 5. Tap **Scan** ([📷]) and repeat steps 3-4 to pair with **Intercom Friends (C)** and **(D)**.

Note: The **Smart Intercom Pairing (SIP)** is not compatible with Sena products that use **Bluetooth 3.0** or **below**.

7.1.2 Using the Button

- 1. Press and hold the **Center Button** of two headsets for **5 seconds** until you hear a voice prompt, **“Intercom pairing.”**

Pairing Headset A with Headset B



- 2. The **SC2 Standard** will automatically pair with a SCHUBERTH headset.

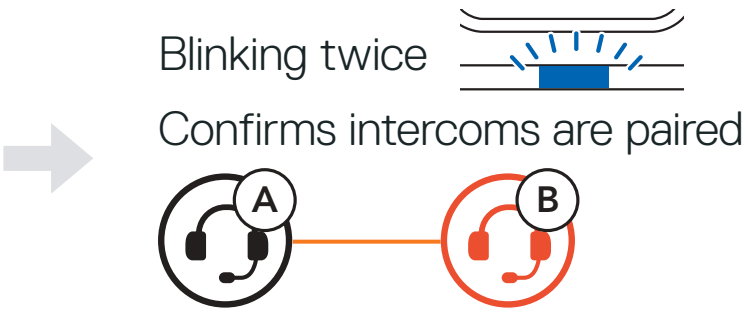

- 3. Repeat the steps above to pair with **Intercom Friends C & D**.

7.2 Last-Come, First-Served

The intercom pairing queue is **Last-Come, First-Served**. If a headset has multiple paired headsets for intercom conversations, the last paired headset is set as the **First Intercom Friend**. For example, after the pairing procedures listed above, **headset (D)** is the **First Intercom Friend of headset (A)**. **Headset (C)** is the **Second Intercom Friend of headset (A)**, and **headset (B)** is the **Third Intercom Friend of headset (A)**.

Last-Come, First-Served

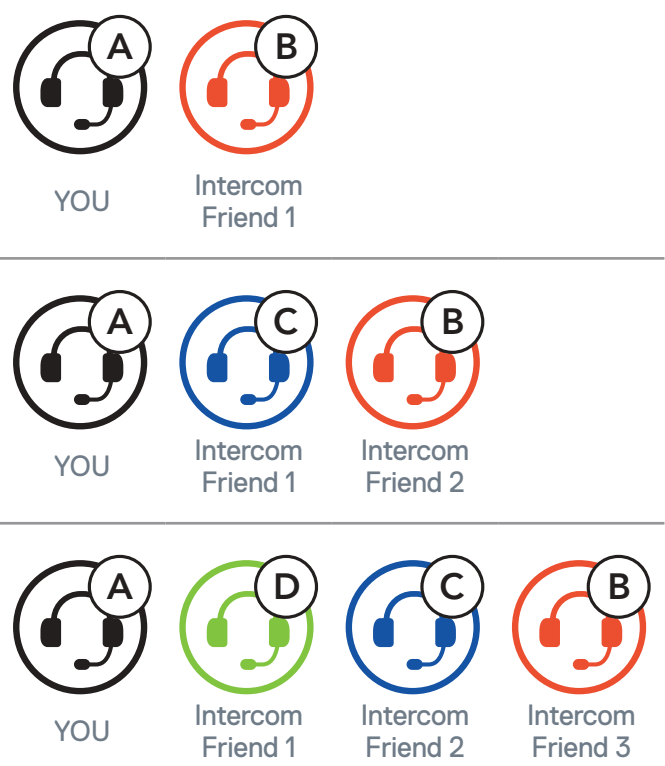

7.3 Two-Way Intercom

You can start or end an intercom conversation with an Intercom Friend by tapping the **Center Button**.

- 1. Tap once for Intercom **Friend 1**.

Start/End with Intercom Friend 1

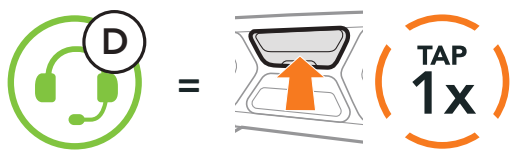

- 2. Tap twice for Intercom **Friend 2**.

Start/End with Intercom Friend 2

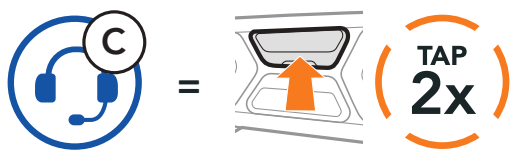

- 3. Tap three times for Intercom **Friend 3**.

Start/End with Intercom Friend 3

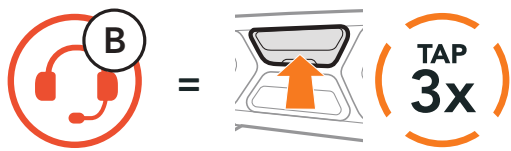

7.4 Multi-Way Intercom

Multi-Way Intercom enables conference-call-style conversations with up to three **Intercom Friends** at the same time. While **Multi-Way Intercom** is in progress, mobile phone connection is temporarily disconnected. However, as soon as **Multi-Way Intercom** terminates, the mobile phone connection will be reestablished.

7.4.1 Starting a Three-Way Intercom Conference

You (A) can have a **Three-Way Intercom Conference** with two other **Intercom Friends** (B & C) by establishing two intercom connections simultaneously.

1. Pair your headset (A) with those of two other **Intercom Friends** (B & C).

Pair with Intercom Friends B & C, refer to Section 7.1: “Intercom Pairing”

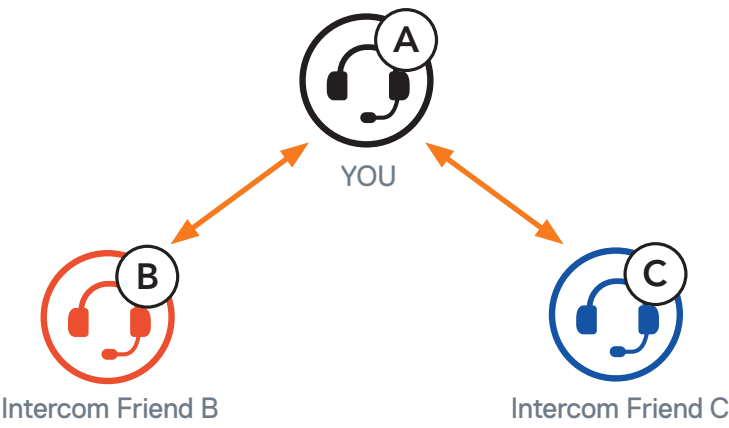

2. Start an intercom conversation with one of the two friends in your intercom group. For example, **you (A)** may start an intercom conversation with the **Intercom Friend (B)**. Or, **Intercom Friend (B)** may start an intercom call with **you (A)**.

Starting an Intercom Conversation with Intercom Friend B

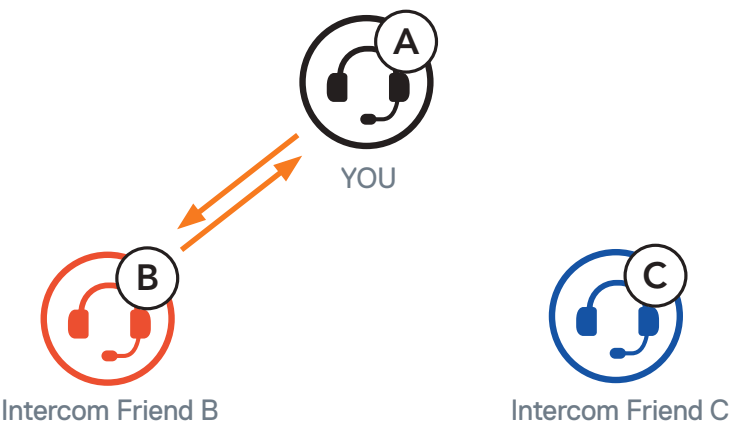

3. Then, **you (A)** can call the **Second Intercom Friend (C)**, or the **Second Intercom Friend (C)** may join the intercom by making an intercom call to **you (A)**.

Starting an Intercom Conversation with Intercom Friend C

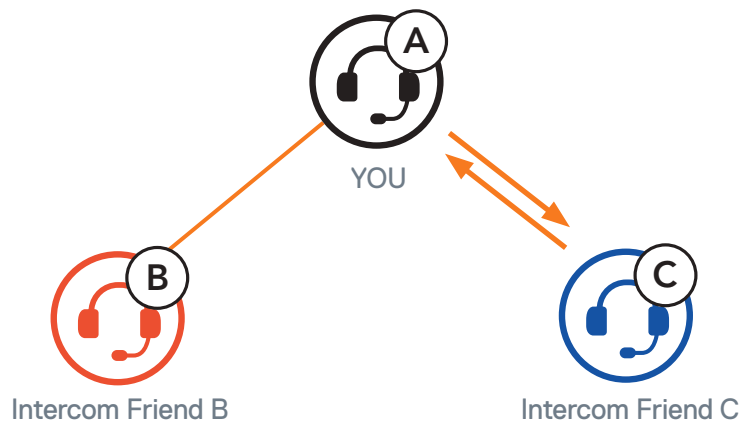

4. Now **you (A)** and two **Intercom Friends (B & C)** are having a **Three-Way Intercom Conference**.

Three-Way Intercom

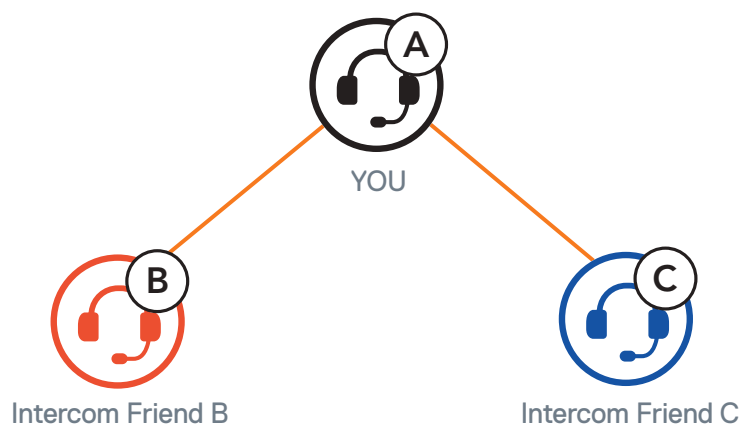

7.4.2 Starting a Four-Way Intercom Conference

With three **Intercom Friends** connected, a new participant **(D)** can make it a **Four-Way Intercom Conference** by making an intercom call to either **(B)** or **(C)**.

Starting a Four-Way Intercom

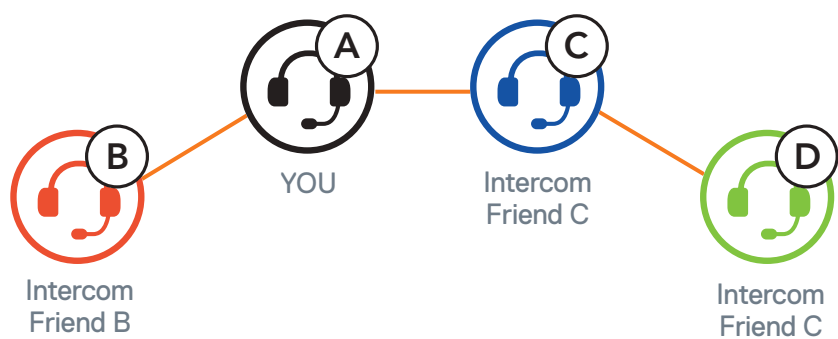

7.4.3 Ending Multi-Way Intercom

1. Press and hold the **Center Button** for **3 seconds** until you hear a beep to terminate all intercom connections.
2. Tap the **Center Button** to disconnect from your **First Intercom Friend**. Double tap the **Center Button** to disconnect from your **Second Intercom Friend**.

7.5 Three-Way Conference Phone Call with Intercom Users

You can have a **Three-Way Conference Phone Call** by adding an **Intercom Friend** to the mobile phone conversation.

- 1. During a mobile phone call, tap the **Center Button** **once, twice, or three times** to invite one of your **Intercom Friends** to the conversation.

Invite an Intercom Friend into Phone Conference

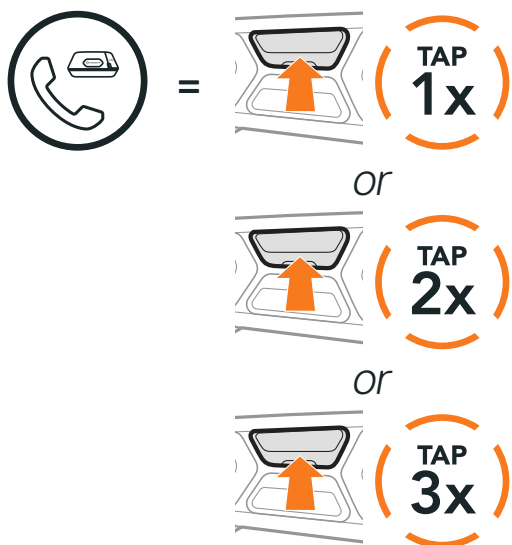

- 2. To disconnect the intercom during a conference phone call, tap the **Center Button** **once, twice, or three times**.

Disconnect Intercom Friend from Conference

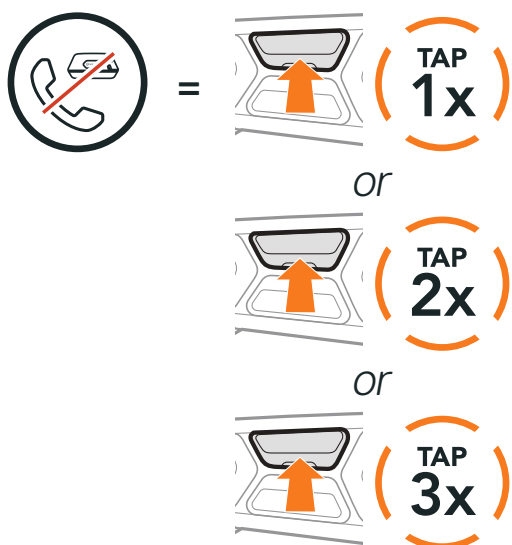

- 3. To disconnect the mobile phone call during a conference phone call, press and hold the **Center Button** for **2 seconds**.

End Phone Call from Conference

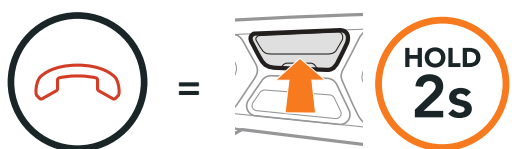

Note: When you have an incoming intercom call during a mobile phone call, you will hear high tone double beeps.

7.6 Group Intercom

Group Intercom allows you to instantly create a **Multi-Way Conference Intercom** with three of the most recently paired headsets.

Start the Group Intercom

- 1. Go through intercom pairing with up to three headsets you want to have **Group Intercom** with.
- 2. Tap the **(+) Button** and **(-) Button** to begin **Group Intercom**.

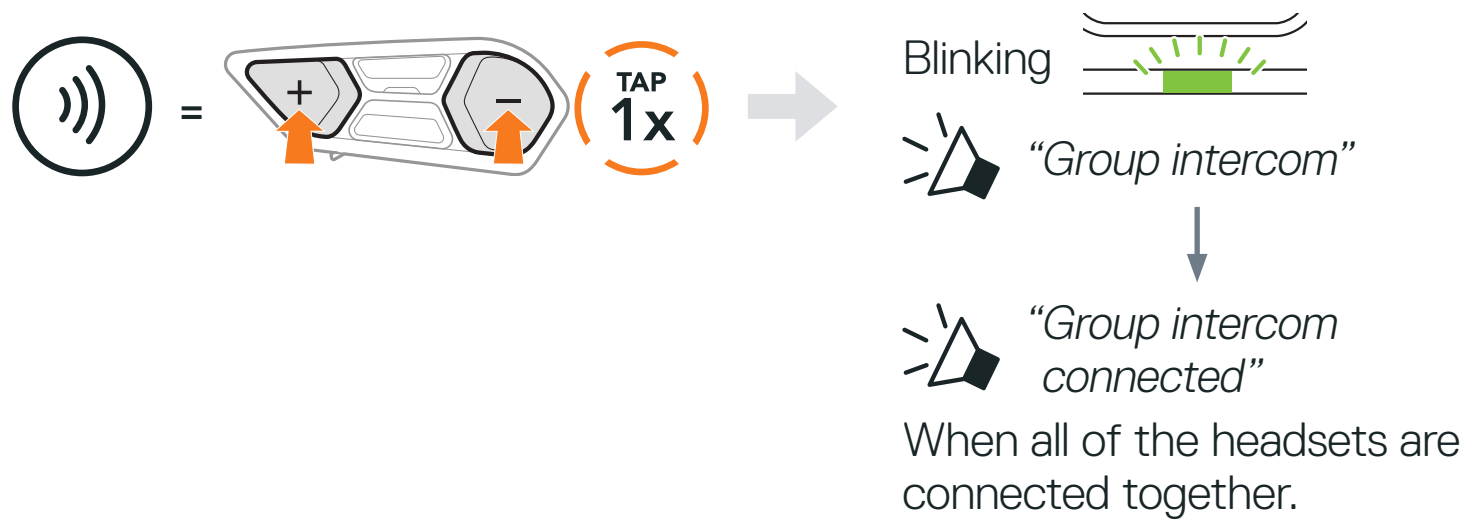

Terminate Group Intercom

To terminate **Group Intercom**, press and hold the **Center Button** for **3 seconds** during **Group Intercom**.



7.7 Universal Intercom

Universal Intercom allows you to have intercom conversations with users of non-SCHUBERTH Bluetooth headsets. Non-SCHUBERTH Bluetooth headset can be connected to the SCHUBERTH headset if they support the **Bluetooth Hands-Free Profile (HFP)**. You can pair your headset with only one non-SCHUBERTH headset at a time. The intercom distance depends on the performance of the Bluetooth headset to which it is connected. When a non-SCHUBERTH Bluetooth headset is paired with the SCHUBERTH headset, if another Bluetooth device is paired via **Second Mobile Phone Pairing**, it will be disconnected.

1. Press and hold the **Configuration Button** for **5 seconds**.



2. Tap the **(-) Button** three times.



3. Tap the **Center Button**.



4. Put the non-SCHUBERTH Bluetooth headset in Pairing Mode. The headset will automatically pair with a non-SCHUBERTH Bluetooth headset.
5. You can have **Two-Way Intercom** or **Multi-Way Intercom communication** with up to three **Intercom Friends** using non-SCHUBERTH headsets by following the procedures described below.

Example of a Three-Way Universal Intercom

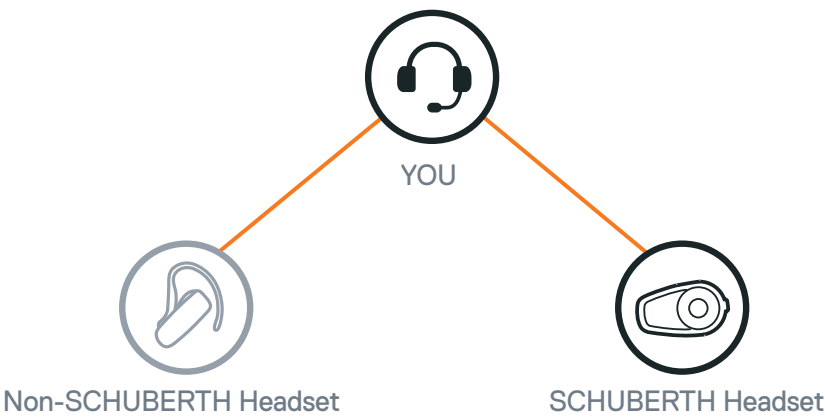

Example of a Four-Way Universal Intercom

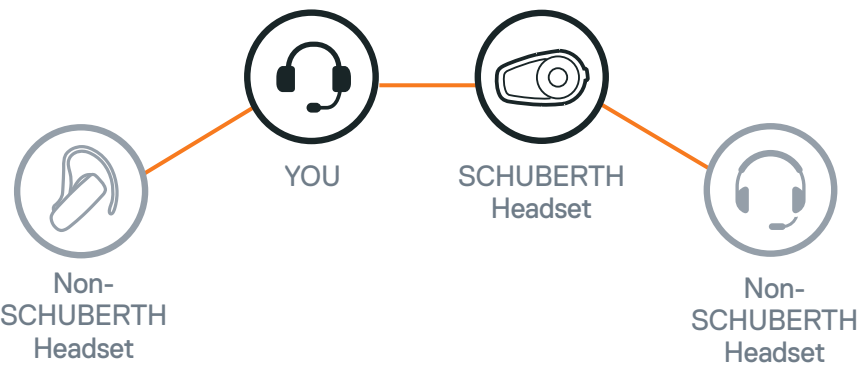

Note: Some non-SCHUBERTH headsets may not support Multi-Way Universal Intercom.

8. USING THE FM RADIO

8.1 FM Radio On/Off

FM Radio On



FM Radio Off



8.2 Seek and Save Radio Stations

The “**Seek**” feature searches for radio stations.

- 1. Search for radio stations.

Seek Stations Forward

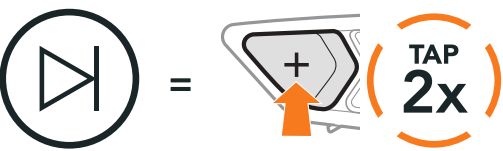

Seek Stations Backward

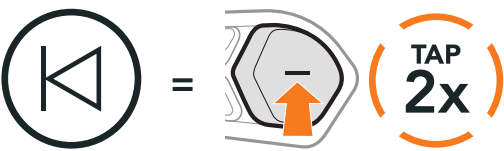

- 2. Save the current station.

Enter Preset Selection Mode



- 3. Navigate through the preset numbers that you want to store.

Navigate Forward/Backward Through Preset Stations



4. Save the station in the preset number you choose or delete the station from memory.

Save Station to the Preset Number



Delete Station from Memory



8.3 Scan and Save Radio Stations

The “**Scan**” function automatically searches for radio stations, starting with the current station’s frequency, then up from there.

1. Scan for stations.

Start Scanning



2. The SCHUBERTH tuner pauses at each station it finds for **8 seconds** before moving to the next.
3. Save the current station. The station will be saved as the next preset number.

Save the Current Station



4. Stop scanning.

Stop scanning

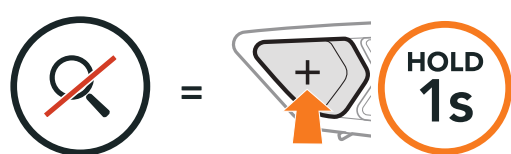

Note:

- ♦ You can use the **SCHUBERTH Device Manager** or the **SCHUBERTH SC2 App** to save the preset stations.
- ♦ If the **SC2 Standard** is installed on full Carbon helmets the electromagnetic interference shielding properties of the carbon fiber shell can influence the clarity of FM signals.

8.4 Navigating Preset Stations

Using the methods above, up to 10 radio stations can be stored. You can navigate through the saved stations.

Navigate through Preset Stations

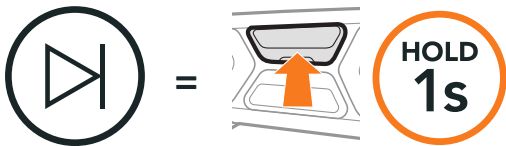

8.5 Temporary Station Preset

The **Temporary Preset** feature automatically finds and saves the nearest 10 radio stations without changing your existing preset stations.

1. Automatically find and save 10 stations.

Temporary Stations

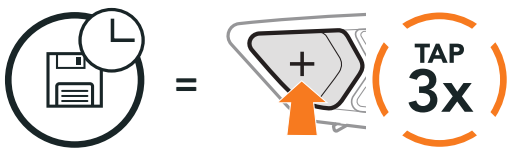

2. The temporary preset stations will be cleared when the headset reboots.

8.6 Region Selection

You can select the proper FM frequency range for your location from the **SCHUBERTH Device Manager** or the **SCHUBERTH SC2 App**. Using the region setting, you can optimize the seek function to avoid unnecessary frequency ranges.

Region	Frequency range	Step
Worldwide	76.0 ~ 108.0 MHz	± 100 kHz
North America, South America and Australia	87.5 ~ 107.9 MHz	± 200 kHz
Asia and Europe	87.5 ~ 108.0 MHz	± 100 kHz
Japan	76.0 ~ 95.0 MHz	± 100 kHz

9. FUNCTION PRIORITY

9.1 Function Priority

The headset prioritizes connected devices in the following order:

- (highest) Mobile phone
- Bluetooth Intercom
- Music sharing via Bluetooth stereo music
- FM radio
- (lowest) Bluetooth stereo music

A lower-priority function gets interrupted by a higher-priority function. For example, stereo music will be interrupted by an **Intercom Conversation**; an **Intercom Conversation** will be interrupted by an incoming mobile phone call.

10. CONFIGURATION SETTING

10.1 Headset Configuration Setting

Access the Configuration Menu

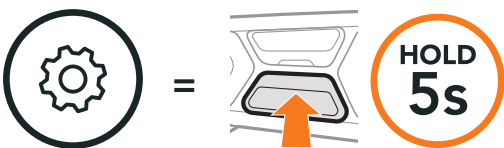

Navigate Between Menu Options

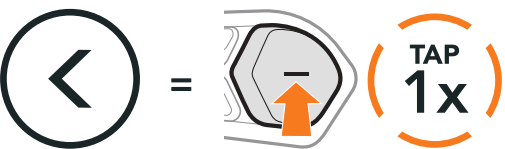
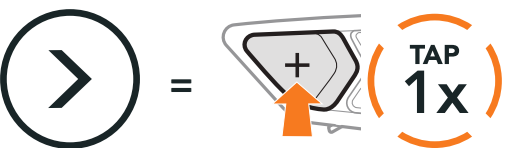

Execute Menu Options

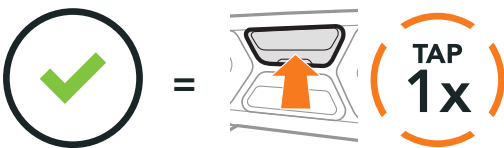

Headset Configuration Menu

Voice Configuration Menu	Tap the Center Button
Phone Pairing	None
Second Mobile Phone Pairing	None
GPS Pairing	None
Delete All Pairings	Execute
Universal Intercom Pairing	Execute
Factory Reset	Execute
Exit	Execute

10.1.1 Delete All Pairings

Delete All Bluetooth Pairing Information stored in the headset.

10.2 Software Configuration Setting

You can change the settings of the headset through the **SCHUBERTH Device Manager** or the **SCHUBERTH SC2 App**.

10.2.1 Speed Dial

Assign phone numbers for speed dialing to make a phone call quickly.

10.2.2 Headset Language

You can select the device language. The selected language is maintained even when the headset is rebooted.

10.2.3 VOX Phone (Default: Enable)

If this feature is enabled, you can answer incoming calls by voice. When you hear a ringtone for an incoming call, you can answer the phone by saying a word such as “**Hello**” loudly or by blowing air into the microphone. **VOX Phone** is temporarily disabled if you are connected to intercom. If this feature is disabled, you have to tap the **Center Button** to answer an incoming call.

10.2.4 VOX Intercom (Default: Disable)

If **VOX Intercom** is enabled, you can initiate an intercom conversation with the last connected intercom friend by voice. When you want to start intercom, say a word such as “**Hello**” loudly or blow air into the microphone. If you start an intercom conversation by voice, the intercom terminates automatically when you and your intercom friend remain silent for 20 seconds. However, if you manually start an intercom conversation by tapping the **Center Button**, you have to terminate the intercom conversation manually. However, if you start the intercom by voice and end it manually by tapping the **Center Button**, you will not be able to start intercom by voice temporarily. In this case, you have to tap the **Center Button** to restart the intercom. This is to prevent repeated unintentional intercom connections by strong wind noise. After rebooting the headset, you can start the intercom by voice again.

10.2.5 VOX Sensitivity (Default: 3)

VOX Sensitivity can be adjusted depending on your riding environment. **Level 5** is the highest sensitivity setting and **level 1** is the lowest.

10.2.6 HD Intercom (Default: Enable)

HD Intercom enhances the two-way intercom audio from normal quality to HD quality. **HD Intercom** will become temporarily disabled when you enter into a multi-way intercom. If this feature is disabled, the two-way intercom audio will change to normal quality.

Note: The intercom distance of **HD Intercom** is relatively shorter than that of normal intercom.

10.2.7 HD Voice (Default: Enable)

HD Voice allows you to communicate in high-definition during phone calls. This feature increases the quality so that the audio will be crisp and clear during phone call conversations.

If this feature is enabled, incoming phone calls will interrupt intercom conversations. Three-Way Conference Phone Call with Intercom Participant will not be available if **HD Voice** is enabled.

Note: Refer to the manufacturer of your Bluetooth device that will be connected to the headset to see if it supports **HD Voice**.

10.2.8 Sidetone (Default: Disable)

Sidetone is audible feedback of your own voice. It helps you to naturally speak at the correct level according to varying helmet noise conditions. If this feature is enabled, you can hear what you are speaking during an intercom conversation or a phone call.

10.2.9 Voice Prompt (Default: Enable)

You can disable voice prompts by software configuration settings, but the following voice prompts are always on.

- Headset configuration settings menu, battery level indicator, speed dial, FM radio functions

10.2.10 RDS AF Setting (Default: Disable)

Radio Data System (RDS) Alternative Frequency (AF) Setting allows a receiver to re-tune to the second frequency location when the first signal becomes too weak. With RDS AF enabled on the receiver, a radio station with more than one frequency can be used.

10.2.11 FM Station Guide (Default: Enable)

When **FM Station Guide** is enabled, FM station frequencies are given by voice prompts as you select preset stations. When **FM Station Guide** is disabled, the voice prompts on FM station frequencies will not be given as you select preset stations.

11. TROUBLESHOOTING

11.1 SC2 Standard Factory Reset

To erase all of your settings and start fresh, the headset can be restored to factory default settings using the **Factory Reset** feature.

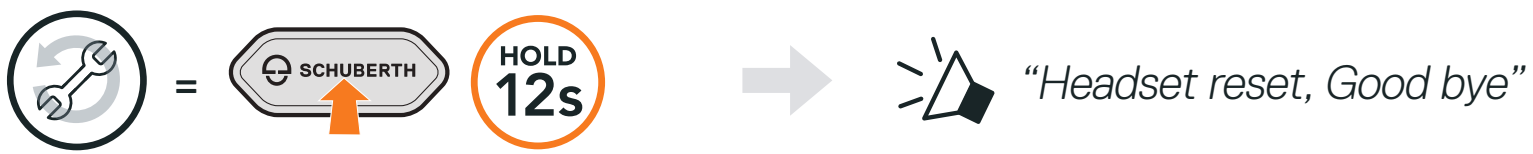

11.2 SC2 Standard Remote Control Factory Reset

To erase all of your settings and start fresh, the **SC2 Standard Remote Control** can be restored to factory default settings using the **Factory Reset** feature.

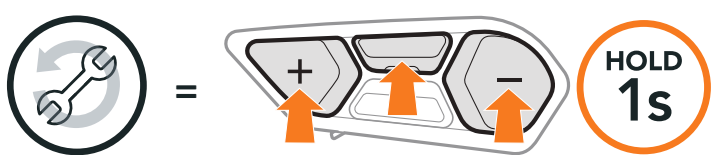

11.3 Remote Control Pairing

The **SC2 Standard** and the **SC2 Standard Remote Control** come paired together. They will automatically connect to each other when the **SC2 Standard** and the **SC2 Standard Remote Control** are powered on. If you are using a **SC2 Standard Remote Control** other than the one included in the package, follow the procedure below to pair the **SC2 Standard** and the **SC2 Standard Remote Control**.

1. On the **SC2 Standard**, press and hold the **Multi-function Button** for **5 seconds**.



2. On your **SC2 Standard Remote Control**, press and hold the **(+) Button** for **8 seconds** to enter Bluetooth-pairing mode.



3. The **SC2 Standard** will automatically perform pairing with the **SC2 Standard Remote Control** in pairing mode.

When they are successfully connected, you will hear a voice prompt.



"Remote control connected"

11.4 SC2 Standard Fault Reset

When the headset is not working properly, you can easily reset the unit.

1. Remove the installed **SC2 Standard** from the helmet by lifting it up with the SC2 Standard Remote Control cover.

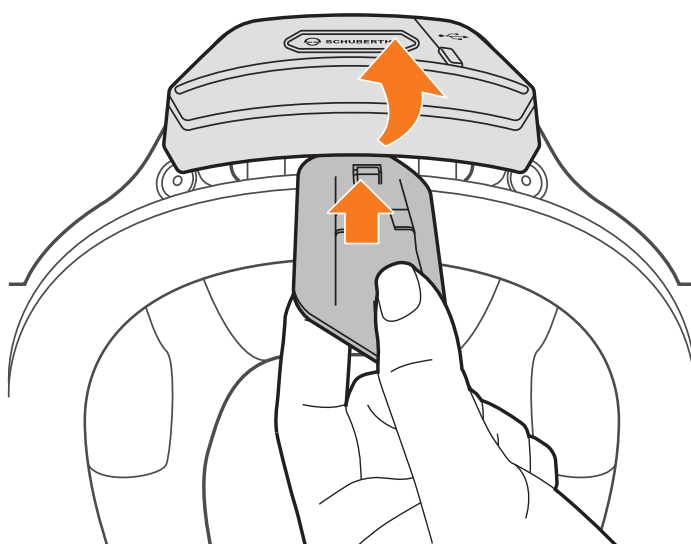

2. Pull the antenna cable retainer out from its original position, and pull out the connected cables from the upper gap in the space.

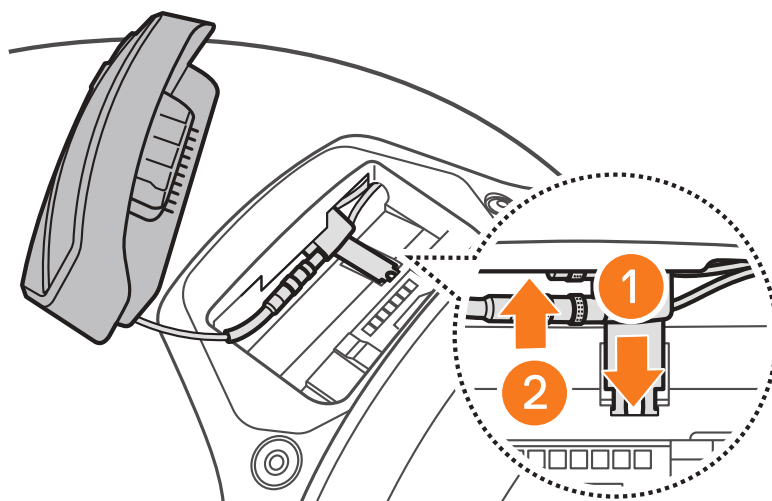

Note: You can reset the **SC2 Standard** without disconnecting the cables from the helmet.

3. Locate the **Pinhole Fault Reset Button** on the back of the **SC2 Standard**.

4. Gently insert a paperclip into the hole and tap the **Pinhole Fault Reset Button** with light pressure.

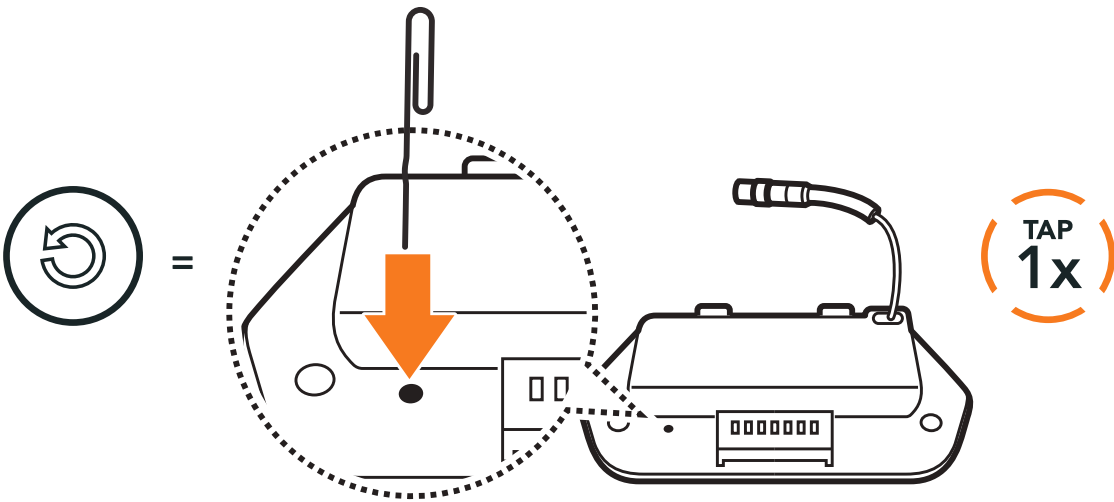

5. The headset will shut down.

Note: Fault Reset will not restore the headset to factory default settings.

Certification and Safety Approvals FCC Compliance Statement

This device complies with part 15 of the FCC rules. Operation is subject to the following two conditions:

- (1) This device may not cause harmful interference, and
- (2) This device must accept any interference received, including interference that may cause undesired operation.

This equipment has been tested and found to comply with the limits for a Class B digital device pursuant to part 15 of the FCC rules. These limits are designed to provide reasonable protection against harmful interference in a residential installation. This equipment generates, uses and can radiate radio frequency energy and, if not installed and used in accordance with the instructions, may cause harmful interference to radio communications. However, there is no guarantee that interference will not occur in a particular installation. If this equipment does cause harmful interference to radio or television reception, which can be determined by turning the equipment on and off, the user is encouraged to try to correct the interference by one or more of the following measures:

- Reorient or relocate the receiving antennae
- Increase the separation between the equipment and the receiver
- Connect the equipment into an outlet on a circuit different from that to which the receiver is connected.
- Consult the dealer or an experienced radio/TV technician for help.

FCC RF Exposure Statement

This equipment complies with FCC/IC radiation exposure limits set forth for an uncontrolled environment. End users must follow the specific operating instructions for satisfying RF exposure compliance. When equipped, the distance between antenna and one’ s head surface is 22mm.

FCC Caution

Any changes or modifications to the equipment not expressly approved by the party responsible for compliance could void user’ s authority to operate the equipment.

Industry Canada(IC) Statement

This device complies with Industry Canada license–exempt RSS standard(s). Operation is subject to the following two conditions:

- (1)this device may not cause interference, and
- (2)this device must accept any interference, including interference that may cause undesired operation of the device.

Le present appareil est conforme aux CNR d’ Industrie Canada applicables aux appareils radio exempts de licence. L’ exploitation est autorisee aux deux conditions suivantes :

- (1) l’ appareil ne doit pas produire de brouillage, et
- (2) l’ utilisateur de l’ appareil doit accepter tout brouillage radioelectrique subi, meme si le brouillage est susceptible d’ en compromettre le fonctionnement.

IC RF Exposure Statement

Cet quipement est conforme aux limites d'exposition aux radiations de la FCC/IC d finies pour un environnement non contr l . Les utilisateurs finaux doivent suivre les instructions d'utilisation sp cifiques pour satisfaire la conformit d'exposition RF. Lorsque quip , la distance entre l’ antenne et la surface de la t te est de 22mm.

Producer: Sena Technologies Co., Ltd.
19, Heolleung-ro 569-gil, Gangnam-gu
Seoul 06376, Republic of Korea

Importer in Europe: SCHUBERTH GmbH
Stegelitzer Straße 12
D-39126 Magdeburg, Germany

Importer in US: SCHUBERTH North America
9920 Pacific Heights Blvd., Suite 150
San Diego, CA 92121

WWW.SCHUBERTH.COM