

HONEYWELL
PART NUMBER

50039279-001

MRP ALIAS: CX-20323

REV

DOCUMENT

CHANGED BY

CHECK

B

0052208

SSK

13MAY09

CMH

(1.75)

THIS DEVICE COMPLIES WITH PART 15 OF
THE FCC RULES. OPERATION IS SUBJECT
TO THE FOLLOWING TWO CONDITIONS:
(1) THIS DEVICE MAY NOT CAUSE HARMFUL
INTERFERENCE AND (2) THIS DEVICE MUST
ACCEPT ANY INTERFERENCE RECEIVED,
INCLUDING INTERFERENCE THAT MAY CAUSE
UNDESIRE OPERATION.

CONTAINS: FCC ID: S5750025034
CONTAINS: 50025034, IC: 5731-50025034

(1.00)

NOTES

- 1 - MADE FROM GL-48194
- 2 - PERMANENTLY MARKED WITH BLACK THERMAL TRANSFER RIBBON
- 3 - CHARACTERS TO BE APPROXIMATE SIZE AS SHOWN

DESIGN UNITS: INCH

TOLERANCES UNLESS NOTED:

NO PLACES	X	±	0.400
ONE PLACE	.X	±	0.03
TWO PLACE	.XX	±	0.015
THREE PLACE	.XXX	±	0.005
ANGLES	X	±	3.0°

THIRD ANGLE PROJECTION

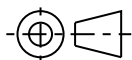

DRAWN

SJS

09FEB09

CHECK

-

-

THIS DRAWING COVERS A PROPRIETARY ITEM
AND IS THE PROPERTY OF HONEYWELL.
THIS DRAWING IS NOT TO BE COPIED OR USED
WITHOUT THE PERMISSION OF HONEYWELL.

INTERPRET PER ASME Y14.5M-1994
OTHER HONEYWELL ENGINEERING
STANDARDS MAY APPLY

Pro/ENGINEER

3D

Honeywell

TITLE

LABEL, FLEXIBLE

SIZE

TYPE

CAGE CODE

DRAWING NAME

REV

A**E****-****50039279****B**

SCALE

2 : 1

SHEET

1 OF 1

Honeywell

RF MOD: 50025034-001
FCC ID: S5750025034
IC: 5731-50025034

50025033-001
DSSS RADIO ASSY

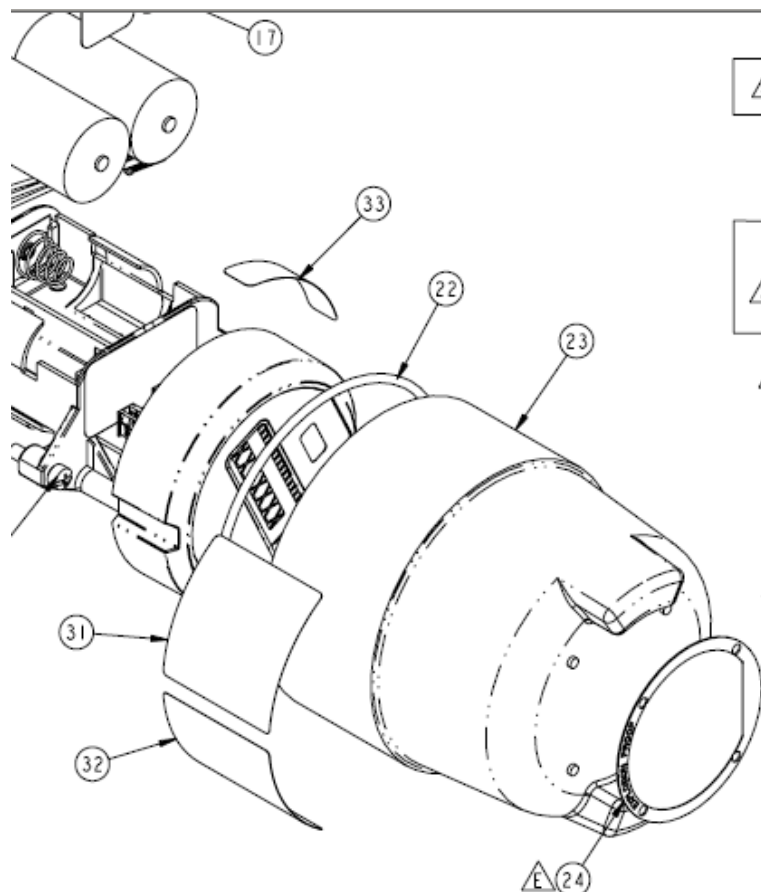

	36	USER MANUAL		1
⚠	35	SCREW, MACHINE THREAD	SEE SHAFT CHART	4
	34	BRACKET, MOUNTING	SEE SHAFT CHART	1
	33	LABEL, FLEXIBLE	50040877-001	1
	32	LABEL, FLEXIBLE	SEE PRODUCT CERTIFICATION CHART	1
	31	LABEL, FLEXIBLE	50039279-001	1
⚠	30	HARDWARE (ALLEN WRENCH)	30754459-002	1
	29	HARDWARE (DRIVER BIT)	GL-10054	1
⚠	28	SCREW, MACHINE THREAD	GK-20238	2
	27	CLAMP, SHEET METAL	CX-20264	1
	26	HARDWARE	CX-20266	1
⚠	25	FITTING, PIPE	EX-10511	1
	24	NAMEPLATE, METAL	SEE PRODUCT CERTIFICATION CHART	1
	23	COVER, DIE CAST	SEE ENCLOSURE/OPTIONAL FEATURE CHART	1
	22	SEAL, RING	CX-20049	1
	21	SCREW, SETSCREW	50039428-001	1
	20	ANTENNA, ASSEMBLY	SEE ANTENNA CHART	1
⚠	19	FITTING, ADAPTER	SEE ANTENNA CHART	1
	18	INSULATOR, SPECIAL	50038827-001	1
	17	BATTERY	50038976-001	2
	16	HOLDER, ASSEMBLY	50038801-001	1
	15	POTENTIOMETER, SUBASSEMBLY	50039116-001	1
	14	BRACKET, SHEET METAL	50038672-001	1
	13	BEARING, SHOULDERED	CX-20008	1
	12	SHAFT	CX-20223	1
	11	BEARING, SHOULDERED	CX-20006	1
	10	SCREW, ASSEMBLED WASHER	LS-20151	2
	9	SPACER, SLEEVE	50038890-001	2
	8	BRACKET, SHEET METAL	50038652-001	1
	7	WASHER, PLAIN	DD-10006	4
	6	SCREW, MACHINE THREAD	FE-32033	4
	5	SEAL, RING	EN-12273	1
	4	SHAFT, SUBASSEMBLY	SEE SHAFT CHART	1
	3	WASHER, PLAIN	CX-20030	1
	2	SPRING, TORSION	SEE SHAFT CHART	1
	1	ENCLOSURE, DIE CAST	SEE ENCLOSURE/OPTIONAL FEATURE CHART	1

PROPOSAL PRINT
NOT RELEASED TO PRODUCTION

