

STOP

RUN

STAGE LIGHT



**CAUTION**

**RISK OF ELECTRIC SHOCK  
DO NOT OPEN**



**CAUTION:**

TO REDUCE THE RISK OF ELECTRIC SHOCK.  
DO NOT REMOVE COVER (OR BACK).  
NO USER SERVICEABLE PARTS INSIDE.  
REFER SERVICING TO QUALIFIED SERVICE PERSONNEL.

**WARNING**

TO PREVENT ELECTRIC SHOCK  
DO NOT REMOVE BACK COVER  
NO USER SERVICEABLE PARTS INSIDE

Power Source : DC 12V --- 1200mA

FCC ID:S4W1703A

This device complies with Part 15 of the FCC Rules.  
Operation is subject to the following two conditions:  
(1) this device may not cause harmful interference, and  
(2) this device must accept any interference received,  
including interference that may cause undesired operation.  
This Class B digital apparatus complies with Canadian ICES-003

California 93120 compliant for formaldehyde

Imported by :  
Modern Marketing Concepts 1220 East Oak Street, Louisville, Kentucky 40204

**FDA CERTIFICATION**  
Product complies with FDA Rules 21 CFR- Subchapter  
J - application date of manufacture

**MADE IN CHINA**

**CROSLEY**

**Model: CR1703A**

**CLASS 1 LASER  
PRODUCT**

**“CAUTION: HAZARD LASER AND  
ELECTROMAGNETIC RADIATION WHEN  
OPEN AND INTERLOCK DEFEATED.  
ATTENTION: RAYONNEMENT LASER  
ET ELECTROMAGNETIQUE DANGERUX SI  
OUVERT AVEC L'ENCLenchMENT DE SEC-  
URITE ANNULE.”** (9CD9300310)

**AVOID EXPOSURE**

INVISIBLE LASER  
RADIATION IS EMITTED  
FROM THE APERTURE  
(9CD300200)

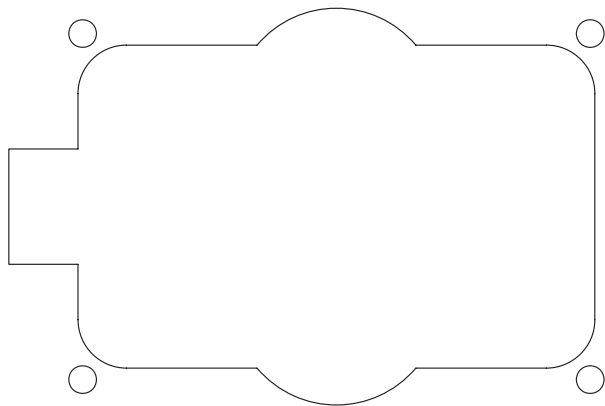

R SP+ L

Size:174x190mm



STOP ☐ RUN

STAGE LIGHT

**CAUTION**  
RISK OF ELECTRIC SHOCK  
DO NOT OPEN

**CAUTION:**  
TO REDUCE THE RISK OF ELECTRIC SHOCK,  
DO NOT REMOVE COVER (OR BACK).  
NO USER SERVICEABLE PARTS INSIDE.  
REFER SERVICING TO QUALIFIED SERVICE PERSONNEL.

**WARNING**  
TO PREVENT ELECTRIC SHOCK  
DO NOT REMOVE BACK COVER  
NO USER SERVICEABLE PARTS INSIDE

Power Source : DC 12V --- 1200mA

FCC ID: S4W1703A  
This device complies with Part 15 of the FCC Rules.  
Operation is subject to the following two conditions:  
(1) this device may not cause harmful interference, and  
(2) this device must accept any interference received,  
including interference that may cause undesired operation.  
This Class B digital apparatus complies with Canadian ICES-003  
California 93120 compliant for formaldehyde  
Imported by :  
Modern Marketing Concepts 1220 East Oak Street, Louisville, Kentucky 40204

**FDA CERTIFICATION**  
Product complies with FDA Rules 21 CFR- Subchapter  
J - application date of manufacture

**MADE IN CHINA**

**CROSLEY**  
Model: CR1703A

**CLASS 1 LASER  
PRODUCT**

"CAUTION: HAZARD LASER AND  
ELECTROMAGNETIC RADIATION WHEN  
OPEN AND INTERLOCK DEFEATED.  
ATTENTION: RAYONNEMENT LASER  
ET ELECTROMAGNETIQUE DANGERUX SI  
OUVERT AVEC L'ENCLenchMENT DE SEC-  
URITE ANNULE."  
(9CD9300310)

**AVOID EXPOSURE**  
INVISIBLE LASER  
RADIATION IS EMITTED  
FROM THE APERTURE  
(9CD300200)

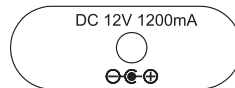
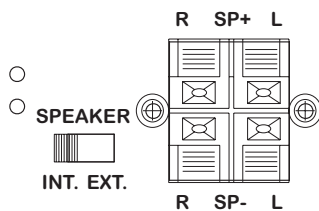



Label location

The label Screen print to the equipment by permanent adhesive