

M64WC Wireless Office Optical Mouse

SPECIFICATIONS

Part 1.0: General Features

- Totally Wireless freedom
- 27MHz digital radio technology
- Office function design
- 1 channel 256 ID to avoid interference (2 CH 512 ID optional)
- 800 DPI Optical precision
- 3 level power saving mode for mouse
- Office mouse come with 10 programmable buttons
- Rechargeable function for mouse
- Mouse charge from to USB Port or AC/DC Adapter optional
- Battery indicator

Part 2.0: Physical characteristics

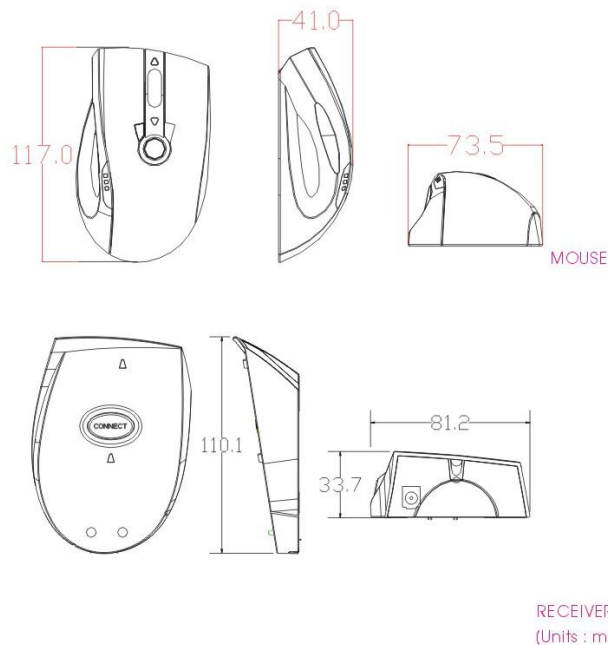

The mouse is setting-up 3 Leds for battery indicator.

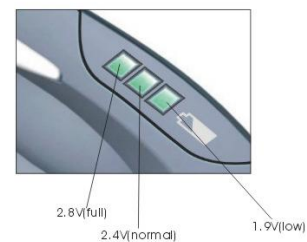

Frequency: Mouse 27.045 MHz (1 CH version)
27.045 MHz (2 CH version)
27.195 Mhz
ID numbers: 256 random ID per channel
Resolutions: 800 DPI
Sensor Tracking Speed: 16 inches / Second
Channel numbers : 1 channel(2 channel optional)

Battery

Battery type: two AAA 600mAh Ni-MH for mouse
Battery consumption:(@2.4v ,White paper)

Mouse:Operating Mode: ≤ 35 mA
Sleep Mode 1 : ≤ 4.5 mA
Sleep Mode 2 : ≤ 0.5 mA

Mechanical Performance

Operating force of mouse buttons	70 ± 10 gf
Operating force of Browser switches	170 ± 25 gf
Operating force of wheel scrolling	20 ± 10 gf
Operating force of ID buttons	100 ± 15 gf

Buttons

Mouse : 10 buttons with scrolling wheel,
1 connect button

Receiver : 1 connect button

Weight:

Mouse: 115 g (battery included)
Receiver: 135 g

Part 3.0: Electrical Specification

Interface : USB 1.1 or PS/2
Sensor report rate on mouse: 3000 times per second
Operation angle: 360 degrees
Operation distance: Mouse 1.2 meter
Sensor light on mouse: Red
Receiver power requirement: 5V DC from USB or PS/2 port

Part 4.0: Reliability

Mouse Button Switch Activation: 300,000 cycle
Scroll Wheel encoder Activation: 100,000 cycle
Operating temperature: -5 - 40 degrees celsius
Operating humidity: 20% - 90%

Part 5.0 System Requirement

Windows 98, Windows 98SE, Windows 2000, or
Windows xp. Windows ME.
Macintosh OS 8.6 or higher

REV: 1.0

Note:

This device complies with Part 15 of the FCC rules. Operation is subject to the following two conditions:

- (1) This device may not cause harmful interference, and
- (2) This device must accept any interference received, including interference that may cause undesired operation.

Caution:

The manufacturer is not responsible for any radio or TV interference caused by unauthorized modifications to this equipment. Such modifications could void the user authority to operate the equipment.