



1:18
Scale



Note to Adults

To ensure that the child's play is both safe and fun, please review all operating instructions and safety rules with your child.

Batteries Installation - Battery pack

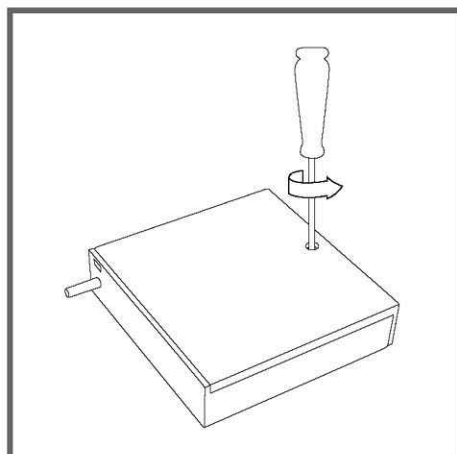

Unscrew battery door with a Philips head screwdriver (not included).

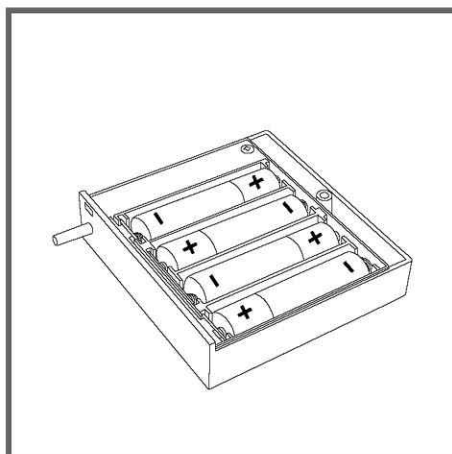

Install 4 AA alkaline batteries with polarity (+/-) as shown inside battery compartment.

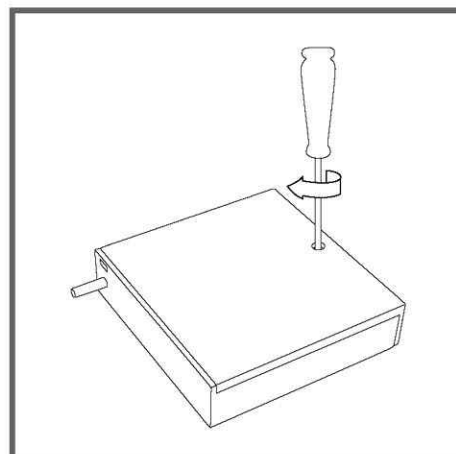

Close battery door and tighten screw.

Charging the bike and battery pack installation

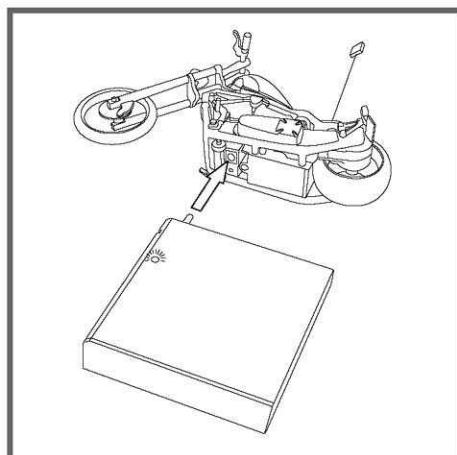

Insert charger pack into socket under the bike wait until the LED indicator turns off (90-120 seconds).

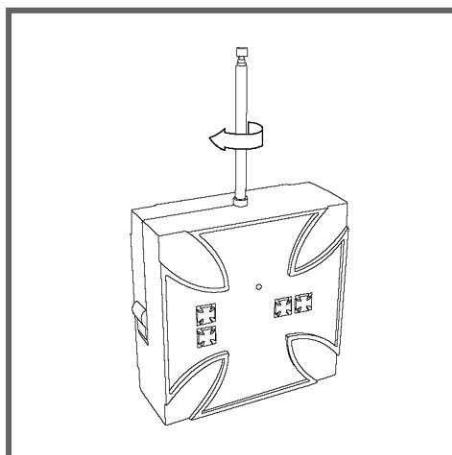

Tighten the antenna into the Transmitter.

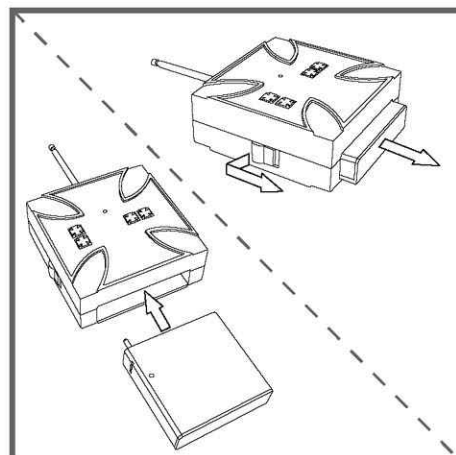

Insert battery pack into the transmitter. Push button to release battery pack.

Transmitter Operation

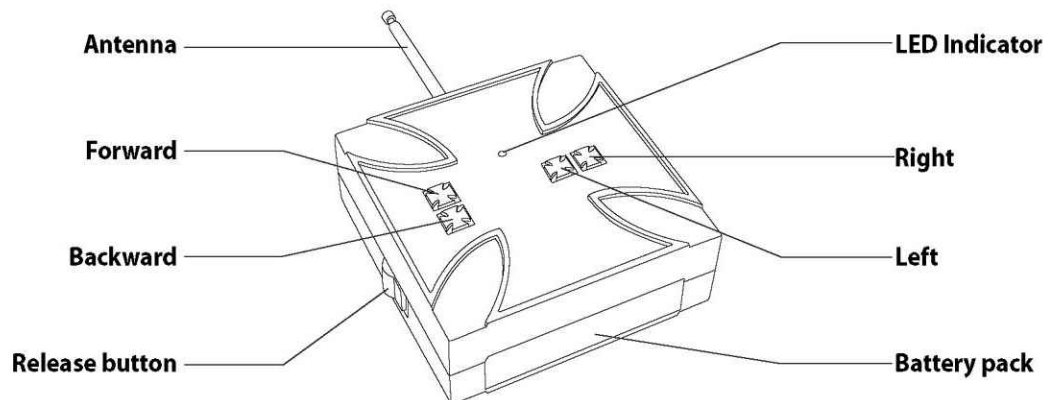

Battery Safety Information

Batteries may leak fluids that can cause damage to your toy. To avoid battery leakage:

- Do not mix old and new batteries or batteries of different types: alkaline, standard (carbon-zinc) or rechargeable (nickel-cadmium).
- Insert batteries as indicated inside the battery compartment.
- Remove batteries during long periods of non-use. Always remove exhausted batteries from the toy.
- Do not dispose of batteries in a fire. The batteries may explode or leak.
- Never short-circuit the battery terminals.
- Use only batteries of the same or equivalent.
- Do not charge non-rechargeable batteries.
- Remove rechargeable batteries from the toy before charging.
- If rechargeable batteries are used, they should be charged according to manufacturer's specifications and under adult supervision.

Battery Performance Note

For best performance, use alkaline batteries. Battery life will vary according to brand.

Safety Tips

- **NEVER** operate your bike on the street, thru water, sand, snow, thick carpet, or in the rain. If your bike gets wet, discontinue use until completely dry.
- **DO NOT** pick up bike while in motion.
- **DO NOT** store either unit near a source of heat or in direct sunlight for extended period.
- **DO NOT** drive the bike on the table top or other elevated surfaces.
- **DO NOT** attempt to recharge a charged bike. Additional charging will not increase running time and may damage the bike.
- Keep fingers, hair and loose clothing away from the wheels.
- Adult supervision is recommended when this bike is being operated.

Quick Tips

- Make sure the contacts on the vehicle are touching the charger contact during charging. If they're not, the LED indicator will not come on and the bike won't be charged.
- A full charge will give you several minutes of driving. After that you may recharge the vehicle for more driving fun.
- Radio interference may cause your bike to run poorly. In the event of interference, you may need to operate the vehicle in another location.
- Your bike's performance may vary depending on the driving surface.
- Point your transmitter antenna up, not downward toward your bike. If your bike gets too far away, it won't work properly.
- When charging becomes weak, it may be time to replace the batteries.

If you have any questions or comments, call our hotline at 1-800-301-9853 or E-mail to us at customerservice@musclerachines.com



© 2004 Funline Merchandise Co., Inc.
City of Industry, CA 91745
All Rights Reserved
MADE IN CHINA



Action is a registered trademark of
Action Performance Companies, Inc.
Funline Merchandise Co., Inc. is a
subsidiary of Action Performance
Companies, Inc.

TM & © 2004 West Coast Choppers, Inc.
All Rights Reserved Manufactured by
Funline Merchandise Co., Inc. and
used under license by Payupucker, Inc.

Modifications not authorized by the manufacturer may void users authority to operate this device.

NOTE: This equipment has been tested and found to comply with the limits for a Class B digital device, pursuant to Part 15 of the FCC Rules. These limits are designed to provide reasonable protection against harmful interference in a residential installation. This equipment generates, uses and can radiate radio frequency energy and, if not install and used in accordance with the instructions, may cause harmful interference to radio communications. However, there is no guarantee that interference will not occur in a particular installation. If this equipment does cause harmful interference to radio or television reception, which can be determined by turning the equipment off and on, the user is encouraged to try to correct the interference by one or more of the following measures:

- Reorient or relocate the receiving antenna.
- Increase the separation between the equipment and receiver.
- Connect the equipment into an outlet on a circuit different from that to which the receiver is connected
- Consult the dealer or an experienced radio/TV technician for help.

APPENDIX D

USER MANUAL INSERTS FOR PART 15

The users manual or instruction manual shall include the following statement:

Warning: Changes or modifications to this unit not expressly approved by the party responsible for compliance could void the user authority to operate the equipment.

In addition, for a Class B digital device or peripheral or cordless phone, the user manual shall include the following or similar statement, placed in a prominent location in the text of the manual:

NOTE: This equipment has been tested and found to comply with the limits for a Class B Digital device, pursuant to Part 15 of the FCC Rules. These limits are designed to provide reasonable protection against harmful interference in a residential installation. This equipment generates, uses and can radiate radio frequency energy and, if not installed and used in accordance with the instructions, may cause harmful interference to radio communications.

However, there is no guarantee that interference will not occur in a particular installation. If this equipment does cause harmful interference to radio or television reception, which can be determined by one or more of the following measures:

- .. **Reorient or relocate the receiving antenna.**
- .. **Increase the separation between the equipment and receiver.**
- .. **Connect the equipment into an outlet on a circuit different from that to which the receiver is needed.**
- .. **Consult the dealer or an experienced radio/TV technician for help.**

If shielded cables or special accessories are required for compliance, a statement must be include which instructs the user to employ them, for example:

Shielded cables must be used with this unit to ensure compliance with the Class B FCC limits.

FCC ID: RZH740010402T2

MADE IN CHINA

This device complies with part 15 of the FCC Rules. Operation is subject to the following two conditions: (1) this device may not cause harmful interference, and (2) this device must accept any interference received, including interference that may cause undesired operation.



Product Name: 1/18 R/C bike

Model Number: Item#74001

FCC ID: RZH740010402T4

MADE IN CHINA

This device complies with part 15 of the FCC Rules. Operation is subject to the following two conditions: (1) this device may not cause harmful interference, and (2) this device must accept any interference received, including interference that may cause undesired operation.