



RAZER LED LIGHT BAR  
MODEL: RZ43-0532

USER MANUAL

---

## WHAT'S INSIDE

- Razer LED Light Bar

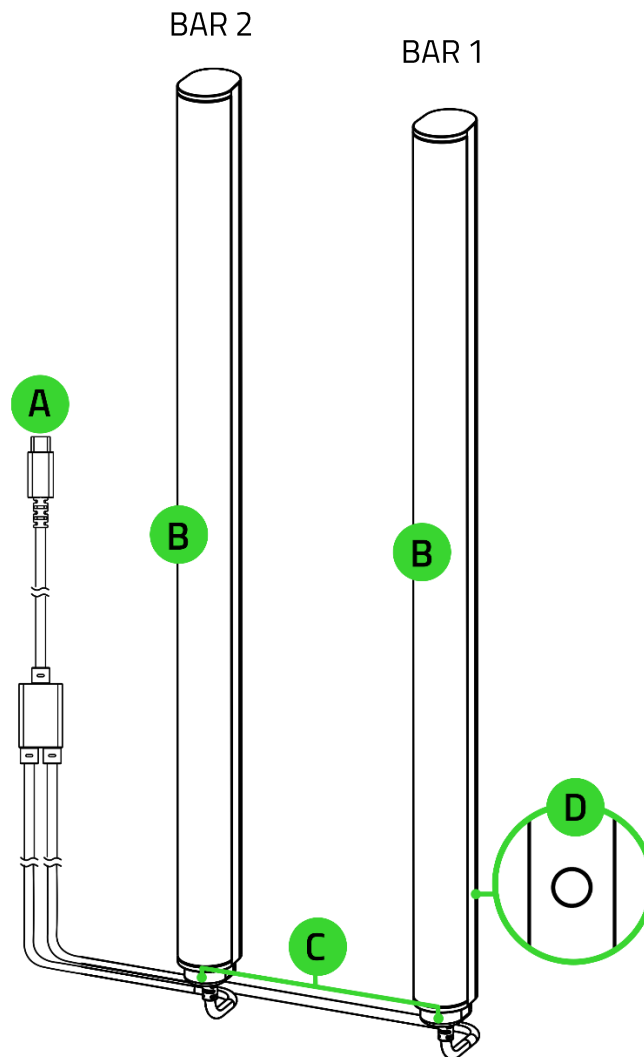

A. USB Type C connector

B. Reversible front-and-back dual lighting

C. Base mount

D. Power / Multifunction button

- 2 x Light bar stands



- Important Product Information Guide

---

## WHAT'S NEEDED

### PRODUCT REQUIREMENTS

- USB Type C port
- 2.4 GHz WiFi network (WPA / WPA2 encryption)
- WiFi-enabled PC / Laptop (Windows® 10 64-bit or higher)\*

### RAZER GAMER ROOM APP REQUIREMENTS

- iOS 16.4 / Android 9 (or higher) device with Bluetooth connectivity\*
- Internet connection for app installation

### RAZER SYNAPSE REQUIREMENTS

- Windows® 10 64-bit (or higher)
- Internet connection for software installation

*\*Bluetooth connectivity required for initial setup only.*

---

## LET'S GET YOU COVERED



Register your product and score exclusive benefits

**[razerid.razer.com/warranty](https://razerid.razer.com/warranty)**

*Your product's  
serial number can  
be found here.*

---

## SETTING IT UP

### 1. Assemble

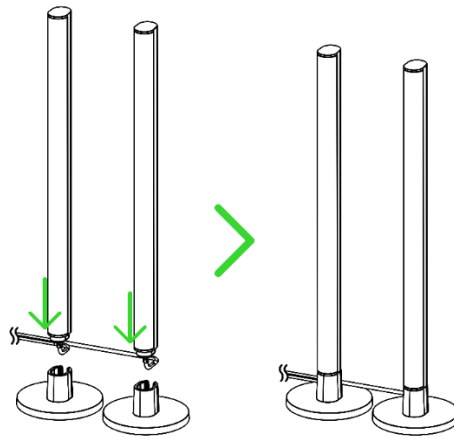

*The light bars can be oriented to face you or projected onto the walls, depending on your setup needs.*

### 2. Position

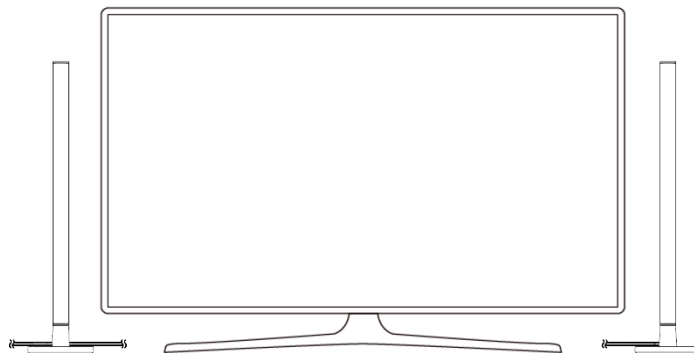

### 3. Connect

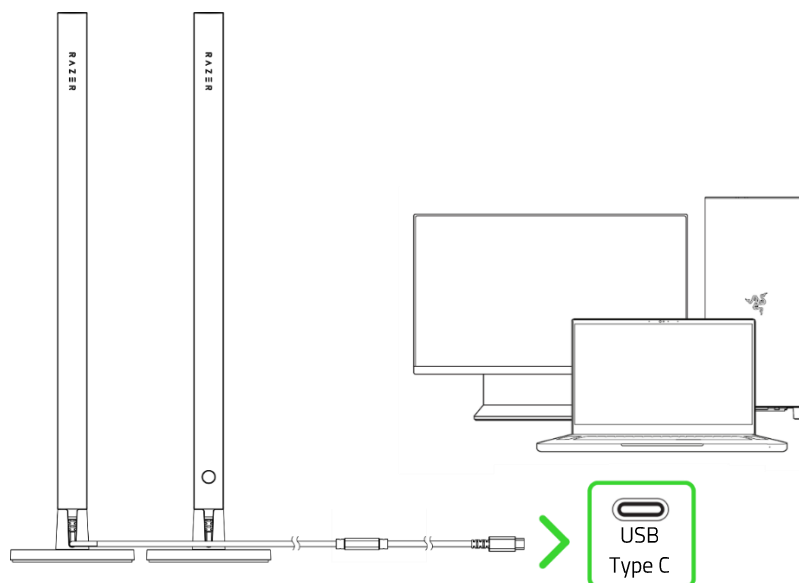

---

## CUSTOMIZING THE LIGHTING

### A. VIA MOBILE DEVICE USING THE RAZER GAMER ROOM APP (REQUIRED)

1.



RZR.TO/GAMER-ROOM-APP



Razer Gamer Room

2.

Power on

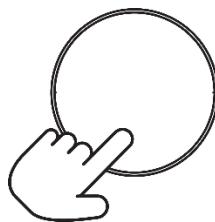

Press

3.



Razer Gamer Room



Launch the app, follow the onscreen instructions and scan the Matter™ QR code on the device. Please make sure that your mobile device is on your preferred 2.4 GHz network.

You can now customize the Razer LED Light Bar using the Razer Gamer Room app.

## B. VIA PC / LAPTOP USING THE RAZER SYNAPSE APP

- i** Before proceeding, make sure the light bars are already set up on your network (via the Razer Gamer Room app) and your PC is on the same network.

1.

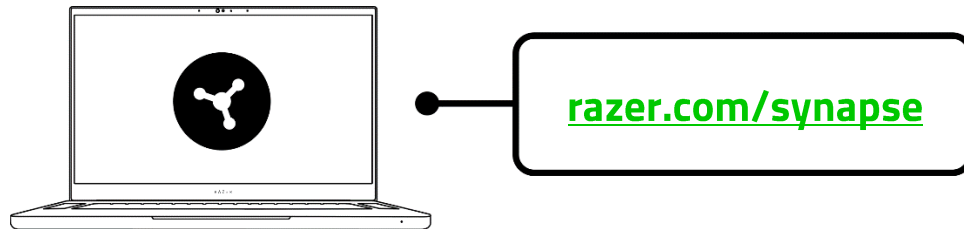

- !** Update Razer Synapse to its latest version or download its installer from [razer.com/synapse](https://razer.com/synapse). Registering for a Razer ID account is recommended but optional. You may continue as a guest; however, you won't be able to store any of your settings on the cloud.

2.



3.

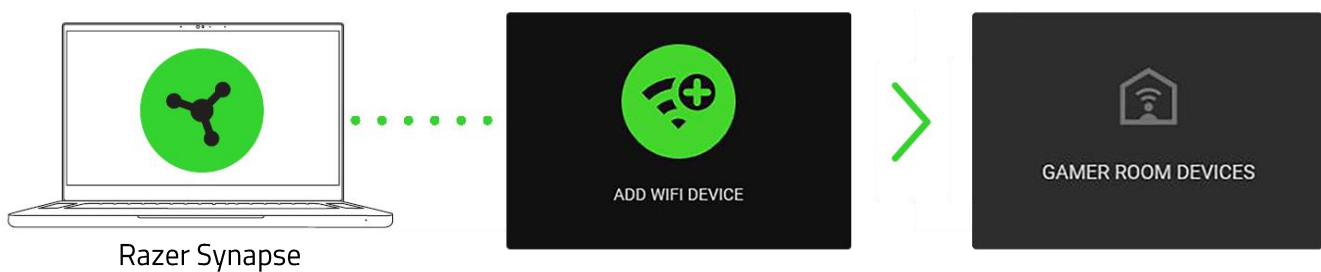

- i** Update Razer Synapse when prompted, and wait for Razer Synapse to set up the light bars.

You can now customize the Razer LED Light Bar using Razer Synapse.

## REACTIVATING PAIRING MODE

Pairing mode is required when setting up the light bars from the Razer Gamer Room app. It activates when you power on the light bars and deactivates after 15 minutes if left unpaired. To reactivate, switch off and on the light bars' power supply.

---

## USING THE LIGHT BARS

### POWER ON/OFF

Power on / off

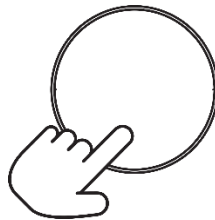

Press

### CYCLING BETWEEN LIGHTING EFFECTS

While  
powered on

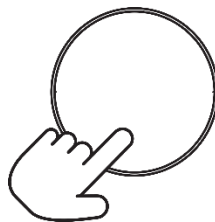

Press and  
hold\*

**STATIC (RED, WHITE, ORANGE, YELLOW, GREEN, CYAN, BLUE, PURPLE) > SPECTRUM  
CYCLING > UPWARD WAVE > DOWNWARD WAVE**

*\*Hold until the desired lighting effect is active.*

## RESETTING TO FACTORY SETTINGS

Once connected, a reset is required to connect the light bars to a new device.

1. While pressing and holding the Power / Multifunction button for more than 4 seconds, disconnect and reconnect the light bars.

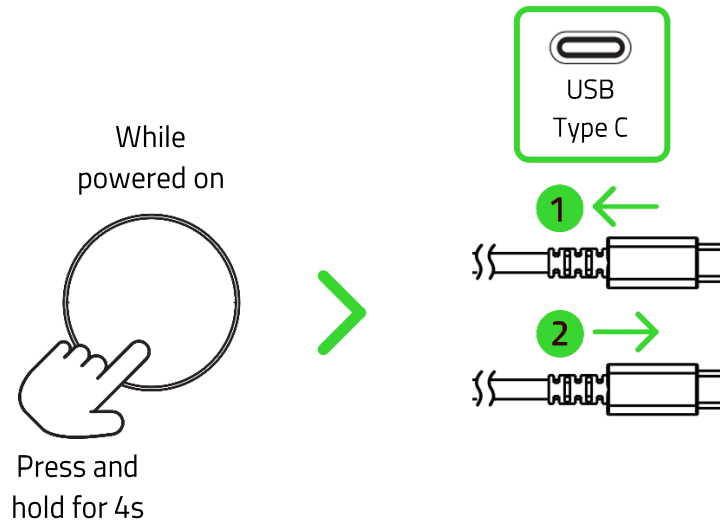

2. Wait for the light bars to briefly cycle through red, green, and blue before displaying the upward wave effect when the reset is successful.
3. Use the Razer Gamer Room app to connect the Razer LED Light Bar to a new mobile device.



---

## SAFETY AND MAINTENANCE

### SAFETY GUIDELINES

To achieve maximum safety while using your Razer LED Light Bar, we suggest that you adopt the following guidelines:

- Should you have trouble operating the device properly and troubleshooting does not work, unplug the device and contact the Razer hotline or go to [support.razer.com](https://support.razer.com) for assistance.
- Don't take apart the device and attempt to operate it under abnormal current loads. Doing so will void your warranty.
- Don't replace any of the light sources of this device. These should only be replaced by the manufacturer, service agent, or a similarly qualified person.
- Always make sure to securely fasten the light bars to their stands to prevent them from toppling over and causing harm or damage.
- Only use the light bars indoors.
- Don't use or install the device near water, moisture, solvents, or other wet surfaces, nor expose it to high temperatures or direct sunlight.
- Don't bend or expose any of the light bars to undue pressure.
- Keep the device away from liquid, humidity or moisture. Operate the device only within the specific temperature range of 0°C (32°F) to 40°C (104°F). Should the temperature exceed this range, unplug and/or switch off the device to stabilize the temperature to an optimal level.

### STATEMENT OF COMPLIANCE WITH UK PSTI

The full Statement of Compliance with UK PSTI is accessible via Internet address:

[www.razer.com/legal/compliance](https://www.razer.com/legal/compliance)

### MAINTENANCE AND USE

The Razer LED Light Bar requires minimum maintenance to keep it in optimum condition. Once a month, we recommend that you clean each light bar using a soft cloth to prevent dirt buildup. Don't use soap or harsh cleaning agents.

## REGULATORY AND COMPLIANCE INFORMATION

### DECLARATION FOR EU COMPLIANCE

Razer (Europe) GmbH, declares that this Razer LED Light Bar Model: RZ43-0532 is in compliance with the essential requirements and other relevant provisions of Directive 2014/53/EU & 2015/863/EU.

The full Declaration of Conformity is accessible via the following: Internet address: [www.razer.com/legal/compliance](http://www.razer.com/legal/compliance)

#### **Bluetooth LE (For EU)**

Operating Frequency: 2402 - 2480Mhz

RF Output power:  $\leq 9.82$  dBm (e.i.r.p.)

#### **WIFI (For EU)**

Operating Frequency: 2402 - 2480Mhz

RF Output power:  $\leq 18.67$  dBm (e.i.r.p.)



For indoor use only.

The external flexible cable or cord of this luminaire cannot be replaced; if the cord is damaged, the luminaire shall be destroyed.

The luminaires shall be supplied by an SELV source which should be certified with standard IEC / EN IEC 61347-2-13 (Class II, IP20 or higher, fail-safe or short circuit proof, with suitable output ratings, and maximum output voltage shall not exceed 60 VDC)

### FCC COMPLIANCE STATEMENTS

This device complies with Part 15 of the FCC Rules. Operation is subject to the following two conditions: (1) this device may not cause harmful interference, and (2) this device must accept any interference received, including interference that may cause undesired operation.

Note: This equipment has been tested and found to comply with the limits for a Class B digital device, pursuant to Part 15 of the FCC Rules. These limits are designed to provide reasonable protection against harmful interference in a residential installation. This equipment generates, uses and can radiate radio frequency energy and, if not installed and used in accordance with the instructions, may cause harmful interference to radio communications. However, there is no guarantee that interference will not occur in a particular installation.

If this equipment does cause harmful interference to radio or television reception, which can be determined by turning the equipment off and on, the user is encouraged to try to correct the interference by one or more of the following measures:

-- Reorient or relocate the receiving antenna.

- Increase the separation between the equipment and receiver.
- Connect the equipment into an outlet on a circuit different from that to which the receiver is connected.
- Consult the dealer or an experienced radio/TV technician for help.

Caution: Changes or modifications not expressly approved by the party responsible for compliance could void the user's authority to operate the equipment.

The device should be installed and operated with minimum distance 20cm between the radiator and your body.

## **Supplier's Declaration of Conformity**

### **Unique Identifier**

Trade Name: RAZER

Model No.: RZ43-0532

### **Responsible Party – U.S. Contact Information**

US Company Name: Razer Inc.

Address: 9 Pasteur, Suite 100 Irvine California 92618 United States

Telephone number or internet contact information: 1-855-872-5233

## **ISED COMPLIANCE STATEMENTS**

This device contains licence-exempt transmitter(s)/receiver(s) that comply with Innovation, Science and Economic Development Canada's licence-exempt RSS(s). Operation is subject to the following two conditions:

- (1) This device may not cause interference.
- (2) This device must accept any interference, including interference that may cause undesired operation of the device.

The device should be installed and operated with minimum distance 20cm between the radiator and your body.

L'émetteur/récepteur exempt de licence contenu dans le présent appareil est conforme aux CNR d'Innovation, Sciences et Développement économique Canada applicables aux appareils radio exempts de licence. L'exploitation est autorisée aux deux conditions suivantes :

- (1) L'appareil ne doit pas produire de brouillage;
- (2) L'appareil doit accepter tout brouillage radioélectrique subi, même si le brouillage est susceptible d'en compromettre le fonctionnement.

Cet équipement est conforme aux limites d'exposition aux radiations IC CNR-102 établies pour un environnement non contrôlé. L'appareil doit être installé et utilisé avec une distance minimale de 20 cm entre le radiateur et votre corps.

## **BATTERY WARNING**

The equipment contains a Li-ion rechargeable battery. In general, the life expectancy of such batteries is dependent upon usage. If you suspect that the Li-ion rechargeable battery inside the equipment may be drained (has a low charge), try charging it. Caution: Do not open, mutilate, or expose to conducting materials (metal), moisture, liquid, fire, or heat. Doing so may cause batteries to leak or explode, resulting in personal injury. Do not leave the rechargeable battery discharged or unused for extended periods. Battery life varies with usage.

## **BATTERY INFO**

Risk of fire or explosion or defeat the safeguard of equipment if the battery is replaced by an incorrect type. Replace only with the same or equivalent type. Disposal of a battery into fire or a hot oven, or mechanically crushing or cutting of a battery, that can result in an explosion. High or low extreme temperatures or low air pressure at high altitude that the battery can be subjected to during use, storage or transportation. Leaving the battery in an extremely high temperature and/or low air pressure surrounding environment that can result in an explosion or the leakage of flammable liquid or gas.

---

## **LEGALESE**

### **COPYRIGHT AND INTELLECTUAL PROPERTY INFORMATION**

©2024 Razer Inc. All rights reserved. Razer, the triple-headed snake logo, Razer logo, "For Gamers. By Gamers." and "Razer Chroma" are trademarks or registered trademarks of Razer Inc. and/or affiliated companies in the United States and other countries. Actual product may differ from pictures. All other trademarks are the property of their respective owners. Warranty not valid outside of product's intended region.

Android, Google, Google Logo, Google Play, and the Google Play logo are trademarks of Google LLC.

Apple, the Apple logo, and iPhone are trademarks of Apple Inc., registered in the U.S. and other countries. App Store is a service mark of Apple Inc. iOS is a trademark or registered trademark of Cisco in the U.S. and other countries and is used under license.

The Bluetooth® word mark and logos are registered trademarks owned by Bluetooth SIG, Inc., and any use of such marks by Razer is under license.

Windows and the Windows logo are trademarks of the Microsoft group of companies.

Razer Inc. ("Razer") may have copyright, trademarks, trade secrets, patents, patent applications, or other intellectual property rights (whether registered or unregistered) concerning the product in this guide. Furnishing of this guide does not give you a license to any such copyright, trademark, patent or other intellectual property right. The Razer LED Light Bar (the "Product") may differ from pictures whether on packaging or otherwise. Razer assumes no responsibility for such differences or for any errors that may appear. Information contained herein is subject to change without notice.

## **LIMITED PRODUCT WARRANTY**

For the latest and current terms of the Limited Product Warranty, please visit [razer.com/warranty](https://www.razer.com/warranty).

## **LIMITATION OF LIABILITY**

Razer shall in no event be liable for any lost profits, loss of information or data, special, incidental, indirect, punitive or consequential or incidental damages, arising in any way out of distribution of, sale of, resale of, use of, or inability to use the Product. In no event shall Razer's liability exceed the retail purchase price of the Product.

## **GENERAL**

These terms shall be governed by and construed under the laws of the jurisdiction in which the Product was purchased. If any term herein is held to be invalid or unenforceable, then such term (in so far as it is invalid or unenforceable) shall be given no effect and deemed to be excluded without invalidating any of the remaining terms. Razer reserves the right to amend any term at any time without notice.