



## Wireless Headset (RZ04-0443)

IMPORTANT PRODUCT INFORMATION GUIDE

---

## 1. WHAT'S INSIDE / WHAT'S NEEDED

### WHAT'S INSIDE

- Wireless Headset (RZ04-0443)

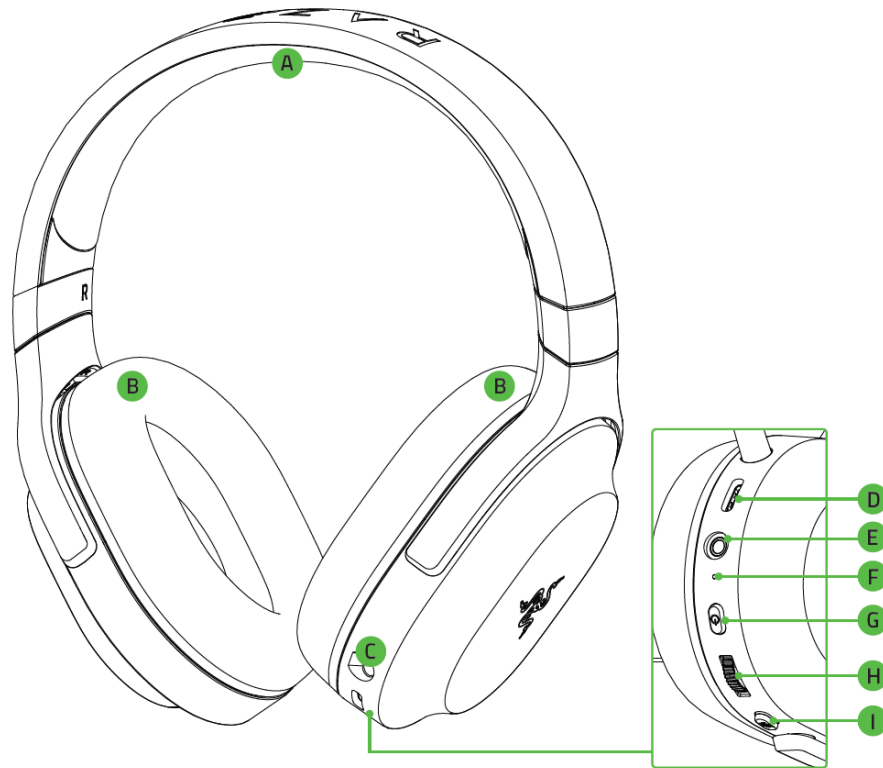

- A. Adjustable padded headband
- B. Ultra-soft leatherette memory foam ear cushions
- C. Microphone jack
- D. Type-C charging port
- E. 3.5 mm audio + mic jack
- F. Status indicator
- G. Razer SmartSwitch / Power button
- H. Volume control wheel
- I. Mic mute button

- Removable Razer™ HyperClear Cardioid Mic

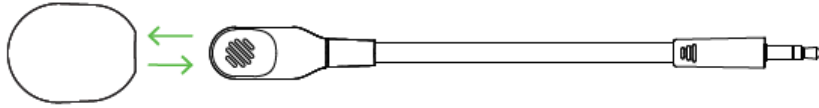

- Type-C wireless dongle



- Type-C charging cable

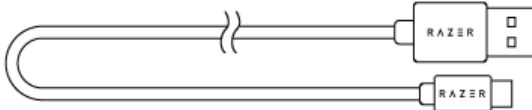

- Type-A to Type-C adapter cable

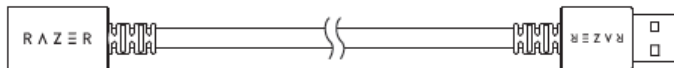

- 3.5 mm combo cable

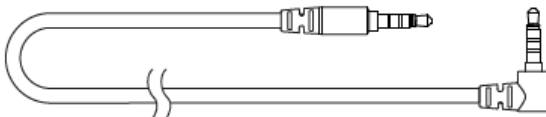

- Important Product Information Guide

## WHAT'S NEEDED

### Product requirements

- [Wireless] Devices with Bluetooth audio capability / USB Type-C or Type-A port
- [Wired] 3.5 mm audio + mic combined jack

### Razer Audio app requirements

- iOS 12 / Android 8.1 Oreo (or higher) device with Bluetooth connectivity
- Internet connection for app installation



*Compatible with Android / PC / PS4 / PS5 / Switch (wired and wireless) and Xbox (wired). Although compatible with most Android devices, earlier models may not fully support wireless USB-C audio. For a comprehensive list of compatible devices, please visit [support.razer.com](https://support.razer.com)*

---

## LET'S GET YOU COVERED

You've got a great device in your hands, complete with a 2-year limited warranty coverage. Now maximize its potential and score exclusive Razer benefits by registering at [razerid.razer.com](https://razerid.razer.com)

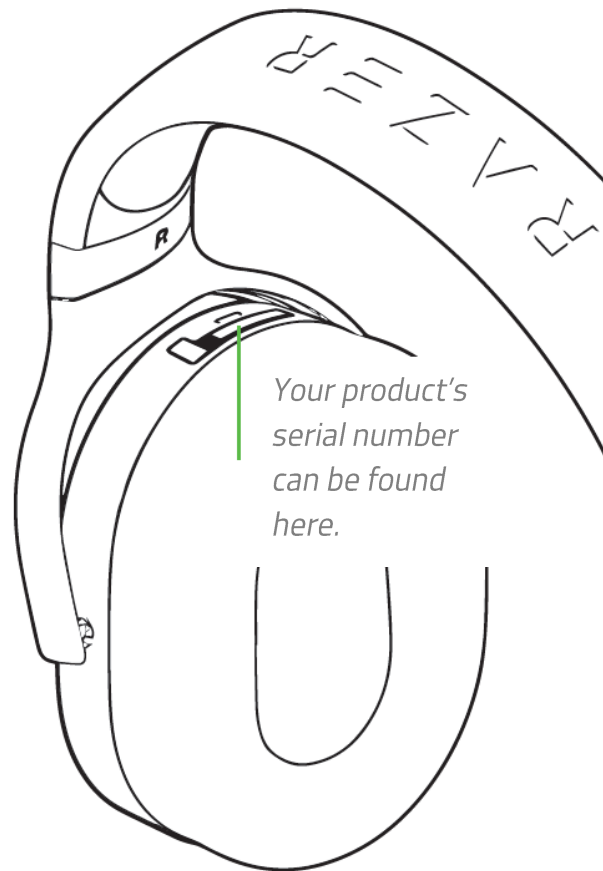



Got a question? Ask the Razer Support Team at [support.razer.com](https://support.razer.com)

## GETTING STARTED

### CHARGING YOUR HEADSET

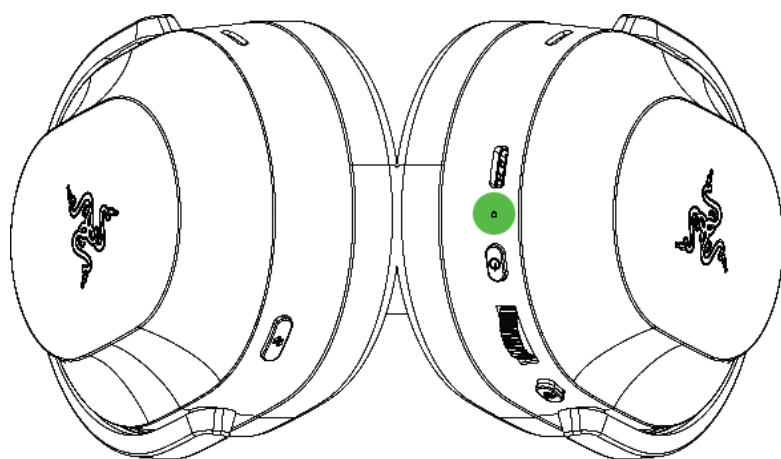
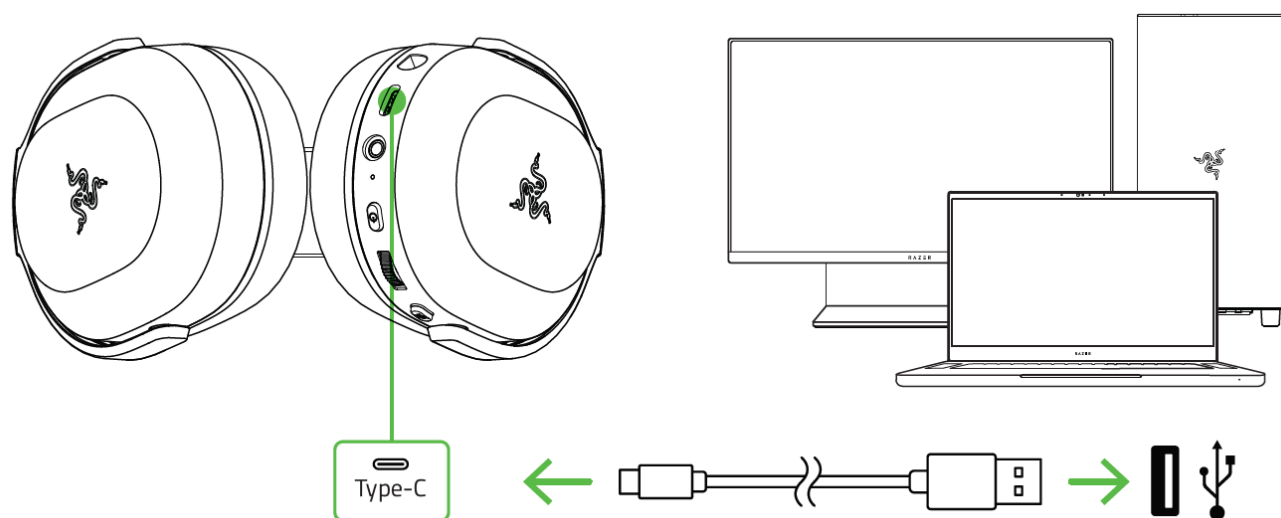
Connect your Gaming Headset to a powered USB Type-A port using the charging cable. For best results, please fully charge your headset before using it for the first time. A depleted unit will fully charge in about 3 hours.



Indicator	Battery level
	Fully charged
	Charging

## CONNECTING TO YOUR DEVICES

### A. Via Type-C wireless dongle (2.4 GHz)

1. Plug the Type-C wireless dongle into your device.

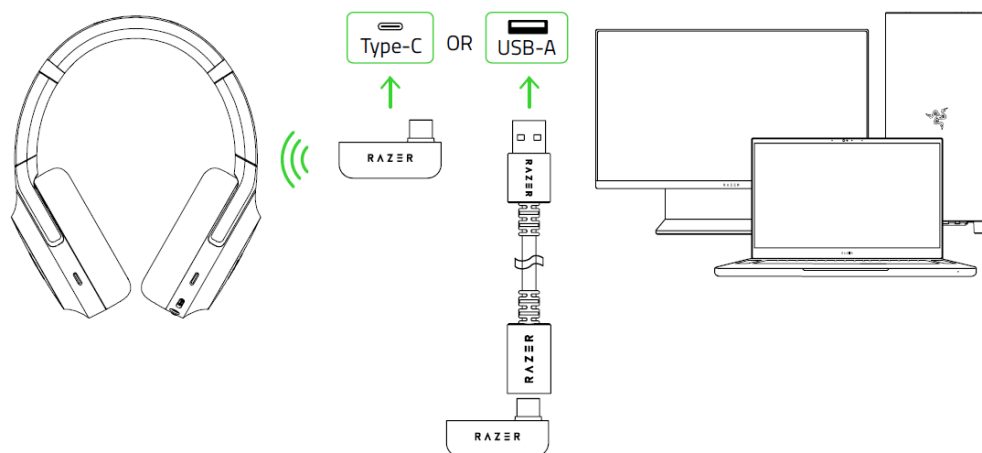

2. Press and hold the Razer SmartSwitch / Power button until the status indicator briefly lights up.

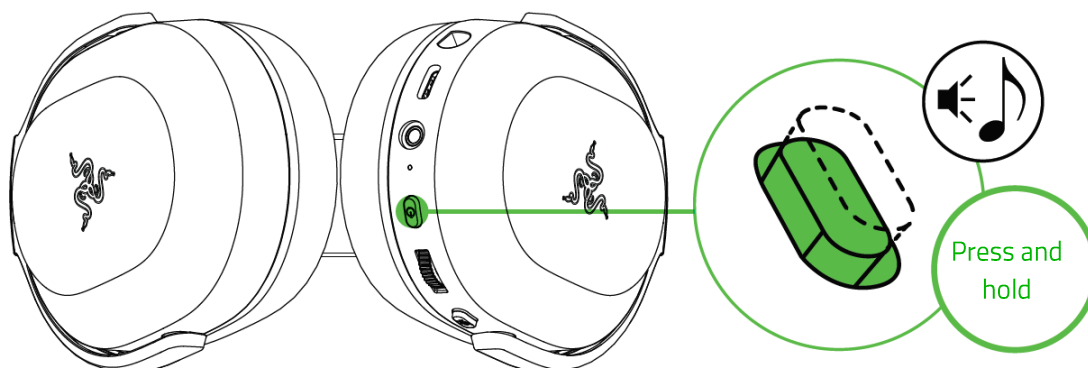

3. Wait until the status indicator briefly becomes static green indicating that the headset is connected to the Type-C wireless dongle.

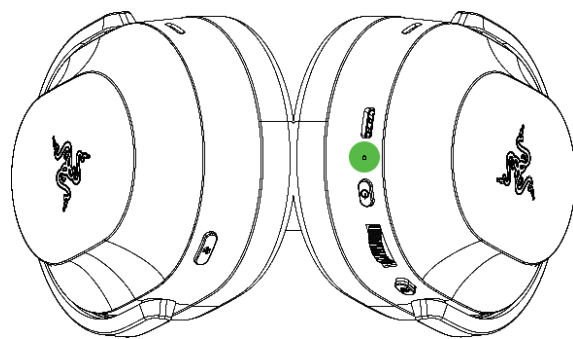

Indicator	Battery level
●	Connected

4. On your device (if applicable), set the Gaming Headset as the default **Input** and **Output Device**.

#### On PC / Laptop

- a. Right-click on the sound icon on the system tray and then select **Open Sound settings**.
- b. On the Sound window, set Gaming Headset as the default **Output** and **Input** device.

#### On PlayStation 5, go to Settings > Sound

- On **Microphone**, set the **Input Device** to Gaming Headset.
- On **Audio Output**, set the **Output Device** to Gaming Headset.



#### On PlayStation 4, go to Settings > Devices > Audio Devices

- Set the **Input Device** and **Output Device** to Gaming Headset.

#### B. Via Bluetooth

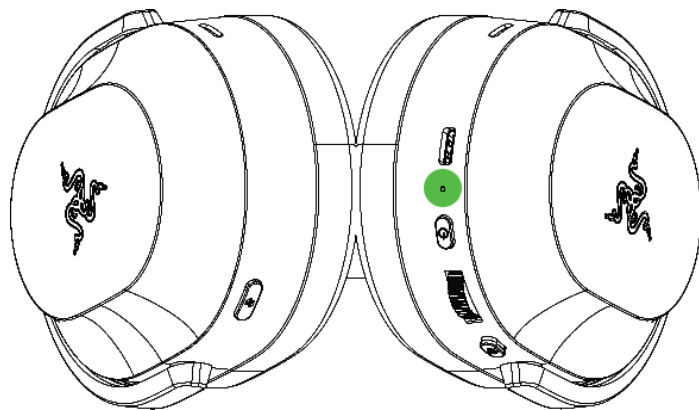
While powered off, press the Razer SmartSwitch / Power button for 5 seconds to activate Bluetooth pairing mode. Follow your device's instructions and select "Gaming Headset" from the list of found devices. The status indicator will briefly change to static blue to indicate that the headset is now paired with your device.



Indicator	Status
	Pairing
	Paired



### C. Via 3.5 mm audio + mic jack

If your device has a 3.5mm audio + mic combined jack, plug the 3.5mm combo cable from your headset into your device's audio jack.

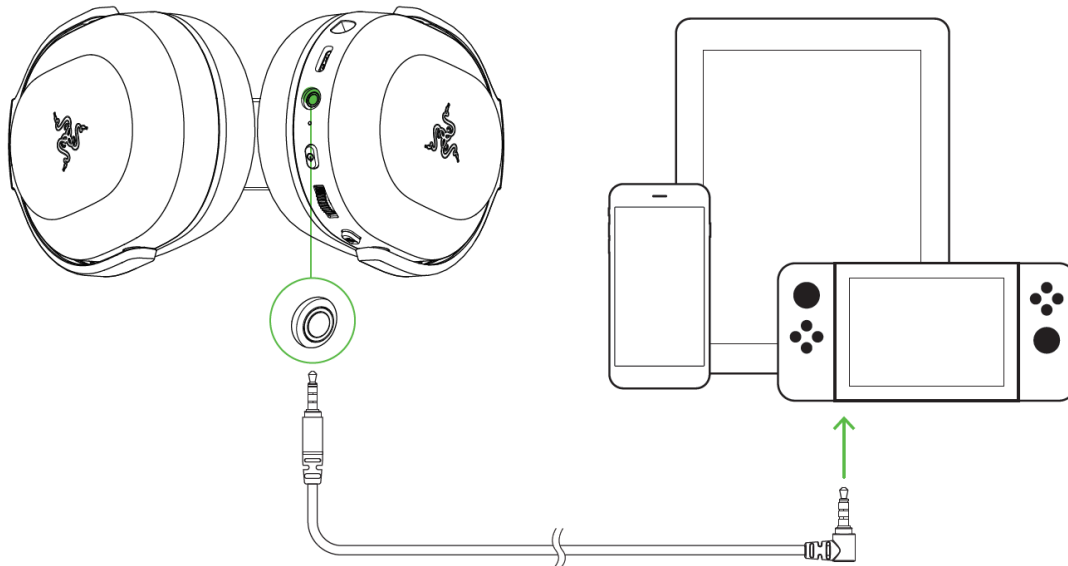

### RAZER SMARTSWITCH

With the Gaming Headset connected to a PC or gaming console (via 2.4 GHz) and a mobile device (via Bluetooth), you'll be able to conveniently take calls from a connected Bluetooth device and switch back to the game audio without removing the headset. The status indicator will briefly show static white to indicate that the headset is connected to both audio sources.

### RAZER AUDIO APP (MOBILE)

Making advanced customization just got a whole lot easier for the Gaming Headset. With the Razer Audio App, you'll be able to customize its EQ settings and auto shutoff feature, enable or disable gaming mode, and much more — anytime, anywhere.

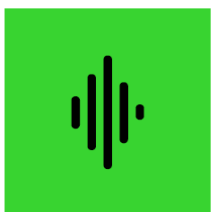

Razer Audio



OR



RZR.TO/AUDAPP  
(For China only)

- i** When using the app, make sure that the headset is only connected to your mobile device via Bluetooth. A solid blue status indicator indicates this connection.

---

## 5. USING YOUR HEADSET

### RAZER SMARTSWITCH / POWER BUTTON

#### Power ON / OFF

Power on the headset by holding the Razer SmartSwitch / Power button until the status indicator is on, and holding the Power button again to turn off. An audio prompt will help notify you when the headset is powered on or off.

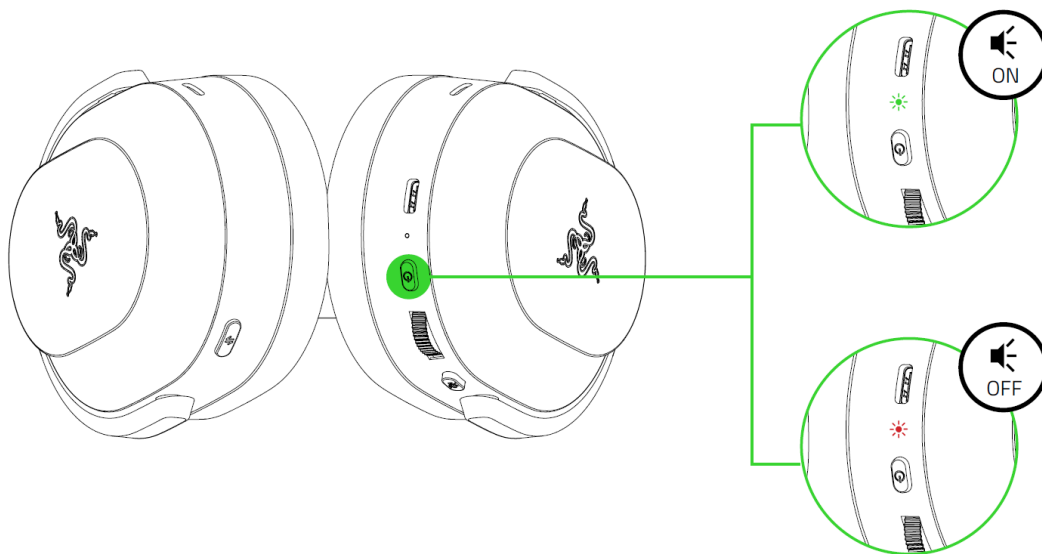

#### Switching audio source

When powered on and connected to any audio source, triple press the Razer SmartSwitch / Power button to switch between Type-C wireless dongle and Bluetooth audio source or vice versa.

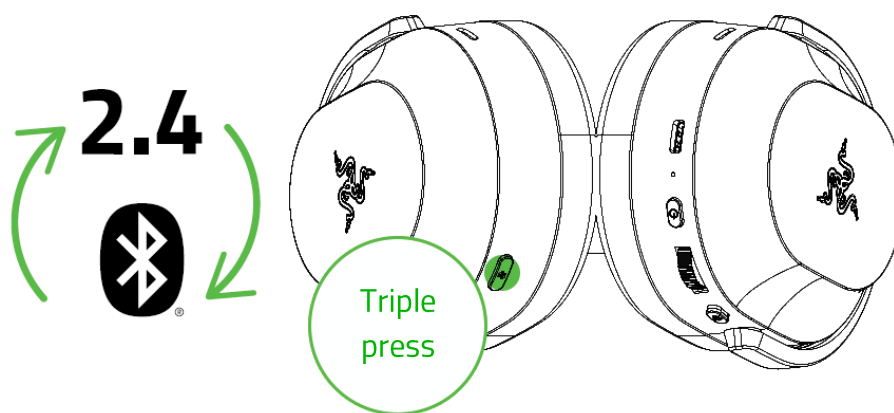

- i** Using Bluetooth as the audio source will reconnect the headset to the last known device. Pairing mode will be activated if no device is found.

### Other functions

Other Razer SmartSwitch / Power button functions are available when the headset is powered on with Bluetooth as the audio source. These functions operate based on your device's current activity and may not apply to certain devices.

Single press	Play/pause*
	Accept incoming call or end current call
	Put call on-hold and accept incoming call
	End call and swap to on-hold call
Double press	Skip track
While powered off, press and hold for 5 seconds	Activate Bluetooth pairing mode

*\*You can also use this function when using the Type-C wireless dongle as an audio source.*

### VOLUME WHEEL

Rotate the Volume wheel to increase or decrease the volume.

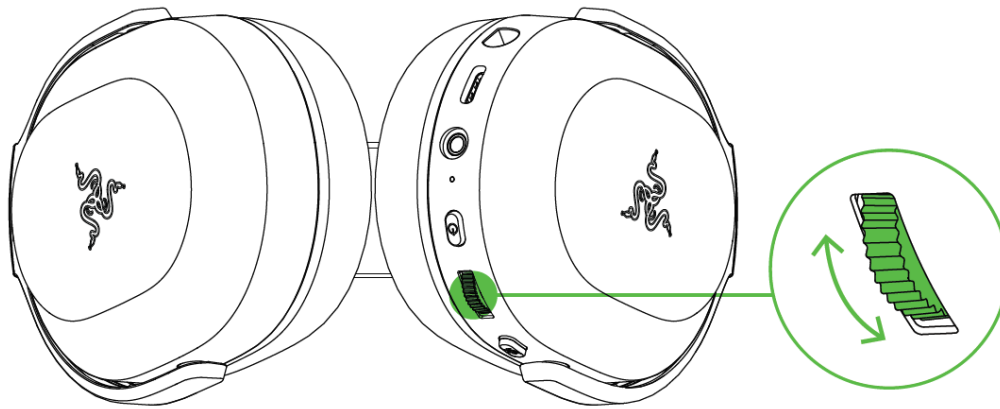

## USING THE RAZER™ HYPERCLEAR CARDIOID MIC

Plug the Razer™ HyperClear Cardioid Mic to the microphone jack and bend until it is parallel to your mouth. Make sure the mic diaphragm is in front and the air vent is facing away from your mouth.

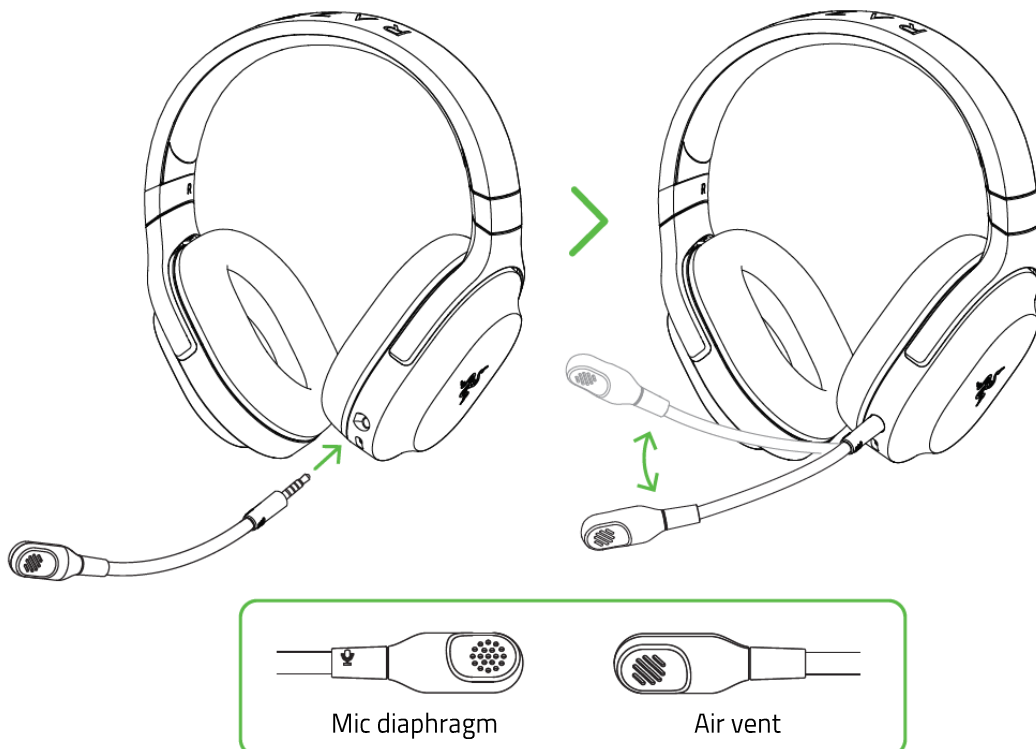

## MUTING / UNMUTING THE MICROPHONE

Press the mic mute button to mute or unmute the microphone.

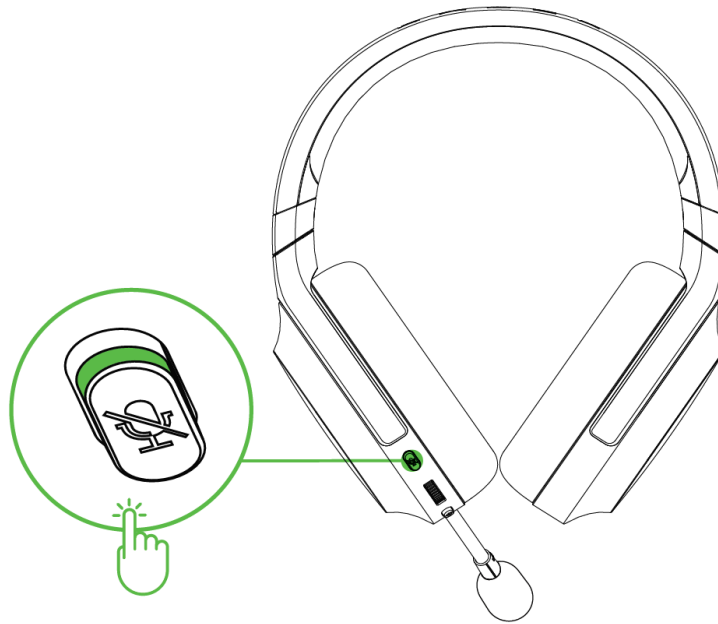

## EXTENDING YOUR HEADSET'S LIFESPAN

We recommend stretching the headset gently apart before placing them over your head to minimize headband stress. However, please avoid overstretching the headset beyond its technical limits.

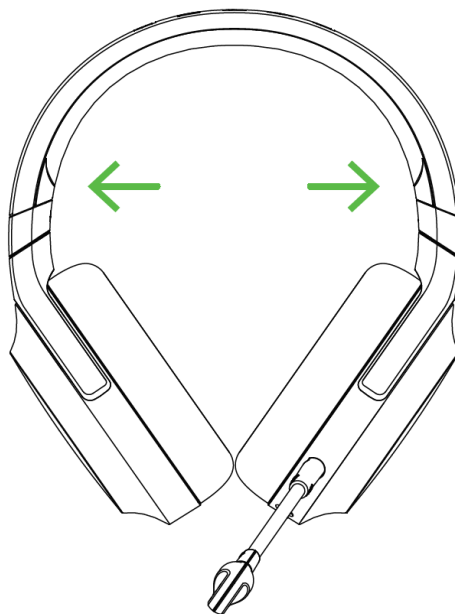

## ACTIVATE THE 7.1 SURROUND SOUND\*

Experience accurate positional sound that's specifically designed for games, movies, and music.

1. Download the 7.1 Surround Sound software from [razer.com/7.1-surround-sound](https://www.razer.com/7.1-surround-sound).
2. Register your product at [razerid.razer.com/products](https://razerid.razer.com/products) to get your activation code sent to your email.

*\*Only available on Windows 10 64-bit and above.*

---

## SAFETY AND MAINTENANCE

### SAFETY GUIDELINES

In order to achieve maximum safety while using your Gaming Headset, we suggest that you adopt the following guidelines:

Should you have trouble operating the device properly and troubleshooting does not work, unplug the device and contact the Razer hotline or go to [support.razer.com](https://support.razer.com) for assistance.

Do not take apart the device and do not attempt to operate it under abnormal current loads. Doing so will void your warranty.

Keep the device away from liquid, humidity or moisture. Operate the device only within the specific temperature range of 0°C (32°F) to 40°C (104°F). Should the temperature exceed this range, unplug and/or switch off the device in order to let the temperature stabilize to an optimal level.

The device isolates external ambient sounds even at low volumes, resulting in lowered awareness of your external surroundings. Please remove the device when engaging in any activities that requires active awareness of your surroundings.

Listening to excessively loud volumes over extended periods of time can damage your hearing. Furthermore, legislation of certain countries permits a maximum sound level of 86db to affect your hearing for 8 hours a day. We therefore recommend that you reduce the volume to a comfortable level when listening for prolonged periods of time. Please, take good care of your hearing.

## MAINTENANCE AND USE

The Gaming Headset requires minimum maintenance to keep it in optimum condition. Once a month we recommend you clean it using a soft cloth or cotton swab to prevent dirt buildup. Do not use soap or harsh cleaning agents.

## BATTERY WARNING

The Gaming Headset contains a Li-ion rechargeable battery. In general, the life expectancy of such batteries is dependent upon usage. If you suspect that the Li-ion rechargeable battery inside the Gaming Headset may be drained (has a low charge), try charging it.

**Caution:** Do not open, mutilate, or expose to conducting materials (metal), moisture, liquid, fire, or heat. Doing so may cause batteries to leak or explode, resulting in personal injury. Battery life varies with usage.

---

## LEGALESE

### COPYRIGHT AND INTELLECTUAL PROPERTY INFORMATION

©2022 Razer Inc. All rights reserved. Razer, the triple-headed snake logo, Razer logo, and “For Gamers. By Gamers.” are trademarks or registered trademarks of Razer Inc. and/or affiliated companies in the United States or other countries. All other trademarks are the property of their respective owners.

Android, Google, Google Logo, Google Play, and the Google Play logo are registered trademarks of Google LLC.

Apple, the Apple logo, and iPhone are trademarks of Apple Inc., registered in the U.S. and other countries. App Store is a service mark of Apple Inc. iOS is a trademark or registered trademark of Cisco in the U.S. and other countries and is used under license.

The Bluetooth® word mark and logos are registered trademarks owned by Bluetooth SIG, Inc., and any use of such marks by Razer is under license.

Windows and the Windows logo are trademarks or registered trademarks of the Microsoft group of companies.

Razer Inc. ("Razer") may have copyright, trademarks, trade secrets, patents, patent applications, or other intellectual property rights (whether registered or unregistered) concerning the product in this guide. Furnishing of this guide does not give you a license to any such copyright, trademark, patent or other intellectual property right. The Gaming Headset (the "Product") may differ from pictures whether on packaging or otherwise. Razer assumes no responsibility for such differences or for any errors that may appear. Information contained herein is subject to change without notice.

## LIMITED PRODUCT WARRANTY

For the latest and current terms of the Limited Product Warranty, please visit [razer.com/warranty](https://www.razer.com/warranty).

## LIMITATION OF LIABILITY

Razer shall in no event be liable for any lost profits, loss of information or data, special, incidental, indirect, punitive or consequential or incidental damages, arising in any way out of distribution of, sale of, resale of, use of, or inability to use the Product. In no event shall Razer's liability exceed the retail purchase price of the Product.

## GENERAL

These terms shall be governed by and construed under the laws of the jurisdiction in which the Product was purchased. If any term herein is held to be invalid or unenforceable, then such term (in so far as it is invalid or unenforceable) shall be given no effect and deemed to be excluded without invalidating any of the remaining terms. Razer reserves the right to amend any term at any time without notice.





## STATEMENT OF COMPLIANCE WITH EU DIRECTIVE

### ENGLISH

STATEMENT OF COMPLIANCE WITH EU DIRECTIVE Hereby, Razer (Europe) GmbH, declares that this Wireless Headset (model: RZ04-0443) and USB Wireless Transceiver (Model: RC30-0378) is in compliance with the essential requirements and other relevant provisions of Directive 2014/53/EU & 2015/863/EU.

#### [Wireless Headset]

Radio Frequency: 2.4GHz SRD/Bluetooth

Frequency Band: 2402MHz-2480MHz

RF Power: <11dBm

## FCC Statement

This equipment has been tested and found to comply with the limits for a Class B digital device, pursuant to part 15 of the FCC Rules. These limits are designed to provide reasonable protection against harmful interference in a residential installation. This equipment generates uses and can radiate radio frequency energy and, if not installed and used in accordance with the instructions, may cause harmful interference to radio communications. However, there is no guarantee that interference will not occur in a particular installation. If this equipment does cause harmful interference to radio or television reception, which can be determined by turning the equipment off and on, the user is encouraged to try to correct the interference by one or more of the following measures:

- Reorient or relocate the receiving antenna.
- Increase the separation between the equipment and receiver.
- Connect the equipment into an outlet on a circuit different from that to which the receiver is connected.
- Consult the dealer or an experienced radio/TV technician for help.

This device complies with FCC radiation exposure limits set forth for an uncontrolled environment. This device complies with Part 15 of the FCC Rules. Operation is subject to the following two conditions: (1) this device may not cause harmful interference, and (2) this device must accept any interference received, including interference that may cause undesired operation.

## Caution!

Any changes or modifications not expressly approved by the party responsible for compliance could void the user's authority to operate the equipment.

### FCC Radiation Exposure Statement:

This equipment complies with FCC radiation exposure limits set forth for an uncontrolled environment. End users must follow the specific operating instructions for satisfying RF exposure compliance. This transmitter must not co-located or operating in conjunction with any other antenna or transmitter.

The separation distance is 0mm.

## Canada Statement

This device contains licence-exempt transmitter(s)/receiver(s) that comply with Innovation, Science and Economic Development Canada's licence-exempt RSS(s). Operation is subject to the following two conditions:

- (1) This device may not cause interference.
- (2) This device must accept any interference, including interference that may cause undesired operation of the device.

L'émetteur/récepteur exempt de licence contenu dans le présent appareil est conforme aux CNR d'Innovation, Sciences et Développement économique Canada applicables aux appareils radio exempts de licence. L'exploitation est autorisée aux deux conditions suivantes :

- 1) L'appareil ne doit pas produire de brouillage;
- 2) L'appareil doit accepter tout brouillage radioélectrique subi, même si le brouillage est susceptible d'en compromettre le fonctionnement.

#### RADIATION EXPOSURE STATEMENT:

The product comply with the Canada portable RF exposure limit set forth for an uncontrolled environment and are safe for intended operation as described in this manual. The further RF exposure reduction can be achieved if the product can be kept as far as possible from the user body or set the device to lower output power if such function is available.

#### DÉCLARATION D'EXPOSITION AUX RADIATIONS:

Le produit est conforme aux limites d'exposition pour les appareils portables RF pour les Etats-Unis et le Canada établies pour un environnement non contrôlé. Le produit est sûr pour un

FOR GAMERS. BY GAMERS.™

12

---

fonctionnement tel que décrit dans ce manuel. La réduction aux expositions RF peut être augmentée si l'appareil peut être conservé aussi loin que possible du corps de l'utilisateur ou que le dispositif est réglé sur la puissance de sortie la plus faible si une telle fonction est disponible.

#### CANADA SAR

This transmitter must not be co-located or operating in conjunction with any other antenna or transmitter. This equipment should be installed and operated with a minimum distance of 0mm between the radiator and your body.

Cet émetteur ne doit pas être Co-place ou ne fonctionnant en même temps qu'aucune autre antenne ou émetteur. Cet équipement devrait être installé et actionné avec une distance minimum de 0mm entre le radiateur et votre corps.