

Series II Mini Transmitter with Flashlight



INSTRUCTIONS

1 IMPORTANT INFORMATION

NOTE: Use only with Series II Electronics. Operates up to three Intellicode Garage Door Openers manufactured after 1997. There are no Security Code Switches inside the Door Operators or Transmitters.

WARNING

Moving Door can cause serious injury or death.



- * Do Not install transmitter unless the door operator's safely reverse works as required by the door operators manual.
- * Wall control must be mounted in sight of door, at least 5 feet above floor and clear of moving door parts
- * Keep people clear of opening while door is moving.
- * Do Not allow children to play with the transmitter or door operator.

If safely reverse does not work properly

- * Close door then disconnect operator using the manual release handle
- * Do Not use transmitter or door operator.
- * Refer to Door and Door Operator Owner's Manuals before attempting any repairs.

2 TO PROGRAM THE RECEIVER

A different Transmitter Code is set at the factory for each INTELLICODE Transmitter.

Step 2-1 Locate the Receiver Learn Code Button and Radio Signal Indicator on the Power Head of your Door Operator.

Step 2-2 Press and release the Learn Code Button Fig 1

- * The Radio Signal indicator will blink approximately 2 times per second.

Step 2.3 Press a Transmitter Button once within 30 seconds.

- * The Radio Signal Indicator stays lit-SOLID.

Step 2.4 Press the same Transmitter Button. The Radio Signal Indicator will go out (the Transmitter Code is now stored in (Receiver memory).

NOTE: If a second Transmitter Code is not confirmed within 30 seconds or if a different Transmitter Code is sent, the Radio Signal Indicator will blink approximately 4 times per second, then programming will stop. If programming stops, repeat previous steps.

Step 2-5 Repeat previous steps for each Transmitter to be learned.

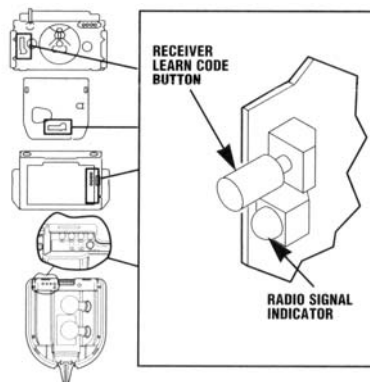

Fig. 1

NOTE: A maximum of 7 Transmitter, Wireless Keypad and other access device Codes can be stored into Receiver Memory at one time. If a Transmitter becomes lost or if you want to delete a Transmitter, Wireless Keypad or other access device, proceed to step 3 ERASING ALL RECEIVER MEMORY.

NOTE: If you are replacing a lost or stolen Transmitter: (1) Erase ALL Transmitter Codes from the Receiver memory. (2) Reprogram the Receiver with the remaining Transmitters.

3 ERASING ALL RECEIVER MEMORY

Step 4-1 Press and HOLD the Learn Code Button for 10 seconds or until Radio Signal Indicator stops flashing and goes out.

All Transmitter Codes are erased from Receiver memory.

Step 4-2 Reprogram the Receiver with the remaining Transmitter Codes (Repeat Steps 2-2 through 2-4).

4 BATTERY INSTALLATION

Step 5-1 Battery replacement (your Transmitter is battery powered).

- * Remove rear battery cap by releasing locking clip.
- * Install new AAA battery with positive forward

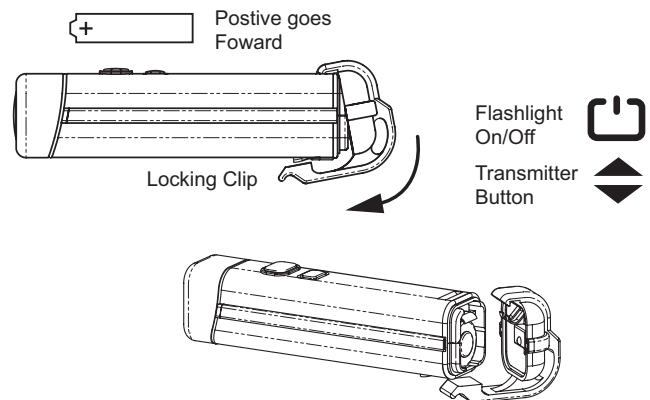

5 TRANSMITTER OPERATION

- * Point Transmitter at the garage door and press the transmitter button. Door will move.
- * Press the Transmitter Button again and the door will stop.
- * Press the Transmitter Button again and the door will move the other way. The door automatically stops at the end of the open or close cycle.

6 FLASHLIGHT OPERATION

- * Simply press the Flashlight on/off Button to turn on and off the flashlight.

FCC and IC CERTIFIED

This device complies with FCC Part 15 and ASS 210 of Industry Canada Operation is subject to the following two conditions: (1) This device may not cause harmful interference, and (2) this device must accept any interference, including interference that may cause undesired operation of the device.

Changes or modifications not expressly approved by the manufacturer could void the user's authority to operate the equipment.

For additional information or help, see Owner's Manual or contact Customer Service:

1-800-35-GENIE

Your Local Distributor: 1-800-OK-Genie

Customer Service

22790 Lake Park Blvd.

Alliance, Ohio 44601-349B

www.geniecompany.com