



MAGNAVOX

3-PIECE CD SHELF SYSTEM

OWNER'S MANUAL

PLEASE READ BEFORE OPERATING THIS EQUIPMENT.

MODEL: MM442M

IMPORTANT SAFETY INSTRUCTION



CAUTION

RISK OF ELECTRIC SHOCK
DO NOT OPEN



CAUTION: TO REDUCE THE RISK OF ELECTRIC SHOCK, DO NOT REMOVE COVER (OR BACK). NO USER-SERVICEABLE PARTS INSIDE. REFER SERVICING TO QUALIFIED SERVICE PERSONNEL.



ATTENTION:

The exclamation point within an equilateral triangle is intended to alert the user to the presence of important operating and maintenance (servicing) instructions in the literature accompanying the appliance.

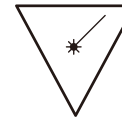

DANGER

Invisible and hazardous laser radiation when open and inter-lock failed or defeated. Avoid direct exposure to beam.

WARNING:

TO REDUCE THE RISK OF FIRE OR ELECTRIC SHOCK, DO NOT EXPOSE THIS PRODUCT TO RAIN OR MOISTURE.

TO REDUCE THE RISK OF FIRE OR ELECTRIC SHOCK, AND ANNOYING INTERFERENCE, USE THE RECOMMENDED ACCESSORIES ONLY.

FCC WARNING:

This equipment may generate or use radio frequency energy. Changes or modifications to this equipment may cause harmful interference unless the modifications are expressly approved in the instruction manual. Modifications not authorized by the manufacturer may void user's authority to operate this device.

This device complies with part 15 of the FCC Rules. Operation is subject to the following two conditions: (1) This device may not cause harmful interference, and (2) this device must accept any interference received, including interference that may cause undesired operation.

Any Changes or modifications not expressly approved by the party responsible for compliance could void the user's authority to operate the equipment.

This equipment complies with FCC radiation exposure limits set forth for an uncontrolled environment. This equipment should be installed and operated with minimum distance 20cm between the radiator & your body.

LASER SAFETY : This unit employs a laser. Only qualified service personnel should attempt to service this device due to possible eye injury.

CAUTION : USE OF CONTROLS, ADJUSTMENTS OR PERFORMANCE PROCEDURE HERENIN MAY RESULT IN HAZARDOUS RADIATION EXPOSURE.

INFORMATION:

This equipment has been tested and found to comply with the limits for a Class B digital device, pursuant to Part 15 of the FCC Rules. These limits are designed to provide reasonable protection against harmful interference in a residential installation. This equipment generates, uses and can radiate radio frequency energy and, if not installed and used in accordance with the instructions, may cause harmful interference to radio communications. However, there is no guarantee that interference will not occur in a particular installation. If this equipment does cause harmful interference to radio or television reception, which can be determined by turning the equipment off and on, the user is encouraged to try to correct the interference by one or more of the following measures:

- Reorient or relocate the receiving antenna.
- Increase the separation between the equipment and receiver.
- Connect the equipment into an outlet on a circuit different from that to which the receiver is connected.
- Consult the dealer or an experienced radio/TV technician for help.

IMPORTANT SAFETY INSTRUCTION

Before using the unit, be sure to read all operating instructions carefully. Please note that these are general precautions and may not pertain to your unit. For example, this unit may not have the capability to be connected to an outdoor antenna.

1) Read these instructions.

All the safety and operating instructions should be read before the product is operated.

2) Keep these instructions.

The safety and operating instructions should be retained for future reference.

3) Heed all warnings.

All warnings on the product and in the operating instructions should be adhered to.

4) Follow all instructions.

All operating and use instructions should be followed.

5) Do not use this apparatus near water.

Do not use this product near water and moisture, for example: near a bathtub, washbowl, kitchen sink or laundry tub; in a wet basement; or near a swimming pool.

6) Do not defeat the safety purpose of the polarized or grounding-type plug.

A polarized plug has two blades with one wider than the other. A grounding type plug has two blades and a third grounding prong. The wide blade or the third prong is provided for your safety. If the provided plug does not fit into your outlet, consult an electrician for replacement of the obsolete outlet.

7) Protect the power cord from being walked on or pinched particularly at plugs, convenience receptacles, and the point where they exit from the apparatus.

8) Unplug this apparatus during lightning storms or when unused for long periods of time.

To protect your product from a lightning storm, or when it is left unattended and unused for long periods of time, unplug it from the wall outlet and disconnect the antenna or cable system. This will prevent damage to the product due to lightning and power-line surges.

9) Refer all servicing to qualified service personnel. Servicing is required when the apparatus has been damaged in any way, such as power-supply cord or plug is damaged, liquid has been spilled or objects have fallen into the apparatus, the apparatus has been exposed to rain or moisture does not operate normally, or has been dropped.

10) Power source

This product should be operated only from the type of power source indicated on the marking label. If you are not sure of the type of power supply to your home, consult your appliance dealer or local power company. For products intended to operate from battery power, or other source, refer to the operation instructions.

11) Overloading

Do not overload wall outlets and extension cords as this can result in a risk of fire or electric shock.

12) Service

Do not attempt to service this product yourself as opening or removing covers may expose you to dangerous voltage or other hazards. Refer all servicing to qualified service personnel.

CARE AND MAINTENANCE

Caring for Compact Discs

- Treat the disc carefully. Handle the disc only by its edges. Never allow your fingers to come in contact with the shiny, unprinted side of the compact disc.
- Do not attach adhesive tape, stickers, etc. to the compact disc label.
- Clean the compact disc periodically with a soft, lint-free, dry cloth. Never use detergents or abrasive cleaners to clean the compact disc. If necessary, use a CD cleaning kit.
- If a compact disc skips or gets stuck on a section of the compact disc, it is probably dirty or damaged (scratched).
- When cleaning the compact disc, wipe in straight lines from the centre of the compact disc to the outer edge of the compact disc. Never wipe in circular motions.

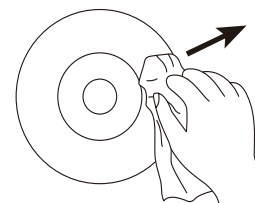
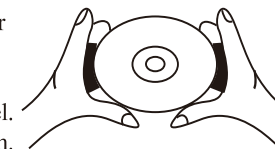

- This unit is designed to play only compact discs bearing the identification logo as shown here. Other discs may not conform to the CD standard and may not play properly.
- Compact Discs should be stored in their cases after each use to avoid damage.
- Do not expose compact discs to direct sunlight, high humidity, high temperatures or dust, etc. Prolonged exposure or extreme temperatures can warp the disc.
- Do not stick or write anything on either side of the disc. Sharp writing instruments, or the ink, may damage the surface.



Cleaning the Unit

- To prevent fire or shock hazard, disconnect your unit from the AC power source when cleaning.
- The finish on your unit may be cleaned with a dust cloth and cared for as other furniture. Use caution when cleaning and wiping the plastic parts.
- Mild soap and a damp cloth may be used on the front panel.

LOCATION OF CONTROLS:

MAIN UNIT:

Top:

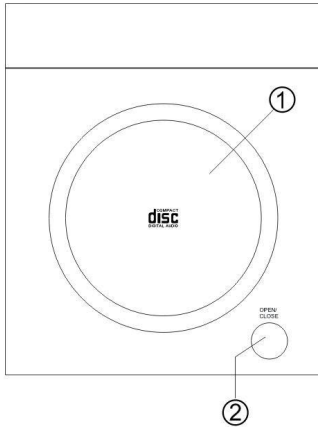

1. CD Door
2. CD Door Open/Close Area

Front:

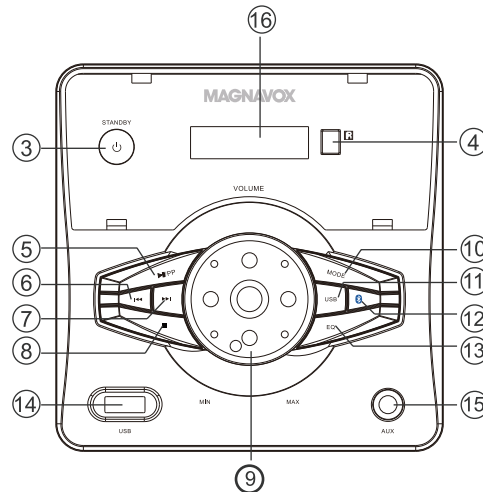

Rear:

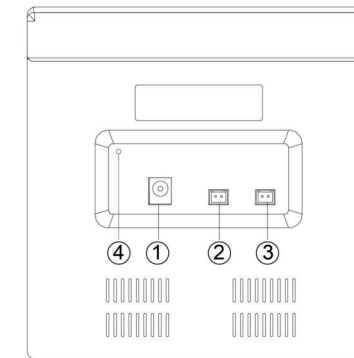

1. DC 9V (In) Jack
2. Speaker out R (Right Channel) Jack
3. Speaker out L (Left Channel) Jack
4. FM Wire Antenna

REMOTE CONTROL:

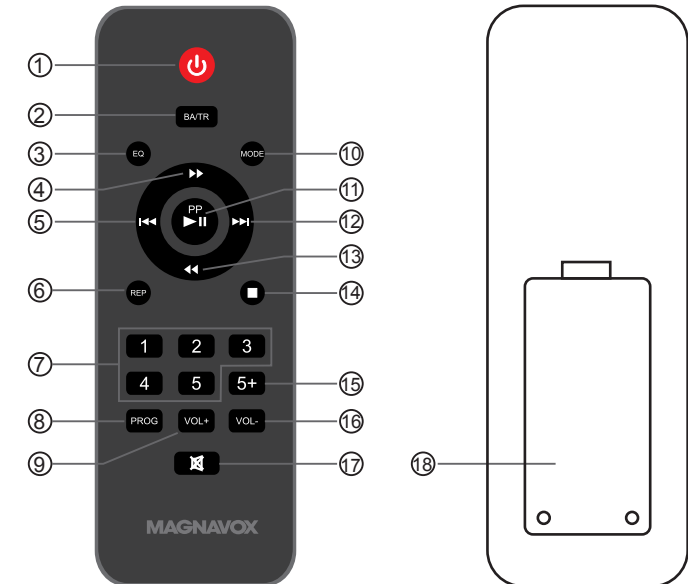

1. (Standby) Button
2. TR/BA (Treble/Bass) Button
3. EQ (Equalizer) Button

4. ►► (Fast forward/Radio tuning up) Button
5. I◄◄ (Previous) Button
6. REP (Repeat) Button
7. Numeric Buttons
8. PROG (Program) Button
9. VOL + (Volume Up) Button
10. MODE Button
11. ►II/PP (Play-Pause/Radio Program Preset) Button
12. ►►I (Next) Button
13. ◄◄ (Fast rewind/Radio tuning down) Button
14. ■ (Stop) Button
15. 5+ Button
16. VOL – (Volume Down) Button
17. [Mute Icon] (Mute) Button
18. Battery compartment cover

CONNECTION:

Connect the Speaker Connection Wires from Speaker Boxes to the SPEAKER OUT Jacks on the rear of unit as illustrated below:

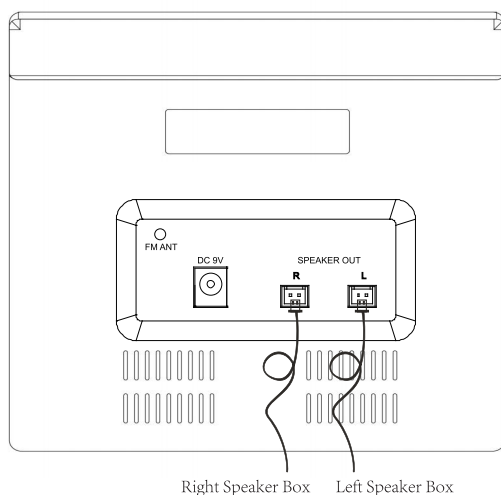

POWER SOURCE:

Main unit:

Connect the small plug from the supplied AC/DC Adaptor to the DC 9V (In) Jack on the rear of unit then plug the AC/DC Adaptor to a AC wall outlet having AC 100-240V~; 50/60Hz as illustrated below:

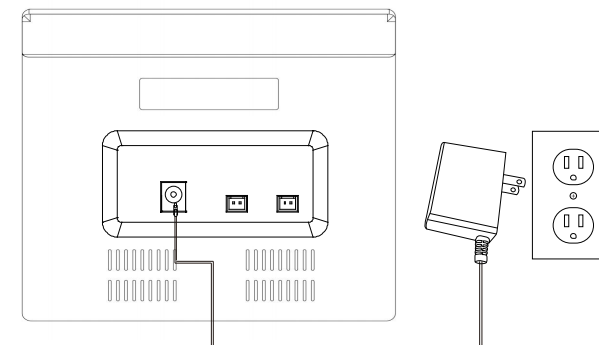

NOTES:

- If you will not use the unit for an extended period of time, unplug the AC/DC Adaptor from wall outlet.
- The AC/DC Adaptor is intended to be correctly orientated in a vertical or floor mount position.

Remote Control:

1. Lay the remote control face-down on a table and hold it down with your hand.



2. Open the battery compartment cover as shown



3. Insert 2 x'AAA' batteries (Not included) into the remote control ensuring correct polarity and replace the battery compartment cover.



Battery precautions:

Follow these Battery Precaution when using a battery in this device:

1. Use only the size and type of battery specified.
2. Be sure to follow the correct polarity when installing the battery as indicated in the battery compartment. A reversed battery may cause damage to the device.
3. Do not mix different types of batteries together (e.g. Alkaline and Carbon-zinc) or old batteries with fresh ones.
4. If the batteries in the device are consumed or the device is not to be used for a long period of time, remove the batteries to prevent damage or injury from possible battery leakage.
5. Do not try to recharge the battery not intended to be recharged; it can overheat and rupture. (Follow battery manufacturer's instructions.)
6. Do not dispose of battery in fire. Battery may explodes or leak.
7. Clean the battery contacts and also those of the device prior to battery installation.

EFFECTIVE DISTANCE OF REMOTE CONTROL

Notes:

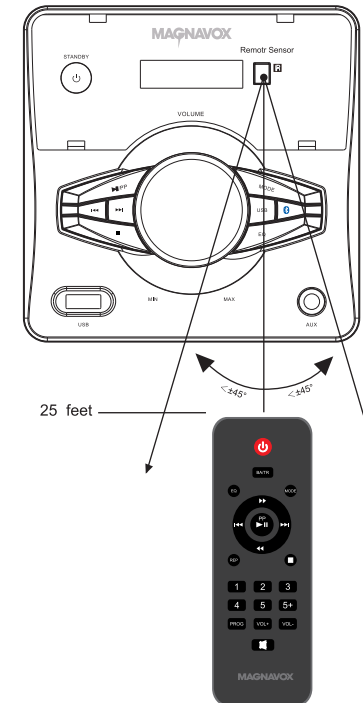

- When there is an obstacle between the unit and the transmitter, the transmitter may not operate.
- When direct sunlight, an incandescent lamp, fluorescent lamp or any other strong shines on the remote control of the unit, the remote operation may be unstable.

OPERATION:

GENERAL OPERATION:

1. Connect the Speaker Boxes to the unit as previously instructed.
2. Connect the unit to AC power as previously instructed. "0" will appear on the LED Display.
3. Press the  (Standby) Button on the unit or Remote Control to power on the

unit from standby mode.

4. Press the MODE Button on the unit or Remote Control repeatedly to switch to desired playback mode (or press the USB,  "Bluetooth" buttons on the unit to the desired playback mode directly). The correspondent indicator will appear (or illuminate) on the display with your selection (see list below):

Playback Mode:	Indicators:
CD	" CD " will appear on the display
USB	" USB " will appear on display & the indicator "USB" will illuminate
AUX (Aux/Line in)	" AUX " will appear on the display
BT (Bluetooth)	" bt " will appear on the display
Radio FM Band	" rAd ! " will appear on the display a few seconds, then radio frequency "XX.X" or "XXX.X" will appear on the display

5. During playback:

- Turn the VOLUME Knob on the unit or press the VOL (Volume) +/- buttons on the Remote Control to adjust volume level as desired.
- Press the  (Mute) Button on the Remote Control to mute the sound, press again to turn the sound back.
- Press the TR/BA Button on the Remote Control to enter Treble/Bass level setting menu, then set the level as below:
 - Press the button once, "b XX" will appear on the display, turn the VOLUME Knob on the unit or press the VOL + or - buttons on the remote control to set the bass level as desired.
 - Press the button once, "t XX" will appear on the display, turn the VOLUME Knob on the unit or press the VOL + or - buttons on the remote control to set the treble level as desired.
- Press the EQ (Equalizer) Button on the unit or Remote Control to activate and set the equalizer effect as desire (see list below):

Showing on display:	Equalizer effects:
OFF	Turn off the equalizer effect
rOC	Rock
JAZZ	Jazz







POP	Pop
CLAS	Classic

6. When finished listening, press the  (Standby) Button on the unit or Remote Control to turn the unit to Standby Mode. "0" will appear on the display.

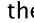
NB: If you will not use the unit for an extended period of time, unplug the AC/DC Adaptor from AC wall outlet.

CD:

CD Playback:

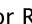
1. Power on the unit as previously instructed.
2. Press the MODE Button on the unit or Remote Control repeatedly until "**CD**" appear on the display.
3. Press the Open/Close area on the top of unit to open the CD door.
4. Place a CD disc on the center spindle, with the printed side face up.
5. Close the CD door, play will automatically start after a few seconds.
6. During playback:
 - Press the /PP Button on the unit or Remote Control to pause, press again to resume normal playback.
 - Press the  or  buttons on the unit or Remote Control repeatedly to skip tracks.
 - Press the  or  buttons on the Remote Control to fast searching the specific section then press the /PP Button to resume normal playback.
7. To stop, press the  (Stop) Button on the unit or Remote Control.

Repeat Playback:

1. During playback, press the REP Button on the Remote Control once. "REP" will appear on the display. The current track will playback repeatedly.
2. During playback, press the REP Button twice. "REP" will appear on the display and start blinking. All the tracks on the current disc will be played back repeatedly.
3. To cancel the repeat function, press the REP Button repeatedly until the repeat indicator "REP" disappears on the display.

Programmed Playback:

Up to 20 tracks can be programmed playback as follows:

1. In CD stop playing mode, press the PROG Button on the Remote Control. "P 01" will appear on the display. Indicator "PROG" will appear on the display and blink.
2. Select the first specific track to be programmed by pressing the ◀◀ or ▶▶ buttons on the unit or Remote Control repeatedly.
3. Press the PROG Button again to store the selected track into the memory.
4. Repeat steps 2 and 3 until all the specific tracks stored into the memory.
5. Press the ▶II/PP Button on the unit or Remote Control to start program playback.
6. To stop playback, press the ■ Button on the unit or Remote Control. Press the ▶II/PP Button to start program playback again.
7. To stop and cancel the program, press the ■ Button on the unit or Remote Control twice. Indicator "PROG" on display will not illuminate.

BT MODE:

BT (Bluetooth) pairing:

First time use or re-pairing the unit to a new BT Device, pair as follows:

1. Power on the unit as previously instructed.
2. Press the MODE Button on the unit or Remote Control repeatedly until indicator "bt" appears on the display and blinks to enter to BT playback mode. (Or press the  Button on the unit to enter to BT playback mode directly).
3. Power on the external BT Device and enter to BT searching mode. Start pairing following the on screen instructions from the external BT Device. After paired, the indicator "bt" on the display will stop blinking.
4. If pairing is complete you may now play music with your external BT Device.
5. During playback:
 - Press the ▶II/PP Button on the unit or Remote Control to pause, press again to resume normal playback.
 - Press the ◀◀ or ▶▶ buttons on the unit or Remote Control repeatedly to skip tracks.

Notes:

- When the external BT Device has searched the unit, our model number "MM442M" will appear on the display of external BT Device.
- If while pairing you are asked for a code please try "0000" or "1234".

Normal operation after pairing:

1. Power on the unit and enter to BT mode as previously instructed. Indicator "bt" will appear on the display and blink.
2. Wait a few seconds until the unit is automatically paired to the external BT Device. The indicator "bt" on the display will stop blinking.
3. After pairing is complete you may now play music with your external BT Device.

FM RADIO:

1. Power on the unit as previously instructed.
2. Press the MODE Button on the unit or Remote Control repeatedly indicator "rAd" appear on the display to enter to Radio FM playback mode. Wait a few seconds, radio frequency "XXX MHz" will appear on the display.
3. To store the available FM stations into the unit (up to 30 stations) at first time use (or relocate the unit in a new location):
 - Press the ▶II/PP Button on the unit or Remote Control. FM frequency on the display will start running.
 - Wait a few minutes, the unit will automatically store all the available (up to 30 stations) FM stations into the memory then playback the first station.
4. Press the ◀◀ or ▶▶ buttons on the unit or Remote Control repeatedly to select and play the desired stored FM station as desired.
5. Or, press and hold the ◀◀ or ▶▶ buttons on the Remote Control until the FM radio frequency on the display start running to automatically search and play the next/previous available FM station.
6. If reception is weak, press and release the ◀◀ or ▶▶ buttons on the Remote Control repeatedly to fine tune.
7. After fine tuned to specific frequency, press PROG button on the remote control or long press ▶II/PP on the unit, This frequency will be added to the last of the channel list.

Antennas:

This unit has a FM wire antenna on the rear of unit, which provides adequate reception in most areas. If reception is weak, unwind and extended to its full length and/or reassemble the other direction/location to improve the reception.

AUX IN (LINE IN) MODE:

Listen from an external Audio Player such as a Cell phone, MP3 Player, Discman ...etc.

1. Connect one end of the Audio Connection Cable (not included) to the AUX Out/Line Out/Phone Jack on the external Audio Player.
2. Connect the other end of the cable to the AUX (Aux/Line In) Jack on the front of unit as illustrated below:

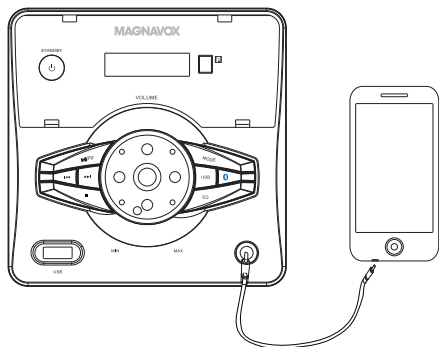

3. Power on the unit as previously instructed.
4. Press the MODE Button on the Remote Control repeatedly until “**FM**” appear on the display.
5. Play the music on the connected Player as usual. (Make sure the volume level of the connected Audio Player is turned to high level.)

USB DEVICE PLAYBACK MODE:

To play the music in USB Device:

1. In standby mode, insert the USB Device into the USB Port on the front of unit as illustrated below:

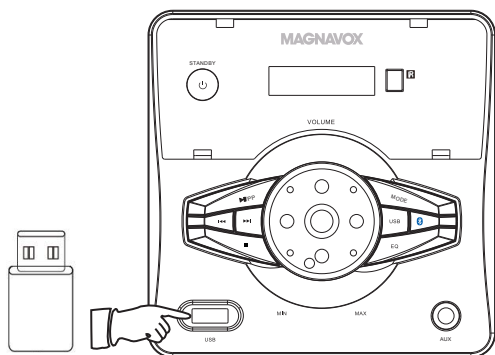

2. Power on the unit as previously instructed.
3. Press the MODE Button on the unit or Remote Control repeatedly until “**USB**” appear on the display to enter to USB playback mode. (Or press the USB Button on the unit to enter to USB playback mode directly).

4. Wait a few seconds, the unit will automatically play the first track on the USB Device.

Note: If no USB Device was inserted into the USB Port. A few seconds later, the unit will turn to CD playback mode automatically.

5. During playback:
 - Press the **▶II/PP** Button on the unit or Remote Control to pause, press again to resume normal playback.
 - Press the **I◀◀** or **▶▶I** buttons repeatedly to skip tracks.
 - Press the **◀◀** or **▶▶** Buttons to search the specific section then press the **▶II/PP** Button to play.
 - Use the Numeric & **5+** buttons on the Remote Control to select and plays the desired tracks. For examples:
 - To play the 4th track on the USB device, press the “4” Button. “0004” will appear on the display then the unit will start to play it.
 - To play the 14th track on the USB device, press the “5+” + “5+” + “4” buttons. “0014” will appear on the display then the unit will start to play it.

Notes:

- Up to 64 GB USB Device the unit supports to play.
- Before replacing USB Device, make sure the unit had been turned to standby mode.
- When inserting the USB Device, make sure the direction you selected is correct. Never insert violently to avoid damaging the USB Device or the unit.
- You also need to download the desired music in MP3 format into the USB Device before insert into the unit.

TROUBLESHOOTING:

Check the following before requesting service:



SYMPTOM	POSSIBLE CAUSE	POSSIBLE SOLUTION
No power	AC/DC Adaptor had not connected	Connected the AC/DC Adaptor to the unit and AC power as page 9

No sound or sound weak	Volume of the unit was set to minimum position	Increase the volume level by turning the VOLUME Knob on the unit clockwise or press the VOL + Button on the Remote Control
	Volume level of paired/connected device is in low level	Rise the volume level of the paired/connected device
Sound distortion	Volume level too high	Reduce the volume level by turning the VOLUME Knob on the unit counterclockwise or press the VOL – Button on the Remote Control
	Volume level of the connected/paired device too high	Reduce the volume level of the connected/paired device
BT not functioning	Unit not in BT mode	Press the MODE Button on the unit or Remote Control repeatedly until indicator “ bt ” appear on the display and blink to enter to BT playback mode. Or press the  (Bluetooth) Button on the unit to enter to BT playback mode directly.
	The external BT Device had NOT paired to the unit	Pair the external BT Device to the unit as page 14

	The external BT device too far from the unit	Place the external BT device close to the unit
CD not play	Unit not in CD mode	Press the MODE Button on the unit or Remote Control repeatedly until “ CD ” appear on the display
	CD disc incorrect install	Place the CD disc on the center spindle with label side face up
	Disc is dirty or scratched	Try other discs
Radio not function	Unit not in radio mode	Press the MODE Button on the Remote Control or unit repeatedly until indicator “ FM ” appear on the display
Radio reception not good	The direction or location no good for radio reception	Unwind and extended the FM wire antenna on the rear of unit to its full length and/or reassemble the other direction/location to improve the reception
USB Device not function	Unit is not in USB mode	Press the MODE Button on the unit or Remote Control repeatedly until “ USB ” appear on the display to enter to USB playback mode. Or press the USB Button on the unit to enter to USB playback mode directly

	No audio files on the USB Device	Download the desired music in MP3 format into the USB Device before insert into the unit
--	----------------------------------	--

GENERAL SPECIFICATTIONS:

Power Source:	DC  9V, 2A, 
Audio Power:	5W per Channel (Total 10W, RMS)
Impedance of Speakers:	6W, 4Ω per channel
FM Band Converge:	87.5 – 108MHz
BT Version:	5.0
BT Operation Distance:	Up to 32 Feet in opera area
Disc Compatible:	CD; CD-R; CD-RW

PACKAGE INCLUDES:

- 1 x User's Manual
- 1 x Remote Control (Uses 2×AAA dry battery, not included)
- 1x AC/DC Adapter

**SPECIFICATIONS AND ACCESSORIES ARE SUBJECT TO CHANGE
WITHOUT NOTICE**

LIMITED WARRANTY

Craig warrants this product to be free from manufacturing defects in material and workmanship under normal use for a period of 180 days from date of purchase. If service is required, please return the product to the store where it was purchased for exchange; or, pack the unit in the original packing material with all accessories if applicable, a copy of your sales receipt and a Cashier's check or Money Order for \$15 (to cover shipping and handling costs) payable to Craig Electronics, LLC. For consumers in Canada, please make sure that the cashier check or money order is redeemable through a U.S. bank. Ship your product freight pre-paid. Your unit will be repaired, replaced or if the unit can not be repaired or replaced, a refund will be forwarded to you within four weeks of receipt of your unit. Please ship your unit to:

Craig Electronics, LLC (If shipping by US postal service)
525 Tribble Gap RD, Box 2069, Cumming, GA 30028

Craig Electronics, LLC (If shipping by Fedex, UPS or other carrier service)
525 Tribble Gap RD, Suite 2069, Cumming, GA 30040-9998

Technical support: 866 321 7191

This warranty is void if the product has been: a) Used in a commercial application or rental. b) Damaged through misuse, negligence, or abuse. c) Modified or repaired by anyone other than an authorized Craig service center. d) Damaged because it is improperly connected to any other equipment.

Note: This warranty does not cover: a) Ordinary adjustments as outlined in the Owner's Manual which can be performed by the customer. b) Damage to equipment not properly connected to the product. c) Any cost incurred in shipping the product for repair. d) Damage to the product not used in the USA.

This warranty is not transferable and only applies to the original purchase. Any implied warranties, including the warranty of merchantability, are limited in duration to the period of this expressed warranty and no warranty whether expressed or implied shall apply to the product thereafter.

Under no circumstance shall Craig be liable for any loss or consequential damage arising out of the use of this product. This warranty gives specific legal rights. However, you may have other rights which may vary from state to state. Some states do not allow limitations on implied warranties or exclusion of consequential damage. Therefore, these restrictions may not apply to you.

This product has been manufactured by and is sold under the responsibility of Craig and Craig is the warrantor in relation to this product. MAGNAVOX and SMART. VERY SMART are registered trademarks of Koninklijke Philips N.V. and are used under license from Koninklijke Philips N.V.

To Obtain Service on your Product
email: magnavox@craigelectronics.com