

# User Manual of BT-010

## 1. Overview

Bluetooth is an open standard of wireless data and voice transmission, which is providing low-cost, short distance for wireless communication, composing personal network for both of the fixed and the mobile equipment communications environment, to achieve resources sharing between all kinds of information equipment in short distance.

BT-010 is a standard headphone with Bluetooth 2.0 + EDR, it supports for Bluetooth Headset and Handsfree Profile; has simplicity and elegant appearance with 2 different colors face plates, you can change the face plates as your wish.

## 2. Attention and maintenance methods

### 2.1 Product maintenance

- The use of non-original accessories may cause performance degradation, personal injury, electrical short-circuit and the warranty failure.
- Decomposition or demolition of your Bluetooth headset may result in damage to headphones, and the warranty failure.
- Do not put headphones in dusty environment.
- Use clean, soft, dry cloth to clean your headphones.
- Put into the original packaging if not use headphones.
- Do not let children play with the headphones, they may harm themselves or your headphones.
- Do not put headphones in over-hot or over-cold environment, otherwise the headset may be temporarily unavailable.

### 2.2 Travel Charger

- Chargers only use the marked input voltage.
- When pull out the charger from the socket, do not pull wires, otherwise it might damage the charger.

### 2.3 Battery maintenance

- For the first time, it needs to charge for the headset at least 4 hours connecting with the charger.
- Rechargeable battery lifetime will be very long if use carefully.
- The temperature of the rechargeable battery is between 10 °C and 45 °C.
- When not to use headphones long time, please charge it at least once per 2 months.

## 3. Sketch of products

### 3.1 Structure Statement

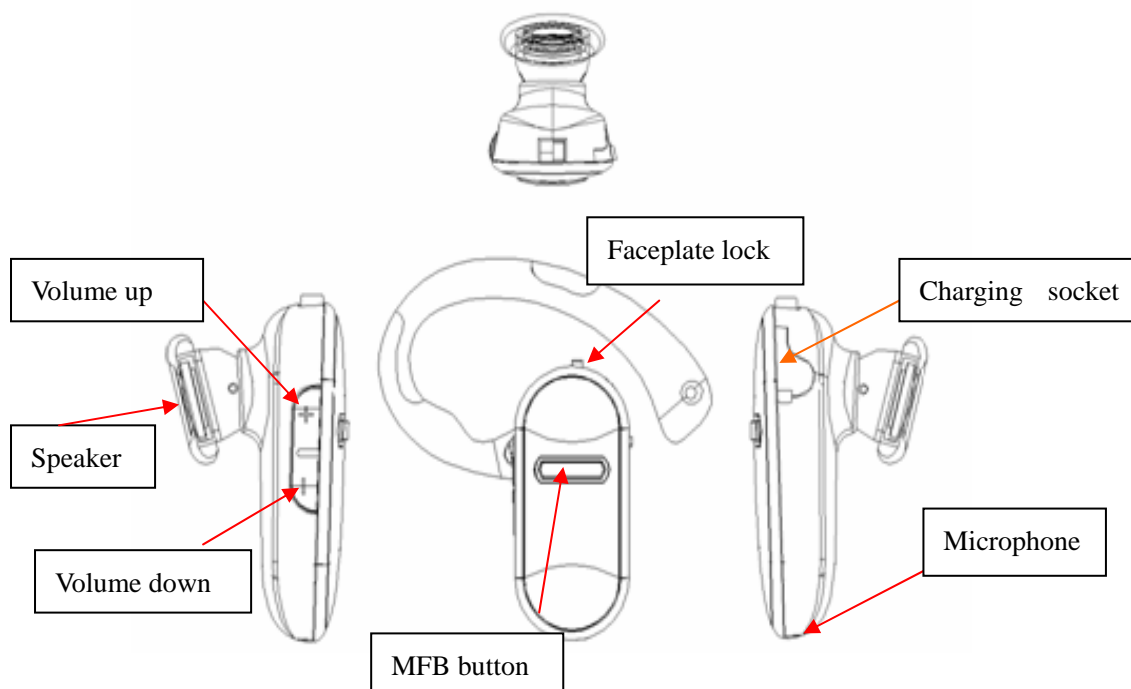

### 3.2 Description in working statement

Working status	Description of indicators
Pairing	Red & blue lights flash alternately
Online	Flash once every 6 seconds
Disconnect	Flash once every 3 seconds

▲ Note: After disconnecting, the Bluetooth headset will be closed automatically after 60 seconds.

### 3.3 How to wear the BT-010

BT-010 is equipped an ear-hook of ergonomic principles, it makes comfortable and convenient, only to rotate the direction of the headset to wear on the right or left ear.

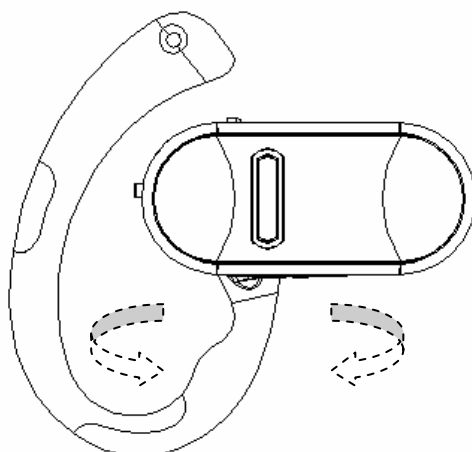

## 4, Product operation guide

### 4.1 Charge the battery:

When using the BT-010 for the first time, you must charge for more than 3 hours continuously, until the red light is off, in charging process, do not use other functions.

When using BT-010 again, you could charge it about 3 hours.

Please insert the charger into the BT-010's socket, in charging process, the light is red, after finished charging, the indicator light will turn off, the battery is full.

#### ▲ Note:

A. When the Bluetooth headset in standby status, the red light flashes as it means the BT-010 need to be charged;

B. If having not used BT-010 for a long time, the headset battery may be "power off" completely, you need to charge more than 3 hours, until the battery is restored to normal working levels, because you could continue to use the BT-010 only when the power is sufficient.

▲ Note: Please do not charge the BT-010 more than 24 hours, and do not use it when charging the Bluetooth headset.

### 4.2 Power on / Power off

A. Press MFB key for 3 seconds, the blue light starts flashing, the Bluetooth headset is power on.

B. Press MFB key for 3 seconds, the red light is off after flashing twice rapidly, the Bluetooth headset is power off.

### 4.3 Pairing

When using the Bluetooth headset for the first time, you have to pair it with Bluetooth devices.

A. Under the power off statement, long press the MFB key for 5 seconds, the red and blue lights flash alternately, Bluetooth will be in pairing state then.

B. Make sure your phone has Bluetooth function and turn on the Bluetooth search equipment (different mobile phone with different operation, see the phone's user manual).

C. Select and pair when "BT-010" words shows on the mobile phone.

D. Input ID code "0000" and press the confirmation button. The indicator changes from red / blue lights flashing to the blue light flashing, that shows pairing successfully.

F. Then the Bluetooth headset is into standby mode, you can use the Bluetooth headset to have a call.

▲ Note: When pairing the Bluetooth headset, best in 10 meters distance between the headset and the mobile phone.

### 4.4 Receiving an incoming call

A. When there is a call, you will hear the music from the headphones, only need to press MFB key to receive the call.

B. If the phone is set with automatic receiving, the headset will receive the call automatically.

#### 4.5 Rejecting an incoming call

When there is a call that you do not want to receive, long press the MFB key for 2 seconds to hear the "du" sound and immediately release, the call is rejected.

#### 4.6 End the call

A. After finishing the call, press MFB key once to end the call.

B. Also can end the call automatically after the other side's hang up.

#### 4.7 Redialing the last number

Under the standby mode, press MFB key twice, when hearing "du" sound you can redial the last number. (pressing times depends on cell phone)

#### 4.8 Mute

In the call, long press the volume down key for 3 seconds, hear the headphones "Du - Lu -" sound, the other side can not hear our telephone, in the mute, you will hear the intermittent "du du" sound. And then press the volume down key for 3 seconds once more to release the mute.

#### 4.9 Transferring the call

When the call is in headphones, if need to be transferred to the phone-call, press the volume up key for 2 seconds, to hear "du" sound, the call is transferred to the phone; press the volume up key for 2 seconds once more, the call is transferred to the headphones.

#### 4.10 Voice dialing

C. If your phone supports voice dialing, you can use voice dialing through the headset.

D. When the headphones in the standby mode or on-line mode, press MFB key once, follow the phone instructions to make the voice dialing.

#### 4.11 Tri-party call

When calling with A, while B is coming, if need to reserve the A, press the call key, will hear the "du" sound, that makes the telephone kept, the headset automatically receive the phone B; then press the call key once more, make B telephone kept, and call with A.

▲Note: To realize this function, make sure that you have opened the telecommunications business.

## 5. Specifications

Bluetooth frequency	2402-2480MHz ISM Band
Bluetooth specification	V2.0+EDR
Modulation	GSK
RF power	-6~+4dBm (class2)
Audio resolution	15bits
Receiver sensitivity	>-75db
Support model	Bluetooth headset / Bluetooth

	hands-free
Reception range	$\leq 10$ meters without obstacle
Pairing code	0000
Voltage	DC 3.7V
Current when call	$\leq 20\text{mA}$
Current when standby	About 19uA
Speaker impedance	32 OHM
Battery Types	Rechargeable lithium polymer batteries
Battery capacity	55mAh
The battery voltage	DC $5.0 \pm 0.25\text{V}$ / 300Ma~600mA
Talking time	3hours
Standby time	70 hours
Charging time	2-3 hours
Charging voltage	$5\text{V} \pm 0.2\text{V}$
Charge current	$\leq 30\text{mA}$
Size	40mm*20mm*11.6mm
Operating temperature	$-10^{\circ}\text{C} \sim +45^{\circ}\text{C}$
Storage temperature	$-10^{\circ}\text{C} \sim +45^{\circ}\text{C}$

## 6. Common questions

6.1 Why cannot search my Bluetooth headset in pairing to the cell phone?

-- If the Bluetooth headset is not in pairing statement, it cannot be searched then. Please make headphones in the pairing statement.

6.2 If need to pair it every time to use Bluetooth headset?

-- No, only in the first time, Bluetooth headsets and cell phones need to pair, they do not need to pair again even they are closed.

6.3 Why there is noise in the headphones?

Call quality will be effected by the following two points

-- If your cell phone signal is weak, will cause call poor

-- Cell phones and headsets not within the standard distance will increase noise

6.4 Why the headphones can not work suddenly?

-- It may due to the power shortage of headset battery. The red light will flash when the power is not enough.

6.5 Why cannot use voice dialing?

-- Before using voice dialing, you must use your headphones to write down voice dialing instructions.

**FCC statement**

This equipment has been tested and found to comply with the limits for a Class B digital device, pursuant to Part 15 of the FCC Rules. These limits are designed to provide reasonable protection against harmful interference in a residential installation. This equipment generates, uses and can radiate radio frequency energy and if not installed and used in accordance with the instructions, may cause harmful interference to radio communications. However, there is no guarantee that interference will not occur in a particular installation. If this equipment does cause harmful interference to radio or television reception, which can be determined by turning the equipment off

and on. The user is encouraged to try to correct the interference by one of the following measures:

Reorient or relocate the receiving antenna.

Increase the separation between the equipment and receiver. Connect the equipment into an outlet on a circuit different from that to which the receiver is connected.

Consult the dealer or an experienced radio/TV technician for help.

To assure continued compliance, any changes or modifications not expressly approved by the party responsible for compliance could void the user's authority to operate this equipment. (Example- use only shielded interface cables when connecting to computer or peripheral devices).

**FCC Radiation Exposure Statement**

This equipment complies with Part 15 of the FCC Rules. Operation is subject to the following two conditions:

- (1) This device may not cause harmful interference, and
- (2) This device must accept any interference received, including interference that may cause undesired operation.

This device complies with FCC RF radiation exposure limits.