



Wireless Racing Wheel Overdrive for Xbox Series X|S, Xbox One

Instruction Manual

Mode d'emploi

Manual de instrucciones

Bedienungsanleitung

Manuale di Istruzioni

Handleiding

Manual de instruções

CZ Návod k obsluze ▶

PL Instrukcja obsługi ▶



<https://hori.co.uk/mbs-016U/manual/>

EN

FR

ES

DE

IT

NL

PT

2119-41

(表紙) p.1

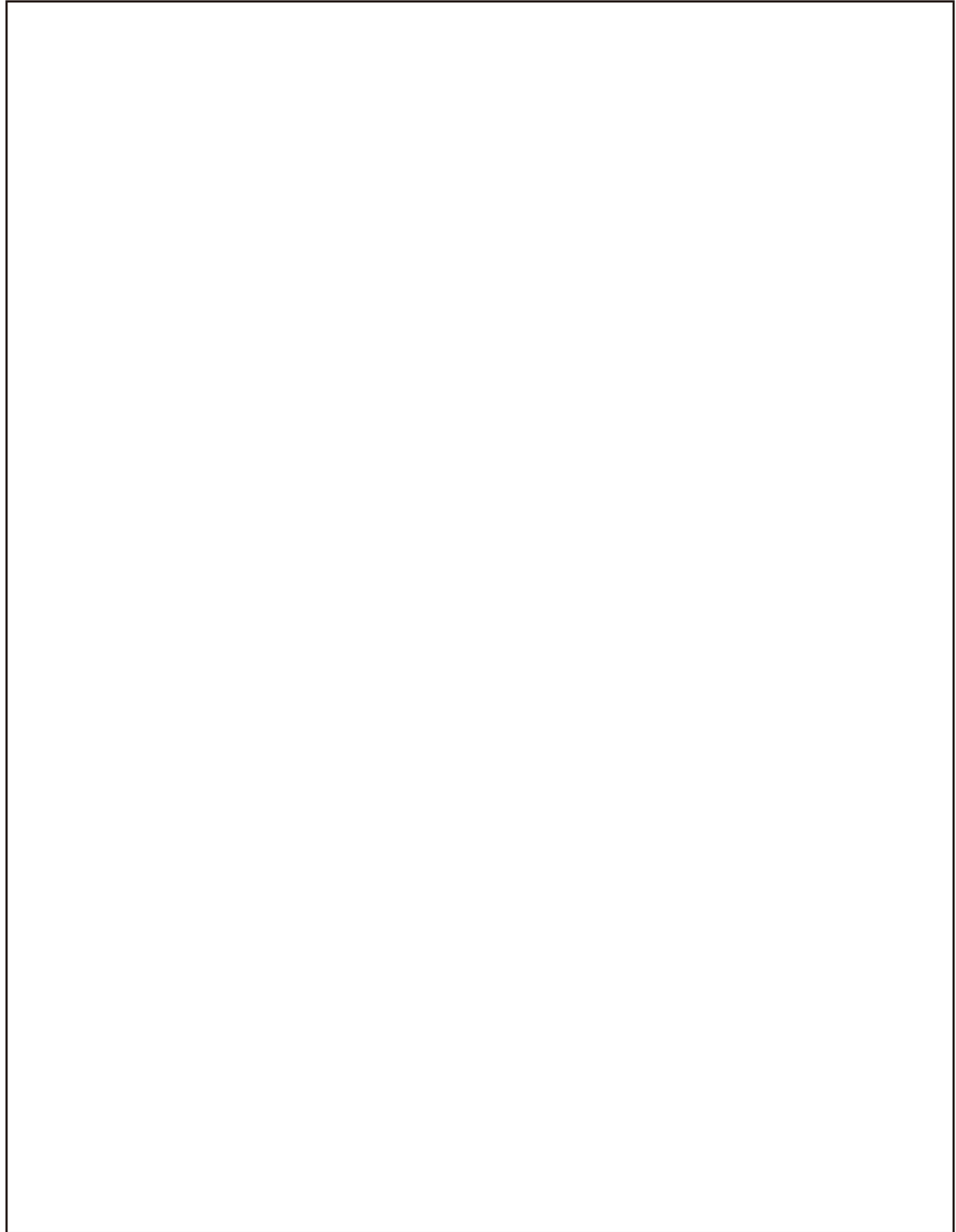

(White page)p.2

EN

Wireless Racing Wheel Overdrive
for Xbox Series X|S, Xbox One

Instruction Manual

Thank you for purchasing this product.
Before using this product, please read the instructions carefully.
After reading the instruction manual, please keep it for reference.

Table of Contents

Quick Start Guide	2-4	How to Charge	10
Caution	4	App [HORI Device Manager for Xbox Series X Series S]	11
Contents	5	▸ Download App	
Compatibility	5	▸ About Profile Settings	
Layout and Features	6	Troubleshooting	11
How to Set Up	7-8	Regarding Wireless Interference	12
▸ Steering Unit		Regarding Battery	12
▸ Foot Pedal		Main Features	12
How to Connect	9-10		



◀ Compatible Software

<https://stores.horiusa.com/mbs-016U/compatibility/>

EN

FR

ES

DE

IT

NL

PT

Quick Start Guide



Before using this product, please read the instructions carefully.

- Please check that your console is updated to the latest system software.
- Please charge this product. ⇒ p.10

1

Mount the steering unit and foot pedal onto a flat, stable surface.

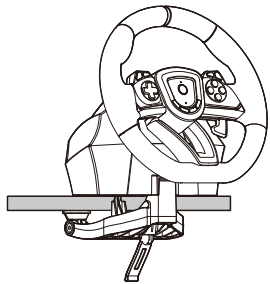

Steering Unit
⇒ p.7-8

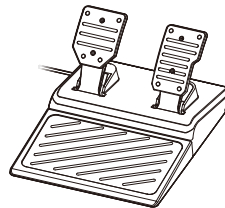

Foot Pedal
⇒ p.8

2

Connect all of the cables accordingly.

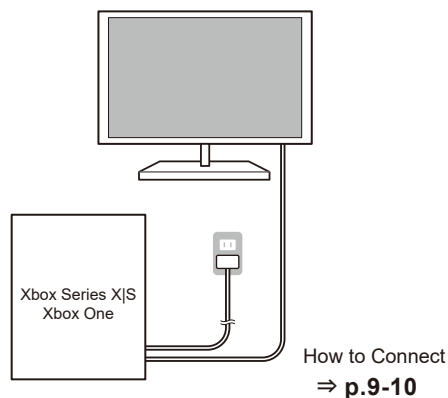
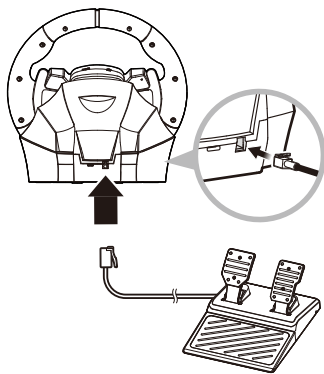

How to Connect
⇒ p.9-10

3 Set the Mode Toggle Switch

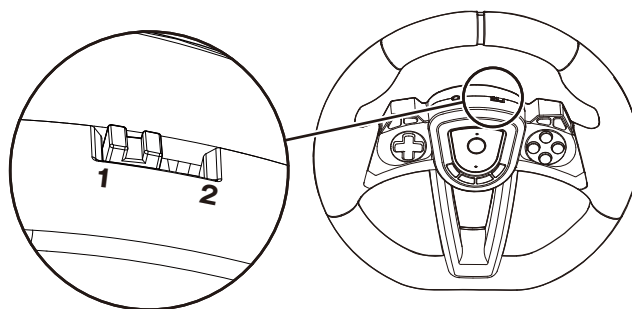

4 To pair, press the buttons in the following order

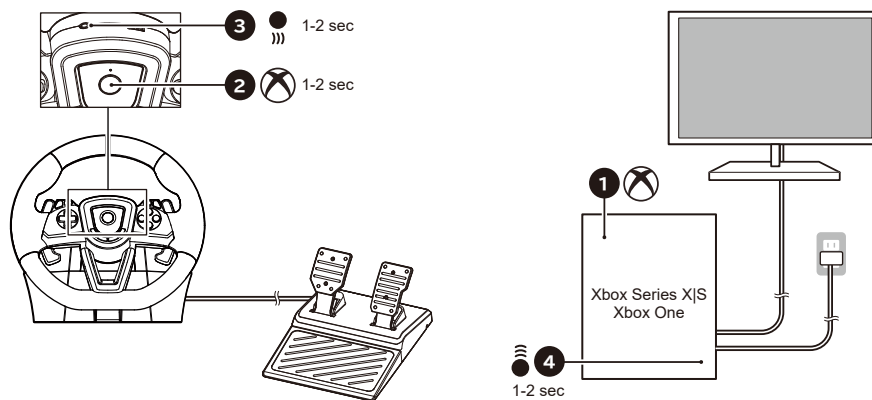

How to pair
⇒ p.10

- 5** Turn the steering wheel fully to the right, then fully to the left. Press down fully on the L pedal and R pedal one at a time. This ensures proper wheel calibration.

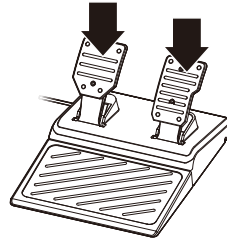
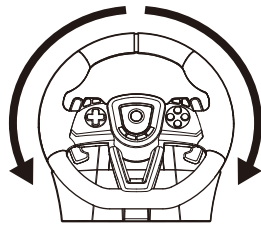

Caution

Parents / Guardians:
Please read the following information carefully.

- Indoor use only.
- This product contains small parts. Keep away from children under 3 years old.
- Keep this product away from small children or infants. Seek medical attention immediately if any small parts are swallowed.
- Long cord. Strangulation hazard.
- Keep the product away from dusty or humid areas.
- Do not use this product if it has been damaged or modified.
- Do not get this product wet. This may cause an electric shock or malfunction.
- Do not place this product near heat sources or leave under direct sunlight for an extended period. Overheating may cause malfunction.
- Please use this product where the room temperature is 0-40°C (32-104°F).
- Do not use this product with a USB hub or extension cable. The product may not function properly.
- Do not touch the metal parts of the USB plug.
- Do not apply strong impact or weight on the product.
- Do not pull roughly or bend the cable of the product.
- Do not disassemble, modify or attempt to repair this product.
- If product needs cleaning, use only a soft dry cloth. Do not use any chemical agents like benzene or thinner.
- The wires are not to be inserted into socket-outlets.
- The packaging must be retained since it contains important information.
- Please retain this instruction manual for your future reference.
- The normal function of the product may be disturbed by strong electro-magnetic interference. If so, simply reset the product to resume normal operation by following the instruction manual (How to Connect). In case the function does not resume, please relocate to an area which does not have electro-magnetic interference to use the product.
- Do not use this product for anything other than its intended purpose. We are not responsible for any accidents or damages in the event of use other than the intended purpose.
- Keep your fingers away from the foot pedals during gameplay.

Contents

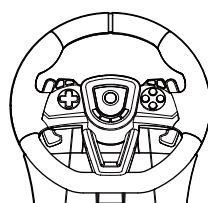

Steering Unit × 1

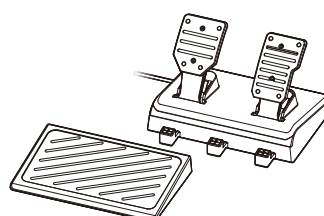

Foot Pedal × 1

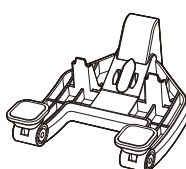

Clamp × 1



Screw × 1

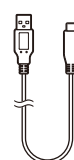

USB Cable
(USB-A to USB-C™) × 1

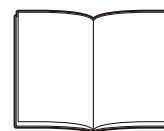

Instruction Manual × 1

Compatibility

Xbox Series X|S / Xbox One

Important

Before using this product, please read the instruction manuals for the software and console hardware to be involved its use.

Please check that your console is updated to the latest system software.

*An internet connection is required to update the Xbox Series X|S / Xbox One to the latest system software.

PC (XInput)

Supported OS	Windows® 11 / 10
Input Method	XInput
System Requirements	USB-A Port

*Functions as PC controller through XInput. This product does not support DirectInput.

Layout and Features

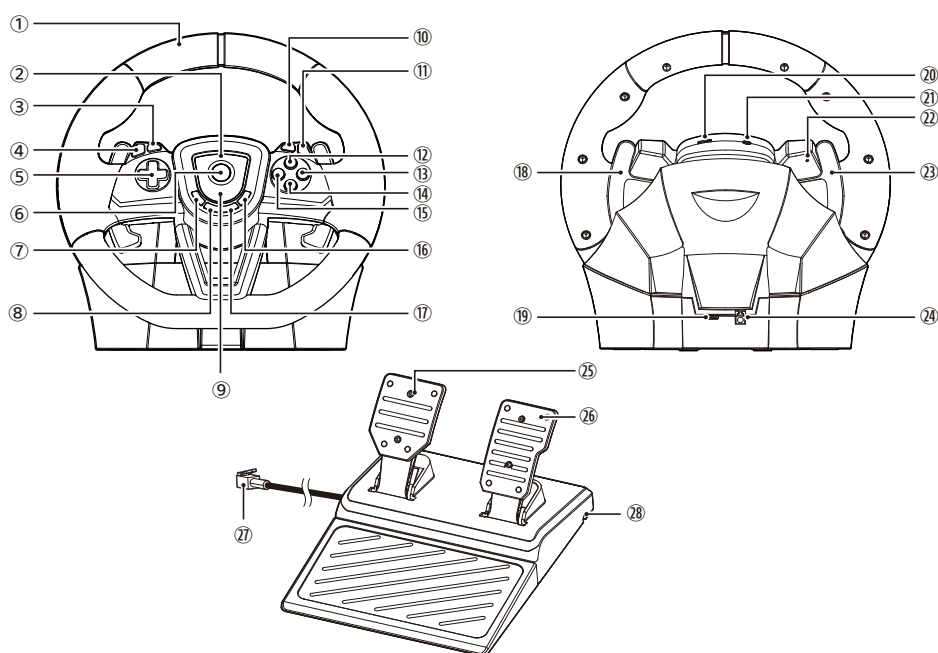

Steering Unit

① ... Steering Wheel	
[Mode 1] Steering	[Mode 2] L Stick X Axis
② ... Status LED	
③ ... [Mode 1] Clutch pedal	[Mode 2] Left stick Button
④ ... [Mode 1] Brake	[Mode 2] Left trigger
⑤ ... Directional pad	
⑥ ... Xbox Button	
⑦ ... View Button	
⑧ ... Profile Button	
⑨ ... Profile LED	
⑩ ... [Mode 1] Handbrake	[Mode 2] Right stick Button
⑪ ... [Mode 1] Accelerator	[Mode 2] Right trigger
⑫ ... Y Button	
⑬ ... B Button	
⑭ ... A Button	
⑮ ... X Button	
⑯ ... Menu Button	
⑰ ... SHARE Button	

Steering Unit (Back View)

⑱ ... [Mode 1] R Paddle	[Mode 2] Right bumper
⑲ ... USB-C™ port	
⑳ ... Mode Toggle Switch	
㉑ ... Pair Button	
㉒ ... Reset Button	
㉓ ... [Mode 1] L Paddle	[Mode 2] Left bumper
㉔ ... Foot Pedal Connection	

Foot Pedal

㉕ ... [Mode 1] Brake	[Mode 2] Left trigger
㉖ ... [Mode 1] Throttle	[Mode 2] Right trigger
㉗ ... Modular Plug	
㉘ ... Cable Groove	

Slide the foot pedal cable through any of the three grooves on the bottom of the foot pedals.

Bottom of Foot Pedal

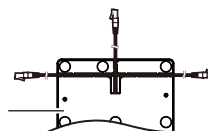

How to Set Up

Steering Unit

**Flat, hard surface required
(i.e., table)**

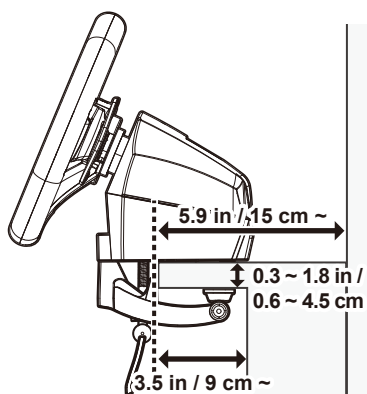

Please read before setup

- ⚠ Tighten the clamp into the steering unit base with the screw.
- ⚠ Carefully detach from furniture to prevent damage to furniture or product.
- ⊘ Do not attach to any unstable surface as shown in the diagram below.

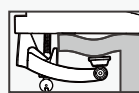

Uneven

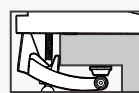

Too thick

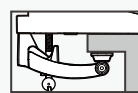

Shallow clamp grip

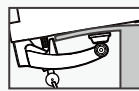

Thin or soft

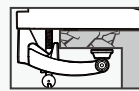

Fragile (i.e., glass)

1

Put the screw through the clamp.

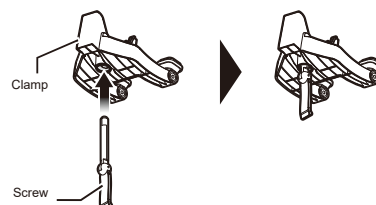

2

Put **1** through the hole on the bottom of the steering unit. Rotate the screw clockwise to secure temporarily.

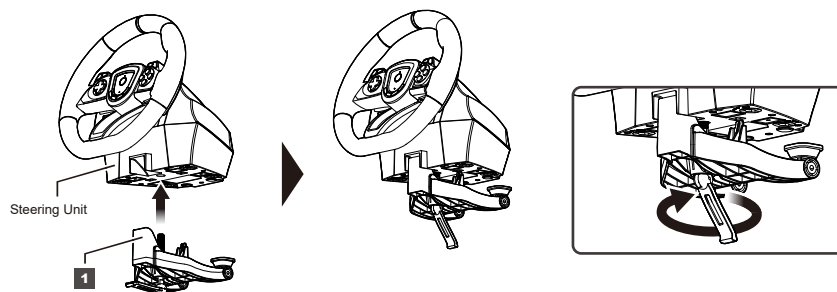

3

Place the base of the steering unit securely on the mounting surface, ensuring the clamp is in place.

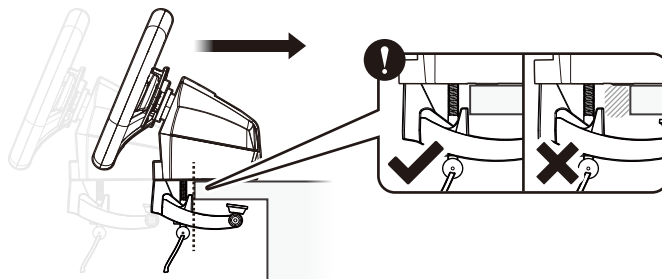
**4**

Rotate the screw clockwise while supporting the steering unit and firmly secure.



■ Foot Pedal

Assemble the foot pedal as shown in the image below.

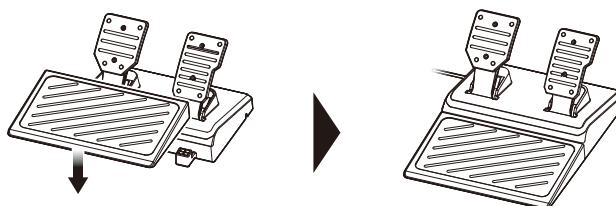

Cable Groove

Slide the foot pedal cable through any of the three grooves on the bottom of the foot pedal.

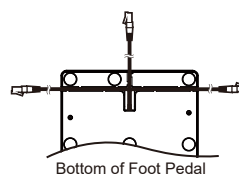

Bottom of Foot Pedal

How to Connect

1

Connect as shown in the image below:
*Please charge this product. ⇒ p.10

**Xbox Series X|S
Xbox One**

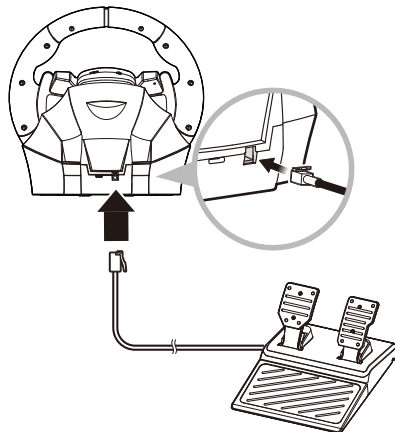

*If using a wired connection, use the included cable to connect the steering wheel to the Xbox Series X|S / Xbox One

PC

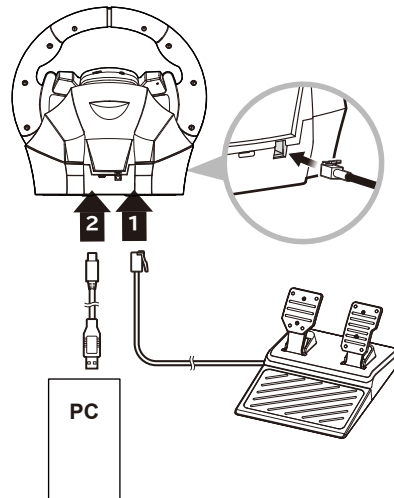

Please follow the instructions below to avoid malfunction.

- Do not use this product with a USB hub and extension cable.
- Do not push any buttons or move the steering unit or pedals when doing the following:
 - When connecting the product to the Xbox Series X|S / Xbox One / PC
 - When turning on the Xbox Series X|S / Xbox One / PC
 - When waking the console from sleep mode

2

Set the toggle switch to the appropriate setting.

■ Mode 1



..... If connecting to the Xbox Series X|S / Xbox One toggle the switch as shown. Response of steering wheel and pedals are more realistic in Mode 1. Some software titles do not support Mode 1.

■ Mode 2



..... If "Mode 1" does not function correctly for Xbox Series X|S / Xbox One or when connecting to a PC, please set to Mode 2.

3

Turn ON the Xbox console and press and hold the Xbox button on the wheel for 1-2 seconds. The LED will slowly flash white when the device is turned on.

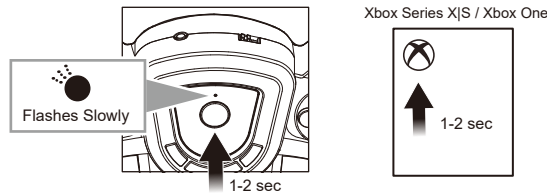
**4**

Press and hold the pairing button on the Xbox console for 1-2 seconds. The Xbox button will flash on the console. When the light stays on, the pairing is complete.

- Follow the above instructions again to connect to a different Xbox Series X|S / Xbox One.
- If a USB cable is connected to charge the battery, this product will be temporarily disconnected and will switch from a wireless to wired device.

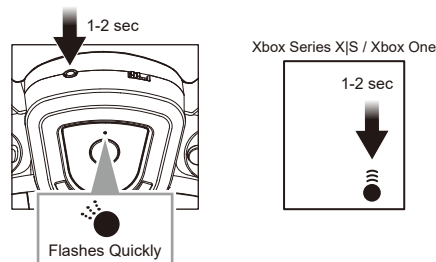
**5**

Turn the steering wheel fully to the right, then fully to the left. Press down fully on the L pedal and R pedal one at a time. This ensures proper wheel calibration.

Please perform this before each of the following actions:

- After connecting the product to the Xbox Series X|S / Xbox One / PC
- After turning on the Xbox Series X|S / Xbox One / PC
- After deactivating the sleep mode

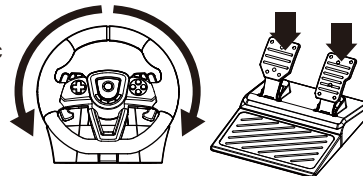

How to Charge

You can charge this product with the included USB cable by connecting to the USB port of the Xbox Series X|S or other device. The charging status can be checked with the profile LED.

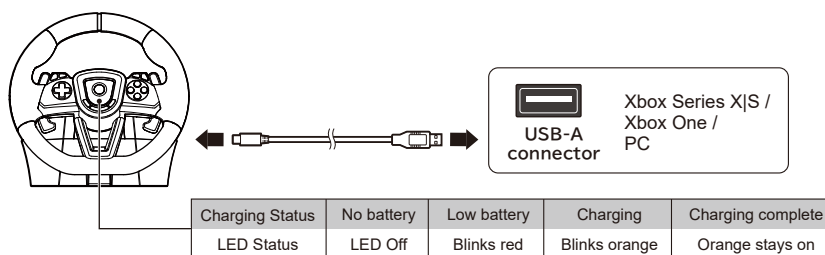

App [HORI Device Manager for Xbox Series X Series S]

Customize the racing wheel sensitivity, dead zone and other settings using the companion app. (PC required)

Profile, Button Mapping, Steering Radius Adjustment, Deadzone Adjustment, Steering Wheel Linearity, Pedal Linearity, D-Pad / Analog Stick Toggle Switch

■ Download App

- ① Search for "HORI" on the Microsoft Store.
- ② Install the "HORI Device Manager for Xbox Series X Series S" App.

Supported OS	Windows® 11 / 10
System Requirements	USB-A Port, Internet Connection

■ About Profile Settings

After setting up profiles in the app, they can be used by pushing the Profile Button on the Steering Unit. Each time it is pushed, it will cycle through profile 1-4.

The profile LED lights will light up as shown below during gameplay.

Profile Set	1	2	3	4
Profile LED	Green	Red	Blue	White

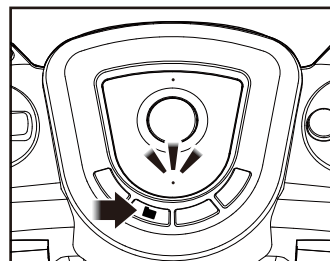

Troubleshooting

1. The product is not working

If the product does not respond when the buttons are pressed, it may be caused due to the low battery. Please fully charge the battery and try to connect the device. See "How to Connect" ⇒ **p.9-10**

2. The product is unable to charge, does not respond even when fully charged, or responds on its own without inputting.

Please try the following steps

1. Press the reset button on the back of the product with a thin stick or similar object (e.g. Paper clip). Do not use a sharp pointed needle. Doing so may scratch or damage the product.

2. Reconnect ⇒ **p.9-10**

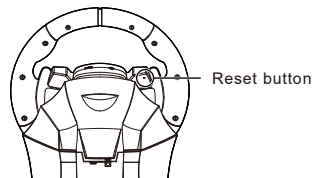

Regarding Wireless Interference

Please do not use this product where wireless devices are prohibited or near electrical devices such as cardiac pacemakers, medical devices, fire alarms or other emergency equipment. Wireless signals may interfere with such devices and cause accidents.

Regarding Battery

If the battery leaks, please do not touch the liquid or battery with your bare hands. Do not place this product near heat sources or leave in direct sunlight. Internal battery life may deplete over time.

- Please be aware of the following during use and storage.
 - Do not place the product in or near fire.
 - Keep this product away from the following high temperature areas:
 - Near heaters, heat sources, or in direct sunlight
 - Heated carpets or on top of home theater equipment
 - Avoid using outdoors or inside a car during hot weather.
- Do not charge this product other than by its specified method. The built-in battery may overheat or rupture which may cause a fire or malfunction.
- Do not charge this product during a thunderstorm, as there may be risk of electric shock.
- Keep USB connector away from metal objects. This may cause malfunction or electric shock.
- Never disassemble, repair or modify this product. There is risk of fire, electric shock, battery rupture, or overheating.
- Do not drop, step on, crush, or strike the product with strong force. This may cause fire, battery rupture, overheating, or electric shock.
- Do not let liquid or foreign matter to enter the product. It may cause fire, electric shock, or malfunction. If any liquid or foreign matter gets inside the product, stop using the product immediately and contact our customer support.
- Keep the product away from water and do not use with wet or oily hands. It may cause electric shock or malfunction.
- Keep the product away from humid, dusty, or smoky areas. It may cause electric shock or malfunction.
- Keep the USB connector away from foreign matter or dust. It may cause electric shock, malfunction, or contact failure. Use a dry cloth to wipe off any foreign matter or dust.
- Charge this product where the room temperature is 10 - 35°C (50 - 95°F). Charging outside this temperature range may result in the product not charging properly or prolong the charging time.
- Please note that as with any rechargeable battery, the maximum amount of charge the battery can hold will gradually lessen over time after many charge cycles.
- Recharge the battery at least once every three months to maintain function even if it has not been used for a prolonged time.



The Lithium Ion battery is a recyclable resource.

Main Features

Steering Unit

External Dimensions : W 11 × D 10.8 × H 11.3 in /
W 28 × D 27.5 × H 28.6 cm

Steering Diameter : 11 in / 28 cm

Degrees of Rotation : 270°

Weight : 3 lbs / 1.4 kg

Battery Life : Up to 20 hours

*The usage time may be significantly shortened depending on the usage environment.

Charging Time : 4 hours

Connection method : Wi-Fi / USB cable

Frequency : 5.15 GHz - 5.85 GHz

Foot Pedals

External Dimensions : W 8.9 × D 11.8 × H 5.9 in /
W 22.5 × D 30 × H 15 cm

Weight : 1.8 lbs / 0.8 kg

Cable Length : 5 ft / 1.5 m

USB Cable

Cable Length : 6.6 ft / 2 m

Connection Type : USB-A to USB-C™

CAUTION:

Any changes or modifications not expressly approved by the party responsible for compliance could void the user's authority to operate the equipment.

THE FCC WANTS YOU TO KNOW

This device complies with part 15 of the FCC Rules. Operation is subject to the following two conditions:

(1) This device may not cause harmful interference, and (2) this device must accept any interference received, including interference that may cause undesired operation.

NOTE:

This equipment has been tested and found to comply with the limits for a Class B digital device, pursuant to part 15 of the FCC Rules. These limits are designed to provide reasonable protection against harmful interference in a residential installation. This equipment generates, uses and can radiate radio frequency energy and, if not installed and used in accordance with the instructions, may cause harmful interference to radio communications. However, there is no guarantee that interference will not occur in a particular installation. If this equipment does cause harmful interference to radio or television reception, which can be determined by turning the equipment off and on, the user is encouraged to try to correct the interference by one or more of the following measures:

- Reorient or relocate the receiving antenna.
- Increase the separation between the equipment and receiver.
- Connect the equipment into an outlet on a circuit different from that to which the receiver is connected.
- Consult the dealer or an experienced radio/TV technician for help.

RF exposure compliance

- 1) This equipment complies with FCC radiation exposure limits set forth for an uncontrolled environment.
- 2) This transmitter must not be co-located or operating in conjunction with any other antenna or transmitter.

IC statement:

This device complies with Industry Canada Licence-exempt RSSs. Operation is subject to the following two conditions:

- (1) this device may not cause harmful interference, and
- (2) this device must accept any interference, including interference that may cause undesired operation of the device.

This equipment complies with Industry Canada radiation exposure limits set forth for an uncontrolled environment.

CAN ICES-003(B) / NMB-003(B)

This Class B digital apparatus complies with Canadian ICES-003.

Cet appareil numérique de la classe B est conforme à la norme NMB-003 du Canada.

Simplified Declaration of Conformity

Hereby, HORI declares that this product is in compliance with Directive 2014/53/EU.

The full text of the EU declaration of conformity is available at the following internet address:

<https://hori.co.uk/consumer-information/>



For UK:

Hereby, HORI declares that this product is in compliance with the relevant statutory requirements.

The full text of the declaration of conformity is available at the following internet address:

<https://hori.co.uk/consumer-information/>



PRODUCT DISPOSAL INFORMATION

Where you see this symbol on any of our electrical products or packaging, it indicates that the relevant electrical product or battery should not be disposed of as general household waste in Europe. To ensure the correct waste treatment of the product and battery, please dispose of them in accordance with any applicable local laws or requirements for disposal of electrical equipment or batteries. In so doing, you will help to conserve natural resources and improve standards of environmental protection in treatment and disposal of electrical waste.



EN

FR

ES

DE

IT

NL

PT

HORI warrants to the original purchaser that our product purchased new in its original packaging shall be free of any defects in both material and workmanship for a period of one year from the original date of purchase. If the warranty claim cannot be processed through the original retailer, please contact HORI customer support.

For customer support in North America and Latin America, please use our customer support form:
<https://stores.horiusa.com/contact-us/>



For customer support in Europe, please email info@horiuk.com

Warranty Information:
For North America, LATAM, Australia : <https://stores.horiusa.com/policies/>



For Europe & Middle East : <https://hori.co.uk/policies/>



Actual product may differ from image.
The manufacturer reserves the right to change the product design or specifications without notice.
Microsoft, Xbox, Xbox "Sphere" Design, Xbox Series X|S, Xbox One are trademarks of the Microsoft group of companies.
USB-C is a registered trademark of USB Implementers Forum.
HORI & HORI logo are registered trademarks of HORI.
All other trademarks are the property of their respective owners.