



BH5300

Bluetooth Headset & Car Kit

User Manual

Instruction	1
1.1 What is Bluetooth	1
1.2 BH5300	1
Overview	2-4
Getting start	4-6
2.1 Charge the battery of headset	4-5
2.2 Wear the headset	5-6
How to use	6-8
3.1 Switch on/off the headset	6
3.2 Pair the headset with Bluetooth device	6
3.3 Making call with the headset	6-7
3.4 Making call with the car kit	7
3.5 LED indication	8
Maintenance and care	8

Congratulation on you purchase of BH5300 featuring Bluetooth technology for conversation wirelessly. Before using it, please read the user manual carefully.

Instruction

1.1 What is Bluetooth

Bluetooth technology is a close range of radio technology to transmit signals wirelessly over short distances between mobile phone, computer, headphone, printer, PDA and other devices.

1.2 BH5300

A. Bluetooth headset

This Bluetooth headset is compliant with any Bluetooth device. It features with crystal clear sound, 8hours talk time and 210hours standby time. After paired and connected it with Bluetooth mobile phone, you can make conversation wirelessly with the headset as below,

- Answer call, end call and reject call wirelessly
- Redial last call
- Voice dial
- Adjust volume
- Switch the conversation between Bluetooth headset and the phone
- Delete current connecting device and connect with other device immediately
- Microphone mute
- Switch current conversation with new coming call (This function need your phone to support)
- Support three-ways conversation (This function need your phone to support)
- Call back last coming call

B. Hands-free car kit

This car kit is specially designed for above Bluetooth headset. When you insert the Bluetooth headset into the car kit, you can enjoy the function as below.

- Let you make a call wirelessly with Bluetooth headset or car kit
- Charge the battery of headset anytime, even while in use
- Power the charger with cigarette light of car, no need extra battery
- Compliant with all type of car with standard plug

Overview

A. Bluetooth Headset

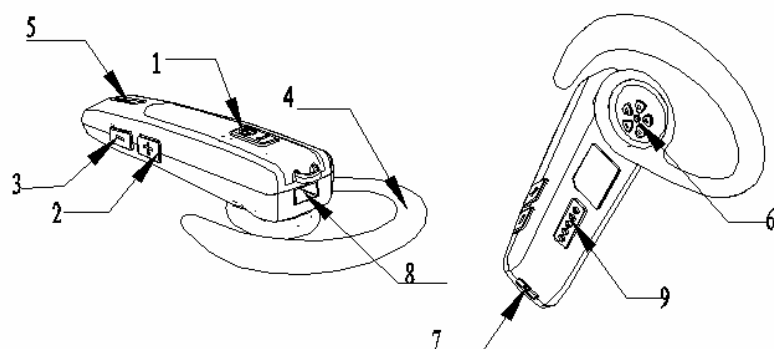

Chart1

B. Hands-free Car Kit

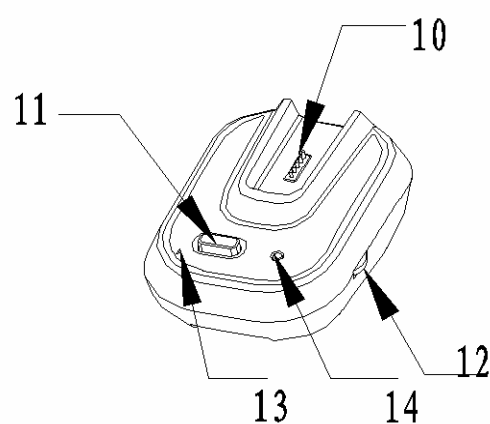

Chart2

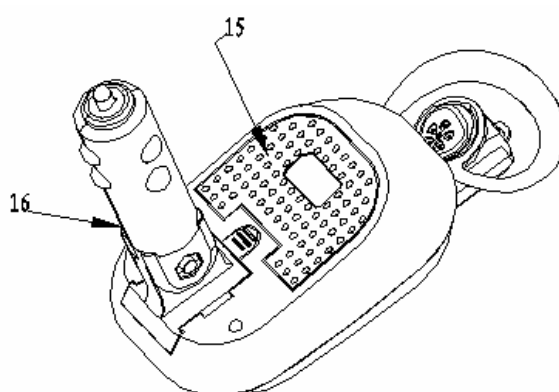

Chart3

On the headset,

1. Switch on/off headset, answer call, reject call
2. Volume up, pair the headset with Bluetooth device
3. Volume down, pair the headset with Bluetooth device
4. Ear hook
5. Indicator light
6. Headset speaker
7. Microphone
8. Mini USB port (charge the battery)
9. Needle bed

On the car kit,

- 10. Probe
- 11. Car kit power switch
- 12. Volume button
- 13. Indicator light
- 14. Build-in speaker
- 15. Cigar plug

Getting start

2.1 Charge the battery of headset

Before the first time to use the headset, you should charge the battery for 2hours. When you hear the headset sounds 4 high indication tunes, at the same time, the read indicator light blinks five times quickly. It means that you should recharge your battery at that time.

Please charge the battery of headset as below,

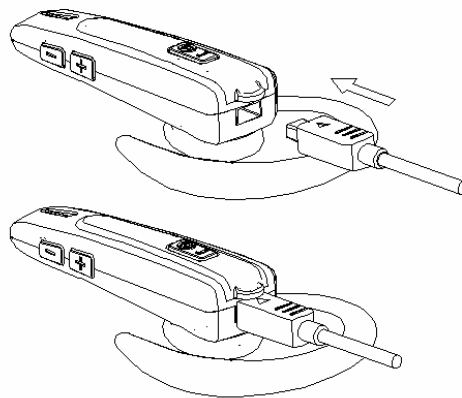

Chart4

A. Charge the battery with travel charger,

Step1 Plug Mini USB of charger into the headset as chart4

Step2 Connect charger with power outlet

Step3 While charging, red indicator light is bright. It takes 2hours for charging full.

Step4 After finishing charging, the red indicator light will be closed.

B. Charge the battery with car kit,

Step1 Insert the cigar plug into the slot of main body as chart5

Step2 Plug the car kit into cigarette light socket

Step3 Switch on car kit power and put the headset on car kit as chart6, then the car kit will charge the battery automatically.

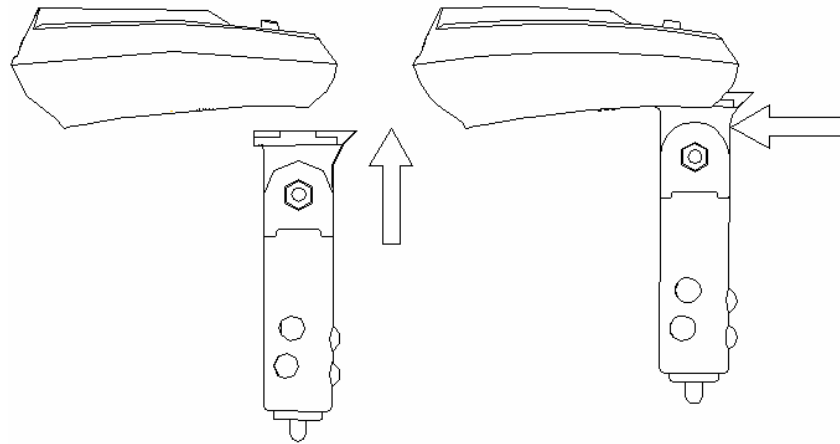

Chart5

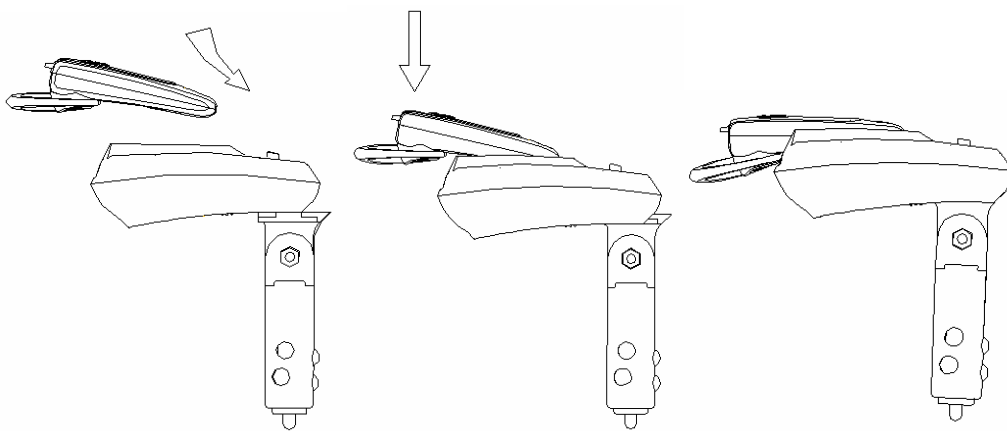

Chart6

2.2 Wear the headset

This headset can be wore on right ear or left ear. You can unfix the ear hook form headset and wear the hook reversely on the speaker. The indication as Chart7,

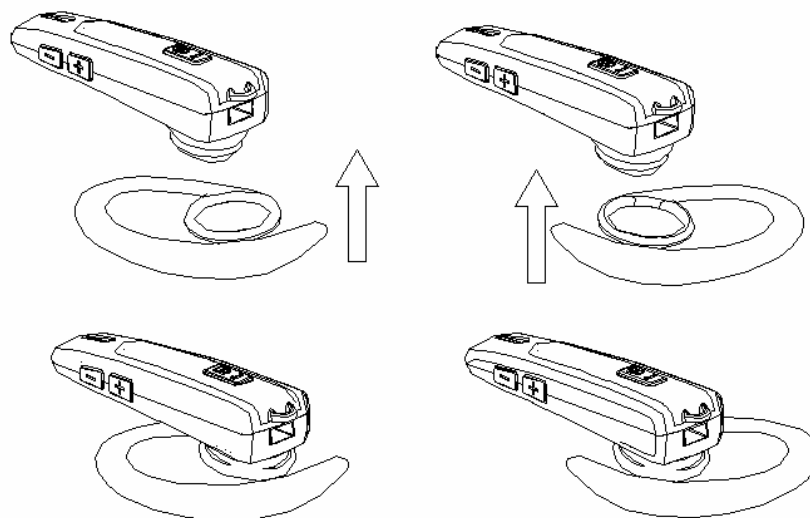

Chart 7

For the best comfort and conversation, you can adjust the earphone and make the

microphone to you.

How to use

3.1 Switch on/of the headset

Switch on: Press and hold the Power Key for 5 seconds. The indicator light will blink once between red and blue once in turn, then you will hear the tune “ Do-Re-Mi”. At that time, release your hand and the headset enters into standby mode.

Switch off: Switch off: Press and hold the Power Key over 3 seconds. You will hear the tune “Di”, then continue to hold the key for 2seconds, then the headset will sound a tune “Mi-Re-Do” and be switched off.

3.2 Pair the headset with Bluetooth device

A. Pair the headset with Bluetooth mobile phone

§ The headset must pair with Bluetooth mobile phone before connecting with Bluetooth mobile phone. Please keep BH400 and phone in the range of 5 meters when pairing.

§ Under standby mode, press and hold the volume key for 5 seconds. The blue indicator light will blink and sound a tune then two tune after 2seconds. Then the headset will enter into pairing mode.

§ Run the program of mobile phone to search Bluetooth device. (For further information, please refer to your mobile phone manual user). After searched, the phone will display surrounding Bluetooth devices.

§ Select “BH5300” in the Bluetooth device list and confirm according to the indication. Then enter the password “1234” and pair it with Bluetooth device successfully.

B. Pair with other Bluetooth device

The headset only can connect with the latest pairing device automatically. If you want to use the headset with other Bluetooth devices, you should pair and connect it with the Bluetooth device again.

3.3 Making call with the headset

After successfully connecting with Bluetooth mobile phone, you can make calling with the headset as following table,

Profile	Status of mobile	Status of headset	Headset operation
Voice dial	Standby mode	Standby mode	Press and hold power key 3seconds until a short tune
Redial	Standby mode	Standby mode	Press power key once

Adjust volume	Conversation mode	Conversation mode	Press volume up or down key
End calling	Conversation mode	Conversation mode	Press power key
Answer calling	Ringing	Standby mode	Press power key
Reject calling	Ringing	Standby mode	Press and hold power key 3seconds
Turn conversation to headset	Conversation mode	Standby mode	Press Power key once
Delete pairing	Conversation mode	Standby mode	Press and hold power key 5seconds then headset will disconnect with mobile phone.
Microphone mute	Conversation mode	Conversation mode	Press and hold the volume button for 5seconds until the hearing a short tune
Switch onversation with coming call (Need the phone to support)	Conversation mode	Conversation mode	Press power key twice for stop current conversation and answer the coming call
Three-way conversation (Need the phone to support)	Conversation mode	Conversation mode	Press power key and volume up key together until you hear a tune.
Call back last coming call (Need the phone to support)	Standby	Standby	Press volume up and down key together until you hear a tune

3.4 Making call with the car kit

When you put the headset in the car kit, the sound of mobile phone will be switched to build-in speaker of car kit automatically. Now, you can use following functions wirelessly,

- § Answer/end call
- § Reject call
- § Redial last call
- § Voice dial
- § Switch conversation
- § Adjust volume

3.5 LED indication

1. Charge the battery

Indicator light	Status of light
Red light	Being charge the headset
Red light is bright	Finish charging

2. Connect with Bluetooth mobile phone

Indicator light	Status of light
Blue light blinks every 5seconds	Standby mode
Blue light blinks every 1second	Conversation mode
Blue light blinks quickly	Pairing mode

Maintenance and care

Please read following suggestion carefully that will help you to fulfill any warranty obligations and to enjoy this product many years.

1. Keep this kit dry. Humidity and all types of liquids or moisture will corrode electronic circuits
2. Don't store the headset in hot areas. High temperatures can shorten the life of electronic devices, damage batteries and warp or melt certain plastics.
3. Don't attempt to open the headset. Non-expert handling may damage it.
4. Don't drop, knock or shake the headset. Rough handling can break internal circuit boards.
5. Don't use harsh chemicals, cleaning solvents, or strong detergents to clean the headset.
6. Don't scratch the cover of headset.

If the headset can't working properly, please carry it to the nearest qualified dealer. The personnel there will assist and help you warmly.

FCC ID: RLQBH5300

Made in China

This device complies with Part 15 of the FCC Rules.

Operation is subject to the following two conditions:

1. This device may not cause harmful interference, and
 2. This device must accept any interference received,
- Including interference that may cause undesired operation

Changes or modifications not expressly approved by the party responsible for compliance could void the user's authority to operate the equipment.

FCC RF Radiation Exposure Statement:

This equipment complies with FCC radiation exposure limits set forth for an uncontrolled environment. End users must follow the specific operating instructions for satisfying RF exposure compliance. This transmitter must not be co-located or operating in conjunction with any other antenna or transmitter.

This product has been tested and complies with the specifications for a Class B digital device, pursuant to Part 15 of the FCC Rules. These limits are designed to provide reasonable protection against harmful interference in a residential installation. This equipment generates, uses, and can radiate radio frequency energy and, if not installed and used according to the instructions, may cause harmful interference to radio communications. However, there is no guarantee that interference will not occur in a particular installation. If this equipment does cause harmful interference to radio or television reception, which is found by turning the equipment off and on, the user is encouraged to try to correct the interference by one or more of the following measures:

- Reorient or relocate the receiving antenna
- Increase the separation between the equipment or devices
- Connect the equipment to an outlet other than the receiver's
- Consult a dealer or an experienced radio/TV technician for assistance