

STANLEY

GUARD 

Access Control System



STST1-79226, STST320000
STST1-71238, STST321000



(GB) XX

A) The lock - main unit **B)** Key x2 **C)** User tag x4
D) Cutter shield (Note: not included in pack - see label)
E) Batteries x2 **F)** USB cable **G)** User manual **H)** Extended user manual

(FR) XX

A) The lock - main unit **B)** Key x2 **C)** User tag x4
D) Cutter shield (Note: not included in pack - see label)
E) Batteries x2 **F)** USB cable **G)** User manual **H)** Extended user manual

(IT) XX

A) The lock - main unit **B)** Key x2 **C)** User tag x4
D) Cutter shield (Note: not included in pack - see label)
E) Batteries x2 **F)** USB cable **G)** User manual **H)** Extended user manual

(ES) XX

A) The lock - main unit **B)** Key x2 **C)** User tag x4
D) Cutter shield (Note: not included in pack - see label)
E) Batteries x2 **F)** USB cable **G)** User manual **H)** Extended user manual



Key In - Insert or remove mechanical key **FR** Key In - Insert or remove mechanical key **IT** Key In - Insert or remove mechanical key **DE** Key In - Insert or remove mechanical key **SE** Key In - Insert or remove mechanical key **DK** Key In - Insert or remove mechanical key



Communication - USB & Bluetooth (for ACS-BT) activation **FR** Communication - USB & Bluetooth (for ACS-BT) activation **IT** Communication - USB & Bluetooth (for ACS-BT) activation **DE** Communication - USB & Bluetooth (for ACS-BT) activation **SE** Communication - USB & Bluetooth (for ACS-BT) activation **DK** Communication - USB & Bluetooth (for ACS-BT) activation

(DE) XX

A) The lock - main unit **B)** Key x2 **C)** User tag x4
D) Cutter shield (Note: not included in pack - see label)
E) Batteries x2 **F)** USB cable **G)** User manual **H)** Extended user manual

(SE) XX

A) The lock - main unit **B)** Key x2 **C)** User tag x4
D) Cutter shield (Note: not included in pack - see label)
E) Batteries x2 **F)** USB cable **G)** User manual **H)** Extended user manual

(DK) XX

A) The lock - main unit **B)** Key x2 **C)** User tag x4
D) Cutter shield (Note: not included in pack - see label)
E) Batteries x2 **F)** USB cable **G)** User manual **H)** Extended user manual



Add new user / Pairing access control **FR** Add new user / Pairing access control **IT** Add new user / Pairing access control **DE** Add new user / Pairing access control **SE** Add new user / Pairing access control **DK** Add new user / Pairing access control



Lock opened / remove users **FR** Lock opened / remove users **IT** Lock opened / remove users **DE** Lock opened / remove users **SE** Lock opened / remove users **DK** Lock opened / remove users

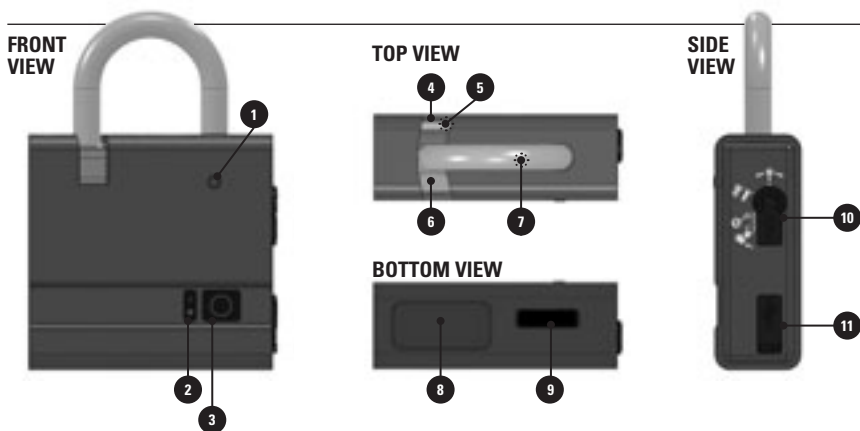

(GB)

FRONT VIEW 1) Shackle release button 2) Indication LEDs 3) Push button **TOP VIEW** 4) Mechanical latch 5) Battery cover screw release 6) Electromechanical latch 7) Shackle protector screw thread **BOTTOM VIEW** 8) Battery cover 9) User tag slot **SIDE VIEW** 10) Key insertion slot 11) USB input

(FR)

FRONT VIEW 1) Shackle release button 2) Indication LEDs 3) Push button **TOP VIEW** 4) Mechanical latch 5) Battery cover screw release 6) Electromechanical latch 7) Shackle protector screw thread **BOTTOM VIEW** 8) Battery cover 9) User tag slot **SIDE VIEW** 10) Key insertion slot 11) USB input

(IT)

FRONT VIEW 1) Shackle release button 2) Indication LEDs 3) Push button **TOP VIEW** 4) Mechanical latch 5) Battery cover screw release 6) Electromechanical latch 7) Shackle protector screw thread **BOTTOM VIEW** 8) Battery cover 9) User tag slot **SIDE VIEW** 10) Key insertion slot 11) USB input

(ES)

FRONT VIEW 1) Shackle release button 2) Indication LEDs 3) Push button **TOP VIEW** 4) Mechanical latch 5) Battery cover screw release 6) Electromechanical latch 7) Shackle protector screw thread **BOTTOM VIEW** 8) Battery cover 9) User tag slot **SIDE VIEW** 10) Key insertion slot 11) USB input

(DE)

FRONT VIEW 1) Shackle release button 2) Indication LEDs 3) Push button **TOP VIEW** 4) Mechanical latch 5) Battery cover screw release 6) Electromechanical latch 7) Shackle protector screw thread **BOTTOM VIEW** 8) Battery cover 9) User tag slot **SIDE VIEW** 10) Key insertion slot 11) USB input

(SE)

FRONT VIEW 1) Shackle release button 2) Indication LEDs 3) Push button **TOP VIEW** 4) Mechanical latch 5) Battery cover screw release 6) Electromechanical latch 7) Shackle protector screw thread **BOTTOM VIEW** 8) Battery cover 9) User tag slot **SIDE VIEW** 10) Key insertion slot 11) USB input

(DK)

FRONT VIEW 1) Shackle release button 2) Indication LEDs 3) Push button **TOP VIEW** 4) Mechanical latch 5) Battery cover screw release 6) Electromechanical latch 7) Shackle protector screw thread **BOTTOM VIEW** 8) Battery cover 9) User tag slot **SIDE VIEW** 10) Key insertion slot 11) USB input

THANK YOU FOR CHOOSING THE STANLEY GUARD ACCESS CONTROL SYSTEM.

- KEEPING YOUR VALUABLE EQUIPMENT SAFE AND ACCOUNTED FOR IS CRUCIAL.
- THE NEW LOCK IS THE BEST WAY TO CONTROL YOUR JOB SITE.
- THE LOCK IS EASILY PROGRAMMED TO OPEN UP DURING SET HOURS AND ONLY TO THE AUTHORIZED WORKERS WITH USER TAGS.
- THE LOG REGISTERS THE ENTRIES.
- SOFTWARE AND MOBILE APPLICATION ENABELS MANAGING WORKERS DETAILS AND CONTROLLING THE LOCK*.

SET UP AND INSTALLATION

-  1. Please copy and keep the code marked on the key.
2. In case of key is lost, contact the customer service to order a new one. You will need to advise the code.
3. There is a spare key so you can also duplicate the key.
4. In case there is no key and also no code is at hand - the cylinder will need to be replaced.
Please contact customer service to send your lock to be fixed or arrive there to do so.

INSTALLING THE BATTERY



Insert the mechanical key and rotate it clockwise till lock is opened.

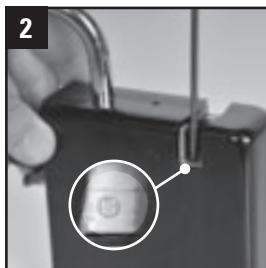

Open the screw beneath the latch.

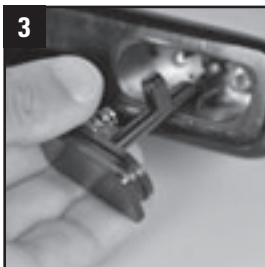

Remove battery cover.



Insert CR123A batteries. Make sure that battery (-) is facing the springs.

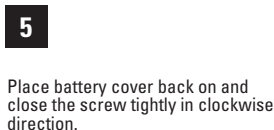

Place battery cover back on and close the screw tightly in clockwise direction.

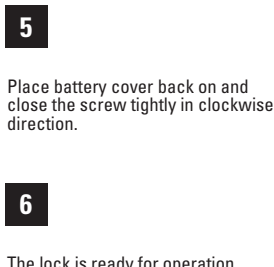

The lock is ready for operation.

ADDING NEW USERS (TAGS)



Insert the mechanical key and rotate it counter-clockwise to "Pairing / Access Control" position.

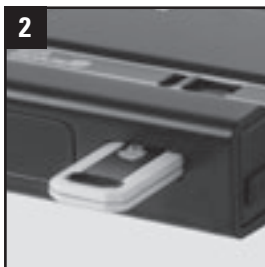

Insert new user tag - After successful pairing¹ the green led will blink and buzzer will sound melody. The new user has been introduced to the system.



NOTE: YOU CAN ENTER UP TO 100 USER TAGS, IF YOU EXCEED THIS NUMBER THE NEW USER TAG WILL NOT BE PAIRED AND THE RED LED WILL BLINK 3 TIMES TOGETHER WITH BUZZER "ERROR" NOTIFICATION .

DELETING ALL AUTHORIZED USERS

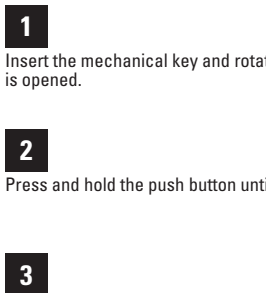

Insert the mechanical key and rotate it clockwise till mechanical latch is opened.

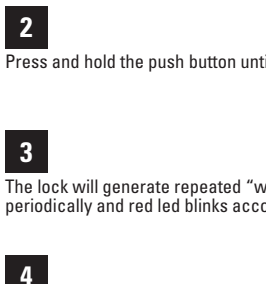

Press and hold the push button until you hear beeping sound.



The lock will generate repeated "warning" notification. Buzzer beeps periodically and red led blinks accordingly.



If no change in key position was made during the "Warning" period of time all paired users will be deleted.



NOTE: YOU CAN ABORT THIS OPERATION BY CHANGING KEY POSITION TO "KEY IN" DURING THE "WARNING" NOTIFICATION.

NOTE: WHEN LOCK IS IN "TEMPORARY AUTHORIZATION FREEZE MODE" (SEE BELOW) USERS CAN'T BE DELETED, IF YOU WILL ATTEMPT PERFORMING THIS OPERATION RED LED WILL BLINKS TWICE FOR NOTIFICATION.

¹ Pairing - introduction of a new tag to the lock.

DELETING A SPECIFIC USER

1

Insert the mechanical key and rotate it clockwise till mechanical latch is opened.

2

Insert paired user tag to the dedicated slot.

3

If tag is identified, the lock will sound melody and green LED will blink once, the tag will be deleted from lock's memory.

4

If tag is not identified or was previously deleted, the lock will play error notification and the red LED will blink 3 times.

OPEN / CLOSE LOCK USING THE USER TAG

1

Make sure that the lock's position is "Key in".

2

Insert user tag.

3

If identified tag is inserted the electromechanical latch will open/close (depending on previous state), Approving buzzer will sound together with single green LED blink.



NOTE: INSERTION OF UNIDENTIFIED/ UNPAIRED USER TAG WILL NOT OPEN THE LOCK. THE LOCK WILL NOTIFY UNAUTHORIZED ACCESS ATTEMPT BY PLAYING "ERROR" NOTIFICATION AND BLINKING RED LED THREE TIMES.

NOTE: WHEN LOCK IS IN "TEMPORARY AUTHORIZATION FREEZE MODE" AND TAG IS INSERTED RED LED WILL BLINK TWICE NOTIFYING THAT ACCESS IS DENIED FOR ALL USERS.



TEMPORARY AUTHORIZATION FREEZE

USING THIS OPTION THE LOCK SHALL BE OPENED/CLOSED ONLY BY USING MECHANICAL KEY. THIS WILL PREVENT OTHER USERS FROM ACCESSING THE LOCK UNIT.



1

Insert the mechanical key and rotate it counter-clockwise to "Pairing / Access Control" position.

2

Long press on the push button on the front panel until buzz sound is heard and red led blinks.

3

Electromechanical latch will close (if open).



FOR ACS-BT ONLY

NOTE: IF "TEMPORARY AUTHORIZATION FREEZE MODE" WAS SET USING SMART PHONE APP THIS OPERATION WILL OVERRIDE AUTOMATIC SETTINGS (SEE SMART PHONE APPLICATION MANUAL/HELP).

NOTE: THIS MODE ALLOWS ALL OPERATIONS EXCEPT OPENING/CLOSING LOCK USING USER TAGS AND DELETING ALL AUTHORIZED USER TAGS (SEE "DELETING ALL AUTHORIZED USERS").

RELEASE AUTHORIZATION FREEZE



1

Insert the mechanical key and rotate it counter-clockwise to "Pairing / Access Control" position.

2

Long press the push button on the front panel until buzz sound heard and green led blinks.

3

The system is back to fully operational mode.



FOR ACS-BT ONLY

NOTE: IF "TEMPORARY AUTHORIZATION FREEZE MODE" WAS SET USING SMART PHONE APP THIS OPERATION WILL OVERRIDE AUTOMATIC SETTINGS (SEE SMART PHONE APPLICATION MANUAL/HELP).

PC CONNECTION



CONNECT THE LOCK TO THE PC USING A USB CABLE IN ORDER TO DOWNLOAD AND UPLOAD HISTORY LOG AND AUTHORIZATIONS.



1

Insert the mechanical key and rotate it counter-clockwise to the "COMMUNICATION" position.

2

Connect the lock to the PC using mini USB cable.

3

Open the PC software (Not included in the pack).



FOR ACS-BT ONLY

NOTE: IF YOU WERE PREVIOUSLY CONNECTED TO BLUETOOTH, CONNECTION TO PC WILL TERMINATE BLUETOOTH COMMUNICATION.

WARNING: DON'T CHANGE KEY POSITION DURING DATA TRANSFER - THIS MAY CAUSE DATA LOSS.

BLUETOOTH CONNECTION

STST1-79226
STST320000



CONNECT LOCK TO SMART PHONE USING BLUETOOTH TO MANAGE USERS AND LOCK SETTINGS (DETAILS IN SMART PHONE APP HELP).

NOTE: BLUETOOTH PAIRING CODE IS "1234"

1

Insert the mechanical key and rotate it counter-clockwise to the "COMMUNICATION" position.

2

Press and hold push button until buzzer beeps and green led blinks - this operation will activate Bluetooth.
When Bluetooth is active green LED will start blinking.

3

Open smart phone app and connect to the lock (details in smart phone app user help).



4

To disconnect from Bluetooth change key position (any other position than the "COMMUNICATION" position).



NOTE: YOU CAN'T ACTIVATE BLUETOOTH WHEN CONNECTED TO PC USING USB, CONNECTION TO PC WILL TERMINATE BLUETOOTH CONNECTION.

NOTE: BLUETOOTH WILL SHUT DOWN AUTOMATICALLY WHEN THERE IS NO CONNECTION ESTABLISHED DURING 5 MINUTE (SAVES BATTERY POWER), YOU CAN ACTIVATE BLUETOOTH AGAIN BY PRESSING THE PUSH BUTTON IN "COMMUNICATION" MODE.

NOTE: BLUETOOTH COMMUNICATION WILL WORK IN A RANGE NO LONGER THAN 15 METERS.

WARNING: DON'T CHANGE KEY POSITION DURING DATA TRANSFER - THIS MAY CAUSE DATA LOSS.

LOW BATTERY INDICATION REPLACING BATTERY



When lock's battery is low the red led will start blinking periodically, once in every 10 seconds. The user should replace the batteries with new CR123A batteries. See page 2 of this guide - installing the battery.

REMOVING/CHANGING SHACKLE



Insert the mechanical key and rotate it clockwise till lock is opened. Rotate shackle in 90 degree angle.

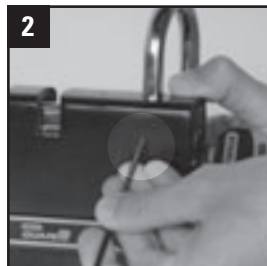

Press shackle release button and remove the shackle.



Insert new shackle in the same manner.

CUTTER SHIELD INSTALLATION



Please make sure you have the supplied screw+washer and a Phillips-key (2mm) as well as the units mechanical key.

1

Using the mechanical key - unlock and open the unit.

2

Insert the lock guard as shown here and slide along the lock's latch.

3

Once in place - screw the guard into final position.

4

The unit now can be used as before.



ACS SPECS

Standards

EN 609050-1
EN 609050-22
UL 60950-1
CSA CS22.2 60950-1
EN 301489
EN 300330
AS/NZS CISPR 22
VCCI V-3
FCC Part 15, Sub-Part B, C
FCC ID:XXXACS320000
FCC ID:XXXACS321000

Application High security electronic lock for access control.

Dimensions 105 x 150 x 37 mm

Weight 1550 gr including batteries

Keys Mechanical + Passive RFID

Standards BS EN 12320

Battery Type CR123A X 2

Nominal Operation voltage 6V

Battery Life Cycle (Average) 6 months

Battery Capacity 1700 mAh

IP 56

Maximum Users 100

Communication Interface USB 2.0, Bluetooth (optional)

Max Bluetooth range 15m

Log Registration of time and events (Unlock, Lock, Pairing, Delete, Authorizations freeze/unfreeze)

Log Capacity 1000 records

RFID Reader Frequency 125KHz

Operating temperature (-20) - (+85) C

Storage temperature (-30) - (+85) C

FCC ID RLBACS320000; RLBACS321000 (ACS-BT)

Patent application number

NOTE: In order to review a list of supported smartphones (for ACS-BT), refer to the Android play market or Apple store.

This device complies with Part 15 of the FCC Rules.

Operation is subject to the following two conditions:

(1) This device may not cause harmful interference, and (2) this device must accept any interference received, including interference that may cause undesired operation.

TROUBLE SHOOTING & TIPS

ACS IS NOT RESPONDING TO MECHANICAL KEY ROTATION AND INSERTION OF USER TAGS

If the lock is still not responding make sure that batteries are installed properly (check batteries polarity).

Not working still? Replace batteries.

RED LED IS BLINKING EVERY 10 SECONDS This is low the low battery indication, Please replace batteries.

LOCK WAS NOT CLOSED PROPERLY WHEN INSERTING THE USER TAG

If this situation occurred it means that something is interfering with the electromechanical latch movement.

Insert user tag again to open the lock.

Place shackle properly in its place to allow movement of the latch.

Insert user tag again to close the latch.

Note: When electromechanical latch is not closed properly an "Error" notification will be sounded.

LOST YOUR USER TAGS

It is possible to erase tags from ACS database, refer to "DELETING A SPECIFIC USER" section of user manual.

It is also possible to erase specific tags using "Stanley Guard PC management software" or smart phone application (Bluetooth version).

LOCK LEFT OPEN, MASTER USER DOESN'T HAVE HIS USER TAG

Option 1 - Rotate key to "pairing position" and then to "Key In" position. These operations will open a 10 seconds time window, during this period of time press the push button until the electromechanical latch is closed.

Option 2- The electromechanical latch is closed automatically when master user places the lock in TEMPORARY AUTHORIZATIONS FREEZE mode refer to this section in the user manual.

PC USB CONNECTION IS NOT ESTABLISHED

Make sure that the mechanical key position is "COMMUNICATION" mode (refer to PC CONNECTION section).

Make sure that the USB cable is not corrupted or damaged.

BLUETOOTH CONNECTION IS NOT ESTABLISHED

Make sure that key position is in "COMMUNICATION" mode.

Make sure that Bluetooth is activated - green LED is blinking.

For making a connection make sure to stand in range of no longer than 10 meters from the lock.

WHEN ADDING NEW USER, ACS IS GENERATING ERROR INDICATION

Make sure that the user tag is not damaged or corrupted.

ACS can store up to 100 user tags, trying to add more than 100 tags will cause ACS to generate error indication.

LOCK INTERPRETS KEY POSITION INCORRECTLY

Rotate mechanical counter-clockwise to "COMMUNICATION" position and then rotate it clockwise till mechanical latch is opened.

BATTERY OPERATION TIME

Battery average operating time is approx 6 months, however this time may vary according to usage policy and environmental temperature.

MECHANICAL KEYS ARE LOST

Make sure you have copied the marked code on the key (the code of the key also appears on the last page of the short manual). Contact the customer service to order a new one. You will need to advise the code.

There is a spare key so you can also duplicate the key.

In case there is no key and no code is at hand - the cylinder will need to be replaced. Please contact the customer service to send your lock to be fixed or arrive there to do so.

GENERAL SAFETY RULES

WARNING : Read and understand all instructions.

Failure to follow all instructions may result in electric shock, fire, property damage and/or serious personal injury or death.

WARNING : SERIOUS INJURY OR DEATH.

This product was designed to provide protection for property only. Do not use this product to provide protection for life safety and from fire. Any use

other than that suggested in this instruction manual could cause injury or even death.

WARNING : SERIOUS INJURY OR DEATH.

Do not use this product in hazardous areas. This may include blasting areas and potentially explosive atmospheres. Sparks in such areas could cause an explosion or fire resulting in bodily injury or even death. They include but are not limited to fueling areas such as gas stations; fuel or chemical transfer or storage facilities; vehicles using liquefied petroleum gas (such as propane or butane); areas where the air contains chemicals or particles, such as grain, dust, or metal powders; and any other area where one would normally be advised to turn off a vehicle engine.

WARNING : SERIOUS INJURY OR DEATH. Consult with manufacturers of any medical devices, such as pacemakers, hearing aids, etc., to determine if they are susceptible to interference from cellular devices.

WARNING : FIRE, ELECTRIC SHOCK OR ELECTROCUTION.

Connect to ACS USB jack only mini USB certified cable. Connect the other side of the USB cable only to a USB certified Host device such as PC or laptop.

Any use other than that suggested could cause malfunction to the device or even injury or death caused by Fire or electric shock.

WARNING : DEVICE MALFUNCTION

Do not connect ACS to USB host device such as PC or laptop when batteries are disconnected, this may cause device malfunction.

Do not use damaged or corrupted USB cable, this may cause unstable or bad connection with the device.

WARNING : DEVICE MALFUNCTION INJURY OR DEATH

Use only CR123A batteries for the device. Any other battery type may cause device malfunction or even injury or death caused by fire or electrical shock.

Install batteries correctly as specified in this manual, improper installation may cause device malfunction.

INTERNAL LITHIUM ION BATTERY

WARNING : BATTERIES – EXPLOSION, INJURY OR FIRE.

The ACS contains a Lithium-Ion batteries. Carefully follow all of the instructions in this manual.

Never dispose of the ACS or its battery in a fire. Return to a Stanley service center to recycle the unit.

The battery can explode in a fire. Toxic fumes, Hydrogen and materials are created when Lead Acid batteries are burned.

Lithium-Ion Battery can cause severe ACID burns.

Do not disassemble, open, crush, bend, shred, puncture or deform the ACS and its battery.

If battery contents come into contact with the skin, immediately wash area with mild soap and water. If battery liquid gets into the eye, rinse water over the open eye for 15 minutes or until irritation ceases. In any way seek medical attention.

WARNING: To comply with FCC RF exposure compliance requirements, the device should be located at a distance of at least 20 cm from all persons during normal operation. The antennas used for this product must not be co-located or operated in conjunction with any other antenna or transmitter.

IMPORTANT NOTICES

This product is not user serviceable. There are no user serviceable parts inside the product. Servicing at a STANLEY authorized service center is required to avoid damage to static sensitive internal components.

Unauthorized service will void the warranty.

Clean only with a dry cloth.

PRODUCT LIMITATIONS

An intruder may gain access through unprotected openings. An intruder with criminal intent, technical knowledge, or jamming devices, may bypass the locking system.

This product will not operate without power. The equipment has a non rechargeable batteries. If the batteries has low charge or they are not installed, the product will not operate.

Despite advanced design and regular testing, this equipment, like other electrical devices, is subject to component failure.

When you wish to close the lock using a user tag make sure that the shackle is in its place to allow the latch to close properly it is your responsibility to ensure that the lock is closed properly.

FCC STATEMENT:

This equipment has been tested and found to comply with the limits for a class B digital device, pursuant to Part 15 of the FCC rules. These limits are designed to provide reasonable protection against harmful interference in a residential installation.

This equipment generates, uses and can radiate radio frequency energy and, if not installed and used in accordance with the instructions, may cause harmful interference to radio communications. However, there is no guarantee that interference will not occur in a particular installation. If this equipment does cause harmful interference to radio or television reception, which can be determined by turning the equipment off and on, the user is encouraged to try to correct the interference by one or more of the following measures:

- a) Reorient or relocate the receiving antenna.
- b) Increase the separation between the equipment and receiver.
- c) Connect the equipment to an outlet on a circuit different from that to which the receiver is connected.
- d) Consult the dealer or an experienced radio/TV technician.

This device complies with Part 15 of the FCC Rules.

Operation is subject to the following two conditions:

- a) This device may not cause harmful interference
- b) This device must accept any interference received, including interference that may cause undesired operation.

FCC Warning

Modifications not expressly approved by the manufacturer could void the user authority to operate the equipment under FCC Rules.

LIMITED ONE YEAR WARRANTY

This warranty covers manufacturing defects in materials or workmanship of your new Stanley Guard Access Control System.

This warranty lasts for a period of one (1) year from the date of original purchase and is only available to the original purchaser.

Stanley will, at its discretion, repair or replace any malfunctioning electromechanical system part of your new Stanley Guard Access Control System.

In order to obtain warranty service, you must contact Stanley customer service in your country within one (1) year of the date of original purchase. A customer service representative will assist you with warranty service in accordance with this warranty. You must also provide a copy of the original purchase receipt, your name and address, as well as a short written description of the product's defect.

Service centers contact information is listed.

This warranty does not cover any problem with the electromechanical system relating to batteries, misuse, abuse, normal wear and tear, failure to maintain, or an act of nature. This warranty does not cover any other aspect or portion of your Stanley Guard Access Control System. Also, this warranty does not cover, and Stanley is not liable for, the loss or damage of any of your property.

By purchasing the Stanley Guard Inventory Control System and accepting this warranty, the purchaser acknowledges that Stanley is not an insurer of any property and that insurance products are available to the purchaser from other sources to cover such losses.

This warranty does not cover and expressly disclaims all implied warranties of any nature, including implied warranties of merchantability or fitness for a particular purpose.

Consequential and incidental damages are not recoverable under this warranty. Some states do not allow limitations on implied warranties or on consequential or incidental damages, so the above exclusion may not apply to you. This warranty gives you specific rights, and you may also have other rights which vary from state to state.

U.S and Canada

1000 Stanley Drive, Concord, NC 28027

Tel: 1-800-262-2161

stanley@stanleycustomercare.com

www.stanleytools.com

Belgique et Luxembourg België en Luxembourg

E. Walschaertstraat 14-16 2800 Mechelen Belgium

NL Tel: +32 15 47 37 63 Fax: +32 15 47 37 99

FR Tel: +32 15 47 37 64 Fax: +32 15 47 37 99

Enduser.be@SBDinc.com

www.stanleytools.eu

Denmark

Farverland 1B 2600 Glostrup

Tlf: 70201510 Fax: 70224910

www.stanleyworks.dk

Deutschland

Richard Klinger Str. 11 65510 Idstein

Tel: 06126-21-1 Fax: 06126-21-2770

www.stanleyworks.de

Ελλάδα

Στράβωνος 7 & Βουλιαγμένης 159 Γλυφάδα 1

6674, Αθήνα

Τηλ: +30 210 8981-616 Φαξ: +30 210 8983-285

www.stanleyworks.gr

España

Parque de Negocios "Mas Blau" Edificio Muntadas,
c/Bergadá, 1, 0t, A6 08820 El Prat de Llobregat (Barcelona)

Tel: 934 797 400 Fax: 934 797 419

S-CDIY-Posventastanley@sbdinc.com

www.stanleyworks.es

France

5, allée des hêtres BP 30084, 69579 Limonest Cedex

Tel: 04 72 20 39 20 Fax: 04 72 20 39 00

scurf@sbdinc.com

www.stanleyoutillage.fr

Schweiz Suisse

In der Lüberzen 40 8902 Urdorf

Tel: 01 - 730 67 47 Fax: 01 - 730 67 70

www.stanleyworks.de

Ireland

210 Bath Road; Slough, Berks SL1 3YD UK

Tel: +44 (0)1753 511234 Fax: +44 (0)1753 572112

www.stanleytools.co.uk

Italia

SWK Utensilerie Srl

Energy Park - Building 03 Sud, Via Monza, 7/A

20871 Vimercate (MB)

Tel. 031.780304 - Fax 031.781766

www.stanley.it

Nederlands

Joulehof 12 4600 AB Bergen Op Zoom

Tel: +31 164 28 30 63 Fax: +31 164 28 32 00

Enduser.NL@SBDinc.com

Norge

Postboks 4613, Nydalen 0405 Oslo

Tel: 45 25 13 00 Fax: 45 25 08 00

Österreich

Werkzeug Vertriebsges m.b.H.

Oberlaaerstrasse 248 A-1230 Wien

Tel: 01-66116-0 Fax: 01-66116-14

www.stanleyworks.de

Portugal

Centro de Escritórios de Sintra Avenida Almirante

Gago Coutinho, 132/134, Edifício 142710-418

Sintra 2710-418 Lisboa

Tel: 214 66 75 00 Fax: 214 66 75 75

resposta.posvenda@sbdinc.com

Suomi

Tekniikkantie 12 02150 Espoo

Puh: 010 400 430 Faksi: 0800 411 340

www.stanleyworks.fi

Sverige

Box 94 431 22 Mölndal

Tel: 031 68 61 00 Fax: 031 68 60 08

Türkiye

KALE Hirdavat ve Makina A.Ş. Defterdar Mah.

Savaklar Cad. No:15

Edirnekapi / Eyüp / İSTANBUL 34050

Tel: 0212 533 52 55 Faks: 0212 533 10 05

United Kingdom

210 Bath Road; Slough, Berks SL1 3YD

Tel: +44 (0)1753 511234 Fax: +44 (0)1753 572112

www.stanleytools.co.uk

Middle East & Africa

P.O.Box - 17164, Jebel Ali (South Zone), Dubai,

UAE

Tel: +971 4 8127400 Fax: +971-4-8127036

www.stanleyworks.ae

Czech Republic

Stanley Black and Decker Czech Republic

s.r.o. Türkova 5b, 149 00, Prague, CZ Czech

Republic

Tel: +420 261 009 779 Fax: +420 261 009 770

Hungary

Stanley Black & Decker Hungary Ltd.

1016 Budapest, Meszaros u. 58/B Hungary

Tel: +36 12 140561

Poland

STANLEY BLACK&DECKER Polska Sp. z o.o. ul.

Postepu 21D 02-676 Warszawa Poland

Tel: 48 22 464-2700 Fax: 48 22 464-2701

Slovakia

Stanley Black & Decker Slovakia s.r.o.

Stará Vajnorská 8 SK-83104 Bratislava, Slovakia

Tel: +421 2 446 38 121,3 Fax: +421 2 446 38 122

Romania

STANLEY BLACK & DECKER

Splaiul Independentiei

319 Corp Cladire

Ob. 153-200A Sector 6 0060044 BUCURESTI RO

Tel: +40 21 30 00 755 Fax: +40 21 31 81 126

Bulgaria

EUROTOOLS LTD.

Andrei Liapchev str. 14 1756 Sofia, Bulgaria

Tel: 359-2-4219723 Fax: 359-2-4219723

Tashev Galving LTD 68 Kliment Ohridski BLVD

1756 Sofia, Bulgaria

Slovenia

G-M&M D.O.O. BRVACE 11, SI -1290,

GROSUPLE

Tel. +386(0)17866 500 Fax +386(0)1 7861 205

www.stanleyguard.com
<http://www.stanley.eu/ics>



www.stanleytools.com © 2013 Stanley Tools. 701 East Joppa Road, Towson, Maryland 21286
U.S. & Canada Only / E.-U. et Canada seulement

© 2013 Stanley Black & Decker. De Kleetlaan 5C/5B, B-1831 Diegem, Belgium. <http://www.stanleytools.eu>