

Radar Type Level Sensor
FR Series

Short-range type with separated display
(FR-S(H)01(C)SA□)
Instruction Manual

Details about the FR Series functions and how to use the unit can be found in the "FR Series User's Manual." A copy of the "FR Series User's Manual" can be downloaded off of the KEYENCE website. Alternatively, contact a local KEYENCE representative. KEYENCE website: <http://www.keyence.com>

Read this manual before using the product in order to achieve maximum performance. Keep this manual in a safe place after reading it so that it can be used at any time.

Symbols

The following symbols alert you to important messages. Be sure to read these messages carefully.

	Indicates a hazardous situation which, if not avoided, will result in death or serious injury.
	Indicates a hazardous situation which, if not avoided, could result in death or serious injury.
	Indicates a hazardous situation which, if not avoided, could result in minor or moderate injury.
	Indicates a situation which, if not avoided, could result in product damage as well as property damage.

	Indicates cautions and limitations that must be followed during operation.
--	--

	Indicates additional information on proper operation.
--	---

	Indicates tips for better understanding or useful information.
--	--

Safety Precautions

General precautions

	<ul style="list-style-type: none">Do not use this product for the purpose of protecting a human body or a part of a human body.This product is not intended for use as an explosion-proof product. Do not use this product in a hazardous location and/or potentially explosive atmosphere.Do not use this product in an application that may cause death, serious injury, or serious property damage due to a failure with this product occurring, such as in nuclear power plants; on aircraft, trains, ships, or vehicles; used within medical equipment, playground equipment, roller coasters, and other rides.
	<ul style="list-style-type: none">Do not use the FR-SH01(C) for applications such as beverages, food, and medical services. Also, if using the FR-LP(H)20(L) for applications such as beverages, food, and medical services, be sure to use a ferrule mounting bracket (OP-8888).If the equipment is used in a manner not specified by the manufacturer, the protection provided by the equipment may be impaired.You must perform a sufficient risk assessment for the machine where this product is to be installed prior to installing this product. Provide appropriate protective fail-safe measures on the machine independent from this product in case a failure with this product should occur.
	<ul style="list-style-type: none">Before starting operation and during operation, verify the functions and performance of the product.In case any failure occurs with the product, take sufficient safety measures to prevent further damage.
	<ul style="list-style-type: none">If the product is used in combination with other equipment, the functions and performance may not meet expectations depending on the operating condition, environment, and other conditions. Consider these points before using this product.If this product is used for an acid or alkaline medium, or for an application within sanitary environments and electroplating, check the resistance of the sensor materials to the target medium or application beforehand.

Precautions on media

	Measured values may exceed the upper limit if conductive components in the target medium adhere to the bottom of the main unit. In this case, clean the bottom of the main unit to remove the adhered substances.
--	---

Precautions on handling

	<ul style="list-style-type: none">When detecting a high-temperature liquid, the temperatures of the metal components of the sensor will also rise, which may cause burns. Do not touch these metal components during operation.Do not touch the screw component of the main unit because it is sharp.
--	--

Precautions on installation

	<p>Do not install the sensor in the following locations, as this may result in an accident:</p> <ul style="list-style-type: none">A location where the main unit is subject to vibrations or impact greater than its environmental resistanceA location whose ambient temperature does not fall within the ambient operating temperature rangeA location where the humidity surrounding the main unit is not between 35%RH and 85%RH (no condensation)A location subject to sudden changes in temperatureA location with any volatile combustibles, solvents, or corrosive gasesA location with a strong magnetic or electric field
	<p>During installation, take the following into account to improve the noise immunity. Otherwise, a malfunction may occur.</p> <ul style="list-style-type: none">Do not use a power cable whose length exceeds 30 m (20 m if using IO-Link).Mount the sensor as far away as possible from any power lines.Mount the sensor as far away as possible from any equipment generating a high electric or magnetic field (such as solenoids and choppers).Wire input/output signal lines separately from power and high-tension lines. <p>Power supply</p> <ul style="list-style-type: none">Noise superimposed on the power supply may result in malfunction. Be sure to use a stabilized DC power supply with an isolating transformer.When using a commercially available switching regulator, be sure to ground the frame ground terminal.Failing to abide by the recommended installation conditions in this manual may lead to unstable detection.

Precautions on Regulations and Standards

CE and UKCA marking

Keyence Corporation has confirmed that this product complies with the essential requirements of the applicable EU Directive(s) and UK regulations, based on the following specifications. Be sure to consider the following specifications when using this product in the Member States of European Union and in the United Kingdom.

RE Directive (CE) and Radio Equipment Regulations (UKCA)

- Operating frequency: 58 to 63 GHz
- Maximum radio output:
 - FR-S(H)01(C): -12.81 dBm (0.05 mW)
 - FR-LM(H)20(LP(H)20)LS20: -5.89 dBm (0.26 mW)
 - FR-LM(H)20(LP(H)20)LS20L: -17.36 dBm (0.02 mW)

Remarks: These specifications do not give any guarantee that the end-product with this product incorporated complies with the essential requirements of RE Directive and Radio Equipment Regulations. The manufacturer of the end-product is solely responsible for the compliance of the end-product itself according to RE Directive and Radio Equipment Regulations.

CSA certificate

This product complies with the following CSA and UL standards and has been certified by CSA.

- Applicable standard CAN/CSA C22.2 No.61010-1 UL61010-1

Be sure to consider the following specifications when using this product as a product certified by CSA.

- Overvoltage category I
- Pollution degree 3 (FR-S(H)01(C)/SA1/SA2/SA1C/SA0/LS20(L))
- Pollution degree 4 (FR-LM(H)20(LP(H)20)LS20(L))
- Use this product at an altitude of 5000 m or less.
- Use a CSA/UL certified power supply that provides Class 2 output as defined in the CEC (Canadian Electrical Code) and NEC (National Electrical Code).

Precautions on radio communication

- The FR Series uses the 60 GHz band.
- Radio frequency interference slowing or even preventing measurement may occur if this product is used in the vicinity of equipment that uses the same frequency band such as wireless LAN equipment, microwaves, factory-use heaters, and high-frequency medical equipment.
- Industrial, scientific, and medical equipment as well as on-site radio stations (requiring a license) used on factory production lines to identify moving bodies, specified low-power radio stations (not requiring a license), and amateur radio stations (requiring a license) operate in the frequency band used by this device.
 - Before using this device, check that near to it there are no on-site radio stations used to identify moving bodies, specified low-power radio stations, or amateur radio stations in operation.
 - In the rare event that this device causes radio frequency interference in on-site radio stations used to identify moving bodies, immediately change the frequency used by this device or its emission of radio waves, and then contact KEYENCE to discuss measures for avoiding this interference (for example, installing partitions).
 - Furthermore, if this device causes harmful radio frequency interference in specified low-power radio stations used to identify moving bodies or in amateur radio stations or if any other similar problems occur, contact KEYENCE. Phone number for contacting KEYENCE corporation: +81 (0)6-6379-1151
- Never disassemble or modify this device. Doing so is prohibited by the Radio Act. As defined by the Radio Act of Japan, this device is a piece of specified radio equipment and has obtained construction design certification according to the standards defined in the Radio Act.
- KEYENCE declares that the FR-S(H)01(C)/LS20(L)/LM(H)20(L)/LP(H)20(L) complies with Radio Equipment Directive 2014/53/EU.
- The entirety of this declaration of conformity with this EU directive is available at the following Internet address.
[www.keyence.com/cedoc]

- Without proper approval, companies and users are not permitted to alter certified low-power, high-frequency devices such as by changing their frequency from that in the original designs, increasing their output, and changing their characteristics and functions.
- The use of low-power radio frequency devices must not affect the safety of aircraft or otherwise interfere with legal communication. If such interference is detected, the user must immediately stop using these devices until measures against interference are implemented.
- Legal communication introduced above refers to radio communication operated according to the regulations provided by the Electrical Communication Management Act. Low-power radio frequency devices must be able to withstand interference from legal communication and from industrial, scientific, and medical electrical equipment that emits radio waves.
- The conformance of this device has been assessed assuming it will be used in an industrial environment. Radio frequency interference may occur if this device is used in a domestic environment.
- Under normal usage conditions, keep this device away from the human body (head or chest) by more than 20 cm.
- 사용자 안내문
이 기기는 업무용 환경에서 사용될 목적으로 적합성평가를 받은 기기로서 가정용 환경에서 사용하는 경우 전파간섭의 우려가 있습니다.
본 기기는 통신 이용 상태의 경우 인체(머리, 몸통)와 20cm 초과하는 거리에서 사용되어야 합니다.

Precautions on radio communication (FR-S(H)01(C)/LS20/LM(H)20(LP(H)20L)

- This device complies with part 15 of the FCC Rules.
- Operation is subject to the following two conditions:
 - This device may not cause harmful interference, and
 - This device must accept any interference received, including interference that may cause undesired operation.
- FCC CAUTION Changes or modifications not expressly approved by the party responsible for compliance could void the user's authority to operate the equipment. (Note: This equipment has been tested and found to comply with the limits for a Class A digital device, pursuant to part 15 of the FCC Rules. These limits are designed to provide reasonable protection against harmful interference when the equipment is operated in a commercial environment.)
- This equipment generates, uses, and can radiate radio frequency energy and, if not installed and used in accordance with the instruction manual, may cause harmful interference to radio communications.
- Operation of this equipment in a residential area is likely to cause harmful interference in which case the user will be required to correct the interference at his own expense.
- This equipment complies with FCC radiation exposure limits set forth for an uncontrolled environment and meets the FCC radio frequency (RF) Exposure Guidelines.
- This equipment should be installed and operated keeping the radiator at least 20cm or more away from person's body.
- This device contains licence-exempt transmitter(s)/receiver(s) that comply with Innovation, Science and Economic Development Canada's licence-exempt RSS(s). Operation is subject to the following two conditions:
 - This device may not cause interference.
 - This device must accept any interference, including interference that may cause undesired operation of the device.
- L'émetteur/récepteur exempt de licence contenu dans le présent appareil est conforme aux CNR d'Innovation, Sciences et Développement économique Canada applicables aux appareils radio exempts de licence. L'exploitation est autorisée aux deux conditions suivantes :
 - L'appareil ne doit pas produire de brouillage;
 - L'appareil doit accepter tout brouillage radioélectrique subi, même si le brouillage est susceptible d'en compromettre le fonctionnement.
- This equipment complies with ISSED radiation exposure limits set forth for an uncontrolled environment and meets RSS-102 of the ISSED radio frequency (RF) Exposure rules.
- This equipment should be installed and operated keeping the radiator at least 20cm or more away from person's body.
- Cet équipement est conforme aux limites d'exposition aux rayonnements énoncées pour un environnement non contrôlé et respecte les règles d'exposition aux fréquences radioélectriques (RF) CNR-102 de l'ISSED.
- Cet équipement doit être installé et utilisé en gardant une distance de 20 cm ou plus entre le radiateur et le corps humain.
- 取得審驗證明之低功率射頻器材，非經核准，公司、商號或使用者均不得擅自變更頻率、加大功率或變更原設計之特性及功能。
低功率射頻器材之使用不得影響飛航安全及干擾合法通信；經發現有干擾現象時，應立即停用，並改善至無干擾時方得繼續使用。
前述合法通信，指依電信管理法規作業之無線電通信。低功率射頻器材須忍受合法通信或工業、科學及醫療用電波輻射性電機設備之干擾。

Packaged Items

- Main unit
- Instruction Manual

System Configuration Example and Name of Each Component

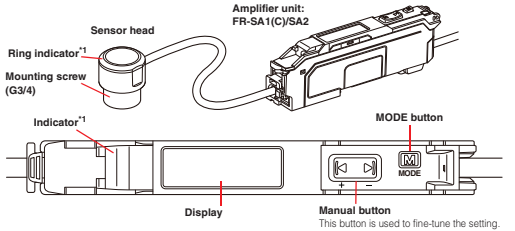

*1 Lights in red, yellow, and green depending on the "Indicator pattern" setting.

Product Overview

The FR Series allows you to specify the following values.

- The distance from the reference surface of the sensor to the bottom of the tank (0%)
 - The distance from the reference surface of the sensor to the top surface of the tank (100%)
- With these values specified, the sensor displays the level of the liquid/powder from the bottom of the tank.

Example) The FR Series is mounted 100 mm above the top surface of a tank whose height (the position at which the tank is filled to 100% capacity) is 1000 mm.

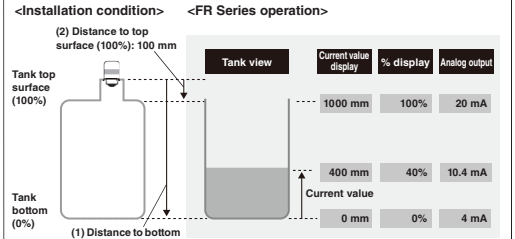

When using an oil-based liquid (low specific conductive capacity)
You can select [Oil-based liquid] for "Detection target" to automatically mask the area close to the bottom of the tank, preventing false detections of the bottom of the tank. The current value display shows "---" in the masked area. For details on the masking function, see the user's manual.

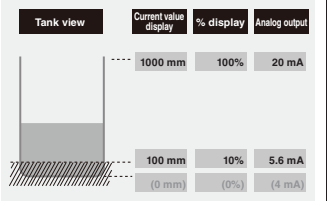

Installation and Mounting

Mounting the sensor head

■ Mounting on the flange nozzle

- 1 Fit a gasket (included with the flange mounting bracket)* on the flange mounting bracket, and then mount the sensor head on the flange mounting bracket.

Recommended tightening torque: 30 N·m for the FR-S01 and 4 N·m for the FR-SH01

- 2 Insert a flange gasket* between the flange mounting bracket and the flange nozzle, and then use bolts and nuts to secure the parts.

* Rubber packing is not required if you are not sealing the parts hermetically.

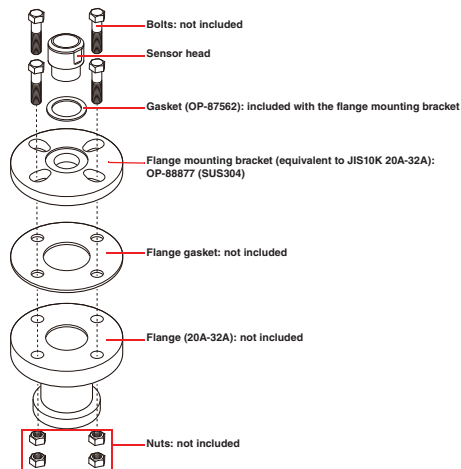

■ Mounting directly on a top panel (mounting with a nut)

- 1 Drill a hole with a diameter of 27 mm in the top panel.
- 2 Fit a gasket* on the mounting screw of the sensor head, and then insert this mounting screw in the hole in the top panel.

- 3 Attach a nut from the bottom of the top panel.

Recommended tightening torque: 30 N·m for the FR-S01 and 4 N·m for the FR-SH01

* A gasket is not required if you are not sealing the parts hermetically.

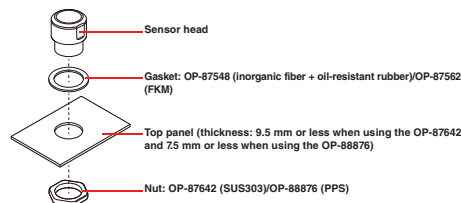

■ Mounting directly on a top panel (using a mounting bracket, not a nut)

- 1 Insert the mounting screw of the sensor head into a general mounting bracket.

Recommended tightening torque: 30 N·m for the FR-S01 and 4 N·m for the FR-SH01

- 2 In the top panel, drill a hole with a diameter of 40 mm and four screw holes for securing the general mounting bracket, and then use screws to secure the general mounting bracket on this panel.

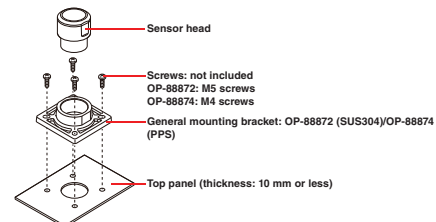

■ Mounting directly on a top panel (screwing in the device)

- 1 Drill a G3/4 screw hole in the top panel.
- 2 Fit a gasket* on the mounting screw of the sensor head, and then screw this device into the top panel.

Recommended tightening torque: 30 N·m for the FR-S01 and 4 N·m for the FR-SH01

* A gasket is not required if you are not sealing the parts hermetically.

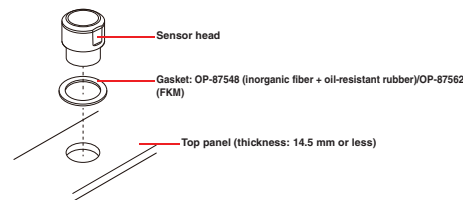

■ Mounting on an inner wall

- 1 Mount a side mounting bracket on a wall with M6 screws.

Recommended tightening torque: XX N·m

- 2 Insert the mounting screw of the sensor or sensor head into the round slot of the side mounting bracket, and then attach a nut from the bottom of the bracket.

Recommended tightening torque: 30 N·m for the FR-S01 and 4 N·m for the FR-SH01

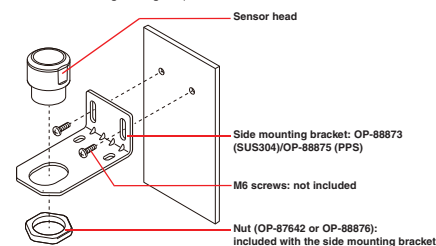

■ Clamping to the tank wall

- 1 Assemble the clamp mounting bracket according to the instruction manual included with this bracket.
- 2 Attach the clamp of the mounting bracket to the tank wall, and then turn the screw to tighten the clamp.

- 3 Insert the mounting screw of the sensor head into the hole of the clamp mounting bracket, and then attach a nut from the bottom of the bracket.

Recommended tightening torque: 30 N·m for the FR-S01 and 4 N·m for the FR-SH01

- 4 Loosen the hexagon socket head cap screw (width between two surfaces: 4 mm) on the adjuster to rotate the bracket. Tighten this screw again after adjusting the bracket to the desired angle.

Recommended tightening torque: 3.5 N·m

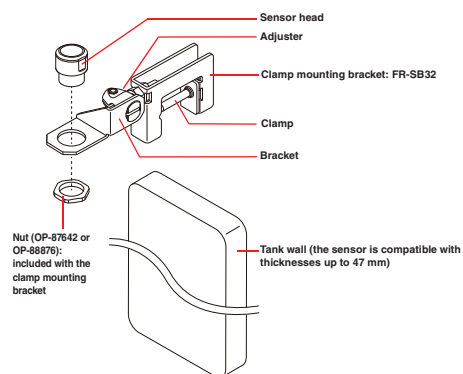

■ Offset mounting

- 1 Drill a hole with a diameter of 50 mm and four M6 screw holes in the top panel.
- 2 Mount an offset mounting bracket to the top panel of the tank with M6 screws.

- 3 Mount the sensor head on the offset mounting bracket.

Recommended tightening torque: 30 N·m for the FR-S01 and 4 N·m for the FR-SH01

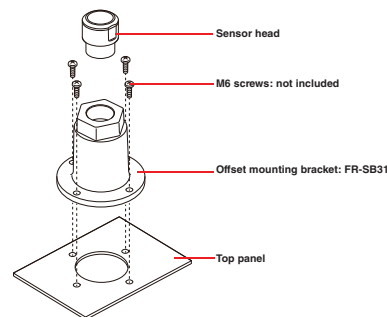

NOTICE If the liquid surface or bubbles reach the undetectable area, you can stabilize detection by mounting the offset mounting bracket at a distance from the liquid surface or bubbles.

■ Adjustable mounting

- 1 Mount the threaded bolt of an adjustable mounting bracket on the inner wall of a tank or similar object.

Recommended tightening torque: 24.5 N·m

- 2 Insert the mounting screw of the sensor head into the hole of the adjustable mounting bracket, and then attach a nut from the bottom of the bracket.

Recommended tightening torque: 30 N·m for the FR-S01 and 4 N·m for the FR-SH01

- 3 Loosen the hexagon socket head cap screw (width between two surfaces: 4 mm) on the adjuster to rotate the bracket. Tighten this screw again after adjusting the bracket to the desired angle.

Recommended tightening torque: 3.5 N·m

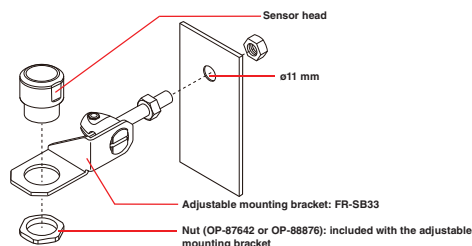

■ Mounting on a ferrule (ferrule mounting bracket)

- 1 Mount a gasket on the ferrule mounting bracket, and then mount this bracket on the sensor head.
- 2 Mount the ferrule gasket on the ferrule.

- 3 Use a clamp to mount the sensor on the ferrule.

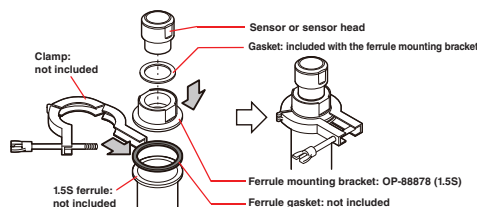

■ Mounting where space is limited

- 1 Align the cable with one of the two grooves, and then fit the sensor head into the compact mounting bracket.

- 2 Mount the compact mounting bracket on the pipe, etc. with two cable ties. This mounting bracket can also be mounted on a wall with two M3 screws. When wall-mounting this bracket, tighten its top with a cable tie.

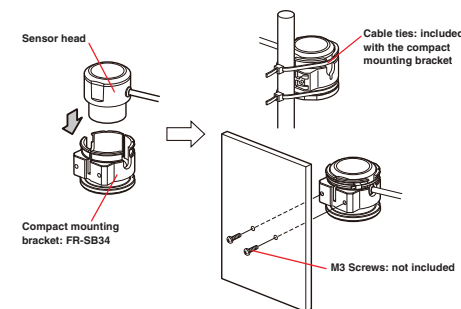

The FR Series beam widens as follows. Ensure there are no metal obstacles in the following range.

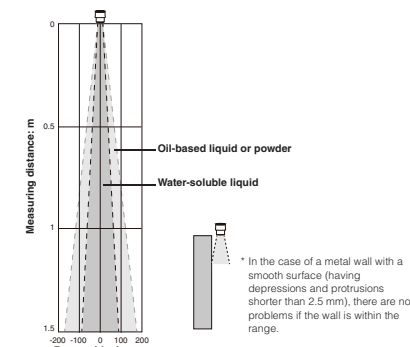

Detection may be unstable at close distances.

It is recommended to install the sensor so that its reference surface is, at a minimum, at the following distances from the highest expected liquid level.

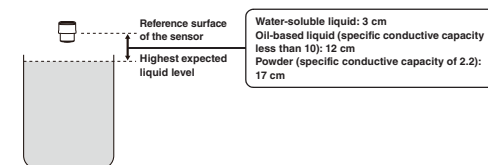

Mounting the amplifier unit and display

● Mounting on a DIN rail

- 1 Align the claw at the bottom of the main unit with the DIN rail, as shown in the figure. While pushing the main unit in the direction of arrow (1), push down in the direction of arrow (2).

- 2 To remove the sensor, raise the main unit in the direction of arrow (3) while pushing the main unit in the direction of arrow (1).

● Mounting on a wall (FR-SA1(C))

- 1 Attach the main unit to the optional mounting bracket (OP-88245), and then insert M3 screws into the two locations shown in the figure to secure the main unit in place.

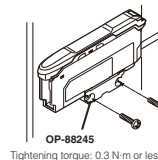

● Connecting multiple amplifiers

Expansion units (FR-SA2) can be connected to one FR-SA1 main unit. For the number of expansion units that can be connected, see the specifications.

CAUTION

When connecting to multiple amplifiers or when mounting main units together, mount the units on a DIN rail installed on a metal surface.

NOTICE

- Be sure to turn the power off before connecting multiple expansion units.
- Do not touch the expansion connector.

- 1
- Remove the expansion protection covers from the main unit and expansion unit(s).
- 2
- Install the amplifiers on the DIN rail one at a time.
- 3
- Slide the main unit and expansion unit(s) together. Mate the two claws of the expansion unit with the recesses on the main unit side until a click is heard/felt.
- 4
- Attach the end units (OP-26751) to the DIN rail on both sides of the amplifiers in the same way as step (2).
- 5
- Secure the amplifiers between the end units. Tighten the screws from the top (two screws x two units) with a Phillips screwdriver to fix the end units in place.

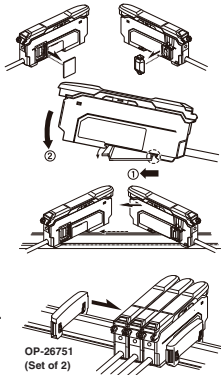

● Connecting the head and amplifier

With the power off, insert the head connector into the amplifier.

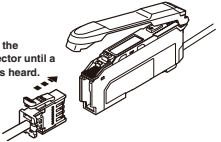

● When cutting the cables to shorten them, connect the connector as follows.

- 1
- Hold the connector with its back (the side where the core wires are visible) in front, move the claw at the top in the direction indicated by (1) to unlock it, and then open the back in the direction indicated by (2).
- 2
- Cut the cables to the appropriate length, and then process the cable connectors as shown in the figure on the right.
 - Remove at least 20 mm of the covering from the end of each cable.
- 3
- Insert each core wire to the back of the connector whose sticker color matches that of the wire.

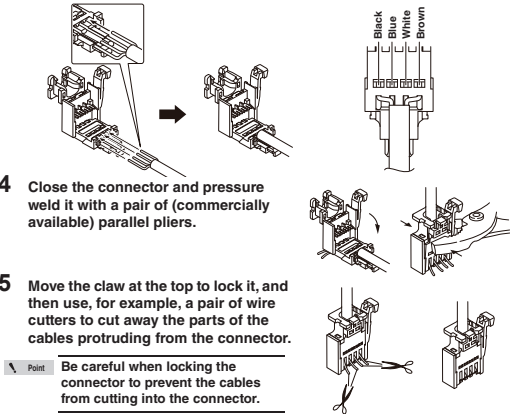

NOTICE

The maximum number of reconnections for the connector is 10. If you exceed this number, use the OP-88921 replacement connector (sold separately).

Wiring

■ Pin layout

● Cable type (FR-SA1/SA2)

Wire color	Description
White*	Analog output
Brown*	Power supply (24 VDC)
Green	OUT3
Yellow	OUT4
Gray	OUT1
Pink	OUT2
Blue*	0 V
Red	OUT5/IN

* FR-SA1 only

● M8 connector type (FR-SA1C)



Pin #	Color	Description
1	Brown	Power supply (24 VDC)
2	White	OUT2/IN/analog output
3	Blue	0 V
4	Black	OUT1*

* IO-Link-compatible wire when connecting an IO-Link device

Independently insulate any unused input/output wires.

Load (input device)

Analog current input device

(1) Control output wiring

● NPN

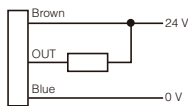

● PNP

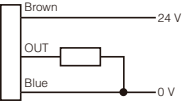

(2) External input wiring

● NPN

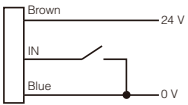

● PNP

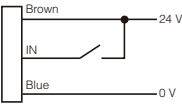

(3) Analog output wiring

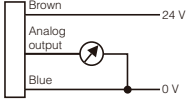

* It is possible to switch between 4-20 mA and 0-20 mA using settings.

Connecting the Power Cable (FR-SA1C)

1 Plug the power cable into the power cable connector.

NOTICE

When connecting the connector, plug it in straight and fix it firmly. If the tightening is not sufficient, the connector may loosen, which may lead to contact failures.

Initial Setting at First Startup

- When the sensor is turned on for the first time, configure the following initial settings.
- Select parameters with the < and > keys and use the MODE key to confirm entries.
 - After you confirm all the parameters on one screen, you will move to the next one.
 - To return to the previous item screen, press the < key.

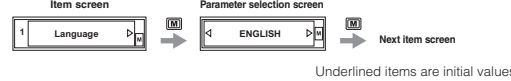

Language	ENGLISH, 日本語, 中文, DEUTSCH
PNP/NPN	PNP, NPN
Number of control outputs	0, 1, 2, 3, 4, 5
External input	OFF, ON
Analog Output	OFF, ON
Detection target	Water-soluble liquid, Oil-based liquid, Powder
Distance unit	mm, m
Distance to bottom	0 to 2000 mm ^{*1}
Distance to top surface	0 to 2000 mm ^{*1}
Set value 1 ^{*2}	0 to 99999
Output logic 1 ^{*2}	N.O., N.C.
Indicator pattern ^{*3}	Pattern 1, Pattern 2, Pattern 3, Only green, Always Off

- ^{*1} The unit and decimal point position vary depending on the "Distance unit" setting.
^{*2} Numbers 1 to 5 are displayed depending on the value selected with Number of control outputs. Nothing is displayed if "0" is selected with Number of control outputs.
^{*3} The selectable number of patterns varies depending on the set judgment output count.

● Number of control outputs

- At most, there are five outputs, one external input, and one analog output.
- Set the number of control outputs to use.
The set number of control outputs are assigned in order from OUT1. You can only use up to four control outputs when you select [ON] for "External input." (This restriction does not apply to the FR-SA1C.)
 - Other functions can be assigned to outputs to which control outputs are not assigned.
For details on these functions, see the user's manual.
 - Each control output can also be changed during area mode.
For details on area mode, see the user's manual.

FR-SA1/SA2

Color	Name	Control output	Auxiliary output			External input	Analog output
			Error	Stability alarm	Period change	Reset period change	
Gray	OUT1	✓	✓	✓	✓	-	-
Pink	OUT2	✓	✓	✓	✓	-	-
Green	OUT3	✓	✓	✓	✓	-	-
Yellow	OUT4	✓	✓	✓	✓	-	-
Red	OUT5/IN	✓	✓	✓	✓	✓	-
White	Analog output	-	-	-	-	-	✓

FR-SA1C

Pin #	Color	Name	Control output	Auxiliary output			External input	Analog output	IO-Link
				Error	Stability alarm	Period change	Reset period change		
4	Black	OUT1	✓	✓	✓	✓	-	-	*
1	White	OUT2/IN/ Analog output	✓	✓	✓	✓	✓	✓	-

* During IO-Link communication, this cannot be used as output, but the OUT1 function can be used.

● Detection target

Select [Water-soluble liquid] if the specific conductive capacity of the measurement target is 10 or higher, [Oil-based liquid] if the specific conductive capacity of the target is less than 10, and [Powder] if the target is a powder. If you select [Oil-based liquid], the area from the base to 10% of the height of the tank on the side far from the sensor is masked. For details, see the user's manual.

Point

Selecting an incorrect detection target may prevent accurate detection of the liquid surface.

● Distance to bottom

Enter the distance from the reference surface of the sensor to the bottom of the tank. For the position of the reference surface of the sensor when using a mounting bracket, see the dimensions provided in, for example, the catalog. The height of the liquid surface from the bottom of the tank is displayed as the current value with the position indicated by this distance used as the zero point (0%).

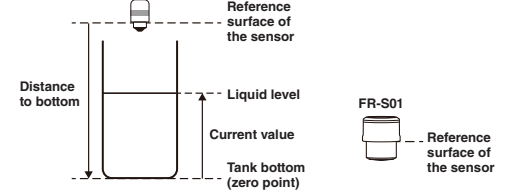

● Distance to top surface

Enter the distance from the reference surface of the sensor to the top surface of the tank. This position is 100% in the % display.

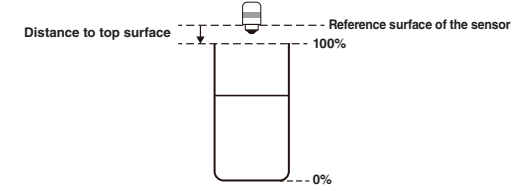

● Output logic 1

N.O.: Control output turns on when the current value exceeds one of the set values. N.C.: Control output turns on when the current value drops below one of the set values.

● Indicator pattern

You can select the lighting pattern of the sensor head ring indicator and the amplifier unit indicator according to the liquid surface position.

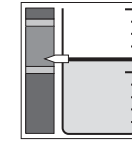

The number of selectable indicator patterns varies depending on the Number of control outputs setting. Select the indicator pattern from those shown below. To use a different pattern, select Custom. For details on how to set custom patterns, see the user's manual.

Number of control outputs	Pattern 1	Pattern 2	Pattern 3	Only green	Always Off
0				Green	
1	Red Green	Green Red		Green Green	
2	Red Yellow Green	Green Yellow Red	Red Green Red	Green Green Green	
3	Red Yellow Green Red	Red Green Yellow Red	Red Green Green Green	Green Green Green Green	
4	Red Yellow Green Yellow Red	Red Green Green Green Red		Green Green Green Green Green	
5	Red Yellow Green Yellow Red	Red Green Green Green Red		Green Green Green Green Green	

Basic Operation

■ Current value screen

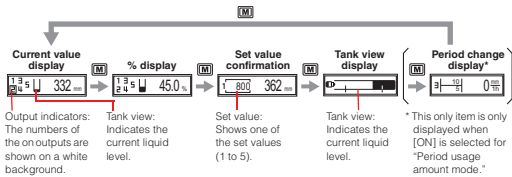

■ Changing set values

Hold down the MODE key on the current value screen to display the menu screen, and then change the set value from "1. Change set value."

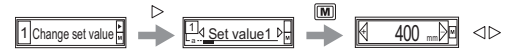

■ Key lock

This function prevents operation mistakes by locking/disabling key operations. This is effective in preventing the settings from being changed easily.

To require a password when canceling the key lock, set "Key lock method" to "With password."

Enabling/disabling the key lock:

Hold down the MODE key and the < key or > key for 3 seconds or more.

When "Key lock method" is set to "With password," the password is required when unlocking the keys.

Reference If the password entered is incorrect, an error will occur, and the normal screen will appear with the key lock still enabled.

■ Initializing settings

On the current value screen, hold down the MODE key and press the < key five times to initialize all settings.

Maintenance

- Clean deposits and foreign substances on the mounting bracket and the bottom of the sensor head as necessary.

Specifications

Item		Built-in display		Separated display	
		SUS304		PPS	
		FR-S01		FR-SH01(C)	
Measurement range ^{*1}		0 to 1500 mm 0.00 to 4.9 ft			
Displayable range ^{*1}		0 to 2000 mm 0.00 to 6.6 ft			
Specific conductive capacity of measurable media ^{*2}		2 or more			
Resolution		1 mm			
Accuracy ^{*3}		0 to 0.3 m: ±5 mm 0.3 to 1.5 m: ±1 mm			
Judgment output response time		0.4 s, 1.5 s, 4 s (default), 10 s			
Tank pressure		-0.1 to 1 MPa		-0.1 to 0.1 MPa	
Material	Inside the tank	Lens: PTFE Internal packing: FKM entering part: SUS304		Lens: PTFE Internal packing: FKM entering part: PPS	
	Case	PPS PBT PAR		PPS PPSU	
Connection port		G3/4 (20A)		G3/4 (20A)	
Environmental resistance	Ambient temperature	-20 to +55°C (no freezing) ^{*4, *5}		-20 to 70°C (no freezing) ^{*4, *5}	
	Ambient humidity	Up to 85%RH (no condensation)			
	Operating coupling temperature	-20 to +85°C (no freezing) ^{*4, *5}		-10 to +85°C (no freezing) ^{*4, *5}	
	Vibration resistance	10 to 500 Hz; Power spectral density: 0.816 G ² /Hz; X, Y and Z directions			
	Shock resistance	100 m/s ² (approx. 10 G), 16 ms pulses, 1000 times each for X, Y and Z axes			
Enclosure rating		IP67 (IEC60529)			
Protection circuit		Protection against reverse power connection, output overcurrent, output surge, and reverse output connection			

^{*1} Value guaranteed with water and the recommended mounting method. With water and the recommended mounting method, measurement is possible right up to the lens surface. An undetectable area on the near side occurs due to the relationship between the environment and the measurement medium. Additionally, the maximum measuring distance decreases.

^{*2} The target shape or the environment may make measurement impossible.

^{*3} This value is guaranteed by KEYENCE inspection facilities. Errors may occur due to your environment.

^{*4} The operating temperature range for each model is as follows.

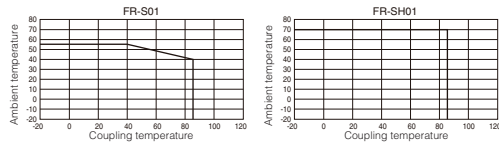

On the FR-S01, selecting [Turns off when no op.] for "Screen brightness" can alleviate the ambient temperature regulation by 10°C.

^{*5} When performing SIP with the FR-S01, turn the power supply off, and then perform this operation for 1 hour or less with an ambient temperature of 40°C or less and an internal system temperature of 130°C. Also, be sure to attach a ferrule mounting bracket and an internal gasket, which are optional KEYENCE products.

Item		Amplifier unit		
		FR-SA1	FR-SA2	FR-SA1C
Cable/connector		Cable	Cable	M8 connector
Main unit/expansion unit		Main unit	Extension unit	Main unit
Output	Number of control outputs	Max. 5		Max. 2
	Judgment output/ alarm output	NPN/PNP open collector (switchable), 30 VDC max., 50 mA max. for each output, with FR-S01 connected: 500 mA total for all amplifiers with system expanded to 5 or more expansion units, ^{*1} with FR-SH01(C) connected: 750 mA total for all amplifiers with system expanded to 5 or more expansion units, ^{*2} residual voltage: 1.4 V max. (50 mA max.), N.O./N.C. switchable, IO5 also used for external input		NPN/PNP open collector (switchable), 30 VDC max., 50 mA max. for each output, residual voltage: 1.4 V max. (50 mA max.), N.O./N.C. switchable, IO1 also used for IO-Link, IO2 also used for analog output/external input
	Analog output	0 to 20 mA/4 to 20 mA, maximum load resistance: 260 Ω (Response time: 0.2 s after comparator output determined [90% response])	-	0 to 20 mA/4 to 20 mA, maximum load resistance: 260 Ω (Response time: 0.2 s after comparator output determined [90% response])
External input		Short circuit current: max. 1.5 mA, input time: min. 500 ms		
External communication		-		IO-Link v1.1/COM2
Analog output accuracy ^{*4}	Resolution	1 mm	-	1 mm
	Zero accuracy	±0.1 mA (zero = 4 mA)	-	±0.1 mA (zero = 4 mA)
	Full scale accuracy	±0.2 mA (F.S. = 20 mA)	-	±0.2 mA (F.S. = 20 mA)
Expansion		With the FR-S01 connected: up to 8 units (9 units total including main unit) ^{*1} With the FR-SH01(C) connected: up to 12 units (13 units total including main unit) ^{*2, 3}		-
Protection circuit		Protection against reverse power connection, output overcurrent, output surge, and reverse output connection		
Power voltage		24 VDC+25%/-20% including ripple, Class 2/LPS ^{*5}		
Power consumption (excluding the load current)		With the FR-S01 connected: 1900 mW max. (72 mA max. at 24 V) With the FR-SH01(C) connected: 1500 mW max. (56 mA max. at 24 V)	With the FR-S01 connected: 1670 mW max. (60 mA max. at 24 V) With the FR-SH01(C) connected: 1280 mW max. (48 mA max. at 24 V)	1830 mW max. (63 mA max. at 24 V)
Environmental resistance	Ambient temperature	-20°C to +55°C (no freezing) ^{*6}		
	Ambient humidity	Up to 85%RH (no condensation)		
Material		PC		

^{*1} When expanding the system by 5 or more expansion units, use a power supply of 21.6 V or higher. You can increase the number of expansion units possible in the system by lowering the analog output current to 400 mA or less. For details, contact KEYENCE.

^{*2} You can increase the number of expansion units possible in the system by lowering the analog output current to 750 mA or less. For details, contact KEYENCE.

^{*3} When expanding the system by 10 or more expansion units, use a power voltage of 20 V or higher.

^{*4} This value is guaranteed when the load resistance is 250 Ω.

^{*5} When expanding the system to include 12 or more FR-S01 units, use a power voltage of 24 V or higher.

^{*6} When expanding the system by 1 expansion unit, ensure the ambient temperature is 50°C or less. When expanding the system by 2 or more expansion units, ensure the ambient temperature is 45°C or less.

WARRANTIES AND DISCLAIMERS

(1) KEYENCE warrants the Products to be free of defects in materials and workmanship for a period of one (1) year from the date of shipment. If any models or samples were shown to Buyer, such models or samples were used merely to illustrate the general type and quality of the Products and not to represent that the Products would necessarily conform to said models or samples. Any Products found to be defective must be shipped to KEYENCE with all shipping costs paid by Buyer or offered to KEYENCE for inspection and examination. Upon examination by KEYENCE, KEYENCE, at its sole option, will refund the purchase price of, or repair or replace at no charge any Products found to be defective. This warranty does not apply to any defects resulting from any action of Buyer, including but not limited to improper installation, improper interfacing, improper repair, unauthorized modification, misapplication and mishandling, such as exposure to excessive current, heat, coldness, moisture, vibration or outdoors air. Components which wear are not warranted.

(2) KEYENCE is pleased to offer suggestions on the use of its various Products. They are only suggestions, and it is Buyer's responsibility to ascertain the fitness of the Products for Buyer's intended use. KEYENCE will not be responsible for any damages that may result from the use of the Products.

(3) The Products and any samples ("Products/Samples") supplied to Buyer are not to be used internally in humans, for human transportation, as safety devices or fail-safe systems, unless their written specifications state otherwise. Should any Products/Samples be used in such a manner or misused in any way, KEYENCE assumes no responsibility, and additionally Buyer will indemnify KEYENCE and hold KEYENCE harmless from any liability or damage whatsoever arising out of any misuse of the Products/Samples.

(4) OTHER THAN AS STATED HEREIN, THE PRODUCTS/SAMPLES ARE PROVIDED WITH NO OTHER WARRANTIES WHATSOEVER. ALL EXPRESS, IMPLIED, AND STATUTORY WARRANTIES, INCLUDING, WITHOUT LIMITATION, THE WARRANTIES OF MERCHANTABILITY, FITNESS FOR A PARTICULAR PURPOSE, AND NON-INFRINGEMENT OF PROPRIETARY RIGHTS, ARE EXPRESSLY DISCLAIMED.

IN NO EVENT SHALL KEYENCE AND ITS AFFILIATED ENTITIES BE LIABLE TO ANY PERSON OR ENTITY FOR ANY DIRECT, INDIRECT, INCIDENTAL, PUNITIVE, SPECIAL OR CONSEQUENTIAL DAMAGES (INCLUDING, WITHOUT LIMITATION, ANY DAMAGES RESULTING FROM LOSS OF USE, BUSINESS INTERRUPTION, LOSS OF INFORMATION, LOSS OR INACCURACY OF DATA, LOSS OF PROFITS, LOSS OF SAVINGS, THE COST OF PROCUREMENT OF SUBSTITUTED GOODS, SERVICES OR TECHNOLOGIES, OR FOR ANY MATTER ARISING OUT OF OR IN CONNECTION WITH THE USE OR INABILITY TO USE THE PRODUCTS, EVEN IF KEYENCE OR ONE OF ITS AFFILIATED

ENTITIES WAS ADVISED OF A POSSIBLE THIRD PARTY'S CLAIM FOR DAMAGES OR ANY OTHER CLAIM AGAINST BUYER. In some jurisdictions, some of the foregoing warranty disclaimers or damage limitations may not apply.

BUYER'S TRANSFER OBLIGATIONS:

If the Products/Samples purchased by Buyer are to be resold or delivered to a third party, Buyer must provide such third party with a copy of this document, all specifications, manuals, catalogs, leaflets and written information provided to Buyer pertaining to the Products/Samples.

E 1101-3

KEYENCE CORPORATION

1-3-14, Higashi-Nakajima, Higashi-Yodogawa-ku,

Osaka, 533-8555, Japan

PHONE: +81-6-6379-2211

www.keyence.com/glb

AUSTRIA +43 (0)2236 378266 0	HONG KONG +852-3104-1010	NETHERLANDS +31 (0)40 206 6100	TAIWAN +886-2-2721-1080
BELGIUM +32 (0)15 281 222	HUNGARY +36 1 802 7360	PHILIPPINES +63-(0)2-8981-5000	THAILAND +66-2-078-1090
BRAZIL +55-11-3045-4011	INDIA +91-44-4963-0900	POLAND +48 71 368 61 60	UK & IRELAND +44 (0)1908-696-900
CANADA +1-905-366-7655	INDONESIA +62-21-2966-0120	ROMANIA +40 (0)269 232 808	USA +1-201-930-0100
CHINA +86-21-3357-1001	ITALY +39-02-6688220	SINGAPORE +65-6392-1011	VIETNAM +84-24-3772-5555
CZECH REPUBLIC +420 220 184 700	KOREA +82-31-789-4300	SLOVAKIA +421 (0)2 5939 6461	
FRANCE +33 1 56 37 78 00	MALAYSIA +60-3-7883-2211	SLOVENIA +386 (0)1 4701 666	
GERMANY +49-6102-3656-0	MEXICO +52-55-8850-0100	SWITZERLAND +41 (0)43 455 77 30	

Specifications are subject to change without notice.

A45WW1-MAN-2033

Copyright (c) 2023KEYENCE CORPORATION. All rights reserved.

xxxxxGB 2093-1 [xxxxxx] Printed in Japan