

HP990

2.4GHz Digital Wireless Headphone



User's Manual

Please read before using the equipment

INTRODUCTION

This 2.4GHz Digital Wireless Headphone uses latest digital wireless technology that enables you to enjoy music and TV sound anywhere inside your home. Simply connect the transmitter to a desired audio source: DVD player, CD player, TV set, VCR or Hi-Fi system. Without complicated wiring and installation with your Audio/Video equipments and rear channel amplifier, the system enables you to enjoy thrilling, lifelike sound in minutes.

FEATURES

1. Purely 2.4GHz Digital UHF Technology.
2. 38 Channel Auto Frequency Searching System.
3. Smart Volume Memory Built-in.
4. Electronic Volume Control.
5. Low Power Indicator Alert.
6. High Power 3 x NiMh Batteries
7. Auto Pin Charging Mechanism.
8. Auto On/Off.
9. Auto Shut Off.
10. Muting.
11. Speed charging mechanism.

COMPONENT PART LIST

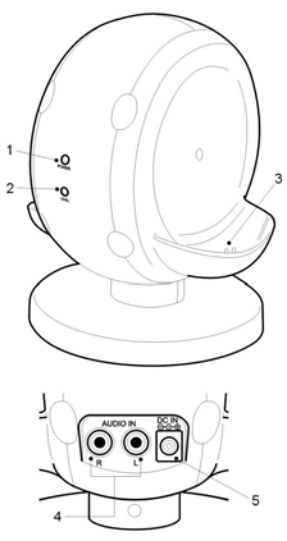
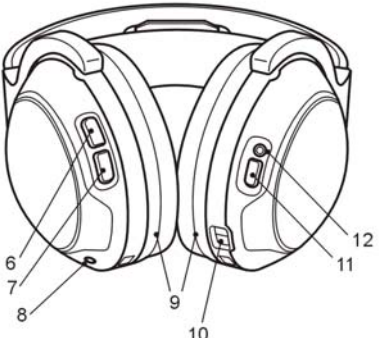
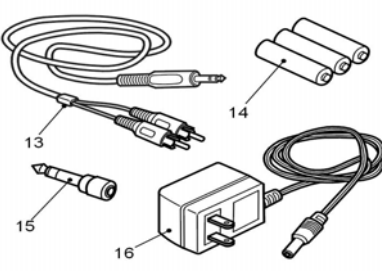
<p>A) TRANSMITTER</p> 	<p>1. Power / Signal indicator.</p> <p>2. Charging indicator.</p> <p>3. Charging pins.</p> <p>4. Audio IN socket.</p> <p>5. DC IN socket.</p>
<p>B) HEADPHONE RECEIVER</p> 	<p>6. Volume Up Control.</p> <p>7. Volume Down Control.</p> <p>8. Volume & Signal LED indicator.</p> <p>9. Battery compartments.</p> <p>10. Charging contacts.</p> <p>11. ON/OFF Control.</p> <p>12. Power LED indicator.</p>
<p>C. ACCESSORIES</p> 	<p>13. RCA cable.</p> <p>14. NiMh batteries for Headphone (3 pieces).</p> <p>15. 3.5mm to 6.3mm adapter plug.</p> <p>16. AC/DC adapter (1x 6V 300mA for transmitter).</p>

INSTALLATION

TRANSMITTER

1. Connect the supplied AC/DC power adapter to an electrical wall outlet.
2. Plug the AC/DC power adapter in the DC jack located on the rear of the transmitter.
3. The rear of the transmitter has one audio cord that can be connected to audio output jack of TV, VCR, Hi-Fi, CD/MP3/VCD/DVD players or to headphone/earphone jack with the connector provided.

Plug the adapter in the AC source and connect the audio plug to the audio source. The transmitter will automatically switch on and the red LED will light up when it receives an audio signal.

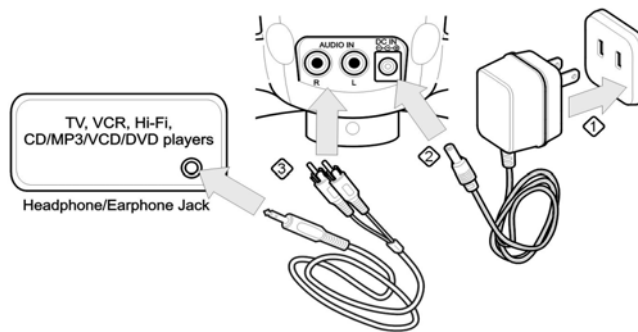

HEADPHONE RECEIVER

1. To install or replace the rechargeable batteries, carefully remove the leather padding around the left and right earphone plates out from the cabinets.
2. Insert 2pcs of AAA size rechargeable batteries (supplied in the package) into the right earphone's battery compartment and 1pc of AAA size rechargeable battery (supplied in the package) into the left earphone's battery compartment. Make sure the batteries are placed at the right polarity.
3. Cover the leather padding back after inserted the batteries.



OPERATION

Transmitter

1. Turn on the audio source (TV or audio component) to which the transmitter is connected with. The Signal / Power LED (Red) on the transmitter will light up when it receives the audio signal.

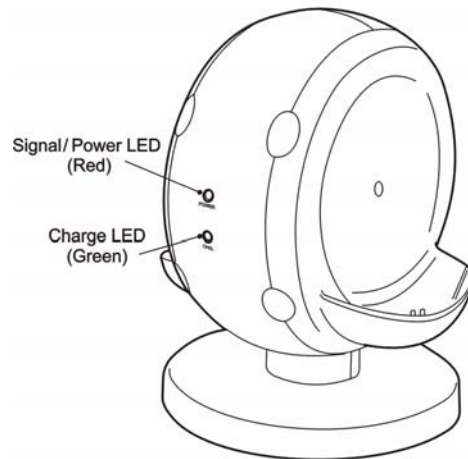

Headphone

1. Turn on the headphone by pressing the Power button. The POWER LED (Red) will light up, the green LED will be flashing until signal link between transmitter and receiver is established.

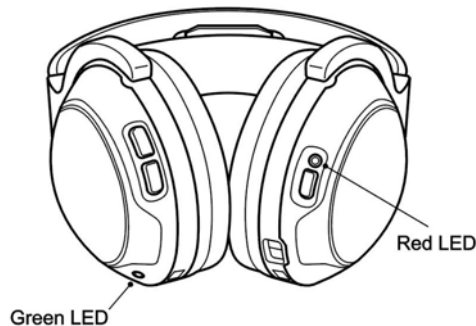

2. Gently place the headphone on your head and adjust for comfort. To obtain the desired sound level, you can adjust the volume control on the headphone. After you have adjusted the volume in the first time, the smart built-in volume memory will memorize your latest volume level automatically.
3. If interference or poor signal reception occurs, the headphone will perform the muting function automatically, and it will search the best channel out of the 38 channels available. The green LED will be flashing when it is searching for the best channel.

4. Charging the batteries

- a) Turn OFF the headphone first.
- b) Place the headphone on the transmitter charging cradle. The charging process begins automatically, and the green LED will light up when the charging contacts of transmitter and headphone are made successfully. When the charging process is completed, the green LED will turn off.

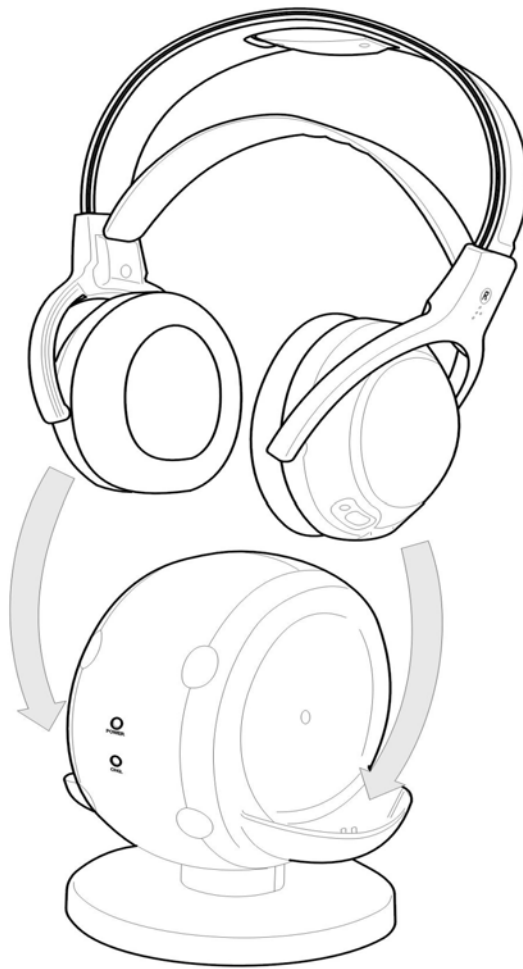

- c) With the smart speedy charging function, the headphone could be fully charged within 4-5 hours. If the headphone is not in use, please place it back to the transmitter charging cradle.

Important:

1. Switching Off
 - a) For protection of the transmitter and power saving, the transmitter will switch off automatically if there is no audio source signal for 3 minutes. If the audio source signal returns, the transmitter will automatically switch back on. Then, power on the headphone again.
 - b) The headphone will switch off automatically if there is no signal from the transmitter for 2 minutes.
2. Make sure the headphone is turned off when charging is in process.
3. Only use the included rechargeable AAA batteries. When the headphone is not in use, turn OFF the power to avoid damaging the batteries.
4. To ensure a long service life, fully charge the batteries before using the headphone for the first time. The initial charge takes 12 hours to complete. Ensure the charging socket located on the right earphone connects securely with the charge prongs on the transmitter cradle.

TROUBLE SHOOTING**NO SOUND**

- Ensure the AC/DC adapter is fully inserted into the AC outlet and the power connection input on the transmitter.
- Ensure the headphone is switch ON.
- Headphone battery charge level may be too low, recharge the batteries fully.
- Ensure the TV or the connected audio device is switched ON.
- The volume of headphone may be too low, adjust the volume to a moderate level.

DISTORTION

- Ensure the volume level of headphone is set to an approximate level.
- The headphone is too far from the transmitter, move it closer.
- The audio signal input level is too low. Increase the volume of the audio source.

TECHNICAL SPECIFICATIONS

Transmission Mode	:	UHF stereo
Carrier Frequency	:	2.4GHz Digital
Operation Voltage	:	Transmitter, DC 9V 400mA Headphone, 3 x AAA size Rechargeable NiMh batteries (included)
Frequency Response	:	30Hz – 24KHz
Distortion	:	0.4%
S/N Ratio	:	80dB
Operation Distance	:	Up to 200 feet

WARNING : Changes or modifications not expressly approved by the party responsible for compliance could void the user's authority to operate the equipment. Operation is subject to the following two conditions: (1) this device may not cause interference, and (2) this device must accept any interference, including interference that may cause undesired operation of the device.

This device must be used with the AC/DC adaptor supplied in the package.

The antenna(s) used for the device must not be co-located or operating in conjunction with any other antenna or transmitter."

The antenna(s) used for this transmitter must be installed to provide a separation distance of at least 20 cm from all persons and must not be co-located or operating in conjunction with any other antenna or transmitter