

USER'S MANUAL

7" TFT LCD HEADREST MONITOR

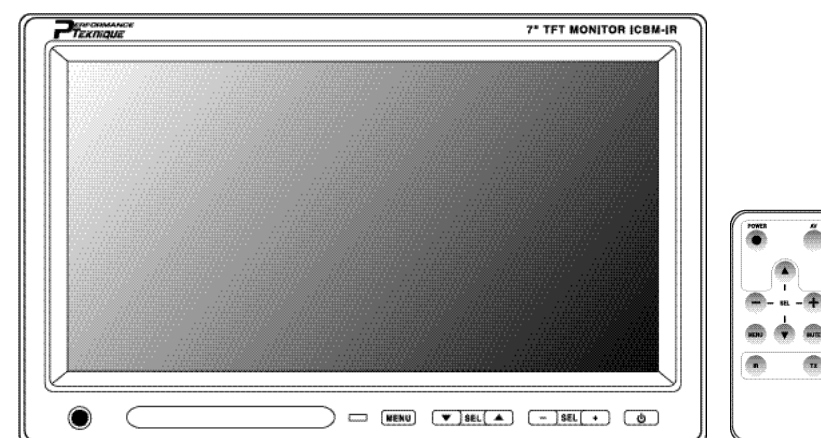

WARNING

Do not watch T.V. while vehicle is in motion, it can be hazardous.

OWNER'S RECORD

*The model and serial numbers are located on the back.
Record the serial numbers in the space provided below.*

Model No. : ICBM-IR
ICBM-HD REST

Serial No. :

FCC NOTICE

THIS DEVICE COMPLIES WITH PART 15 OF THE FCC RULES.
OPERATION IS SUBJECT TO THE FOLLOWING TWO CONDITION:
(1) THIS DEVICE MAY NOT CAUSE HARMFUL INTERFERENCE, AND
(2) THIS DEVICE MUST ACCEPT ANY INTERFERENCE RECEIVED,
INCLUDING INTERFERENCE THAT MAY CAUSE UNDERSIRED
OPERATION.

This equipment has been tested and found to comply with the limits for a Class B digital device, pursuant to part 15 of the FCC Rules. These limits are designed to provide reasonable protection against harmful interference in a residential installation.

This equipment generates, uses and can radiate radio frequency energy and, if not installed and used in accordance with the instructions, may cause harmful interference to radio communication. However, there is no guarantee that interference will not occur in a particular installation. If this equipment does cause harmful interference to radio or television reception, which can be determined by turning the equipment off and on, the user is encouraged to try to correct the interference by one or more of the following measures :

- Reorient or relocate the receiving antenna.
- Increase the separation between the equipment and receiver.
- Connect the equipment into an outlet on a circuit different from that to which the receiver is connected.
- Consult the dealer of an experienced radio/TV technician for help.

NOTE : The manufacturer is not responsible for any radio or TV interference caused by unauthorized modifications to this equipment. Such modifications could void the user's authority to operate the equipment.

CAUTION : Changes or modifications not expressly approved by the party responsible for compliance could void the user's authority to operate the equipment.

TABLE OF CONTENTS

1. TABLE OF CONTENTS 1

2. PRODUCT COMPOSITION 2

3. FEATURES 2

4. PRECAUTIONS FOR SAFETY 3

5. SYSTEM FUNCTIONS

 DISPLAY UNIT 4

 REMOTE CONTROL 4

6. BASIC OPERATION

 INPUT MODE CHOICE - 1 5

 INPUT MODE CHOICE - 2 5

 SCREEN ADJUSTMENTS 6

7. APPLICATION BEHAVIOUR

 TX : BUTTON TO SELECT FM FREQUENCY
 FOR USAGE OF BUILT-IN CAR AUDIO SYSTEM 7

 MUTE FUNCTION 7

 MENU BEHAVIOUR METHOD 8

 TO REPLACE THE BATTERY 8

8. SPECIFICATION 9

9. TROUBLE-SHOOTING GUIDE10

PRODUCT COMPOSITION

The components of this device are as follows.

• 7 inch 16:9 wide monitor	1ea
• HeadRest shroud	1ea
• Stand for Monitor	1ea
• Screw	6ea
• Remote Control(included battery)	1ea
• AV cable	1ea

FEATURES

- 7 INCH 16:9 WIDE SCREEN HEADREST MONITOR.
- MULTI-MODE AUDIO/VIDEO INPUT FACILITY(AV1/AV2).
- NTSC/PAL SWITCHABLE(AUTO SELECTION).
- BUILT-IN IR-TRANSMITTER FOR IR-WIRELESS HEADPHONE SYSTEM.
- FULL FUNCTION ON-SCREEN DISPLAY(O.S.D).
- BUILT-IN FM MODULATOR(FM-TX FOR AUDIO SIGNAL 88.1 ~ 89.6 MHz).
- INSTALLATION HEADREST, STAND & SCREWS SUPPLIED.
- POWER-IN & AV INPUT CONNECTOR SUPPLIED.
- MULTI FUNCTION REMOTE CONTROL.

PRECAUTIONS FOR SAFETY

- Make sure to read the "manual" for safety precautions before installing unit or accessories.
- Do not install unit in location where it may obstruct or cause injury to driver or passengers while driving under normal driving conditions.
- Do not install unit where it may be exposed to high temperatures, moisture, dust or any foreign matter which will damage unit and cause it to malfunction.
- Avoid direct sunray and keep away from heating apparatus. Packing outdoor for a longtime with exposure to the direct sunray during summertime, the temperature inside the car can rise over 50~60°C (114~140°F). Also when use indoor, please keep away from any heating apparatus such as electric heater or stove.
- Do not watch TV/Monitor while driving.
- Do not open the monitor. Opening or removing covers may expose you to dangerous shock hazards or the risks.
- Avoid dropping and hard impact.
- Do not spill any liquid into the cabinet or use your monitor near water.
- Do not Scratch or Press the surface of the LCD panel, it will cause a permanent damage. Use only soft cloth with non-ammonia glass cleaner to clean the panel.

SYSTEM FUNCTIONS

1. DISPLAY UNIT

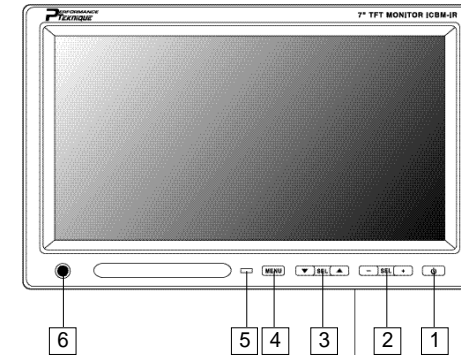

1. POWER ON/OFF
2. SELECTION MENU UP/DOWN
3. SELECTION UP/DOWN
4. MENU, MODE SELECTION
5. IR/REMOTE SENSOR
6. HEADPHONE JACK
7. VIDEO 1/2 INPUT
8. AUDIO (L) 1/2 INPUT
9. AUDIO (R) 1/2 INPUT
10. DC + 12V(RED) FUSE : 2A
11. GND (BLACK)

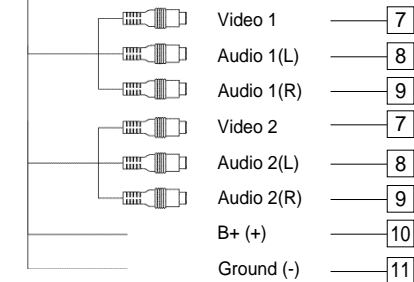

2. REMOTE CONTROL

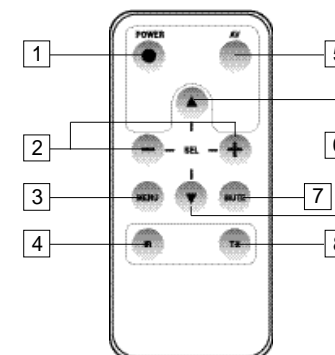

1. POWER ON/OFF
2. SELECTION MENU UP/DOWN
3. MENU, MODE SELECTION
4. IR ON/OFF
5. AV INPUT SELECTION
6. SELECTION UP/DOWN
7. MUTE
8. FM TX ON/OFF

BASIC OPERATION

1. INPUT MODE CHOICE - 1

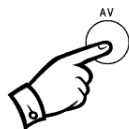

1. Press AV button on the remote control. On the upper left of the screen, following order will be displayed and received in sequence. Select the INPUT MODE of your choice.

AUX 1 AUX 2

2. INPUT MODE CHOICE - 2

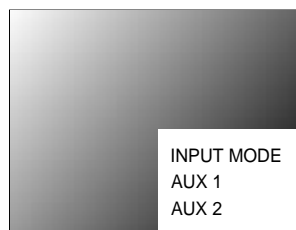
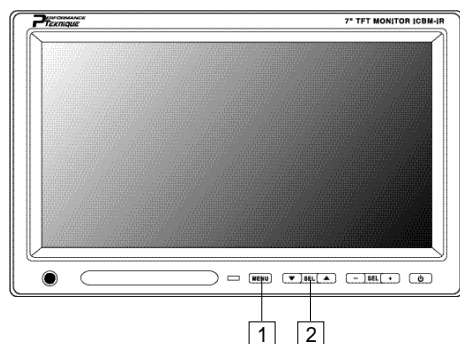

or

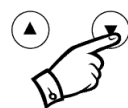
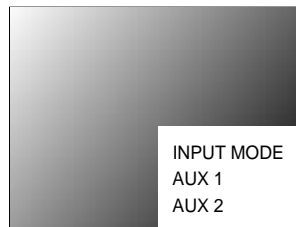

1. Press the "MENU" button or the "MENU" button of the remote control once. INPUT MODE will be displayed when you press of SEL button or button of the remote control twice.
2. Press of SEL button or + button of the remote control and choose the mode of your choice by pressing , of the SEL button or , button of the remote control. Then, press , of the SEL button or +, - button of the remote control to set the mode.

3. SCREEN ADJUSTMENTS

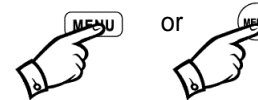
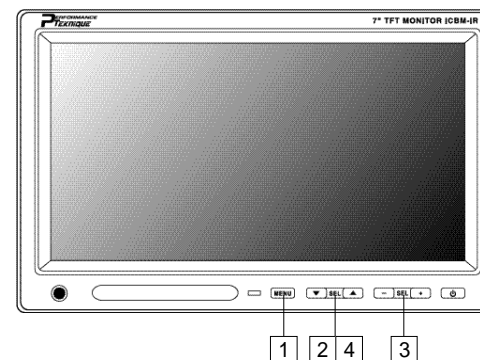

or

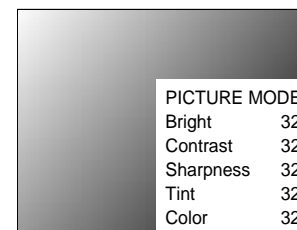
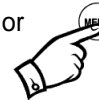

or



or

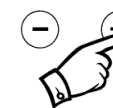

1. Press the "MENU" button once or press the "MENU" button of the remote control. PICTURE MODE will be displayed on the lower right side of the screen.
2. Press , of the SEL button or , button of the remote control to select the mode of your need.
3. Press of the SEL button or + button of the remote control to make adjustments of that mode and press of the SEL button or +, - button of the remote control to increase or decrease the value. To move to the next stage, press , of the SEL button or , button of the remote control and the location will be shifted.
4. If you press , of the SEL button or +, - button of the remote control in the PICTURE MODE, it will move in the sequence as shown below.

Bright

Contrast

Sharpness

Tint

Color

APPLICATION BEHAVIOUR

1. TX : BUTTON TO SELECT FM FREQUENCY FOR USAGE OF BUILT- IN CAR AUDIO SYSTEM

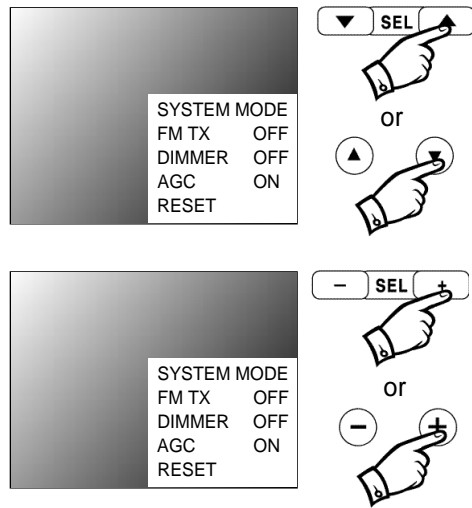
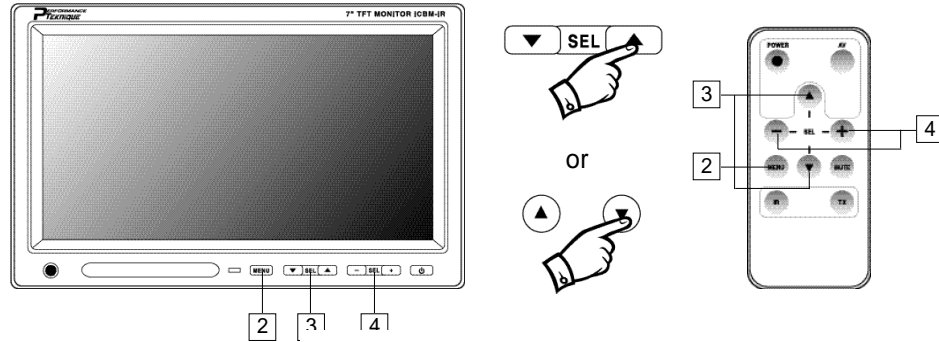

2. MUTE FUNCTION

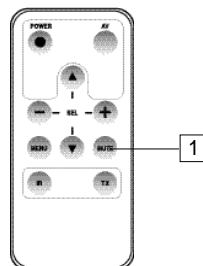

1. Put the Radio frequency to 88.1 MHz ~ 89.6 MHz where there is no signal.
2. Press the MENU button or the MENU button of the remote control once. SYSTEM MODE will be displayed on the lower right of the screen.
3. Press + of SEL button + button of the remote control to move to FM TX.
4. Press +, - of the SEL button or +, - button of the remote control to select the frequency equal to that of a F radio.
5. You can receive the sound of the TV through the radio.

1. Press the MUTE button of the remote control. All sounds will be intercepted.
2. Press the MUTE button again. The sounds will be recovered.

3. MENU BEHAVIOUR METHOD

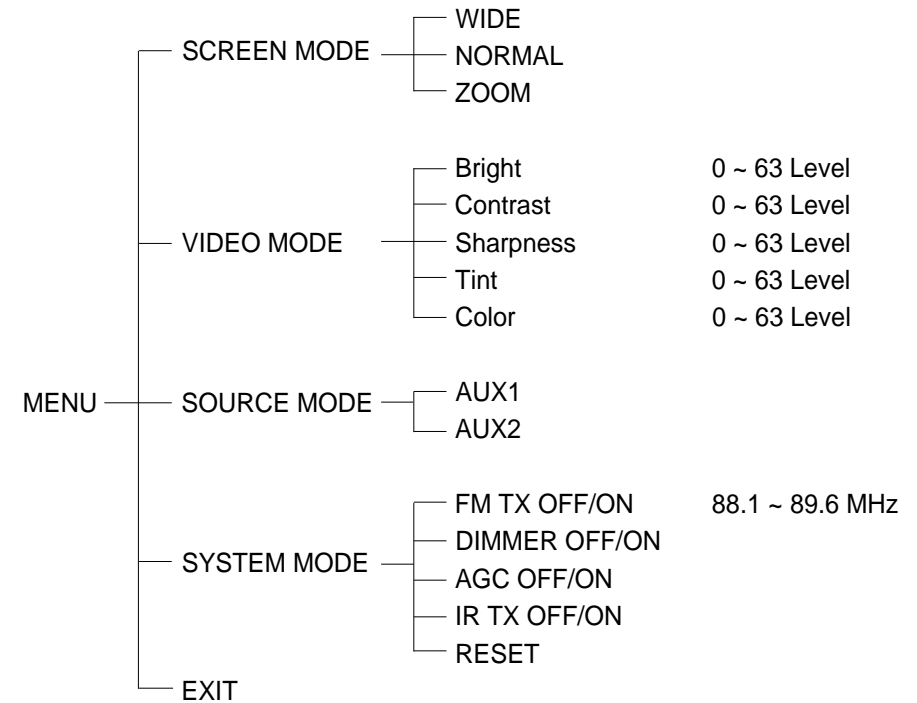

4. TO REPLACE THE BATTERY

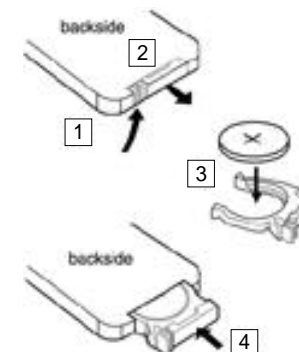

1. Please push the part marked in arrow to the right.
2. Push the battery case forward to open.
3. Put the battery in the case with positive pole facing the top as shown in the picture.
4. Push the battery case in the direction of the arrow.

SPECIFICATION

Power Source	DC 12V Fuse : 2A
Display Size	7 inch (18cm)
Active Area	152.4(H) X 91.44(V)mm
Display Pixels	800(H) X 480(V) Pixels
Number of Colors	262,144 colors
Contrast (CR)	200:1
Brightness	400 cd/m2
Viewing Angle	65/65(R/L), 45/60(U/D) Degrees
Power Consumption	8.0W
IR-TX Frequency	L : 2.3MHz, R : 2.8MHz
IR Range	1m ± 30°, 3m ± 15°
FM-TX Frequency	88.1 ~ 89.6MHz
Features	Video/Audio 2 input DC 12V input
Dimension (Main unit)	174(W) X 126(H) X 27(L)mm
Net Weight	470g
Standard Accessories	User's Manual, A/V cable, Screw Remote Control, Stand

TROUBLE-SHOOTING GUIDE

- No power
POSSIBLE CAUSES
 - Power connection is not properly connected Connect correctly
 - Fuse on power cable burn out Replace fuse
- Remote control unit doesn't work
POSSIBLE CAUSES
 - Batteries are missing, dead or incorrect polarity Replace batteries.
 - Remote control distance is too far The distance must be less than 5m.
 - Improper direction of remote control Point the remote control unit to the sensor directly.
- No picture and sound
POSSIBLE CAUSES
 - A/V source connection is wrong Check the A/V source power.
- Blurry picture and noise
POSSIBLE CAUSES
 - Interference from automobiles, electric appliances, Move further away from appliances causing interference.
- Sound heard but picture all white or dark
POSSIBLE CAUSES
 - Brightness control is not set correctly Adjust brightness.
- Sound heard but color light
POSSIBLE CAUSES
 - Color control is not set correctly Adjust color.
- Picture visible but no sound
POSSIBLE CAUSES
 - Earphone inserted Disconnect earphone.
- No color
POSSIBLE CAUSES
 - Incorrect setting of playback system Switch NTSC/PAL Switch to correct position of A/V sources.