

# Plow & Hearth®

# 52493

Product Name: Key Finder FCC ID: R62-LD2519

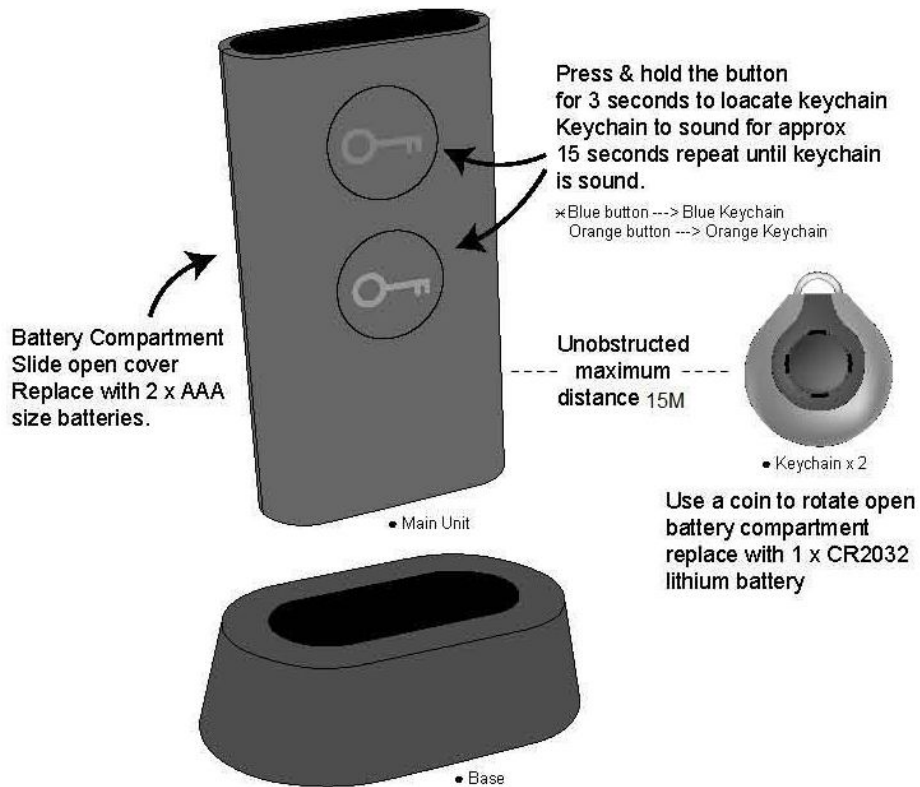

## Batteries safety warnings:

- Please read all instructions carefully before use.
- Install batteries correctly by matching the polarities(+/-).
- Always replace a complete set of batteries.
- Never mix used and new batteries.
- Remove exhausted batteries immediately.
- Remove batteries when not in use.
- Do not recharge and do not dispose of batteries in fire as the batteries may explode.
- Ensure batteries are stored away from metal objects as contact may cause a short circuit.
- Avoid exposing batteries to temperature or humidity extremes or direct sunlight.
- Keep all batteries out of reach from children. They are a choking hazard.
- Please retain packaging for future reference.

## Warnings

Do not subject the unit to excessive force, shock, dust, temperature or humidity.

Do not immerse the unit in water and avoid water splashing. This device is not water proof.

Do not remove any screws or try to fix the device.

Do not dispose this unit in a fire, IT MAY EXPLODE.

Keep unit away from small children. The unit or parts of the unit might be a choking hazard.

Dispose the unit legally.

Recycle when possible.

@2012 Made in China for plow & Hearth ®, Madison, Va. 22727 [plowandhearth.com](http://plowandhearth.com)

## FCC Statement

1. This device complies with part 15 of the FCC Rules Operation is subject to the following two conditions:

- (1) This device may not cause harmful interference, and
- (2) This device must accept any interference received, including interference that may cause undesired operation.

2. Changes or modifications not expressly approved by the party responsible for compliance could void the user's authority to operate the equipment.