

Buttons and ports labeled

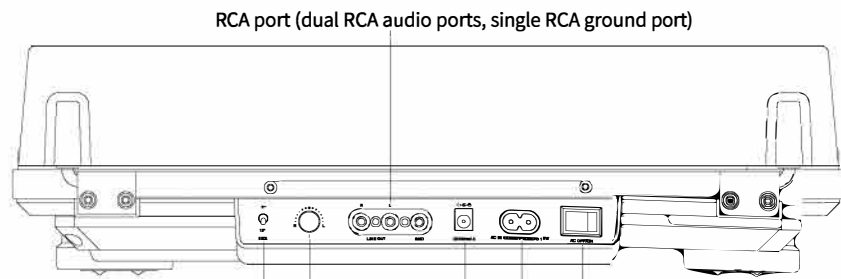

Power button  
Speed control button  
Bluetooth pairing button (Bluetooth version)/  
Light brightness adjusting button (Non-Bluetooth version)  
Start/Stop button  
Repeat button  
Tonearm up/down button



Tonearm size toggle switch  
12V DC power input  
AC power switch  
Balanced potentiometer  
AC power input (available for all voltages)

Power on/off

Hold the power button for 3 seconds to turn on the device while it is off; hold the power button for 3 seconds to turn it off while it is on.

Place/Remove a vinyl record

Open the top cover to place or remove the vinyl record, and then close the cover.

Power supply

When the AC power switch is turned on, the device needs a 220V AC power supply. When the AC power switch is turned off, the device needs a 12V DC power supply.

Operation explained

- **Power button:** Hold for 3 seconds to turn on the device while it is off; hold for 3 seconds to turn it off while it is on; short press to switch lighting effects.
- **Speed control button:** Short press to switch between 33RPM and 45RPM.
- **Bluetooth pairing button:** When pairing an unconnected device, hold for 3 seconds to enter the Bluetooth pairing mode. When the device is paired successfully, hold for 3 seconds to disconnect the pairing. For successfully paired Bluetooth devices, short press for reconnection.
- When there is no Bluetooth connection for an extended period, the Bluetooth module will automatically enter sleep mode.
- **Start/Stop button:** When not playing, short press to start playing; when playing, short press to stop playing.
- **Repeat button:** When repeat play is turned off, short press to enter the repeat play state. When the record is played to the end, the tonearm will automatically return to the beginning of the record and play from the beginning; short press again to exit the repeat play state.
- **Tonearm up/down button:** Short press to lift/put down the tonearm.
- **Tonearm size toggle switch:** Toggle to switch the tonearm size between 7 and 12 inches.
- **Balanced potentiometer:** Adjust the output balance of the left and right channels.
- **AC power switch:** Switch the power supply between DC and AC.

Lighting effect explained

- Short press the power button to switch between lighting effects in the following order: Blue - Cyan - Red - Purple - Yellow - White - Green. Powering on after powering off defaults to display in blue, and waking up from standby displays the last-indicated lighting effect (if you don't like the lighting effect, you can turn it off with the brightness button on the remote control).
  - When powering on or waking up from standby, the turntable light will rotate clockwise once and then remain constantly on. The light colors of the FIOO logo and turntable will match.
  - When powering off, the turntable light will rotate anticlockwise once and then turn off, and the logo light will go out.
- If the light color has been changed, the last selected color will be used.

- During playback, the turntable light will be constantly on, and the logo light will match it. Double-press the power button to switch the lighting effect to slow rotation at 33 RPM or fast rotation at 45 RPM.
- When stopped, both the turntable and logo lights will stay on in the same color.
- In standby mode, the light will turn off after an anticlockwise rotation.
- When connecting the TT13 to a new device through Bluetooth, the logo light will flash alternately in red and blue.
- During Bluetooth reconnection, the logo light will quickly flash in blue. When Bluetooth is reconnected successfully, the logo light will stop flashing.
- When connecting the TT13 via Bluetooth, the logo light will breathe in sync with the light color of the turntable.
- When the repeat mode is enabled, the logo light will display in purple as a priority.

Remote control explained

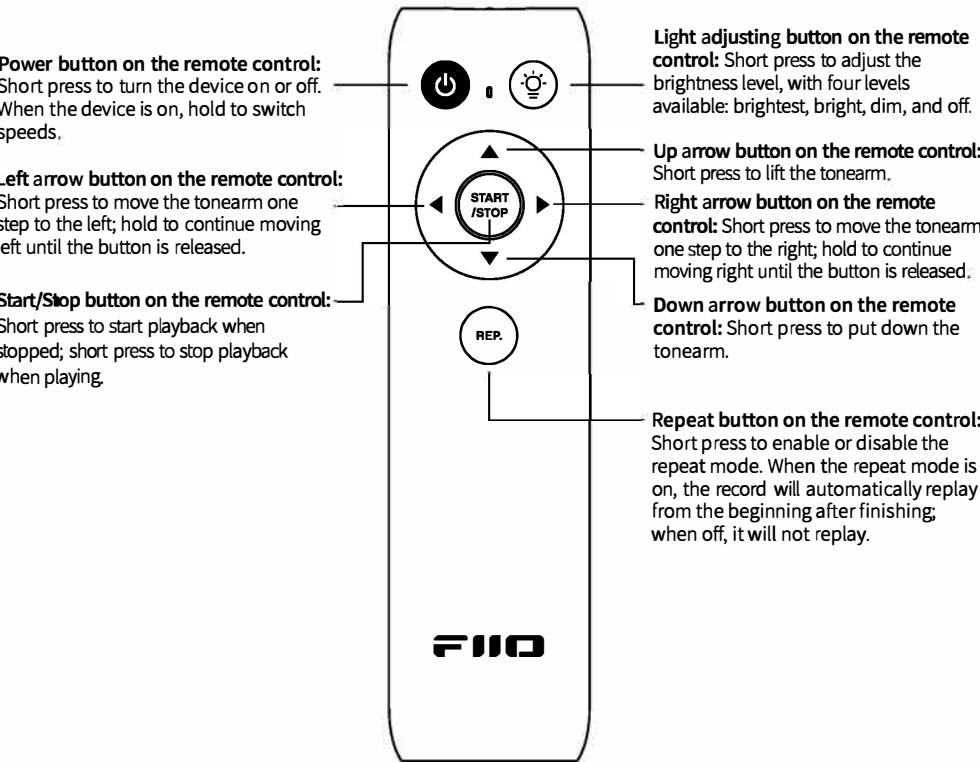

\*The remote control requires two AAA batteries.

Notes and precautions

- ★ It is recommended to use a suitable power adapter (DC 12V == 1A) in case of a high-voltage adapter causing damage to the device.
- ★ Please do not place the device in circumstances of excessive high/low temperatures (above 45°C or below 0°C).
- ★ Please keep the device away from liquids to avoid any damage to it.
- ★ Please adjust the volume to a suitable level before putting on headphones, so as to protect your hearing.

List of items included (please check if all the following items are included)

- F3491T unit
- Turntable platter
- Turntable mat
- AC power cable
- Remote control

- Coaxial cable
- Record deck
- Quick start guide
- Warranty card

To learn more

- For related video instructions of the device and FAQ (Frequently Asked Questions), please scan the QR code below.
- To learn more about the product, please visit our website: [www.fioo.com](http://www.fioo.com)

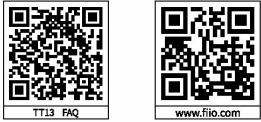

Due to continuous improvement, every specification and design is subject to change at anytime without further notice.

Hereby, Guangzhou FIO Electronics Technology Co., Ltd declares that this device is in compliance with Directive 2014/53/EU. The full text of the EU declaration of conformity is available at: [www.fioo.com/doc](http://www.fioo.com/doc)

Function	Frequency	Maximum output power
Bluetooth	2402-2480MHz	10dBm



WEEE Directive & Product Disposal

At the end of its serviceable life, this product should not be handed as household or general waste. It should be handed over to the applicable collection point for the recycling of electrical and electronic equipment, or returned to the supplier for disposal.

Qualcomm is a trademark of Qualcomm Incorporated, registered in the United States and other countries. aptX is a trademark of Qualcomm Technologies International, Ltd., registered in the United States and other countries.



\*Only the Bluetooth version applies to the terms of this page.

**FCC NOTICE:**  
This equipment has been tested and found to comply with the limits for a Class B digital device, pursuant to Part 15 of the FCC Rules. These limits are designed to provide reasonable protection against harmful interference in a residential installation. This equipment generates, uses and can radiate radio frequency energy and, if not installed and used in accordance with the instructions, may cause harmful interference to radio communications. However, there is no guarantee that interference will not occur in a particular installation. If this equipment does cause harmful interference to radio or television reception, which can be determined by turning the equipment off and on, the user is encouraged to try to correct the interference by one or more of the following measures:

- Reorient or relocate the receiving antenna.
- Increase the separation between the equipment and receiver.
- Connect the equipment into an outlet on a circuit different from that to which the receiver is connected.
- Consult the dealer or an experienced radio/TV technician for help.

The equipment complies with FCC radiation exposure limits set forth for an uncontrolled environment. The equipment should be installed and operated with minimum distance 20 cm between the radiator & your body. Any Changes or modifications not expressly approved by the party responsible for compliance could void the user's authority to operate the equipment.

This device complies with part 15 of the FCC Rules. Operation is subject to the following two conditions: (1) This device may not cause harmful interference, and (2) this device must accept any interference received, including interference that may cause undesired operation.

The mains plug is used as the disconnect device, the socket-outlet shall be easily accessible.

- replacement of a battery with an incorrect type that can defeat a safeguard (for example, in the case of some lithium battery types);
  - disposal of a battery into fire or a hot oven, or mechanically crushing or cutting of a battery, that can result in an explosion;
  - leaving a battery in an extremely high temperature surrounding environment that can result in an explosion or the leakage of flammable liquid or gas; and
  - a battery subjected to extremely low air pressure that may result in an explosion or the leakage of flammable liquid or gas.
- CAUTION  
- "Risk of fire or explosion if the battery is replaced by an incorrect type"