



AH68-00000A (Rev 0.0)



# YCA-F1

Handy FM radio broadcasting system  
FM transmitter

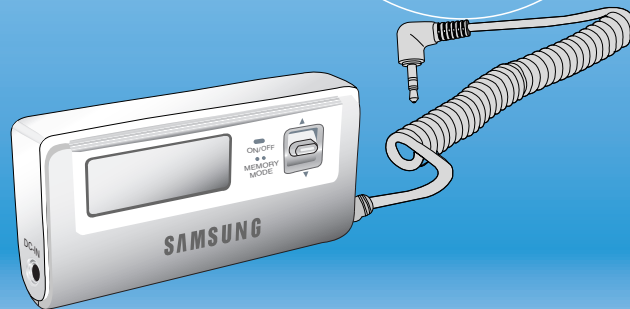

Safety Precautions(Refer to page 4, and 5) For your safety and protection of your property, it is required for you to read carefully and use the product as directed.

Information to user : Part 15, Paragraph 15.21 and 15.105(b)

Changes or modifications not expressly approved by the party responsible for compliance could void the user's authority to operate the equipment

#### FCC Notice

NOTE : This equipment has been tested and found to comply with the limits for a Class B digital device, pursuant to Part 15 of the FCC Rules. These limits are designed to provide reasonable protection against harmful interference in a residential installation. This equipment generates, uses and can radiate radio frequency energy and, if not installed and used in accordance with the instructions, may cause harmful interference to radio communications. However, there is no guarantee that interference will not occur in a particular installation. If this equipment does cause harmful interference to radio or television reception, which can be determined by turning the equipment off and on, the user is encouraged to try to correct the interference by one or more of the following measures:

- Reorient or relocate the receiving antenna.
- Increase the separation between the equipment and receiver
- Connect the equipment into an outlet on a circuit different from that to which the receiver is connected.
- Consult the dealer or an experienced radio/TV technician for help.

-----

This device complies with Part 15 of the FCC Rules. Operation is subject to the following two conditions: (1) this device may not cause harmful interference, and (2) this device must accept any interference received, including interference that may cause undesired operation.

## FM radio transmitter, YCA-F1 1

FM radio transmitter makes possible to listen through FM radios in cars or at home by converting and transmitting it to FM frequency by connecting it to MP3 player or other various multimedia players.

## Contents 2

Safety Instructions .....	3
Feature of the product.....	5
Components and names .....	6
Inserting a Battery.....	8
Power ON // OFF .....	9
HOLD Fuction .....	9
Changing of transmitting frequency.....	10
Setting the frequency.....	11
How to operate .....	13
When the product is out of order.....	15
Size of the Product .....	16

## 1. Safety Instructions

3

Do not apply excessive pressure to the device.



Do not try to disassemble and repair the device yourself.

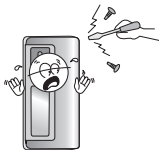

Do not place heavy objects on top of the device.



Keep the battery out when it's not in use for long time.

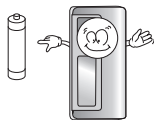

Operating the transmitter while driving can cause an accident.



Operating wet transmitter can cause the break down of the product or an electric shock.



4

Do not expose to extreme temperatures (above 95°F or below 23°F). Do not expose to moisture.



Do not expose to direct sunlight or heat sources.

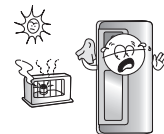

Do not expose to chemicals such as benzene and thinners.



Keep the transmitter off from the children's reach.



Keep the dirt out of the internal substance.



## 2. Feature of the product

5

### FM Full bandwidth ( 88.0 ~ 107.0 MHz )

- It is possible to send in FM full bandwidth.

### Frequency memory function

- It is possible to set the repeatedly used frequency and make a quick search of it.
- It is possible to set 8 frequencies.

### Dry battery remain indicator function

- Dry battery capacity indicator function indicates the time to change the battery.

### Blue backlight support

- Backlight function helps to operate the transmitter in the dark.

## 3. Components and names

6

### FM transmitter body

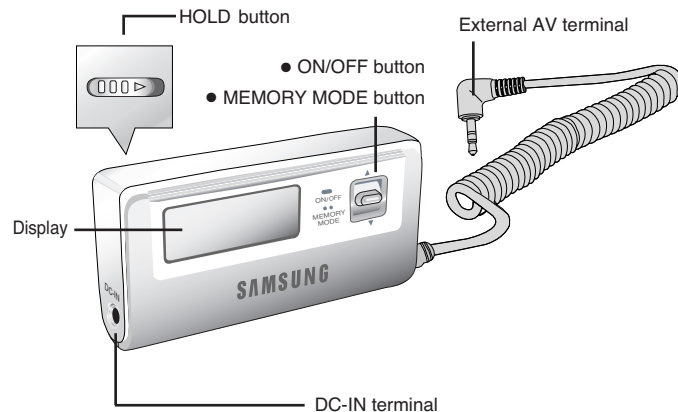

### 3. Components and names

7

#### Display



#### Other accessories



AAA Battery



User manual

### 4. Inserting a Battery

8

- ① Slide the cover in the direction of the arrow to open.

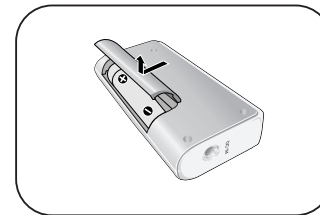

- ② Insert the battery facing the +/- properly.

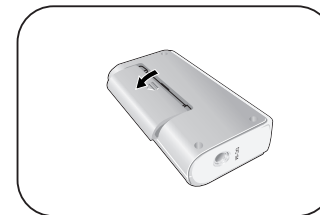

- ③ Place the battery and slide the battery cover in indicated direction.

## 5. Power ON // OFF

9

After insertion the battery to the body

- Power ON : Press ON/OFF button for a long while.
- Power OFF : Press ON/OFF button for a long while.

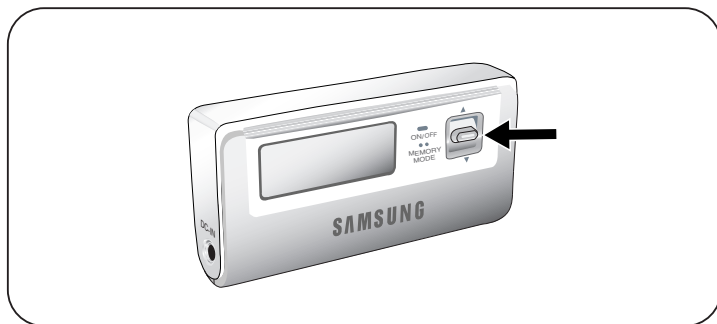

## 6. HOLD Function

In Hold mode, all buttons are disabled.

Slide the  switch on the player in the direction of the arrow.

- When the button is pressed, the "  HOLD!" message will appear on the display.

## 7. Changing of transmitting frequency

10

### ① Changing the step of 0.1 MHz :

Slide the button upwardly or downwardly for a short period of time.

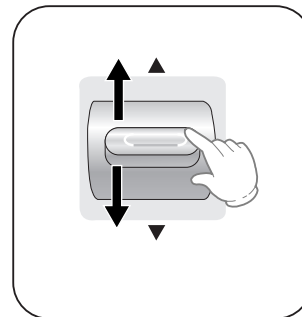

### ② Quick change of frequency :

Slide the button upwardly or downwardly for a long while

### ③ Changing frequency to the Memorized state :

Press the button shortly.

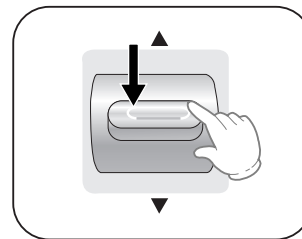

## 8. Setting the frequency 11

It is possible to set 8 different frequencies which are used repeatedly and make a quick search of them or change them.

### ① **Selecting the frequency to set :**

Handle the transmitter to move to the frequency which is to be set.

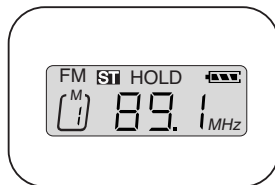

### ② **Setting the memory mode :**

Press the button of the transmitter twice.  
(Memory addressing number is blinking.)

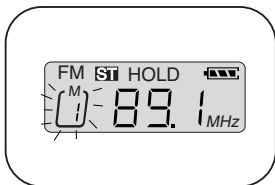

### ③ **Selection of the memory address :**

Press the button until the proper memory address appears in Memory Mode state.  
(select among from no. 1 to 8)

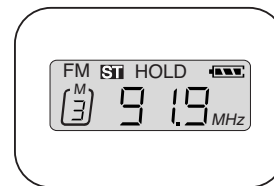

### ④ **Setting :**

Press the button until the blinking of the memory address stops.

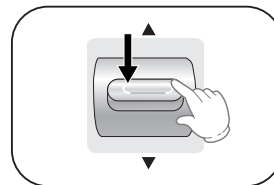



## 9. How to operate

13

- ① Turn on the power of the transmitter.
- ② Connect the FM transmitter to External AV components (MP3 Player, CD player, laptop etc.)
- ③ Press the play button of the External AV component in order to play the intended music through the FM radio.

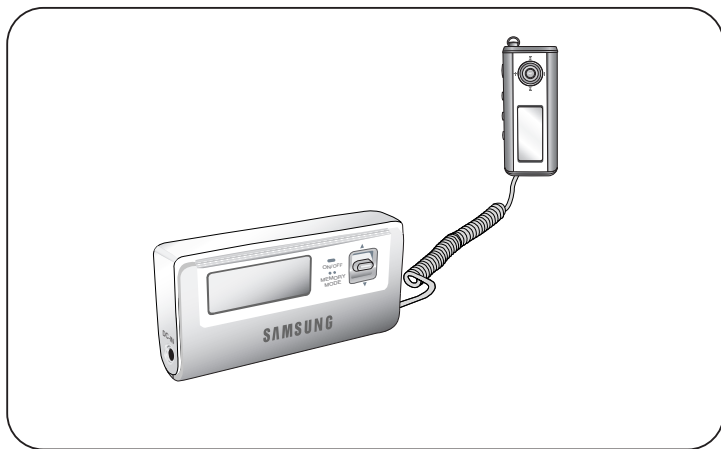

14

- ④ Turn on the FM radio and tune the frequency of the FM radio and FM transmitter at the same state.
  - It is possible to listen to the played music of the external AV component through FM radio.
- ⑤ Control the volume of the external AV component or FM radio.

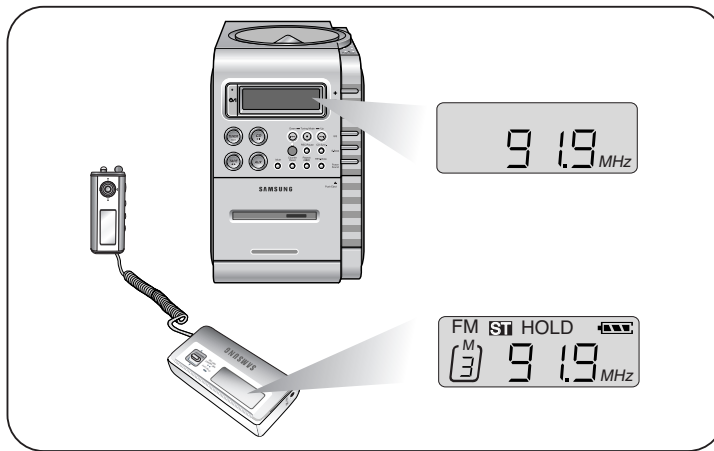

## 10. When the product is out of order 15

When Power ON error occurs

- Replace the battery.
- Check whether the battery's been inserted properly.

When serious noisy occurs

- When remained capacity of the battery is too small the noisy would occurs therefore it's necessary to replace the battery.
- Change the frequency.
- Control the volume of the external AV component which is connected to the FM transmitter.

When it's inaudible

- Control the volume of the external AV component.
- Check the connection of the external AV component.

## 11. Size of the Product 16

Model	YCA-F1
Voltage	AAA1.5V battery
Frequency bandwidth	88.0MHz ~ 107MHz (0.1MHz step)
Signal to Noise ratio	60 dB
Operatingtemperature	-10 ~ 40°C
Dimension(H, V, D) / weight	646 x 374 x 131mm / 30g (except battery)
Running time	Max 12 Hours
Authentication	MIC / FCC
manufactured by / country	BKM / Korea

The contents of the manual can be changed for the better use without notice.

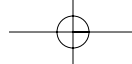

**MEMO**

**MEMO**

