

WiFi Share User Manual



Model : WD1201

Hualu

CHENZHOU HUALU DIGITAL TECHNOLOGY CO.,LTD

Warning

Warning: Changes or modifications to this unit not expressly approved by the party responsible for compliance could void the user's authority to operate the equipment.

NOTE: This equipment has been tested and found to comply with the limits for a Class B digital device, pursuant to Part 15 of the FCC Rules. These limits are designed to provide reasonable protection against harmful interference in a residential installation. This equipment generates, uses and can radiate radio frequency energy and, if not installed and used in accordance with the instructions, may cause harmful interference to radio communications.

However, there is no guarantee that interference will not occur in a particular installation. If this equipment does cause harmful interference to radio or television reception, which can be determined by turning the equipment off and on, the user is encouraged to try to correct the interference by one or more of the following measures:

1. Reorient or relocate the receiving antenna.
2. Increase the separation between the equipment and receiver.
3. Connect the equipment into an outlet on a circuit different from that to which the receiver is connected.
4. Consult the dealer or an experienced radio/TV technician for help.

This device complies with Part 15 of the FCC Rules. Operation is subject to the following two conditions : (1) this device may not cause harmful interference, and (2) this device must accept any interference received, including interference that may cause undesired operation.

Shielded cables must be used with this unit to ensure compliance with the Class B FCC limits.

CAUTION
RISK OF EXPLOSION IF BATTERY IS REPLACED
BY AN INCORRECT TYPE.
DISPOSE OF USED BATTERIES ACCORDING
TO THE INSTRUCTIONS

POWER SUPPLY : 5V === 600mA

Functions

Function1	Wireless share hard disk	P1
Function2	Act as wireless router	P19

Wireless share hard disk

	Basic operations of wireless share hard disk
Step1	charge
Step2	insert external storage card(SD or TF card)
Step3	download and install App program
Step4	Activate WiFi Share
Step5	connect wireless network
Step6	apply App program

Charge

Confirm WiFi Share electricity quantity

Before first usage, please fully charge the battery with Computer. To charge battery, please connect one end of connecting cable to WiFi Share, and the other end to USB port of computer, and then the red indicator will light up. After charging completed, the indicator will turn to green.

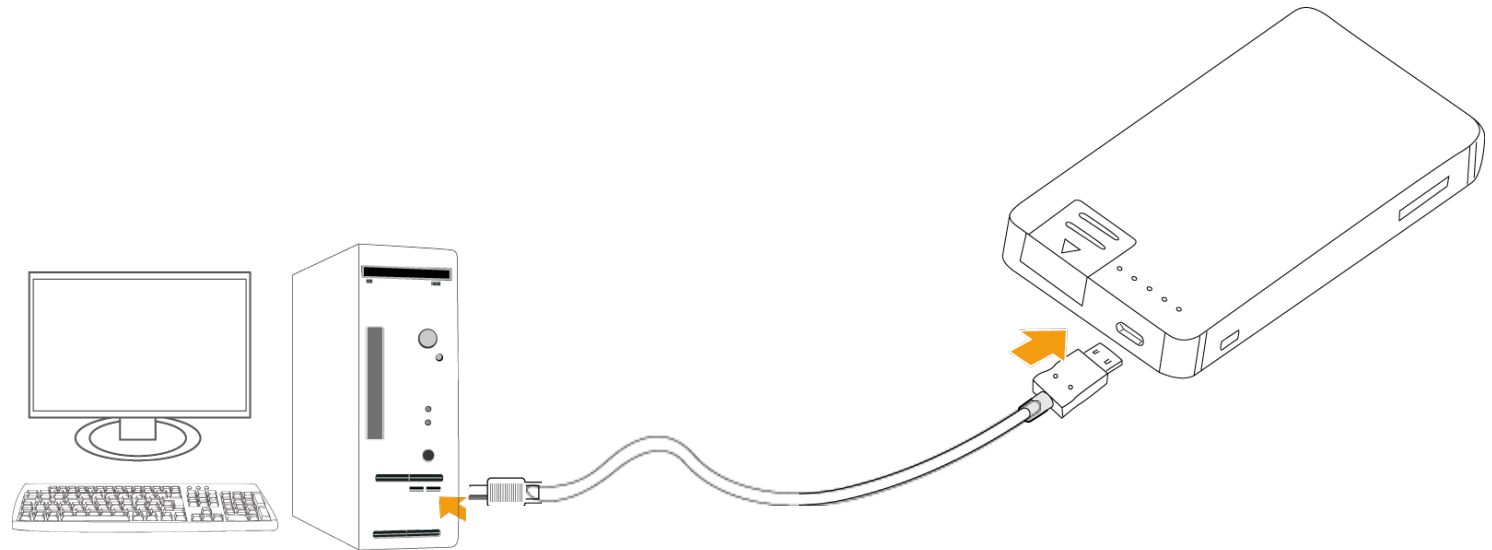

Insert external storage card(SD or TF)

Step1	Copy files, such as video, audio, picture, and document, etc, from computer into SD or TF card.
Step2	Insert TF card from left port, and insert SD card from right port.(TF card will be defaulted for external storage 1; SD card will be defaulted for external storage 2)



Download App program

User can download "WiFi Share" program from "91Assistant" or "Snap Pea"

Step1	User need to install "91Assistant" or "Snap Pea" on computer and mobil device first
Step2 PCversion"91Assistant" as example	After installation of "91Assistant" on computer, then connect the mobile device to computer, and connect to "91Assistant", searching WiFi Share.



Click "Game
software"

Input "WiFi
Share", then
click "search"

Download and install App

Installation

Click "Installation", to install APK into mobile device.



Click
"Installation"

Download and install App

Installation
complete

The icon of "WiFi Share" will turn up on mobile device



WiFi Share icon

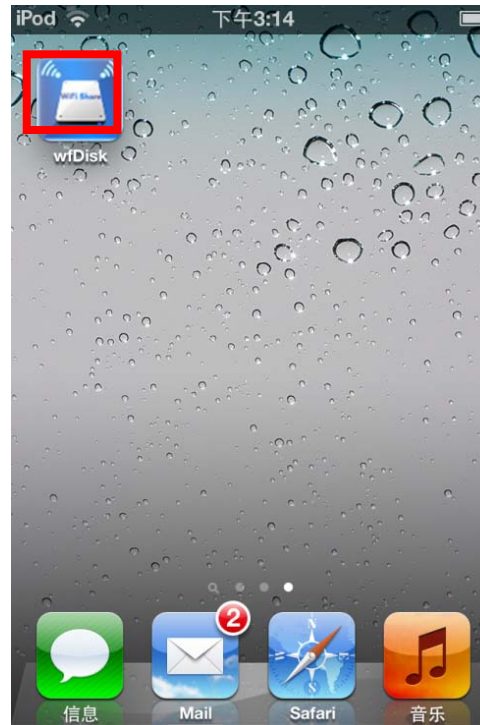

Activate WiFi Share

Activate

Press "Power" key of WiFi Share for 3 seconds, to activate. While activating, the power indicator will glitter.

Press Power key
for 3 seconds



Connect wireless network

Search wireless network	The device using iOS or Android system need to be connected to WiFi Share network first.
Connect wireless network	Choose the wireless network named WiFi Share and connect.

Choose "WIFI Share"



Apply program

Step1	Click the icon of WiFi Share
Step2	Click "Skip" to main interface

Click "WiFi Share"

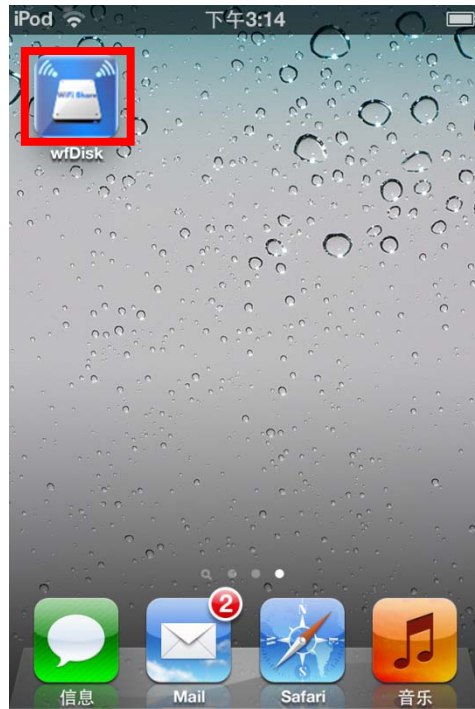

Click "Skip"

Apply program

	Menu
Setting	act as settings of wirelss router
Local storage	the storage area under the device root directory
External storage1	TF card storage area
External storage2	SD card storage area



Apply program

Music operation

Click "Music"

Click "Music"



Apply program

Display music

Click music file, then it will display

Click music
file

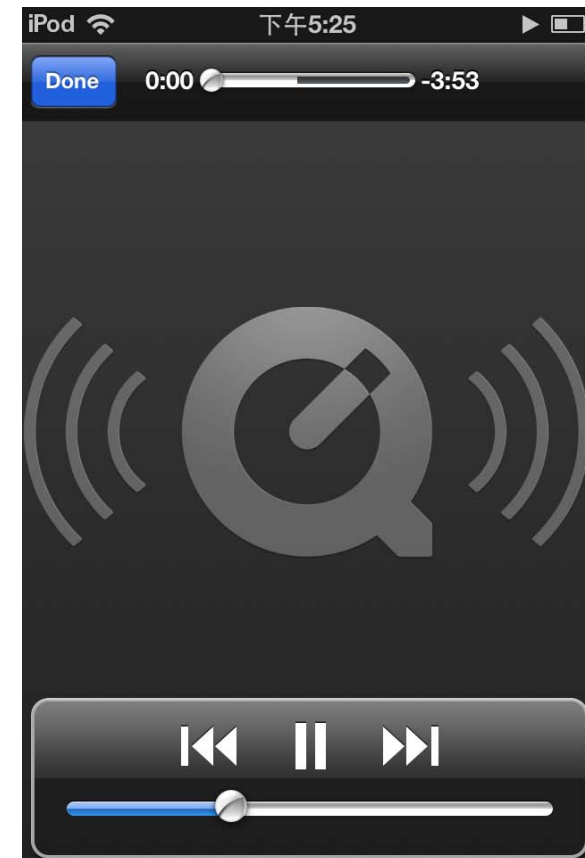

Apply program

Copy local files to
external storage area

First choose and mark, then click "Copy"

Similar with
copying files
from external
storage area
to local



Click "Copy"

Apply program

Back to
external
storage

Click "Home",back to Menu,then come to external storage.(or click
"Previous")

Previous



back to Menu

Apply Program

Paste

Come to external storage, click paste, finish file pasting from local to external storage.

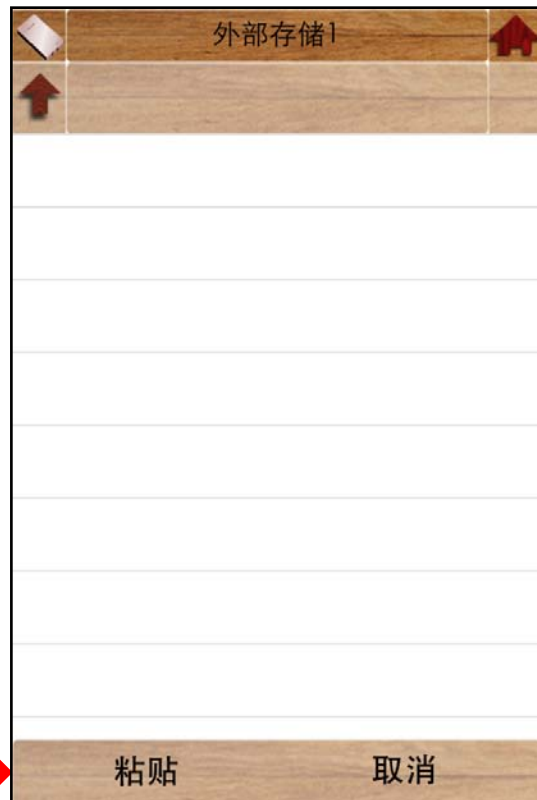

Apply Program

Delete

First mark, then click delete and confirm

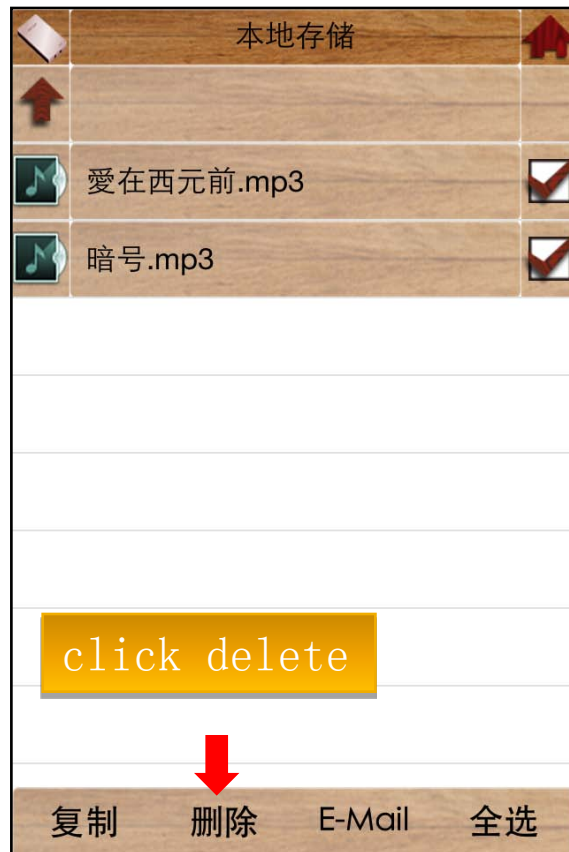

Apply Program

E-Mail

First marking, click E-mail, input receiver add and title. Click "Send", send email out enclosed music file.

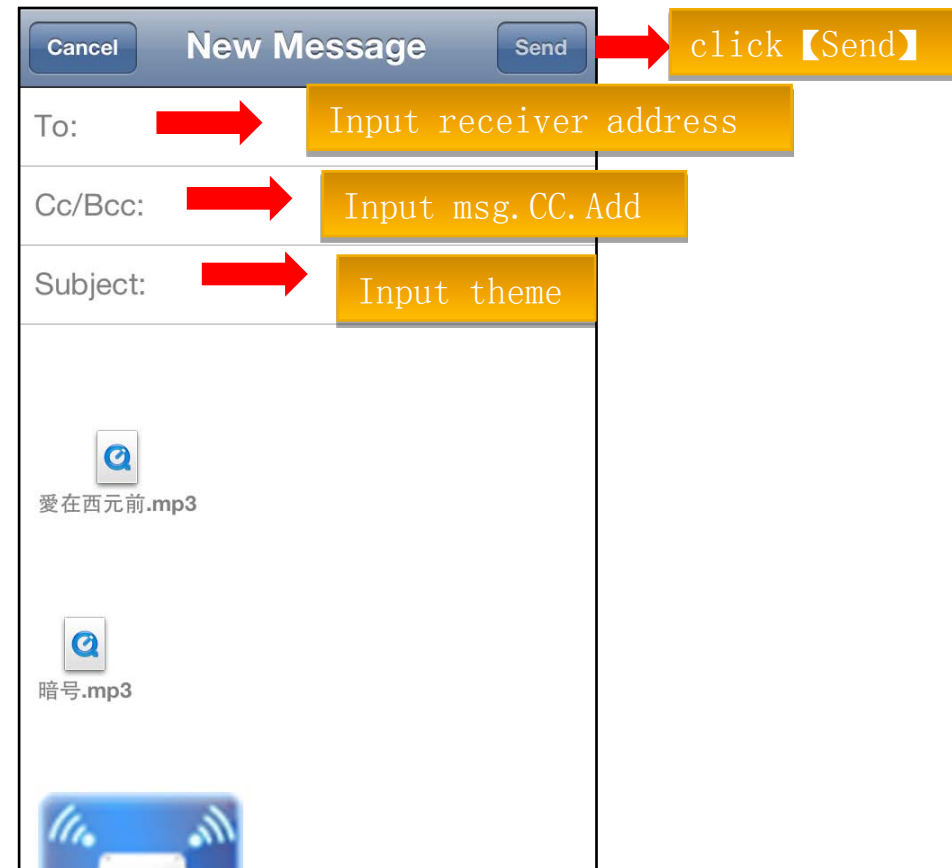

Apply Program

Operations for
other types files

The operations for Video, Picture, File and other files, are similar with Music file.

As wireless router

	Settings as wireless router
LAN means	wire connect to Internet
WiFi means	wireless connect to Internet

Set up wire connect as wireless router

Step 1

connect net jacket to WiFi Share



Set up wire connect as wireless router

Step 2

click settings, wire route ,Next



Set up wire connect as wireless router

Step 3

Follow tips to finish settings. This way fits no WiFi but net jacket .

After settings, the device will reset [WiFi Share], user need re-research WLAN, and re-connect. Then you could surf the Internet.

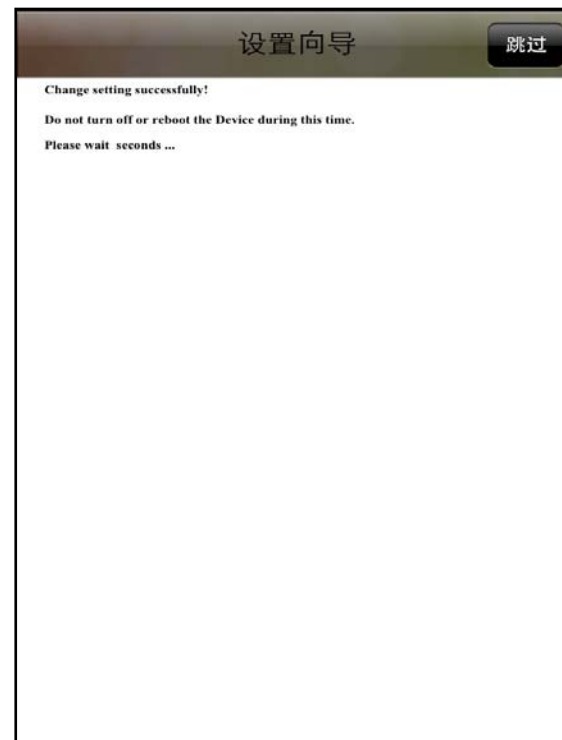

Set up wireless connect as wireless router

Step 1

click settings, WiFi transmitter ,Next

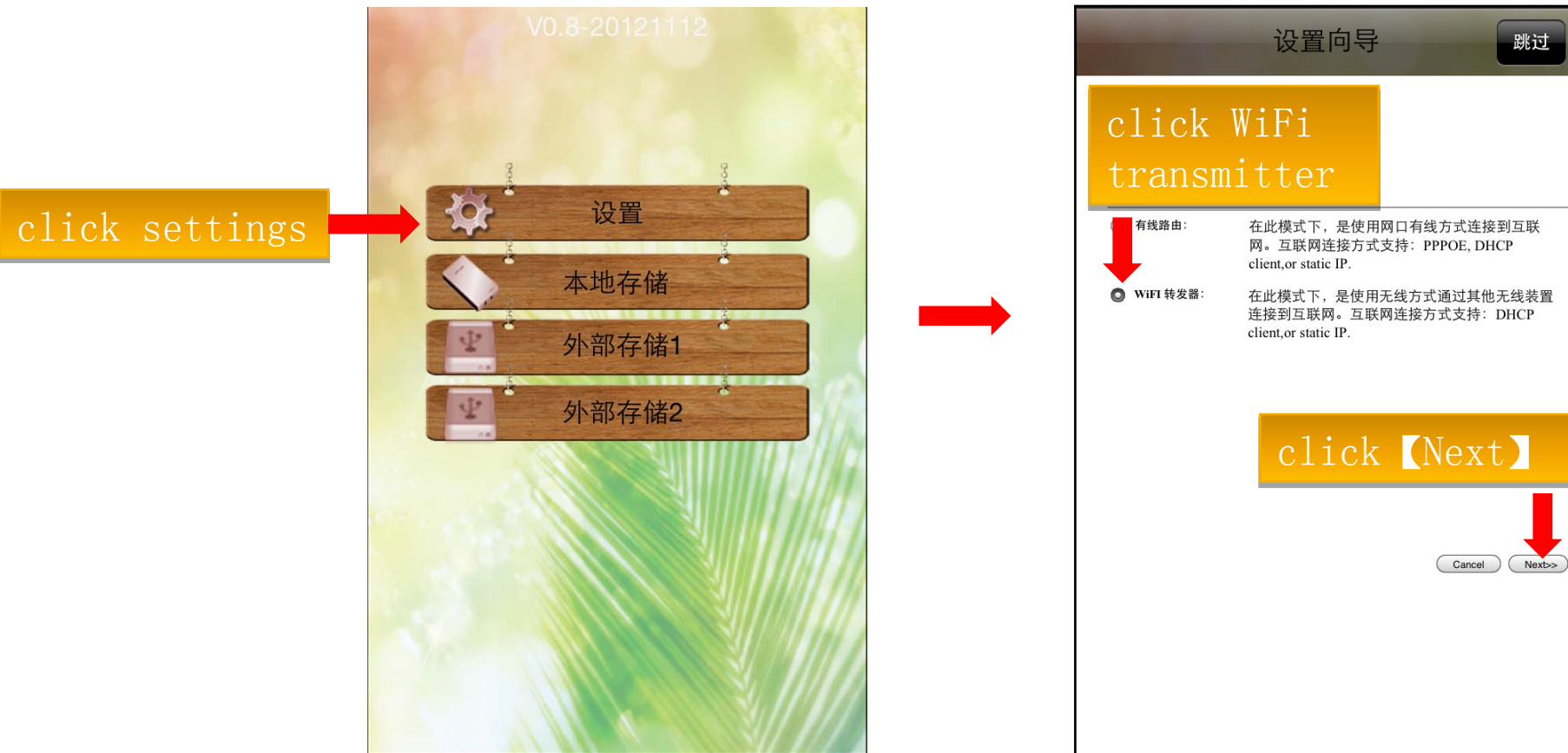

Set up wireless connect as wireless router

Step 2

Follow tips, finish setting up "As router" function. This way fits WIFI condition.

After settings, the device will reset [WiFi Share], user needs to re-research WLAN, and re-connect. Then you could surf the Internet.

