

**This page to be removed for digital version!**

PART NUMBER: **E19-LQ265-ISSA**

PAGE SIZE: 150x100mm

COLOUR: CMYK

# Mevo Range User Manual



@flightscopegolf



Thank you for choosing the Mevo Range launch monitor. This device uses patented FlightScope Fusion Tracking technology that combines 3D Doppler tracking radar and synchronized image processing to ensure you have accurate performance data you can trust.

This Mevo Range unit is designed to be used at the driving range or indoor simulator with a semi-permanent baseplate mount and 12 hours of tracking time.

A handwritten signature in black ink, which appears to read 'H. Johnson'.

Henri Johnson - Founder & CEO

# Contents

Battery warning	1	Technical specifications	22
Mevo Range	2	Product dimensions	23
Placement	3	Contact details	24
Connecting to the Mevo Range	5		
FS Golf app	7		
FS Skills app	8		
Battery indicators	13		
System indicators	14		
Important notes	15		
Frequency band	18		
Switch off	19		
Lift unit	20		
Data parameters	21		

# Battery warning



**CAUTION:** This device contains a Li-ion battery. Do not expose to temperatures below freezing point. Do not expose to excessive heat. Avoid physical impact, puncture, crushing or dropping. If the unit is struck by a club or ball, a short circuit or other heat reaction may occur, resulting in a fire.

Do not tamper with the battery pack. Avoid physical damage or stress when removing or inserting the battery. Do not short-circuit the battery terminals. Maintain battery condition by charging and discharging regularly, at least every few months.

Use only the included charger and charging cable for best results. If the battery bulges, emits fumes, or becomes very hot, disconnect it from the charger and replace the battery. Dispose of old batteries in accordance with applicable waste battery and recycling regulations.

# Mevo Range

- 1 On/Off button
- 2 QR Code to connect device (only used when rear is not visible)
- 3 QR Code to connect device
- 4 Indicators
- 5 Alignment camera
- 6 Hand grip
- 7 Security port lock
- 8 12V Charging Connector
- 9 Serial Sticker/ Frequency Band
- 10 USB-A access hole
- 11 USB Dongle (Wi-Fi)  
Insert dongle prior to use

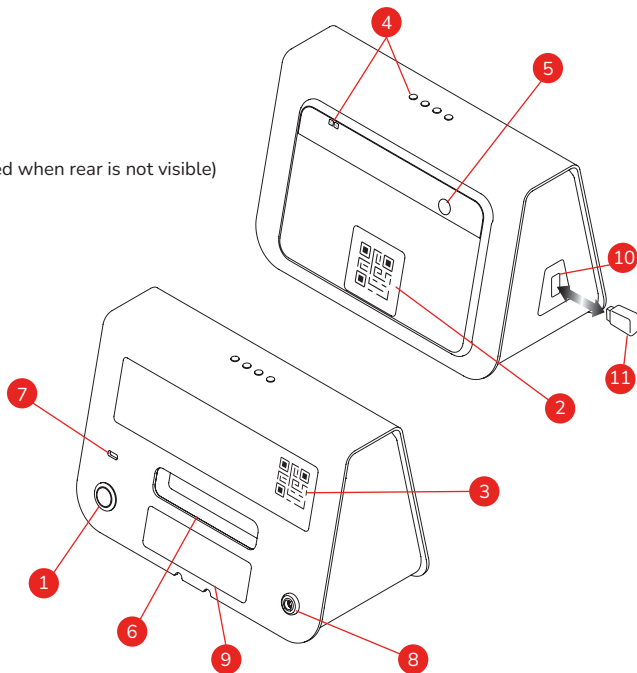

# Placement

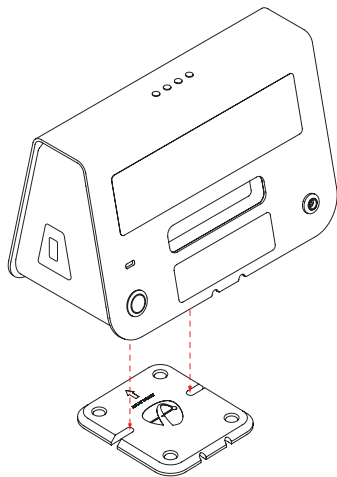

Place unit on baseplate.  
Unit will click into place magnetically.

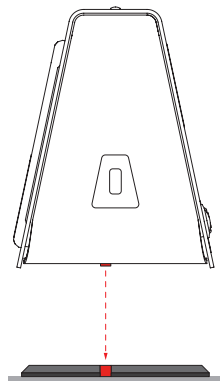

Ensure the hexagon cap screws on the bottom of the unit align with the base plate. This will ensure the unit is facing the correct direction.

Unit facing the right direction and correctly aligned with the baseplate.

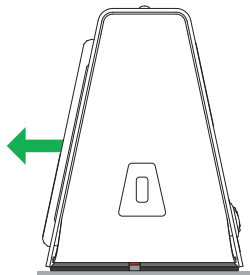

Unit aligned incorrectly with baseplate.

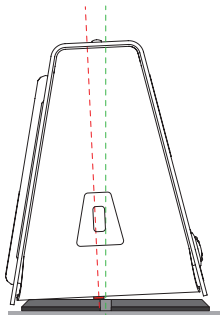

Unit facing the wrong direction in relation to the baseplate.

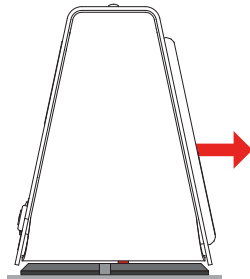



# Connecting to the Mevo Range

- 1 **Scan** the QR Code in your bay for the desired app.

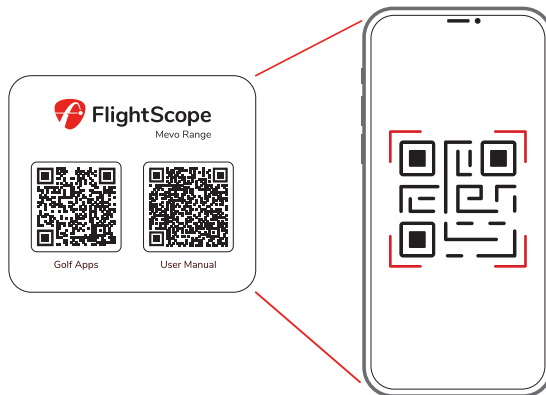

# FS Golf app



A comprehensive and customizable phone app allowing users to teach, fit, and practice with radar data, video capabilities, 3D trajectories and more.



## **Data Margins & Instant Feedback**

Set your minimum and maximum values for any data parameter to train smarter and improve consistency. Receive instant visual feedback with simple green and red data display.



## **Data and Video Combined**

Practice without interruption using the FS Golf App. The app on your phone will automatically record and clip each video before storing on the app for easy review.



## **Customizable Trajectory View**

Customize your trajectory screen display and preferred performance data blocks for the ultimate user experience.

# FS Skills app



Evaluate your players with the most advanced and customizable combine assessments available.



## **FlightScope Combines**

Designed to be the ultimate and most advanced assessment of a golfer's skill level.



## **Practice Smarter**

Use Skills to determine accuracy and skill level for benchmarking and compare performance with players around the world.



## **Customized Challenges**

Practice with a purpose by choosing target size, location, and point values for weaknesses.

- 2 Switch on the unit by pressing the power button.

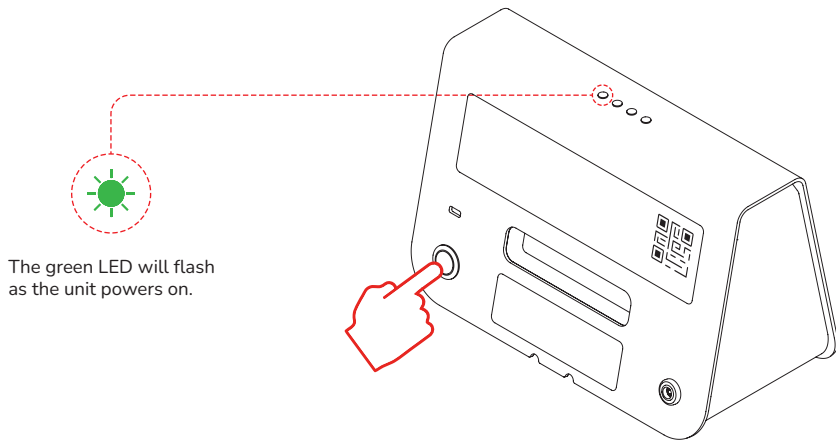

- 3 Make sure your phones **Wi-Fi** is turned **ON**.



- 4 Open up the desired **App**.

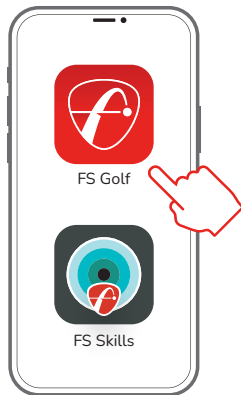

- 5 Scan the **QR Code** on the back of the unit to connect the App with the Mevo Range unit.

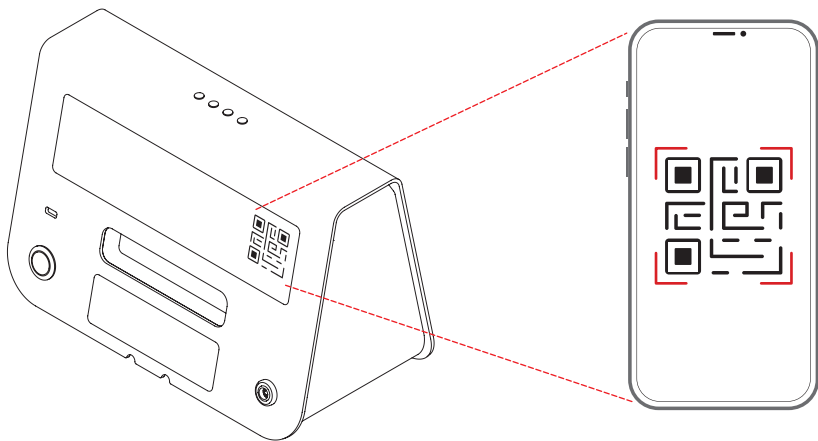

- 6 Check that the radar connection status changes from **Ready** to **Connected**.

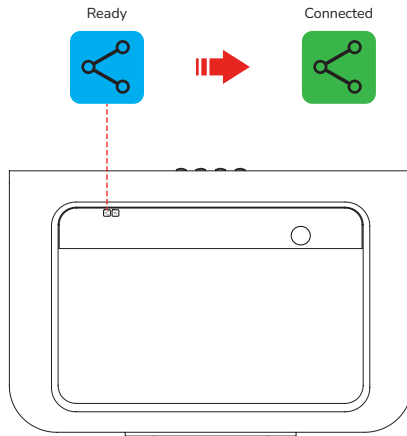

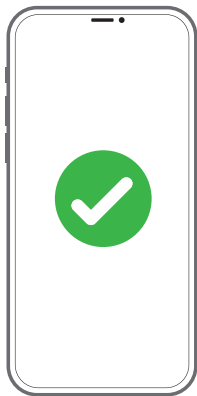

You are now ready to **start** your session.



# Battery indicators

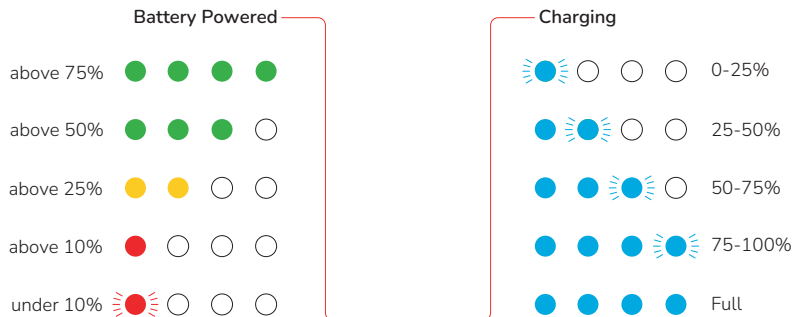

\*

Have the battery charged if the level is <25% to ensure that your session can be completed.











# System indicators

## Connection Status

Off	
Ready	
Connected	

## Radar Status

	System off
	Power on, switching on
	Processor start up 30-60 seconds
	Standby mode
	Armed, ready to measure
	Processor shut down 15-30 seconds
	Battery empty
	Error



## Important Notes

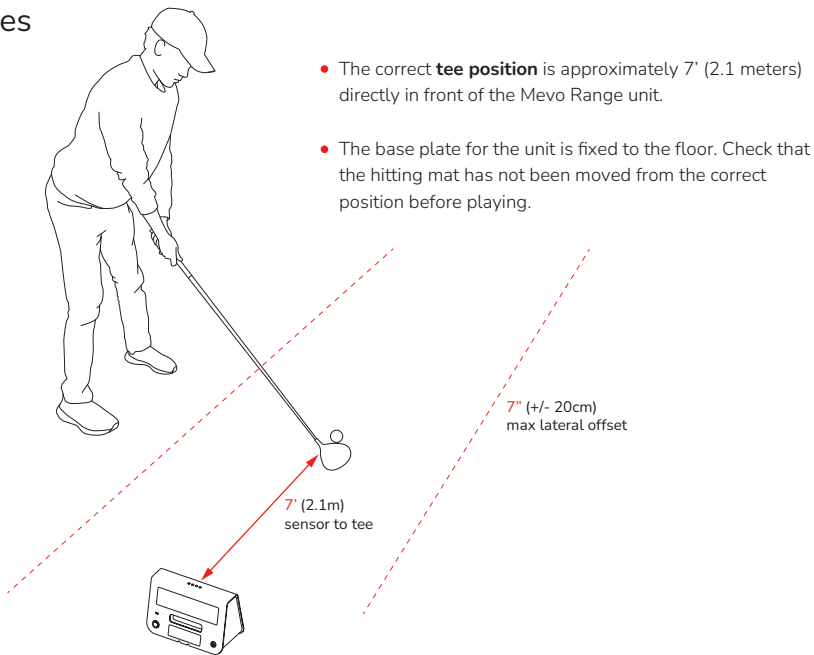

- Extremely low and wide shots, and shots where the player is between the Mevo Range and the ball, might not register.

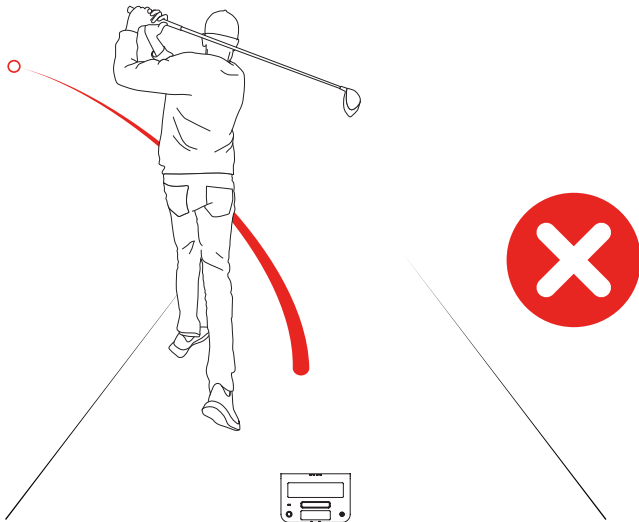

- Keep the area between Mevo Range and the ball position clear of any objects and people.

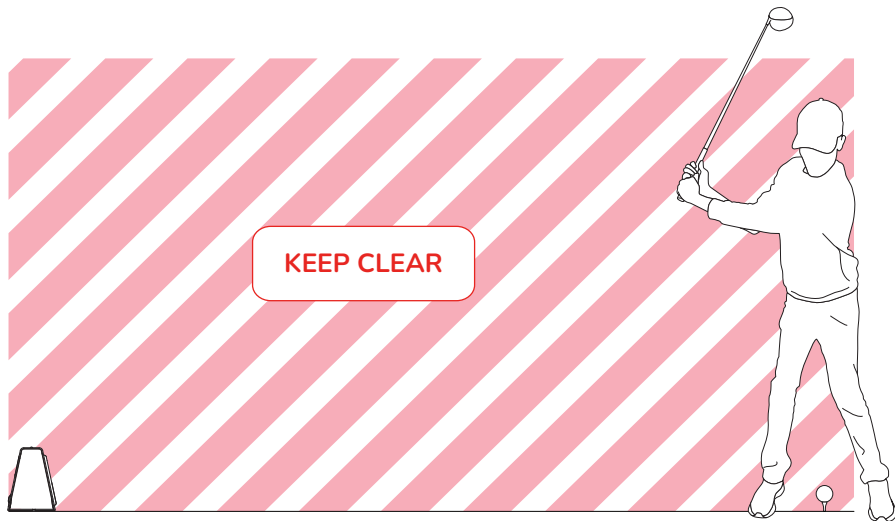

# Frequency band

If there are units next to each other, make sure the **Fband numbers** are **different**. The same numbers next to each other can cause inaccurate results.

Channel  
0 0 0  
0 1 0  
0 2 0  
0 3 0  
0 4 0  
0 5 0  
0 6 0  
0 7 0  
0 8 0  
0 9 0

 **FlightScope** Mevo Range  
For patent info: [www.flightscope.com/patents](http://www.flightscope.com/patents)  
FCC ID: QXP-JR230  
IC: 4612A-JR230  
This device complies with Part 15 of the FCC rules.  
Operation is subject to the following two conditions:  
1. This device may not cause harmful interference, and  
2. This device must accept interference received, including interference that may cause undesired operation.

SN: M2R-001001  
Rechargeable Li-Ion Battery  
7.4V 13000mAh 96.2Wh  
FN: ES1-JR230  
[flightscopemevo.com](http://flightscopemevo.com)  
[myflightscope.com](http://myflightscope.com)  
Made in South Africa

  018-200072  

If you are getting inaccurate results or false triggers:

1. Check if there is another Mevo Range in your adjacent bays.
2. Check the frequency number and switch out.

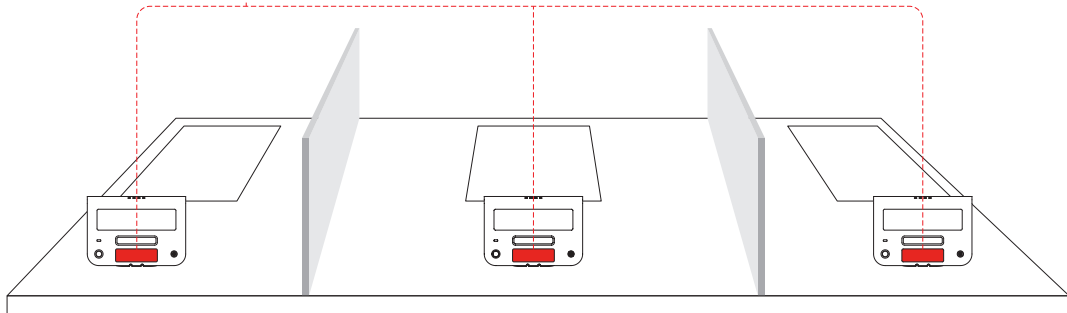

## Switch off

- Press and hold the power button for 2 seconds to turn off the unit.

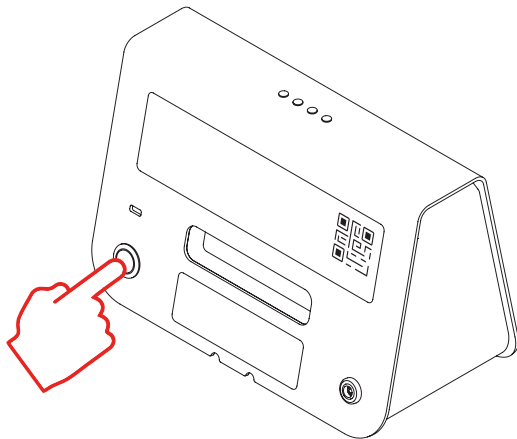

# Lift unit

- 1 Grab the unit using the recessed handle.

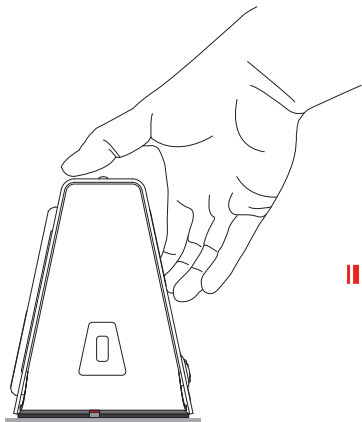

- 2 Pull the unit forward whilst lifting to break the magnetic bond.

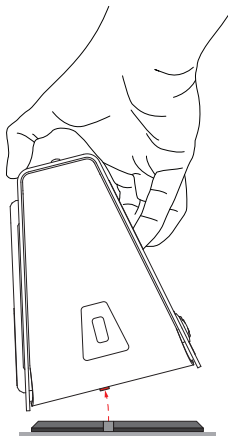



# Technical specifications

Transceiver	
Operating frequency	Fixed frequency in the 24,08 - 24,16z GHz band
Output power	24 dBm +/-3dBm (North America); 17dBm +/-3dBm (Japan)
Antenna gain	15.3 dB +/-1dB
Carrier modulation	CW/ None (NON)
Detection method	Doppler velocity measure-
Communication	
Data interfaces	USB 2.0 on a USB-A connector (Specified commercial USB Wi-Fi adapters may be used).
Electrical & Physical	
Operating temperature	0°C to +40°C (operating, recommended)
Storage temperature	-10°C to +55°C (storage, non-operating)
Dimensions	212 x 137 x 113mm
Mass	3kg
Power supply/ charger	12V dc +/- 10%; current up to 3.3A (lourens to confirm)
Charging time	5 - 6hrs (recommended)
Battery (Optional)	7.4V 13000mAh 96.2Wh

## Product dimensions

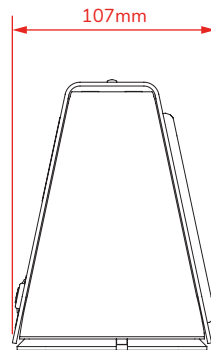
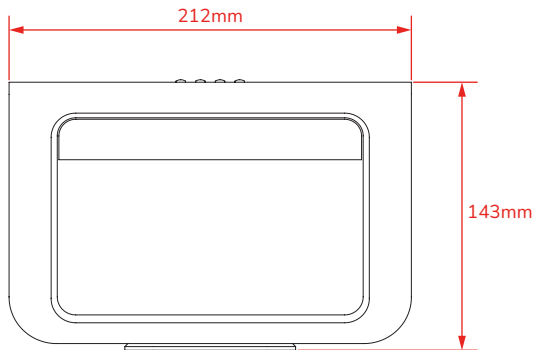

- \*Total height with baseplate attached.

**FCC Statement:** This equipment has been tested and found to comply with the limits for a Class B digital device, pursuant to Part 15 of the FCC Rules. These limits are designed to provide reasonable protection against harmful interference in a residential installation. This equipment generates, uses and can radiate radio frequency energy and, if not installed and used in accordance with the instructions, may cause harmful interference to radio communications. However, there is no guarantee that interference will not occur in a particular installation. If this equipment does cause harmful interference to radio or television reception, which can be determined by turning the equipment off and on, the user is encouraged to try to correct the interference by one or more of the following measures:

- Reorient or relocate the receiving antenna.
- Increase the separation between the equipment and receiver.
- Connect the equipment into an outlet on a circuit different from that to which the receiver is connected.
- Consult the dealer or an experienced radio/TV technician for help.

Changes or modifications not expressly approved by FlightScope (PTY) could void the user's authority to operate the equipment.

In order to comply with FCC and ISED RF Exposure requirements, a minimum separation distance of 20 cm must be maintained between the device and all persons during normal operation.

Afin de se conformer aux exigences de la FCC et de l'ISED en matière d'exposition aux RF, une distance de séparation minimale de 20 cm doit être maintenue entre l'appareil et toutes les personnes pendant le fonctionnement normal.

**ISED Statement:** This device contains licence-exempt transmitters(s)/receiver(s) that comply with Innovation, Science and Economic Development Canada's licence-exempt RSS(s). Operation is subject to the following conditions:

- (1) This device may not cause interference.
- (2) This device must accept any interference, including interference that may cause undesired operation of the device.

**Declaration ISED:** Cet appareil contient des émetteurs/récepteurs exemptés de licence conformes à la norme Innovation, Sciences, et Développement économique Canada. L'exploitation est autorisée aux deux conditions suivantes:

- (1) L'appareil ne doit pas produire de brouillage.
- (2) L'utilisateur de l'appareil doit accepter tout brouillage radioélectrique subi, même si le brouillage est susceptible d'en compromettre le fonctionnement.

**Japanese caution: for Indoors use only.**

+++++本機器の使用に係る注意事項+++++ 本機器の使用周波数帯（10.5GHzを超え10.55GHz以下の周波数）では、免許を受けて屋外で利用されている無線局があります。これらとの干渉が懸念される為、本機器の使用は、屋内での使用、即ち住宅、マンション、ビル等の建築物内のみと限定されています。万一、10.5GHz帯の周波数を使用する移動体検知センサーを屋外で利用した場合には、その使用に支障が生じるばかりでなく、電波法令に違反し罰則の適用を受けることとなりますので、十分注意してください。

E19-LQ265-ISS1.1



## CONTACT DETAILS

Office phone number:

Mevo Series: +1 407 967 7121

X-Series: +1 407 664 2622

Email:

[support@flightscope.com](mailto:support@flightscope.com)

Company address:

8600 Commodity Cir #106, Orlando, FL 32819, United States

Country of Origin:

South Africa



# FlightScope®

Performance data you can trust

[myflightscope.com](https://myflightscope.com)