Appendix 8. User Manual

SAVERCALL - 3000

User Manual



Hyun Joung System Co., Ltd.



IMPORTANT – PLEASE READ THIS SECTION FIRST

Savercall-3000 is a Do-It-Yourself Wireless Security System designed to help users protect themselves, their loved ones, and their property and personal possessions. Please read through the important information below before getting started with **Savercall-3000**

- Carefully follow the instructions in this manual when installing, setting up and programming **Savercall-3000**
- Take special notice of any specified notes, bullet points, and so on throughout this manual
- Please take the following precautionary measures while handling and situating the **Savercall-3000** system:
 1. Keep **Savercall-3000** away from water or damp areas
 2. Do not install **Savercall-3000** in direct sunlight or near extreme heat
 3. Do not install **Savercall-3000** near strong electrical current or magnetic force
 4. Avoid dropping **Savercall-3000** or placing it in an area with strong vibration
 5. Do not disassemble the product – doing so will void the Warranty
 6. If old people or pregnant woman want to test siren, please test at a long distance(about 33ft).
- To better understand **Savercall-3000** and its performance capabilities, users should test the entire system at least one a week

Hyun Joung Systems Co., Ltd. is a company focused on ensuring our customers the fullest level of satisfaction. If you have any comments, questions, please feel free to contact us at:

Or visit our website at: www.hjsys.co.kr

CONTENTS

<u>Section</u>	<u>Page</u>
<i>Savercall-3000</i> Features & Benefits	3
Main Components & Optional Accessories	5
Details of main controller & sensors	6
Main function	9
Installation & Setup	10
Examples of How <i>Savercall-1000</i> Works	28
Menu Summary	30
User Guide	31
Savercall-3000 Specifications	36
Trouble Shooting (Q & A)	37
Technical Support, Customer Care & Sales	38
Warranty Information	39

Savercall-3000 Features & Benefits

Feature	Benefit
Do-It-Yourself Wireless System	<ul style="list-style-type: none">• FM frequency : Up to 150ft. range covers an entire house, apartment, small business, etc.• No hard-wired installation necessary• Simple screw-in or double-sided tape mounting
LCD display and Voice-Guided Setup & Operation	<ul style="list-style-type: none">• Simple programming & operation• Very user-friendly• Voice-prompts for responses• All setup & programming options are Password-protected
Remote Control	<ul style="list-style-type: none">• Allows for easy “alarm on”, “alarm off” & emergency calls directly from the remote controller
“Alarm away” & “Alarm home” Security Modes	<ul style="list-style-type: none">• Various programming & arming options for “Alarm away” or “Alarm home” security• Support of “Alarm home” security without Motion detector
CID(Caller-ID) function	<ul style="list-style-type: none">• It saves maximum 20 phone number• Supports redial function
Automatic mode conversion	<ul style="list-style-type: none">• Supports automatic conversion among alarm-home, alarm-away and off mode• User can assign conversion time
Record of sensor activation	<ul style="list-style-type: none">• Possible to record sensor activation reasons up to five.• User can check memory through remote controller and LCD.
Support of wire extension port	<ul style="list-style-type: none">• Support of various wire sensor as an option
Auto-Dialer	<ul style="list-style-type: none">• Automatically calls up to five specified phone numbers upon alarm activation & plays pre-recorded voice messages• Voice-prompts for responses• Can call out & notify any telephone, cellular phone of an Alarm Activation

Feature	Benefit
Loud Siren (Including built-in siren)	<ul style="list-style-type: none">• Immediately deters intruders• Alerts users, neighbors & others of an Alarm Activation
SOS call function	<ul style="list-style-type: none">• Auto-dialer function through SOS button on Main unit & Remote controller
Phone line disconnection alarm	<ul style="list-style-type: none">• Siren will notify in case phone line is disconnected
Power supply disconnection alarm	<ul style="list-style-type: none">• Voice and LCD notification when power supply is disconnected
Remote Operation via Telephone	<ul style="list-style-type: none">• Call in to alarm-home, alarm away & program system from anywhere in the world• Monitor situation or speak directly to an intruder
Exclusive Integrated Speakerphone (Telephone function)	<ul style="list-style-type: none">• Usage as a telephone through speakerphone• Allows for advanced 2-way voice communication• Converse with emergency personnel during an on-site crisis situation
1-button Emergency Call (SOS call function)	<ul style="list-style-type: none">• Make on-site emergency calls directly from remote controller & main unit by pressing SOS button• Call out to emergency personnel during on-site panic or crisis situations
Various additional functions	<ul style="list-style-type: none">• Support of various function such as chime bell alarm and wake-up call etc.
Rechargeable Backup Battery	<ul style="list-style-type: none">• Backs up Controller unit in the event of a power outage
Long-Life Sensor Batteries	<ul style="list-style-type: none">• remote controller contain replaceable long-life batteries• Notify users of any low-battery situation
Memory Chip Stores All Programmed Data	<ul style="list-style-type: none">• Retains programmed settings for all User Functions, even during power outages

Main Components & Optional Accessories

Main Components*	Optional Accessories
Main Unit	Remote Controller
Remote Controller	Remote Controller
Motion Detector	Motion Detector
Wire Loud Siren	Wire Loud Siren
A/C Adaptor	A/C Adaptor
Rechargeable Backup Battery (8.4V 300mA)	Rechargeable Backup Battery (8.4V 300mA)
Telephone Line	Telephone Line
Sticker/Manual	
<i>*Refer to Package Contents label on box for exact list of main components. Alternate components may be included.</i>	

The details of main controller & sensors

- The front side

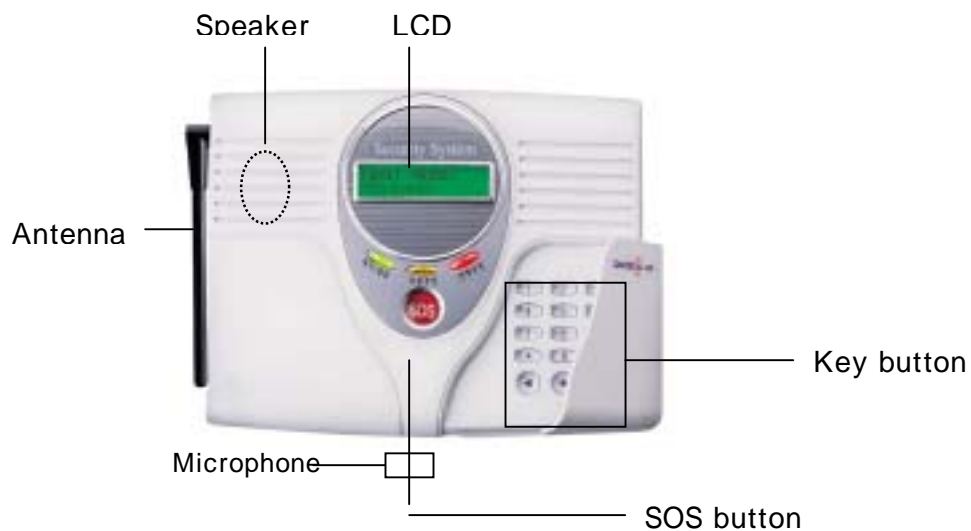

- The backside

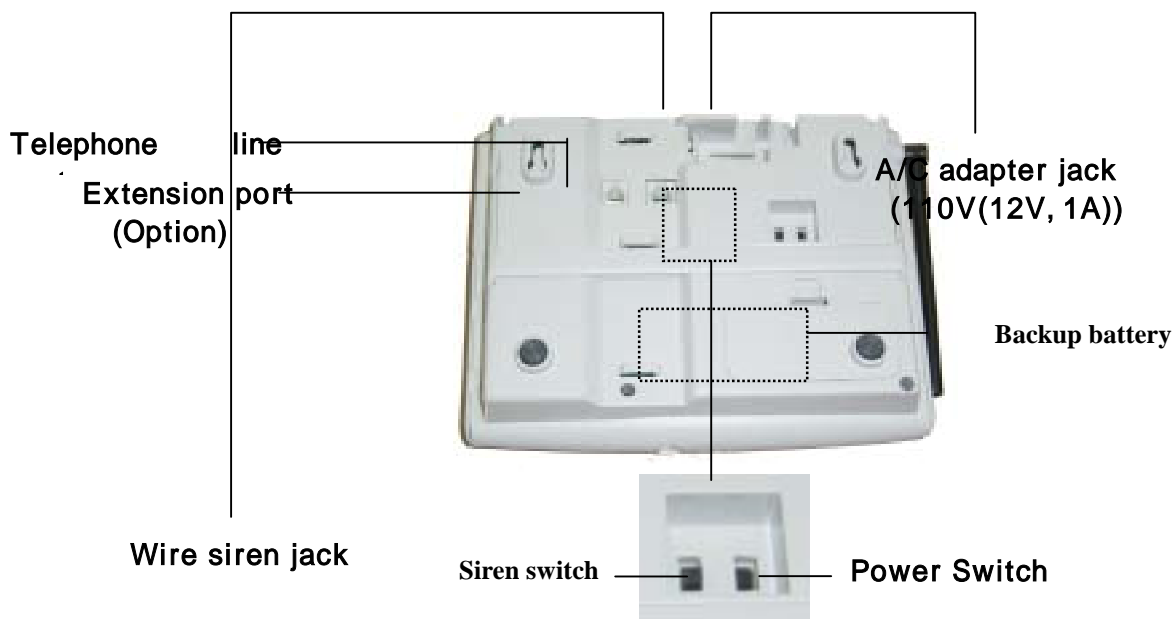

● Remote controller

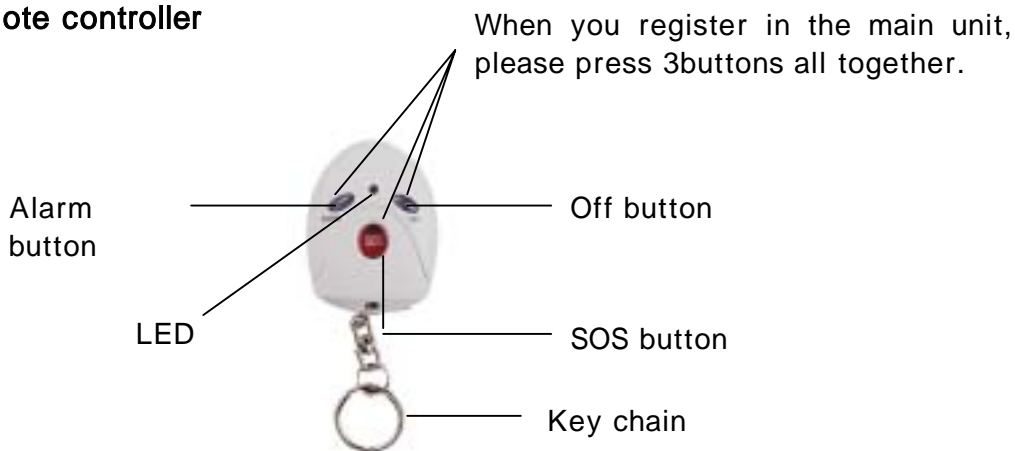

● Motion Detector



You can open lid as the above pictures.



Power Switch

Please turn on switch when you register in the main unit.

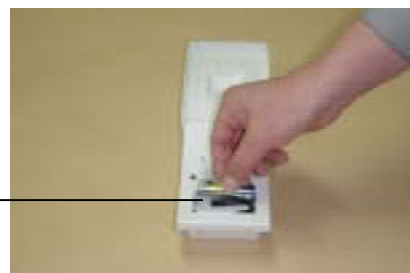

Open the lid and replace all batteries when necessary with: AA - 1.5x4ea

Main function

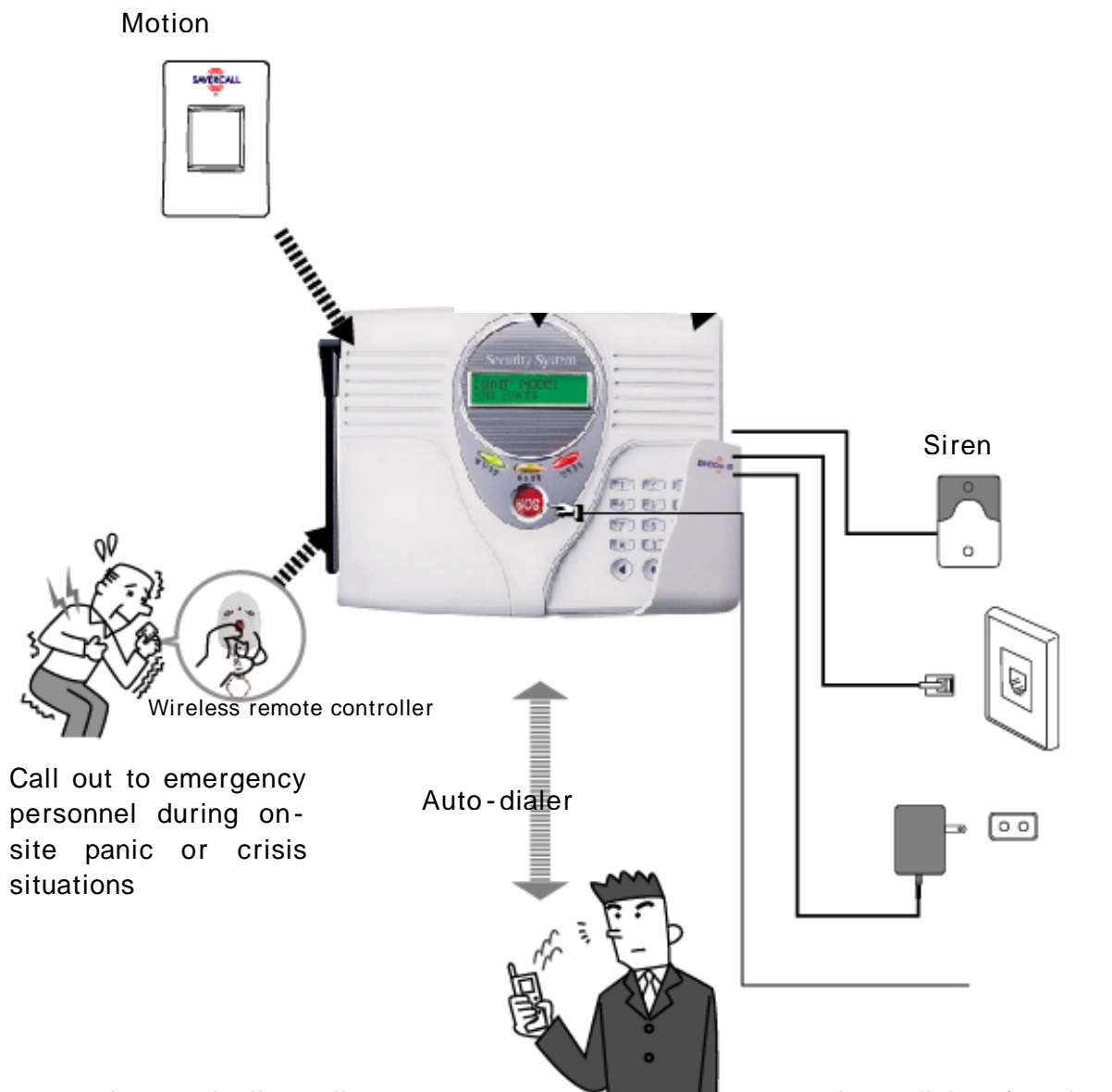

- Automatically calls up to five specified phone numbers upon alarm activation & plays pre-recorded voice messages
- Monitor situation or speak

Auto-dialer function through SOS button

Installation & Setup

- How to install main unit.



- To connect main unit and telephone line.



- To connect A/C adapter(AC220V 60HZ, DC9V/500mA)

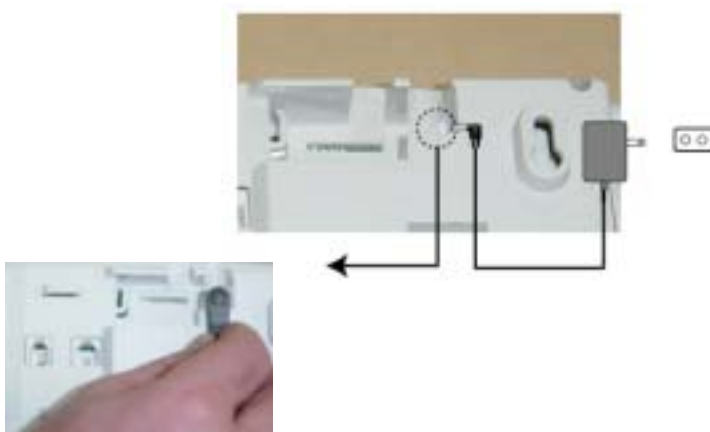

How to install Motion detector

Mount the Motion Detector utilizing the included mount and screws.

* Please note, if you don't follow the diagram and details listed below, detection range could be shorter.

- Place the Motion Detector on a wall or desired location (pole, etc.)
- Tilt the Motion Detector slightly downward, approximately a 14° angle
- The detection range covers about a 90° angle horizontally
- The detection distance is approximately 33-ft.
- The Motion Detector and the Controller let users know when to replace the batteries. When battery is low:
 - Buzzer sounds on Motion Detector
 - Controller gives a voice message, "Motion Detector has been activated, low battery"
 - Open the lid and replace all batteries when necessary with: 1.5V(AA size)x4ea

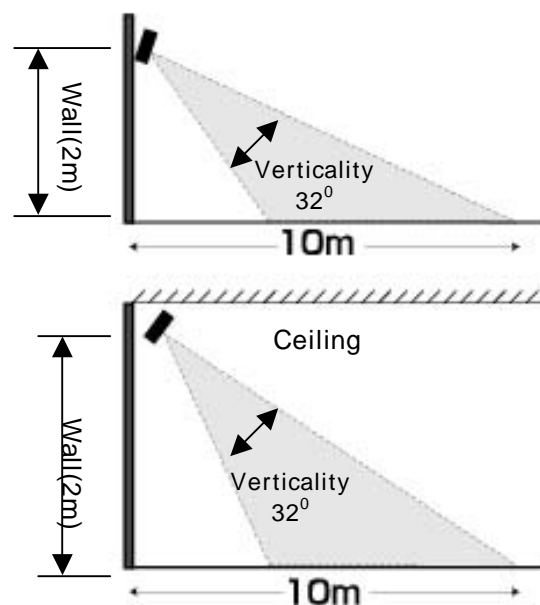
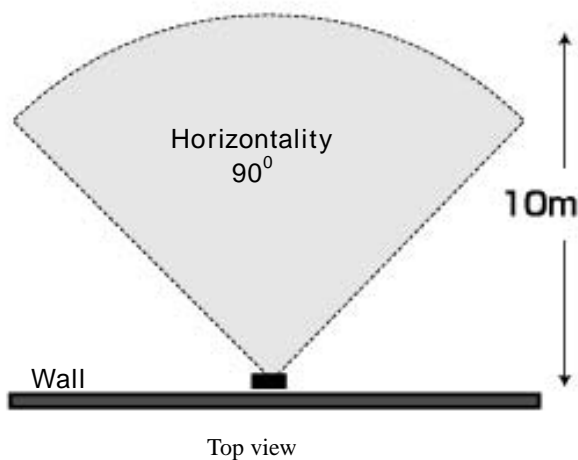
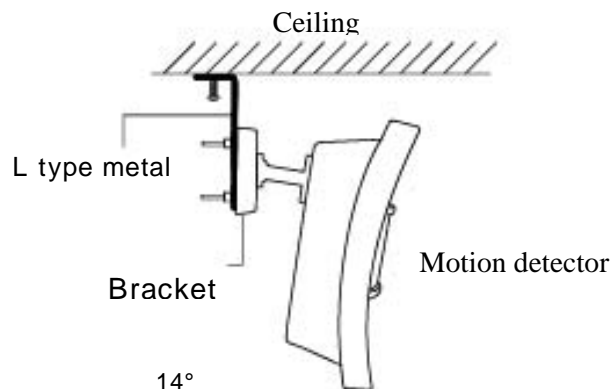
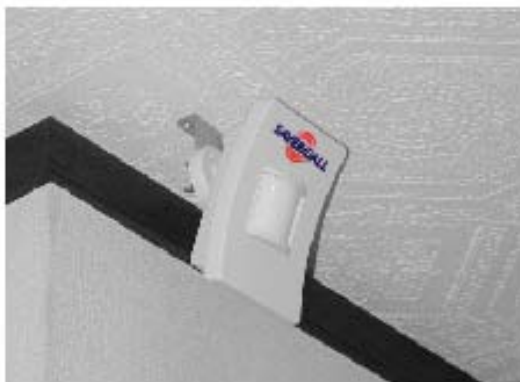
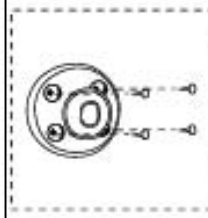

How to set up Main unit.

Initial setup

To activate **WAIT/SET** into the "Setting Mode" for the first time, follow the steps below:

- 1) Plug in A/C Adaptor to main controller
- 2) Turn on the main controller power in the back side with pressing **WAIT/SET** key
- 3) You will hear "ding" then you will enter setting mode.
- 4) Green LED will be blinking in the setting mode

L C D	0=Exit 1=ID 2=Sensor memory 3=Recording 4=Delaying alarm 5=Phone number 6=Time 7=Others
	Select >>
VOICE	This is setting mode. Please select the function number.

* If you cannot see the above menu, please start from 2) after turning off system

Note: Please note that '1=ID', '2=Sensor memory', '3=Recording', '5=Phone number' are essential menu. User must set up for normal working of this system.

<Main Menu>

“1” To set password [1=ID]

Create & SET/WAIT a 4-digit Password(=ID Number) that will be needed for programming, editing or accessing the system through the keypad on Control Panel or Remotely by Telephone.

K E Y	1
L C D	ID =
VOICE	Please input the password. Please press set key after finishing.

Example: If you input password “1 2 3 4”

K E Y	1 + 2 + 3 + 4 + WAIT/SET
L C D	ID =1234
VOICE	1,2,3,4, The data is entered.

* Please note that password should be 4digits.

To Confirm the password you inputted

L C D	ID=1234 1=ok 2=change
VOICE	Password 1 2 3 4, Press no.1 for selection, press no.2 for change.

Please press 1key for selection or press 2key for change.

“2” sensor(Remote controller)registration. [2=sensor memory]

K E Y	2
L C D	Activate Sensor
VOICE	Please activate sensor and remote controller.

Please activate any sensors (Remote Controller, Motion detector) one by one to register.

*Number of extension sensor is total 60pcs.

To register sensors.

- Remote controller

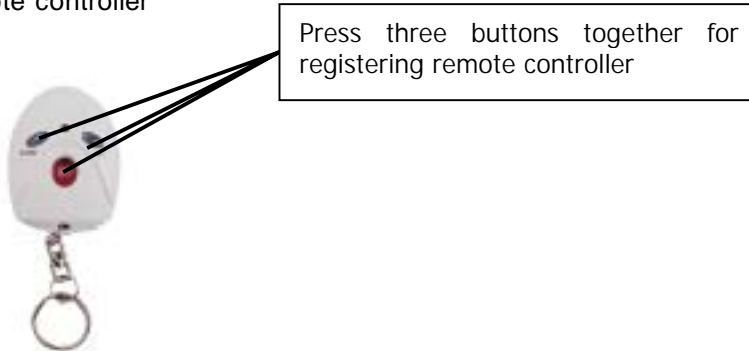

When you register "Remote controller" (Please press "ALARM", "OFF", "SOS" together)

L C D	Remote
	Sensor No=
VOICE	Please input remote controller& sensor number. Please press set key after finishing.

If you assign "remote controller" as no.1 (You can register sensor from no.1 to no. 30)

K E Y	1 + WAIT/SET
L C D	Remote
	Sensor No=1
VOICE	1, the data is entered.

If you input wrong key, you will hear the below voce.

VOICE	Please input again
-------	--------------------

To confirm sensor you registered. (Remote controller: Please press "ALARM", "OFF", "SOS" together)

L C D	Activate
	Sensor
VOICE	Please activate sensor and remote controller.

If you assign "remote controller" as sensor no.1

L C D	Remote 01
	1=ok 2=change
VOICE	Remote controller, No.1, Press no.1 for selection, press no.2 for change.

If you want to select, press **1** key. If you want to change, press **2** key.

If you select the change (no.2), you will see the below message.

L C D	(1 ->30)Sensor No
	=
VOICE	Please input sensor number. Please press set key after finishing.

- Motion detector

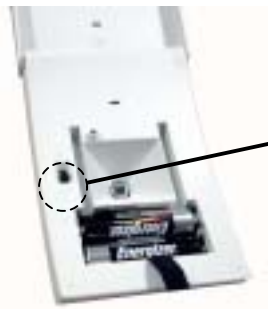

**Please turn on the Power Switch.
You will see LED blinking light**

When you register "Motion detector", please turn on switch.

L C D	Motion sensor
	Sensor No=
VOICE	"Motion detector", Please input sensor number. Please press set key after finishing.

If you assign "Motion detector" as no.3(You can register sensor from no.1 to no. 30)

K E Y	3 + WAIT/SET
L C D	Motion detector
	Sensor No=3
VOICE	3, the data is entered.

To confirm sensor you assigned.

L C D	Activate
	Sensor
VOICE	Please activate sensor and remote controller.

If you assign "Motion detector" as sensor no.3

L C D	Motion detector 03
	1=ok 2=change
VOICE	Remote controller, No.3, Press no.1 for selection, press no.2 for change.

If you select the change (no.2), you will see the below message.

L C D	(1 ->30)Sensor No
	=
VOICE	Please input sensor number. Please press set key after finishing.

"3" Leave user message [3=recording]

To record alarm notification message [3=Recording]
Speak slowly & clearly while recording (Max. 30 seconds)

K E Y	[3] + [Message and address recording] + <u>WAIT/SET</u>
L C D	Record address
	Press any key
VOICE	Please leave your message after the beep and then press set key.

Then user message will be revived as follows:

L C D	Record address
	Confirm address
VOICE	



To select user messages

L C D	Record address
	1=ok 2=change
VOICE	Press no.1 for selection, press no.2 for change.

Please press no.1 key for selection, press no.2 key for change

“4” To input alarm delay time [4=Delaying alarm]

To input alarm delay time [4=Delaying alarm]

Silent Activation delay while you enter the alarmed zone

K E Y	4
L C D	Delay time [15]
	1=ok 2=change
VOICE	Alarm delay time,15seconds, Press no.1 for selection, press no.2 for change.

The default time is 15seconds. You can set from 1sec. to 99sec.

Please press 1key for selection, press 2key for change.

When you select “change” of alarm delay time

L C D	Delay time
	=
VOICE	Please input the alarm delay time. Please press set key after finishing.

If you set “alarm delay time” as 30seconds

K E Y	<u>3</u> + <u>0</u> + <u>WAIT/SET</u>
L C D	Delay time
	=30
VOICE	3, 0, The data is entered.

From the next step, registration will be same as above instructions.

“5” To input telephone number

To input telephone number [5=Phone number]

You can input maximum 5 telephone numbers and within 20 digits.

K E Y	[5]
L C D	1 Phone number
	=
VOICE	Please input the first telephone no. Please press set key after finishing.

If you input the first telephone no. “02-861-5333”.

K E Y	[0] + [2] + [8] + [6] + [1] + [5] + [3] + [3] + [3] + [WAIT/SET]
L C D	Phone number 1
	=028615333
VOICE	0, 2, 8, 6, 1, 5, 3, 3, 3, The data is entered.

To confirm the first telephone number you inputted

L C D	1=028615333
	1=ok 2=change
VOICE	The first telephone number 0,2,8,6,1,5,3,3,3, Press no.1 for selection, press no.2 for change.

To register from the second to the fifth telephone numbers.

K E Y	[Input user telephone number] + [WAIT/SET]
L C D	Phone number [2 ~ 5]
	=[Input user telephone number]
VOICE	(Input user telephone number), the data is entered.

Same as above instruction.

To register extension telephone number.

(Example: to register 02-861-5333 as extension code 9)

K E Y	[9] + [ALARM AWAY] + [0] + [2] + [8] + [6] + [1] + [5] + [3] + [3] + [3] + [WAIT/SET]
L C D	[1 ~ 5] Phone number =9W028615333
VOICE	9, WAIT, 0, 2, 8, 6, 1, 5, 3, 3, 3, the data is entered.

Same as above instruction.

To register telephone number of pulse system(example: 012-345-6789)

K E Y	[ALARM AWAY] + [0] + [1] + [2] + [3] + [4] + [5] + [6] + [7] + [8] + [9] + [WAIT/SET]
L C D	[1 ~ 5] Phone number =P0123456789
VOICE	PULSE, 0, 1, 2, 3, 4, 5, 6, 7, 8, 9, the data is entered.

“6” To set up the current time / day

To set up the current time [6=Time]

K E Y	[6]
L C D	Time [HH:MM]? 12:00 AM
VOICE	Please set the current time. Please press set key after finishing.

Example-The current time is A.M 8 : 12

K E Y	[0] + [8] + [1] + [2] + [WAIT/SET]
L C D	Time [HH:MM]? 08:12AM
VOICE	0, 8, 1, 2

To set up the current day [6=Day]

L C D	Day [YY/MM/DD]?
	2000/01/01
VOICE	Please set the current day. Please press set key after finishing.

Example - The current day is 2003.09.12

K E Y	0 + 3 + 0 + 9 + 1 + 2 + WAIT/SET
L C D	Day [YY/MM/DD]?
	2003/09/12
VOICE	0,3,0,9,1,2

“0” To finish Set mode [0=EXIT]

K E Y	0
L C D	0=Exit 1=ID 2=Sensor memory 3=Recording 4=Delaying alarm 5=Phone number 6=Time 7=Others
	Select >>
VOICE	The setting is accomplished

Then you will enter “wait mode”.

L C D	WAIT mode
	9/12 8:12.AM
VOICE	This is wait mode.

*Please note that “1=ID”, “2=Sensor memory”, “3=Recording”, “5=Phone number” are essential menus.

Ex) if you don't set “password” & “recording”, you will hear

VOICE	Password, Recording, not yet set
-------	----------------------------------

“7” To set up additional menu

To set up additional menu [7=Others]

K E Y	7
L C D	Others: 0=Exit 1=Delay tone 2=Remote sound 3=Chime bell 4=Ringer sound select >>
VOICE	Please select the function number.

<Additional Menu>

“1” To set up delay tone

To set up delay tone

K E Y	1
L C D	Delay tone [1] 1=select 2=not
VOICE	Delay tone, press no.1, otherwise, press no.2

“2” To set up remote controller sound

To set up remote controller sound

K E Y	2
L C D	Remote sound [1] 1=select 2=not
VOICE	Remote controller sound, press no.1, otherwise, press no.2

If you want to use this function, please press no.1, otherwise, press no.2

“3” To set up chime bell sound

To set up chime bell sound

K E Y	3
L C D	Chime bell [1]
	1=select 2=not
VOICE	Chime bell sound, press no.1, otherwise, press no.2

“4” To set up ringer sound

To set up telephone ringer sound when main unit receive call.

K E Y	4
L C D	Ringer sound [2]
	1=select 2=not
VOICE	Ringer sound, press no.1, otherwise, press no.2

“5” To set up CID function

To set up CID function [5=CID function]

K E Y	5
L C D	CID usd? [2]
	1=select 2=not
VOICE	CID, press no.1, otherwise, press no.2

“6” To set up morning call

To set up morning call [6=Morning call]

K E Y	6
L C D	Morning call [2]
	1=select 2=not
VOICE	Morning call, press no.1, otherwise, press no.2

Ex) If you set up (A.M) 6:30,

K E Y	0 + 6 + 3 + 0 + WAIT/SET
L C D	Morning call
	06:30 AM
VOICE	0,6,3,0

“7” To set up auto mode

To set up auto mode [7=Ringer time]

K E Y	7
L C D	Auto mode? [2]
	1=select 2=not
VOICE	Auto mode, press no.1, otherwise, press no.2

“8” To set up siren time

To set up siren time [8=Siren time]

K E Y	8
L C D	Siren time [30]
	=
VOICE	Please input siren time. Please press set key after finishing.

“9” To set up ringer time

To set up ringer time [9=Ringer time]

K E Y	[9]
L C D	Ringer time [12]
	=
VOICE	Please input ringer time. Please press set key after finishing.

“10” To set up guide volume

To set up guide volume [10=Guide volume]

K E Y	[] or []
L C D	Guide volume
	=down =up
VOICE	Please control the volume with volume key. Please press set key after finishing.

“0” To finish additional menu

To finish additional menu [0=Exit]

To finish additional menu and return to the main menu.

K E Y	[0]
L C D	0=Exit 1=ID 2=Sensor memory 3=Recording 4=Delaying alarm 5=Phone number 6=Time 7=Others
	select >>
VOICE	Please select the function number.

To finish set mode

To finish set mode

- * In the main menu -> 0 = Exit (To finish set mode and turn to wait mode)
- * In the additional menu -> 0 = Exit (To finish additional menu and turn to main menu)
- > 0 = Exit (To finish set menu and turn to wait menu)

K E Y	0
L C D	0=Exit 1=ID 2=Sensor memory 3=Recording 4=Delaying alarm
	5=Phone number 6=Time 7=Others
	select >>
VOICE	The setting is accomplished.

Then you will hear:

VOICE	This is wait mode
-------	-------------------

Examples of How *Savercall-3000* Works

Burglary Example

- When you are out, please set "Alarm away" mode. All sensors will be activated.
- When you are in your home, please set "Alarm home" mode. All sensors without motion detector will be activated.
- If intruder enters your home, *Savercall-3000* will activate as below:

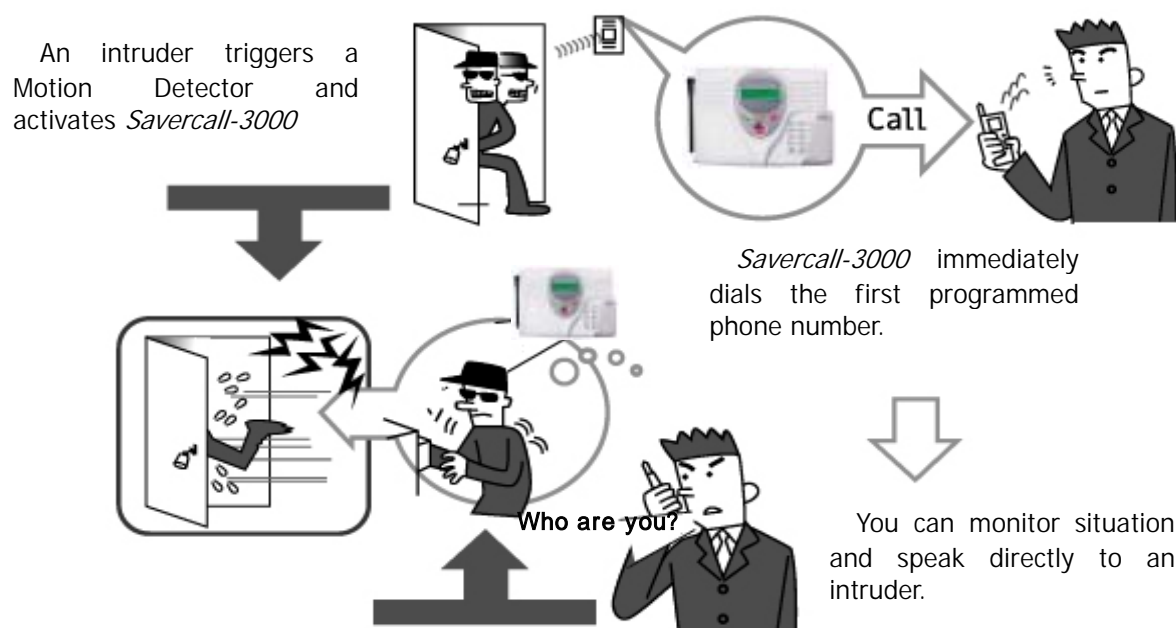

Time chart

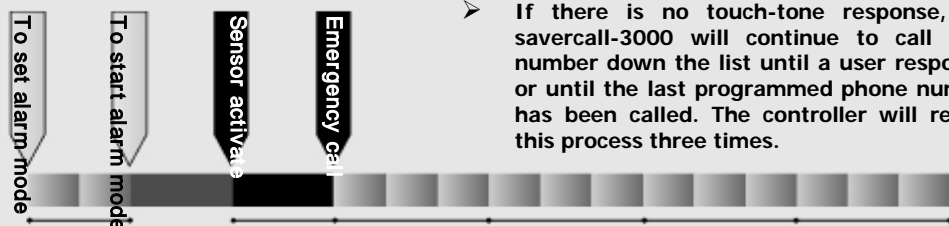

- *Savercall-3000* immediately dials the first programmed phone number.
- If there is no touch-tone response, the *savercall-3000* will continue to call each number down the list until a user responds, or until the last programmed phone number has been called. The controller will repeat this process three times.

Emergency Call Example



The user presses and holds the red **SOS** button on the Keychain Remote or main controller.

Savercall-3000 immediately dials the last programmed phone number with ringing Siren



You can monitor situation and speak directly to an intruder.

[USER GUIDE]

1. To enter set mode

When you are in "Wait mode".

Press **WAIT/SET** + 4digit password (Ex: password is "1 2 3 4")

K E Y	WAIT/SET + 1 + 2 + 3 + 4
L C D	ID =*****
VOICE	This is setting mode.

When you are in "alarm(alarm away & alarm home)" mode.

If you press press **WAIT/SET** + 4digit password, you will enter "wait mode",

Then please follow in order to enter "set mode".

2. To enter alarm away mode

- By Keychain Remote – Press the **Alarm** button
- By Keypad on the main unit – **Alarm Away** + Press **(Password)**
- Remotely by Telephone – Press **(Password)** + **5**

Details:

- LED on Controller lights RED
- Controller begins counting down before arming.

L C D	ALARM AWAY 9/12 8:12.AM
VOICE	This is alarm-away mode

3. To Enter Alarm home mode

- By Keychain Remote – Press the **Alarm** button in Alarm away mode.
- By Keypad on the controller – **Alarm Home** + Press **(Password)**
- Remotely by Telephone – Press **(Password)** + **6**

Details:

- LED on Controller lights ORANGE
- Controller begins counting down before arming

L C D	ALARM HOME
	9/12 8:12.AM
VOICE	This is alarm -home mode

4. To Enter Wait mode

- By Remote Controller – Press the **OFF** button
- By Keypad on the Controller – **WAIT/SET** + press **(Password)**
- Remotely by Telephone – Press **(Password)** + **4**

Details:

- LED on Controller lights GREEN

L C D	WAIT mode
	9/12 8:12AM
VOICE	This is wait mode.

5. To Call Emergency Ring

- By Keychain Remote – Press the red **SOS** button at any mode
- By Keypad on the Controller – Press the red **SOS** button for 2 seconds at any mode.

Details:

- LED on Controller lights Yellow/Orange/Green blinking
- Loud Siren immediately sounds
- Controller automatically dials the 5th programmed phone number, plays the Alarm Notification message and voice-prompts for a response
- Press **OFF** of remote controller to remove emergency call

6. Receiving & Responding To an Alarm Notification Call

During an Alarm Notification Call, the call recipient will first hear which sensor/detector activated the alarm, then the alarm Notification Message, and finally they will be Voice-Guided to respond to the options in the table below, which the system will run twice.

- If there is a response, *Savercall-3000* will act depending upon receiver's option selection(s)
- If a phone number is busy, or if there is no touch-tone response (DTMF signal) from a receiver (= there is no response in 2times of voice guidance), *SAVERcall-3000* will try calling the next phone number the system will run this process twice.
- This will repeat until a user responds, or until the last programmed phone number has been called

User Function	Voice Guide	Press
Converse via 2-way speakerphone	"To speak, no. 1"	1
Listen only, mute speakerphone at the alarmed zone	"To wiretap, no. 2."	2
Want to start Siren alarm	"To start Siren, no. 3."	3
Enter wait mode	"To enter the wait mode, no. 4."	4
Have Controller stop dialing the programmed phone numbers	"To stop all dialing, no. 8"	8
To hang up the phone and dial the next phone	"To hang up the phone and dial the next, no.9"	9
Hear Voice guidance again	"To hear repeatedly, press no. 0."	0

7. To Enter Control Mode Remotely by Telephone

- SAVERCALL-3000 will receive a call from the outside.
- After you hear "ringer time" you set, you'll enter Remote control mode.
- When *Savercall-3000* answers, you will hear: "ding, ding, ding", then "Please input password."
- Press **(Password)**
- Follow the Voice-Guided instructions

User Function	Voice Guide	Press
Converse via 2-way speakerphone	"To speak, no. 1"	1
Listen only, mute speakerphone at the alarmed zone	"To wiretap, no. 2."	2
Want to start Siren alarm	"To start Siren, no. 3."	3
To enter wait mode	"To enter the wait mode, no. 4."	4
To enter alarm away mode	"To enter alarm away mode, no. 5"	5
To enter alarm home mode	"To enter alarm home mode, no. 6"	6
Hear Voice guidance again	"To hear repeatedly, press no. 0."	0

8. How to use telephone by main unit.

- Press [0]Key in the main unit

K E Y	[0]
L C	Phone number
D	=

- If you want to increase volume, please press [#]
If you want to decrease volume, please press [*]
- To hang up the phone, please press **WAIT/SET**.
- When you receive a call, please press [0]Key.

9. How to use Siren by main unit.

- Savercall-3000 supports inner siren & siren with wire.
- If you select "remote controller sound" in the additional menu, you will hear whistle sound from siren when you activate remote controller.
 Wait mode Press "alarm" key alarm away mode : 1time of whistle sound
 Alarm away mode Press "alarm" key alarm home mode : 2times of whistle sound
 Alarm home mode Press "alarm" key alarm away mode : 1time of whistle sound
 All mode without set mode Press "off" key wait mode : 3times of whistle sound

10. LED status according to mode.

Mode	LED Status
Set Mode	Blinking Green
Wait Mode	Green
Alarm - away Mode	Red
Alarm - home Mode	Orange
Emergency call	Yellow/Orange/Red blink

Savercall-2000 has 3types of LED as follows:

- Green LED : Wait/set mode
- Orange LED: Alarm -home mode
- Red LED: Alarm away mode

Trouble Shooting (Q & A)

Q : What if I forget the password?

A : 1. Please turn off main unit.

2. Please turn on main unit with pressing **SOS** button. Then you will enter initial setting mode after 'Beep'.

Q : If I don't want to use some sensors such as Motion Detector during somebody is in.

A : 1. Enter Alarm home mode.

2. You can't use some sensors that are only installed as alarm away mode.

Q : Why can't I receive phone calls?

A : 1. Check that the programmed telephone number is correct or not.

2. Check that the telephone line is securely connected in the "LINE" port.

Q: If motion dectector doesn't work

A: 1. Please change the the sensor's location and direction to avoid detecing pets.

2. Check that the seonsor is in windy place (ex : around air conditioner, near by window) or sunny place .

Q: If remote controller doesn't work

A: 1. Please turn off the power, and turn on the power after five seconds.

Then operate remote controller.

2. Check remote controller light by pressing button. If light doesn't work, please change battery.



Technical Support, Customer Care & Sales

Technical Support

If you need Technical Support regarding installation, programming or using the *SAVERCALL - 2000* system, please feel free to contact our Technical Support Line at:

Phone : (82-2)861-5333
Email : emark@hjsys.co.kr

Customer Care

If you would like to contact Customer Care with general questions, comments or concerns regarding *Savercall-1000* or any other Hyun Joung Systems' product, please feel free to write to our Customer Care Department at:

Attn: CUSTOMER CARE
Hyun Joung System Co., Ltd.
Seoul, Korea
Email : emark@hjsys.co.kr

Sales

If you need Additional or Optional Accessories for *Savercall-3000*, please feel free to contact our Sales Department at:

Phone : (82-2) 861-5333
Email : emark@hjsys.co.kr

General Information Regarding Savercall-3000

For general information, please feel free to visit our website at:

www.hjsys.co.kr

We at Hyun Joung System co., Ltd. would like to thank you for your patronage, and we look forward to your ongoing support.



Warranty Information

The following product is covered by the Manufacturer's Warranty for a period of one (1) year from the purchase date. All terms and conditions of this warranty are stated within. The purchaser must register (by following the instructions on the attached Warranty Registration Form) within 60 days of the purchase date to qualify for warranty coverage.

Product: **Savercall-3000, Do-It-Yourself Wireless Security System**

Covered by Warranty	Not covered by Warranty
<ul style="list-style-type: none">• Factory defects• Product malfunction <p>*All parts and labor are covered under the conditions of this Warranty. Parts that become obsolete will be kept in manufacturer's stock for up to three years. Manufacturer reserves the right to replace any part with equal or better quality as deemed necessary.</p>	<ul style="list-style-type: none">• Batteries• Damage or malfunction due to customer abuse or negligence• Defects from repair or assembly by an unauthorized service company or individual• Defects from the use of non-OEM, after-market parts or accessories• Defects from natural disasters, including but not limited to: fire; earthquake; flood; lightning, etc.

NOTE: The Manufacturer shall have no liability for any death, personal and/or bodily injury and/or damage to property or other loss, whether direct, indirect, incidental, consequential or otherwise, based on a claim that the Product failed to function.

Warranty claims, repairs and exchanges

Please submit all Warranty claims/requests in a letter to the address listed below, along with any defective merchandise. Please include the following information:

- 1) Your name, address and phone number
- 2) The product name and model number
- 3) The part name or part number being returned
- 4) A description of the defect/malfunction

Hyun Joung System Co., Ltd.

Warranty Registration Form

Hyun Joung System Co., Ltd. now offers two easy ways to register your product under Warranty:

- 1) Register online at www.hjsys.co.kr (Just click on the Warranty Registration Form, fill it out and submit it), **or**
- 2) Fill out this Warranty Registration Form and send e-mail us : emark@hjsys.co.kr

Name: _____

Purchase

Date: _____

Address: _____