

WARNING

To prevent possible **SERIOUS INJURY** or **DEATH** from a moving gate or garage door:

- ALWAYS keep remote controls out of reach of children. NEVER permit children to operate, or play with remote controls.
- Activate gate or door **ONLY** when it can be seen clearly, is properly adjusted, and there are no obstructions to door travel.
- ALWAYS keep gate or garage door in sight until completely closed. NEVER permit anyone to cross path of moving gate or door.



2-Button Remote Control

For use with garage door openers, gate operators or other products that are 315 MHz
Compatible with garage door openers that have a **purple** learn button. The code between the remote control and the receiver changes with each use, randomly accessing over a billion new codes. Refer to your product manual for the location of the learn button.

NOTE: Your product may look different than the products illustrated in this manual.

PROGRAMMING THE REMOTE CONTROL

1

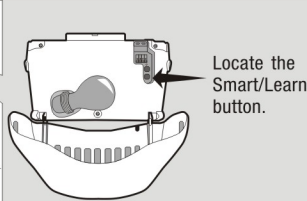
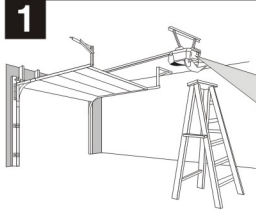

Locate the Smart/Learn button.

2

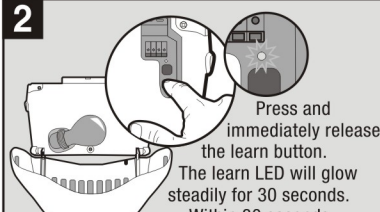

Press and immediately release the learn button. The learn LED will glow steadily for 30 seconds. Within 30 seconds...

3

Press and hold the button on the remote control that you wish to use.

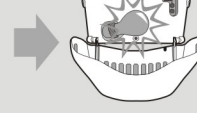
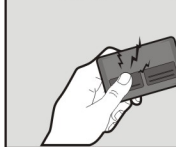

"click"
"click"

Release the button when the garage door opener lights blink or two clicks are heard. If programming to other products, press the button a second time to activate the product.

TO ERASE ALL CODES FROM MEMORY

When deactivating any unwanted remote control code, all previous codes will be erased.

1

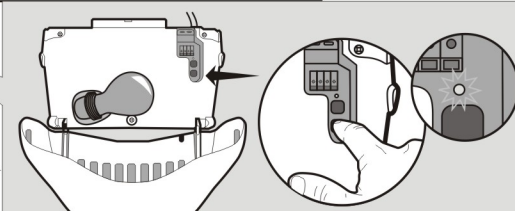
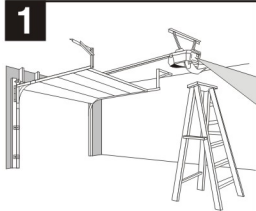

Press and hold the learn button on garage door opener or other product until the learn LED goes out (approximately 6 seconds). All previous codes are now erased. Reprogram each remote control you wish to use.

THE REMOTE CONTROL BATTERY

The alkaline battery should produce power for up to 5 years.
To replace battery:

1

Use the visor clip or screwdriver to try open the cover

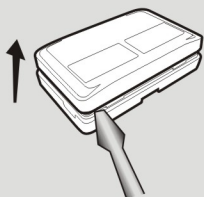

2

Remove the old battery
Dispose of old batteries properly

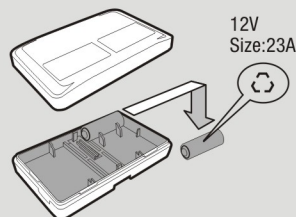

12V
Size:23A

3

Insert replacement batteries ⊕ right side.
Replace the batteries with only 12V / 23A Alkaline batteries

12V / 23A

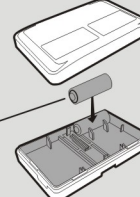

4

Replace cover

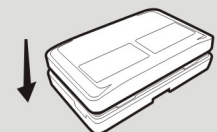

General specification & Feature:

1. Output Power: -37dBm
2. Output Frequency: 315MHz
3. Power Supply: 12Vdc(5Vdc Regulation)
4. Visor clip

Caution

Any changes or modifications in construction of this device which are not expressly approved by the party responsible for compliance could void the user's authority to operate the equipment.

DISTRIBUTED BY
Export Management System Inc.
Hawthorne, CA 90250 USA