



High Definition Sound
Home Audio



APEX ASB-6000

SOUNDBAR

Technical Specifications and Operating Instructions

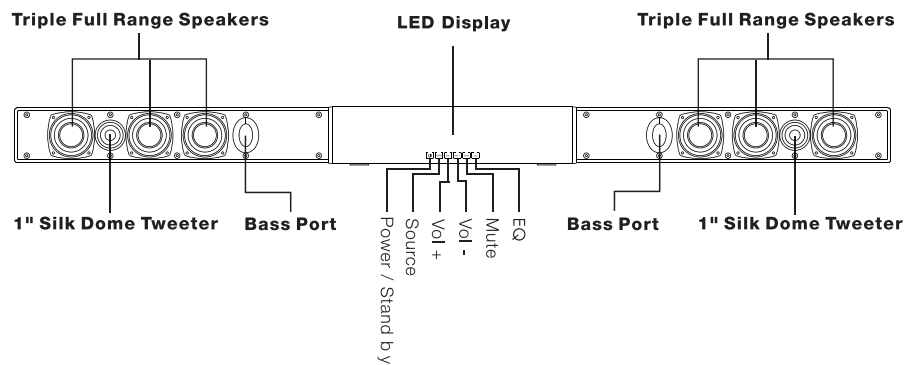

1. ASB6000 Highlights

- Simple One Cable Connectivity
- Supports two Aux, one PCM Digital and one Bluetooth Input Methods
- Fits 50" to 120" TVs
- Customized Sound Processor Circuitry Optimizes the Soundbar to Any Room
- Internal Distortion Limiter to Deliver Crystal Clear Sound
- Provides Clear Dialogue from Movies and TV Programs
- Freestanding or Wall-Mountable
- LED Readout Display
- Multi-Function Remote Control
- Subwoofer Pre-out for Optional Powered Subwoofer



2. What's Included

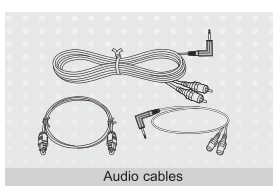

Audio cables



Remote control

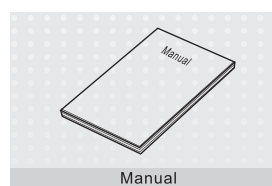

Manual

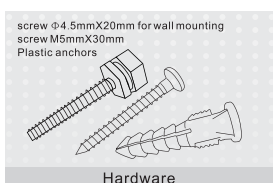

screw $\phi 4.5\text{mm} \times 20\text{mm}$ for wall mounting
screw $\text{M5mm} \times 30\text{mm}$
Plastic anchors

Hardware

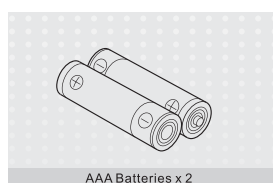

AAA Batteries x 2

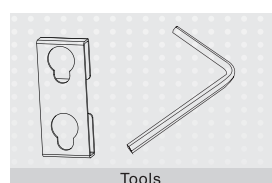

Tools

3. Assemble the Soundbar

The ASB6000 system uses a compact packaging with three sections, the main unit, and the L and R parts of the soundbar. You would to assemble the soundbar first before any of the following setups.

Step 1. Put the main unit face down on a flat surface such as table or floor.

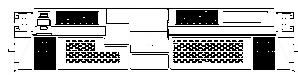

Step 2. Attach the left soundbar part to the left side of the main unit, then attached the right soundbar part to the right side of the main unit. If it is installed appropriately, the three section is fit smoothly.

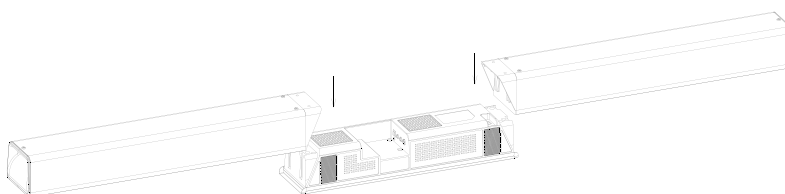



Step 3. Mount the 4 socket head screws and fasten them using the "Hex Key"

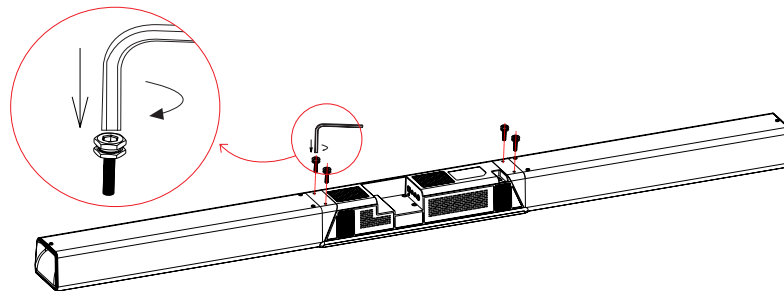

Assembled Soundbar



4. Soundbar Connections

Source Connections (see Fig. 1)

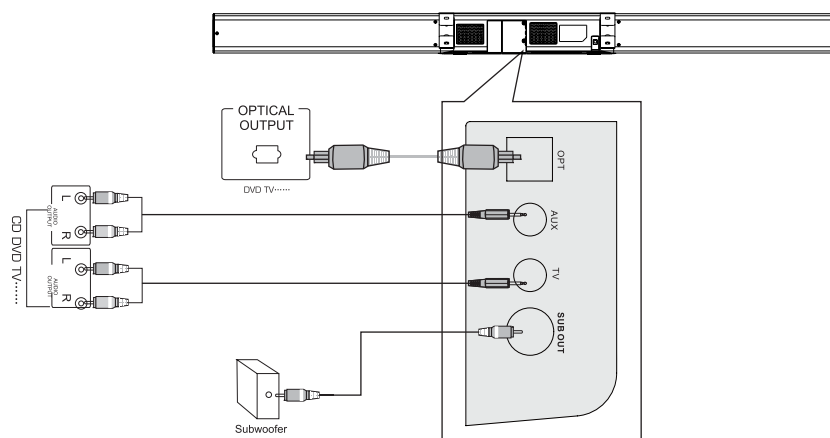

Fig.1 Recommended Audio Connections



Safety Instructions

Please refer to the label on the back of the ASB6000 unit. This provides information on the required main voltage.

In order to make sure that heat dissipates, please setup your ASB6000 unit either freestanding or leave a ventilation gap of at least 5-10cm. Do not block any of the ventilation openings on the appliance itself.

- Do not stack this appliance on top of other appliances
- Switch off attached devices and ASB6000 unit before moving them.
- Switch off all components and ASB6000 unit before connecting or changing cables.
- Switch ASB6000 unit to standby or disconnect it completely from the power supply, especially if you are not using the appliance for a long time.
- Avoid high temperatures caused by direct sunlight or radiators/heaters and protect your speakers from humidity.

CAUTION: TO PREVENT THE RISK OF ELECTRIC SHOCK, DO NOT REMOVE COVER (OR BACK). NO USER-SERVICEABLE PARTS INSIDE. REFER SERVICING TO QUALIFIED SERVICE PERSONNEL.

This product is for general household purposes. Any failure due to use for other than household purposes (such as a long-term use for business purposes in a restaurant or use in a car or ship) and which requires repair will be charged for even during the warranty period.

If any of the following occurs, disconnect the appliance and consult our technicians:

- If the plug or cable are damaged
- If foreign objects or liquid have got into the appliance
- If an appliance has been in direct contact with rain or other water
- If an appliance does not work, even though you have followed the instructions
- If one of the appliances has been dropped or damaged in some other way



WARNING: Handling the cord on this product or cords associated with accessories sold with the product may expose you to chemicals listed on proposition 65 known to the State of California and other governmental entities to cause cancer and birth defect or other reproductive harm. Wash hands after handling.



Inputs:

Analog: Use the supplied audio cable to connect to the soundbar's rear input labeled **TV** and/or **AUX**.

Digital: If your TV (or other source devices; BD & DVD player, satellite receiver, cable box) has a "PCM" digital audio output, you can use a digital toslink cable (one optical cable included) to connect to the soundbar's digital inputs labeled **OPT** (Optical)

Important Memo: The Digital Inputs will operate only using a TV or other source devices with PCM format output. They are NOT Compatible with Dolby Digital format output. If your source device output is directly Dolby Digital output you will not hear audio playback! You need to set up the audio output of the TV or source in "PCM" format before connection. Please refer to the Audio setting in the user manual of the device.

In the event your source device does not have a PCM setting, use the analog inputs as shown in the operating instructions of the soundbar.

Bluetooth: The Bluetooth device name of the system is "APEX ASB6000". When users switch to Bluetooth input method, the Bluetooth logo flashes until your mobile devices such as Smartphone and Tablet connect to the device. When it connects successfully, the Bluetooth logo stays highlight.

Important Memo: Due to Bluetooth protocol, If one device is already being connected to the ASB6000 system, other Bluetooth devices may not be able to search and find the 'APEX ASB6000' device. Please disconnect the existing connection first, then search and connect again.

Output:

Sub Out: (Analog Subwoofer Output) Connect a standard RCA cable (not included) to an optional powered subwoofer's input for additional bass. Follow the instructions included with the subwoofer.

Important Memo: If your TV or other devices do not have RCA (red,white) connectors, you can connect the attached 3.5mm to RCA (red,white) female and 3.5mm to RCA (red,white) male together, to get 3.5mm to 3.5mm audio cable (See Fig. below)

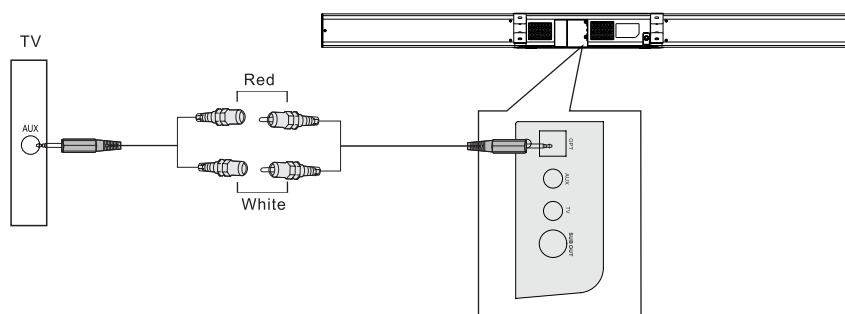

Power Connections (see Fig. 1)

After you have made and verified all of the source connections above, then plug the supplied AC cord into an active, unswitched 110VAC outlet.

Important Memo: For the best sound, it is recommended turning the TV's built-in speakers off. Consult your TV's owner's manual to find out how accomplish this. If you cannot determine how to turn the TV speakers off, adjust the TV's volume so that the soundbar is louder and provides most of the audio.

5. Speaker Location

The ASB6000 system is a high quality playback set suitable for reproducing film and music sound. The sound is automatically in perfect symmetry with the internal satellite speakers. The system is suggested to install below your flat-panel TV.

- Setup height should be between 3ft – 6.5ft (40cm and 2.0m), ideally at ear height to the sitting position. Your listening position should be central and in front of the unit. It also helps to position the unit in a central position between the two side walls.

The bar comes with rubber feet already attached so it will sit securely on any flat surface. If your TV is placed on a table, you can place the soundbar on the table directly in front of the TV stand. Be sure to center the bar under your TV screen. If your TV is housed in a media center, you can place the bar above the TV.



6. Wall Mounting Instructions

Please use strong screws in combination with the wall plugs supplied to guarantee a secure hold. For optimal sound, setup the unit below the TV.

1. Do not place or lean any objects on or against the ASB6000 unit.
2. Please check the ASB6000 unit is mounted securely and recheck at regular intervals.
3. Hardware is provided for drywall or sheetrock installations. If you are trying to mount the bar to masonry you will need to purchase special hardware (not included).

If your TV is wall mounted, the bar can be mounted directly below the TV screen. The rear of the bar has four screws and two brackets with built-in keyhole slots for simple yet secure mounting.

NOTE: To ensure that the soundbar will be level, use a carpenter's level, laser sight or other device to ensure the screw holes are at exactly the same height.

Make sure you have made all the connections on the rear of the bar prior to securing the bar on the wall

Step 1. Mount two brackets into the wall, with 15-3/16 Inches (385mm) in distance. Bolt specification: BA4.5x20mm; Make sure two brackets are straight to avoid mounting the unit crookedly. Make sure the brackets are securely installed.

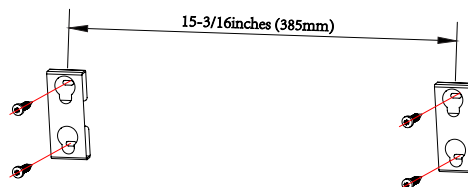

Step 2. Guide the soundbar by aligning the key slots on the two brackets with the four exposed mounting screws on rear of the soundbar. Hang the soundbar on the screws by pushing down as shown.

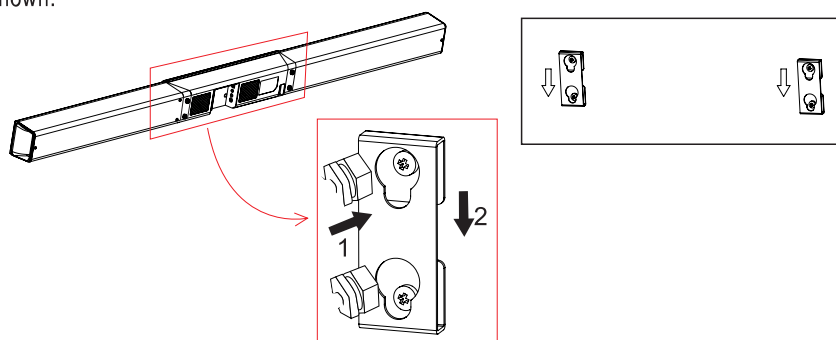

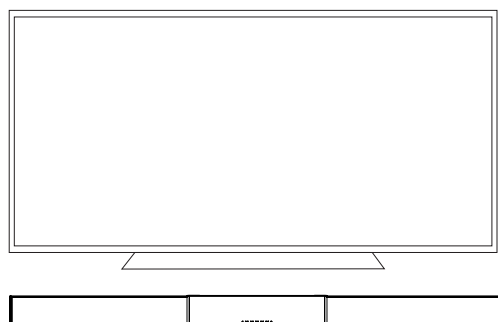

CAUTION: We are not responsible for any accidents or damage that result from improper installation, misuse or modification of the product, or natural disasters.

7. Operating Instructions

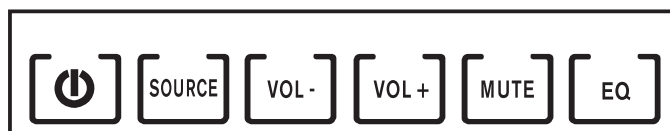

(Fig. 2) Soundbar Front Control Panel

1) POWER

Turns **ON** the soundbar or puts it in standby mode. The LED readout shows a dashed line in the standby mode (- - -).

2) SOURCE

Switches the input source you are listening to. Repeatedly pushing this button will cycle through the LED readout indicating TV, AUX, OPT or Bluetooth.

3-4) VOL -/+

Use these buttons to reduce or increase the amplifier volume. The control ranges from 0 (min) to 30 (max) and is displayed on the LED readout as V 0 through V 30.

5) MUTE

Mutes and unmutes the sound. The LED display will show a flashing dashed line (- - -) while the mute is engaged.

6) EQ

Three EQ modes are available for the system, TV, Movie, Game and News. Please select EQ mode based on your own preference.



8. Remote Control

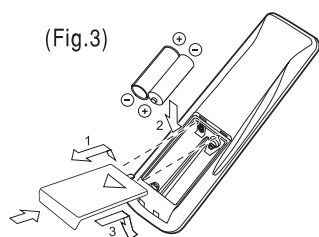

Installing the Battery (Fig.3)

1. Push the (\triangle) sign on the back of the remote control and open the cover
2. Put two AAA battery into the compartment following the polarity markings
3. Close the cover

Note:

- If the remote control operation range decreases, replace batteries.
- Always remove expired batteries.
- Do not use new/used batteries together or mix batteries with different types.
- Do not dispose of batteries in fire, batteries may explode.
- Exhausted batteries may leak. If the batteries have leaked, dispose them immediately.
- Avoid touching the leaked materials. Clean the battery compartment before install new batteries.
- Remove the batteries if the unit will not be used for a long period of time.
- Dispose exhausted batteries properly following your local regulations

Remote Control Range

Point the remote control at the remote control sensor to transmit the commands.

Do not place any obstacles between the remote control and the receiver window. The effective range of the remote control is approximately 20 feet (6 meters) from the front of the receiver window, 30° to the left and right, 20° up and down.

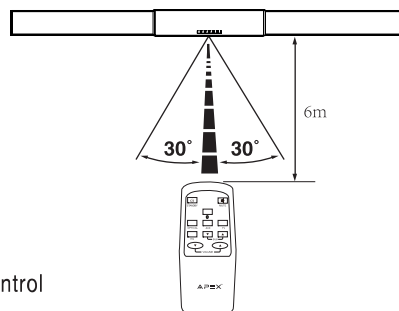

Note:

- Do not spill water or other liquids on the remote control
- Do not drop the remote control
- Do not leave the remote control in following conditions: places of high humidity, places of high temperatures or extremely low temperatures, dusty places.



Operations

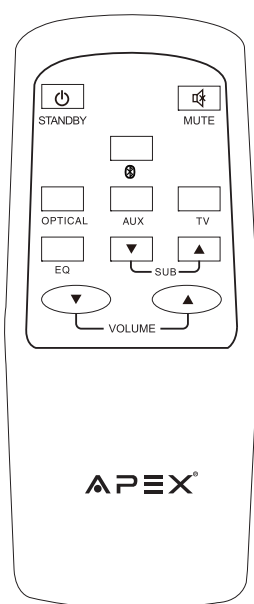

Power

Switches the appliance on and off

Mute

Switches sound playback on and off. The display shows the active mute function.

Aux/TV/Bluetooth/Optical

Press these buttons to select corresponding audio inputs (Aux, TV, Bluetooth, Optical). Note: The Bluetooth device ID is APEX-ASB6000. If switches to Bluetooth, the Bluetooth logo flashes until its pair devices connect to it successfully.

EQ

Switch between TV, Movie, Game and News. The default is Movie.

SUB +/-

These two buttons are used to control the Subwoofer Volume (0-30<max>).

Volume +/-

These two buttons are used to control the Unit volume (0-30<max>).

9. Care and Cleaning

FIRST UNPLUG THE POWER CORD FROM THE WALL OUTLET

Soundbar: Wipe the housing and panel surface gently using only a cleaning cloth or a soft, lint-free cloth.

Do not scratch or hit the surface of the LED display with fingernails or other hard objects. Furthermore, avoid contact with volatile substances such as solvents, chemicals and thinners otherwise the quality of the display may be adversely effected.



10. Trouble Shooting

If a problem should occur, please check through the following advice before contacting our service staff.

No power - Soundbar

- Please check whether the plug is properly inserted in the electrical socket.
- Check to see the wall outlet circuit is live.
- Make sure the power switch in the rear of the soundbar is properly turned on.

No sound or poor sound output

- You may have inserted an incompatible disc. To test this, insert an audio CD into your playback appliance and use the remote control to select the correct input.
- Check whether the television and ASB6000 unit are switched on and ensure the correct program source is selected.
- Check the cable connection between the TV, player and ASB6000 unit.
- Check whether the mute function has been activated.
- Check whether the right input methods are chosen, TV/Aux/Optical/Bluetooth
- If use Bluetooth, please check whether your mobile device and the ASB6000 unit are connected successfully.
- If use Optical input, please check (1) whether your audio play device audio output is set to PCM output, (2) check your optical cable connections

Malfunctions

- If the ASB6000 system malfunctions, disconnect the soundbar from the power supply for at least 10 minutes. Then connect the power supply again. The internal restore function should reset the appliance.

The remote control does not work

- Check whether the batteries are still charged and if necessary replace them.
- Point the remote control at the sensor on the soundbar. Make sure that there are no obstacles between the remote control and ASB6000 unit. Remove these, if necessary.
- Check whether the batteries in the remote control have been inserted with the correct polarity.

The soundbar does not react to input commands

- Switch the soundbar to standby and switch it on again. If this doesn't help, switch the system off completely and then on again. To do this, switch the ASB6000 unit to standby.



Technical Specifications

| | |
|------------------------|---|
| RMS Power | 50W/CH 6 Ohms THD \leq 1% 1K Hz |
| Input Sensitivity | TV/500mV,AUX/450mV |
| Frequency Response | 50Hz-20KHz |
| Sensitivity | 90dB (1m/1w/CH) |
| Maximum Sensitivity | 113dB(1m/100W/2CH) |
| S/N | \geq 75dB |
| Input | AUX,TV,Optical,Bluetooth |
| Output | SubWoofer Line Output |
| EQ | MOVIE, GAME, TV, NEWS |
| Adapter | Input:AC 100-220V 50/60Hz Output: DC24V/4A |
| Installation | Free Standing/Wall Mounting |
| Operating Temperature | 5 $^{\circ}$ -35 $^{\circ}$ C/ 41 $^{\circ}$ - 95 $^{\circ}$ F |
| Operating Humidity | 10% - 75% non-condensing |
| Drive Components | 3 Full Range Speaker x6 Silk Dome Tweeter x 2 |
| Enclosure Construction | ABS |
| Dimensions(L x W x H) | 59.10 " x 3.82 " x 3.00 " |
| Net Weight | 5.0 KG |
| Package Contents | Audio Cables(one optical cable included), Remote Control and Batteries, Operation Manuals, Hardware: screws and plastic anchors |
| Warranty | One Year |



Limited North American Warranty

MODEL:ASB6000

For peace of mind and valuable services, please take a moment to register your product at www.aresmicro.com

Ares Micro Inc expresses the following non-transferable and limited warranty on a new APEX ASB6000 purchased from an authorized Ares Micro ® U.S. retailer. Retain the original bill of sale for proof of purchase.

Limited One (1) Year Warranty

We warrant the parts in this product against defects in material or workmanship for a period of one (1) year from the date of original purchase from an Ares Micro ® authorized retailer. We also warrant labor charges for a period of one (1) year from the date of original purchase. For a list of Ares Micro authorized service centers, please call the Ares Micro customer support line. Service repairs may be made with new or recertified parts. Service that is provided is warranted for the duration of the original warranty or 45 days. If it is determined to have the unit to be sent in for service/replacement, it is customer's responsibility to retain the original packaging or provide secure packaging in order to facilitate any warranty service.

Your Responsibility

The above warranty is subject to the following conditions: You must retain the original bill of sales to provide proof of purchase then call Customer Service for an assessment of the problem. The warranty extends only to defects in materials or workmanship as limited above and does not extend to any other products or parts, accessories that have been lost, discarded, damaged by misuse, accident, neglect, acts of God such as lightning, voltage surges in the home, improper installation, rendered illegible. Warranty does not cover cosmetic damage.

How to Obtain Warranty Service

contact Customer Service directly at (909) 468-9352, Mon. - Fri. from 7 am to 9 pm(CST) , Sat. - Sun. 7 am to 9 pm(CST). You will be instructed on how your claim will be processed. Have information available including date of purchase, serial number and the problem with the product. Should a problem be determined to be within the limits of the warranty you will be provided with an on-site authorization number and instructions. Proof of purchase must be confirmed before any warranty service can be provided. Should a claim not be covered by the limited warranty, you will be asked whether you wish to have service provided for a fee. We may charge the customer for any service call made for anything not covered by the limited warranty.

Limitations

All warranties implied by state law are expressly limited to the duration of the limited warranty set forth above with the exception of warranties implied by state law. The foregoing warranty is exclusive and in lieu of all other warranties, guarantees, agreements etc., with respect to repair or replacement of any parts and also after unit sold 7 days its can not refund. We shall not be liable for consequential or incidental damage or exclusions and imitations of incidental or consequential damages, so the above may not apply to you. For our Pixel Policy, please refer to our website www.aresmicro.com. This warranty gives you specific rights though these rights may vary from state to state. Some states do not allow limitations on the duration of the warranty or exclusions and limitations of incidental or consequential damages, so the above may not apply to you.



Licensed by APEX Inc.

Ares Micro Inc
515 Spanish Ln #C.
Walnut, CA 91789, USA
Tel: (909) 468-9352
www.aresmicro.com
Email: sales@aresmicro.com

Shenzhen Dongyuan Electronics CO.,Ltd

SOUNDBAR 

FCC ID: QRYASB-6000

Model: ASB-6000; Input: AC120V/60Hz, Max Power 350W

This device complies with part 15 of the FCC rules. Operation is subject to the following two conditions (1)This device may not cause harmful interference,and(2)this device must accept any interference received, Including interference that may cause undesired operation.

Changes or modifications not expressly approved by the party responsible for compliance could void the user's authority to operate the equipment.

Note: This equipment has been tested and found to comply with the limits for a Class B digital device, pursuant to part 15 of the FCC Rules. These limits are designed to provide reasonable protection against harmful interference in a residential installation. This equipment generates, uses and can radiate radio frequency energy and, if not installed and used in accordance with the instructions, may cause harmful interference to radio communications. However, there is no guarantee that interference will not occur in a particular installation. If this equipment does cause harmful interference to radio or television reception, which can be determined by turning the equipment off and on, the user is encouraged to try to correct the interference by one or more of the following measures:

- Reorient or relocate the receiving antenna.
- Increase the separation between the equipment and receiver.
- Connect the equipment into an outlet on a circuit different from that to which the receiver is connected.
- Consult the dealer or an experienced radio/TV technician for help.