



American Telecommunications Certification Body Inc.
6731 Whittier Ave, McLean, VA 22101

August 15, 2005

RE: Windigo SYSTEMS

FCC ID: QQFPBTCRMRYC2-X

After a review of the submitted information, I have a few comments on the above referenced Application.

- 1) Please provide bottom view of the RF module/board shown:

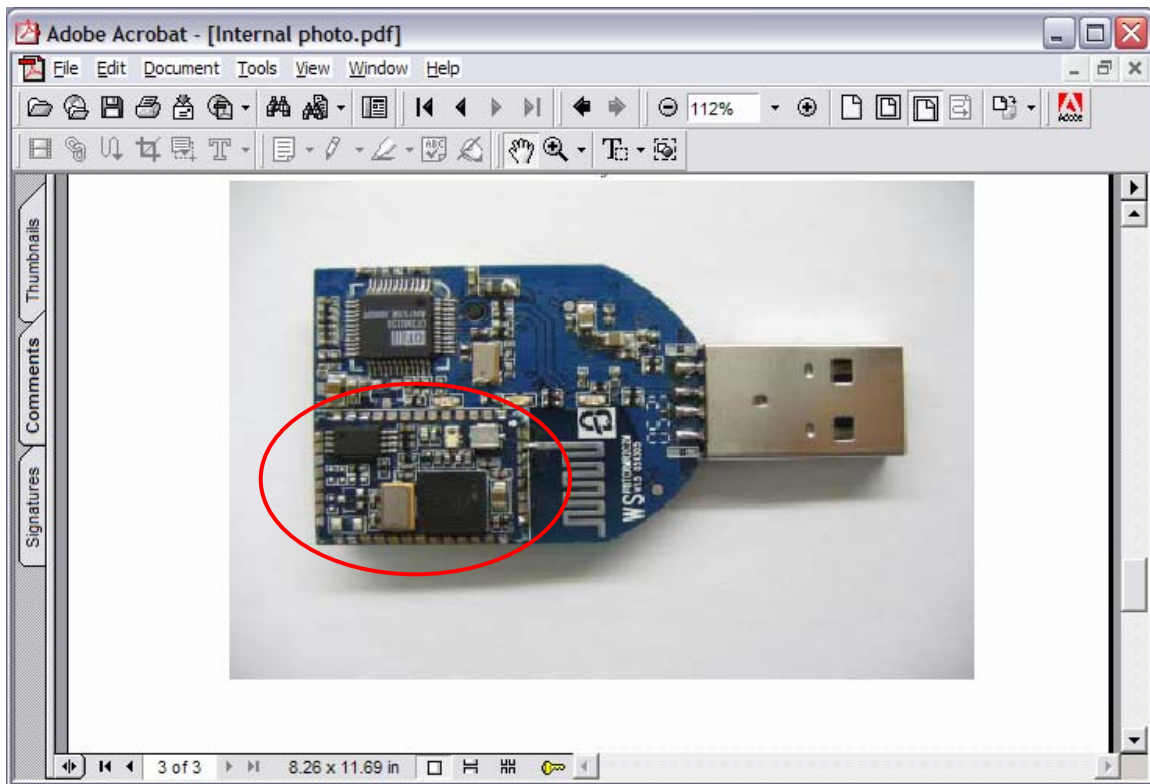

- 2) The block diagram should show the frequencies of all oscillators in the TX portion of the device (CFR 2.1033(a)(5)), unless this portion of the device is an OEM part from a different manufacturer. Please provide either the block diagram for the TX portion, or alternatively provide a parts list that clearly shows this part and the manufacturer of the part is different than the applicant. Please update the list of confidential exhibits if necessary. Please review/correct as necessary.
- 3) The schematics do not include the TX. Note that a schematic for the TX portion of the device is required as specified 2.1033(b)(5) for the RF section. Please provide either a schematic for the TX card or as an alternative, you may provide a parts list that lists that shows that this part is provided by another manufacturer (the parts list should show the manufacturers name as well). Please provide either a schematic or parts list as specified. If necessary, please update the confidentiality letter to include the parts list.

- 4) The labeling exhibit should show a sample label and also the placement of the label on the device. The labeling exhibit provided does not show this. Please correct.
- 5) Please clarify if you are asking for:
 - a) Certification of the device as a TX, and a DoC has been performed by an appropriately accredited test lab for a PC peripheral
 - b) Certification as a TX + PC peripheral

Note 1: The option b) would be considered as a composite application and 2 certificates (one for the TX, one for the PC peripheral portion) would be issued. There are additional review costs associated with this additional certification.

Note 2: To qualify to perform DoC applications, the test lab must be accredited by an acceptable agency and meet the requirement of 2.948(e) to perform testing under the DoC procedure and the device has additional labeling and manual requirements for the DoC. Currently few labs from Taiwan appear as an accredited test lab on the FCC site under 2.948(e). You may need to investigate this issue with your accreditors.

Note 3: Note that for DoC tests, the device is configured with a minimum test configuration as specified by ANSI C63.4 which includes complete computer + 2 I/O devices attached (one may be the EUT).

Note 4: For the remaining part of this current review, it is assumed that the device is being approved under a DoC for the PC portion.

- 5) FYI.....Currently the label does not support DoC approval.
- 6) FYI.....If the PC is subjected to a DoC, the users manual should contain all the following information on a single page. This information does not appear to be provided together in the manual as specified by 2.1077.

COMPLIANCE INFORMATION (47CFR 2.1077)

If a product is tested and authorized under a Declaration of Conformity, a compliance information statement shall be supplied with the product at the time of marketing or importation, containing the following information on a single page:

- (1) Identification of the product, i.e. name and model number.
- (2) A statement similar to that contained in Section 15.19(a)(3) that the product complies with Part 15 of the regulations.
- (3) The identification, by name, address and telephone number, of the responsible party. The responsible party is defined as either the manufacturer, or if the equipment is imported, the importer. The responsible party for a Declaration of Conformity must be located within the United States.



Timothy R. Johnson
Examining Engineer

[mailto: tjohnson@AmericanTCB.com](mailto:tjohnson@AmericanTCB.com)

The items indicated above must be submitted before processing can continue on the above referenced application. Failure to provide the requested information may result in application termination. Correspondence should be considered part of the permanent submission and may be viewed from the Internet after a Grant of Equipment Authorization is issued.

Please do not respond to this correspondence using the email reply button. In order for your response to be processed expeditiously, you must submit your documents through the AmericanTCB.com website. Also, please note that partial responses increase processing time and should not be submitted.

Any questions about the content of this correspondence should be directed to the sender.