

PRELIMINARY

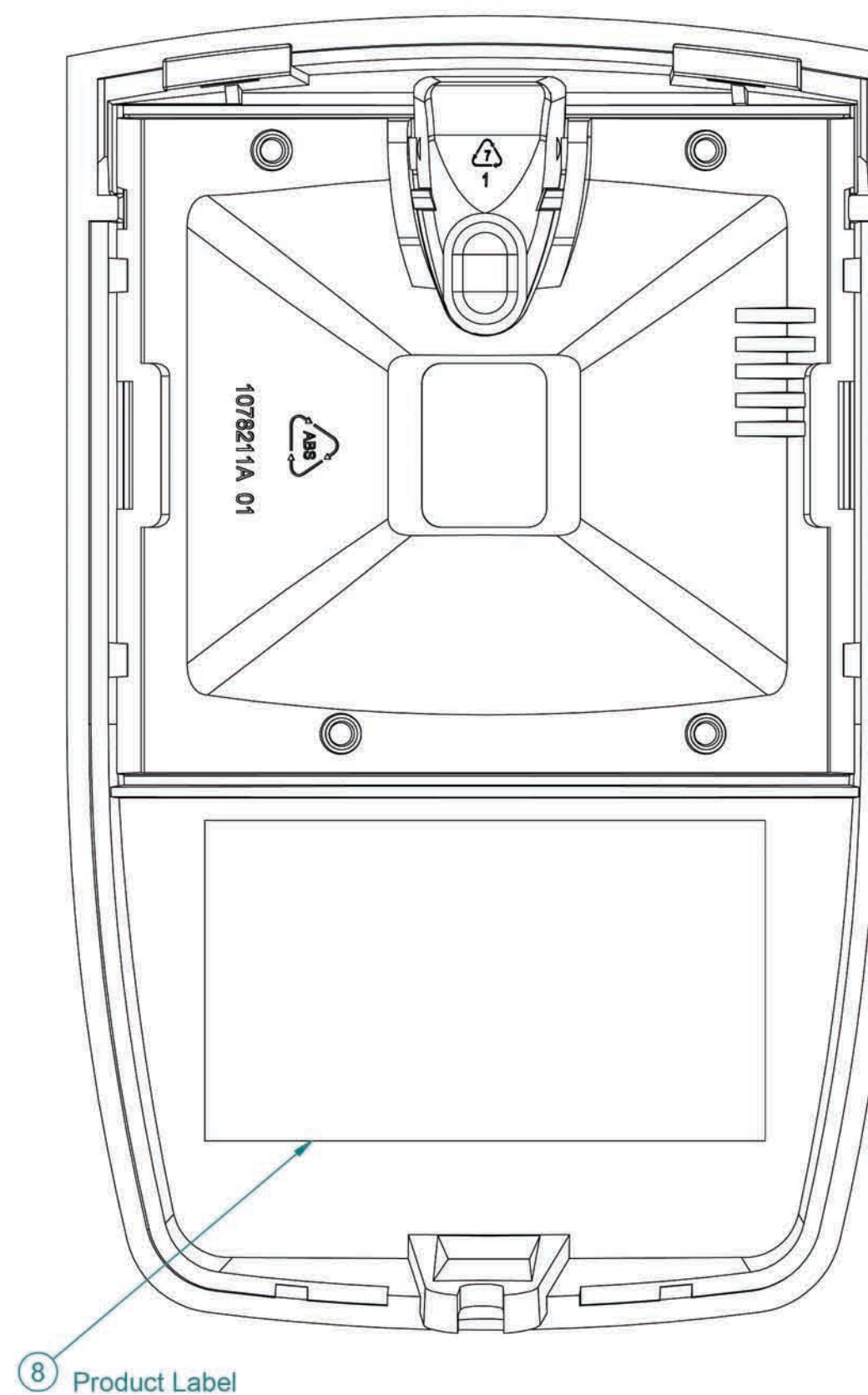
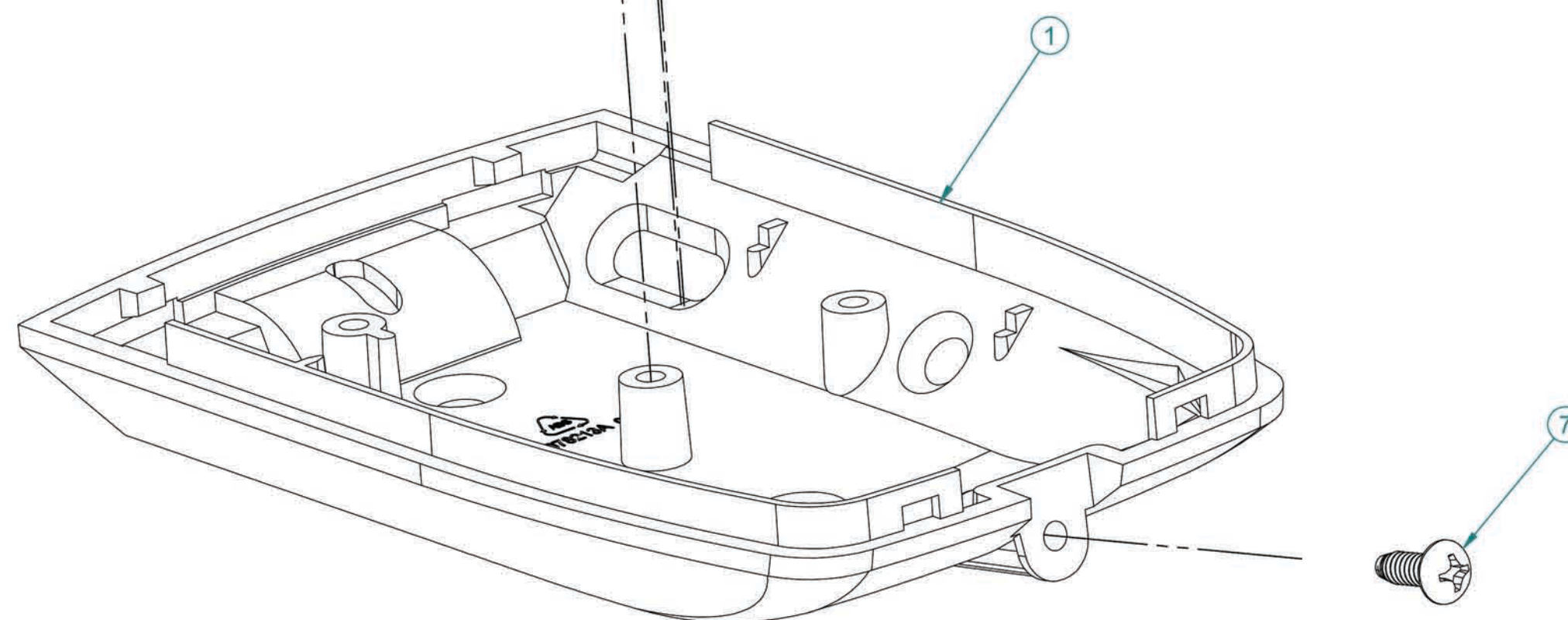
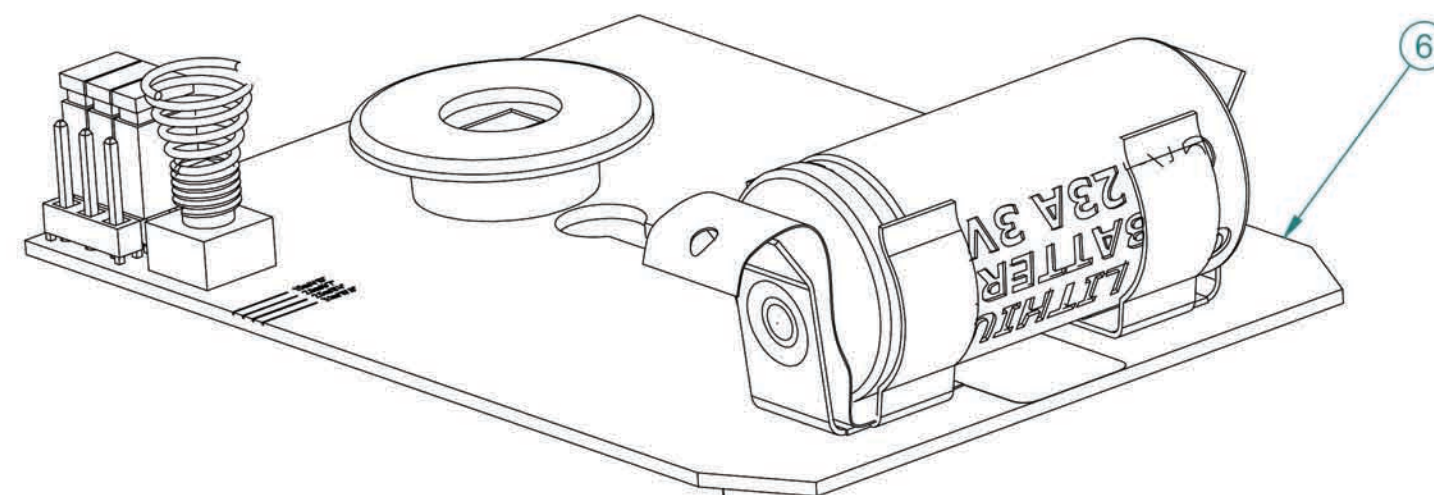
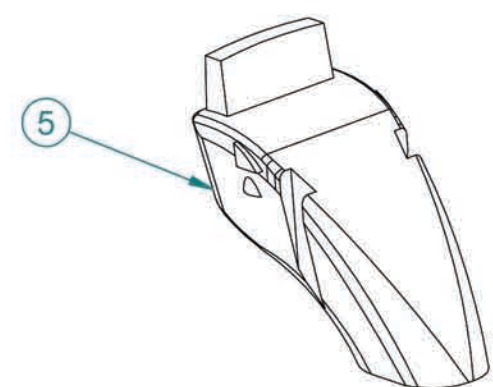
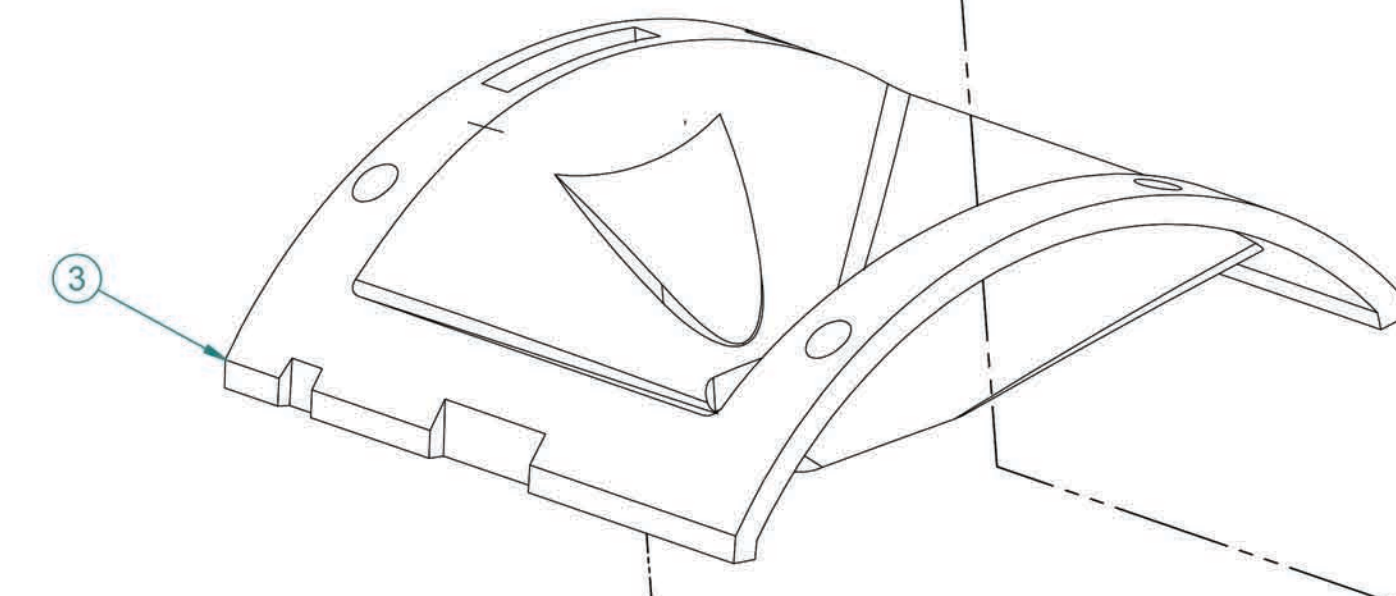
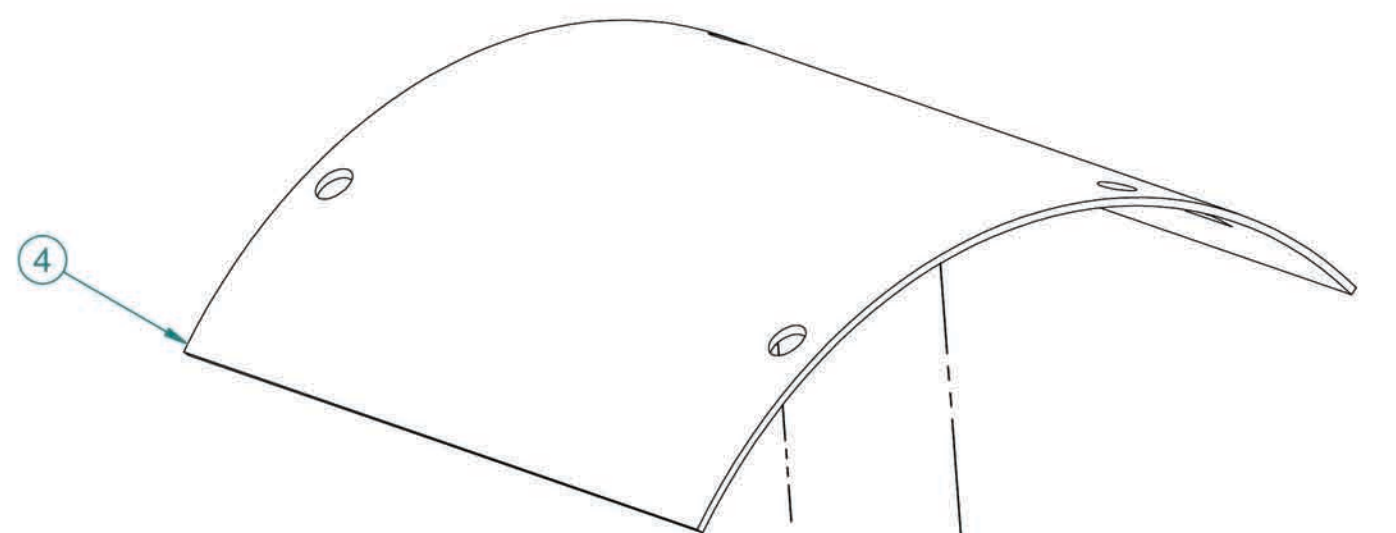
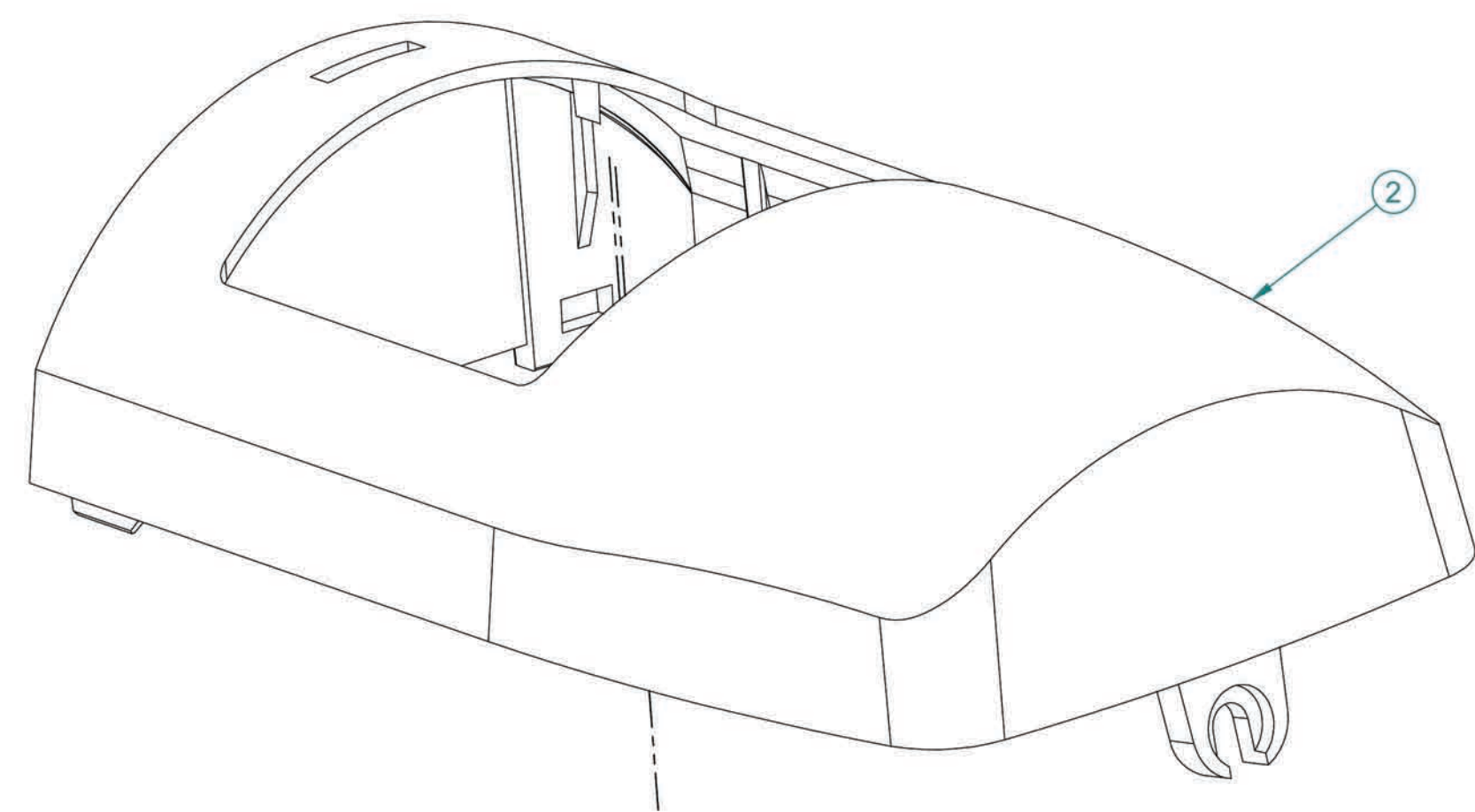

Assembly Notes:

1. PCB Assembly (Item - 6) is mounted by screwing Plastite screw (Item - 7) in the Base housing (Item - 1) as shown.
2. Light Pipe (Item - 5) is snapped into the Focus lens housing (Item - 3).
3. Fresnel lens (Item - 4) is positioned on the projections on the Top cover (Item - 2) and the Focus lens housing (Item - 3) along with Light pipe (Item - 5) snapped, is positioned on the same projections on the Top Cover (Item - 2) and snapped.
4. Product Label (Item - 8) is adhered inside the Top cover (Item - 2) as shown.
5. Top cover (Item - 2), along with Fresnel lens (Item - 4), Focus lens housing (Item - 3), Light pipe (Item - 5) and Product label (Item - 8), is placed by inserting the rectangular slots on the rear end of the Top cover, into the tabs on the rear end of the Base housing (Item - 1) and snapping by pressing towards the front end.
6. Plastite screw (Item - 7) is screwed into the Base housing (Item - 1), to hold the Top and Base housing

EDWARDS, A UTC FIRE & SECURITY COMPANY
8885 TOWN CENTER PARKWAY
BRADENTON, FL 34202-5129
(941) 739-4200

ASM, PRODUCT PIR

SIZE	CAGE CODE	DWG NO.	REV
D	4SPQ6	1078206A	01
SCALE NTS	FILE NAME 1078206A.dft	SHEET 2	OF 2