



R/C Helicopter

INSTRUCTION MANUAL

Sky **COBRA** TM

R/C HELICOPTER INSTRUCTION MANUAL

Sky COBRA™

INTRODUCTION

Thank you for purchasing R/C Helicopter Sky Cobra. Before your first flight, be sure to read this instruction carefully. Then keep this manual in a safe place, so you can refer to it whenever you need to do so.

BATTERY SAFETY INFORMATION

- Be sure to insert batteries as instructed.
- Please use alkaline batteries in the transmitter and charging station.
- Battery life may vary depending on battery brand. The overall performance may decrease as batteries weaken.
- Use only batteries of the type recommended (or equivalent)
- Do NOT mix old and new batteries. Replace all batteries at the same time.
- Remove all batteries if the transmitter and the charging station are not in use for a long period of time.
- Check the metal contact surfaces are clean before installing batteries.
- Due to small parts, batteries should be replaced by adults.
- Dispose batteries safely
- The metal contacts must NOT be short-circuited

CAUTION: The helicopter contains a rechargeable battery. If fluid leaks from the helicopter, avoid contact with eyes and dispose the helicopter immediately. Only use the provided charging unit to charge the helicopter. Do NOT use any other source to charge the helicopter

SAFETY INFORMATION

Please follow the safety rules below when you are flying the helicopter:

- The helicopter is operated by built-in mini rechargeable battery, which does not need replacement.
- Do NOT short-circuit the terminals and metal contact plates.
- Transmitter, charging station and helicopter contain small and delicate parts. Do NOT try to disassemble them.
- Do NOT operate the transmitter while charging the helicopter.
- The helicopter is designed for outdoor playing. Do NOT fly in indoor area.
- Avoid flying the helicopter in extreme weather such as rainy, windy or snowy days.
- Do NOT operate the helicopter during thunderstorm
- Do NOT fly in temperatures above 133°F/ 45°C, or below 50°F/ 10°C.
- Please buy the official AC adaptor only from the dealer of this helicopter. DO NOT use any other AC adaptor to perform battery charging.

PARTS LIST

1. Sky Cobra Helicopter x 1
2. Transmitter x 1
3. Launching Pad Charging Station x1
4. Instruction manual x 1; Important notice x 1

PARTS & NAMES

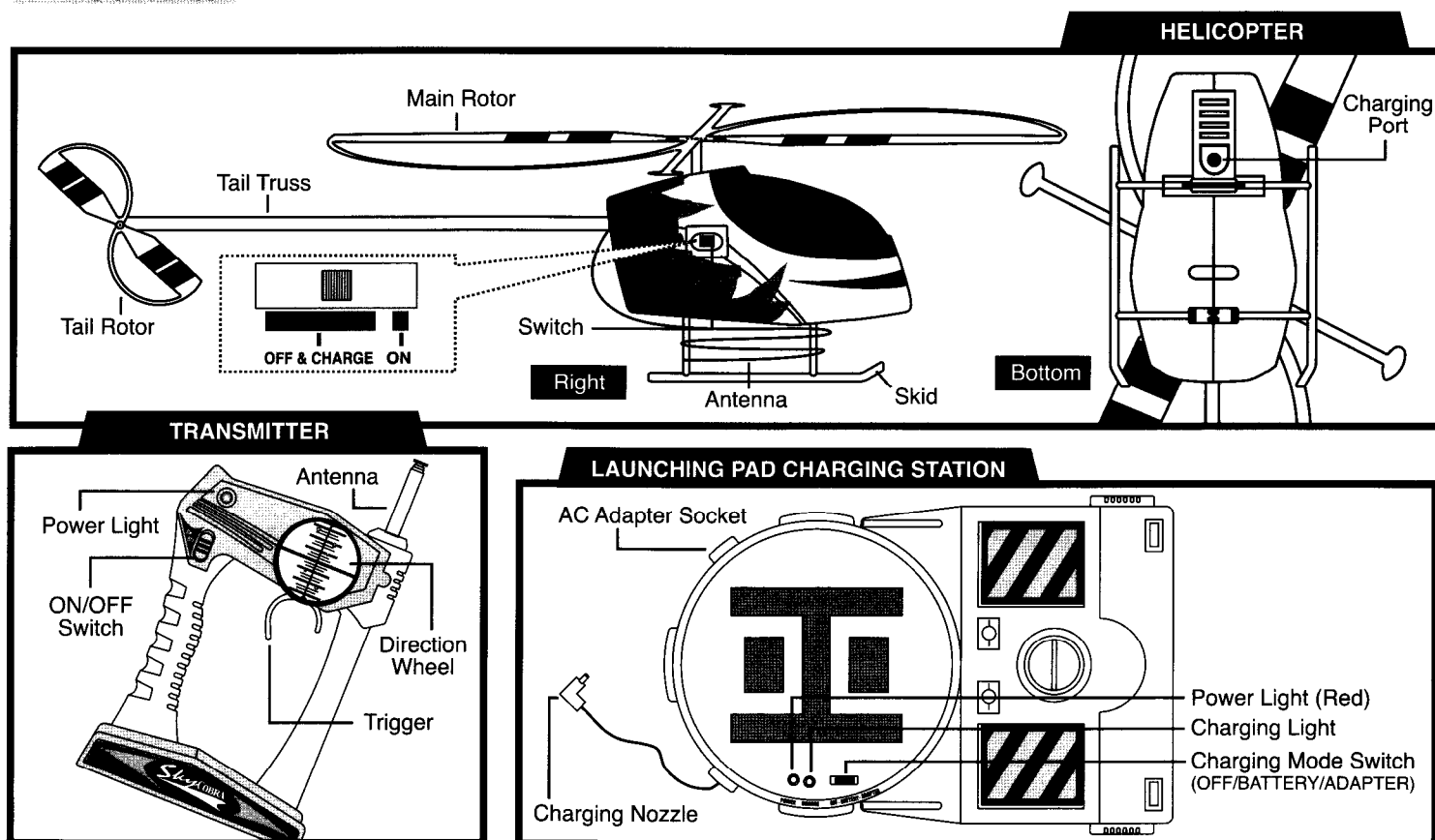

BATTERIES INSTALLATION

- Installing the battery for the Transmitter (requires 9-V alkaline battery x 1pc, sold separately)
 - Unscrew the screw on the battery door.
 - Put the 9-V alkaline battery into the battery compartment.
 - Make sure the positive (+) and negative (-) battery ends are connected correctly with battery clip. Besides, make sure the battery is placed over the ribbon.
 - Close the battery door. Tighten the screw.
- Installing the batteries for the Launching Pad Charging Station (Requires D-type alkaline battery x 8pcs, sold separately)
 - Unscrew the screw on the battery door
 - Install 8pcs of D-type alkaline batteries. Make sure that the positive (+) and negative (-) ends are aligned with the "+" and "-" markings inside the battery compartment.
 - Close the battery door and tighten with screw.
- Installing official AC adaptor (output 12V DC, 800mAh, sold separately) for the Launching Pad Charging Station. Only buy the official AC adaptor from the dealer of this helicopter. DO NOT use any other AC adaptor to perform battery charging. Simply plug the AC adaptor into the wall socket and then put the nozzle into the adaptor socket of Launching Pad Charging Station.

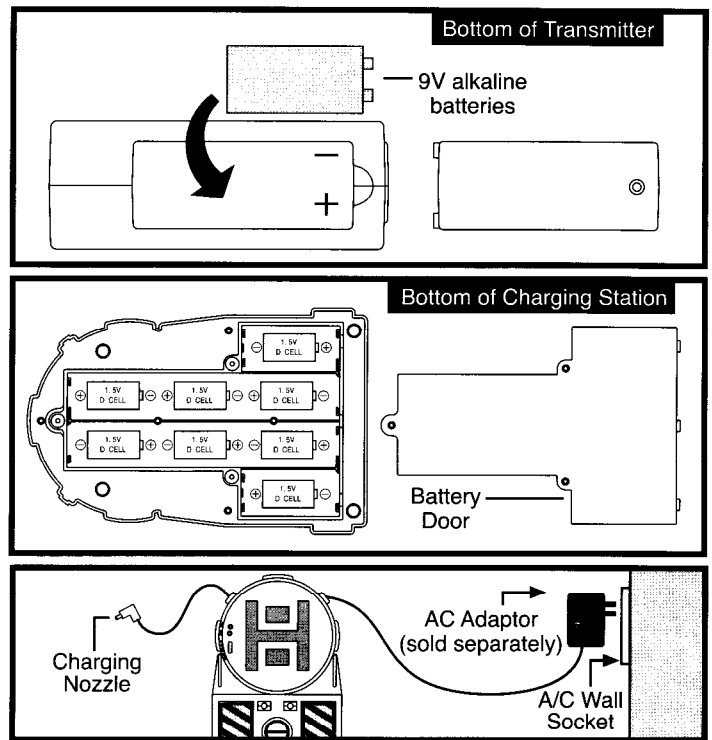

CHARGING THE HELICOPTER

You need to fully charge your helicopter before flying.

IMPORTANT: For the first play of the day, charge your helicopter twice before playing (i.e. after the first charge, please keep the charger ON, unplug the nozzle and then plug the nozzle again into the charging port immediately). For subsequent play of the same day, charge only once. Never double-charge your helicopter after the first play.

A. Charging the helicopter by D-type alkaline battery.

- Make sure you have installed 8pcs of D-type alkaline batteries properly.
- Move the helicopter's switch to the "OFF & CHARGE" position.
- Move the switch of the charging station to the "BATTERY" position.
- Hold the tail truss of the helicopter by one hand.
- Use the other hand to plug the charge nozzle of the Charging Station into the charging port located on the bottom of the helicopter.
- The charging light will be on.
- The normal charging time is 5 minutes. When the charging light is off, the rechargeable battery inside the helicopter is fully charged.
- Switch off the Charging Station by moving the switch to the "OFF" position.
- Unplug the charge nozzle from the helicopter. You are now ready to fly your helicopter.

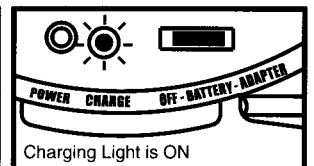
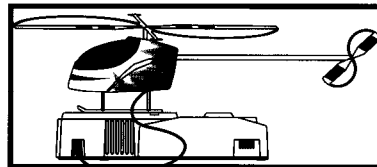
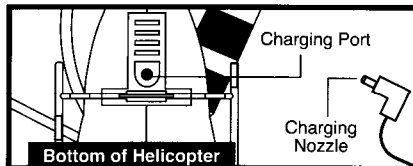
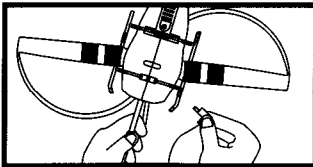

B. Charging the helicopter by official AC adaptor (Sold separately)

- Make sure you have connected the AC adaptor properly.
- Move the helicopter's switch to the "OFF & CHARGE" position.
- Move the switch of the charging station to the "ADAPTER" position.
- Hold the tail truss of the helicopter by one hand.
- Use the other hand to plug the charge nozzle of the Charging Station into the charging port located on the bottom of the helicopter.
- The charging light will be on.
- When the charging light is off, the rechargeable battery inside the helicopter is fully charged.
- Switch off the Charging Station by moving the switch to the "OFF" position.
- Unplug the charge nozzle from the helicopter. You are now ready to fly your helicopter.

FLYING THE HELICOPTER

IMPORTANT: Check the weather/ location carefully before flying the helicopter!

- Select a large, wide-open, grassy area for flying.
- Avoid flying the helicopter in extreme weather such as rainy, windy or snowy day.
- Do NOT operate the helicopter during thunderstorm.
- Do NOT fly in temperatures above 133°F/ 45°C, or below 50°F/ 10°C.
- Check if the location is clear before flying. Do not fly near other people, animals, trees, buildings or overhead wires.
- Do not fly near a public road.
- Check if nobody is playing similar r/c toys around you. Make sure you are using a different band to others in the same area.

1. Prepare to take off

- Make sure the helicopter is fully charged and make sure you have installed the battery into the transmitter properly.
- Turn the helicopter's switch to "ON" position.
- Fully extend the antenna in the transmitter.
- Turn the transmitter's switch to "ON" position, the red power light will be on.
- Check the area again to make sure it is clear.

IMPORTANT! Make sure you are standing at least 5m (15 feet) away from the helicopter when launching. Besides, make sure the head of the helicopter is not placed at a direction facing yourself before launching

2. Taking off

Pull the transmitter's trigger inwards. The harder you pull the trigger, the higher the helicopter will fly.

IMPORTANT: let the helicopter cool down at least 10 minutes after every 4-5 continuous flights!

3. Changing direction

While the helicopter is flying, you can change the direction of helicopter by turning the direction wheel left or right.

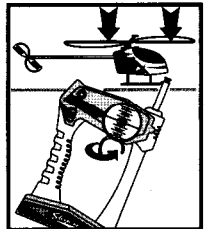
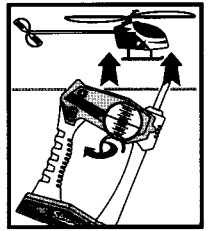
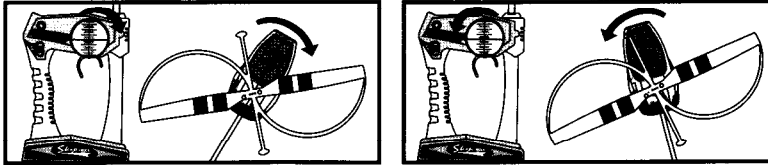

4. Landing

Ease off the trigger slowly and the helicopter will land on the ground slowly. It is recommended landing on soft grassy area to avoid damage of the helicopter.

5. Retrieving the helicopter

Wait for a while until all rotors stop moving. Then turn the transmitter's switch to "OFF" position. Also turn the helicopter's switch to "OFF" position. You can now get back the helicopter.

Note: The normal control range is within 50 meters (165 feet) and the normal flight time is about 30 seconds to 2 minutes (under the wind speed of 0 - 5 MPH). If your flying time is less than that, you may need to change all 8pcs of D type alkaline batteries inside the launching pad charging station.

BATTERY REPLACEMENT

A. Replace the battery for the Transmitter

When the red power light becomes dim or the helicopter is not under control, please replace the 9-V alkaline battery inside the transmitter.

B. Replace the batteries for the Launching Pad Charging Station

1. When the red power light and charge light become dim while charging the helicopter, please replace the all batteries (8pcs D-type alkaline batteries) inside the charging station.
2. Please replace all batteries (8 pcs D-type alkaline batteries) if the helicopter cannot fly even after charging.

When replacing batteries, please refer to "Batteries Installation" in earlier chapter.

CAUTION: Do not expose the batteries to direct heat, short circuit them or try to take them apart.

UNIT STORAGE

The packaging box and foam tray should be kept and reused for proper storage of helicopter. Please return the helicopter to the foam tray after each use.

FAQ

Helicopter is not flying

- Power of charging station become low, replace its batteries.
- The helicopter is running out of battery, need to recharge immediately.
- Transmitter's power becomes low, replace its batteries.

The Charging light of Launching Pad is not ON while charging

- Make sure you have set the switch of to "BATTERY" if you are charging by D-type alkaline batteries, or "ADAPTER" if you are charging by official AC adaptor.
- Make sure you have set the switch of the helicopter to "OFF & CHARGE" position.
- Please check the batteries polarity for the D-type alkaline batteries
- You may have to replace all D-type alkaline batteries if they are exhausted
- Make sure you have inserted the charge nozzle into the helicopter and push firmly to ensure it is all the way inside.

No Control on the helicopter

- Check the power of the transmitter. Make sure you have switched on the transmitter
- Make sure the antenna is fully extended
- Do NOT fly in wind.

Helicopter cannot fly very high

- Pull the trigger hard to make the helicopter fly higher.
- Check if you need to re-charge the battery. Make sure the speed of rotor is fast.
- Make sure the batteries inside the Launching Pad Charging Station are not exhausted.

Helicopter lands too quickly

- Ease off the trigger slowly for slow landing

Instruction for transformer toys

- Toy is not intended for children under 3 years old;
- The toy must only be used with the recommended transformer;
- The transformer is not a toys;
- Toys liable to be cleaned with liquid are to be disconnected from the transformer before cleaning;

"Any battery charger / transformer to be used with the toy should be regular examined for potential hazards, such as damage to the cable or cord, plug, enclosure or other parts, and that, in the event of such damage, the toy must not be used until that damaged has been properly removed."



PRODUCT SPECIFICATIONS

Fly height: 15 meters (50 feet) high
Range of control: 50 meter (165 feet)
Operational frequency : 27.17 MHz
Remote controller power by : alkaline type 9V x 1 (not included)
Intelligence charging station power by : alkaline type D x 8 (not included)
Official AC adaptor for charging station (optional)
Main rotor dia: 370 mm (14.6")

Tail rotor dia: 97 mm (3.8")
Total length: 490 mm (19.3")
Total height : 110mm (4.3")
Fuselage length : 380 mm (15")
Fuselage width : 75 mm (3")
Fuselage height: 75mm (3")
Helicopter Weight: approx. 140g
Build in rechargeable battery: NiMH 7.2V

This device complies with Part 15 of the FCC Rules. Operation is subject to the following two conditions : (1) this device may not cause harmful interference, and (2) this device must accept any interference received, including interference that may cause undesired operation.



Warning: Changes or modifications to this unit not expressly approved by the party responsible for compliance could void the user authority to operate the equipment.

NOTE: This equipment has been tested and found to comply with the limits for a Class B digital device, pursuant to Part 15 of the FCC Rules. These limits are designed to provide reasonable protection against harmful interference in a residential installation. This equipment generates, uses and can radiate radio frequency energy and, if not installed and used in accordance with the instructions, may cause harmful interference to radio communications.

However, there is no guarantee that interference will not occur in a particular installation. If this equipment does cause harmful interference to radio or television reception, which can be determined by turning the equipment off and on, the user is encouraged to try to correct the interference by one or more of the following measures :

- Reorient or relocate the receiving antenna.
- Increase the separation between the equipment and receiver.
- Connect the equipment into an outlet on a circuit different from that to which the receiver is needed.
- Consult the dealer or an experienced radio / TV technician for help.