

WIRELESS DOORBELL INSTALLATION (CL2050T-RH2000R)

*. Installation for Transmitter & Receiver

1 • Transmitter -

- ① Discharge the Transmitter case: (as fig.1) hold the transmitter case with right hand & push button under this case with left hand to take off the "wall cap".

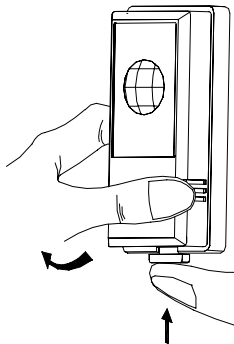
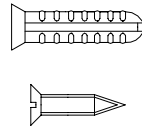

fig 1



plastic screw sock(rim): \varnothing 6 L25
tap screw: M3 L16

fig 2

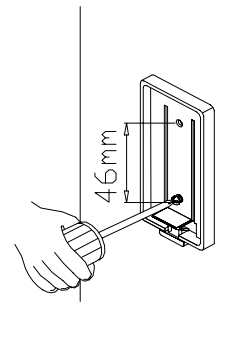

fig 3

- ② Installation on the wall: find a proper position on wall or door, make 2 holes with (distance 46mm, Dia:6mm, depth:25mm) Then put "plastic screw sock: (as fig 2) into these holes. Screw the wall cap On the wall or door.
- ③ Install the transmitter case: hold the top portion of transmitter case with left hand (as fig 4) make About 10 degrees slant with wall cap then push to upper. When the protrusion transmitter case is Come into the concavity of wall cap with right hand (as fig 5). Upon hearing "KA", the installation Is finished.

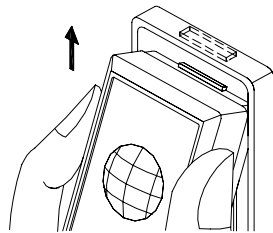

fig 4

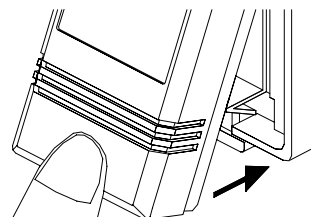

fig 5

2 • Receiver -

- ① Installation for hanging screw: keep within 150ft distance of transmitter (in plan field). Find a Proper position indoor and make 2 holes/with distance 60mm, dia.: 6mm, width:25mm (as fig 6) Then put "plastic screw cap" into these holes & screw the tap screw (as fig 7).
Remarks: tap screw should leave 8-9mm out of wall
- ② Install the receiver: shoot the hanging hole (as fig 6) to the tap screw on wall then pull down the Receiver case slightly (as fig 8)

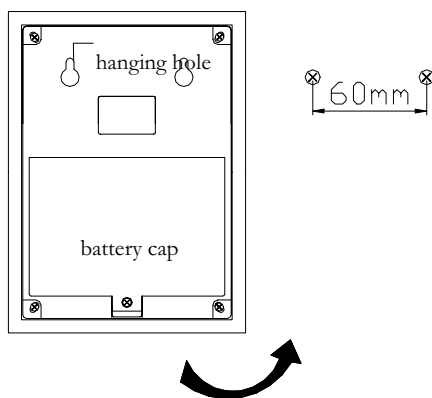
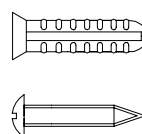

fig 6



plastic screw (rim): \varnothing 6 L25
tap screw: M4 L27

fig 7

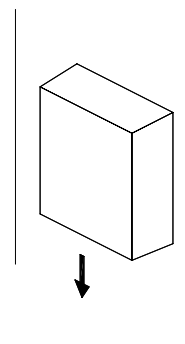

fig 8

**** Battery installation/replacement & selection code adjusted**

1. Battery replacement:

- ① Transmitter-Battery installation/replacement: Take off transmitter case. Open the back-side battery Cap (as fig 9)
Battery Standard : 23A 12V
Remarks : Beware that the positive/negative & battery standard should be exactly as required.

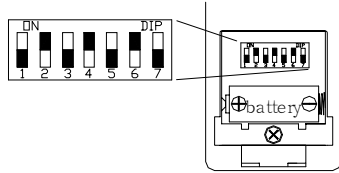

fig 9

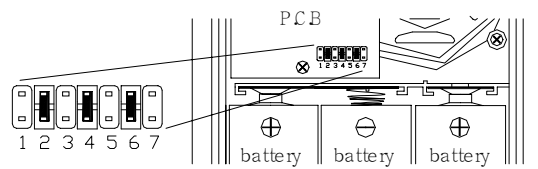

fig 10

- ② Receiver-Battery installation/replacement: un-screw the battery cap (as fig 6), be sure install The battery in right position (as fig 10)
Battery standard: D 1.5V
Remarks : Beware that the positive/negative & battery standard should be exactly as required

2. Selection Code Adjusted:

There are 7 selections code on both Transmitter & Receiver (ad fig 9 & fig 10) for choosing. Adjusted selection code of Transmitter to “ON”, for example: fig 9 selection code “ON” – 246 Then the receiver selection code will be “ON” – 246 (fig 10) via jumped circuit automatically.
Remarks : The selection code for Transmitter & Receiver shall be complied.

***** Notice & Common Defects Inspection:**

1. Working Frequency: 312MHZ
2. The Transmitter & receiver shall be kept away from water & damp. The battery is strictly followed Battery standard. These notices are required for avoiding damage the electric elements & lasting Products used.
3. The available distance between Transmitter & Receiver is 150ft(in vast field). Do not over this Distance always!
4. If the “Red Lights” on the Transmitter does not work. Please check whether the battery positive & Negative is correct!
5. If the “Red Lights” on Transmitter can work, but the Doorbell Receiver don’t work. Please check:
 - (1) Whether the battery positive & negative is correct
 - (2) Whether the distance between Transmitter & Receiver is available
 - (3) Whether the selection code is complied
6. Do not install the transmitter on “IRON DOOR” to avoid influence. If the receiver is installed Beneath Door or Window will be more effective for use.

FEDERAL COMMUNICATIONS COMMISSION INTERFERENCE STATEMENT

This equipment has been tested and found to comply with the limits for a Class B digital device, pursuant to Part 15 of the FCC Rules. These limits are designed to provide reasonable protection against harmful interference in a residential installation. This equipment generates, uses and can radiate radio frequency energy and, if not installed and used in accordance with the instructions, may cause harmful interference to radio communications. However, there is no guarantee that interference will not occur in a particular installation. If this equipment does cause harmful interference to radio or television reception, which can be determined by turning the equipment off and on, the user is encouraged to try to correct the interference by one or more of the following measures:

- Reorient or relocate the receiving antenna.
- Increase the separation between the equipment and receiver.
- Connect the equipment into an outlet on a circuit different from that to which the receiver is connected.
- Consult the dealer or an experienced radio/TV technician for help.

CAUTION:

To assure continued FCC compliance:

Any changes or modifications not expressly approved by the grantee of this device could void the user's authority to operate the equipment.

This device complies with Part 15 of the FCC Rules. Operation is subject to the following two conditions: (1) this device may not cause harmful interference, and (2) this device must accept any interference received, including interference that may cause undesired operation.