



# SBT-7200 *User Guide*

Bluetooth Headset



## Contents

### Before using your headset

Checking the accessories .....	4
Your headset overview .....	5
Wearing the headset .....	6
Charging the headset .....	7

### Get Started

Turning the headset on/off .....	8
Pairing with your Bluetooth phone .....	9

### Basic Use

Making a call .....	10
Making a voice activated call .....	10
Rejecting a call .....	10
Redialing the last number .....	11
Ending a call .....	11
Answering a call .....	11
Switch the call between phone and headset .....	11
Adjust the volume .....	11

### Appendix

Troubleshooting .....	12
Product information .....	13

## Care and maintenance

**Please read this user guide carefully before using the headset.  
This provides important safety and maintenance information.**

### ! Use Safety

Do not drop, knock, or shake the device.  
Do not expose the headset or any of its supplied parts to rain or other liquids.  
Do not store the device at high temperatures.  
Keep all accessories including the headset out of the reach of small children.

### ! Do not attempt to open the device.

Users shall not attempt to perform service, adjustments or repairs on the unit.  
It must be returned to the purchase point or authorized service agency.

### ! Use only chargers approved by Samsin Innotec.

The use of any other types may invalidate any approval or warranty,  
and may be dangerous.

### ! Do not place the headset near a microwave oven, cordless phones, or 2.4 GHz WiFi networking.

⚠ **Do not use harsh chemicals, cleaning solvents, or strong detergents to clean the device.**

⚠ **Do not store the headset in hot or cold areas when you are using the headset and make sure it is safely protected.**

This device complies with Part 15 of the FCC Rules.

Operation is subject to the following two conditions:

(1) this device may not cause harmful interference, and

(2) this device must accept any interference received, including interference that may cause undesired operation.

⚠ **CAUTION: Changes or modifications not expressly approved by the party responsible for compliance could void the user's authority to operate the equipment.**

**IMPORTANT NOTE:** To comply with RF exposure requirements, this device may not be co-located with any other transmitter or antenna

Samsin Innotec, distributors, and agencies are not liable to for any incidental or consequential damages arising from the use or misuse of the product.

This user guide has been written based on product specifications.

Product specifications are subject to change without notice.

Please read the user's guide to get started, and to make the best use of the headset's many features.

**Before using  
your headset**

### • Checking the accessories



**Headset**



**Charger**



**User Guide**

## • Your headset overview

### | Headset

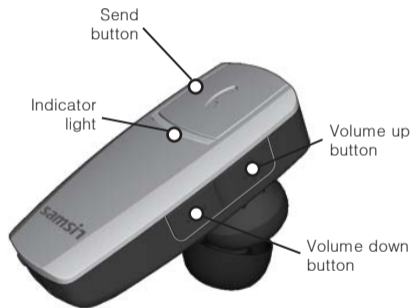

## • Wearing the headset

Your headset uses a rechargeable battery. You must charge the battery fully before using the headset for the first time.



- Charging the headset



Connect the charger cable  
Connect the charger to a wall outlet.

## Get Started Basic Operations

- Turning the headset on/off

	Press and hold	LED
On	The send button for 8 seconds.	The indicator light flashes in blue and red color
Off	The send button for 8 seconds.	The indicator light flashes in blue and red color

- **Pairing with your Bluetooth phone**

1. **Ensure the headset is off.**  
Then press and hold the send button for 8 seconds.
2. **The indicator light on your headset will flash in red and blue color. Then set your Bluetooth phone to discover the headset by following your phone's guide.**
3. **Your phone will find the SBT-7200 headset and ask if you want to pair with it. Confirm this by pressing the Yes or Ok key.**
4. **Enter a passkey or PIN, 0000(4 zeros), then press the Yes or Ok to confirm it.**

\* If pairing was successful,  
the indicator light will flash in blue every 3 seconds.

## Basic Operations

- **Making a call**

To make a call, use your phone in the normal way when the headset is connected to your phone. After you confirm the connecting tone, press and hold the send button for 2 seconds.

- **Making a voice activated call**

If the voice recognition feature is on, you can make a voice activated call. Press and hold the send button for 2 seconds. You will hear the voice-activation tone. Say the name of the person you wish to call.

- **Rejecting a call**

This feature may be supported if your headset is connected to the phone in a hands-free profile depending on your phone's setting or type.

## • Redialing the last number

Press the send button to access the recent call list.  
Press and hold the send button to make a call to the last number you have dialed or received.

## • Ending a call

To end a call, press the send button.

## • Answering a call

After you hear the ring tone, press the send button.  
To end a call, press the send button again

## • Switch the call between phone and headset

To switch the call between the headset and a compatible phone, press and hold the send button for 2 seconds during a call.

## • Adjusting the volume

Press the volume button  to increase or  to the volume during a call.

## • Troubleshooting

### *Unable to turn the headset on*

Recharge the headset

### *Unable to connect with a device / Unable to work with my cordless phone at home*

Your headset is compatible with most Bluetooth devices that support the headset and/or hands-free profile(s). Ensure your device has Bluetooth capability by contacting your device manufacturer. The headset is not designed for use with cordless phones.

### *The talk and standby times are shorter than normal*

The battery can be charged and discharged many times, but it will eventually wear out. If the talk and standby times are noticeably shorter than normal, please replace the battery. Using unauthorized battery may damage the headset.

### *Something may cause interference with my conversation when I am using the headset*

Appliances such as cordless phones and wireless networking equipment may cause interference with your conversation. To reduce any interference, keep the headset away from other devices that use or produce radio waves.

### *The headset is not working properly*

Take it to the nearest authorized service facility for service.

## Appendix | Product information

Bluetooth version	v2.0
Using Frequency	2.402 ~ 2.480GHz
Using Channel	0 ~ 79CH
Transmission Power Level	Class II
Effective Range	10m
Dimensions	19 x 39 x 11(28) (mm)
Weight	10g
Operating Temperature	0 ~ 40℃
Standby Time	Max. 80 hours
Talk Time	About 4 hours
Charging Time	About 2 hours
Input Power	AC 100 ~ 240v, 50/60Hz, 0.16A
Output Power	DC 5v, 350mA

*Memo*