

- NOTES: (UNLESS OTHERWISE SPECIFIED)
1. PLACE BADGE IN FINAL ASSEMBLY CLAMPING FIXTURE.
  2. INSERT FIVE SCREWS INTO SCREW HOLES AS SHOWN.
  3. USE A TORQUE LIMITED DRIVER SET AT 14 OzF-In, DRIVE SCREWS INTO LOCATION UNTIL SET TORQUE IS ATTAINED.
  4. INSERT SCREW CAPS, ITEMS 10 AND 9 INTO POSITIONS.
  5. ADHERE BADGE LABEL (ITEM 7) TO BACK OF BADGE.

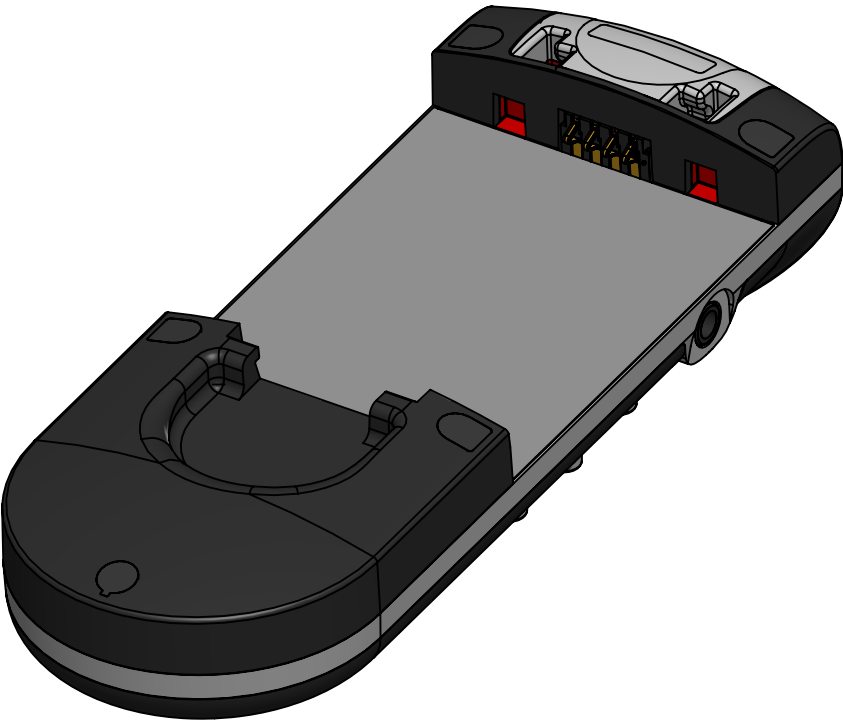
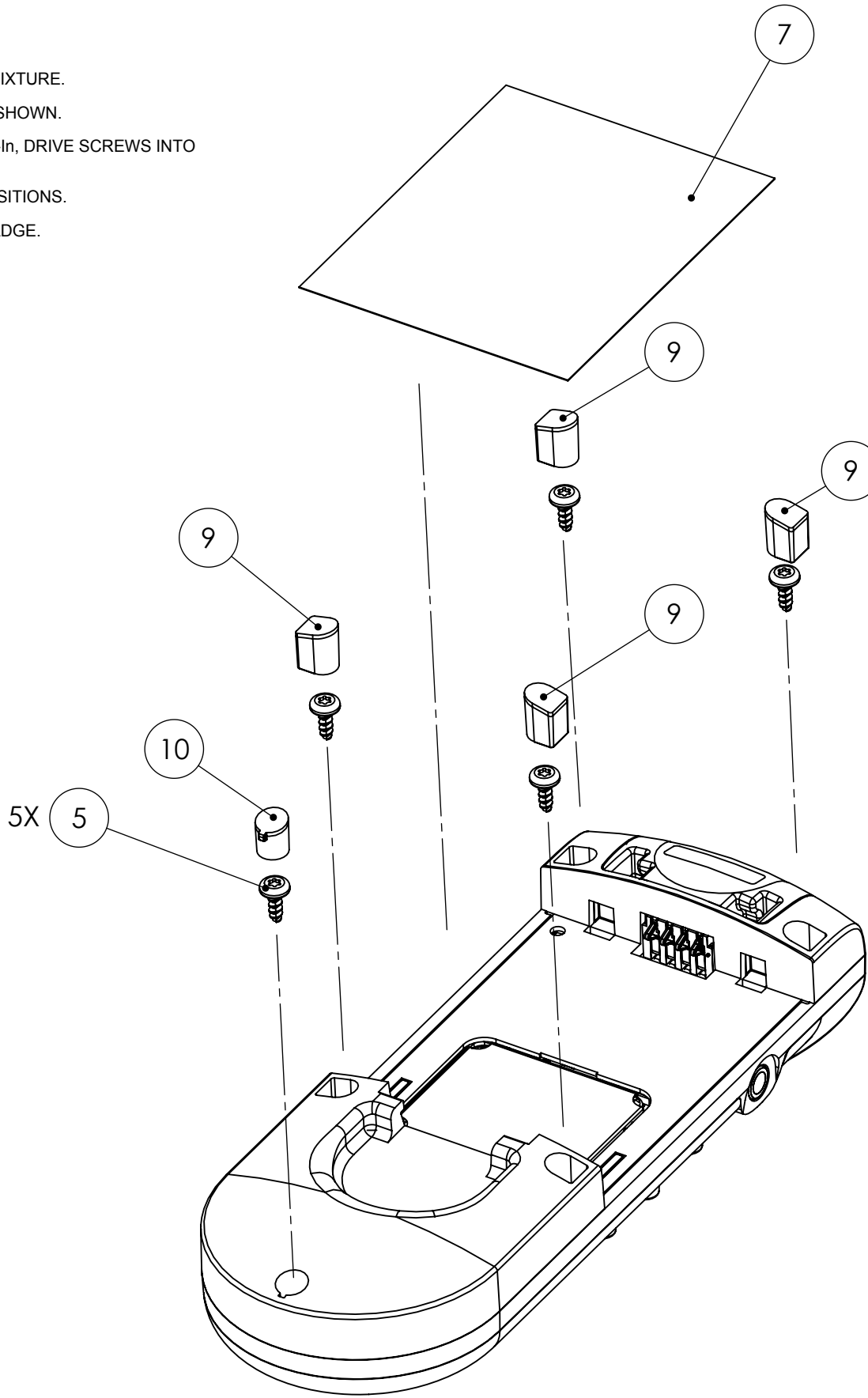

vocera			525 RACE STREET SAN JOSE, CA 95126 WWW.VOCERA.COM 408.882.5100
TITLE:			
Generic Drawing, Top Assembly, Monopole, Badge, B3000			
SIZE	DWG. NO.	REV	
B	132-01600	A	
SCALE: 1:1			SHEET 6 OF 7