

# WONLINK

## WS-131F

### Hardware Installation



#### 1. Special Features of Wonlink WS-131F

- 1) Up to 400Mbps transfer rate
- 2) Support various OS (windows 98SE/ ME/ 2000/XP, MAC OS 9.X over)
- 3) Portable & compact size
- 4) Strong to impact(Durable metal case, Leather Case)
- 5) External power unnecessary
- 6) Power from USB or IEEE1394 bus
- 7) Plug & play
- 8) Ultramodern design

#### 2. Specification of Wonlink WS-131F

Model	Wonlink ws-131F
Interface	IEEE 1394
System Requirement	Win98SE, winME/2000/XP Mac OS 9.X OVER
Transmission Speed	Up to 400 Mbps
Dimensions	77mm X 15mm X 132mm (W X H X D)
package includes	Wonlink WS-131F 1394 Cable(6-4 Pin) USB power cable User's Manual Screw driver Leather case
Weight	186g (with HDD)

#### Notice

- 1) Some PC or Mac systems may not provide adequate power the external hard drive.
- 2) All specifications are subject to change without notice.

### 3. Assembling Wonlink WS-131F

The Deal Drawing for installation in next is convenient to assembling Wonlink WS-131F for reference.

A. Firstly, prepare these items from package.

- a. 2.5" HDD (2.5" HDD is not included in package)
- b. Wonlink WS-131F case
- c. 8 pieces of large bolt (4 for application, 4 for spare)
- d. 16 pieces of small bolt (8 for application, 8 for spare)

B. Separate upper and low aluminum cases.

Upper, lower aluminum cases, a plastic guide and a PCB board are included in Wonlink WS-131F case

C. Place HDD on the PCB board and connect the HDD to the socket on the board.

D. Using 4 pieces of large bolts, screw the PCB board on to the plastic guide.

E. Using 8 pieces of small bolts, replace the upper and lower aluminum cases back on the plastic guide and screw the upper and lower cases to the plastic guide.

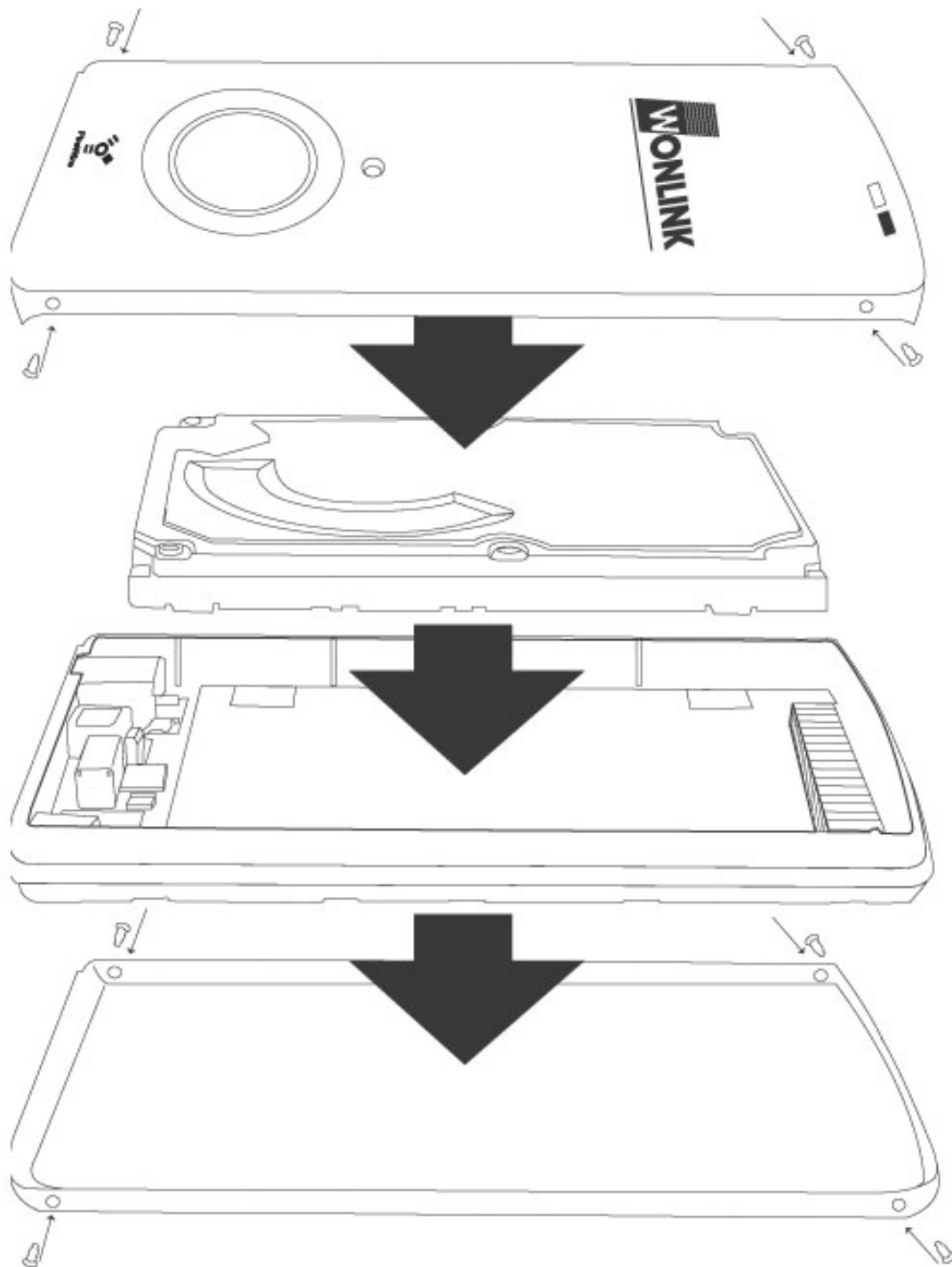

■ Deal Drawing for installation ■

#### 4. Reference of Wonlink WS-131F

- Blue LED indicator : shows the statue of transferring data
- Red LED indicator : shows the statue of connecting with Wonlink WS-131F
- IEEE1394 6pin connector : connects IEEE1394 6pin cable
- IEEE1394 4pin connector : connects IEEE1394 4pin cable
- Switch : controls the of Wonlink WS-131F
- USB power cable : supports extra power from USB port when adequate power is not supplied.

Information to user : Part 15, Paragraph 15.21 and 15.105(b)

Changes or modifications not expressly approved by the party responsible for compliance could void the user's authority to operate the equipment

#### FCC Notice

NOTE : This equipment has been tested and found to comply with the limits for a Class B digital device, pursuant to Part 15 of the FCC Rules. These limits are designed to provide reasonable protection against harmful interference in a residential installation. This equipment generates, uses and can radiate radio frequency energy and, if not installed and used in accordance with the instructions, may cause harmful interference to radio communications. However, there is no guarantee that interference will not occur in a particular installation. If this equipment does cause harmful interference to radio or television reception, which can be determined by turning the equipment off and on, the user is encouraged to try to correct the interference by one or more of the following measures:

- Reorient or relocate the receiving antenna.
- Increase the separation between the equipment and receiver
- Connect the equipment into an outlet on a circuit different from that to which the receiver is connected.
- Consult the dealer or an experienced radio/TV technician for help.

-----  
This device complies with Part 15 of the FCC Rules. Operation is subject to the following two conditions: (1) this device may not cause harmful interference, and (2) this device must accept any interference received, including interference that may cause undesired operation.