

1:6 SCALE RADIO CONTROL SPORTS CAR

SPECIFICATIONS ;

- 2 Channel radio control
- 7 driving functions ;
Forward-left-right
Backward-left-right-stop
- Incredible digital headlight
- Front and rear suspension with coil spring units
- Two speed selectable

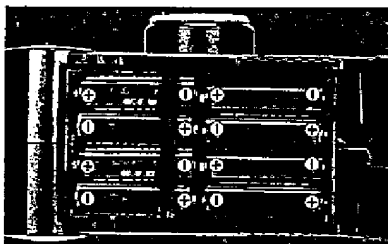

8 x 1.5V R6 (AA SIZE) BATTERIES



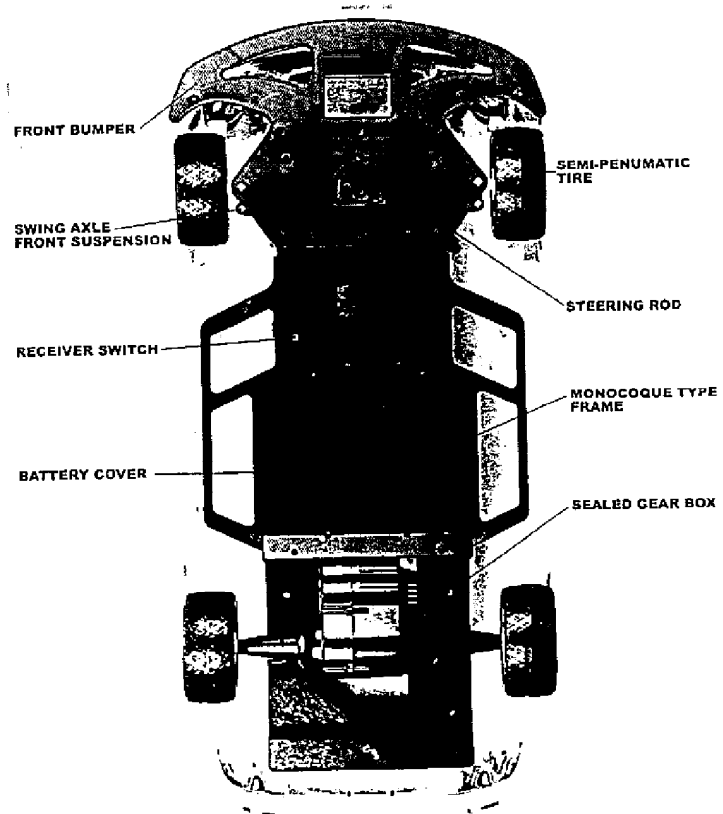
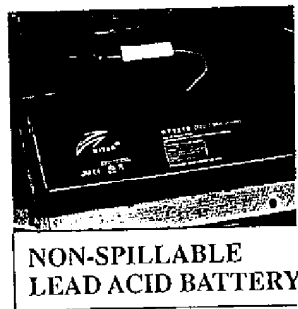

ATTENTION !

- Do not pick up the car while in motion.
- Keep fingers, hair and loose clothing away from the tires and the wheel hub while the car is on.
- To avoid accidental operation, remove battery pack when not in use.
- First the transmitter and then the car must be switched on to avoid an unexpected operation. Always switch off in reverse order, i.e. first the car and then the transmitter.

THE MODEL CAR IS NOT RESPOND TO THE SIGNAL ;

- Switch remote control and model car to ON position.
- Have batteries been correctly inserted ?
- Are the battery contacts bent or dirty ?
- Are battery empty or faulty ?

THE MODOL CAR IS NOT RESPONDING PROPERLY THE REMOTE CONTRIL IS OUT OF RANGE ;

- Are the batteries losing strength?
- Are there other radio controlled vehicles being used in the vicinity, may be using the same frequency ?
- Are metal grids/fences causing disturbance.
- Transmitter towers or pylons often interfere with the control of the models.

R/C 1:6 RACING CAR

CAUTION - ELECTRICALLY OPERATED PRODUCT - Not recommended for children under 6 years of age. As with all electrical products, precautions should be observed during handling and use to reduce the risk of electrical shock.

MODEL: 12300
AC-DC ADAPTOR
INPUT: 120VAC 60Hz 3.6W
OUTPUT: 12VDC 300mA
Class 2 Transformer

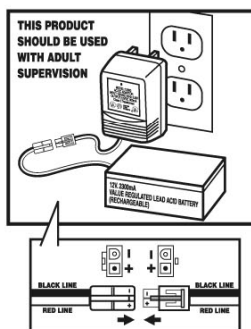

FOR AGES 6 & UP

**NON-SPILLABLE
LEAD ACID BATTERY**

CAUTION - ELECTRICALLY OPERATED PRODUCT -
" CHARGE ONLY FOR RECHARGEABLE TYPE BATTERIES. OTHER TYPES OF BATTERIES MAY BURST CAUSING INJURY TO PERSONS AND DAMAGE. "

Batteries and Charger Required

- Condition of battery pack for best results by charging according to these instructions on every charge.
- On the first charge, expect a shorter run time. Run times will increase over the next 6 charges, reaching specified run times.

Battery Heat

- It is normal for the Battery getting hot after use. But be careful. Wait until battery is cool before charging (around 20 minutes or more if required).
- Charging batteries when they are not will severely reduce the number of times they can be recharged.
- After charging. Battery pack will be warm.

Drain Down - Cool Down - Charge Up

- After the first charge, for best performance always run the battery pack all the way down before recharging. Run until vehicle wheels/fans/motors slow to a stop.
- If you are operating a boat, hovercraft or other water vehicle in operate other kinds of vehicles in or near water.)
- Allow charging, battery pack to cool before recharging.

Recharging Instructions

- **Adaptor/Charger must be handled by adult.**
- Connect the battery pack plug to the charger as shown.
- Plug wall pack charger into a standard wall outlet.
- Normal charging time is approximately 4 hours. And Unplug charger from wall after 4 hours of charging.
- After charging, battery pack will feel warm.

Rechargeable Battery Tips

- Do not overcharge the battery pack.
- NiCd battery packs are not like alkaline batteries. They lose all their power suddenly, not gradually, and vehicle will stop very soon after slowing down becomes noticeable.
- Store your battery pack discharged.
- Your battery pack will hold a charge for a shorter time in hot weather. Otherwise, you can charge a battery a day.
- When your battery pack's running time gets shorter and shorter, probably it's getting close to the end of its life and needs to be replaced.

CAUTION :

The transformer be periodically examined for conditions that may result in the risk of fire, electric shock, or injury to persons and that, in an event such conditions, the transformer should not be used until properly repaired.

FCC Information

This device complies with Part 15 of the FCC Rules. Operation is subject to the following two conditions:

- (1) This Device may not cause harmful interference, and
- (2) This device must accept any interference received, including interference that may cause undesired operation.

Note: This equipment has been tested and found to comply with the limits for CLASS B digital device, pursuant to Part 15 of FCC Rules. These limits are designed to provide reasonable protection against harmful interference when the equipment is operated in a commercial environment. This equipment generates, uses and can radiate radio frequency energy and, if not installed and used in accordance with the instructions, may cause harmful interference to radio communications. However, there is no guarantee that interference will not occur in a particular installation. If this equipment does cause harmful interference to radio or television reception, which can be determined by turning the equipment off and on, the user is encouraged to try correct the interference by one or more of the following measures:

- 1.1. Reorient or relocate the receiving antenna.
- 1.2. Increase the separation between the equipment and receiver.
- 1.3. Connect the equipment into an outlet on a circuit different from that to which receiver is connected.
- 1.4. Consult the dealer or experienced radio/TV technician for help.

WARNING

Changes or modifications not expressly approved by the manufacturer could void the user's authority to operate the equipment.